

PROJECT REFERENCE NO. R-5725	SHEET NO. 8
ROADWAY DESIGN ENGINEER 5/3/2023	HYDRAULICS ENGINEER 5/4/2023
Michael S. Burns, Jr. DB 495230 PG 437	Reid E. Kolb DB 043870 PG 131
STEWART	VHB Engineering NC, P.C. (C-3705) 940 Main Campus Drive, Suite 500 Raleigh, NC 27606
DOCUMENT NOT CONSIDERED FINAL UNLESS ALL SIGNATURES COMPLETED	

-Y2A-	-RABT2-	-DRIVE1-	-DRIVE2-	-Y2B-
PI Sta 13+79.58 Δ = 12° 08' 44.0" (LT) D = 6' 01' 52.1" L = 201.38' T = 101.07' R = 950.00' S _e = Exist.	PI Sta 17+07.68 Δ = 14° 57' 51.5" (RT) D = 8' 11' 06.4" L = 182.82' T = 91.93' R = 700.00' S _e = 3% Runoff = 60'	PI Sta 18+51.28 Δ = 29° 31' 43.6" (LT) D = 28' 38' 52.4" L = 103.07' T = 52.71' R = 200.00' V _D = 25 MPH	PI Sta 10+00.00 Δ = 36° 00' 00.0" (LT) D = 143' 14' 22.0" L = 251.33' T = 0.00' R = 40.00'	PI Sta 11+34.07 Δ = 46° 02' 11.1" (LT) D = 57' 17' 44.8" L = 80.35' T = 42.49' R = 100.00' V _D = 20 MPH
PI Sta 10+40.49 Δ = 44° 05' 26.3" (RT) D = 57' 17' 44.8" L = 76.95' T = 40.49' R = 100.00' V _D = 20 MPH	PI Sta 10+64.24 Δ = 35° 36' 48.8" (RT) D = 28' 38' 52.4" L = 124.31' T = 64.24' R = 200.00' V _D = 25 MPH			

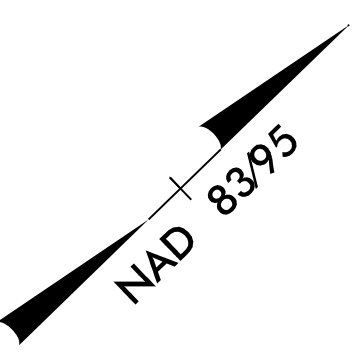

REVISIONS

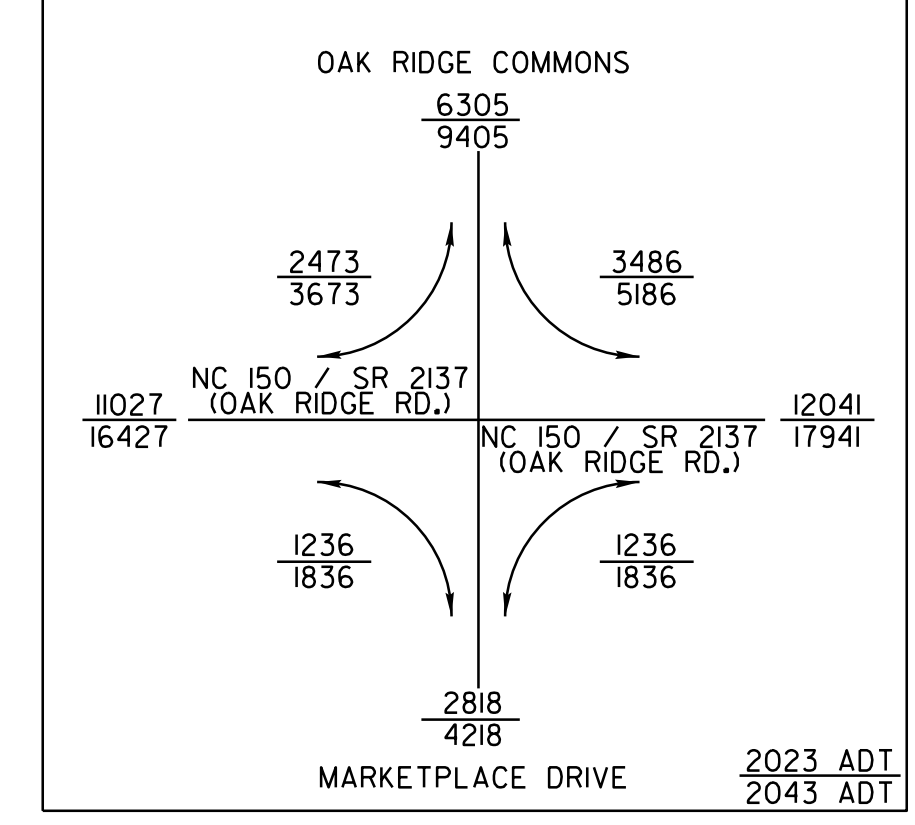
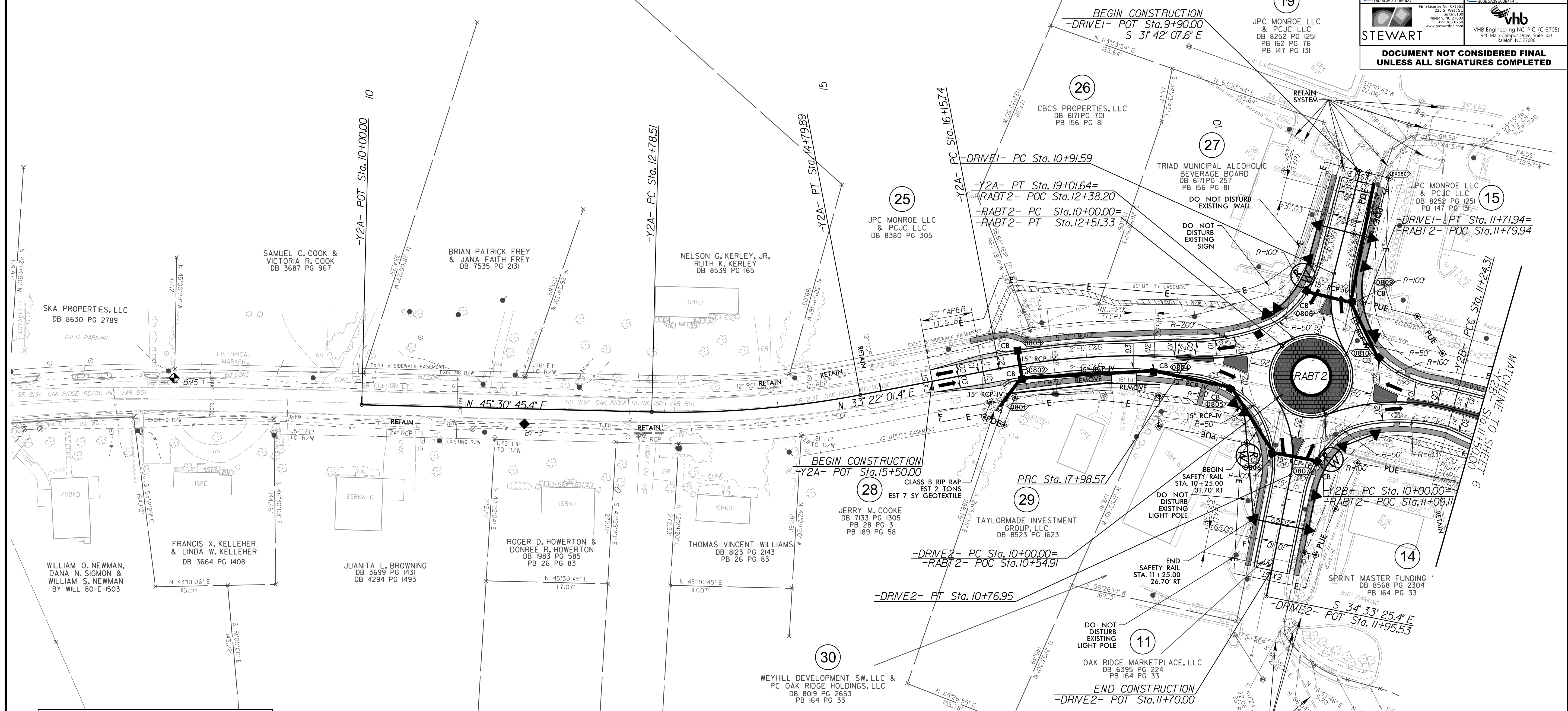

- PROP SIDEWALK REMOVAL
- PROP PAVEMENT REMOVAL
- PROP MONOLITHIC ISLAND
- PROP CONC SIDEWALK
- PROP PAVED SHOULDER
- FOR -Y2A- PROFILE, SEE SHEET 11
- FOR -Y2B- PROFILE, SEE SHEET 12
- FOR -DRIVE1- PROFILE, SEE SHEET 13
- FOR -DRIVE2- PROFILE, SEE SHEET 13
- FOR -RABT2- PROFILE, SEE SHEET 12

5/3/2023 R5725_Rd1_psh08.dgn
11:58:12 AM