

| | |
|--|------------------------------------|
| PROJECT REFERENCE NO. R-5725 | SHEET NO. 6 |
| ROADWAY DESIGN ENGINEER 5/3/2023 | HYDRAULICS ENGINEER 5/4/2023 |
| | |
| Michael S. Burns, Jr. 4455 SC 1000 #437 | Reid E. Kolod 4455 SC 1000 #437 |
| | |
| DOCUMENT NOT CONSIDERED FINAL UNLESS ALL SIGNATURES COMPLETED | |

-L2-
 PI Sta 28+82.84
 $\Delta = 33^{\circ} 39' 16.0''$ (RT)
 $D = 3^{\circ} 22' 13.2''$
 $L = 998.55'$
 $T = 514.14'$
 $R = 1700.00'$
 $S_e = 3\%$
 Runoff = 90'

-Y2B-
 PI Sta 11+76.02
 $\Delta = 2^{\circ} 57' 42.3''$ (RT)
 $D = 2^{\circ} 51' 53.2''$
 $L = 103.38'$
 $T = 51.70'$
 $R = 2000.00'$
 $V_D = 30$ MPH
 $S_e = 2\%$
 Runoff = 60'

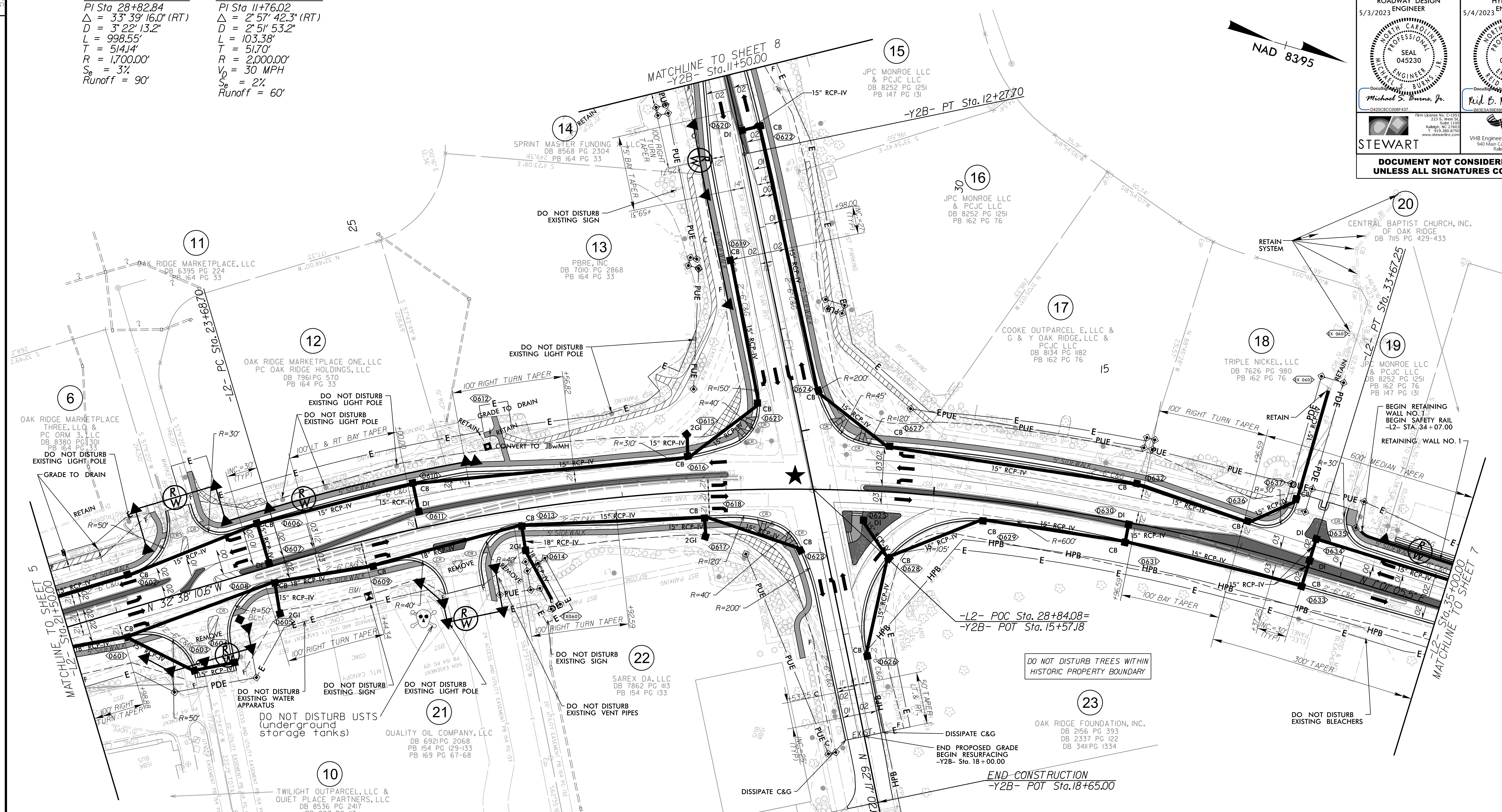
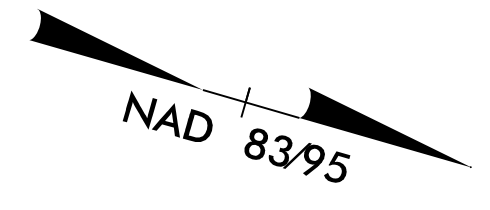

REVISIONS

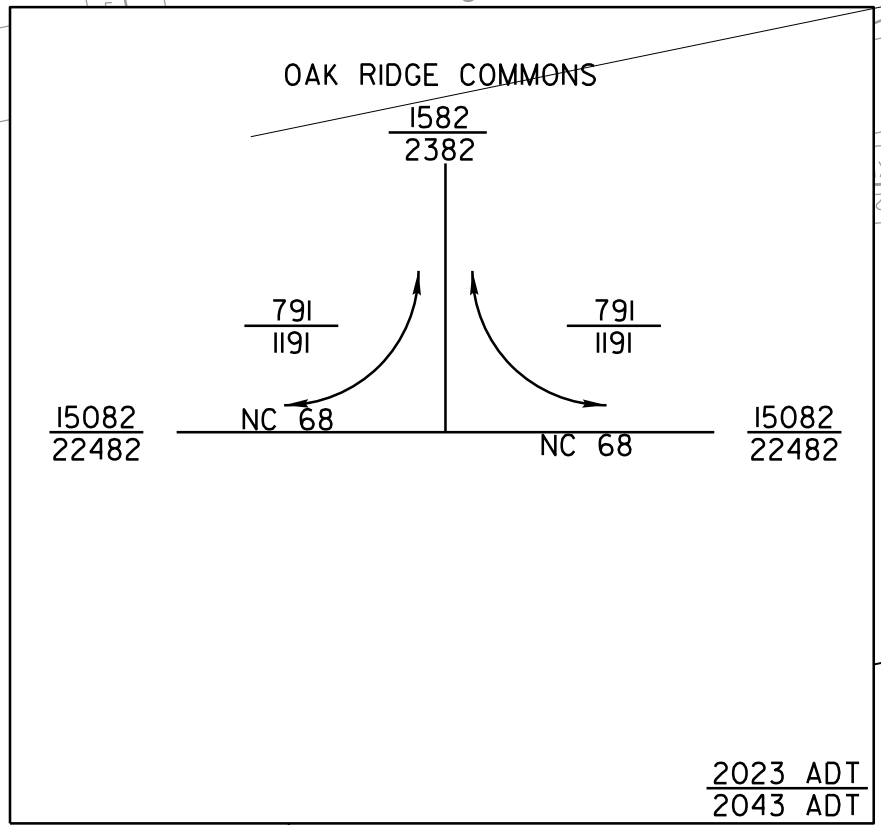
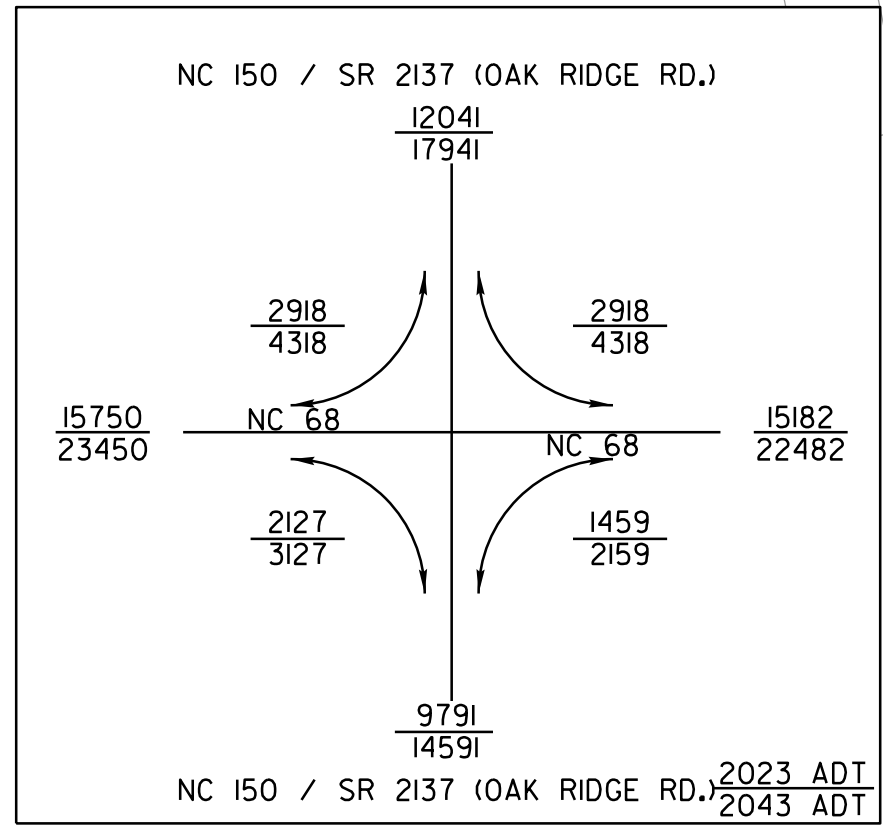
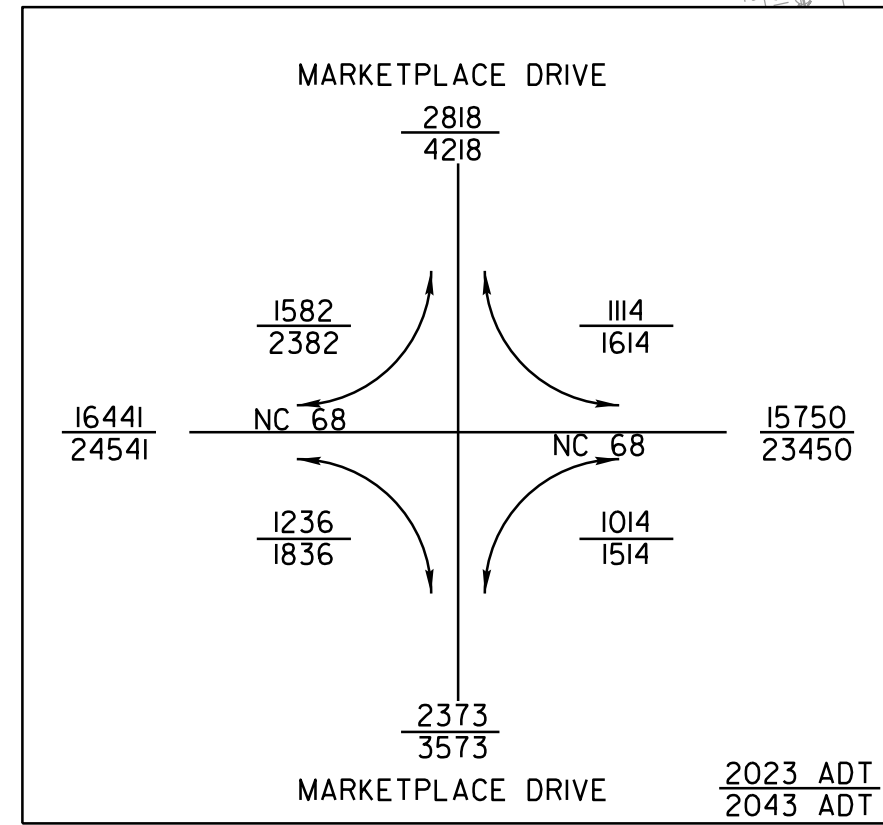

★ SIGNAL MODIFICATION

- PROP SIDEWALK REMOVAL
- PROP PAVEMENT REMOVAL
- PROP MONOLITHIC ISLAND
- PROP CONC SIDEWALK
- PROP PAVED SHOULDER

FOR -L2- PROFILE, SEE SHEET 10
 FOR -Y2B- PROFILE, SEE SHEET 12

5/7/2023 R5725_RdL_psh06.dgn