

PROJECT REFERENCE NO.		SHEET NO.	
U-2729		EC-5/CONST.-5	
RW SHEET NO.			
ROADWAY DESIGN ENGINEER		HYDRAULICS ENGINEER	

CLEARING AND GRUBBING  
EROSION CONTROL FOR  
CONSTRUCTION SHEET 5

NOTE:  
PERIMETER EROSION CONTROL MEASURES SHALL BE  
INSTALLED DURING CLEARING AND GRUBBING PHASE.

NOTE:  
USE FABRIC INSERT INLET PROTECTION DEVICES AS DIRECTED  
IN LIEU OF ROCK INLET SEDIMENT TRAP TYPE C TO AVOID  
IMPOUNDING RUNOFF ON ROADWAYS OPEN TO THE PUBLIC.

66 x 24 x 3  
1.5 inch Skimmer  
with 1.125 inch  
Orifice Diameter  
6 ft. weir  
ID 5.2 B

65 x 32 x 3  
1.5 inch Skimmer  
with 1.25 inch  
Orifice Diameter  
8 ft. weir  
ID 5.1 B

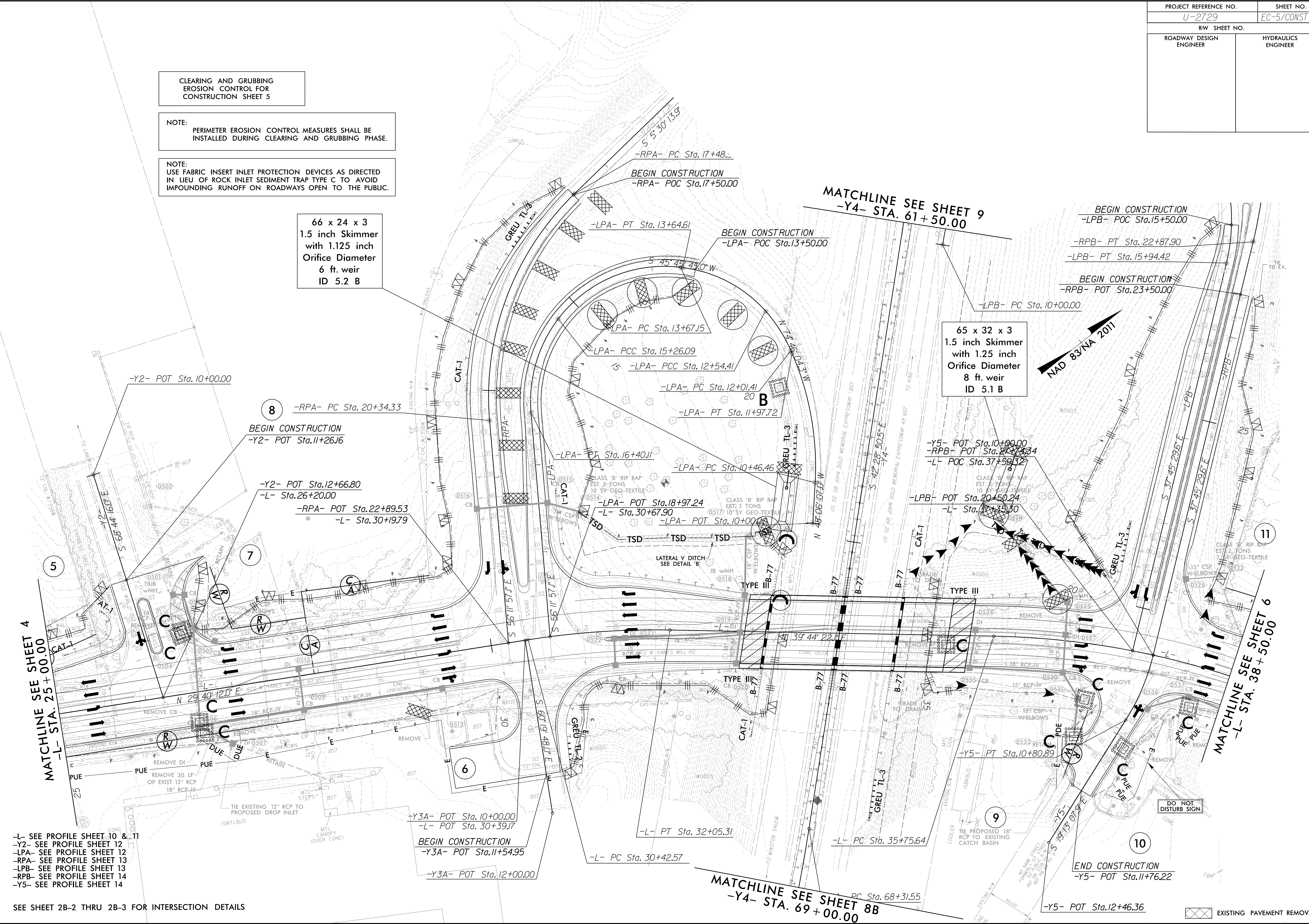

-L- SEE PROFILE SHEET 10 & 11  
-Y2- SEE PROFILE SHEET 12  
-LPA- SEE PROFILE SHEET 12  
-RPA- SEE PROFILE SHEET 13  
-LPB- SEE PROFILE SHEET 13  
-RPB- SEE PROFILE SHEET 14  
-Y5- SEE PROFILE SHEET 14

SEE SHEET 2B-2 THRU 2B-3 FOR INTERSECTION DETAILS

3/20/2023 11:45 AM C:\PSH\_CG.dgn

EXISTING PAVEMENT REMOVAL