

09/08/99

STATE	STATE PROJECT REFERENCE NO.	SHEET NO.	TOTAL SHEETS
N.C.	U-2729	RW01	16

TIP PROJECT: U-2729

STATE OF NORTH CAROLINA
DIVISION OF HIGHWAYS

SURVEY CONTROL, EXISTING CENTERLINES,
RIGHT OF WAY, EASEMENTS AND PROPERTY TIES

FORSYTH COUNTY

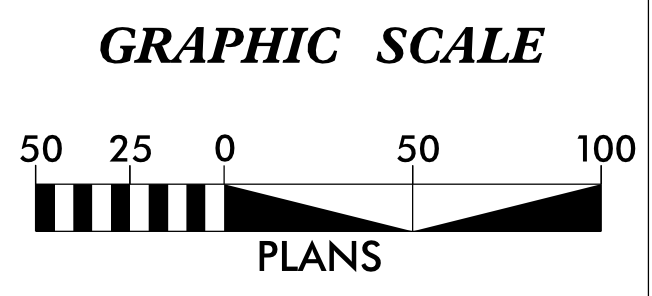
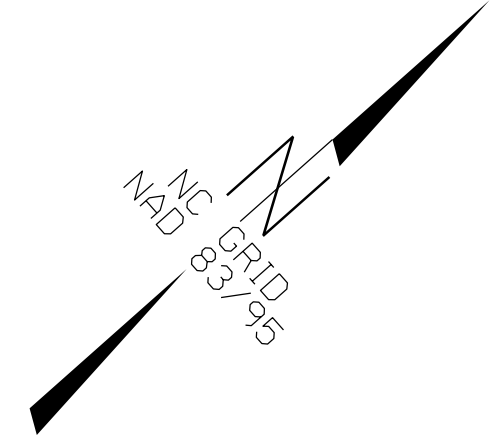
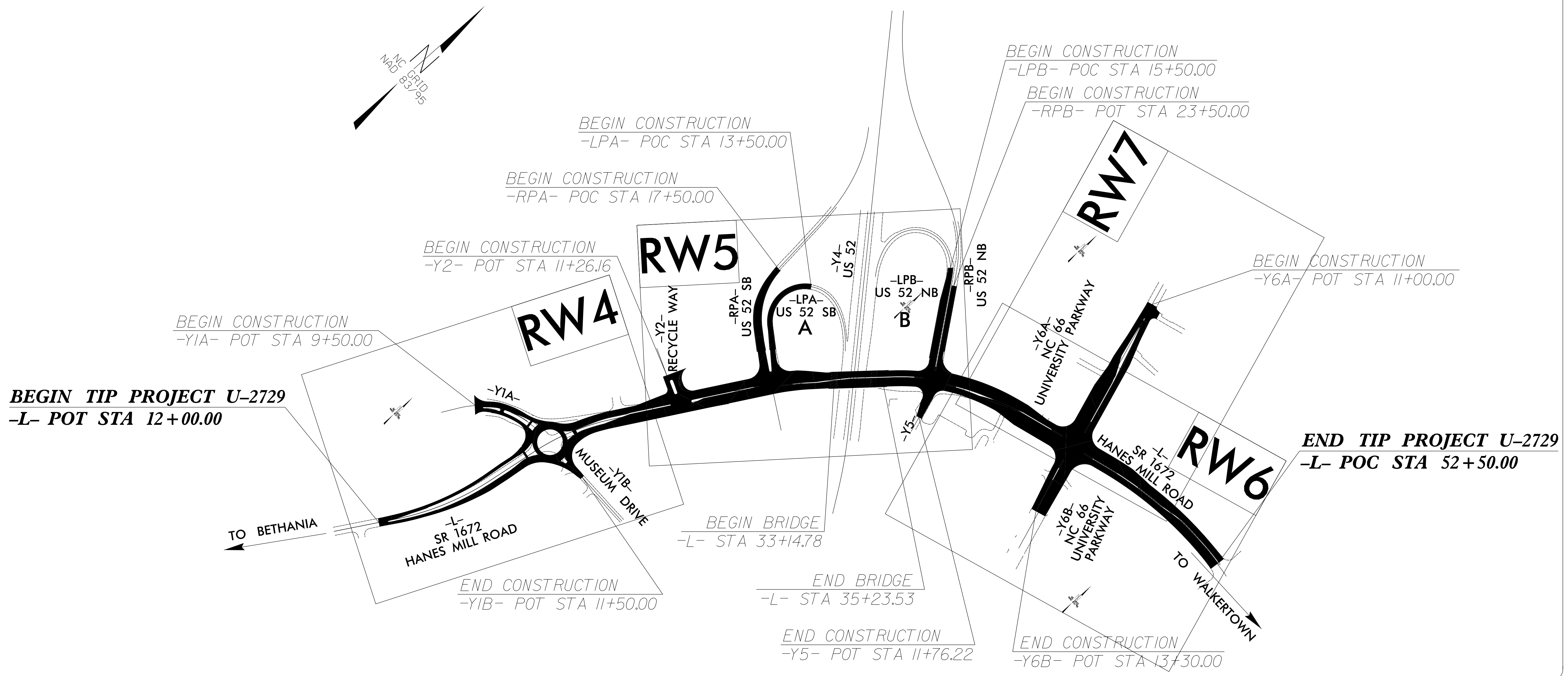

DATUM DESCRIPTION

THE LOCALIZED COORDINATE SYSTEM DEVELOPED FOR THIS PROJECT IS BASED ON THE STATE PLANE COORDINATES ESTABLISHED BY NCDOT FOR MONUMENT "U2579C-1" WITH NAD 83/95 STATE PLANE GRID COORDINATES OF NORTHING: 876,419.2850(ft) EASTING: 1,651,591.6020(ft) ELEVATION: 976.94(ft)

THE AVERAGE COMBINED GRID FACTOR USED ON THIS PROJECT (GROUND TO GRID) IS: 0.99995453

THE N.C. LAMBERT GRID BEARING AND LOCALIZED HORIZONTAL GROUND DISTANCE FROM "U2579C-1" TO -L- STATION 10+00.00 IS N 69°44'16.8" W 32,301.63(ft)

ALL LINEAR DIMENSIONS ARE LOCALIZED HORIZONTAL DISTANCES VERTICAL DATUM USED IS NAVD 88

Prepared in the Office of:

2018 STANDARD SPECIFICATIONS

RIGHT OF WAY DATE:
XXXX/XXXX

LETTING DATE:
XXXX/XXXX

PROFESSIONAL LAND SURVEYOR

DocuSigned by:
Michael L. Mosinger
F088F8F2334AE
SIGNATURE:

03/09/2023
Date:

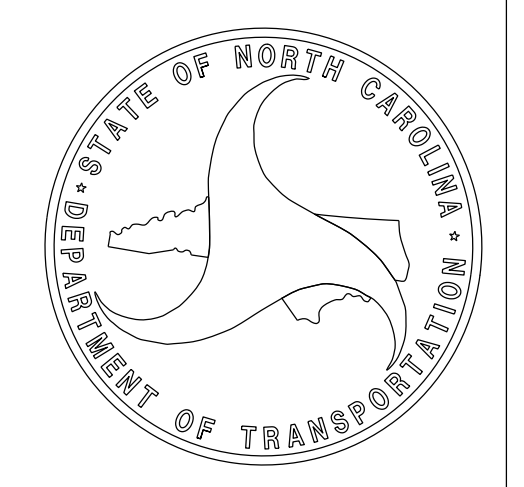
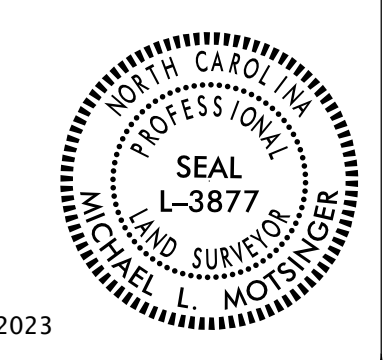

09-MAR-2023 17:06
G:\UP\ban\U2729\Right_of_Way_Staking\Julie\files\tobechecked\U2729_Is_rw01.dgn
mmotisinger AT LS-3286.rtl