

8/17/19

36	+75 EX. RW	45	+95 -Y6B- 80'	57	+15 -Y6A- 60'
37	+55 EX. RW	46	+00 -Y6B- EX. RW	58	+35 -Y6A- 86.31'
38	+83.29 EX. RW	47	+35 -Y6B- 80'	59	EX. RW 50'
39	+85 EX. RW	48	+25 -Y6B- 80'	60	+75 -Y6B- 75'
40	+20 60'	49	+30 120'	61	+30 -Y6B- EX. RW 50'
41	+39.95 75'	50	+40 120'	62	+30 -Y6B- 60'
42	+55 65'	51	+45 105'	63	+30 85'
43	+30 65'	52	+45 90.14'	64	+30 85'
44	+35 75'			65	+30 85'
				66	+30 85'
				67	+30 85'
				68	+73 -L- 73'
				69	+94.52 -L- 73'
				70	+45.04 -L- 63.48'
				71	+15.16 -L- 131.14'
				72	+00 50'

SEE SHEET 2B-4 FOR INTERSECTION DETAILS

-L- SEE PROFILE SHEET 11
-Y6A- SEE PROFILE SHEET 15
-Y6B- SEE PROFILE SHEET 15

PROJECT REFERENCE NO.	SHEET NO.
U-2729	6
ROADWAY DESIGN ENGINEER	HYDRAULICS ENGINEER
DOCUMENT NOT CONSIDERED FINAL UNLESS ALL SIGNATURES COMPLETED	
Prepared in the Office of:	MOTT MACDONALD
Mott MacDonald I & E, LLC 7621 Purley Road, Suite 115 Fuquay-Varina, NC 27524 www.mottmac.com MOTT MACDONALD NC License No. F-0669	

MATCHLINE SEE SHEET 7
-Y6A- STA. 16+00.00

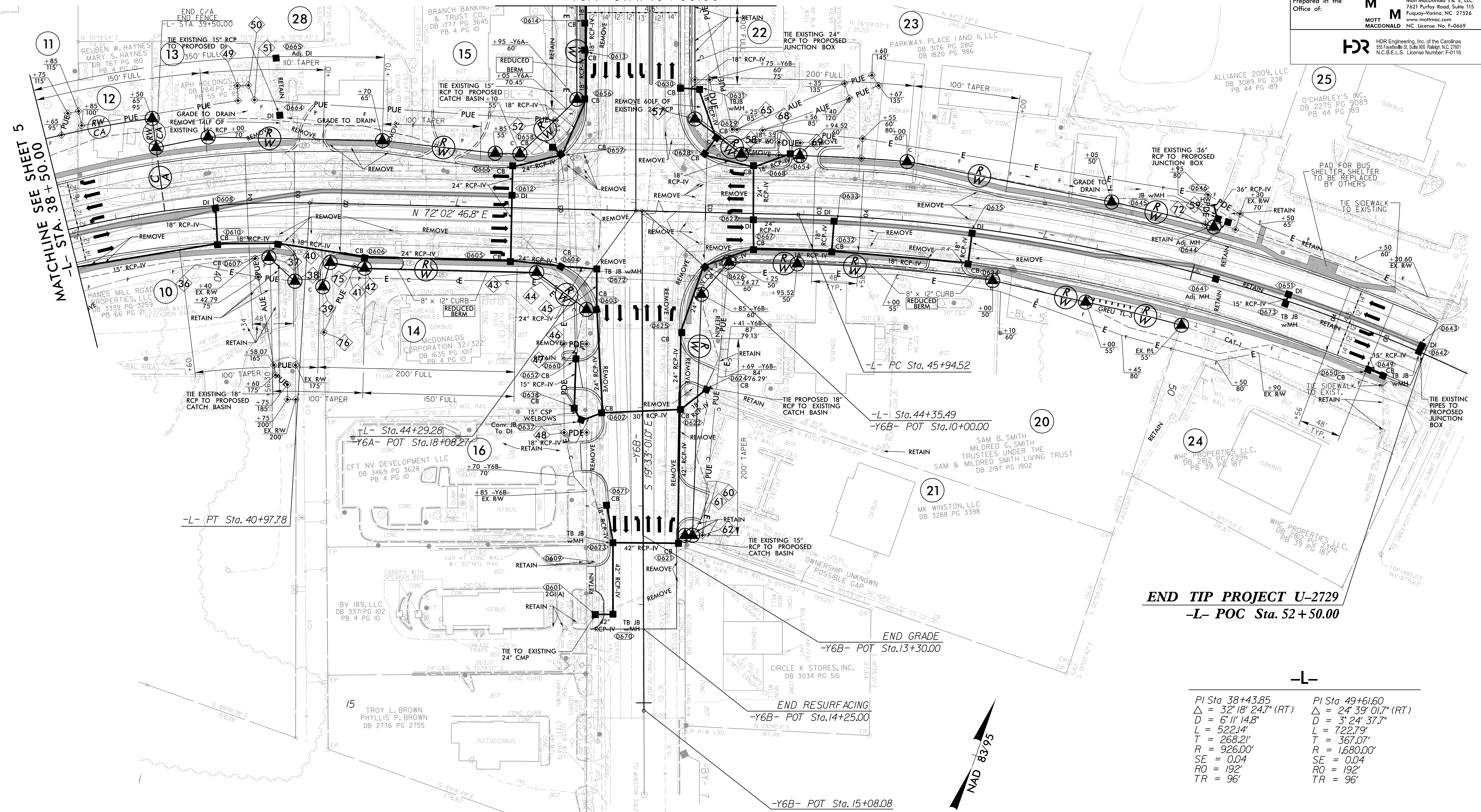

MATCHLINE SEE SHEET 5
-L- STA. 38+50.00

END TIP PROJECT U-2729
-L- POC Sta. 52+50.00

PI Sta 38+43.85	PI Sta 49+61.60
$\Delta = 32' 18" 24.7" (RT)$	$\Delta = 24' 39" 01.7" (RT)$
$D = 6' 11" 14.8"$	$D = 3' 24' 37.7"$
$L = 522.14'$	$L = 722.79'$
$T = 268.21'$	$T = 367.07'$
$R = 926.00'$	$R = 1,680.00'$
$SE = 0.04$	$SE = 0.04$
$RO = 192'$	$RO = 192'$
$TR = 96'$	$TR = 96'$

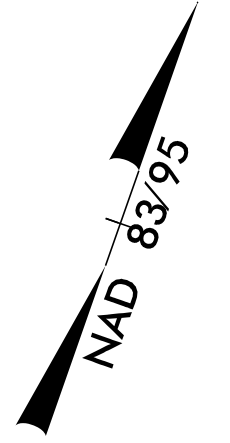

4/6/2023
C:\Users\jwalker\OneDrive\Documents\U-2729_L-adj_psh06.dgn

EXISTING PAVEMENT REMOVAL