

-LPB-

PI Sta 10+58.79 Δ = 20° 17' 15.3" (RT) D = 17' 26' 15.6" L = 116.34' T = 58.79' R = 328.57' SE = 0.08 RO = 144' TR = 36'	PI Sta 11+65.70 Δ = 30° 40' 11.4" (RT) D = 31' 49' 51.8" L = 96.35' T = 49.36' R = 180.00' SE = 0.08 RO = 144' TR = 36'	PI Sta 13+93.02 Δ = 10° 14' 46.5" (RT) D = 38' 42' 48.0" L = 261.53' T = 180.33' R = 148.00' SE = 0.08 RO = 144' TR = 36'	PI Sta 15+35.99 Δ = 32° 31' 07.8" (RT) D = 27' 03' 19.7" L = 120.19' T = 61.76' R = 211.77'
--	---	---	--

-RPA-

PI Sta 14+75.22 Δ = 2° 31' 26.7" (RT) D = 5' 43' 46.5" L = 44.05' T = 22.03' R = 1000.00' SE = 0.08 RO = 192' TR = 48'	PI Sta 19+01.55 Δ = 50° 41' 43.3" (LT) D = 17' 44' 19.1" L = 285.79' T = 153.01' R = 323.00' SE = 0.08 RO = 192' TR = 48'
--	---

-L- SEE PROFILE SHEET 10 & 11
 -Y2- SEE PROFILE SHEET 12
 -LPA- SEE PROFILE SHEET 12
 -RPA- SEE PROFILE SHEET 13
 -LPB- SEE PROFILE SHEET 13
 -RPB- SEE PROFILE SHEET 14
 -Y5- SEE PROFILE SHEET 14

SEE SHEETS 2B-2 THRU 2B-3 FOR INTERSECTION DETAILS
 SEE SHEETS 2G-1 THRU 2G-4 FOR TEMPORARY SHORING PLANS
 SEE SHEETS S-1 THRU S-54 FOR STRUCTURES PLANS
 SEE SHEETS W-1 THRU W-4 FOR RETAINING WALL PLANS

PROJECT REFERENCE NO. U-2729	SHEET NO. 5
ROADWAY DESIGN ENGINEER	HYDRAULICS ENGINEER
DOCUMENT NOT CONSIDERED FINAL UNLESS ALL SIGNATURES COMPLETED	
Prepared in the Office of:	

-LPA-

PI Sta 13+12.30 Δ = 41° 19' 26.3" (LT) D = 37' 41' 40.5" L = 109.63' T = 57.32' R = 152.00' SE = 0.08 RO = 144' TR = 36'	PI Sta 14+54.75 Δ = 59° 54' 37.0" (LT) D = 37' 41' 40.5" L = 158.94' T = 87.60' R = 155.36' SE = 0.08 RO = 144' TR = 36'	PI Sta 15+85.81 Δ = 42° 03' 05.1" (LT) D = 36' 52' 45.9" L = 114.02' T = 59.72' R = 155.36' SE = 0.08 RO = 144' TR = 36'
--	--	--

-Y5-

PI Sta 10+40.80 Δ = 18° 32' 21.7" (RT) D = 22' 55' 05.9" L = 80.89' T = 40.80' R = 250.00' SE = 0.04 RO = 76' TR = 38'
--

-RPB-

PIs Sta 20+17.64 Os = 11° 00' 00.0" Ls = 200.00' LT = 133.59' ST = 66.90' SE = 0.08 RO = 192' TR = 48'

PI Sta 21+87.29 Δ = 22° 25' 21.1" (RT) D = 11° 00' 00.0" L = 203.84' T = 103.24' R = 520.87' SE = 0.08 RO = 192' TR = 48'

PI Sta 31+24.15 Δ = 10° 04' 10.0" (RT) D = 6' 11' 14.8" L = 162.74' T = 81.58' R = 926.00' SE = 0.04 RO = 192' TR = 96'

PI Sta 38+43.85 Δ = 32° 18' 24.7" (RT) D = 6' 11' 14.8" L = 522.14' T = 268.21' R = 926.00' SE = 0.04 RO = 192' TR = 96'
--

-Y4-

PI Sta 69+59.28 Δ = 7° 18' 31.0" (RT) D = 2' 51' 53.2" L = 255.12' T = 127.73' R = 2,000.00'

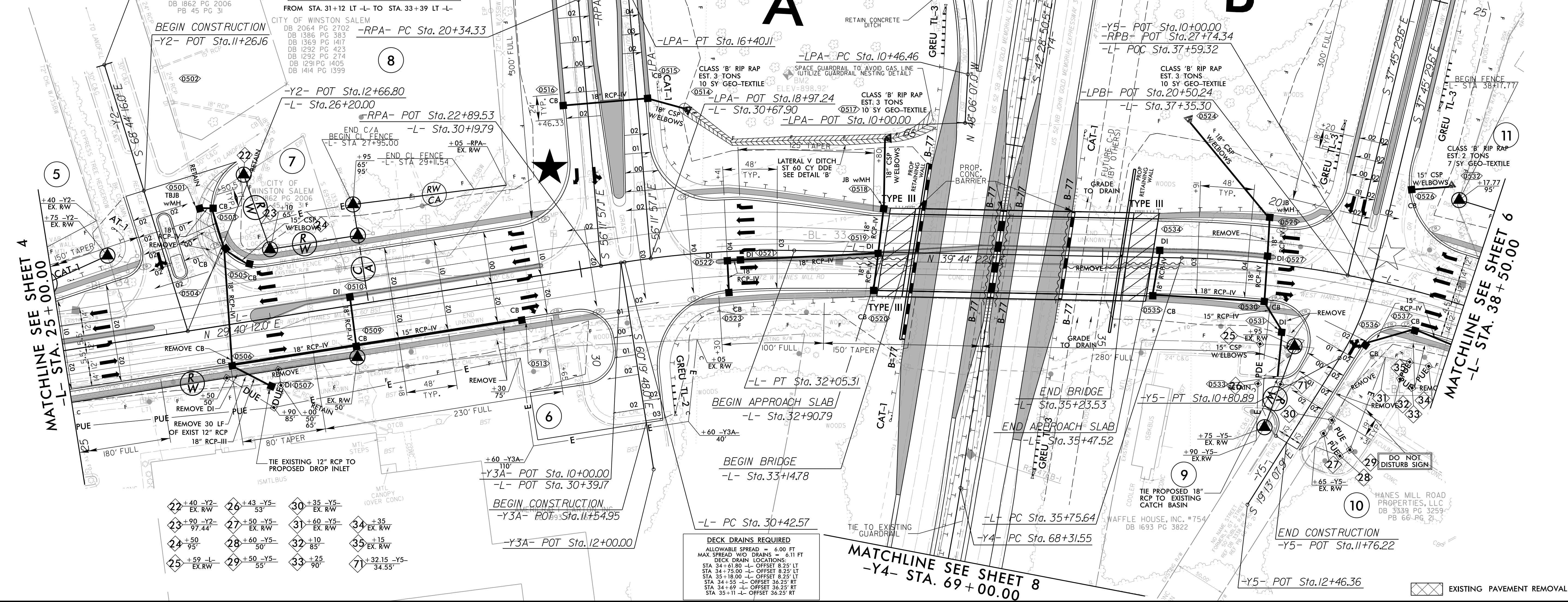
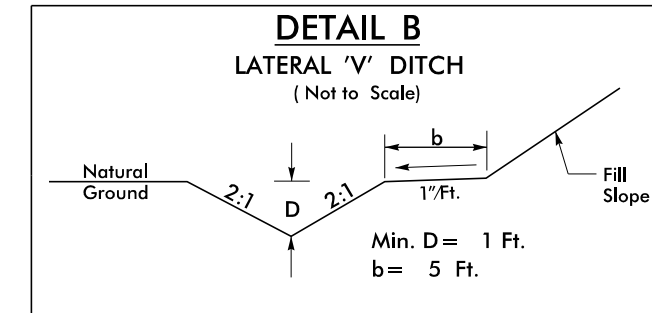

22 +40 -Y2- EX. RW	26 +43 -Y5- EX. RW	30 +35 -Y5- EX. RW
23 +90 -Y2- EX. RW	27 +50 -Y5- EX. RW	31 +60 -Y5- EX. RW
24 +50 -Y2- EX. RW	28 +60 -Y5- EX. RW	32 +10 -Y5- EX. RW
25 +59 -Y2- EX. RW	29 +50 -Y5- EX. RW	33 +25 -Y5- EX. RW
		34 +35 -Y5- EX. RW
		35 +15 -Y5- EX. RW
		36 +32.15 -Y5- EX. RW

DECK DRAINS REQUIRED
 ALLOWABLE SPREAD = 6.00 FT
 MAX. SPREAD W/O DRAINS = 6.11 FT
 DECK DRAIN LOCATIONS:
 STA 34+61.80 -L- OFFSET 8.25' LT
 STA 34+75.00 -L- OFFSET 8.25' LT
 STA 35+18.00 -L- OFFSET 8.25' LT
 STA 34+55 -L- OFFSET 36.25' RT
 STA 34+69 -L- OFFSET 36.25' RT
 STA 35+11 -L- OFFSET 36.25' RT

EXISTING PAVEMENT REMOVAL