

8/17/99

*FOR INTERSECTION DETAILS SEE SHEET 2B-1
**UNLABELED RADII FOR MONOLITHIC CONCRETE ISLAND ARE 1'

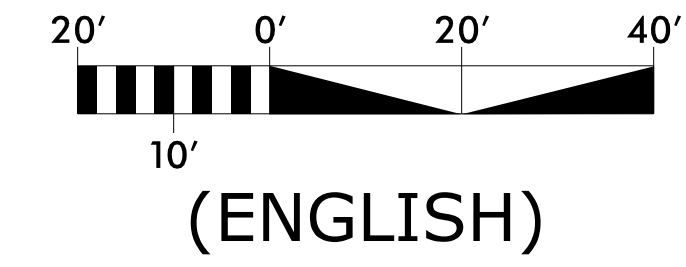

PROJECT REFERENCE NO. U-2729	SHEET NO. 2B-8
RW SHEET NO.	
ROADWAY DESIGN ENGINEER	
<p>DOCUMENT NOT CONSIDERED FINAL UNLESS ALL SIGNATURES COMPLETED</p>	
Prepared in the Office of:	
	<p>Mott MacDonald I & E, LLC 7621 Purfoy Road, Suite 115 Fuquay-Varina, NC 27526 www.mottmac.com NC License No. F-0669</p>

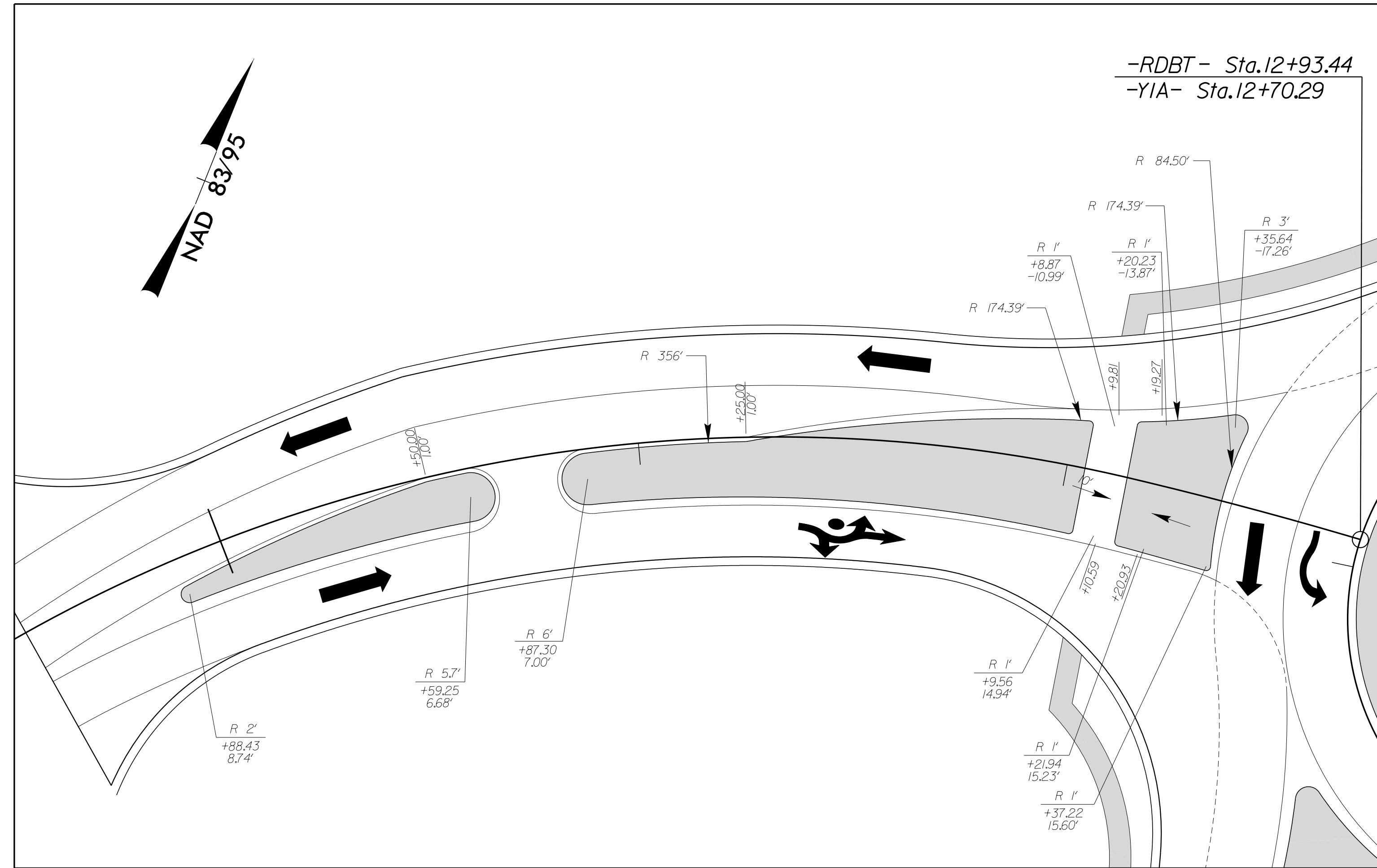

-YIA- ISLAND DETAIL

FOR PLAN, SEE SHEET NO. 4

8/10/03 AM
R:\Roadway\Proj\U2729_rdlj.dsn_islands_det.dgn
D:\K82519