

**U-4424 CULVERT PHASING -L- 96+63
UT TO HOLLY CREEK
EDGECOMBE COUNTY**

PROJECT REFERENCE NO.	SHEET NO.
U-4424	EC-10A/CONST.10
RW SHEET NO.	
<p align="center">VIDYA MOHANDAS, PE EROSION CONTROL LEVEL III CERTIFICATION #3404</p>	

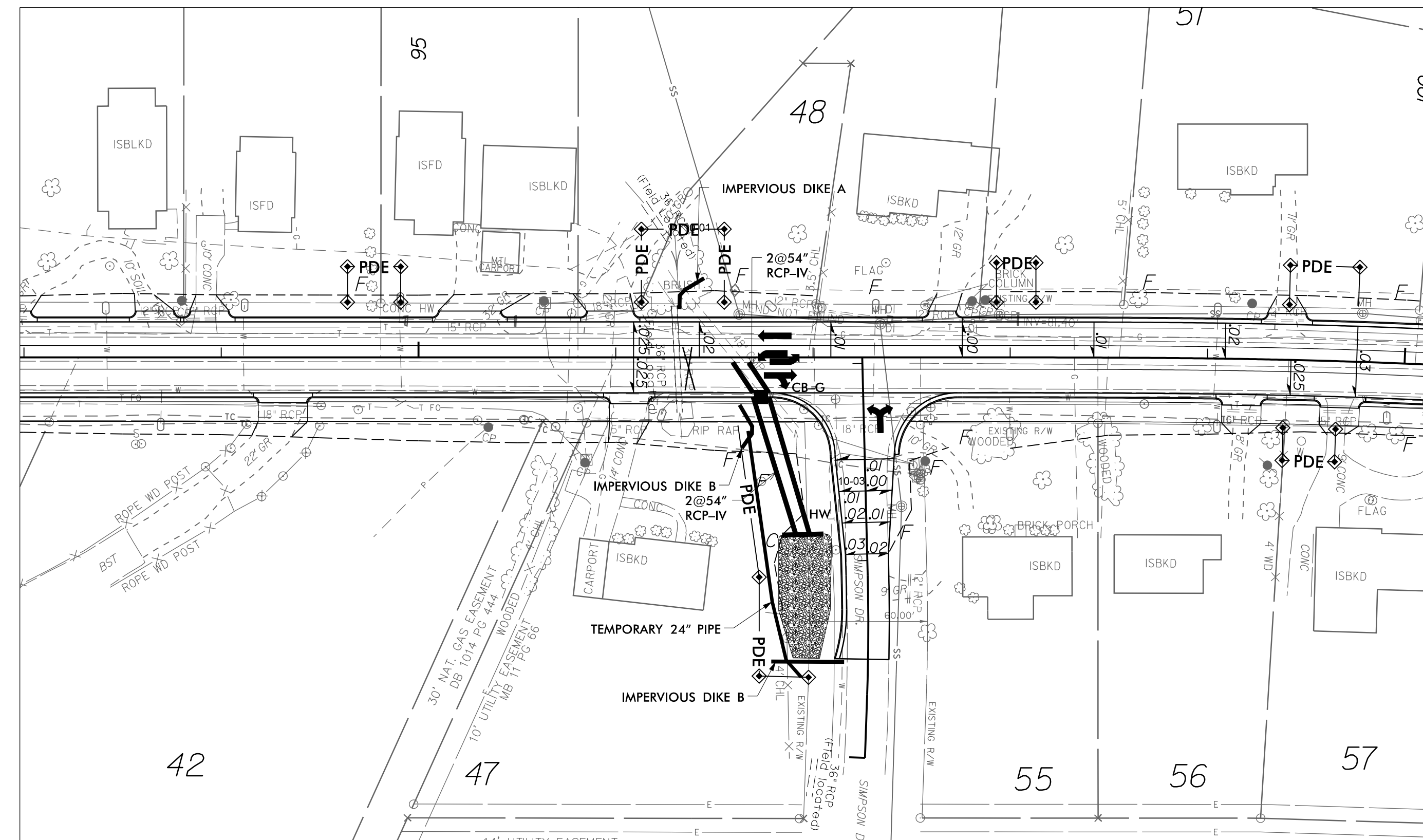

PHASE I

1. UTILIZE SPECIAL STILLING BASIN(S) AS NEEDED DURING THE CULVERT SEQUENCING.
2. INSTALL IMPERVIOUS DIKES A & B AS SHOWN UPSTREAM AND DOWNSTREAM OF EXISTING 48" CMP.
3. INSTALL 24" TEMPORARY PIPE.
4. UTILIZE EXISTING 36" RCP AS TEMPORARY PIPE DURING THE CROSSPIPE SEQUENCING.
5. BEGIN REMOVAL OF DOWNSTREAM HALF OF EXISTING 48" CMP AND REPLACE DOWNSTREAM HALF WITH PROPOSED DUAL 54" RCP PIPES AND SPECIAL CB-G BOX FOR DUAL PIPES.
6. DEWATER CONSTRUCTION AREA INTO SPECIAL STILLING BASIN(S) AS NEEDED WHILE NEW ALIGNMENT IS UNDER CONSTRUCTION.
7. CONSTRUCT DOWNSTREAM CHANNEL IMPROVEMENTS.

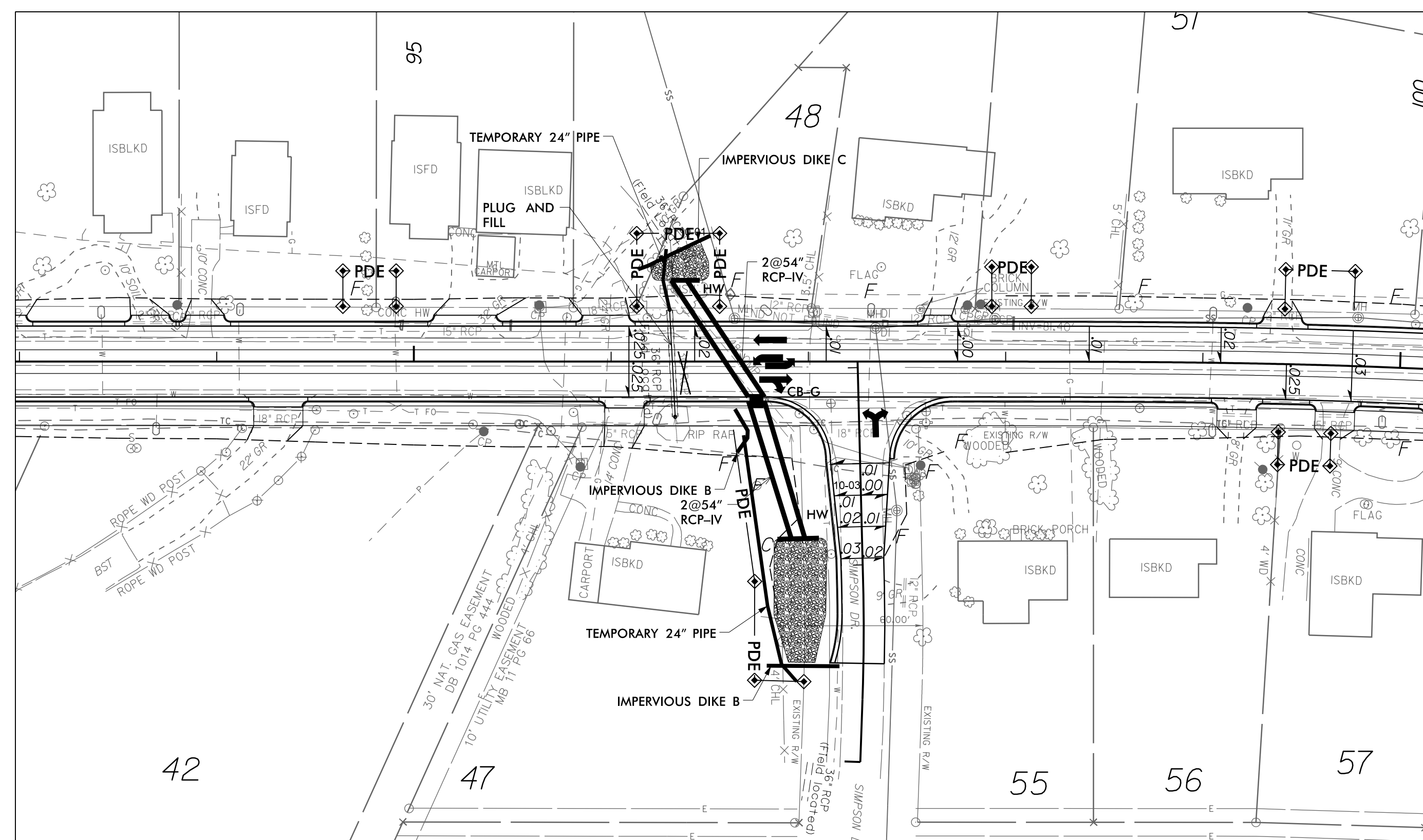

PHASE II

1. MOVE TRAFFIC TO NEWLY CONSTRUCTED ROADWAY.
2. INSTALL UPSTREAM TEMPORARY 24" PIPE.
3. REMOVE IMPERVIOUS DIKE "A" AND INSTALL IMPERVIOUS DIKE "C" TO DIVERT FLOW TEMPORARY PIPE.
4. BEGIN REMOVAL OF UPSTREAM HALF OF EXISTING 48" CMP AND INSTALL REMAINDER OF PROPOSED DUAL 54" RCP PIPES. DEWATER CONSTRUCTION AREA INTO SPECIAL STILLING BASIN(S) AS NEEDED.
5. CONSTRUCT UPSTREAM CHANNEL IMPROVEMENTS.
6. REMOVE IMPERVIOUS DIKES "B" AND "C", SPECIAL STILLING BASIN(S), AND TEMPORARY PIPE. PLUG AND FILL EXISTING 36" RCP CROSSPIPE.
7. COMPLETE ROADWAY.