



8/17/99

PLANS PREPARED BY:



WSP USA  
434 FAYETTEVILLE STREET  
SUITE 1500  
RALEIGH, NC 27601  
TEL: 1.919.836.4040  
FAX: 1.919.836.4099  
LICENSE NO. F-0165

PROJECT REFERENCE NO. U-4424	SHEET NO. 5
ROADWAY DESIGN ENGINEER	HYDRAULICS ENGINEER
	
<b>DOCUMENT NOT CONSIDERED FINAL UNLESS ALL SIGNATURES COMPLETED</b>	

**-L- CURVE DATA**  
 PI Sta 34+72.78  
 $\Delta = 0^{\circ}16'02.6''$  (RT)  
 $D = 0^{\circ}08'35.7''$   
 $L = 186.66'$   
 $T = 93.33'$   
 $R = 40,000.00'$   
 $e = NC$   
 $Ds = 50$  MPH

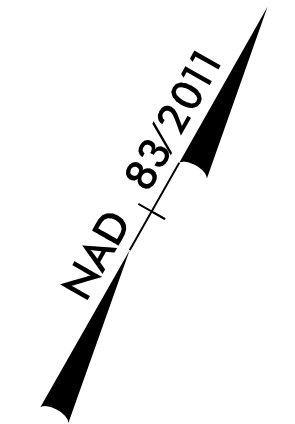
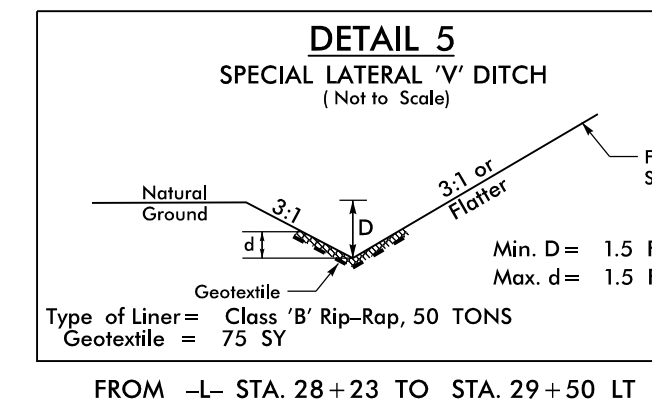
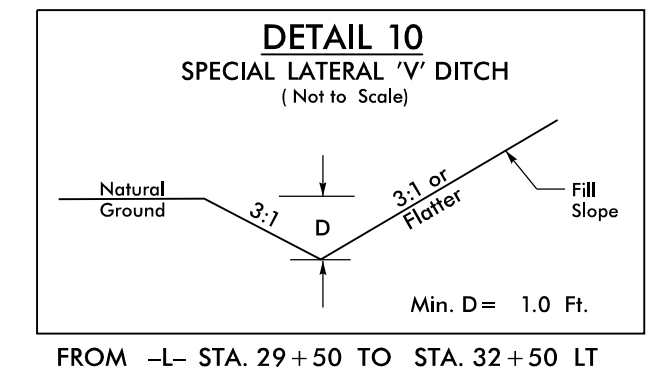
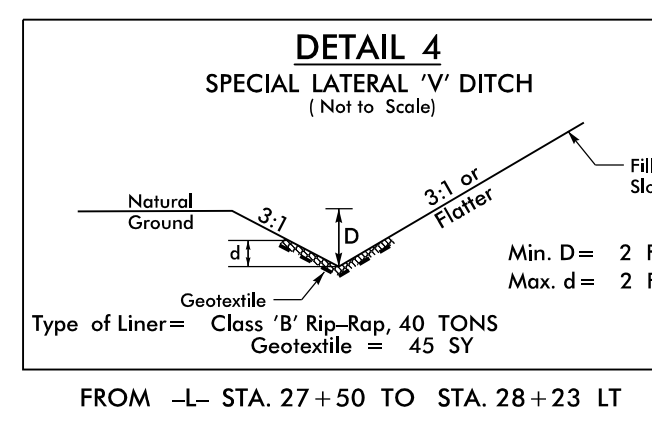
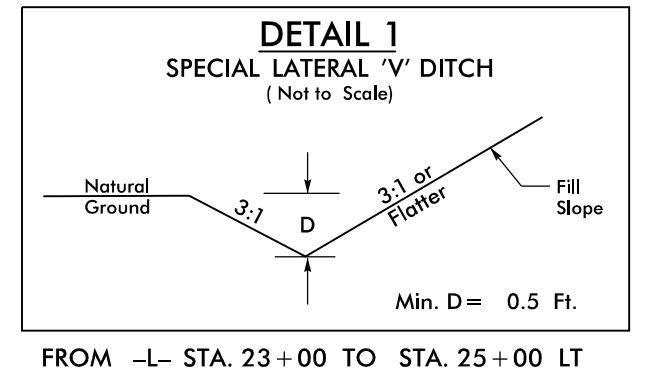
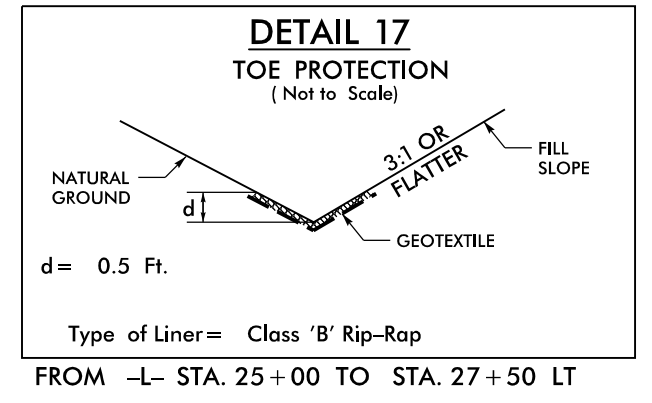

MATCH LINE SEE SHEET 04  
-L- STA. 21+50.00

MATCH LINE SEE SHEET 06  
-L- STA. 35+50.00

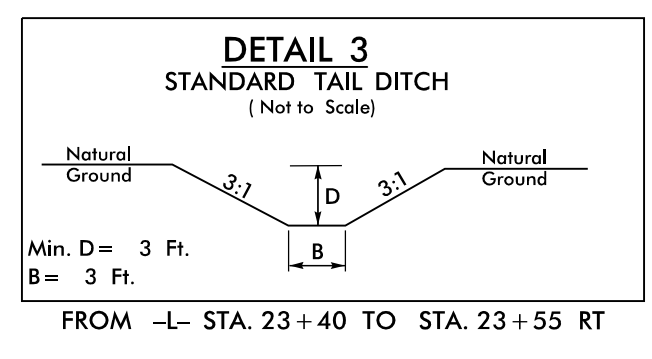
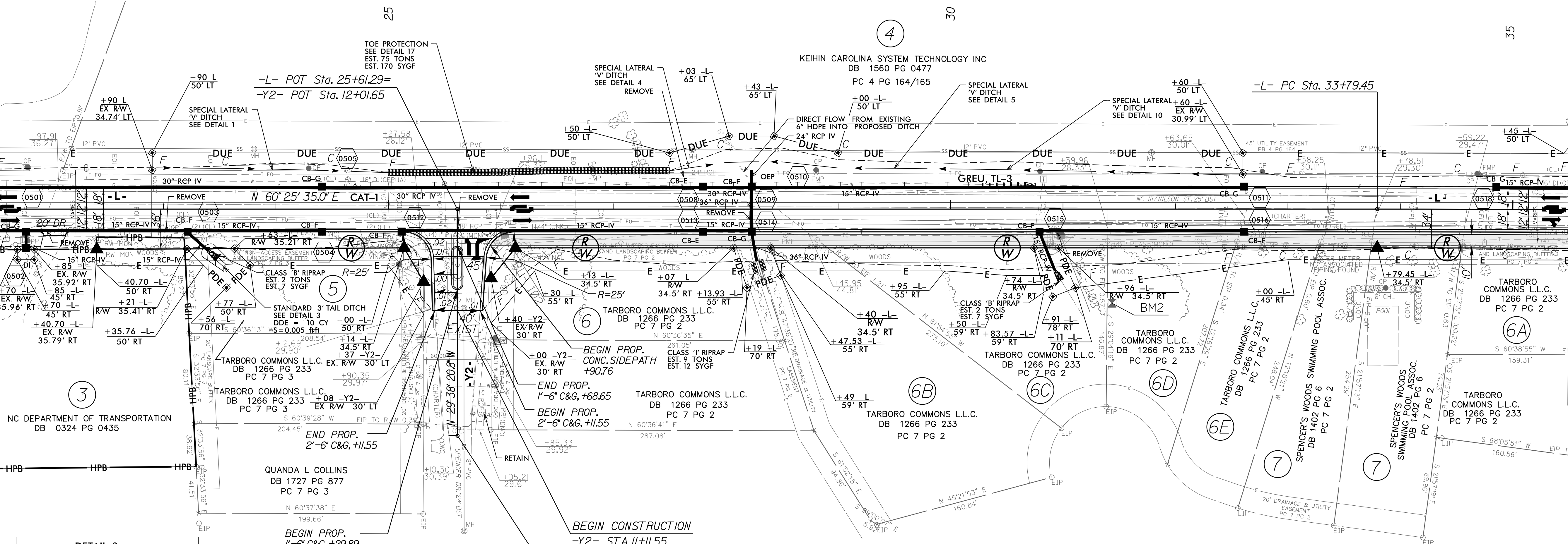

**MULTI-USE PATH**

SEE SHEET 14 FOR -L- PROFILE  
SEE SHEET 19 FOR -Y2- PROFILE

REVISIONS

U:\APR-2023\_15st7\WSP\roadway\PRoJ\U-4424-Rdy-psn\_05.dgn