

# CULVERT CONSTRUCTION SEQUENCE STA. 27+87 -Y-

--- PIPE CONSTRUCTED IN PREVIOUS PHASE

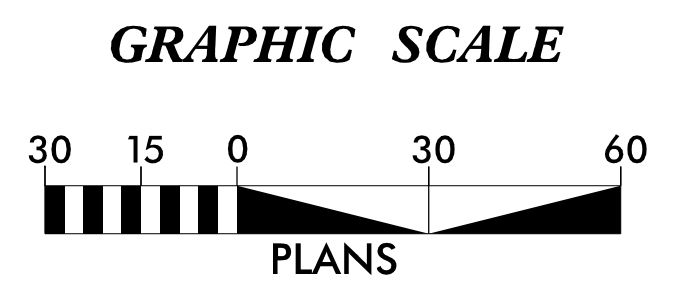
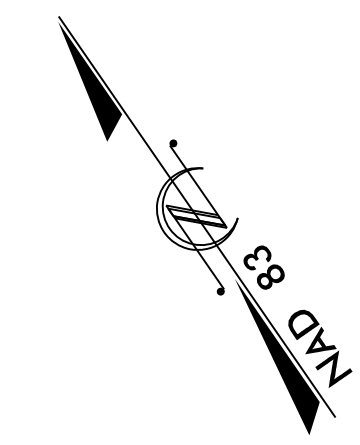

PROJECT REFERENCE NO. R-2561CA	SHEET NO. EC-7C/CONST.7
<small>1 Glenwood Avenue Raleigh, NC 27603 Tel: 919.789.9977 Fax: 919.789.9591 License: C-2197</small>	

## PHASE I

1. UTILIZE SPECIAL STILLING BASINS DURING CULVERT CONSTRUCTION AS DIRECTED BY ENGINEER.
2. CONSTRUCT PROPOSED 2@54" PIPES UPSTREAM AND DOWNSTREAM OF NC-11 IN THE DRY AS SHOWN. CONSTRUCTION ACTIVITIES IN PHASE I SHOULD NOT IMPACT EXISTING TRAFFIC PATTERNS OR THE EXISTING STREAM.
3. INSTALL DETOUR PHASE SPECIAL DETAIL JUNCTION BOX TO CONNECT PIPES.

## PHASE II

1. UTILIZE SPECIAL STILLING BASINS DURING CULVERT CONSTRUCTION AS DIRECTED BY ENGINEER.
2. BEGIN CONSTRUCTION OF ON-SITE DETOUR (-YDET-) AND COMPLETE UP TO AREA OF PROPOSED 2@54" PIPES
3. BEGIN TEMPORARY CLOSURE OF NC-11
4. INSTALL REMAINING PORTION OF 2@54" PIPES BENEATH NC-11. INSTALL IMPERVIOUS DIKE #1 AND PUMP AROUND OPERATION 'A'.
5. INSTALL REMAINING PORTION OF 2@54" PIPES AT DOWNSTREAM END AS WELL AS RIP RAP STREAM IMPROVEMENTS. REMOVE PUMP AROUND OPERATION AT DOWNSTREAM END. INSTALL IMPERVIOUS DIKE #2 FOR UPSTREAM PUMP AROUND OPERATION 'B'.
6. TEMPORARILY PUMP BASE FLOW AROUND WORK AREA TO COMPLETE INSTALLATION OF UPSTREAM DETOUR PHASE PIPE AND CONNECT TO STREAM
7. REMOVE PUMP AROUND OPERATION. DIVERT BASE FLOW INTO NEWLY CONSTRUCTED 2@54" PIPES ONCE CONNECTIONS TO STREAM ARE STABILIZED.
8. REMOVE EXISTING 2@30" PIPES AND COMPLETE DETOUR CONSTRUCTION. END TEMPORARY CLOSURE AND SHIFT TRAFFIC ONTO DETOUR.

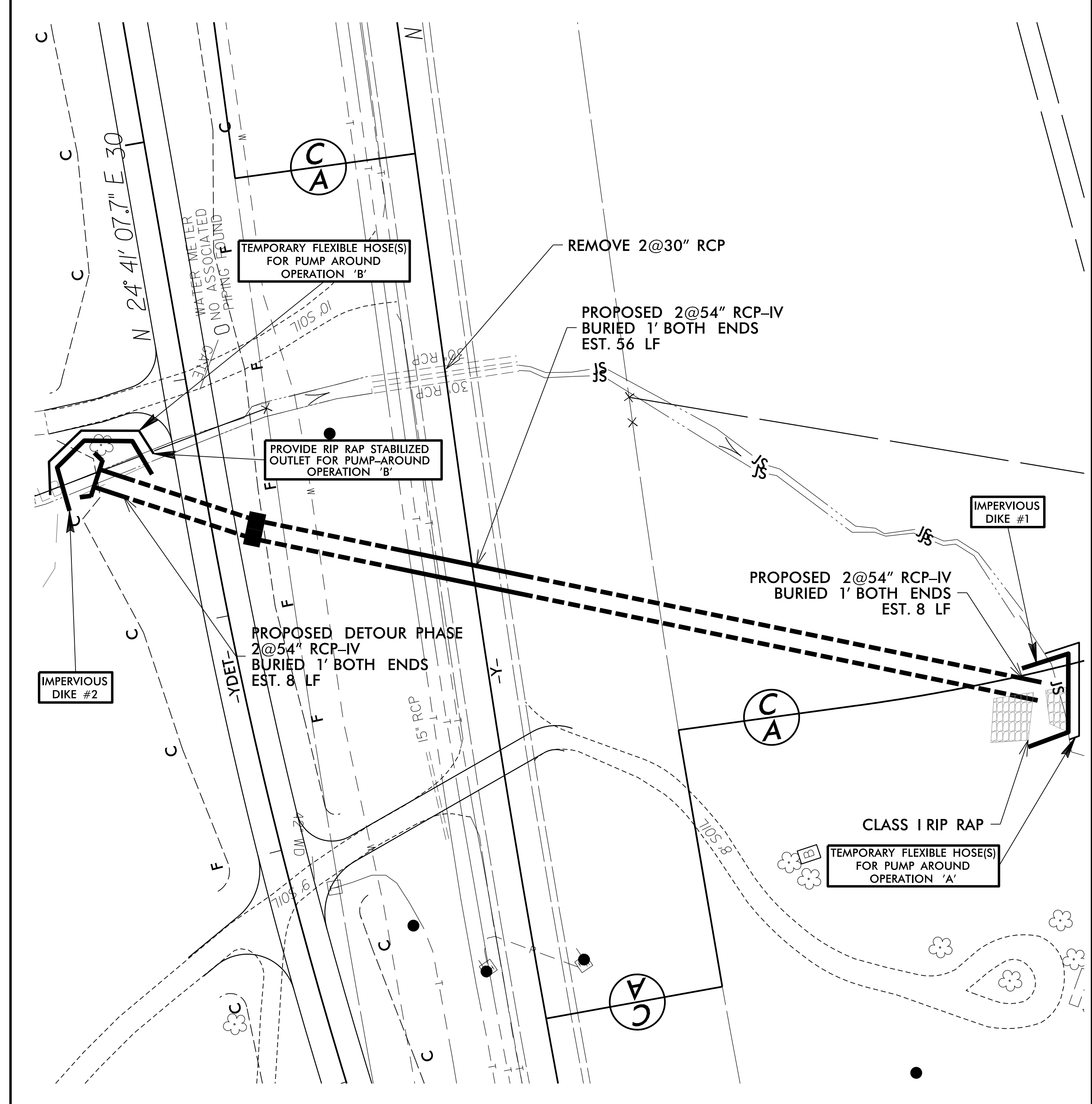
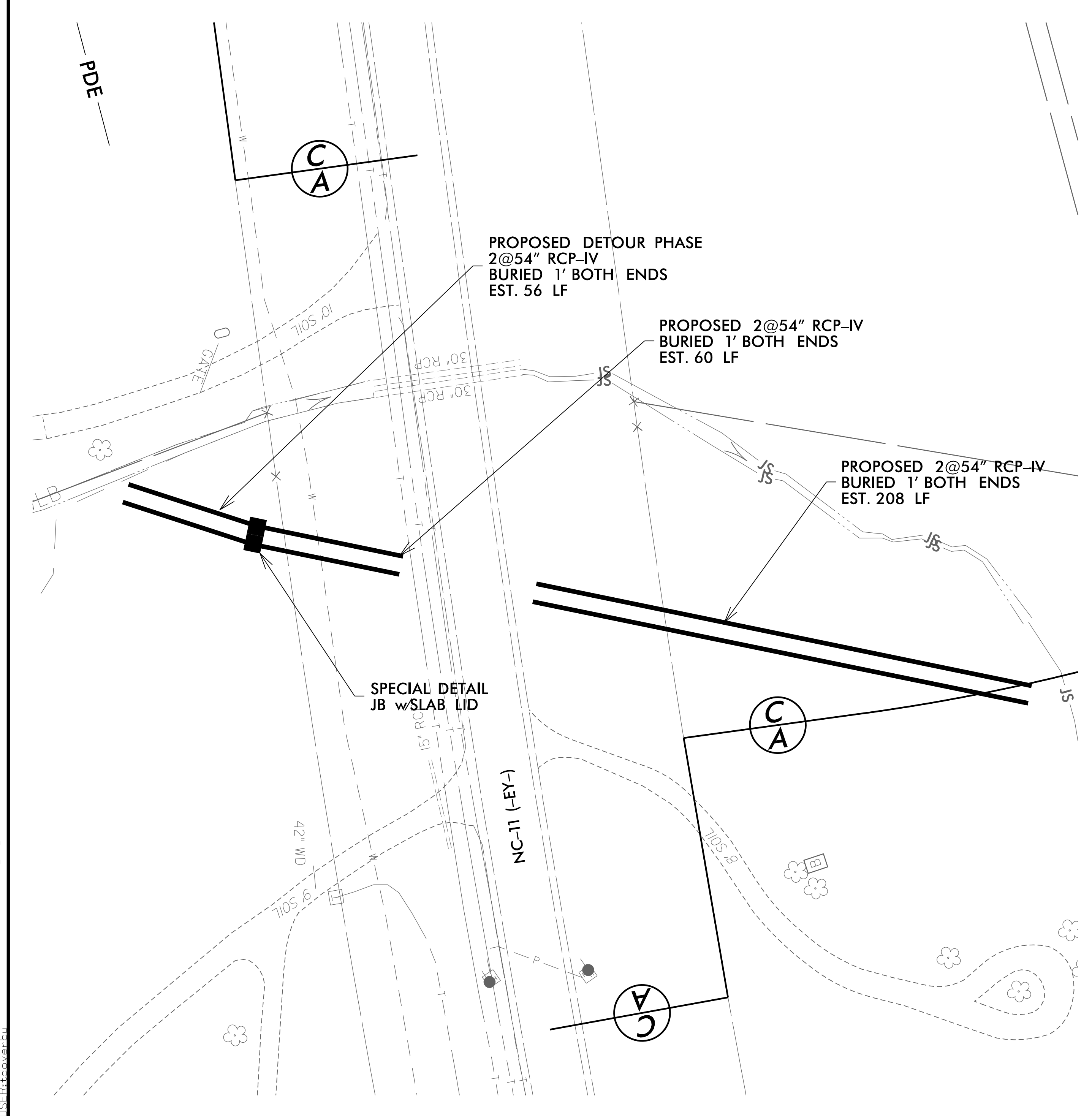

12/16/2020  
 R-2561CA\_reu\_EC-07C\_Culvert\_Phasing.dgn  
 11:51:10 AM