

STATE OF NORTH CAROLINA
 DIVISION OF HIGHWAYS
 PLAN FOR PROPOSED
 HIGHWAY EROSION CONTROL

COLUMBUS COUNTY

LOCATION: NC 87 (OLD STAGE RD.)/NC 11 (GENERAL HOWE RD.) INTERCHANGE
 TYPE OF WORK: GRADING, DRAINAGE, PAVING, AND STRUCTURES

STATE	STATE PROJECT REFERENCE NO.	SHEET NO.	TOTAL SHEETS
N.C.	R-2561CA	1	
STATE PROJ. NO.	F.A. PROJ. NO.	DESCRIPTION	
34466.4.5	N/A	P.E.	
34466.3.8	N/A	RW & UTILITIES	

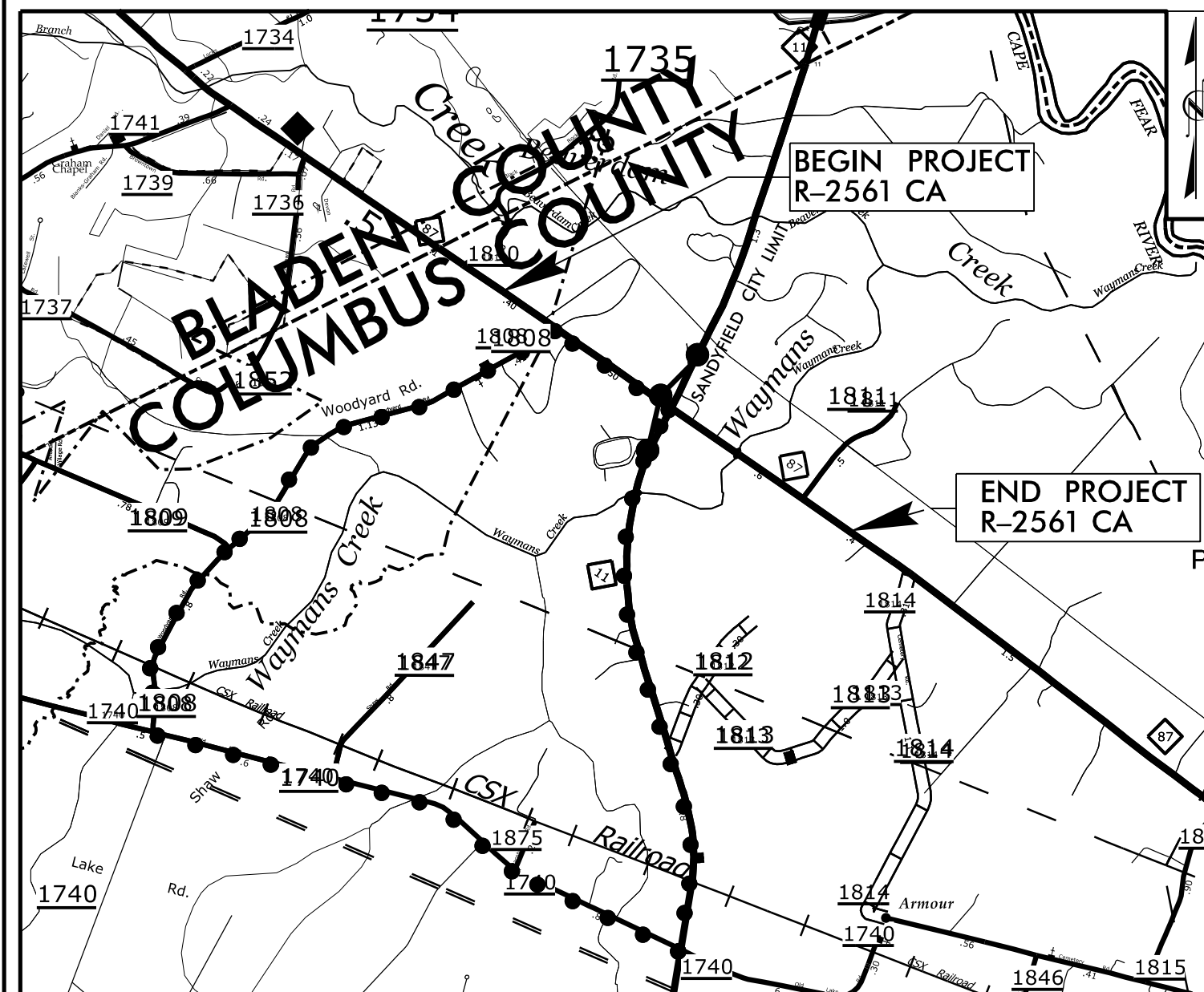

VICINITY MAP
(NOT TO SCALE)

DETOUR ROUTE

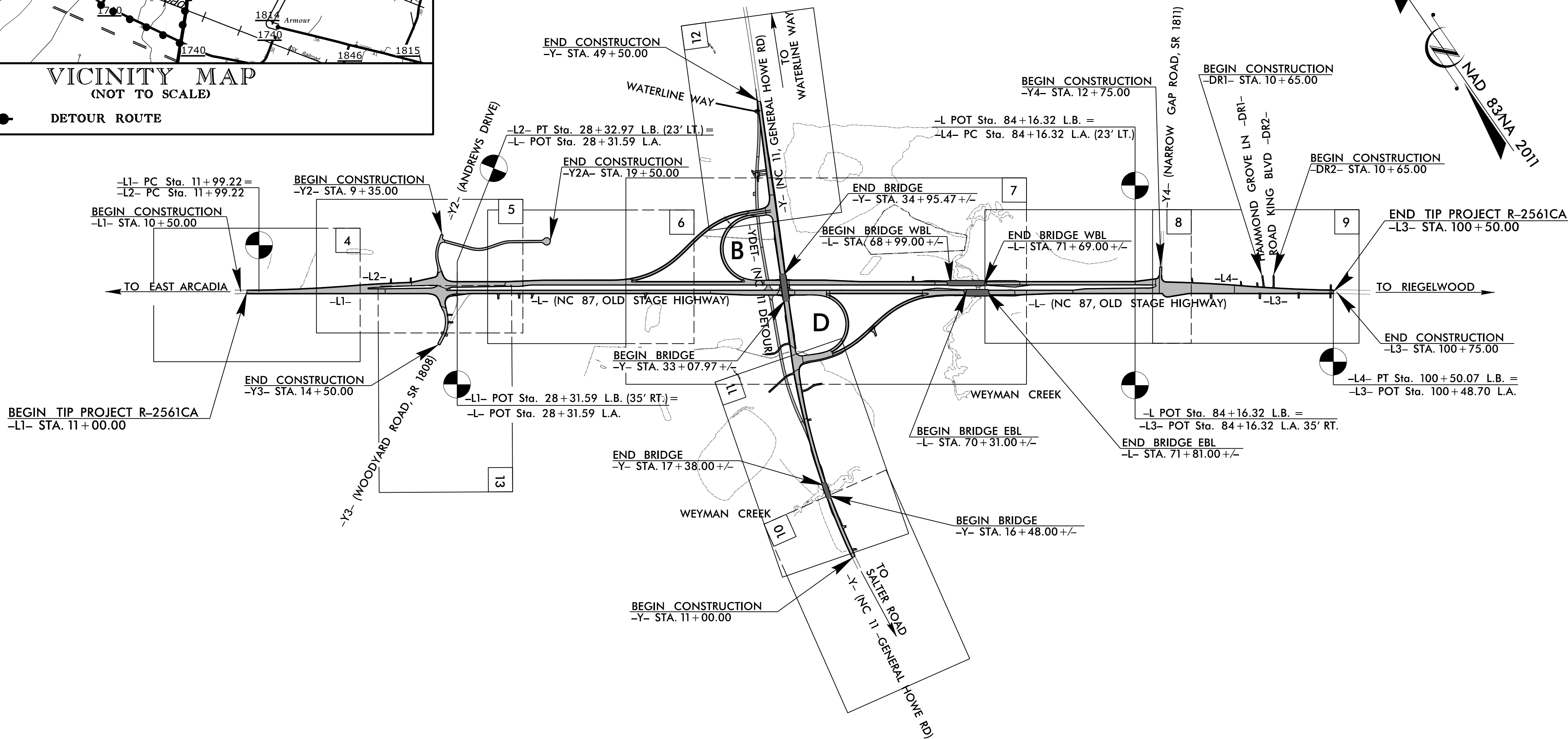

EROSION AND SEDIMENT CONTROL MEASURES

Std. #	Description	Symbol
1650.03	Temporary Silt Ditch	---
1650.05	Temporary Diversion	TD
1605.01	Temporary Silt Fence	III III III
1606.01	Special Sediment Control Fence	III III III
1622.01	Temporary Berms and Slope Drains	T
1650.02	Silt Basin Type B	[Symbol]
1653.01	Temporary Rock Silt Check Type-A	[Symbol]
	Temporary Rock Silt Check Type-A with Matting and Polyacrylamide (PAM)	[Symbol]
1653.02	Temporary Rock Silt Check Type-B	[Symbol]
	Wattle / Coir Fiber Wattle	[Symbol]
	Wattle / Coir Fiber Wattle with Polyacrylamide (PAM)	[Symbol]
1654.01	Temporary Rock Sediment Dam Type-A	[Symbol]
1654.02	Temporary Rock Sediment Dam Type-B	[Symbol]
1655.01	Rock Pipe Inlet Sediment Trap Type-A	[Symbol]
1655.02	Rock Pipe Inlet Sediment Trap Type-B	[Symbol]
1650.04	Stilling Basin	[Symbol]
1650.06	Special Stilling Basin	[Symbol]
	Rock Inlet Sediment Trap:	
1652.01	Type A	A
1652.02	Type B	B
1652.03	Type C	C
	Skimmer Basin	[Symbol]
	Tiered Skimmer Basin	[Symbol]
	Infiltration Basin	[Symbol]

THIS PROJECT CONTAINS EROSION CONTROL PLANS FOR CLEARING AND GRUBBING PHASE OF CONSTRUCTION.

TIP PROJECT: R-2561CA

CONTRACT:

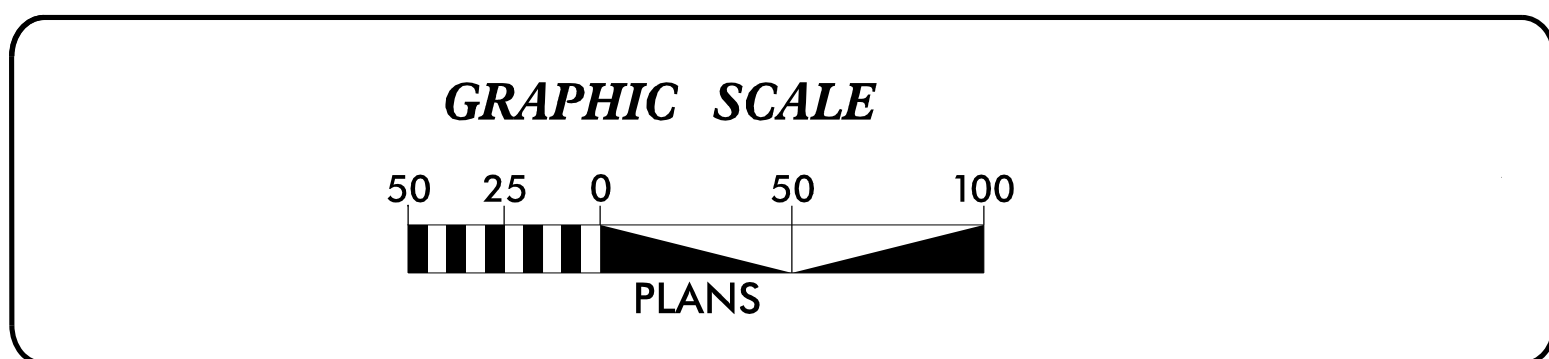

THESE EROSION AND SEDIMENT CONTROL PLANS COMPLY WITH THE APPLICABLE REGULATIONS SET FORTH BY THE NCG-010000 GENERAL CONSTRUCTION PERMIT EFFECTIVE APRIL 1, 2019 AND ISSUED BY THE NORTH CAROLINA DEPARTMENT OF ENVIRONMENTAL QUALITY DIVISION OF WATER RESOURCES.

SEPI
 Engineering & Construction, Inc.

1 Glenwood Avenue
 Raleigh, NC 27603
 Tel: 919.789.9977
 Fax: 919.789.9591
 License: C-2197

Prepared in the Office of:
SEPI, Inc.
 1 Glenwood Avenue
 Raleigh, NC 27603

Designed by:
Tyler Overby 4140
 NAME LEVEL III CERTIFICATION NO.

Roadway Standard Drawings

The following roadway english standards as appear in "Roadway Standard Drawings"- Roadway Design Unit - N. C. Department of Transportation - Raleigh, N. C., dated January 2018 and the latest revision thereto are applicable to this project and by reference hereby are considered a part of these plans.

1604.01 Railroad Erosion Control Detail	1632.01 Rock Inlet Sediment Trap Type A
1605.01 Temporary Silt Fence	1632.02 Rock Inlet Sediment Trap Type B
1606.01 Special Sediment Control Fence	1632.03 Rock Inlet Sediment Trap Type C
1607.01 Gravel Construction Entrance	1633.01 Temporary Rock Silt Check Type A
1622.01 Temporary Berms and Slope Drains	1633.02 Temporary Rock Silt Check Type B
1630.01 Riser Basin	1634.01 Temporary Rock Sediment Dam Type A
1630.02 Silt Basin Type B	1634.02 Temporary Rock Sediment Dam Type B
1630.03 Temporary Silt Ditch	1635.01 Rock Pipe Inlet Sediment Trap Type A
1630.04 Stilling Basin	1635.02 Rock Pipe Inlet Sediment Trap Type B
1630.05 Temporary Diversion	1640.01 Coir Fiber Baffle
1630.06 Special Stilling Basin	1645.01 Temporary Stream Crossing
1631.01 Matting Installation	

09/08/19

10/7/2020
 R-2561CA_Rev_TSH.dgn
 USER:tdoverby