

8/17/99
8/25/2014 R-2561CA_Rdy_psh_9.dgn
US:R:\psh\psh_9.dgn



1 Glenwood Avenue
Raleigh, NC 27603
Tel: 919.789.9977
Fax: 919.789.9591
License: C-2197

PROJECT REFERENCE NO. R-2561CA	SHEET NO. 9
RW SHEET NO.	
ROADWAY DESIGN ENGINEER	HYDRAULICS ENGINEER
Daniel W. Gardner, Jr.	Andrew M. Howell
DOCUMENT NOT CONSIDERED FINAL UNLESS ALL SIGNATURES COMPLETED	

-L4-	-DR2-
PI Sta 96+41.80	PI Sta 10+77.55
$\Delta = 4^{\circ} 04' 11.5" (LT)$	$\Delta = 3^{\circ} 42' 50.6" (RT)$
$D = 0^{\circ} 29' 53.6"$	$D = 3^{\circ} 34' 51.6"$
$L = 816.87'$	$L = 103.72'$
$T = 408.61'$	$T = 51.88'$
$R = 11,500.00'$	$R = 1,600.00'$
SE = NC	

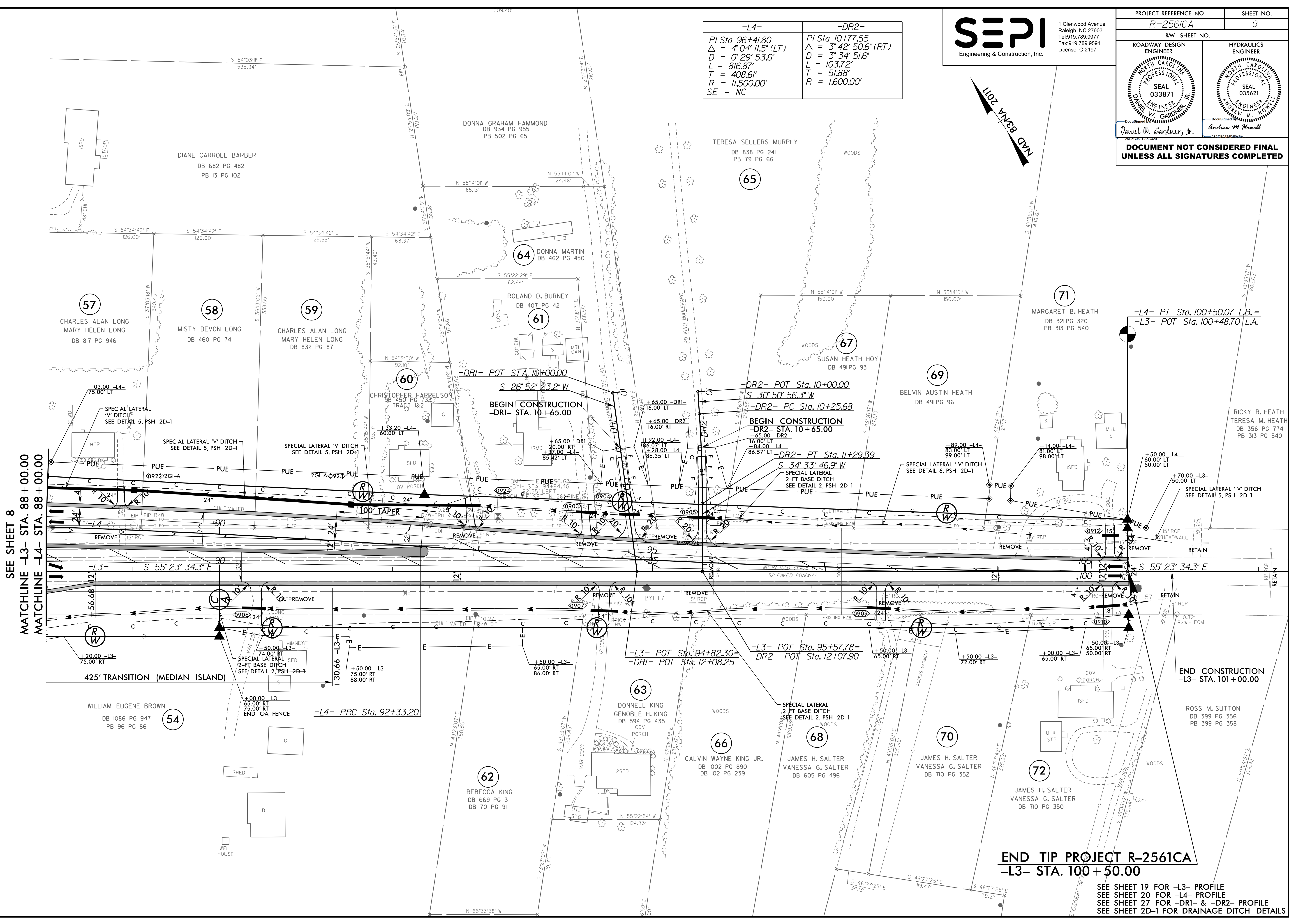

SEE SHEET 8
MATCHLINE -L3- STA. 88 + 00.00
MATCHLINE -L4- STA. 88 + 00.00

-L4- PT Sta. 100+50.07 L.B. =
-L3- POT Sta. 100+48.70 L.A.

END TIP PROJECT R-2561CA
-L3- STA. 100 + 50.00

SEE SHEET 19 FOR -L3- PROFILE
SEE SHEET 20 FOR -L4- PROFILE
SEE SHEET 27 FOR -DRI- & -DR2- PROFILE
SEE SHEET 2D-1 FOR DRAINAGE DITCH DETAILS