

REFERENCE: B-5869

PROJECT: 48063

STATE OF NORTH CAROLINA
DEPARTMENT OF TRANSPORTATION
DIVISION OF HIGHWAYS
GEOTECHNICAL ENGINEERING UNIT

STRUCTURE
SUBSURFACE INVESTIGATION

COUNTY BURKE
PROJECT DESCRIPTION REPLACE BRIDGE NO. 0099 on
US-64/US-70 (FLEMING DRIVE) over SOUTHERN RAILROAD
SITE RETAINING WALL ALONG -L- FROM
STA's I2+50.00 to I6+50.00 LT

CONTENTS

SHEET NO.	DESCRIPTION
1	TITLE SHEET
2	LEGEND (SOIL)
3	SITE PLAN
4	PROFILE
5-10	CROSS SECTIONS

STATE	STATE PROJECT REFERENCE NO.	SHEET NO.	TOTAL SHEETS
N.C.	B-5869	1	10

CAUTION NOTICE

THE SUBSURFACE INFORMATION AND THE SUBSURFACE INVESTIGATION ON WHICH IT IS BASED WERE MADE FOR THE PURPOSE OF STUDY, PLANNING AND DESIGN, AND NOT FOR CONSTRUCTION OR PAY PURPOSES. THE VARIOUS FIELD BORING LOGS, ROCK CORES AND SOIL TEST DATA AVAILABLE MAY BE REVIEWED OR INSPECTED IN RALEIGH BY CONTACTING THE N. C. DEPARTMENT OF TRANSPORTATION, GEOTECHNICAL ENGINEERING UNIT AT (919) 707-6850. THE SUBSURFACE PLANS AND REPORTS, FIELD BORING LOGS, ROCK CORES AND SOIL TEST DATA ARE NOT PART OF THE CONTRACT.

GENERAL SOIL AND ROCK STRATA DESCRIPTIONS AND INDICATED BOUNDARIES ARE BASED ON A GEOTECHNICAL INTERPRETATION OF ALL AVAILABLE SUBSURFACE DATA AND MAY NOT NECESSARILY REFLECT THE ACTUAL SUBSURFACE CONDITIONS BETWEEN BORINGS OR BETWEEN SAMPLED STRATA WITHIN THE BOREHOLE. THE LABORATORY SAMPLE DATA AND THE IN SITU (IN-PLACE) TEST DATA CAN BE RELIED ON ONLY TO THE DEGREE OF RELIABILITY INHERENT IN THE STANDARD TEST METHOD. THE OBSERVED WATER LEVELS OR SOIL MOISTURE CONDITIONS INDICATED IN THE SUBSURFACE INVESTIGATIONS ARE AS RECORDED AT THE TIME OF THE INVESTIGATION. THESE WATER LEVELS OR SOIL MOISTURE CONDITIONS MAY VARY CONSIDERABLY WITH TIME ACCORDING TO CLIMATIC CONDITIONS INCLUDING TEMPERATURES, PRECIPITATION AND WIND, AS WELL AS OTHER NON-CLIMATIC FACTORS.

THE BIDDER OR CONTRACTOR IS CAUTIONED THAT DETAILS SHOWN ON THE SUBSURFACE PLANS ARE PRELIMINARY ONLY AND IN MANY CASES THE FINAL DESIGN DETAILS ARE DIFFERENT. FOR BIDDING AND CONSTRUCTION PURPOSES, REFER TO THE CONSTRUCTION PLANS AND DOCUMENTS FOR FINAL DESIGN INFORMATION ON THIS PROJECT. THE DEPARTMENT DOES NOT WARRANT OR GUARANTEE THE SUFFICIENCY OR ACCURACY OF THE INVESTIGATION MADE, NOR THE INTERPRETATIONS MADE, OR OPINION OF THE DEPARTMENT AS TO THE TYPE OF MATERIALS AND CONDITIONS TO BE ENCOUNTERED. THE BIDDER OR CONTRACTOR IS CAUTIONED TO MAKE SUCH INDEPENDENT SUBSURFACE INVESTIGATIONS AS HE DEEMS NECESSARY TO SATISFY HIMSELF AS TO CONDITIONS TO BE ENCOUNTERED ON THE PROJECT. THE CONTRACTOR SHALL HAVE NO CLAIM FOR ADDITIONAL COMPENSATION OR FOR AN EXTENSION OF TIME FOR ANY REASON RESULTING FROM THE ACTUAL CONDITIONS ENCOUNTERED AT THE SITE DIFFERING FROM THOSE INDICATED IN THE SUBSURFACE INFORMATION.

- NOTES:
- THE INFORMATION CONTAINED HEREIN IS NOT IMPLIED OR GUARANTEED BY THE N. C. DEPARTMENT OF TRANSPORTATION AS ACCURATE NOR IS IT CONSIDERED PART OF THE PLANS, SPECIFICATIONS OR CONTRACT FOR THE PROJECT.
 - BY HAVING REQUESTED THIS INFORMATION, THE CONTRACTOR SPECIFICALLY WAIVES ANY CLAIMS FOR INCREASED COMPENSATION OR EXTENSION OF TIME BASED ON DIFFERENCES BETWEEN THE CONDITIONS INDICATED HEREIN AND THE ACTUAL CONDITIONS AT THE PROJECT SITE.

PERSONNEL

-NCDOT-

DC CHEEK

CJ COFFEY

CD JOHNSON

DC ELLIOTT

INVESTIGATED BY NCDOT GEU /DCE

DRAWN BY DC ELLIOTT

CHECKED BY JC KUHNE

SUBMITTED BY JC KUHNE

DATE _____

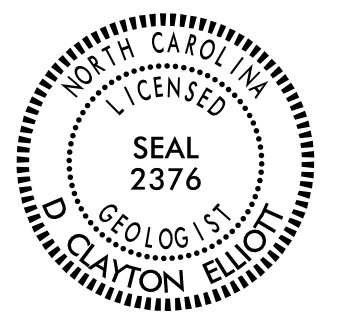

DocuSigned by:
D. Clayton Elliott 2/20/2020

FD421F60 SIGNATURE DATE

DOCUMENT NOT CONSIDERED FINAL
UNLESS ALL SIGNATURES COMPLETED

NORTH CAROLINA DEPARTMENT OF TRANSPORTATION
DIVISION OF HIGHWAYS
GEOTECHNICAL ENGINEERING UNIT
SUBSURFACE INVESTIGATION

SOIL AND ROCK LEGEND, TERMS, SYMBOLS, AND ABBREVIATIONS

Table with 4 main columns: SOIL DESCRIPTION, GRADATION, ROCK DESCRIPTION, and TERMS AND DEFINITIONS. It contains detailed classification schemes, legends for soil types and gradations, rock descriptions, and definitions for various geotechnical terms and symbols.

SITE PLAN

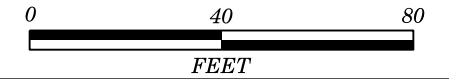

BEGIN TIP PROJECT B-5869

-L- STA. 12+50.00

-DET- POT Sta. 10+00.00

END RETAINING WALL
BEGIN TEMP RETAINING WALL

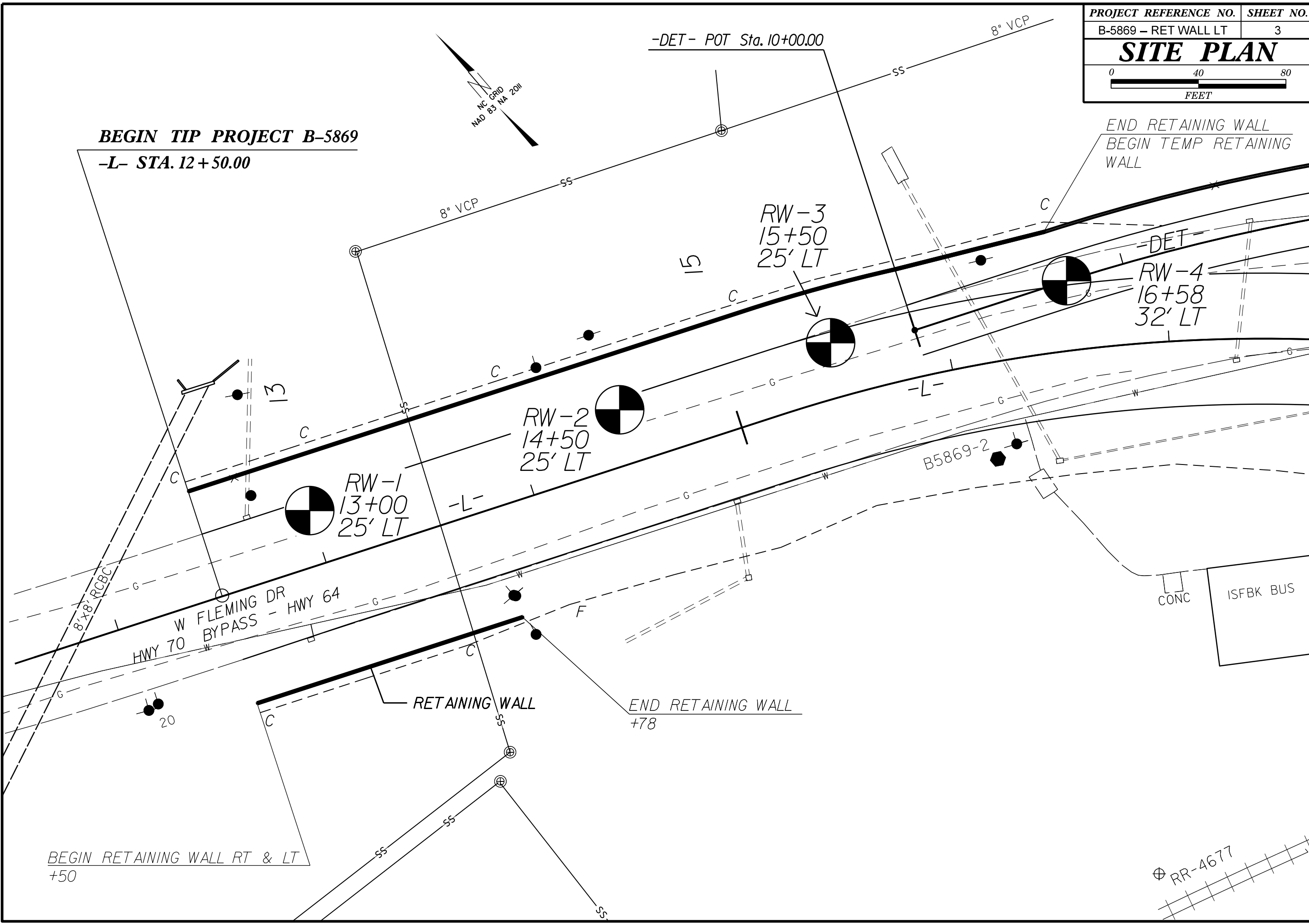

BEGIN RETAINING WALL RT & LT
+50

RR-4677

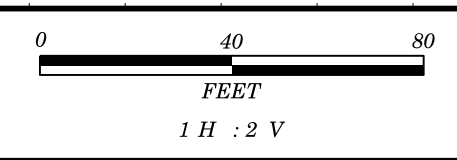

PROJECT REFERENCE NO.	SHEET NO.
B-5869	4
PROPOSED RETAINING WALL	
ALONG -L- STA	
12+50 to 16+50 LEFT	

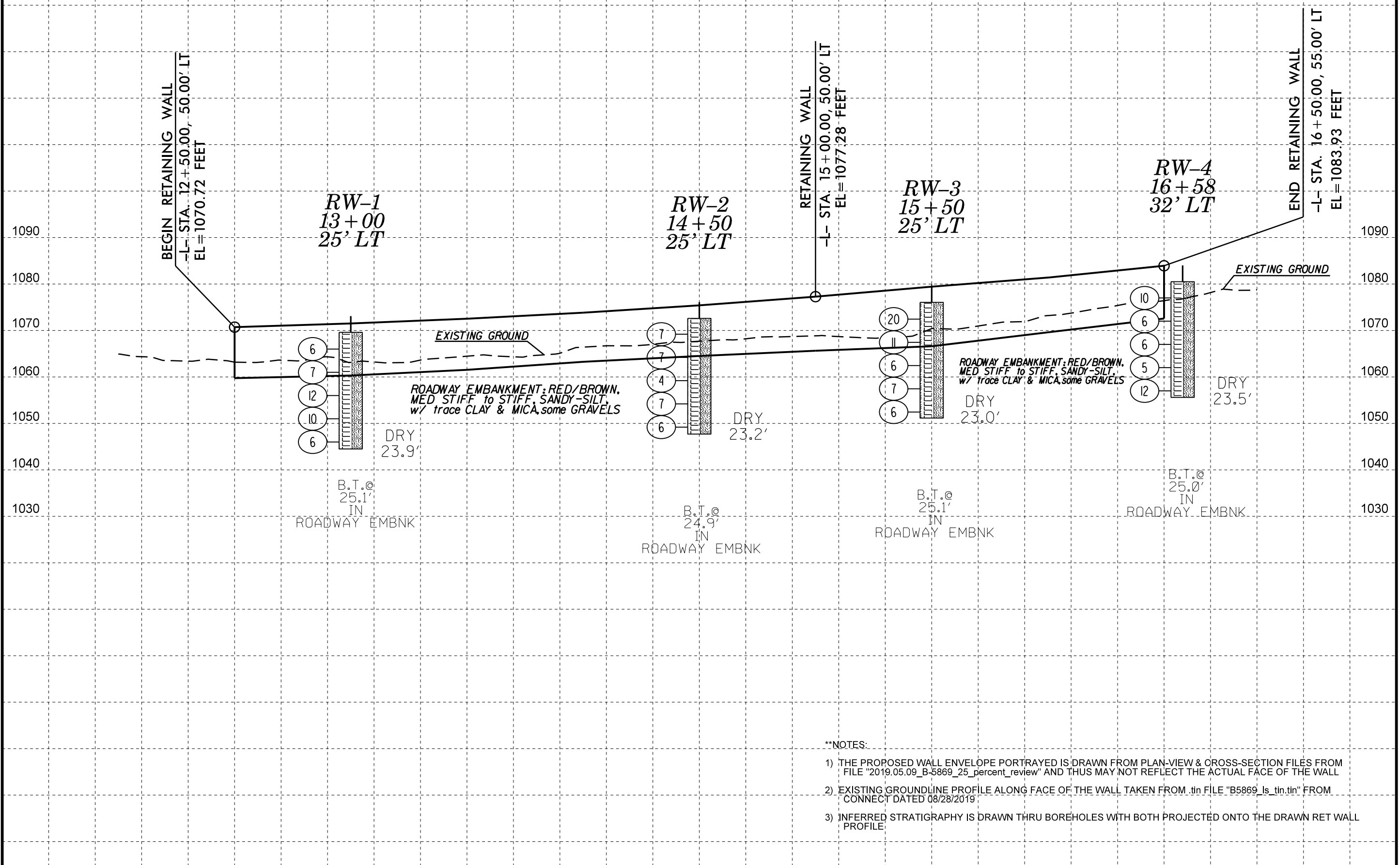

- **NOTES:**
- 1) THE PROPOSED WALL ENVELOPE PORTRAYED IS DRAWN FROM PLAN-VIEW & CROSS-SECTION FILES FROM FILE "2019.05.09_B-5869_25_percent_review" AND THUS MAY NOT REFLECT THE ACTUAL FACE OF THE WALL
 - 2) EXISTING GROUNDLINE PROFILE ALONG FACE OF THE WALL TAKEN FROM .tin FILE "B5869_Is_tin.tin" FROM CONNECT DATED 08/28/2019
 - 3) INFERRED STRATIGRAPHY IS DRAWN THRU BOREHOLES WITH BOTH PROJECTED ONTO THE DRAWN RET WALL PROFILE

12+30 12+50 12+70 12+90 13+10 13+30 13+50 13+70 13+90 14+10 14+30 14+50 14+70 14+90 15+10 15+30 15+50 15+70 15+90 16+10 16+30 16+50 16+70

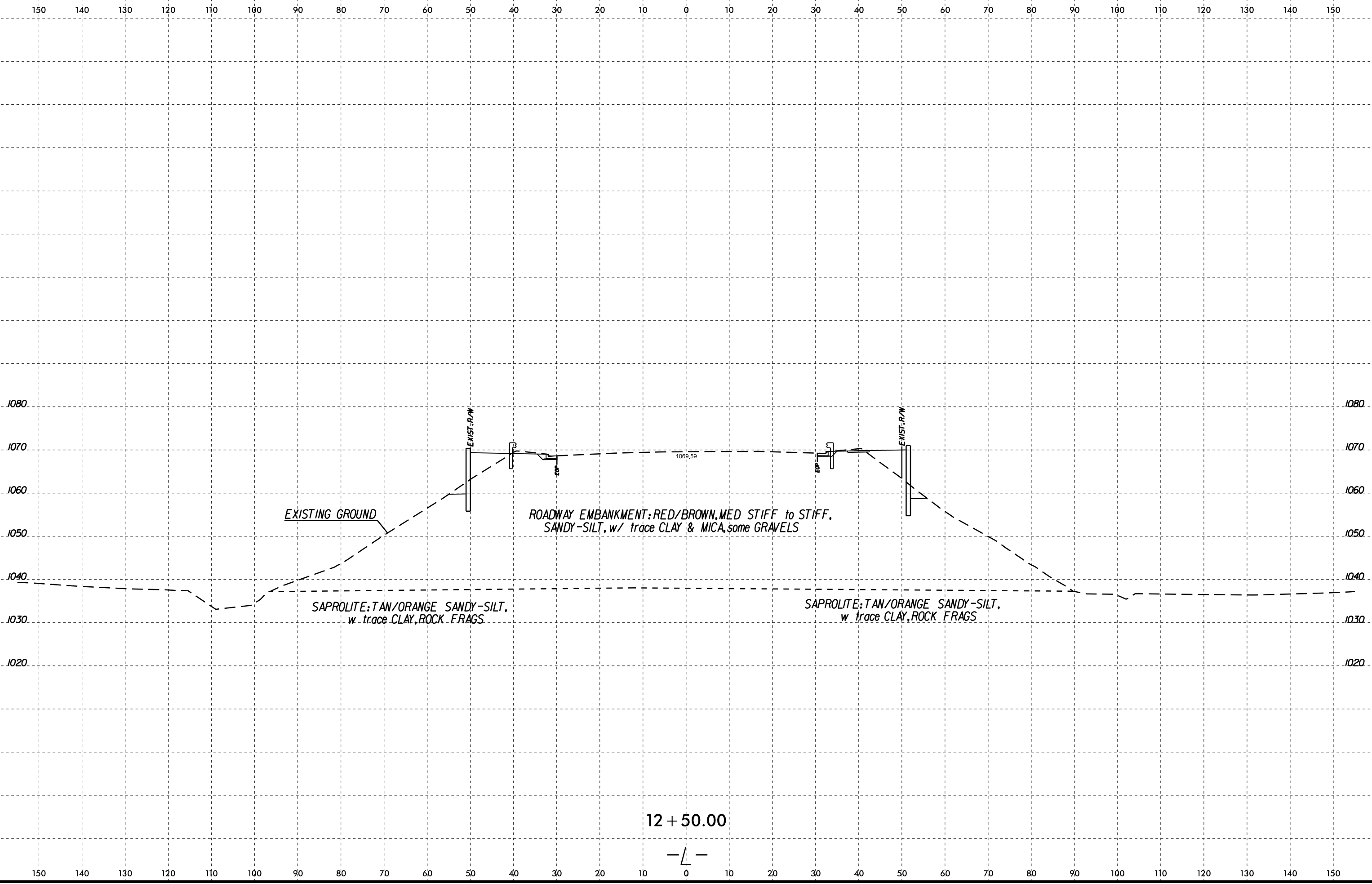

19-FEB-2020 09:28
 C:\PROJECTS\STRUCTURES\B5869\GEO\RAWAL_BROG00\99\GEO\RAWAL_BROG00\99\GEO\CADD\GEO\TECH\XSEC\B-5869_Geo_xpl.dgn
 \$\$\$USERNAME\$\$\$

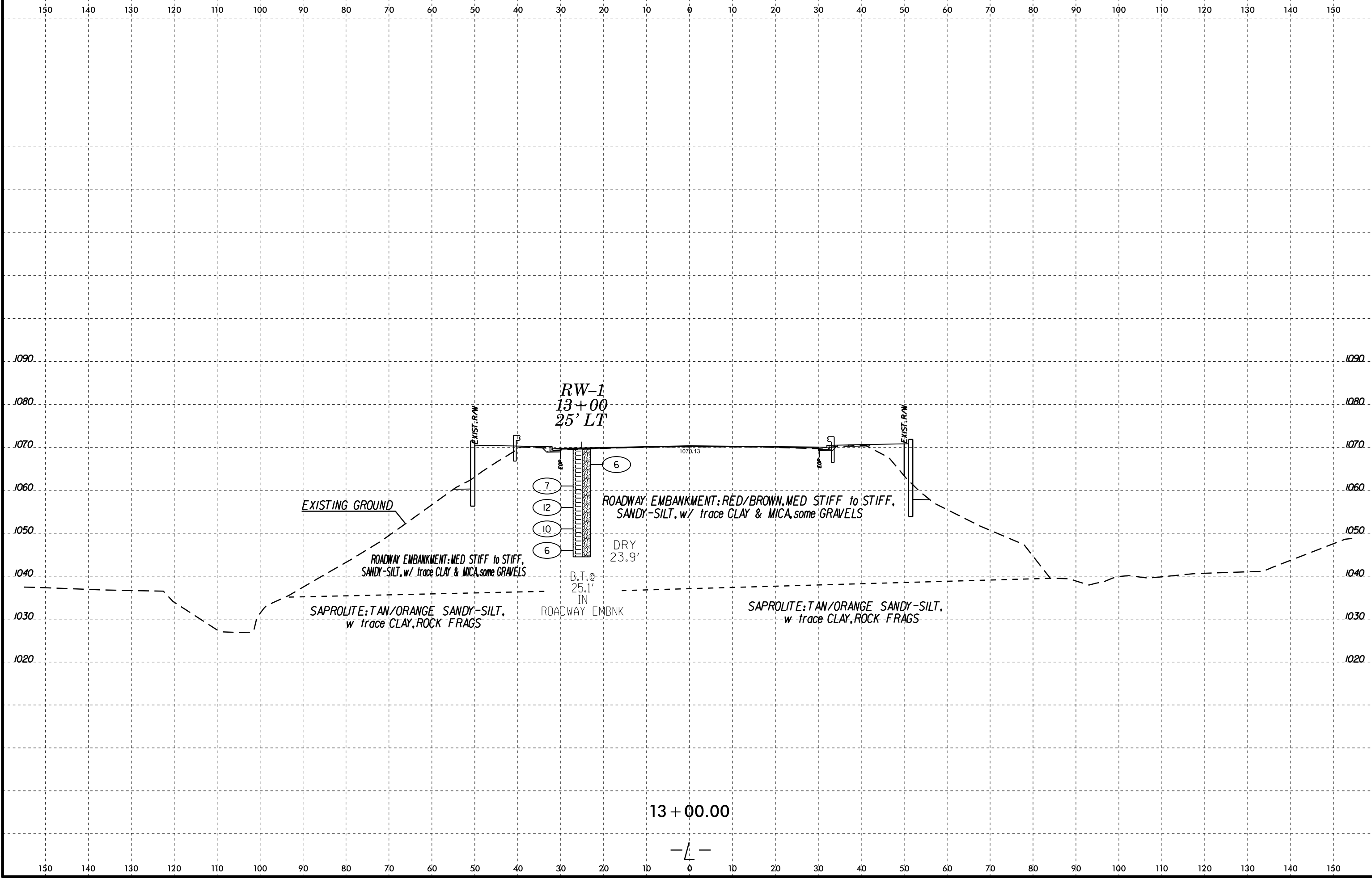

RW-1
13+00
25' LT

EXISTING GROUND

ROADWAY EMBANKMENT: MED STIFF to STIFF,
SANDY-SILT, w/ trace CLAY & MICA, some GRAVELS

ROADWAY EMBANKMENT: RED/BROWN, MED STIFF to STIFF,
SANDY-SILT, w/ trace CLAY & MICA, some GRAVELS

DRY
23.9'

B.T. @
25.1'
IN
ROADWAY EMBNK

SAPROLITE: TAN/ORANGE SANDY-SILT,
w trace CLAY, ROCK FRAGS

SAPROLITE: TAN/ORANGE SANDY-SILT,
w trace CLAY, ROCK FRAGS

13 + 00.00

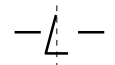

6/23/16

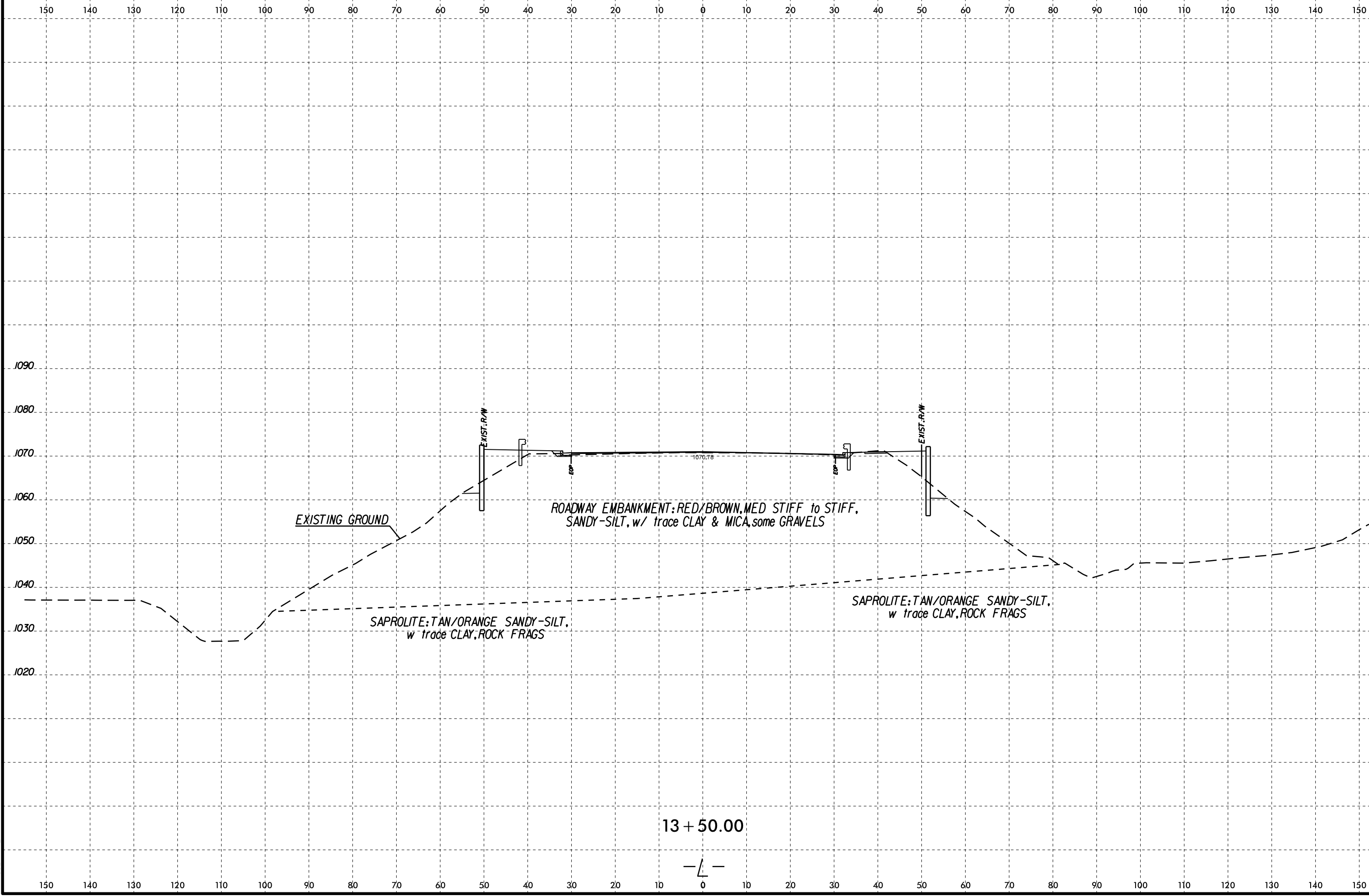

19-FEB-2020 09:32
\\B-5869\Geo\proj\1.dwg
\$\$\$USERNAME\$\$\$

13 + 50.00

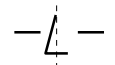

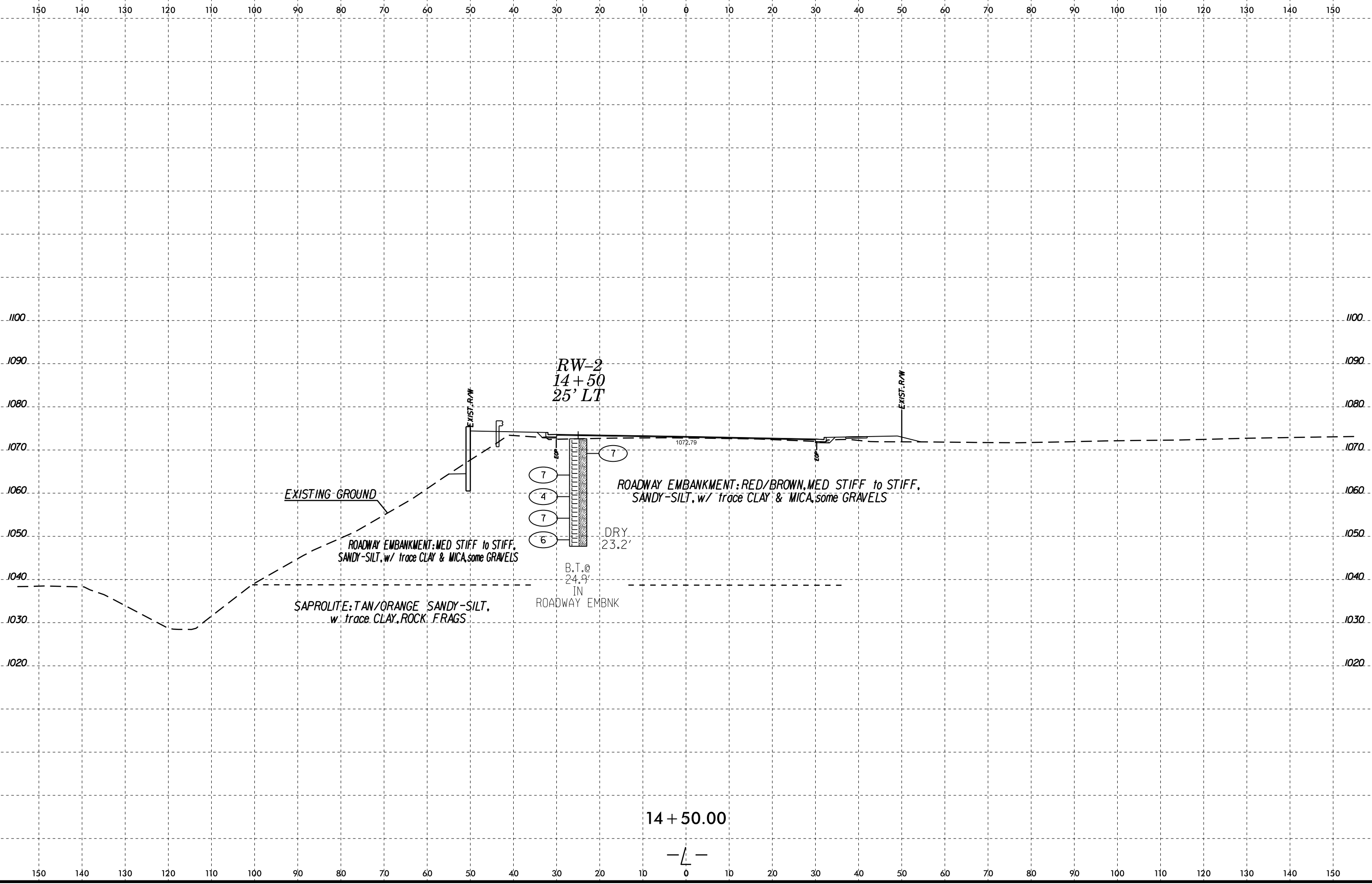

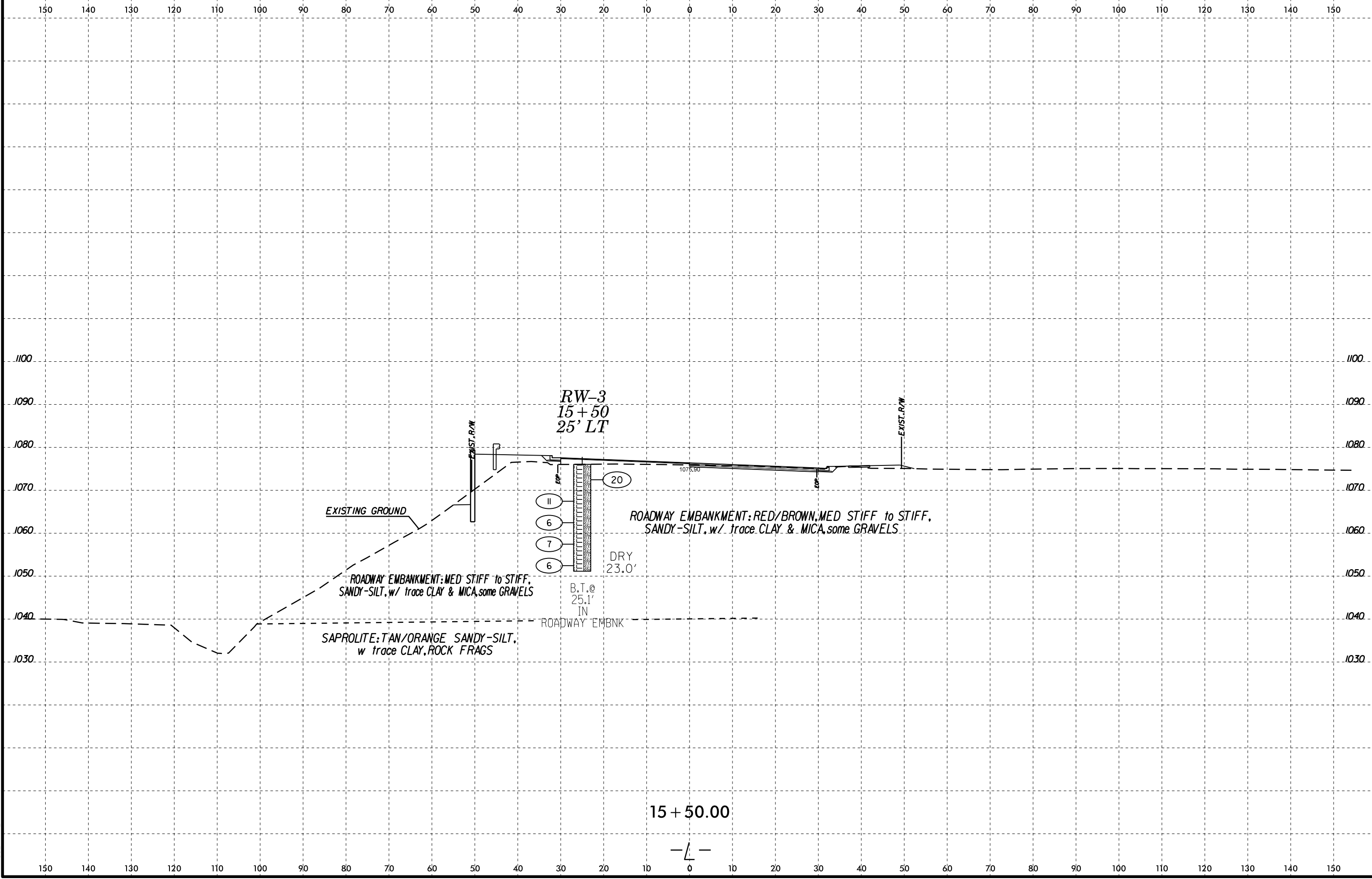

RW-3
15 + 50
25' LT

EXISTING GROUND

ROADWAY EMBANKMENT: MED STIFF to STIFF,
 SANDY-SILT, w/ trace CLAY & MICA, some GRAVELS

ROADWAY EMBANKMENT: RED/BROWN, MED STIFF to STIFF,
 SANDY-SILT, w/ trace CLAY & MICA, some GRAVELS

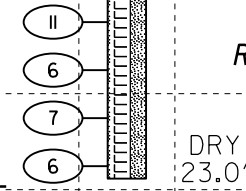

DRY
 23.0'

B.T. @
 25.1'
 IN

SAPROLITE: TAN/ORANGE SANDY-SILT,
 w trace CLAY, ROCK FRAGS

ROADWAY EMBNK

15 + 50.00

