

11/21/2022 10:18:59 AM P:\Raleigh\Projects\2018\Division 13 (SEA)\B-5869 (Burke 99)\Structures\Drawings\2\Final\2\B5869_SMU_BM_110099(2).dgn

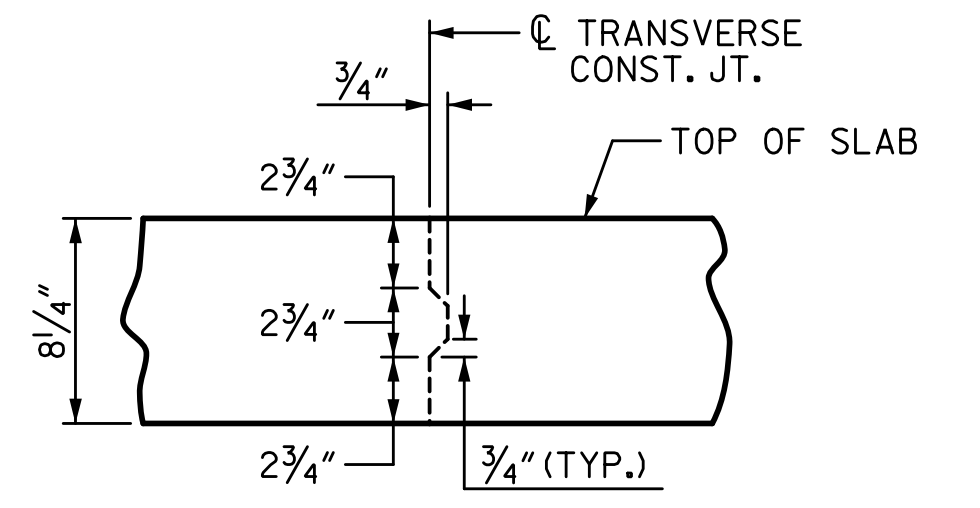
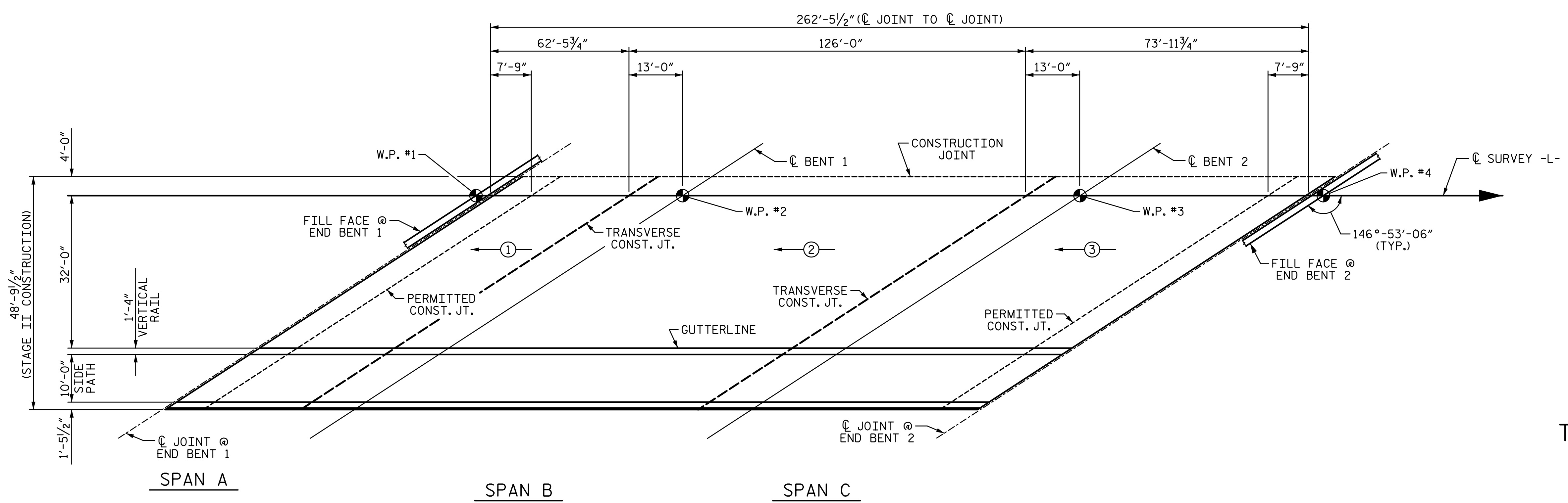

TRANSVERSE CONSTRUCTION JOINT DETAIL

NOTE: REINFORCING STEEL IN SLAB NOT SHOWN. LONGITUDINAL REINFORCING STEEL SHALL BE CONTINUOUS THRU JOINT.

POUR SEQUENCE AND LAYOUT FOR COMPUTING REINFORCED CONCRETE DECK SLAB AREA

(SQ. FT. = 12,806)

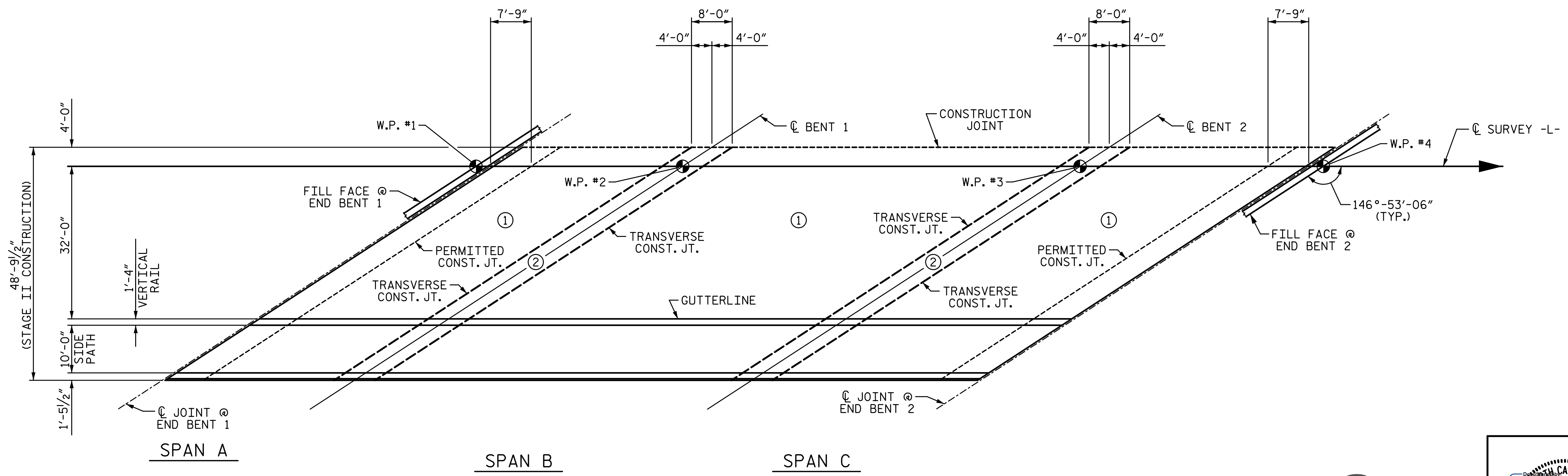

OPTIONAL POUR SEQUENCE

POUR CAN NOT BE STARTED UNTIL BOTH ADJACENT POURS REACH A MINIMUM OF 3000 PSI

PROJECT NO. B-5869
 BURKE COUNTY
 STATION: 21+62.39 -L-

SHEET 1 OF 4

STATE OF NORTH CAROLINA
 DEPARTMENT OF TRANSPORTATION
 RALEIGH
 SUPERSTRUCTURE

BILL OF MATERIAL

STAGE II

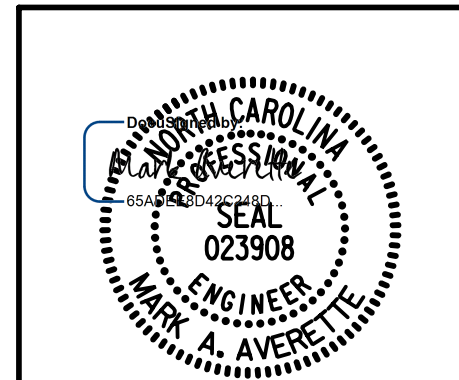

DRAWN BY: S.D. COOPER	DATE: 3-2022
CHECKED BY: M. AVERETTE	DATE: 3-2022
DESIGN ENGINEER OF RECORD: M. AVERETTE	DATE: 3-2022

REVISIONS				SHEET NO.	
NO.	BY:	DATE:	NO.	BY:	DATE:
1			3		
2			4		

DOCUMENT NOT CONSIDERED FINAL UNLESS ALL SIGNATURES COMPLETED