

STATE OF NORTH CAROLINA
DIVISION OF HIGHWAYS

TRANSPORTATION MANAGEMENT PLAN

WAKE COUNTY

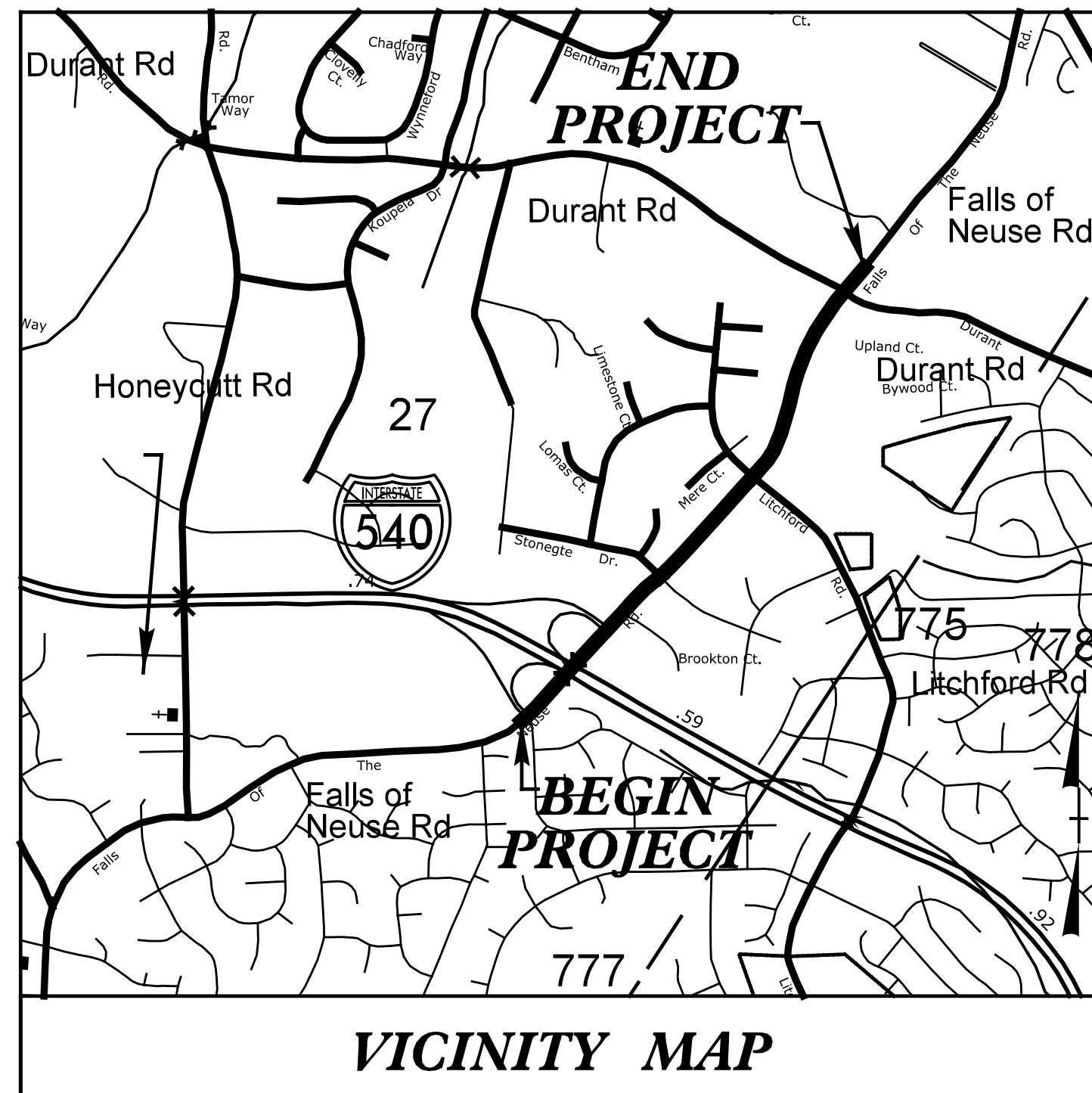
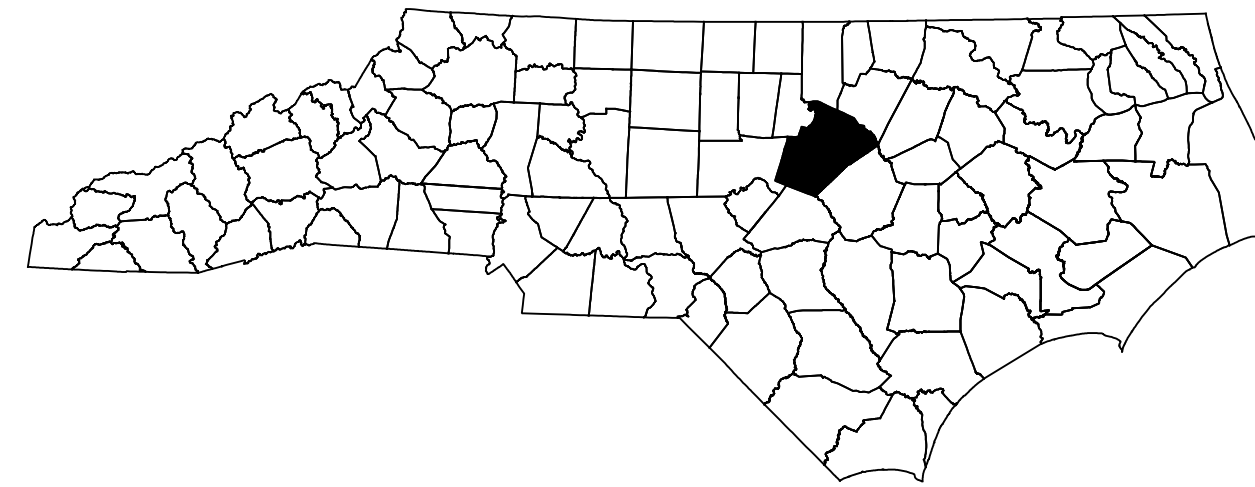

LOCATION: FALLS OF NEUSE ROAD. (SR 200) FROM I-540 TO DURANT ROAD (SR 2006)

TYPE OF WORK: GRADING, PAVING, DRAINAGE AND SIGNALS

VICINITY MAP

INDEX OF SHEETS	
<u>SHEET NO.</u>	<u>TITLE</u>
TMP-1	TITLE SHEET, VICINITY MAP, AND INDEX OF SHEETS
TMP-1A	LIST OF APPLICABLE ROADWAY STANDARD DRAWINGS AND LEGEND
TMP-1B	TRANSPORTATION OPERATIONS PLAN: (MANAGEMENT STRATEGIES AND GENERAL NOTES)
TMP-2	PHASING
TMP-3-3D	TEMPORARY TRAFFIC CONTROL PHASE I DETAIL
TMP-4-4D	TEMPORARY TRAFFIC CONTROL PHASE II DETAIL
TMP-5-5D	TEMPORARY TRAFFIC CONTROL PHASE III DETAIL

SHEET NO.
TMP-1

U-5826

4/6/2021 X:\2015\TRIS\030.00 U-5826 Falls of Neuse\Traffic\TCP\U-5826 TMP-1.dgn JBauman

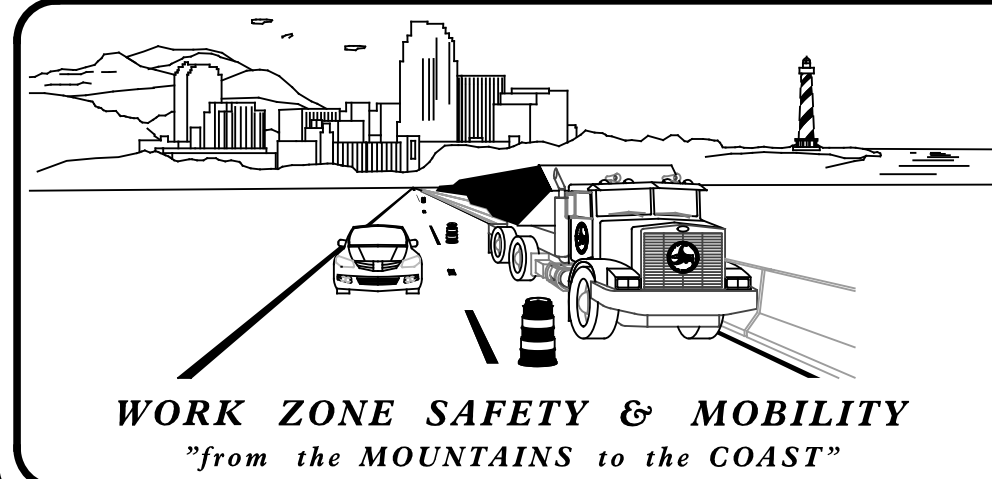

PLANS PREPARED BY:
JOHN BAUMAN, E.I.
STEVE MILLER, P.E.

NCDOT CONTACTS:
KENNETH C. THORNEWELL, JR., P.E.
PROJECT ENGINEER
JUSTIN D. BEAVER, P.E.
PROJECT DESIGN ENGINEER

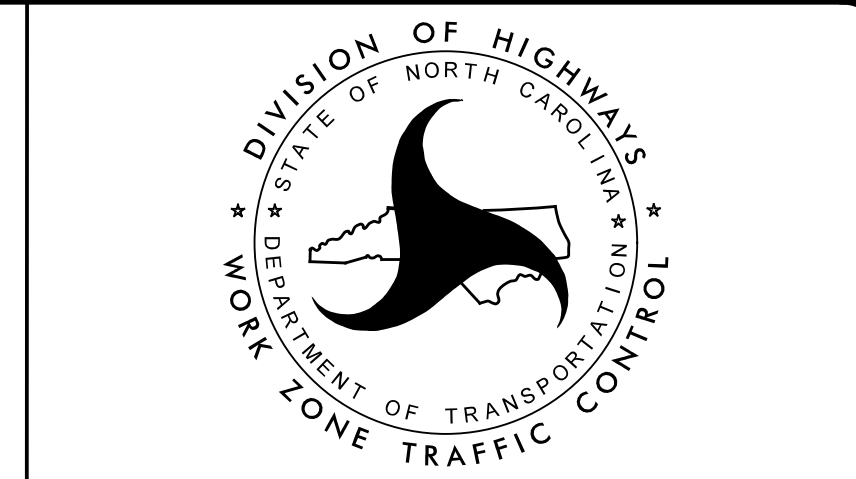

DOCUMENT NOT CONSIDERED FINAL UNLESS ALL SIGNATURES COMPLETED

APPROVED: _____
DATE: _____
SEAL

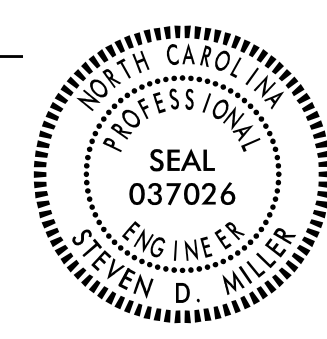

TIP PROJECT:

ROADWAY STANDARD DRAWINGS

THE FOLLOWING ROADWAY STANDARDS AS SHOWN IN "ROADWAY STANDARD DRAWINGS" - PROJECT SERVICES UNIT - N.C. DEPARTMENT OF TRANSPORTATION - RALEIGH, N.C., DATED JANUARY 2018 ARE APPLICABLE TO THIS PROJECT AND BY REFERENCE HEREBY ARE CONSIDERED A PART OF THESE PLANS:

STD. NO.	TITLE
1101.01	WORK ZONE ADVANCE WARNING SIGNS
1101.02	TEMPORARY LANE CLOSURES
1101.04	TEMPORARY SHOULDER CLOSURES
1101.05	WORK ZONE VEHICLE ACCESSES
1101.11	TRAFFIC CONTROL DESIGN TABLES
1110.01	STATIONARY WORK ZONE SIGNS
1110.02	PORTABLE WORK ZONE SIGNS
1130.01	DRUM
1135.01	CONES
1150.01	FLAGGING DEVICES
1180.01	SKINNY-DRUM
1205.01	PAVEMENT MARKINGS - LINE TYPES AND OFFSETS
1205.02	PAVEMENT MARKINGS - TWO-LANE AND MULTI-LANE ROADWAYS
1205.04	PAVEMENT MARKINGS - INTERSECTIONS
1205.05	PAVEMENT MARKINGS - TURN LANES
1205.06	PAVEMENT MARKINGS - LANE DROPS
1205.07	PAVEMENT MARKINGS - PEDESTRIAN CROSSWALKS
1205.08	PAVEMENT MARKINGS - SYMBOLS AND WORD MESSAGES
1205.09	PAVEMENT MARKINGS - PAINTED ISLANDS
1205.12	PAVEMENT MARKINGS - BRIDGES
1205.13	PAVEMENT MARKINGS - LANE REDUCTIONS

LEGEND

GENERAL

- DIRECTION OF TRAFFIC FLOW
- DIRECTION OF PEDESTRIAN TRAFFIC FLOW
- EXIST. PVMT.
- NORTH ARROW
- PROPOSED PVMT.
- TEMP. SHORING (LOCATION PURPOSES ONLY)
- WORK AREA
- REMOVAL
- CONSTRUCTION UNDER TRAFFIC

SIGNALS

- EXISTING
- PROPOSED
- TEMPORARY

PAVEMENT MARKINGS

- EXISTING LINES
- TEMPORARY LINES

TRAFFIC CONTROL DEVICES

- BARRICADE (TYPE III)
- CONE
- DRUM
- SKINNY DRUM
- TUBULAR MARKER
- TEMPORARY CRASH CUSHION
- FLASHING ARROW BOARD
- FLAGGER
- LAW ENFORCEMENT
- TRUCK MOUNTED ATTENUATOR (TMA)
- CHANGEABLE MESSAGE SIGN

TEMPORARY SIGNING

- PORTABLE SIGN
- STATIONARY SIGN
- STATIONARY OR PORTABLE SIGN

PAVEMENT MARKERS

- CRYSTAL/CRYSTAL
- CRYSTAL/RED
- YELLOW/YELLOW

PAVEMENT MARKING SYMBOLS

- PAVEMENT MARKING SYMBOLS
- PAVEMENT MARKING SYMBOLS
- PAVEMENT MARKING SYMBOLS

TEMPORARY PAVEMENT MARKING

SYMBOL	DESCRIPTION	SYMBOL	DESCRIPTION
P2	PAINT (24") WHITE STOP BAR	QA	PAINT MARKING SYMBOLS LEFT TURN ARROW
PA	PAINT (4") WHITE EDGE LINE	QB	RIGHT TURN ARROW
PC	10 FT. WHITE SKIP	QC	STRAIGHT ARROW
PD	3 FT. - 9 FT./SP WHITE MINISKIP	QD	COMBO. LEFT/STRAIGHT ARROW
PE	WHITE SOLID LANE LINE	QI	PAINT MARKING CHARACTER ALPHANUMERIC CHARACTER
PI	YELLOW DOUBLE CENTER		
P13	PAINT (8") 3 FT. - 9 FT./SP WHITE MINISKIP		
PN	WHITE GORELINE		
PP	YELLOW DIAGONAL		
PR	WHITE SOLID LANE LINE		
PU	PAINT (12") WHITE DIAGONAL		

4/6/2021 X:\2015\Traffic\TCP\U-5826 TMP-1A.dgn JBauman

1 Glenwood Avenue
Raleigh, NC 27603
Tel: 919.789.9977
Fax: 919.789.9591
License: C-2197

APPROVED: _____
DATE: _____

SEAL

DIVISION OF HIGHWAYS
STATE OF NORTH CAROLINA
DEPARTMENT OF TRANSPORTATION
WORK ZONE TRAFFIC CONTROL

ROADWAY STANDARD
DRAWINGS & LEGEND

DOCUMENT NOT CONSIDERED FINAL
UNLESS ALL SIGNATURES COMPLETED

MANAGEMENT STRATEGIES

- LOCAL ACCESS TO ALL RESIDENCES AND BUSINESSES WILL BE MAINTAINED AT ALL TIMES DURING CONSTRUCTION
- PEDESTRIAN TRAFFIC WILL BE MAINTAINED AT ALL TIMES DURING CONSTRUCTION
- PROVIDE THIRTY (30) DAYS NOTICE TO THE ENGINEER, WAKE COUNTY EMERGENCY SERVICES, AND WAKE COUNTY SCHOOL OFFICIALS PRIOR TO ROAD CLOSURE

GENERAL NOTES

CHANGES MAY BE REQUIRED WHEN PHYSICAL DIMENSIONS IN THE DETAIL DRAWINGS, STANDARD DETAILS, AND ROADWAY DETAILS ARE NOT ATTAINABLE TO MEET FIELD CONDITIONS OR RESULT IN DUPLICATE OR UNDESIRED OVERLAPPING OF DEVICES. MODIFICATION MAY INCLUDE: MOVING, SUPPLEMENTING, COVERING, OR REMOVAL OF DEVICES AS DIRECTED BY THE ENGINEER.

THE FOLLOWING GENERAL NOTES APPLY AT ALL TIMES FOR THE DURATION OF THE CONSTRUCTION PROJECT EXCEPT WHEN OTHERWISE NOTED IN THE PLAN OR DIRECTED BY THE ENGINEER.

TIME RESTRICTIONS

- A) DO NOT CLOSE OR NARROW TRAVEL LANES AS FOLLOWS:

<u>ROAD NAME</u>	<u>DAY AND TIME RESTRICTIONS</u>
ALL ROADS	MONDAY-FRIDAY 6:00 A.M.-9:00 A.M. AND 3:00 P.M.-7:00 P.M.

- B) DO NOT CLOSE OR NARROW TRAVEL LANES DURING HOLIDAYS AND SPECIAL EVENTS AS FOLLOWS:

ROAD NAME: ALL ROADS

HOLIDAY

1. FOR ANY UNEXPECTED OCCURRENCE THAT CREATES UNUSUALLY HIGH TRAFFIC VOLUMES, AS DIRECTED BY THE ENGINEER.
2. FOR NEW YEAR'S, BETWEEN THE HOURS OF 6:00 A.M. DECEMBER 31ST TO 7:00 P.M. JANUARY 2ND. IF NEW YEAR'S DAY IS ON A FRIDAY, SATURDAY, SUNDAY, OR MONDAY THEN UNTIL 7:00 P.M. THE FOLLOWING TUESDAY.
3. FOR EASTER, BETWEEN THE HOURS OF 6:00 A.M. THURSDAY AND 7:00 P.M. MONDAY.
4. FOR MEMORIAL DAY, BETWEEN THE HOURS OF 6:00 A.M. FRIDAY TO 7:00 P.M. TUESDAY.
5. FOR INDEPENDENCE DAY, BETWEEN THE HOURS OF 6:00 A.M. THE DAY BEFORE INDEPENDENCE DAY AND 7:00 P.M. THE DAY AFTER INDEPENDENCE DAY.

IF INDEPENDENCE DAY IS ON A FRIDAY, SATURDAY, SUNDAY, OR MONDAY THEN BETWEEN THE HOURS OF 6:00 A.M. THE THURSDAY BEFORE INDEPENDENCE DAY AND 7:00 P.M. THE TUESDAY AFTER INDEPENDENCE DAY.

6. FOR LABOR DAY, BETWEEN THE HOURS OF 6:00 A.M. FRIDAY AND 7:00 P.M. TUESDAY.
7. FOR THANKSGIVING DAY, BETWEEN THE HOURS OF 6:00 A.M. TUESDAY TO 7:00 P.M. MONDAY.

8. FOR CHRISTMAS, BETWEEN THE HOURS OF 6:00 A.M. THE FRIDAY BEFORE THE WEEK OF CHRISTMAS DAY AND 7:00 P.M. THE FOLLOWING TUESDAY AFTER THE WEEK OF CHRISTMAS.

LANE AND SHOULDER CLOSURE REQUIREMENTS

- C) REMOVE LANE CLOSURE DEVICES FROM THE LANE WHEN WORK IS NOT BEING PERFORMED BEHIND THE LANE CLOSURE OR WHEN A LANE CLOSURE IS NO LONGER NEEDED OR AS DIRECTED BY THE ENGINEER.
- D) WHEN PERSONNEL AND/OR EQUIPMENT ARE WORKING WITHIN 15 FT OF AN OPEN TRAVEL LANE, CLOSE THE NEAREST OPEN SHOULDER USING ROADWAY STANDARD DRAWING NO. 1101.04 UNLESS THE WORK AREA IS PROTECTED BY BARRIER OR GUARDRAIL OR A LANE CLOSURE IS INSTALLED.
- E) WHEN PERSONNEL AND/OR EQUIPMENT ARE WORKING ON THE SHOULDER ADJACENT TO AN UNDIVIDED FACILITY AND WITHIN 5 FT OF AN OPEN TRAVEL LANE, CLOSE THE NEAREST OPEN TRAVEL LANE USING ROADWAY STANDARD DRAWING NO. 1101.02 UNLESS THE WORK AREA IS PROTECTED BY BARRIER OR GUARDRAIL.

WHEN PERSONNEL AND/OR EQUIPMENT ARE WORKING ON THE SHOULDER ADJACENT TO A DIVIDED FACILITY AND WITHIN 10 FT OF AN OPEN TRAVEL LANE, CLOSE THE NEAREST OPEN TRAVEL LANE USING ROADWAY

- F) WHEN PERSONNEL AND/OR EQUIPMENT ARE WORKING WITHIN A LANE OF TRAVEL OF AN UNDIVIDED OR DIVIDED FACILITY, CLOSE THE LANE ACCORDING TO THE TRAFFIC CONTROL PLANS, ROADWAY STANDARD DRAWINGS, OR AS DIRECTED BY THE ENGINEER. CONDUCT THE WORK SO THAT ALL PERSONNEL AND/OR EQUIPMENT REMAIN WITHIN THE CLOSED TRAVEL LANE.

- G) DO NOT WORK SIMULTANEOUSLY WITHIN 15 FT ON BOTH SIDES OF AN OPEN TRAVELWAY, RAMP, OR LOOP WITHIN THE SAME LOCATION UNLESS PROTECTED WITH GUARDRAIL OR BARRIER.

PAVEMENT EDGE DROP OFF REQUIREMENTS

- H) BACKFILL AT A 6:1 SLOPE UP TO THE EDGE AND ELEVATION OF EXISTING PAVEMENT IN AREAS ADJACENT TO AN OPENED TRAVEL LANE THAT HAS AN EDGE OF PAVEMENT DROP-OFF AS FOLLOWS:

BACKFILL DROP-OFFS THAT EXCEED 2 INCHES ON ROADWAYS WITH POSTED SPEED LIMITS OF 45 MPH OR GREATER.

BACKFILL DROP-OFFS THAT EXCEED 3 INCHES ON ROADWAYS WITH POSTED SPEED LIMITS LESS THAN 45 MPH.

BACKFILL WITH SUITABLE COMPACTED MATERIAL, AS APPROVED BY THE ENGINEER, AT NO EXPENSE TO THE DEPARTMENT.

- I) DO NOT EXCEED A DIFFERENCE OF 2 INCHES IN ELEVATION BETWEEN OPEN LANES OF TRAFFIC FOR NOMINAL LIFTS OF 1.5 INCHES. INSTALL ADVANCE WARNING "UNEVEN LANES" SIGNS (W8-11) 350 FEET IN ADVANCE AND A MINIMUM OF EVERY HALF MILE THROUGHOUT THE UNEVEN AREA.

TRAFFIC PATTERN ALTERATIONS

- J) NOTIFY THE ENGINEER THIRTY (30) DAYS PRIOR TO ANY TRAFFIC PATTERN ALTERATION.

SIGNING

- K) INSTALL ADVANCE WORK ZONE WARNING SIGNS WHEN WORK IS WITHIN 40 FT FROM THE EDGE OF TRAVEL LANE AND NO MORE THAN THREE (3) DAYS PRIOR TO THE BEGINNING OF CONSTRUCTION.

- L) ENSURE ALL NECESSARY SIGNING IS IN PLACE PRIOR TO ALTERING ANY TRAFFIC PATTERN.

TRAFFIC CONTROL DEVICES

- M) WHEN LANE CLOSURES ARE NOT IN EFFECT SPACE CHANNELIZING DEVICES IN WORK AREAS NO GREATER IN FEET THAN TWICE THE POSTED SPEED LIMIT (MPH) EXCEPT, 10 FT ON-CENTER IN RADII, AND 3 FT OFF THE EDGE OF AN OPEN TRAVELWAY. REFER TO STANDARD SPECIFICATIONS FOR ROADS AND STRUCTURES SECTIONS 1130 (DRUMS), 1135 (CONES), AND 1180 (SKINNY DRUMS) FOR ADDITIONAL REQUIREMENTS.
- N) PLACE TYPE III BARRICADES, WITH "ROAD CLOSED" SIGN R11-2 ATTACHED, OF SUFFICIENT LENGTH TO CLOSE ENTIRE ROADWAY.
- O) PLACE ADDITIONAL SETS OF THREE CHANNELIZING DEVICES (DRUMS) PERPENDICULAR TO THE EDGE OF TRAVELWAY ON 500 FT CENTERS WHEN UNOPENED LANES ARE CLOSED TO TRAFFIC.

PAVEMENT MARKINGS AND MARKERS

- P) INSTALL TEMPORARY PAVEMENT MARKINGS AND TEMPORARY PAVEMENT MARKERS ON INTERIM LAYERS OF PAVEMENT AS FOLLOWS:

<u>ROAD NAME</u>	<u>MARKING</u>	<u>MARKER</u>
ALL ROADS	PAINT	TEMPORARY RAISED

- Q) PLACE ONE APPLICATION OF PAINT FOR TEMPORARY TRAFFIC PATTERNS. PLACE A SECOND APPLICATION OF PAINT SIX (6) MONTHS AFTER THE INITIAL APPLICATION AND EVERY SIX MONTHS AS DIRECTED BY THE ENGINEER.

- R) TIE PROPOSED PAVEMENT MARKING LINES TO EXISTING PAVEMENT MARKING LINES.

- S) REMOVE/REPLACE ANY CONFLICTING/DAMAGED PAVEMENT MARKINGS AND MARKERS BY THE END OF EACH DAY'S OPERATION.

- T) TRACE THE PROPOSED MONOLITHIC ISLAND LOCATIONS WITH PROPER COLOR PAVEMENT MARKINGS PRIOR TO INSTALLATION. PLACE (DRUMS) TO DELINEATE ANY PROPOSED MONOLITHIC ISLANDS.

MISCELLANEOUS

- U) ALL CURB RAMP LOCATIONS SHALL BE DERIVED FROM STATIONING SHOWN ON PAVEMENT MARKING PLANS OR AS DIRECTED BY THE ENGINEER IN COORDINATION WITH THE SIGNING AND DELINEATION UNIT.

4/6/2021 X:\2015\TRIS\030.00 U-5826 Falls of Neuse\Traffic\TCP\U-5826 TMP-1B.dgn jbauman

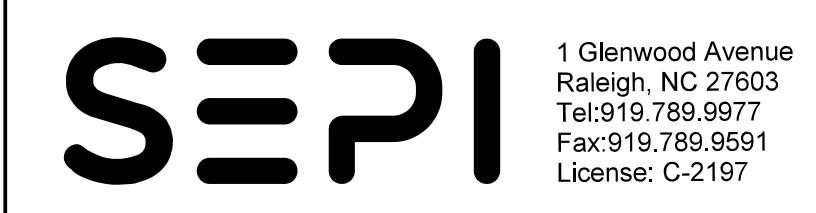

APPROVED: _____
DATE: _____

SEAL

**DOCUMENT NOT CONSIDERED FINAL
UNLESS ALL SIGNATURES COMPLETED**

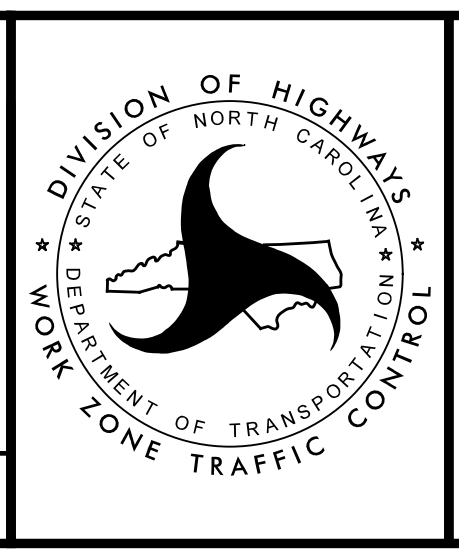

TRANSPORTATION OPERATIONS PLAN

PHASING

PHASE I

- STEP 1: USING RSD 1101.01, SHEETS 2 AND 3 OF 3, PLACE WORK ZONE ADVANCE WARNING SIGNS ON FALLS OF NEUSE ROAD AND ALL -Y- LINES.
- STEP 2: AWAY FROM TRAFFIC AND USING RSD 1101.02 SHEETS 1 AND 3 OF 14, PERFORM THE FOLLOWING AS SHOWN ON TMP-3 THROUGH TMP-3D:
- BEGIN TO CONSTRUCT WIDENING ON THE LEFT SIDE OF -L- FROM STA 13+00 +/- TO STA 76+75 +/- UP TO BUT NOT INCLUDING THE FINAL LAYER OF SURFACE COURSE.
 - COMPLETE MULTI-USE PATH CONSTRUCTION ON THE RIGHT SIDE OF -L- AND OPEN TO PEDESTRIAN TRAFFIC.

NOTE: THE CONTRACTOR SHALL PROVIDE A PEDESTRIAN TRANSPORT SERVICE THROUGH AND/OR AROUND THE PROJECT AS NEEDED. AT MINIMUM, THE PEDESTRIAN TRANSPORT SERVICE SHALL BE ON CALL BETWEEN THE HOURS OF 7:00 AM TO 8:00 PM MONDAY THROUGH SUNDAY. (SEE SPECIAL PROVISIONS)

- STEP 3: USING RSD 1101.02 SHEETS 1 AND 3 OF 14, INSTALL PHASE II TEMPORARY PAVEMENT MARKINGS AS SHOWN ON TMP-4 THROUGH TMP-4A, MOVE DEVICES, ACTIVATE TEMPORARY SIGNALS, AND SHIFT TRAFFIC TO THE PHASE II PATTERN.

PHASE II

THE CONTRACTOR SHALL COMPLETE THE WORK REQUIRED FOR PHASE II STEP 1 (MEDIAN DRAINAGE) DURING NIGHTLY CLOSURES MONDAY THRU SUNDAY BETWEEN THE HOURS OF 8 PM TO 6 AM. SEE INTERMEDIATE CONTRACT TIMES.

- STEP 1: USING RSD 1101.02 SHEETS 1 AND 3 OF 14, PERFORM THE FOLLOWING AS SHOWN ON TMP-4 THROUGH TMP-4D.
- REMOVE CONCRETE MEDIAN FROM -L- STA 17+05 +/- TO STA 27+40 +/- AND -L- STA 28+74 +/- TO STA 32+57 +/-
 - INSTALL MEDIAN DRAINAGE FROM -L- STA 17+05 +/- TO STA 32+57 +/-
 - PERFORM SHOTBLASTING ON CONCRETE BRIDGE AS PART OF BRIDGE PRESERVATION
 - MAINTAIN PEDESTRIAN ACCESS TO MULTI-USE PATH ON RIGHT SIDE OF -L-
 - CONSTRUCT THE RIGHT SIDE OF -L- UP TO BUT NOT INCLUDING THE FINAL LAYER OF SURFACE COURSE.
 - CONTINUE TO CONSTRUCT THE LEFT SIDE OF -L- FROM STA 13+00 +/- TO STA 76+75 +/- UP TO BUT NOT INCLUDING THE FINAL LAYER OF SURFACE COURSE.
- STEP 2: USING RSD 1101.02 SHEETS 1 AND 3 OF 14, PERFORM THE FOLLOWING IN A CONTINUOUS MANNER:
- USE WEDGING TO CREATE A TIE IN TO THE FINAL TRAFFIC PATTERN UP TO BUT NOT INCLUDING THE FINAL LAYER OF SURFACE COURSE
 - PLACE TEMPORARY PAVEMENT MARKINGS IN THE SAME LOCATION AS THE FINAL PAVEMENT MARKINGS ACCORDING TO THE PAVEMENT MARKING PLANS
 - MOVE DEVICES, ACTIVATE FINAL SIGNALS, AND SHIFT TRAFFIC TO THE FINAL PATTERN

PHASE III

- STEP 1: USING RSD 1101.02 SHEETS 1 AND 3 OF 14, COMPLETE CONSTRUCTION UP TO BUT NOT INCLUDING THE FINAL LAYER OF SURFACE COURSE AS SHOWN ON TMP-5 THROUGH TMP-5D. COMPLETE ROADWAY AND SIDEWALK CONSTRUCTION.
- STEP 2: USING RSD 1101.02 SHEETS 1 AND 3 OF 14, CONSTRUCT THE FINAL LAYER OF SURFACE COURSE AND INSTALL THE FINAL PAVEMENT MARKINGS.
- STEP 3: REMOVE ALL WORK ZONE TRAFFIC CONTROL DEVICES.

4/6/2021
X:\2015\TRIS\030.00 U-5826 Falls of Neuse\Traffic\TCP\U-5826 TMP-2.dgn
JBauman

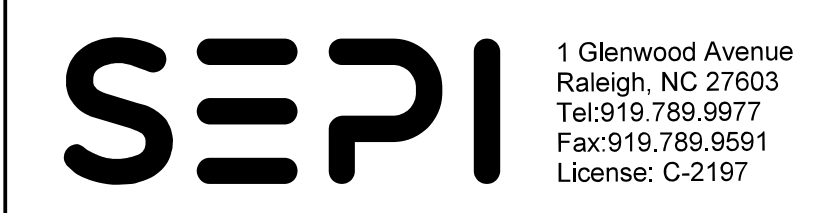

APPROVED: _____
DATE: _____

SEAL

**DOCUMENT NOT CONSIDERED FINAL
UNLESS ALL SIGNATURES COMPLETED**

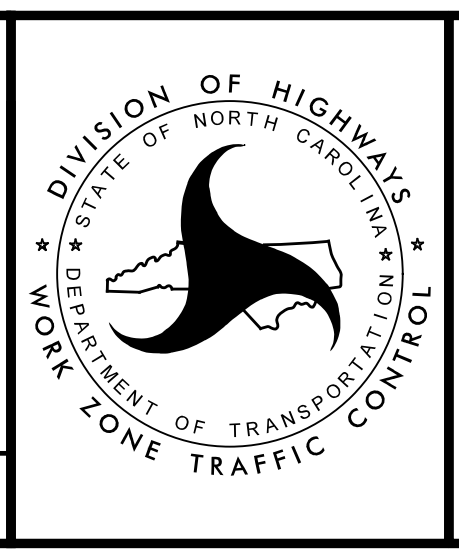

PHASING

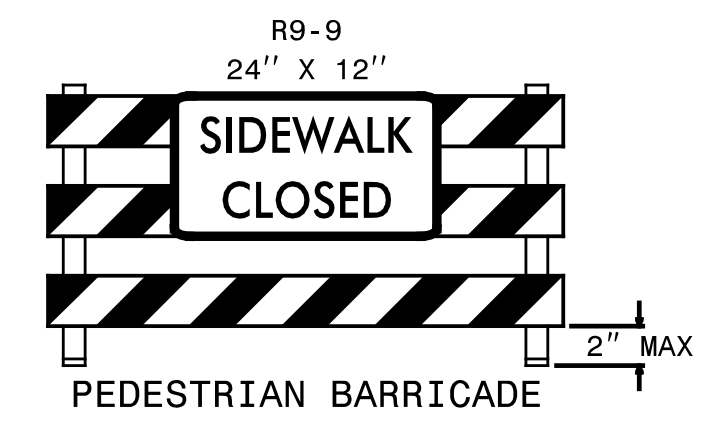
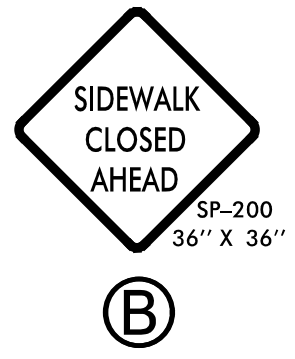
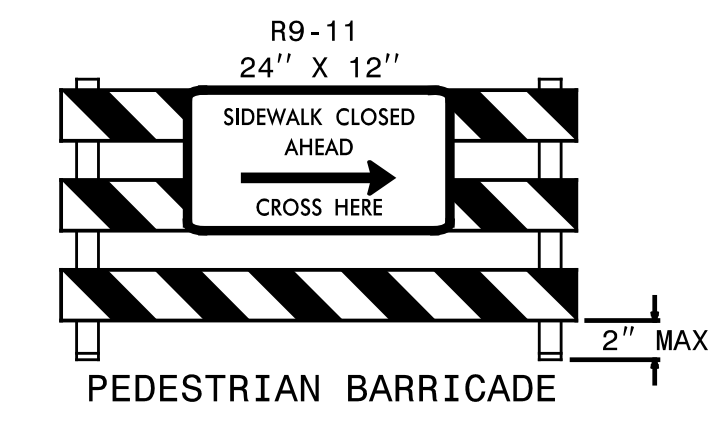

A

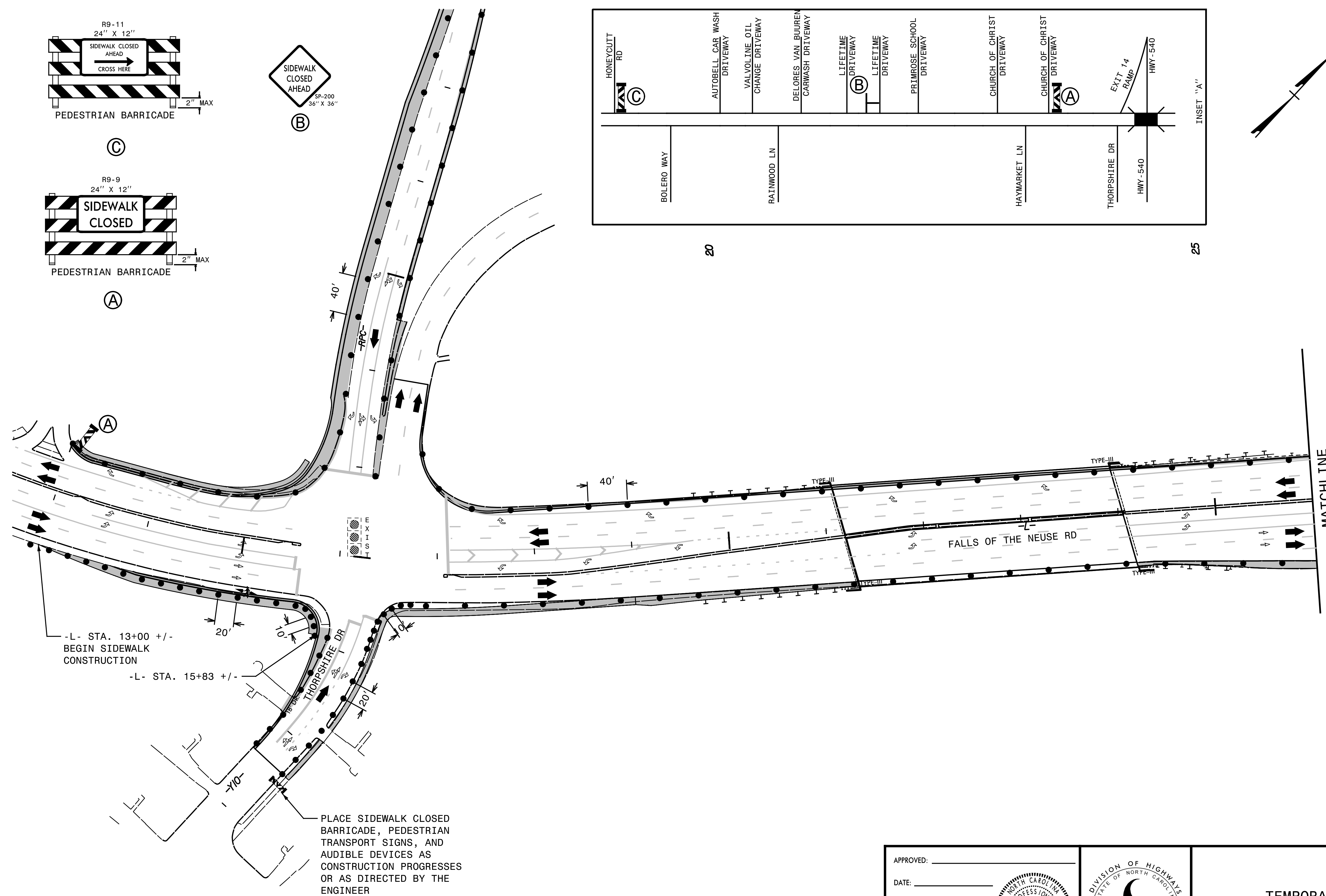
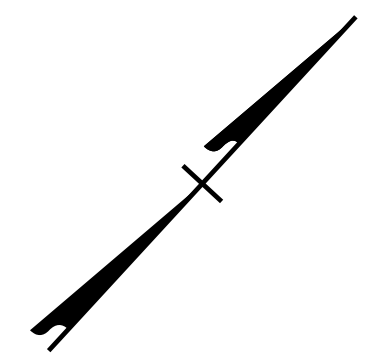
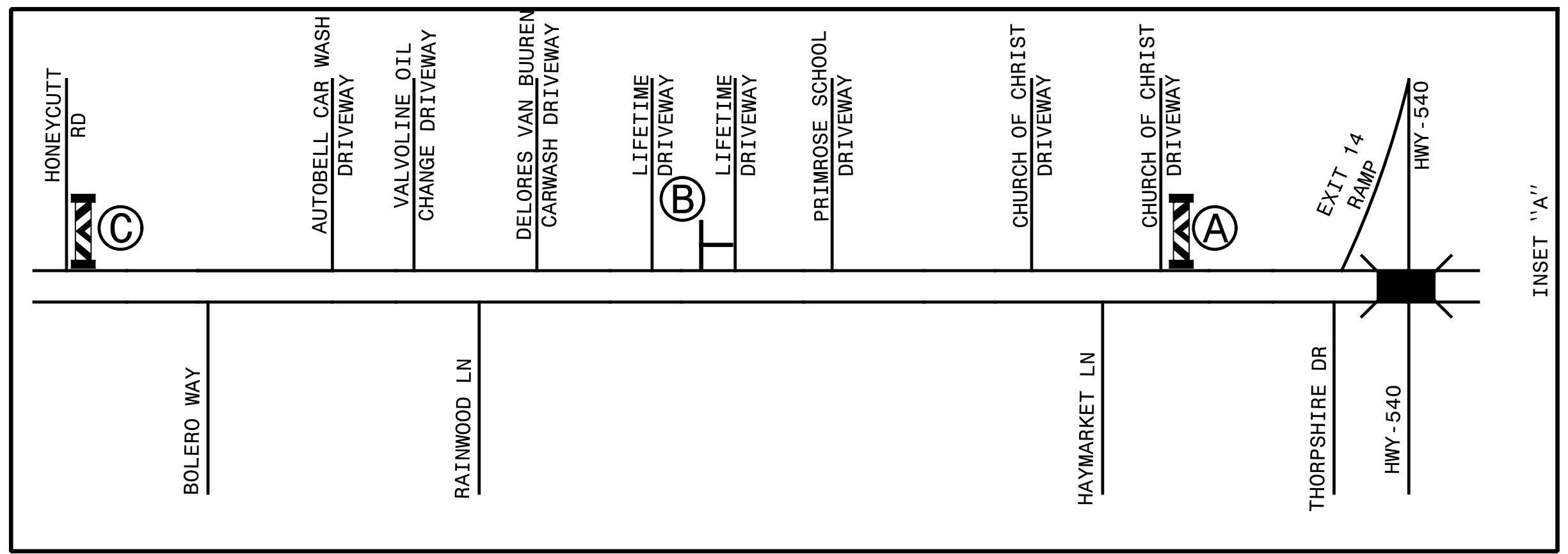

4/6/2021 X:\2015\TRIS\030.00 U-5826 Falls of Neuse\Traffic\TCP\TCP-U-5826 TMP-3.dgn jbauman

SEPI
1 Glenwood Avenue
Raleigh, NC 27603
Tel: 919.789.9977
Fax: 919.789.9591
License: C-2197

APPROVED: _____
DATE: _____

SEAL

DOCUMENT NOT CONSIDERED FINAL
UNLESS ALL SIGNATURES COMPLETED

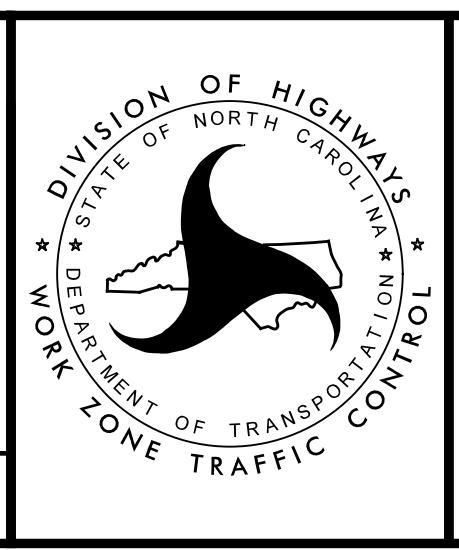

**TEMPORARY
TRAFFIC CONTROL
PHASE I DETAIL**

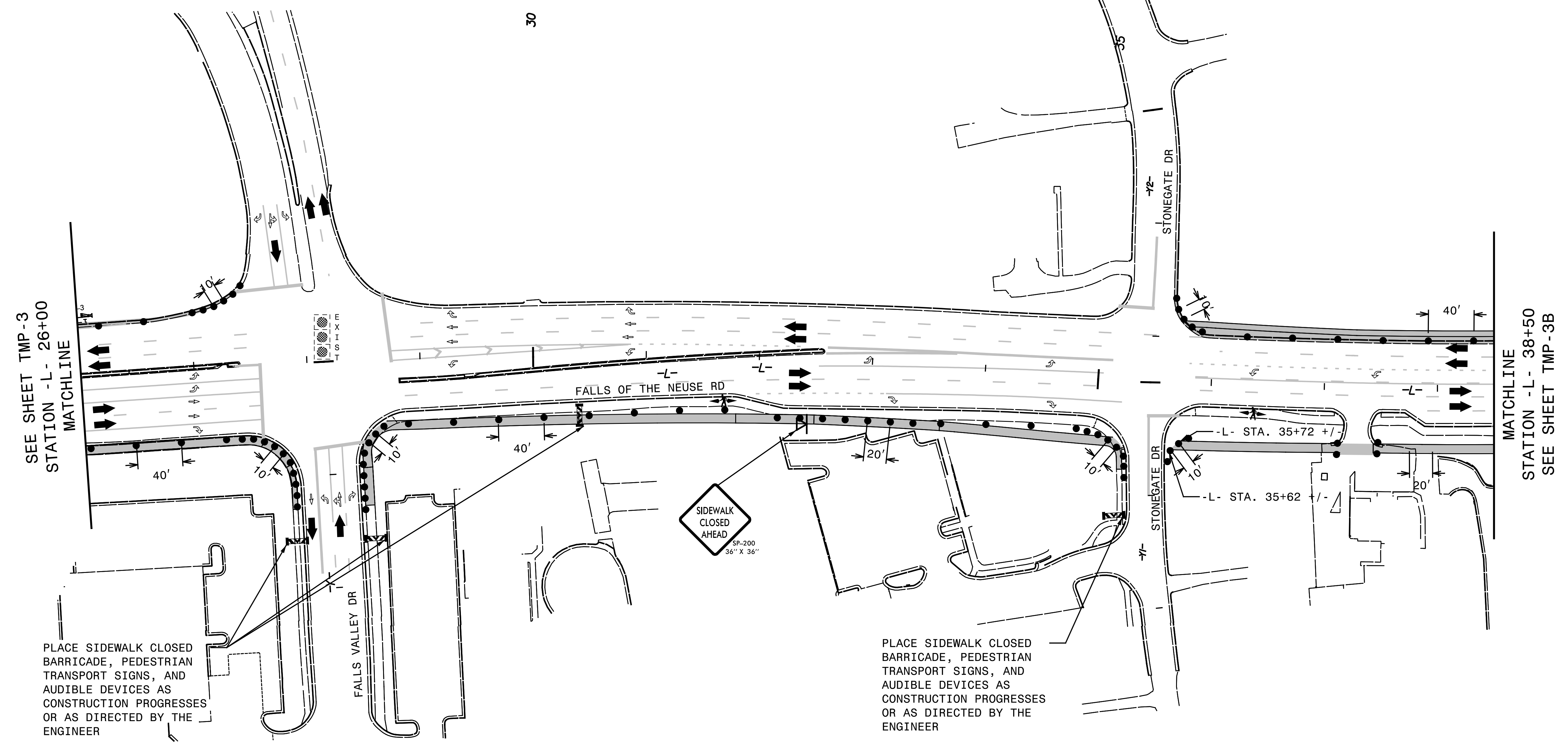
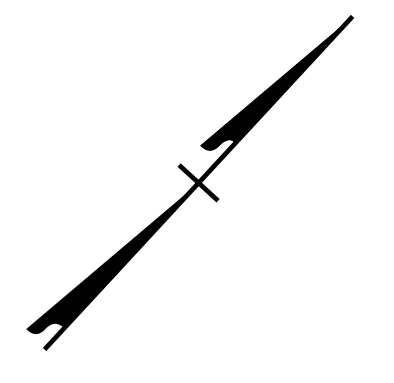

SEE SHEET TMP-3
STATION -L- 26+00
MATCHLINE

MATCHLINE
STATION -L- 38+50
SEE SHEET TMP-3B

PLACE SIDEWALK CLOSED BARRICADE, PEDESTRIAN TRANSPORT SIGNS, AND AUDIBLE DEVICES AS CONSTRUCTION PROGRESSES OR AS DIRECTED BY THE ENGINEER

PLACE SIDEWALK CLOSED BARRICADE, PEDESTRIAN TRANSPORT SIGNS, AND AUDIBLE DEVICES AS CONSTRUCTION PROGRESSES OR AS DIRECTED BY THE ENGINEER

4/6/2021 X:\2015\TRIS\030.00 U-5826 Falls of Neuse\Traffic\TCP\TCP-U-5826 TMP-3A.dgn jbauman

SEPI
1 Glenwood Avenue
Raleigh, NC 27603
Tel: 919.789.9977
Fax: 919.789.9591
License: C-2197

APPROVED: _____
DATE: _____

SEAL

**DOCUMENT NOT CONSIDERED FINAL
UNLESS ALL SIGNATURES COMPLETED**

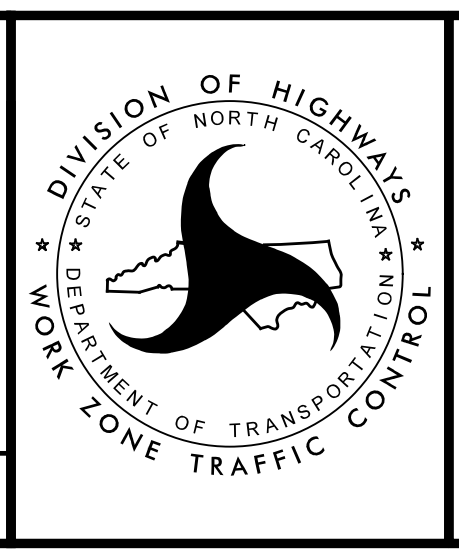

**TEMPORARY
TRAFFIC CONTROL
PHASE I DETAIL**

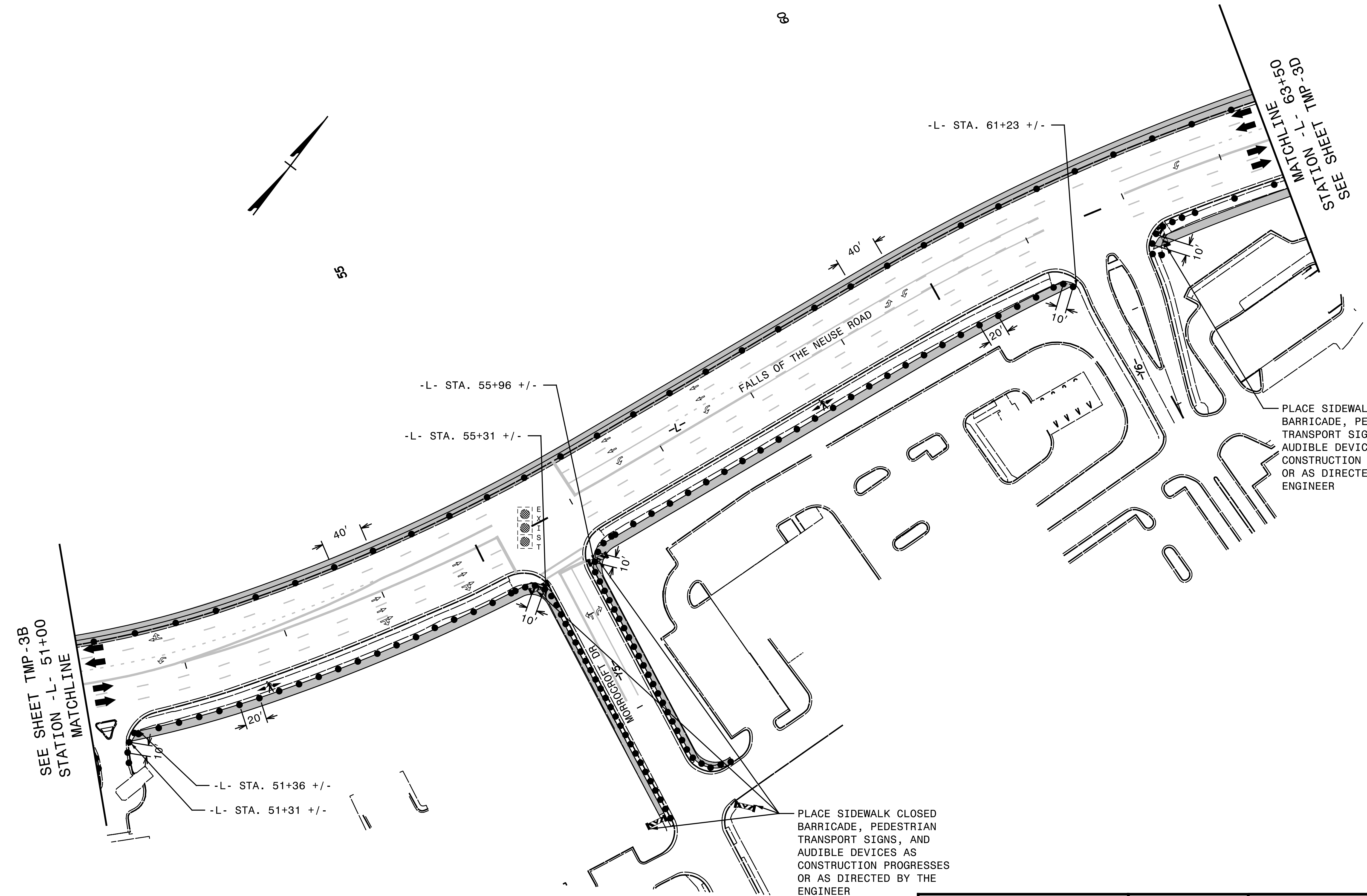

PLACE SIDEWALK CLOSED BARRICADE, PEDESTRIAN TRANSPORT SIGNS, AND AUDIBLE DEVICES AS CONSTRUCTION PROGRESSES OR AS DIRECTED BY THE ENGINEER

PLACE SIDEWALK CLOSED BARRICADE, PEDESTRIAN TRANSPORT SIGNS, AND AUDIBLE DEVICES AS CONSTRUCTION PROGRESSES OR AS DIRECTED BY THE ENGINEER

SEE SHEET TMP-3B
STATION -L- 51+00
MATCHLINE

4/6/2021 X:\2015\TRIS\030.00 U-5826 Falls of Neuse\Traffic\TCP\TCP-U-5826 TMP-3C.dgn jbauman

SEPI
1 Glenwood Avenue
Raleigh, NC 27603
Tel: 919.789.9977
Fax: 919.789.9591
License: C-2197

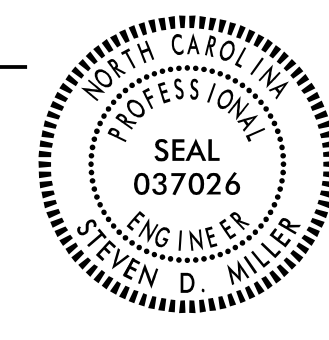
APPROVED: _____
DATE: _____
SEAL

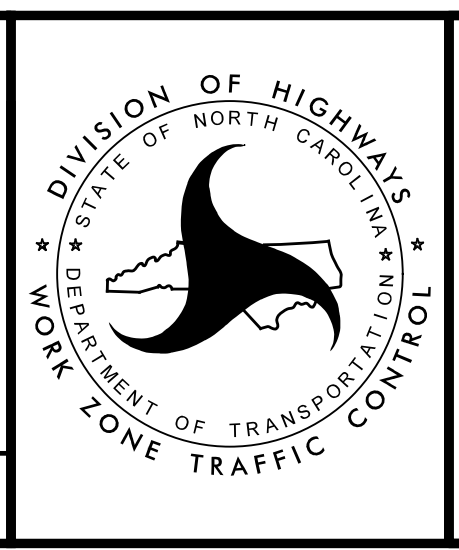
**DOCUMENT NOT CONSIDERED FINAL
UNLESS ALL SIGNATURES COMPLETED**

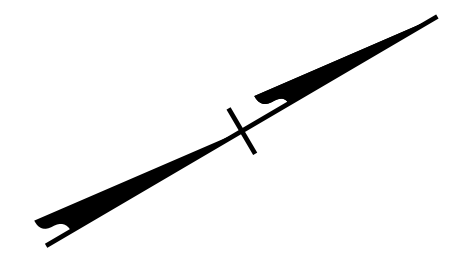
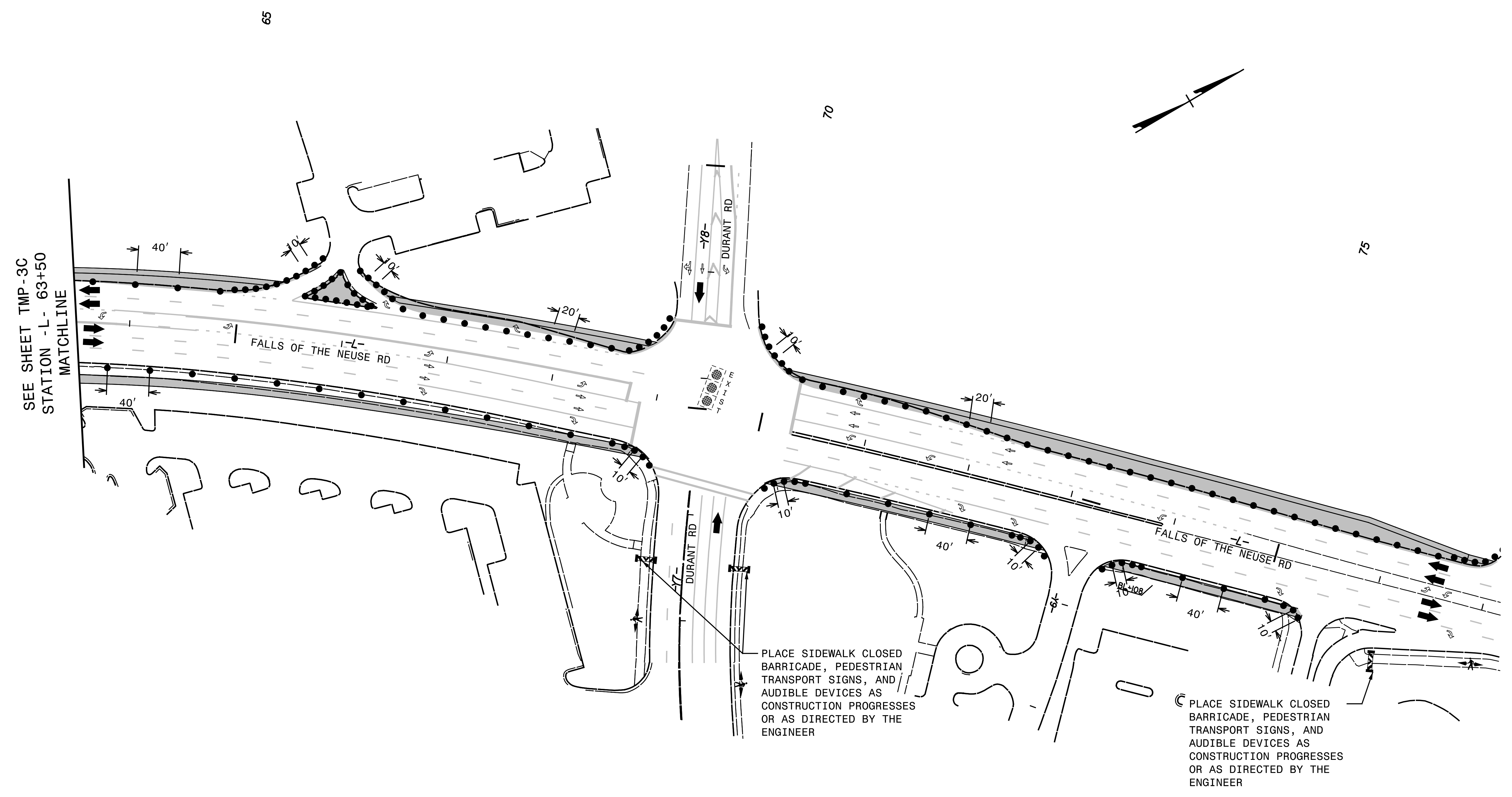

**TEMPORARY
TRAFFIC CONTROL
PHASE I DETAIL**



4/6/2021
 X:\2015\TRIS\030.00 U-5826 Falls of Neuse\Traffic\TCP\U-5826 TMP-3D.dgn
 jbauman

SEPI
 1 Glenwood Avenue
 Raleigh, NC 27603
 Tel: 919.789.9977
 Fax: 919.789.9591
 License: C-2197

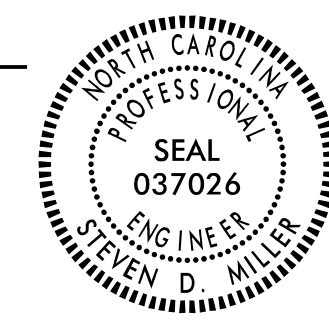
APPROVED: _____
 DATE: _____
 SEAL

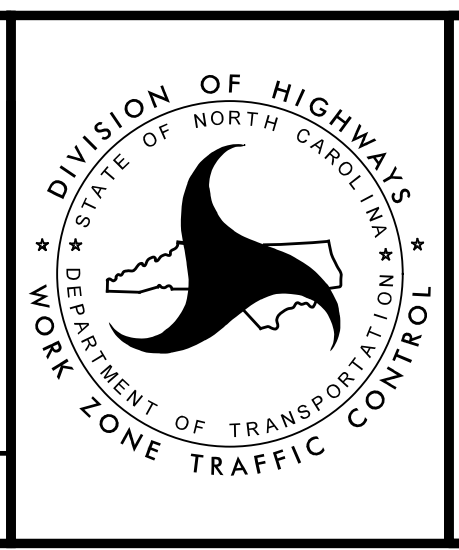
**DOCUMENT NOT CONSIDERED FINAL
 UNLESS ALL SIGNATURES COMPLETED**

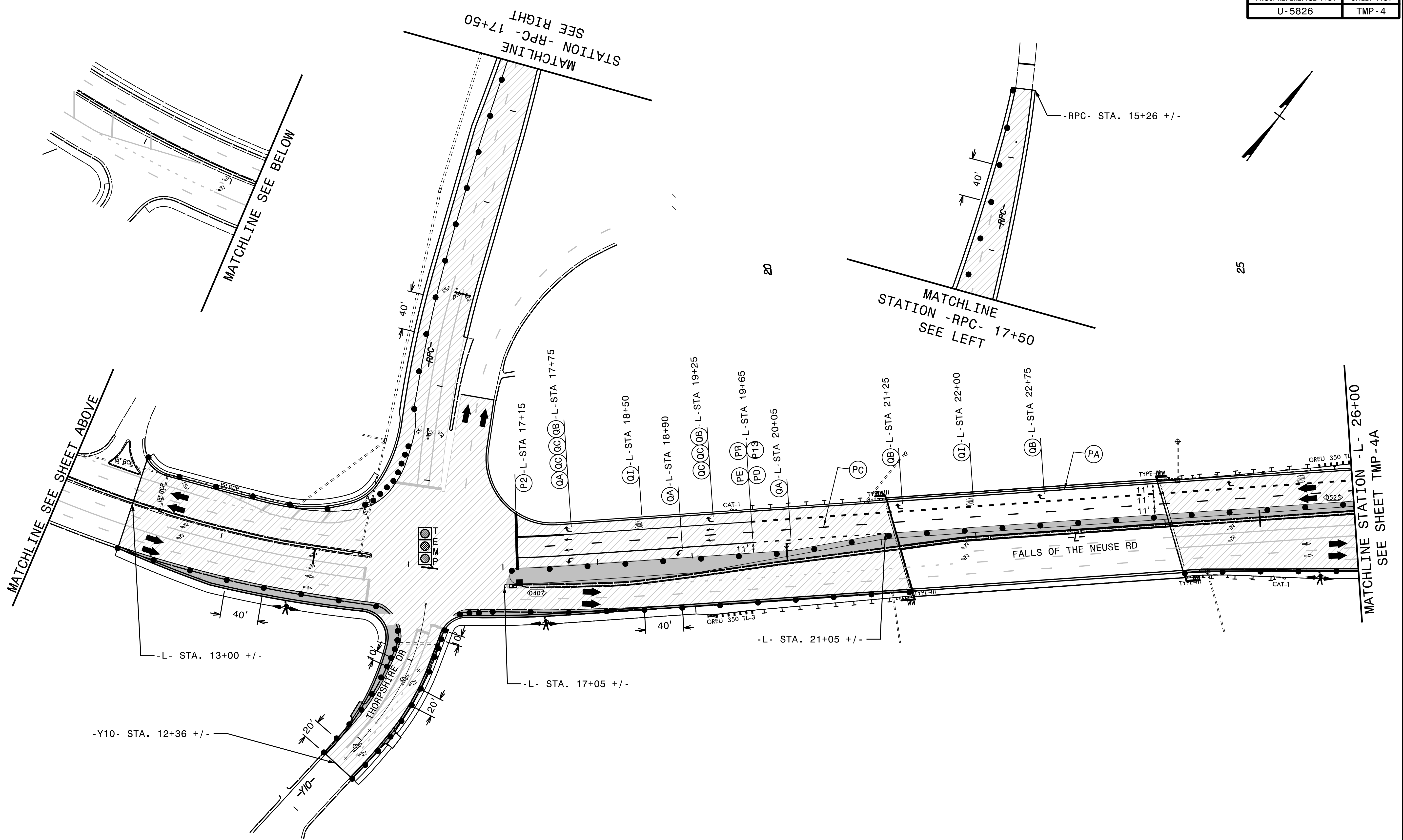

**TEMPORARY
 TRAFFIC CONTROL
 PHASE I DETAIL**



4/6/2021
 X:\2015\TRIS\030.00 U-5826 Falls of Neuse\Traffic\TCP\TCP-U-5826 TMP-4.dgn
 JBauman

SEPI
 1 Glenwood Avenue
 Raleigh, NC 27603
 Tel: 919.789.9977
 Fax: 919.789.9591
 License: C-2197

APPROVED: _____
 DATE: _____
 SEAL
 DOCUMENT NOT CONSIDERED FINAL
 UNLESS ALL SIGNATURES COMPLETED

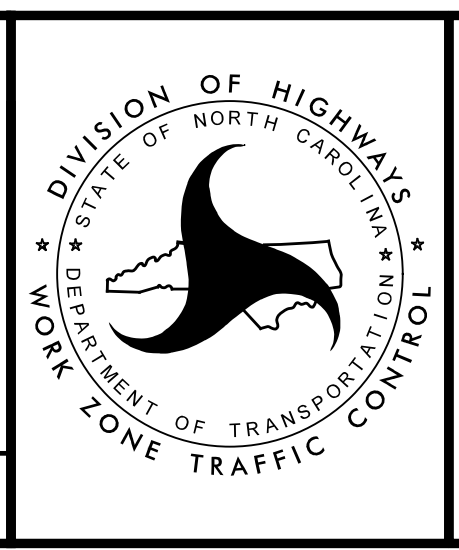

DIVISION OF HIGHWAYS
 STATE OF NORTH CAROLINA
 DEPARTMENT OF TRANSPORTATION
 WORK ZONE TRAFFIC CONTROL

**TEMPORARY
 TRAFFIC CONTROL
 PHASE II DETAIL**

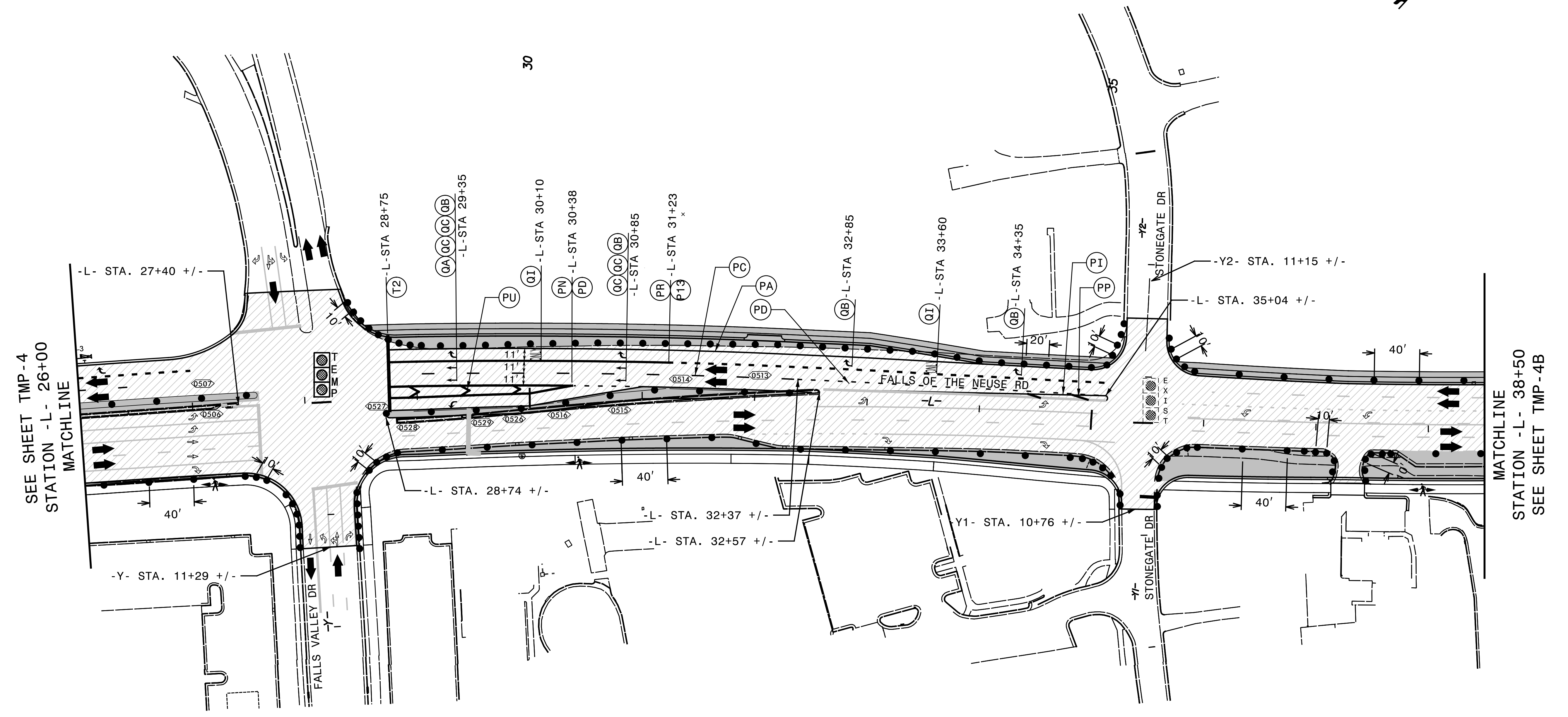
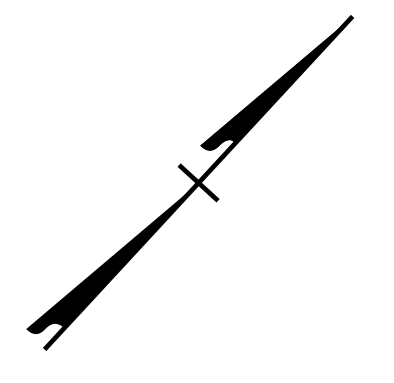

4/6/2021
 X:\2015\TRIS\030.00 U-5826 Falls of Neuse\Traffic\TCP\TCP-U-5826 TMP-4A.dgn
 jbauman

SEPI

1 Glenwood Avenue
 Raleigh, NC 27603
 Tel: 919.789.9977
 Fax: 919.789.9591
 License: C-2197

APPROVED: _____
 DATE: _____

SEAL

**DOCUMENT NOT CONSIDERED FINAL
 UNLESS ALL SIGNATURES COMPLETED**

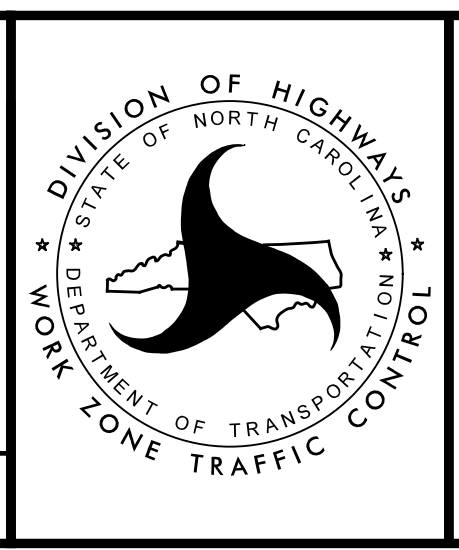

**TEMPORARY
 TRAFFIC CONTROL
 PHASE II DETAIL**

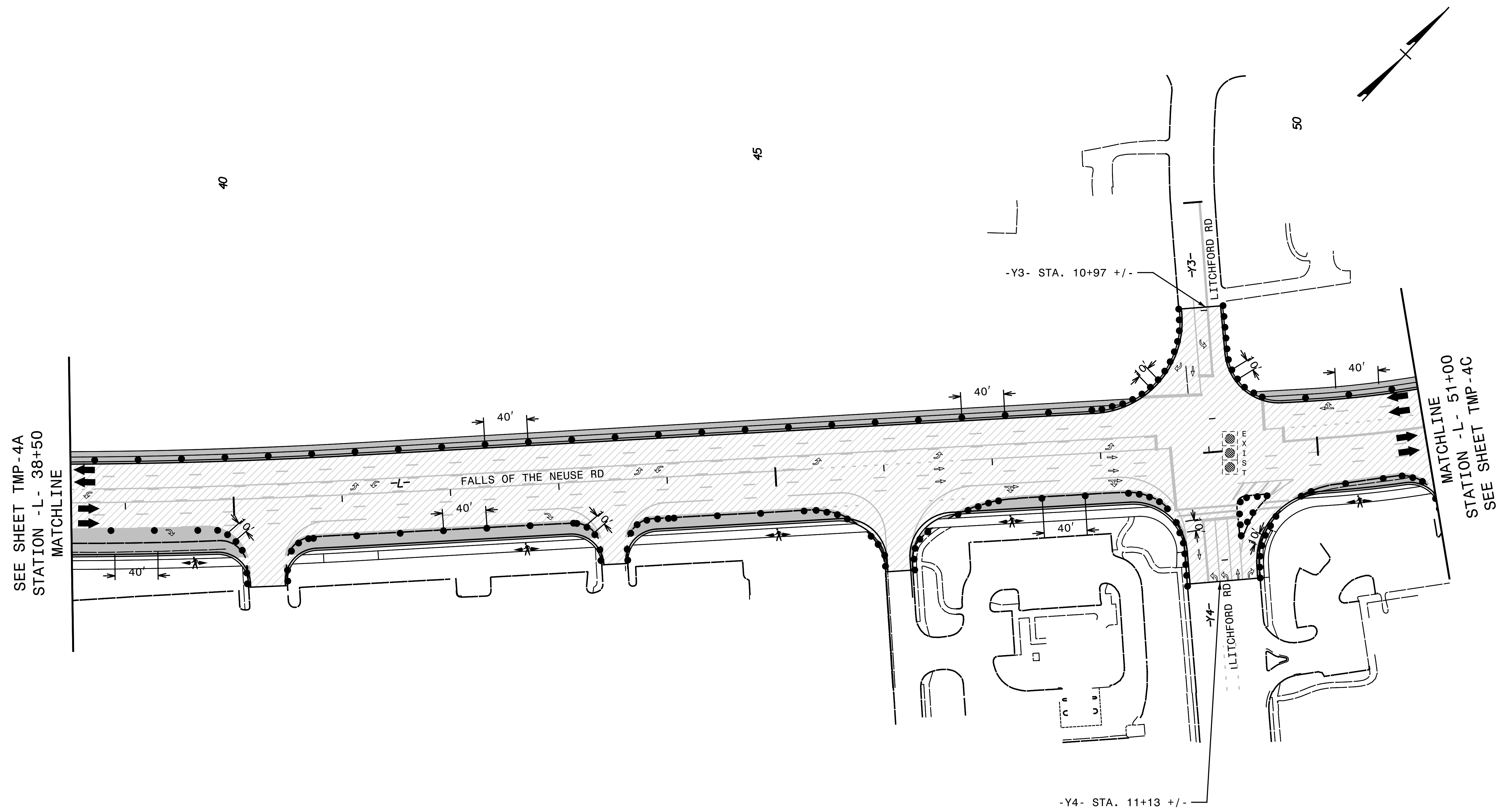

4/6/2021
 X:\2015\TRIS\030.00 U-5826 Falls of Neuse\Traffic\TCP\TCP\U-5826 TMP-4B.dgn
 jbauman

SEPI
 1 Glenwood Avenue
 Raleigh, NC 27603
 Tel: 919.789.9977
 Fax: 919.789.9591
 License: C-2197

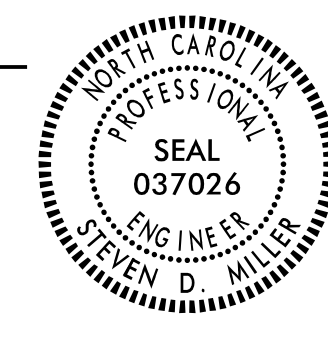
APPROVED: _____
 DATE: _____
 SEAL

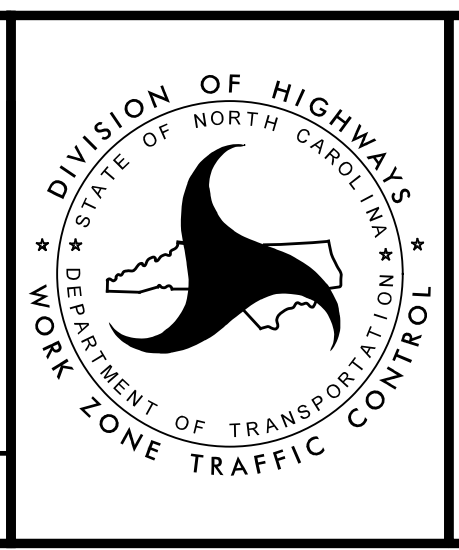
**DOCUMENT NOT CONSIDERED FINAL
 UNLESS ALL SIGNATURES COMPLETED**

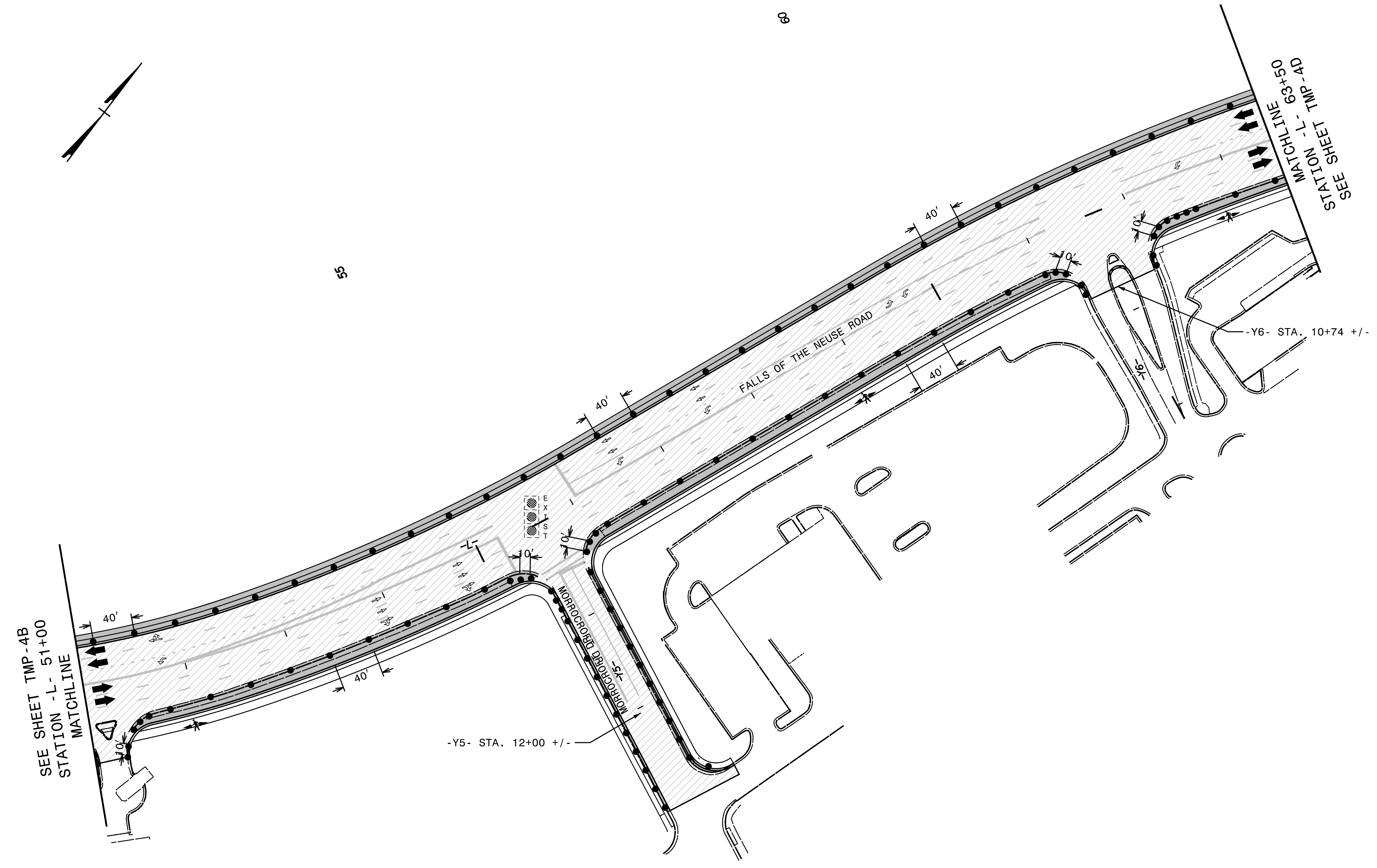

**TEMPORARY
 TRAFFIC CONTROL
 PHASE II DETAIL**



4/6/2021
 X:\2015\TRIS\030.00 U-5826 Falls of Neuse\Traffic\TCP\TCP-U-5826 TMP-4C.dgn
 jbauman

SEPI
 1 Glenwood Avenue
 Raleigh, NC 27603
 Tel: 919.789.9977
 Fax: 919.789.9591
 License: C-2197

APPROVED: _____
 DATE: _____
 SEAL
 DOCUMENT NOT CONSIDERED FINAL
 UNLESS ALL SIGNATURES COMPLETED



TEMPORARY
 TRAFFIC CONTROL
 PHASE II DETAIL

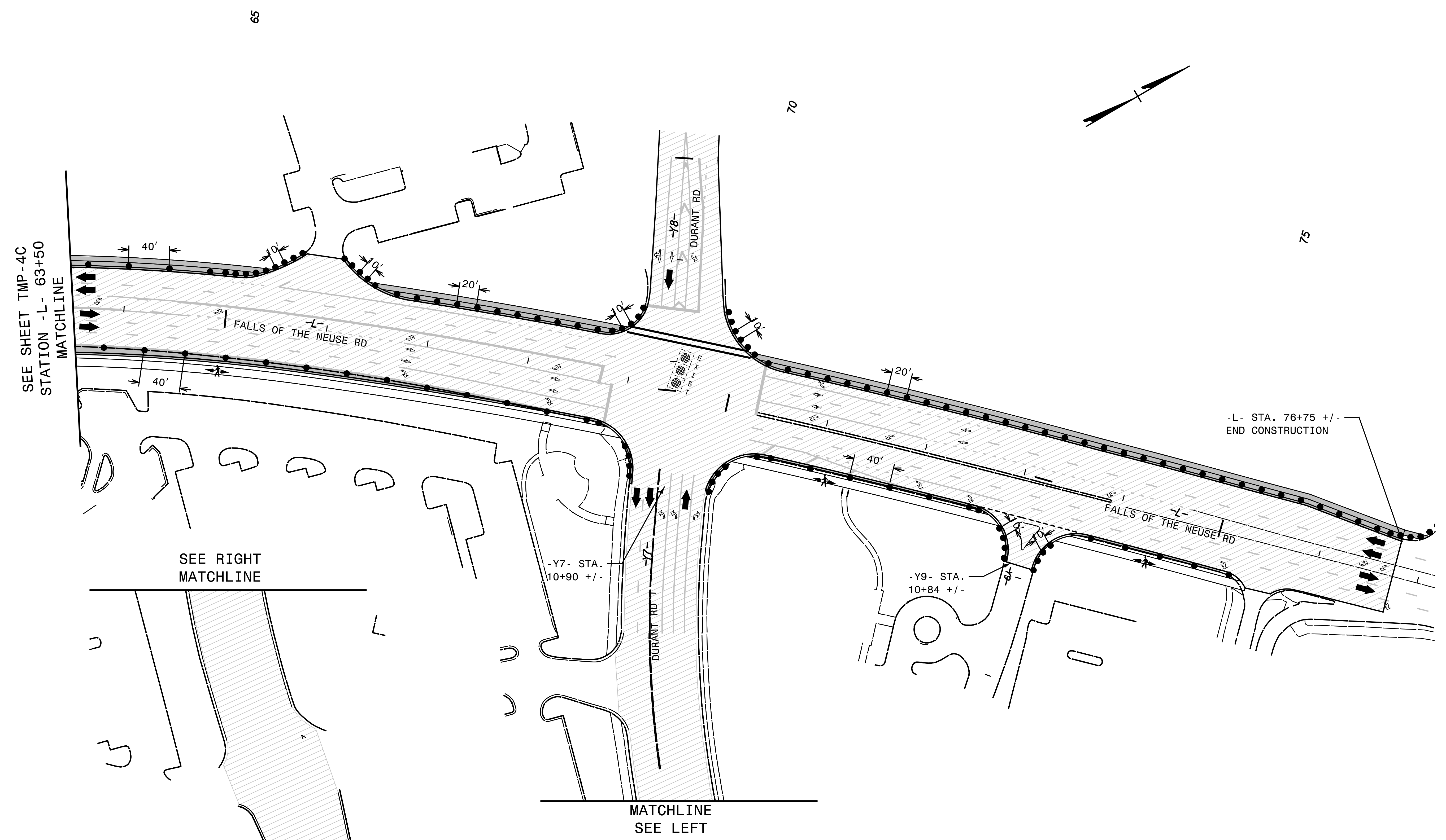

4/6/2021
 X:\2015\TRIS\030.00 U-5826 Falls of Neuse\Traffic\TCP\U-5826 TMP-4D.dgn
 jbauman

SEE RIGHT
MATCHLINE

SEE SHEET TMP-4C
STATION -L- 63+50
MATCHLINE

-Y7- STA.
10+90 +/-

-Y9- STA.
10+84 +/-

-L- STA. 76+75 +/-
END CONSTRUCTION

MATCHLINE
SEE LEFT

SEPI
 1 Glenwood Avenue
 Raleigh, NC 27603
 Tel: 919.789.9977
 Fax: 919.789.9591
 License: C-2197

APPROVED: _____
 DATE: _____

SEAL

**DOCUMENT NOT CONSIDERED FINAL
UNLESS ALL SIGNATURES COMPLETED**

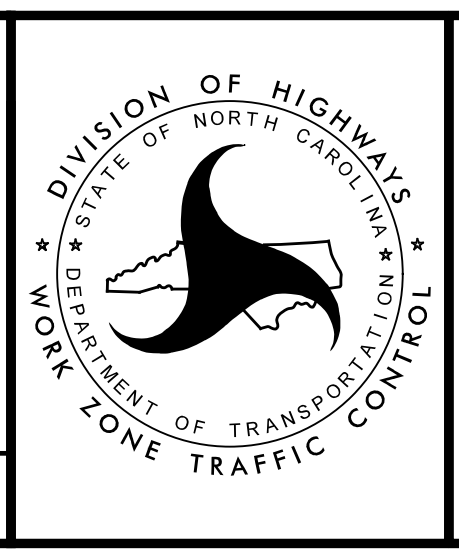

**TEMPORARY
TRAFFIC CONTROL
PHASE II DETAIL**

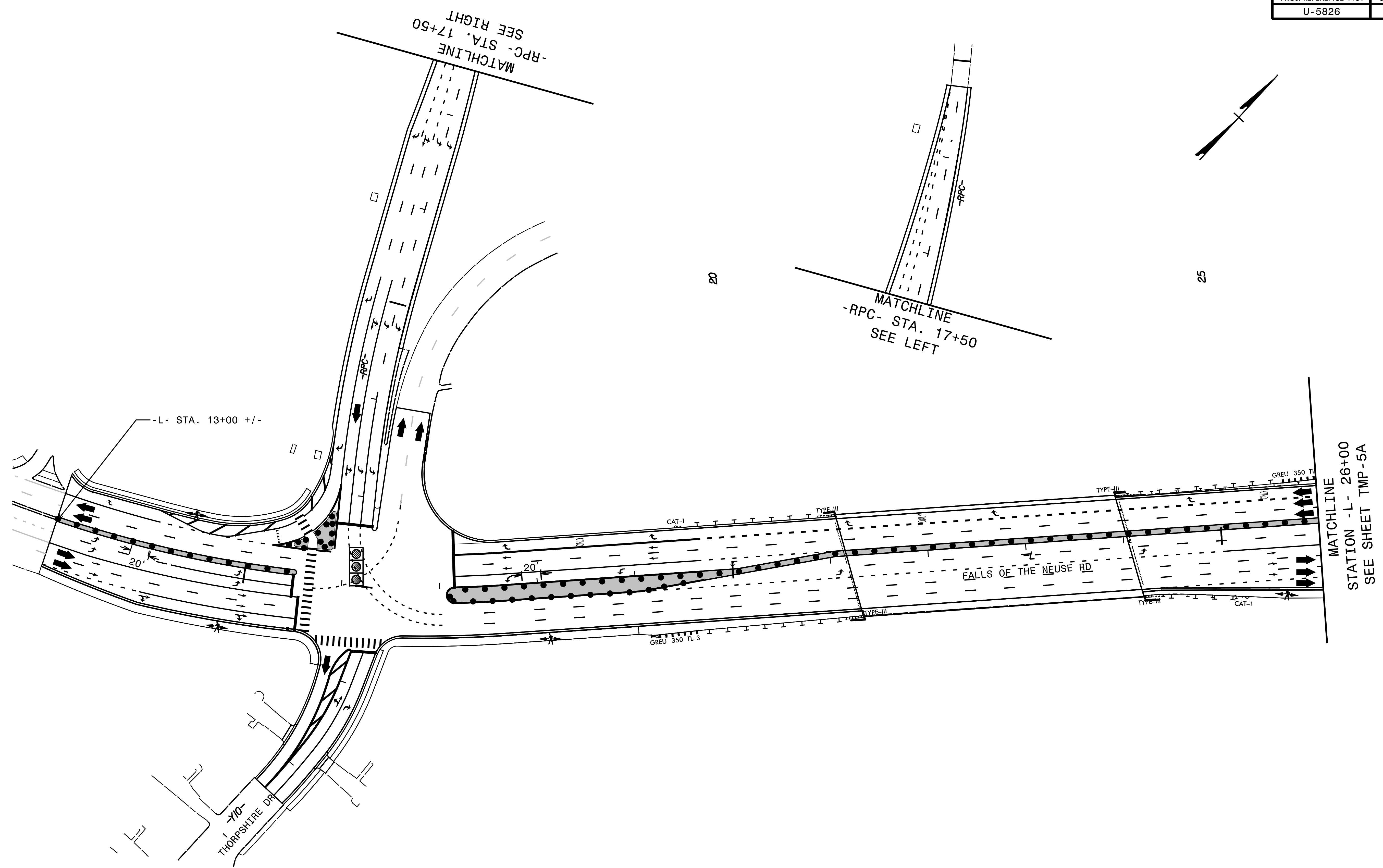

4/6/2021
 X:\2015\TRIS\030.00 U-5826 Falls of Neuse\Traffic\TCP\TCP\U-5826 TMP-5.dgn
 jbauman

SEPI
 1 Glenwood Avenue
 Raleigh, NC 27603
 Tel: 919.789.9977
 Fax: 919.789.9591
 License: C-2197

APPROVED: _____
 DATE: _____
 SEAL
 DOCUMENT NOT CONSIDERED FINAL
 UNLESS ALL SIGNATURES COMPLETED

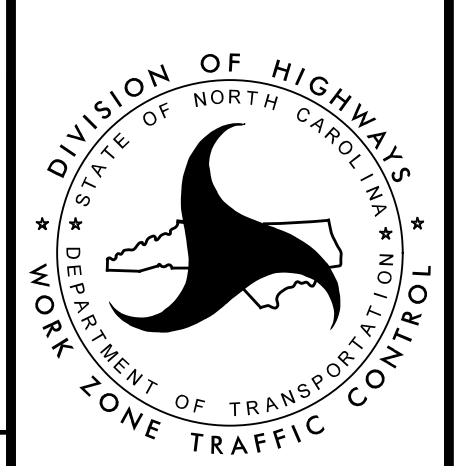
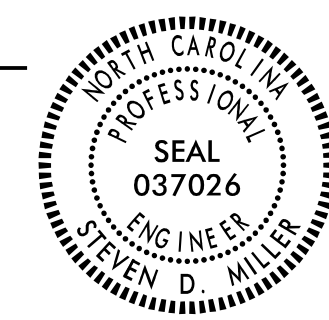

TEMPORARY
 TRAFFIC CONTROL
 PHASE III DETAIL

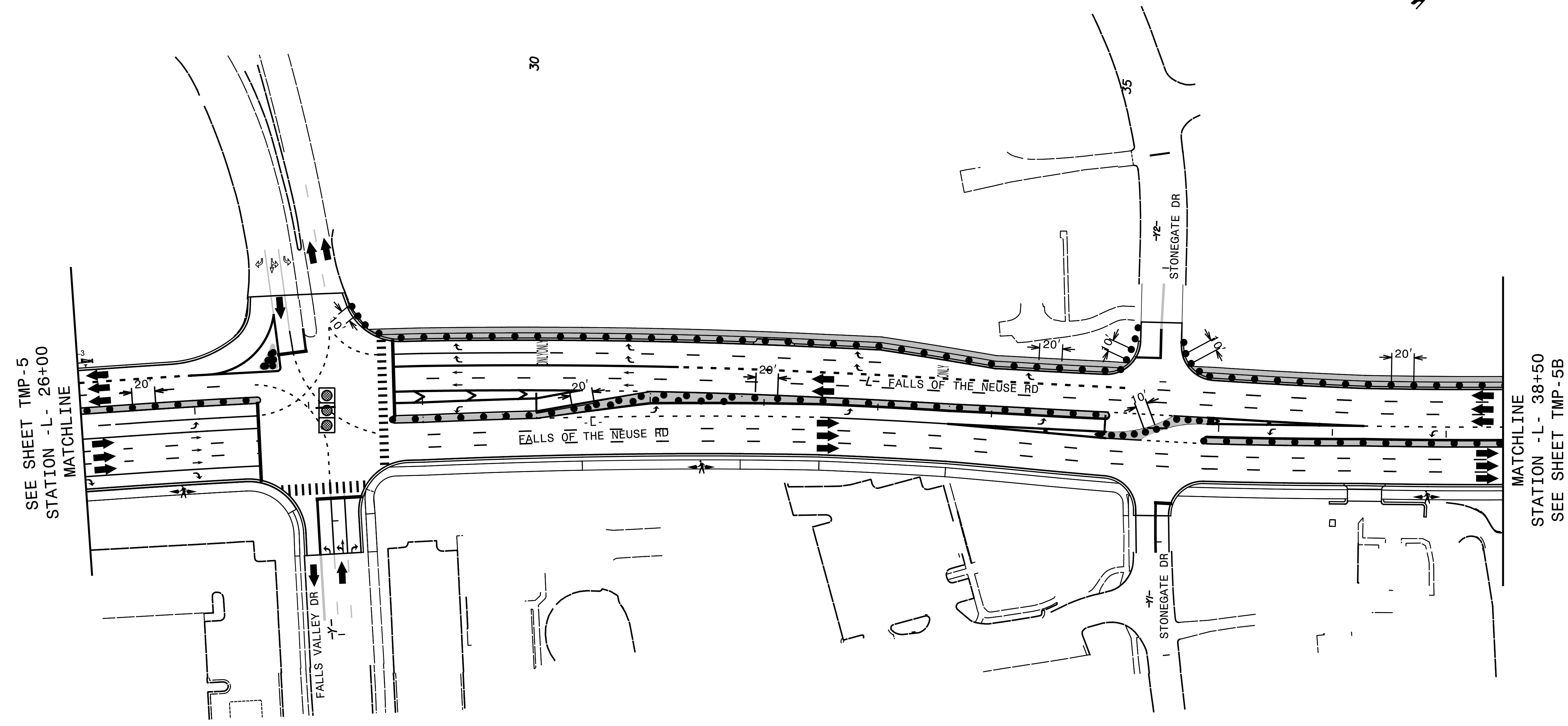
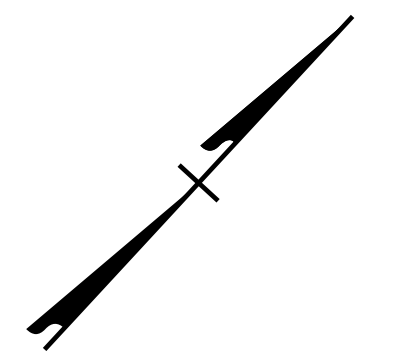

SEE SHEET TMP-5
STATION -L- 26+00
MATCHLINE

MATCHLINE
STATION -L- 38+50
SEE SHEET TMP-5B

4/6/2021
 X:\2015\TRIS\030.00 U-5826 Falls of Neuse\Traffic\TCP\TCP-U-5826 TMP-5A.dgn
 jbauman

SEPI
 1 Glenwood Avenue
 Raleigh, NC 27603
 Tel: 919.789.9977
 Fax: 919.789.9591
 License: C-2197

APPROVED: _____
 DATE: _____

SEAL

**DOCUMENT NOT CONSIDERED FINAL
UNLESS ALL SIGNATURES COMPLETED**

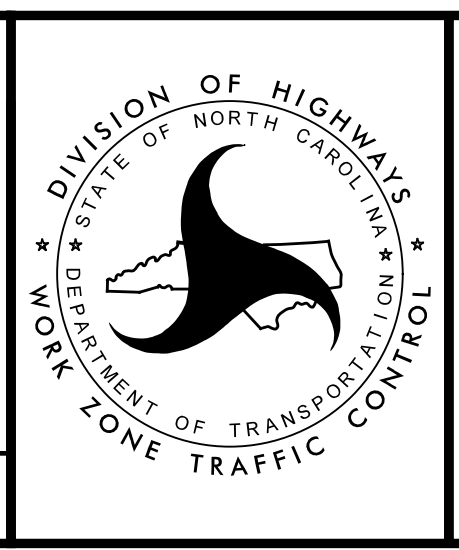

**TEMPORARY
TRAFFIC CONTROL
PHASE III DETAIL**

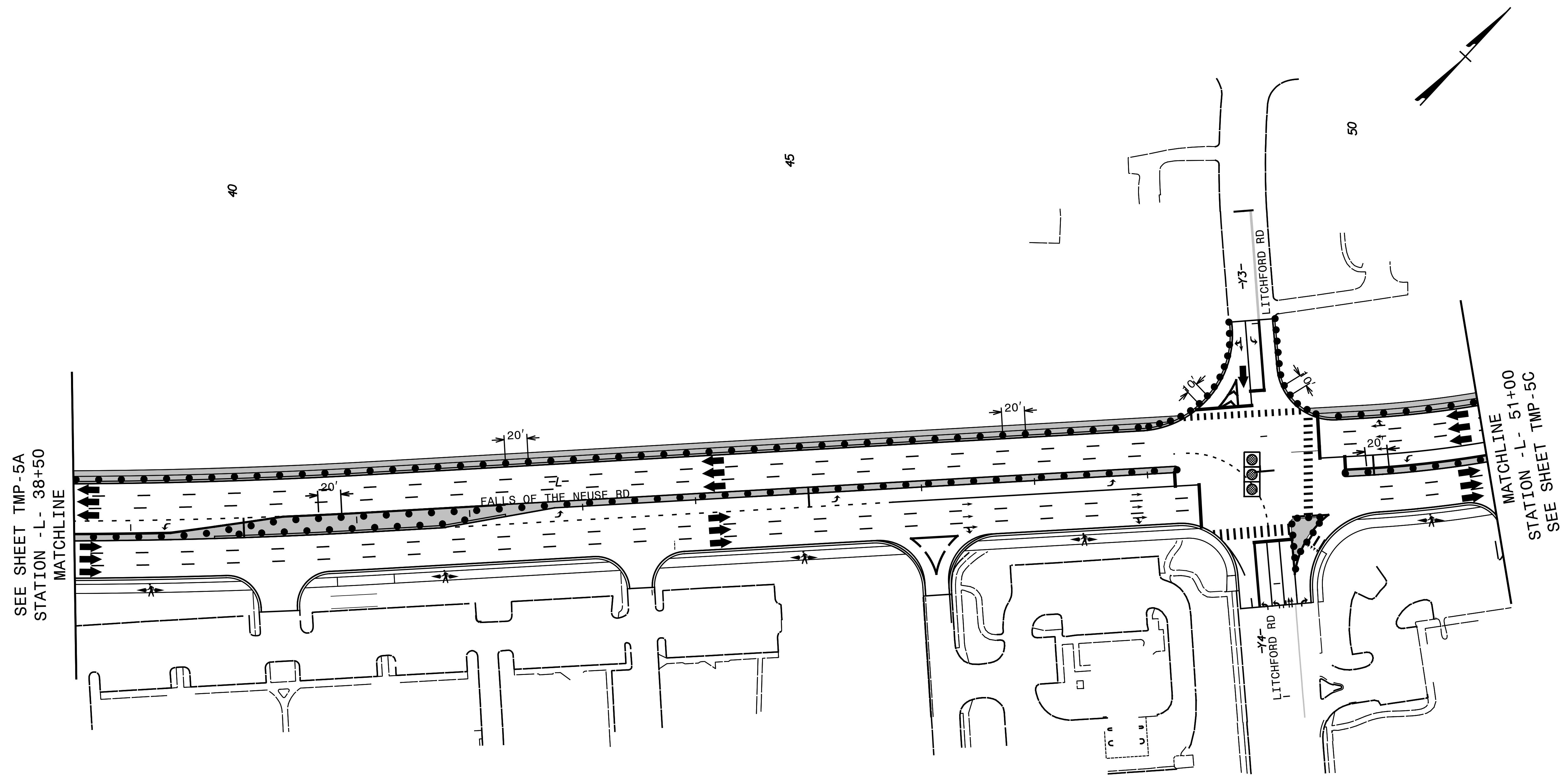

SEE SHEET TMP-5A
STATION -L- 38+50
MATCHLINE

MATCHLINE
STATION -L- 51+00
SEE SHEET TMP-5C

4/6/2021
X:\2015\TRIS\030.00 U-5826 Falls of Neuse\Traffic\TCP\TCP\U-5826 TMP-5B.dgn
JBauman

SEPI
1 Glenwood Avenue
Raleigh, NC 27603
Tel: 919.789.9977
Fax: 919.789.9591
License: C-2197

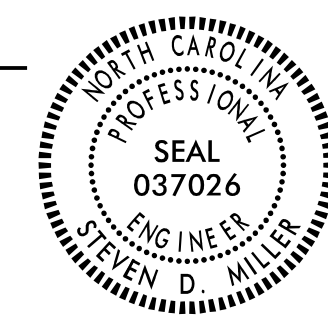
APPROVED: _____
DATE: _____
SEAL

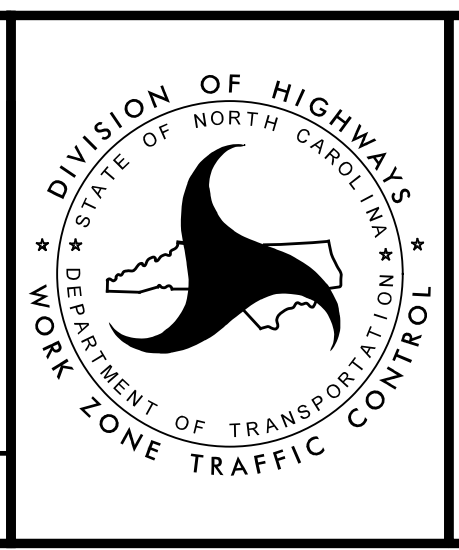
**DOCUMENT NOT CONSIDERED FINAL
UNLESS ALL SIGNATURES COMPLETED**

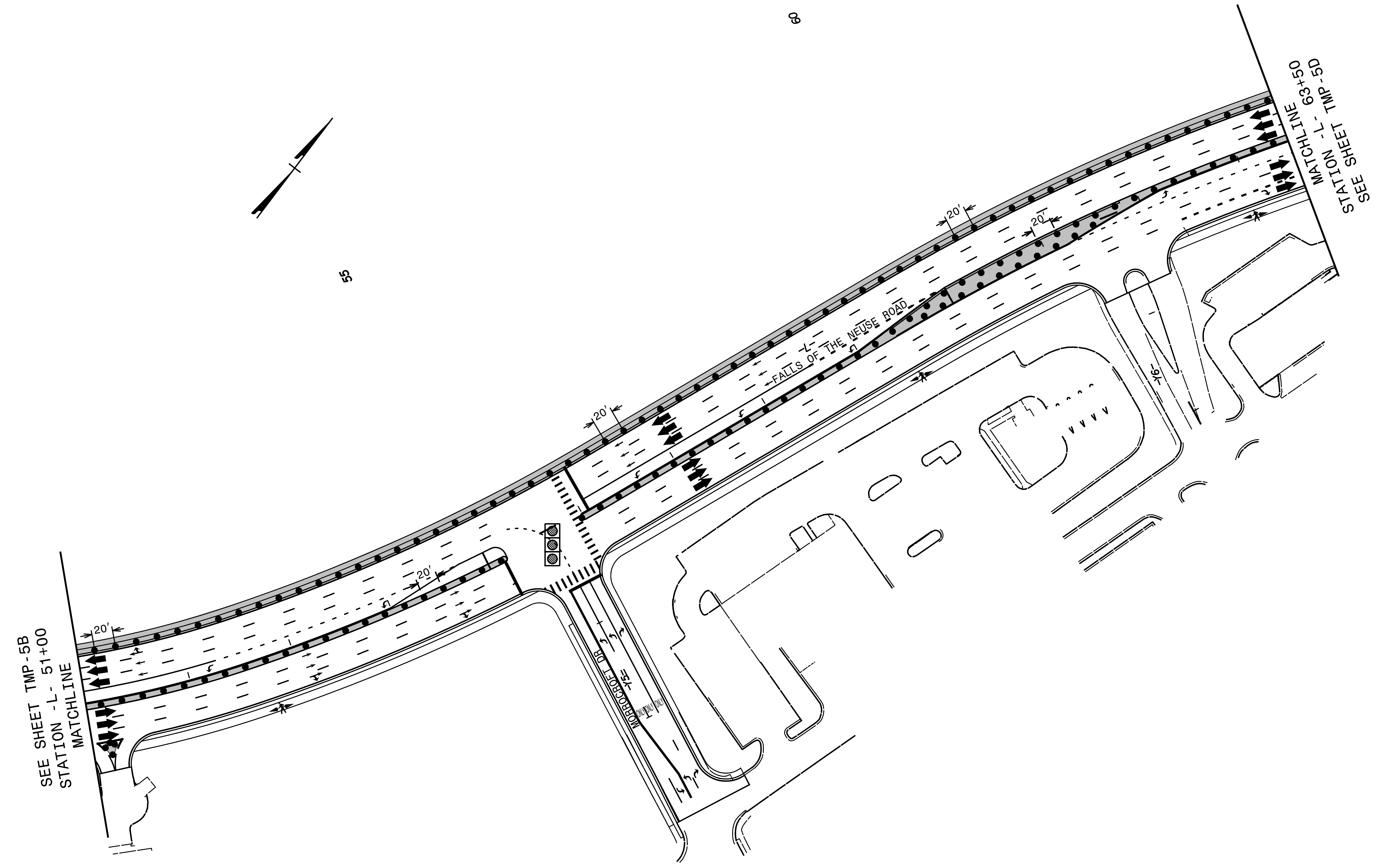

**TEMPORARY
TRAFFIC CONTROL
PHASE III DETAIL**



4/6/2021
 X:\2015\TRIS\030.00 U-5826 Falls of Neuse\Traffic\TCP\U-5826 TMP-5C.dgn
 jbauman

SEPI
 1 Glenwood Avenue
 Raleigh, NC 27603
 Tel: 919.789.9977
 Fax: 919.789.9591
 License: C-2197

APPROVED: _____
 DATE: _____
 SEAL
**DOCUMENT NOT CONSIDERED FINAL
 UNLESS ALL SIGNATURES COMPLETED**



**TEMPORARY
 TRAFFIC CONTROL
 PHASE III DETAIL**

