

UTILITIES BY OTHERS

NOTE:  
CITY OF RALEIGH FIBER/ ITS TO BE TRANSFERRED TO  
NEW POLE LINE PRIOR TO THE DATE OF AVAILABILITY.

NOTE:  
ALL PROPOSED UTILITY WORK SHOWN ON THIS  
SHEET WILL BE DONE BY OTHERS. NO  
PAYMENT WILL BE MADE TO THE CONTRACTOR  
FOR PROPOSED UTILITY WORK SHOWN ON THIS  
SHEET.

SEPTIC DRAIN FIELD LOCATION IS APPROXIMATE.  
THE CONTRACTOR SHALL FIELD LOCATE DRAIN FIELD LINES  
WITHIN THE EASEMENT AND PROTECT THEM FROM DAMAGE.

PROPOSED BURIED AT&T LINE  
DOMINION ENERGY, VERIZON  
BUSINESS/ MCI, CHARTER/ SPECTRUM  
& AT&T JOINT AERIAL LINE

DOMINION ENERGY TO RELOCATE  
8" STEEL GAS MAIN UNDER/AROUND  
PROPOSED DRAIN PIPE

DUKE ENERGY TO TIE INTO  
EXISTING U/G POWER LINE

DOMINION ENERGY EXISTING  
GAS LINE TO REMAIN

PROPOSED DUKE ENERGY,  
VERIZON BUSINESS/ MCI,  
CHARTER/ SPECTRUM  
& AT&T JOINT AERIAL LINE

MATCHLINE -L- 52 +00.00  
SEE SHEET UO-04

MATCHLINE -L- 66 +00.00  
SEE SHEET UO-06

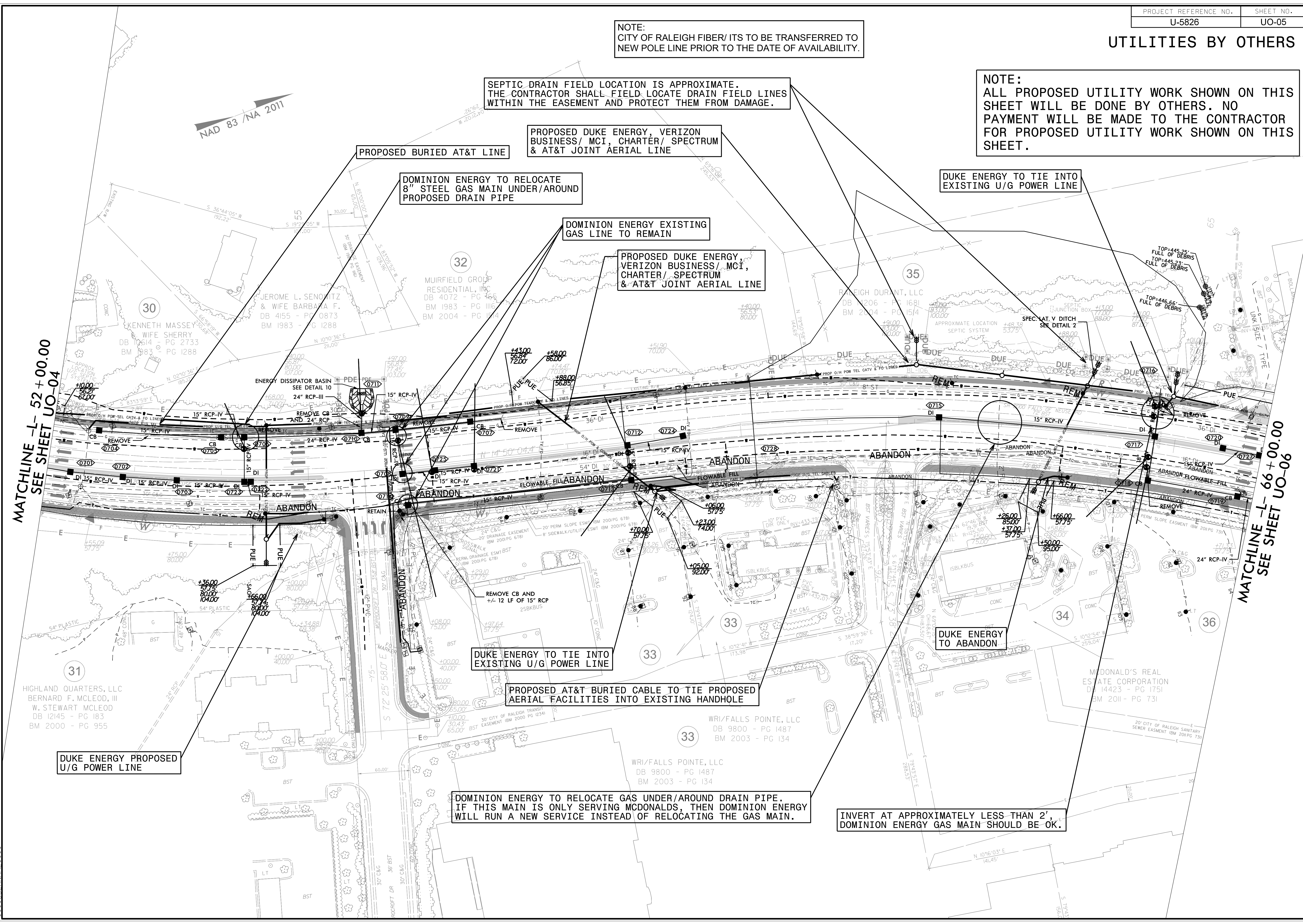

DUKE ENERGY TO TIE INTO  
EXISTING U/G POWER LINE

PROPOSED AT&T BURIED CABLE TO TIE PROPOSED  
AERIAL FACILITIES INTO EXISTING HANDHOLE

DUKE ENERGY  
TO ABANDON

DOMINION ENERGY TO RELOCATE GAS UNDER/AROUND DRAIN PIPE.  
IF THIS MAIN IS ONLY SERVING MCDONALDS, THEN DOMINION ENERGY  
WILL RUN A NEW SERVICE INSTEAD OF RELOCATING THE GAS MAIN.

INVERT AT APPROXIMATELY LESS THAN 2',  
DOMINION ENERGY GAS MAIN SHOULD BE OK.

DUKE ENERGY PROPOSED  
U/G POWER LINE

10-MAY-2022 15:36  
 M:\2013\213335\03 NCDOT U-5826 Falls of the Neuse Rd\Utilities\210\_005\_U-5826.ut\_rdy05-U005-pah.dgn  
 8/17/99