

PROJECT REFERENCE NO.	SHEET NO.
U-5826	EC-12/CONST.06
RW SHEET NO.	
ROADWAY DESIGN ENGINEER	HYDRAULICS ENGINEER

FINAL GRADING
EROSION CONTROL FOR
CONSTRUCTION SHEET 06

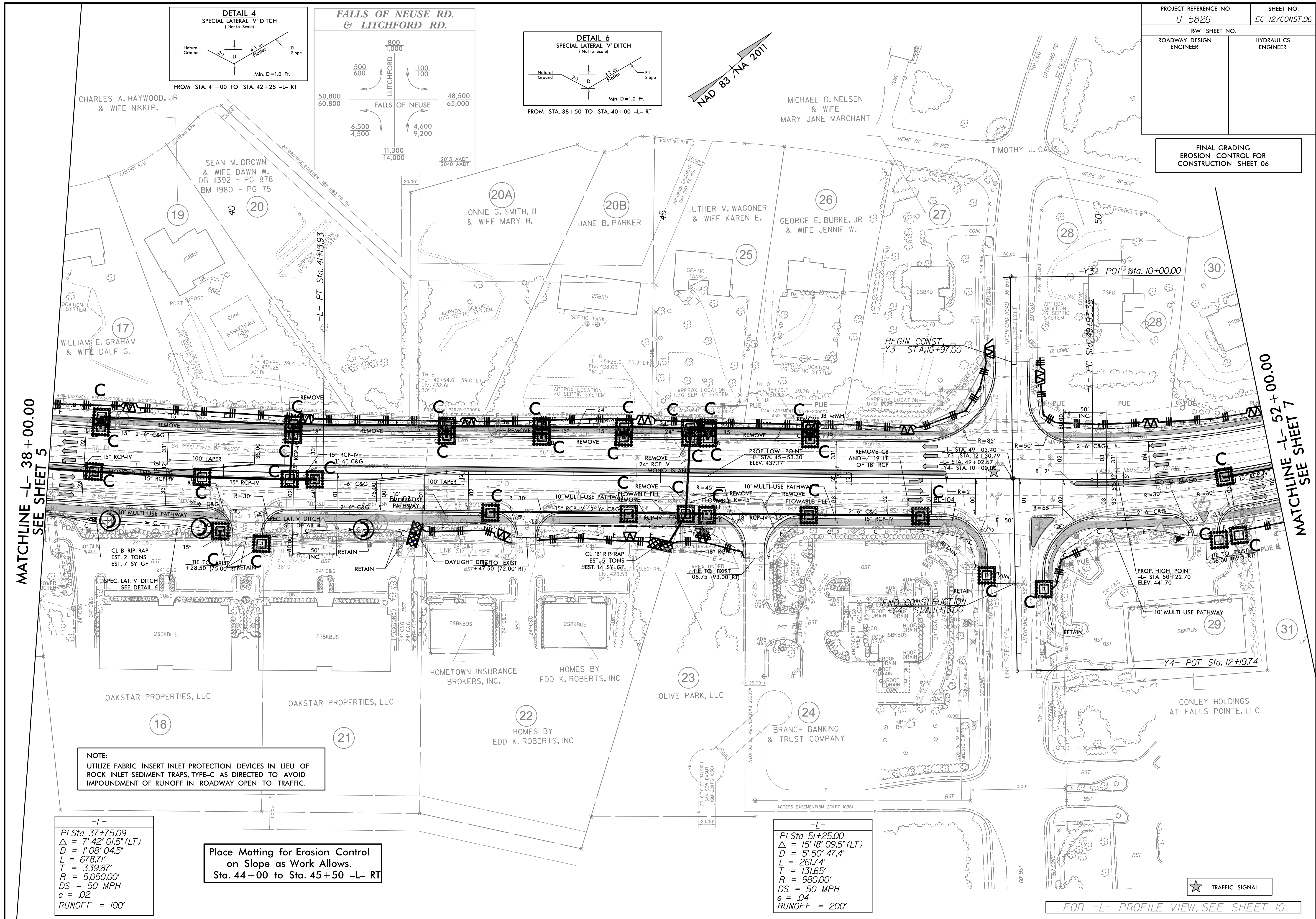
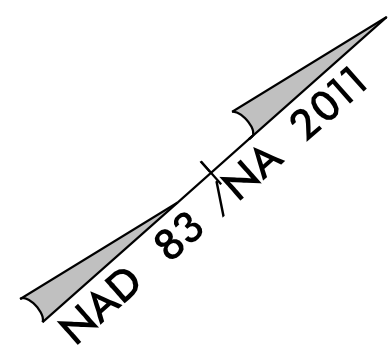
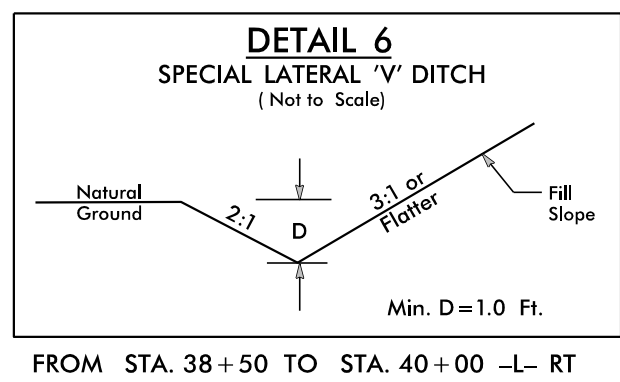
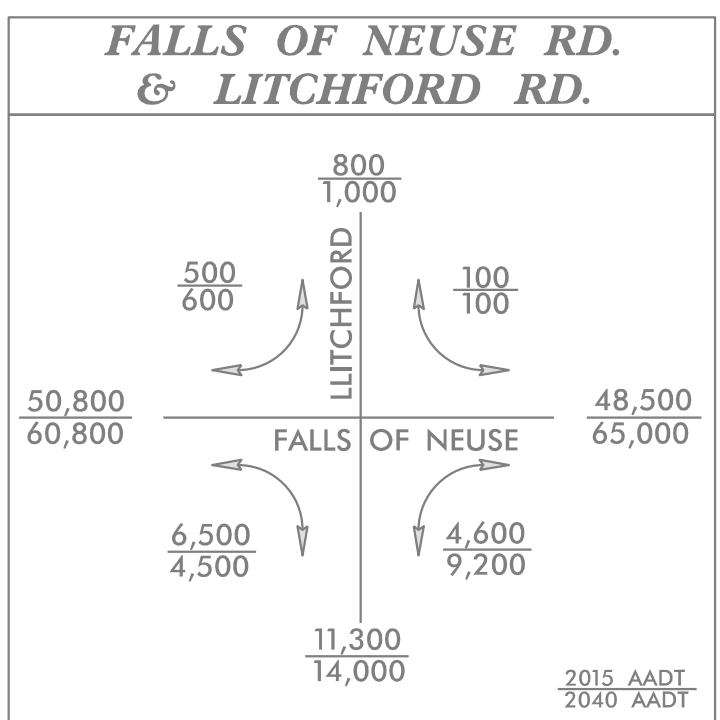
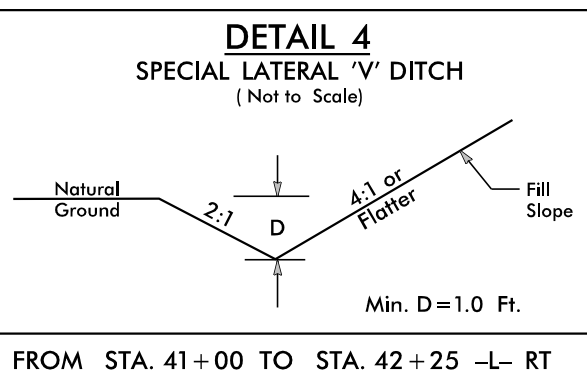

MATCHLINE -L- 38+00.00
SEE SHEET 5

MATCHLINE -L- 52+00.00
SEE SHEET 7

NOTE:
UTILIZE FABRIC INSERT INLET PROTECTION DEVICES IN LIEU OF
ROCK INLET SEDIMENT TRAPS, TYPE-C AS DIRECTED TO AVOID
IMPOUNDMENT OF RUNOFF IN ROADWAY OPEN TO TRAFFIC.

-L-
PI Sta 37+75.09
 $\Delta = 7' 42'' 01.5'' (LT)$
 $D = 1' 08'' 04.5''$
 $L = 678.71'$
 $T = 339.87'$
 $R = 5,050.00'$
 $DS = 50 MPH$
 $e = .02$
RUNOFF = 100'

Place Matting for Erosion Control
on Slope as Work Allows.
Sta. 44+00 to Sta. 45+50 -L- RT

-L-
PI Sta 51+25.00
 $\Delta = 15' 18'' 09.5'' (LT)$
 $D = 5' 50'' 47.4''$
 $L = 261.74'$
 $T = 131.65'$
 $R = 980.00'$
 $DS = 50 MPH$
 $e = .04$
RUNOFF = 200'

FOR -L- PROFILE VIEW, SEE SHEET 10

