

USE FOR LIGHTING CONSTRUCTION ONLY

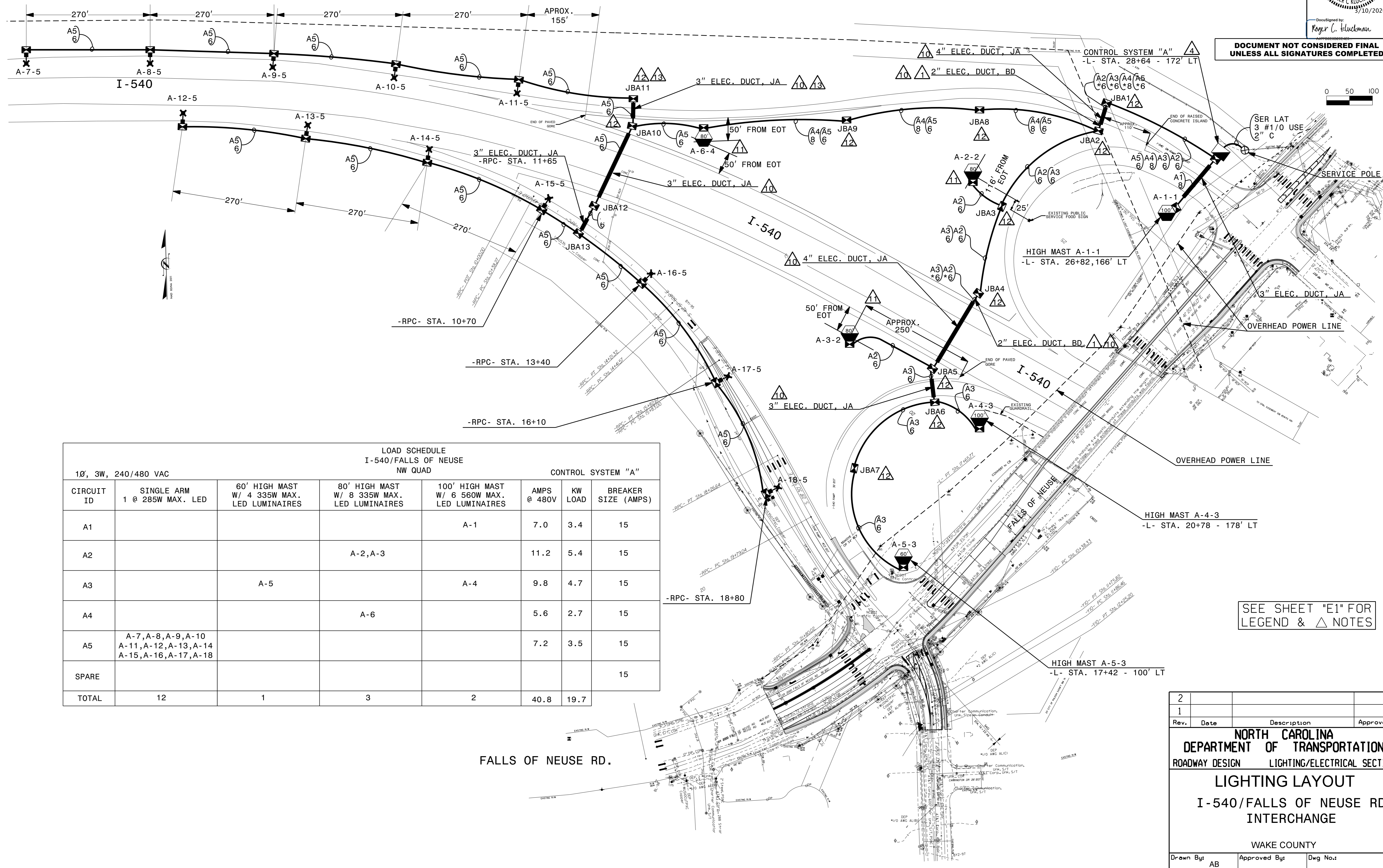

Documented by:
Roger C. Blackman

DOCUMENT NOT CONSIDERED FINAL
UNLESS ALL SIGNATURES COMPLETED



LOAD SCHEDULE I-540/FALLS OF NEUSE NW QUAD							
1Ø, 3W, 240/480 VAC				CONTROL SYSTEM "A"			
CIRCUIT ID	SINGLE ARM 1 @ 285W MAX. LED	60' HIGH MAST W/ 4 335W MAX. LED LUMINAIRES	80' HIGH MAST W/ 8 335W MAX. LED LUMINAIRES	100' HIGH MAST W/ 6 560W MAX. LED LUMINAIRES	AMPS @ 480V	KW LOAD	BREAKER SIZE (AMPS)
A1				A-1	7.0	3.4	15
A2			A-2, A-3		11.2	5.4	15
A3		A-5		A-4	9.8	4.7	15
A4			A-6		5.6	2.7	15
A5	A-7, A-8, A-9, A-10 A-11, A-12, A-13, A-14 A-15, A-16, A-17, A-18				7.2	3.5	15
SPARE							15
TOTAL	12	1	3	2	40.8	19.7	

SEE SHEET "E1" FOR
LEGEND & △ NOTES

2			
1			
Rev.	Date	Description	Approved
NORTH CAROLINA DEPARTMENT OF TRANSPORTATION ROADWAY DESIGN LIGHTING/ELECTRICAL SECTION LIGHTING LAYOUT I-540/FALLS OF NEUSE RD INTERCHANGE WAKE COUNTY			
Drawn By:	AB	Approved By:	Dwg No.:

09-MAR-2020 15:40
U-5826-1-01-02.dgn
labrown1 A1 RD-301554