

PROJECT REFERENCE NO.	SHEET NO.
U-5826	RW02C-3
Location and Surveys	
ESP ASSOCIATES, INC 2200 GATEWAY CENTRE BLVD, SUITE 216 MORRISVILLE, NC 27560	

SURVEY CONTROL SHEET

W/ EXISTING CENTERLINE ALIGNMENTS PRIOR TO CONSTRUCTION

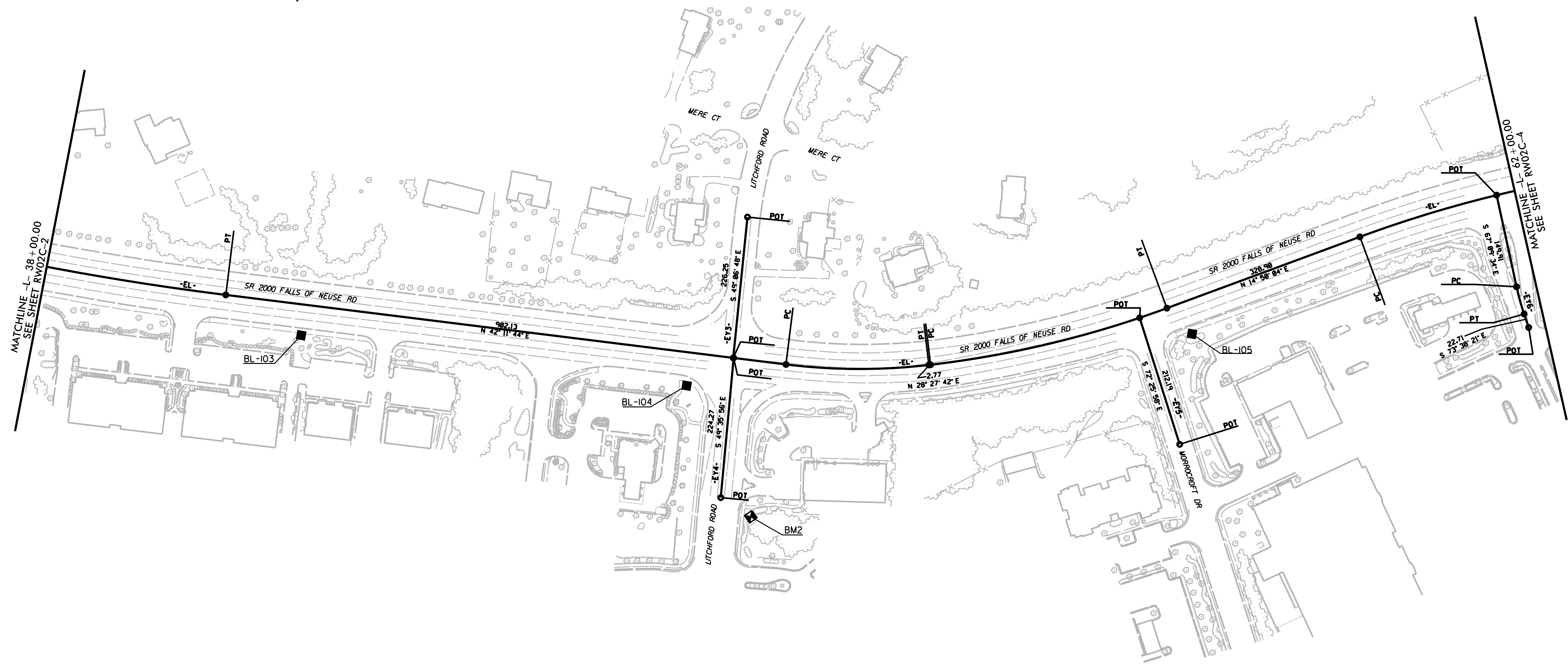
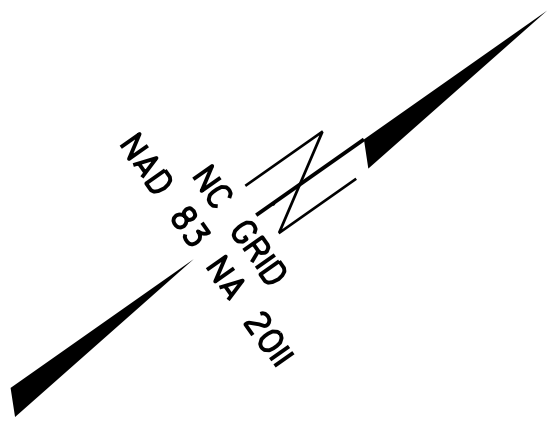

REVISIONS

07-DEC-2018 14:12
 Y:\NC001\2018\U5826-con_esp4-Raleigh\Survey Control Sheets\U5826-1s-RW02C-003.dgn
 ppetrucci AT ESP201517

NOTES:

1. PROJECT CONTROL WAS ESTABLISHED USING GNSS, THE GLOBAL NAVIGATION SATELLITE SYSTEM.
2. THE SURVEY CONTROL DATA FOR THIS PROJECT HAS BEEN COMPILED FROM VARIOUS SOURCES. IF FURTHER INFORMATION REGARDING PROJECT CONTROL IS NEEDED, PLEASE CONTACT THE LOCATION AND SURVEYS UNIT.