

8/17/99

PROJECT REFERENCE NO. U-5826	SHEET NO. 2B-3
RW SHEET NO.	
ROADWAY DESIGN ENGINEER	
DOCUMENT NOT CONSIDERED FINAL UNLESS ALL SIGNATURES COMPLETED	

INTERSECTION DETAIL -L- AND -Y5-

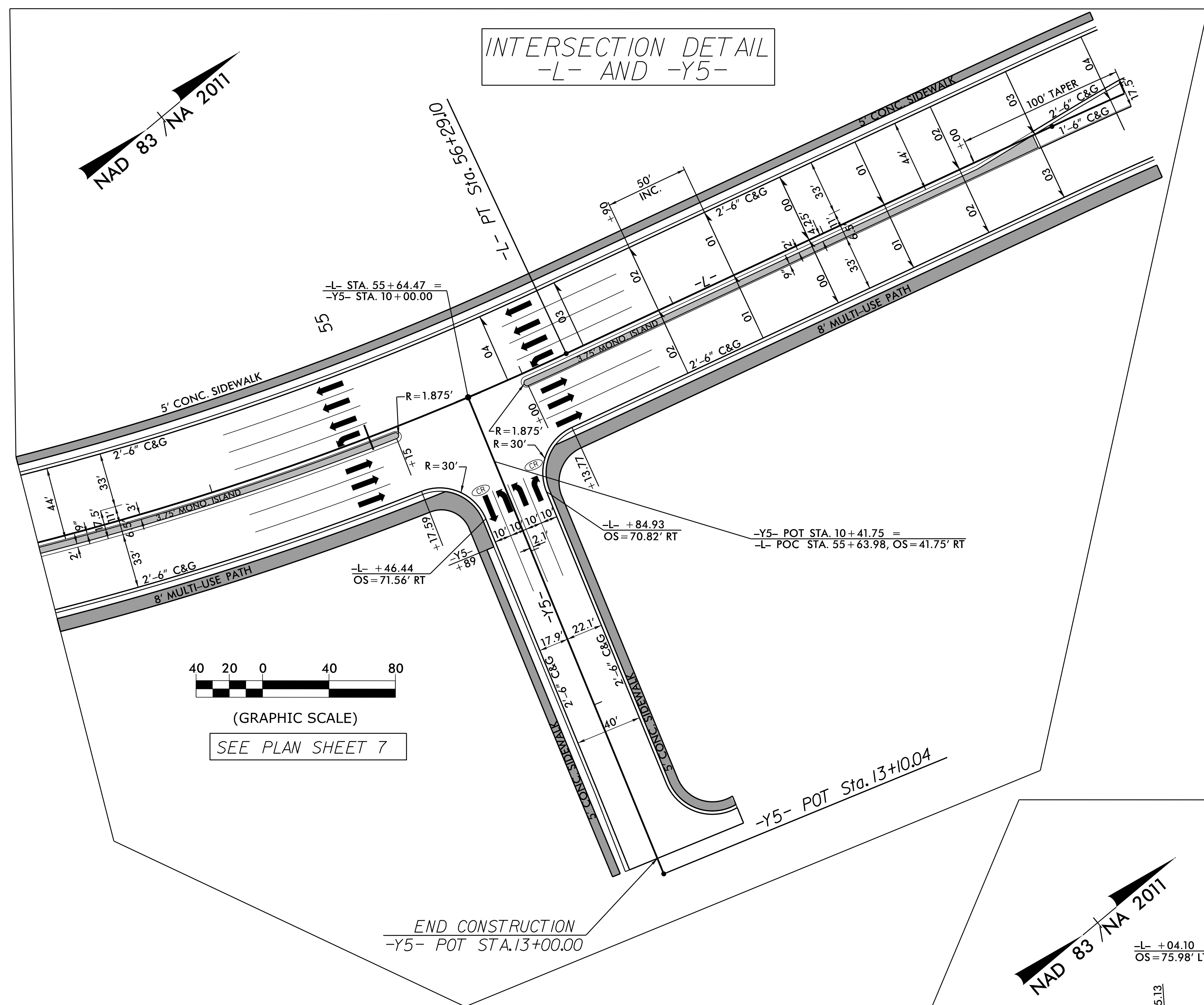

40 20 0 40 80
(GRAPHIC SCALE)
SEE PLAN SHEET 7

END CONSTRUCTION
-Y5- POT STA. 13+00.00

INTERSECTION DETAIL -L-, -Y7-, AND -Y8-

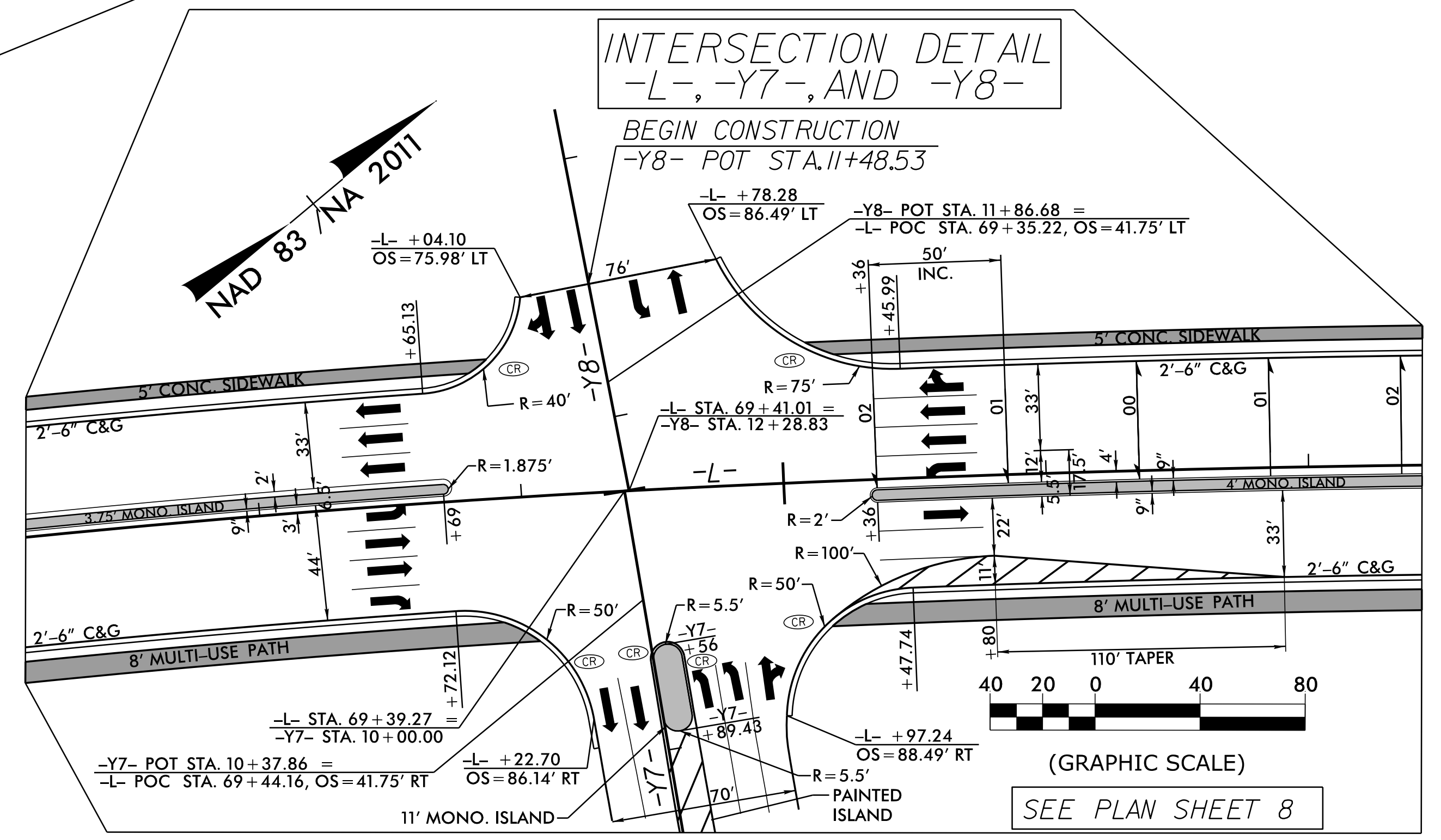

40 20 0 40 80
(GRAPHIC SCALE)
SEE PLAN SHEET 8

REVISIONS

06-FEB-2023 12:49
M:\2013\213395_03 NCDOT U-5826 Falls of the Neuse Rd\Roadway\Pro\U-5826_Rdy-dtl_Intersection.dgn
BRYAN E. HODGE