

NOTES:
 #5 "G" BARS MAY BE SHIFTED SLIGHTLY, AS NECESSARY, TO CLEAR REINFORCING STEEL AND STIRRUPS.
 FOR REINFORCING STEEL IN MEDIAN, SEE CONCRETE MEDIAN DETAILS SHEET.
 FOR SECTION VIEWS, SEE "TYPICAL SECTION DETAILS" SHEET.
 FOR TRANSVERSE CONSTRUCTION JOINT DETAIL, SEE "TYPICAL SECTION DETAILS" SHEET.
 LINK SLAB SAW CUT SHALL EXTEND TO EDGE OF DECK.
 FOR LOCATIONS OF TRANSVERSE CONSTRUCTION JOINTS, SEE "SUPERSTRUCTURE BILL OF MATERIAL" SHEET.

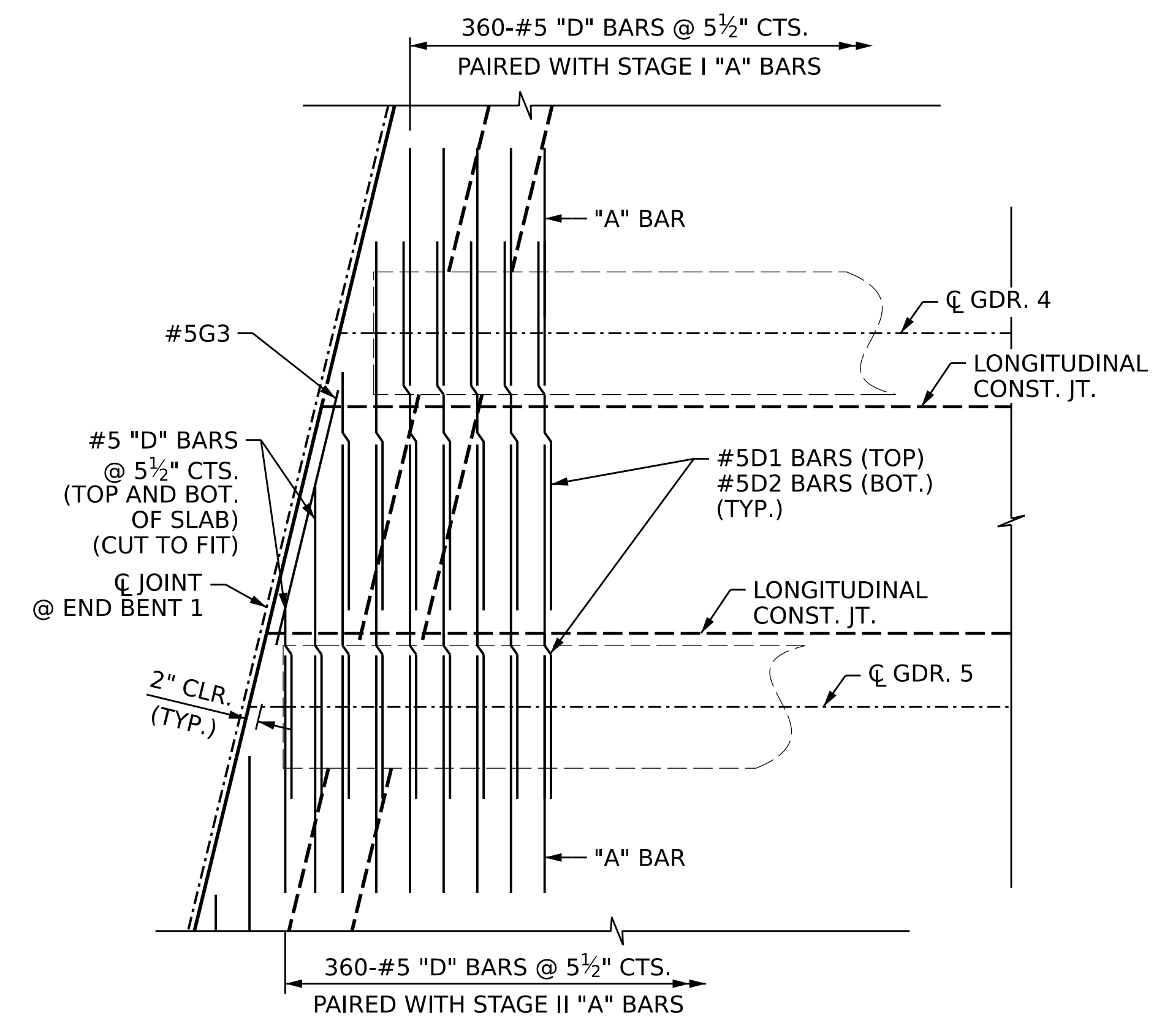

DECK REINFORCEMENT

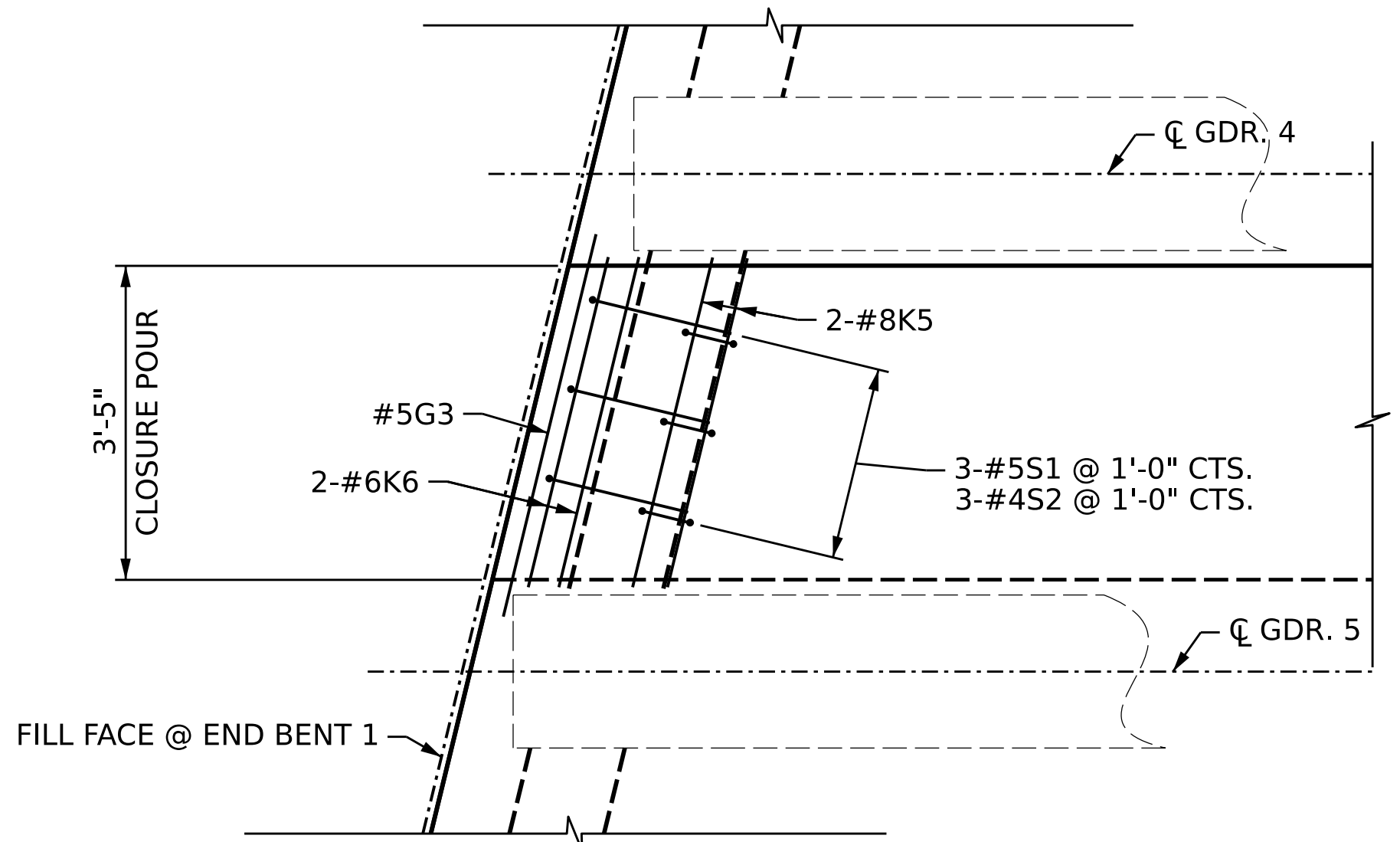

END BENT DIAPHRAGM
(TYP. BAY 4)

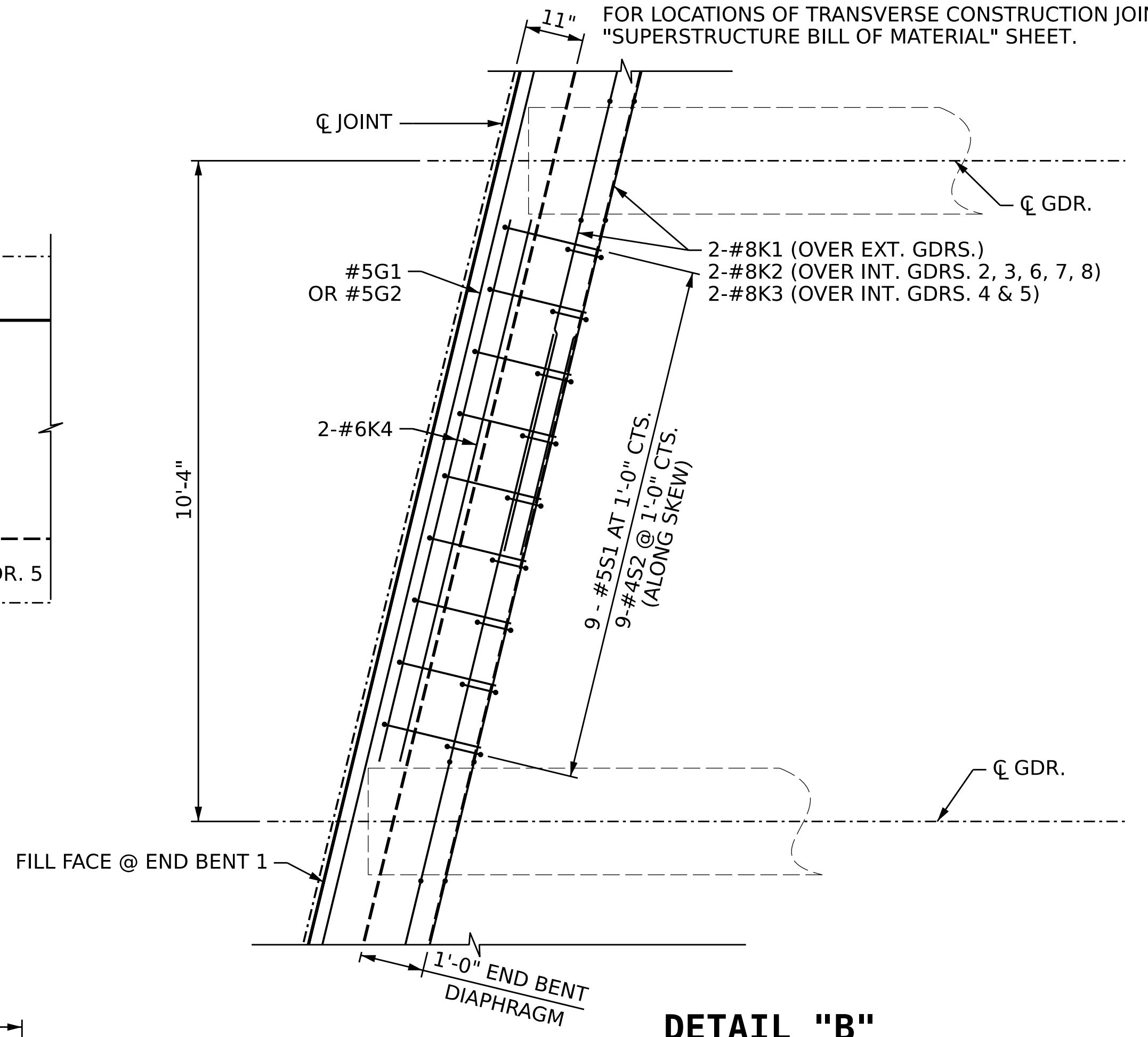

DETAIL "B"
(TYP. BAYS 1-3 & 5-8)

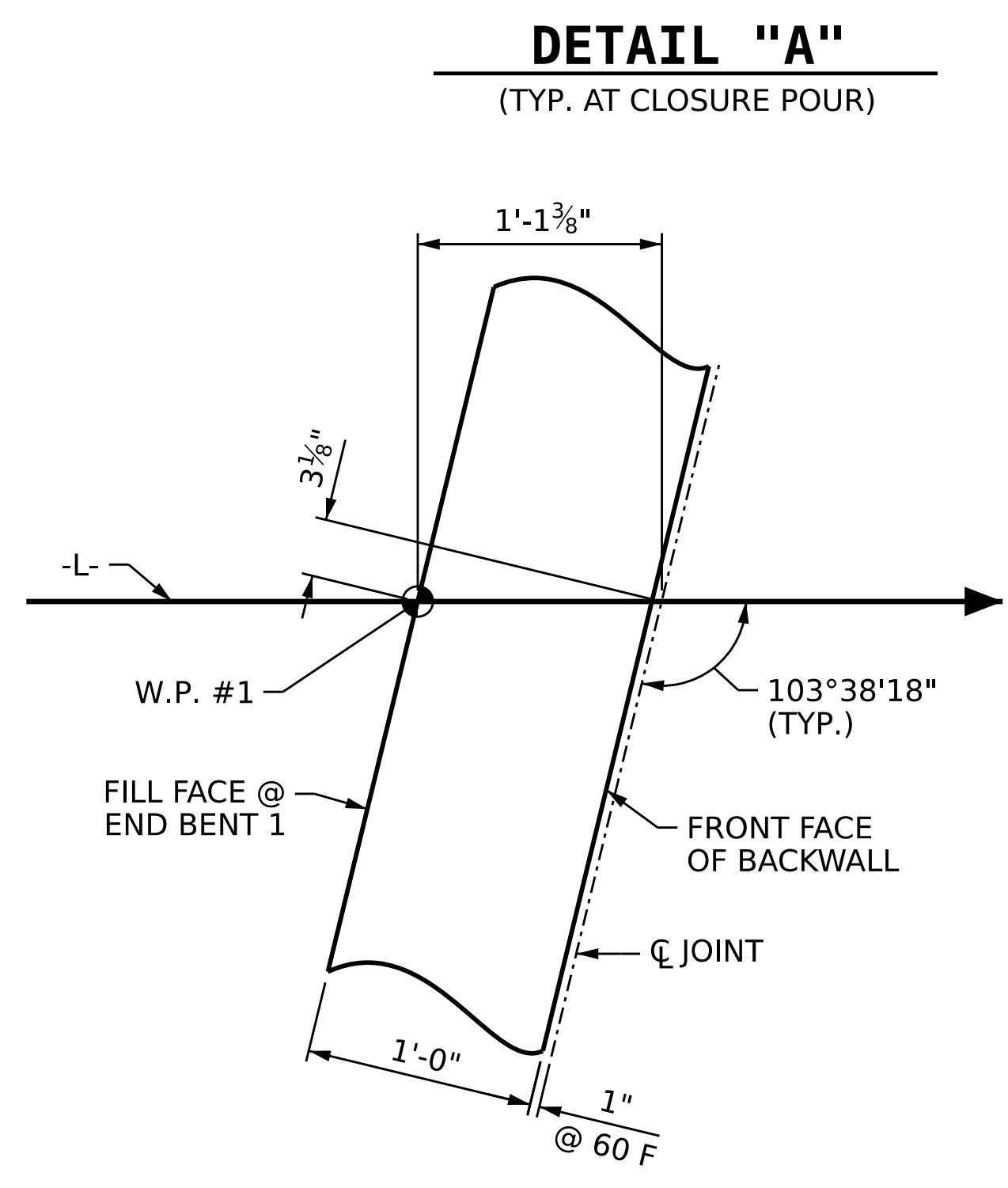

DETAIL "A"
(TYP. AT CLOSURE POUR)

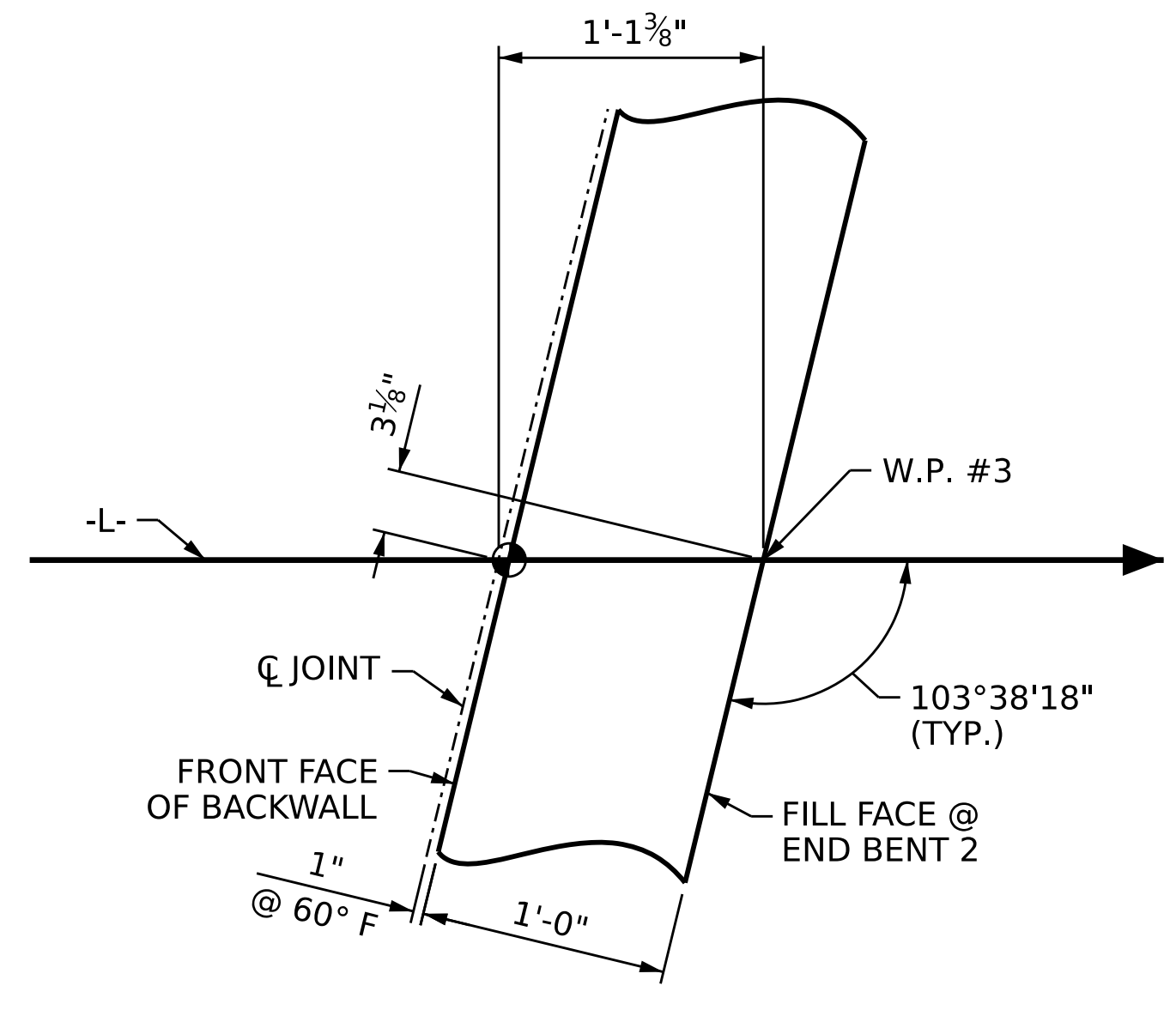

DETAIL "D"

DETAIL "C"

PROJECT NO. BR-0043
ROCKINGHAM COUNTY
 STATION: POT 25+80.88 -L-
 SHEET 5 OF 5

AECOM
AECOM TECHNICAL SERVICES OF NC, INC.
 5430 WADE PARK BOULEVARD, SUITE 200
 RALEIGH, NC 27607
 (919) 854-6200 www.aecom.com
 AECOM License No. F02642

SEAL
 030474
 ENGINEER
 JOHN C. MORRISON

DocuSigned by:
 John C. Morrison 1/31/2023
A2FDE142C82F448

STATE OF NORTH CAROLINA DEPARTMENT OF TRANSPORTATION RALEIGH					
SUPERSTRUCTURE					
PLAN OF SPAN DETAILS					
REVISIONS					
NO.	BY:	DATE:	NO.	BY:	DATE:
1			3		
2			4		
SHEET NO.					S-15
TOTAL SHEETS					45

DRAWN BY:	M.L. CATER	DATE:	11/2022
CHECKED BY:	J.C. MORRISON	DATE:	11/2022
DESIGN ENGINEER OF RECORD:	J.C. MORRISON	DATE:	12/2022

DOCUMENT NOT CONSIDERED
 FINAL UNLESS ALL
 SIGNATURES COMPLETED