

SPAN A - STAGE II
FOR NOTES, SEE SHEET 5 OF 5

** = DOWELS SHALL BE PLACED IN THE SAME HORIZONTAL PLANE AS THE TOP AND BOTTOM REINFORCING STEEL ("A" BARS).

PROJECT NO. BR-0043
ROCKINGHAM COUNTY
 STATION: POT 25+80.88 -L-
 SHEET 3 OF 5

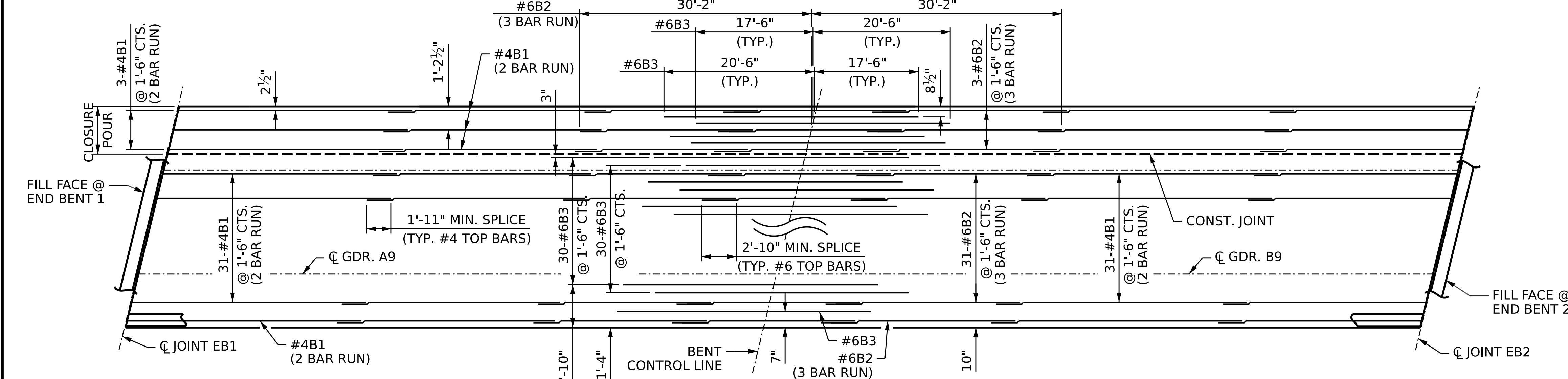

TOP REINFORCING STEEL LAYOUT
SHOWING "B" BARS IN TOP OF SLAB
(NOT DRAWN TO SCALE)

AECOM
AECOM TECHNICAL SERVICES OF NC, INC.
 5430 WADE PARK BOULEVARD, SUITE 200
 RALEIGH, NC 27607
 (919) 854-0200 www.aecom.com
 AECOM License No. F02642

DocuSigned by:
John C. Morrison 1/31/2023
AZFD8142C82F44B...

STATE OF NORTH CAROLINA
 DEPARTMENT OF TRANSPORTATION
 RALEIGH

SUPERSTRUCTURE
PLAN OF SPAN A
 STAGE II

REVISIONS					
NO.	BY:	DATE:	NO.	BY:	DATE:
1			3		
2			4		

SHEET NO. **S-13**
 TOTAL SHEETS 45

DRAWN BY: M.L. CATER DATE: 11/2022
 CHECKED BY: J.C. MORRISON DATE: 11/2022
 DESIGN ENGINEER OF RECORD: J.C. MORRISON DATE: 12/2022

DOCUMENT NOT CONSIDERED
 FINAL UNLESS ALL
 SIGNATURES COMPLETED