

TYPICAL SECTION AT LINK SLAB

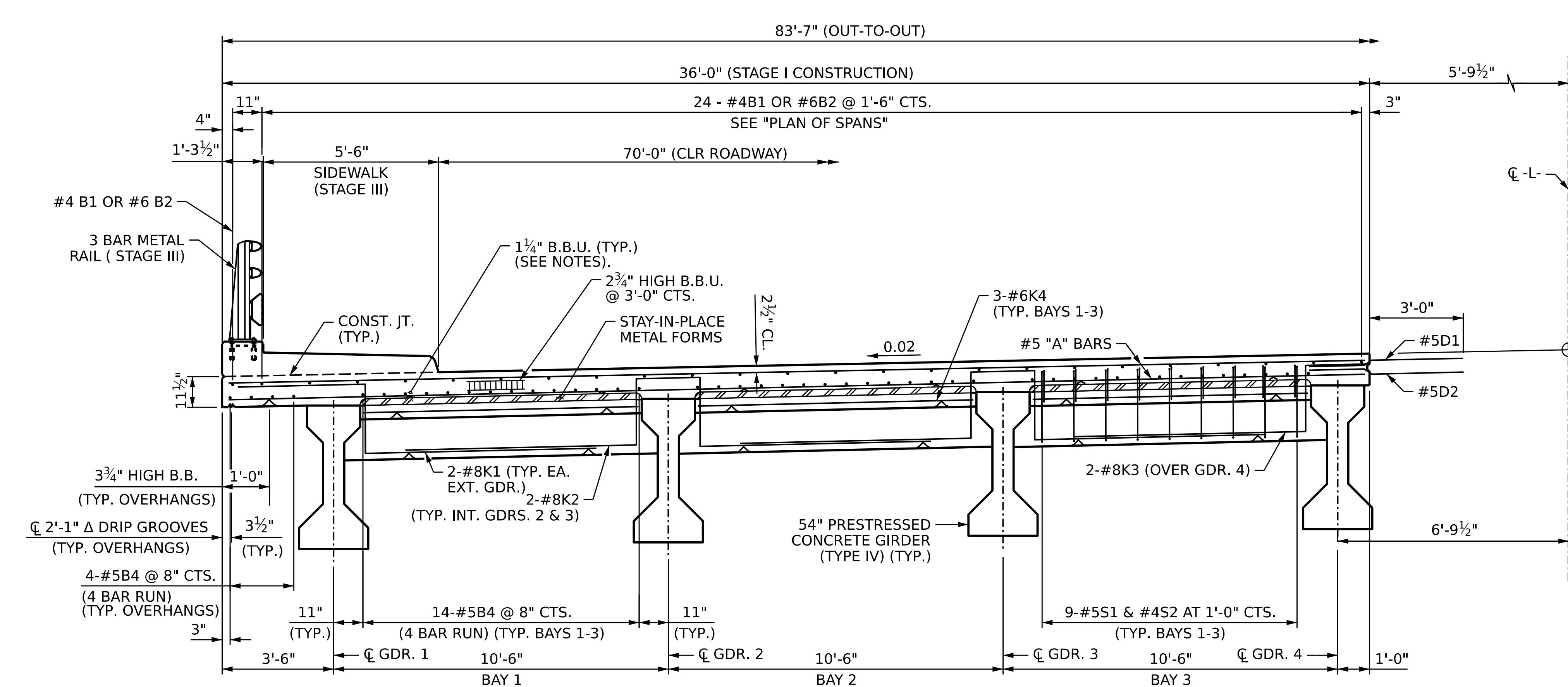

TYPICAL SECTION

SECTION SHOWN AT END BENT, SIMILAR AT MIDSPAN

- NOTES**
- PROVIDE 1 1/4" HIGH BEAM BOLSTERS UPPER AT 4'-0" CTS. ATOP THE METAL STAY IN PLACE FORMS TO SUPPORT THE BOTTOM MAT OF "A" BARS. WHEN USING REMOVABLE FORMS. PROVIDE CONTINUOUS HIGH CHAIRS FOR METAL DECK (CHCM) AT 4'-0" CTS. WITH A HEIGHT TO SUPPORT THE BOTTOM MAT OF "A" BARS A CLEAR DISTANCE OF 2 1/2" ABOVE THE TOP OF THE REMOVABLE FORM.
 - LONGITUDINAL STEEL MAY BE SHIFTED SLIGHTLY, AS NECESSARY, TO AVOID INTERFERENCE WITH STIRRUPS IN PRESTRESSED CONCRETE GIRDERS.
 - PREVIOUSLY CAST CONCRETE IN A CONTINUOUS UNIT SHALL HAVE ATTAINED A MINIMUM COMPRESSIVE STRENGTH OF 3,000 PSI BEFORE ADDITIONAL CONCRETE IS CAST IN THE UNIT.
 - BARRIER RAIL OR SIDEWALK IN A CONTINUOUS UNIT SHALL NOT BE CAST UNTIL ALL SLAB CONCRETE IN THAT UNIT HAS BEEN CAST AND HAS REACHED A MINIMUM COMPRESSIVE STRENGTH OF 3,000 PSI.
 - DOWELS SHALL BE PLACED IN THE SAME HORIZONTAL PLANE AS THE TOP AND BOTTOM SLAB REINFORCING STEEL.
 - SEE CONSTRUCTION SEQUENCE SHEETS FOR LOCATION OF TEMPORARY PORTABLE CONCRETE BARRIER (ANCHORED)
 - FOR SIDEWALK, MEDIAN AND 3 BAR METAL RAIL, SEE DETAIL SHEETS.
 - THE JOINT IN THE DECK SHALL BE SAWED PRIOR TO CASTING OF SIDEWALK

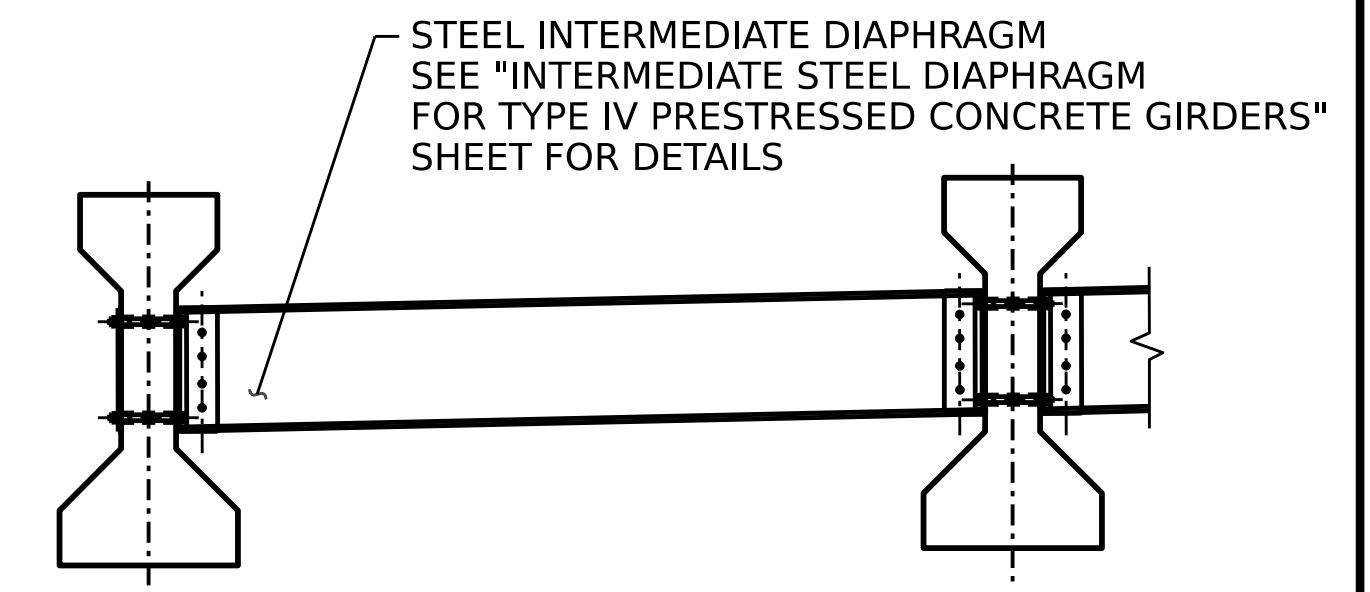

EXTERIOR GIRDER INTERIOR GIRDER

PART TYPICAL SECTION (SHOWING INTERMEDIATE STEEL DIAPHRAGMS)

"B" BAR KEY

- = NON-CONTINUOUS BAR RUN FOR NEGATIVE MOMENT REGIONS. SEE "PLAN OF SPANS" SHEET
- = CONTINUOUS BAR RUN SEE "PLAN OF SPANS" SHEET

PROJECT NO. BR-0041
ROCKINGHAM COUNTY
 STATION: POT 34+73.00 -L-
 SHEET 1 OF 3

AECOM
AECOM TECHNICAL SERVICES OF NC, INC.
 5430 WADE PARK BOULEVARD, SUITE 200
 RALEIGH, NC 27607
 (919) 854-6200 www.aecom.com
 AECOM License No. F0242

SEAL
STATE OF NORTH CAROLINA
 PROFESSIONAL ENGINEER
 DANIEL DRUM
 2/19/2023

STATE OF NORTH CAROLINA DEPARTMENT OF TRANSPORTATION RALEIGH					
SUPERSTRUCTURE TYPICAL SECTION STAGE I AND PART STAGE III					
REVISIONS					
NO.	BY:	DATE:	NO.	BY:	DATE:
1			3		
2			4		
					SHEET NO. S-09
					TOTAL SHEETS 48

DRAWN BY : M.L. CATER	DATE : 10/2022
CHECKED BY : G.R. COLS	DATE : 10/2022
DESIGN ENGINEER OF RECORD : G. COLS	DATE : 12/2022

DOCUMENT NOT CONSIDERED
 FINAL UNLESS ALL
 SIGNATURES COMPLETED