

2/7/2023 11:19:12 AM P:\Raleigh\Projects\2018\Division 7 (SEAN)\7B7R142 Guilford 225 (Rehobeth Ch Rd over I-85 Bus)\Structures\Drawings\Final\7B7R142_SMJ_GD_400225.dgn

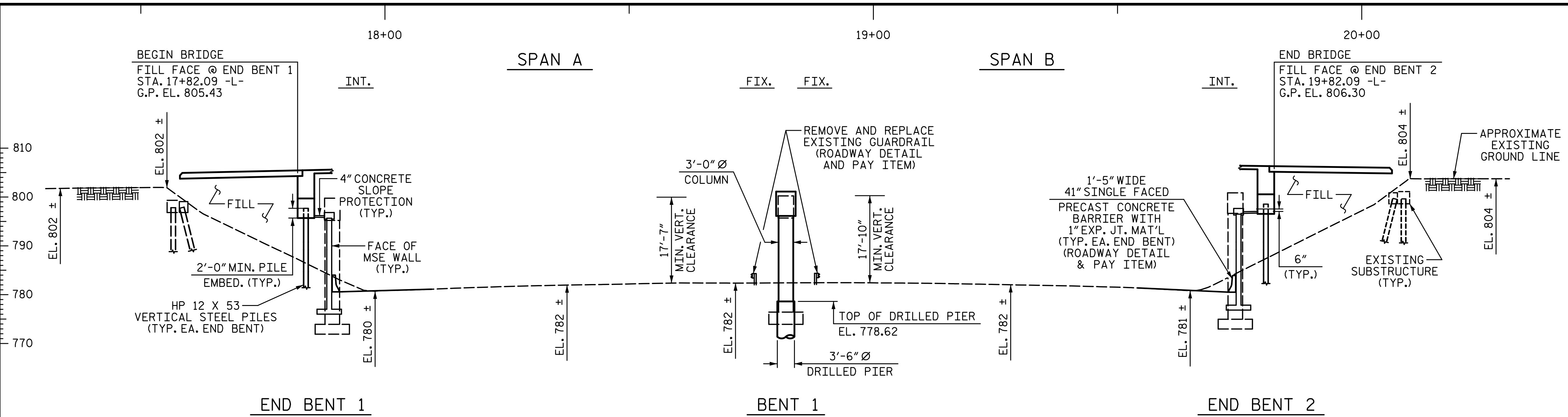

(+3.4714%	(-1.5573%
PVI STA. 18+50.00 EL. = 808.40 VC = 310'	
GRADE DATA -L-	

PMVC 1	PMVC 2
STA. 18+48.05 -L- OFFSET 43.78' LT. BOTTOM OF GDR. EL. 800.01	STA. 18+90.37 -L- OFFSET 43.78' LT. BOTTOM OF GDR. EL. 800.28
STA. 15+01.09 -Y- OFFSET 20.00' LT. EL. 782.42	STA. 14+89.33 -Y- OFFSET 20.0' RT. EL. 782.39
PMVC = POINT OF MINIMUM VERTICAL CLEARANCE	

HORIZONTAL CURVE DATA	
PI STA. 18+52.99 -L-	Δ = 13°-04'-00.0" (LT.)
D = 1°-56'-32.0"	L = 672.77'
T = 337.85'	R = 2950.00'

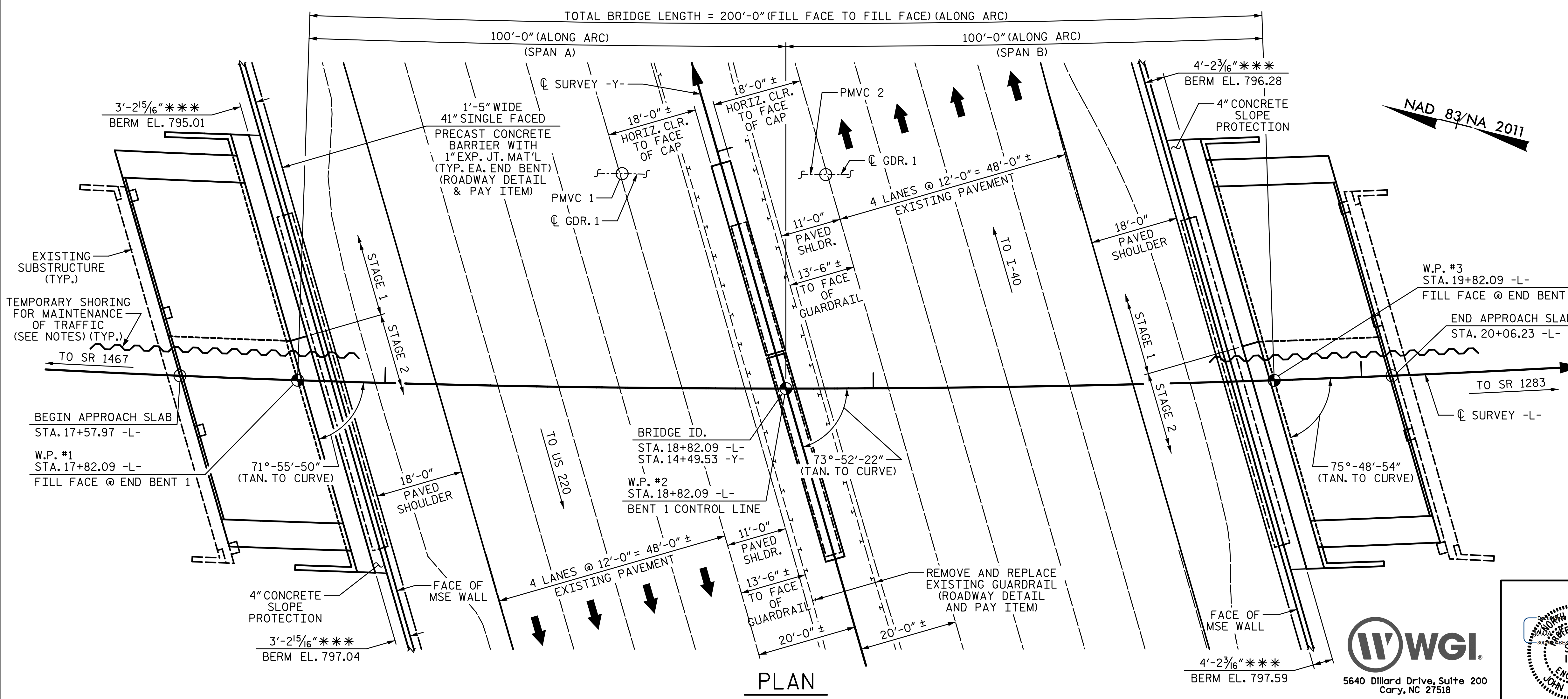

PROJECT NO. BP7.R006.3
GUILFORD COUNTY
 STATION: 18+82.09 -L-
14+49.53 -Y-
 SHEET 1 OF 6 REPLACES BRIDGE #400225

STATE OF NORTH CAROLINA
 DEPARTMENT OF TRANSPORTATION
 RALEIGH
GENERAL DRAWING
 FOR BRIDGE ON SR 115
 (REHOBETH CHURCH ROAD)
 OVER US 29/70
 BETWEEN SR 1467 AND SR 1283

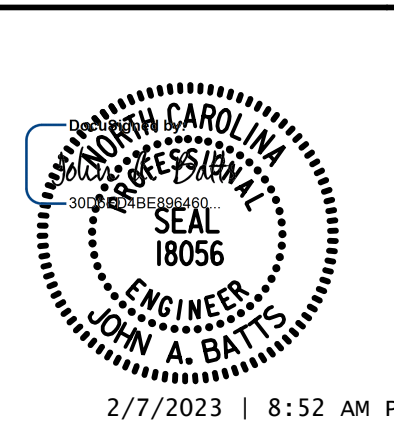

DRAWN BY: S.D. COOPER	DATE: 2-22
CHECKED BY: J.A. BATTS	DATE: 2-22
DESIGN ENGINEER OF RECORD: J.A. BATTS	DATE: 2-22

REVISIONS						SHEET NO.
NO.	BY:	DATE:	NO.	BY:	DATE:	S-2
1			3			TOTAL SHEETS
2			4			58

DOCUMENT NOT CONSIDERED FINAL UNLESS ALL SIGNATURES COMPLETED