

PROJECT: BP7.R006

CONTRACT: C204813

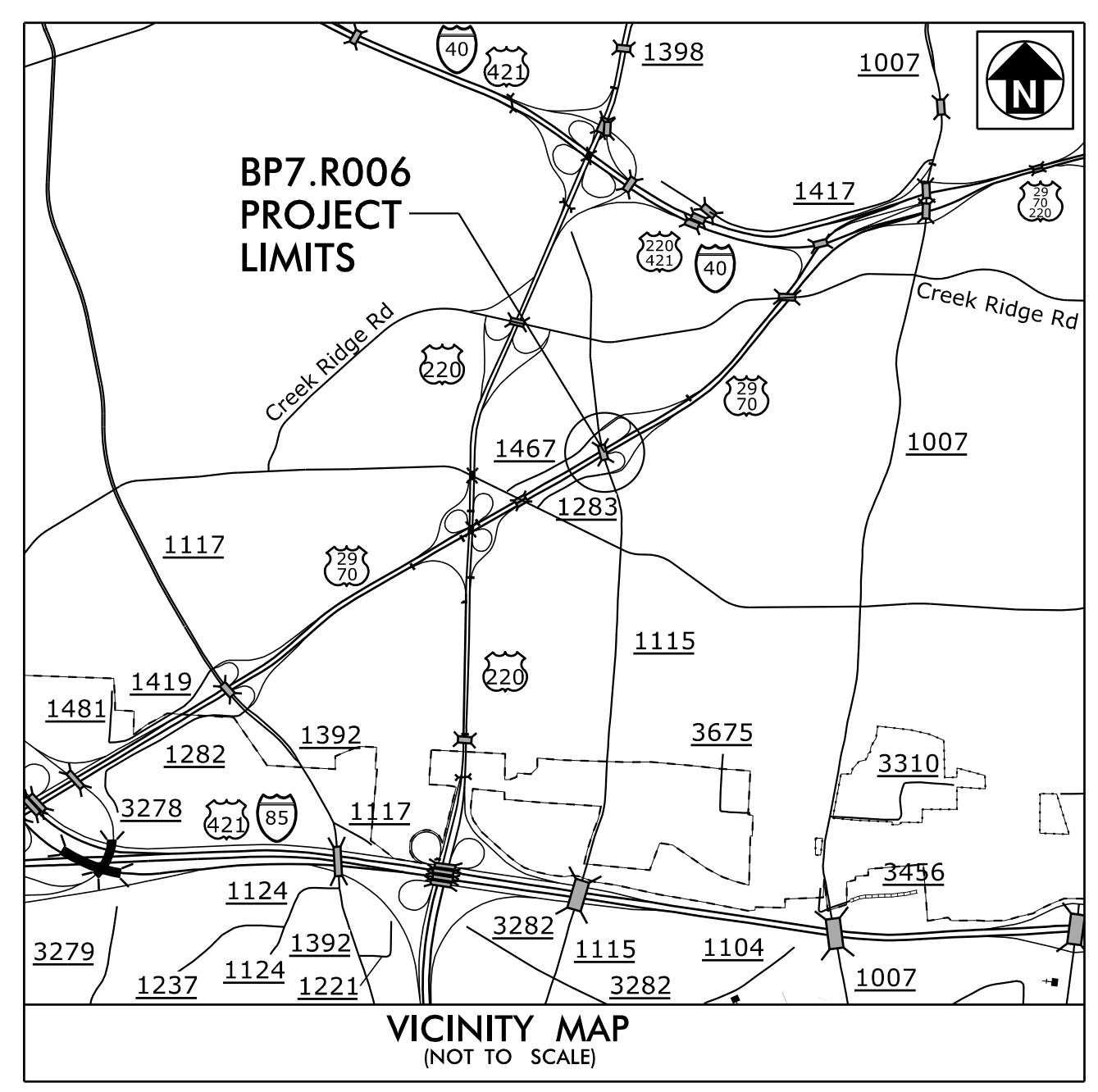

STATE OF NORTH CAROLINA  
DIVISION OF HIGHWAYS  
**GUILFORD COUNTY**

**LOCATION: BRIDGE NO. 225 OVER US 29/70 ON SR 1115  
(REHOBETH CHURCH ROAD) IN GREENSBORO**

**TYPE OF WORK: GRADING, PAVING, DRAINAGE, STRUCTURE,  
RETAINING WALL & SIGNALS**

STATE	STATE PROJECT REFERENCE NO.	SHEET NO.	TOTAL SHEETS
N.C.	BP7.R006	1	
STATE PROJ. NO.	F.A. PROJ. NO.	DESCRIPTION	
BP7.R006.1		PE	
BP7.R006.3		CONSTRUCTION	

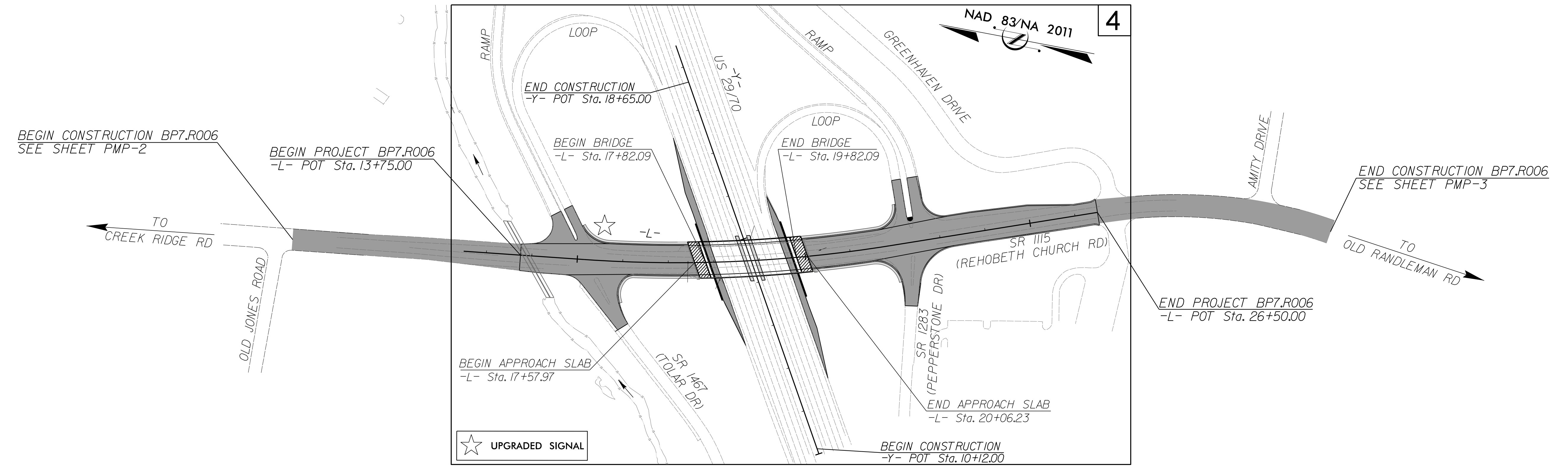

DOCUMENT NOT CONSIDERED FINAL  
UNLESS ALL SIGNATURES COMPLETED

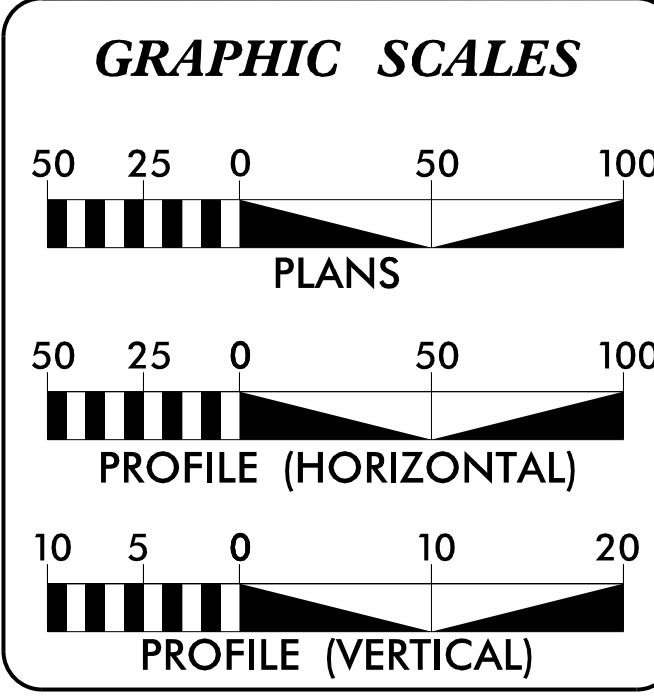

**DESIGN DATA**

ADT (2023)= 7,140  
ADT (2043)= 8,570

V = 35 MPH

FUNC CLASS =  
SUB REGIONAL TIER  
COLLECTOR

**PROJECT LENGTH**

LENGTH ROADWAY PROJECT	=	0.203 MILES
LENGTH STRUCTURE PROJECT	=	0.038 MILES
TOTAL LENGTH PROJECT	=	0.241 MILES

Prepared in the Office of WGI for  
**DIVISION 7**  
NORTH CAROLINA DEPARTMENT OF TRANSPORTATION

2018 STANDARD SPECIFICATIONS

RIGHT OF WAY DATE:  
N/A

LETTING DATE:  
APRIL 18, 2023

NCDOT CONTACT:

DAVID SIMPSON, PE  
PROJECT ENGINEER

REID B. ROBOL, PE  
HYDRAULIC ENGINEER

TIM POWERS, PE  
DIVISION BRIDGE  
PROGRAM MANAGER

**ROADWAY DESIGN ENGINEER**

SEAL 21102  
James Simpson  
SIGNATURE: P.E.

**HYDRAULICS ENGINEER**

SEAL 043870  
Reid B. Robol  
SIGNATURE: P.E.

**PLANS PREPARED BY:**

**WGI**

5640 Dillard Drive  
Suite 200  
Cary, NC 27518  
(919) 852-0468  
(919) 852-0598 (Fax)  
www.wginc.com

LICENSE NO. C-4434

**vhb**

VHB Engineering NC, P.C. (C-3705)  
940 Main Campus Drive, Suite 500  
Raleigh, NC 27606