

09/08/09

PROJECT: BR-0073

See Sheet 1A For Index of Sheets

STATE OF NORTH CAROLINA DIVISION OF HIGHWAYS

| | | | |
|-------|-----------------------------|-----------|--------------|
| STATE | STATE PROJECT REFERENCE NO. | SHEET NO. | TOTAL SHEETS |
| N.C. | BR-0073 | 1 | 5 |

SURVEY CONTROL, EXISTING CENTERLINES, RIGHT OF WAY, EASEMENTS, AND PROPERTY TIES

COLUMBUS COUNTY

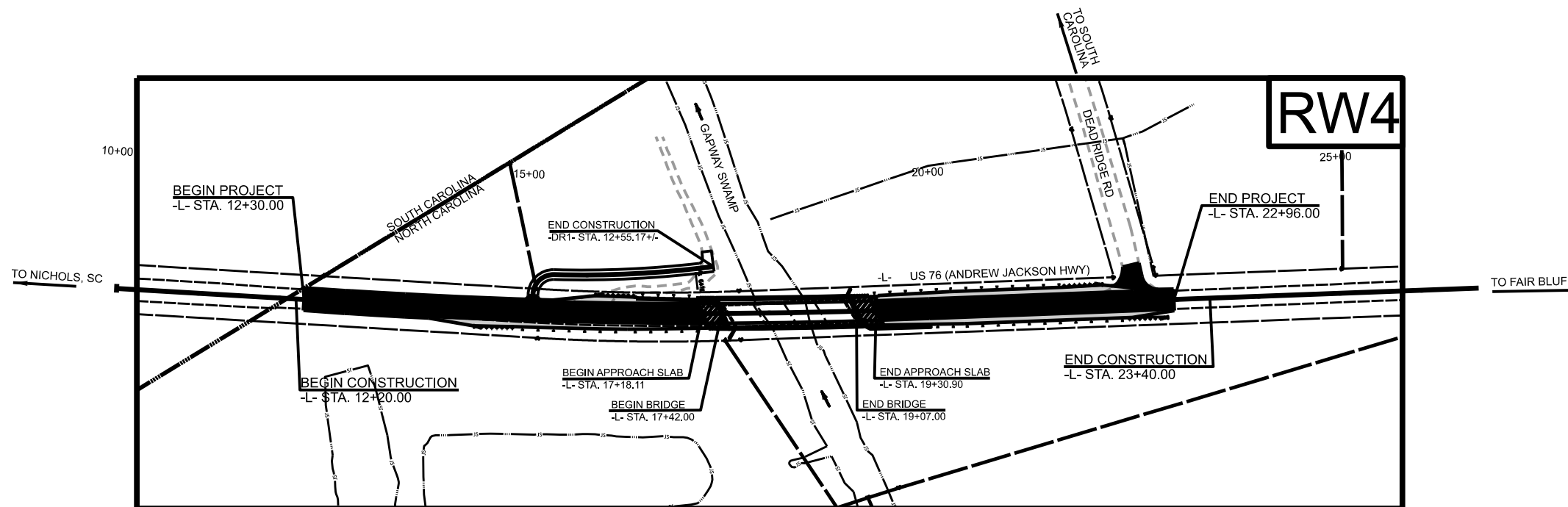
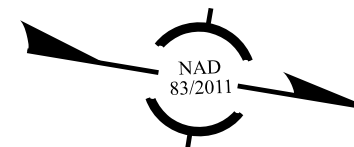
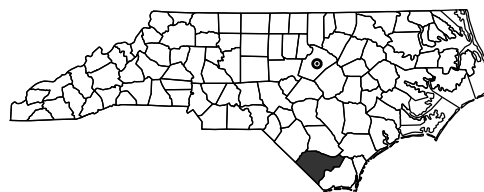
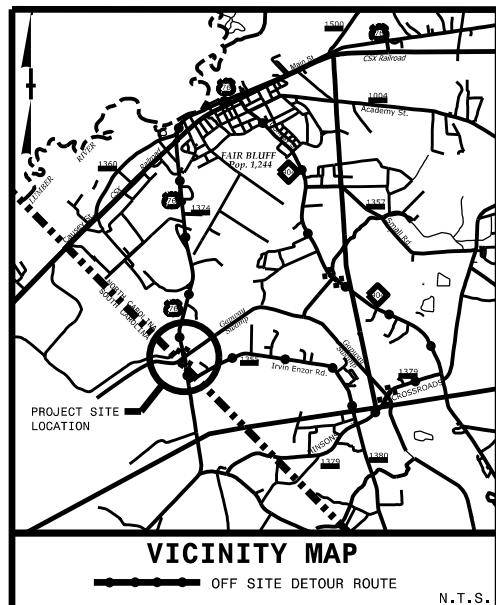

DOCUMENT NOT CONSIDERED FINAL
UNLESS ALL SIGNATURES COMPLETED

GRAPHIC SCALES



DATUM DESCRIPTION

THE LOCALIZED COORDINATE SYSTEM DEVELOPED FOR THIS PROJECT IS BASED ON THE STATE PLANE COORDINATES ESTABLISHED BY NCDOT FOR MONUMENT "BR0073-P7" WITH NAD 83(2011) STATE PLANE GRID COORDINATES OF
 NORTHING: 190062.907(ft) EASTING: 1987616.9722(ft)
 ELEVATION: 70.17(ft)
 THE AVERAGE COMBINED GRID FACTOR USED ON THIS PROJECT (GROUND TO GRID) IS: 1.00001851634
 ALL LINEAR DIMENSIONS ARE LOCALIZED HORIZONTAL DISTANCES
 VERTICAL DATUM USED IS NAVD 88

Prepared in the Office of:

DIVISION 6
 LOCATION & SURVEYS
 4834 US US HWY 301S
 HOPE MILLS, NC 28348

2018 STANDARD SPECIFICATIONS

RIGHT OF WAY DATE:
 01/21/2022

LETTING DATE:
 01/17/2023

PROFESSIONAL LAND SURVEYOR



DocuSigned by:

Keith E. Honeycutt 10/14/2022

09/08/09 DATE:

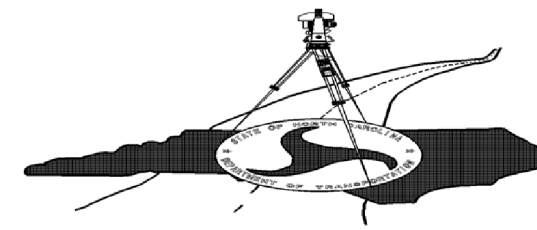

SECONDARY SURVEY CONTROL SHEET

W/EXISTING CENTERLINE ALIGNMENTS PRIOR TO CONSTRUCTION

I, Keith E. Honeycutt, PLS, certify that the Project Control was [performed] under my supervision from an actual GPS survey made under my supervision and the following information was used to perform the survey:

Class of survey: AA
 Type of GPS field procedure: [RTN]
 Dates of survey: March 2020
 Datum/Epoch: NAD83/2011
 Published/Fixed-control use: [N/A]
 Localized around: BR0073-P7
 Northing: 190062.9074
 Easting: 1987616.9722
 Combined grid factor: 1.00001851634
 Geoid model: 12BNC
 Units: US : SURVEY FEET

I also certify that the Baseline Control for this project was completed under my direct and responsible charge from an actual survey made under my supervision; that all horizontal closures had a minimum ratio of precision of 1:20,000 (Class AA) and Vertical accuracy to Class A. Field work was performed in March 2020, and all coordinates are based on NAD 83/2011 and all elevations are based on NAVD 88; that this survey was performed to meet the requirements of 21NCAC 56.1600 as applicable.

This 27th day of September, 2022.
 DocuSigned by:

 8C11B4DAEF3D4DF...
 Professional Land Surveyor L-4169

BR-0073
 R/W RW02G-1
 NORTH CAROLINA DEPARTMENT OF TRANSPORTATION

 PROFESSIONAL LAND SURVEYOR

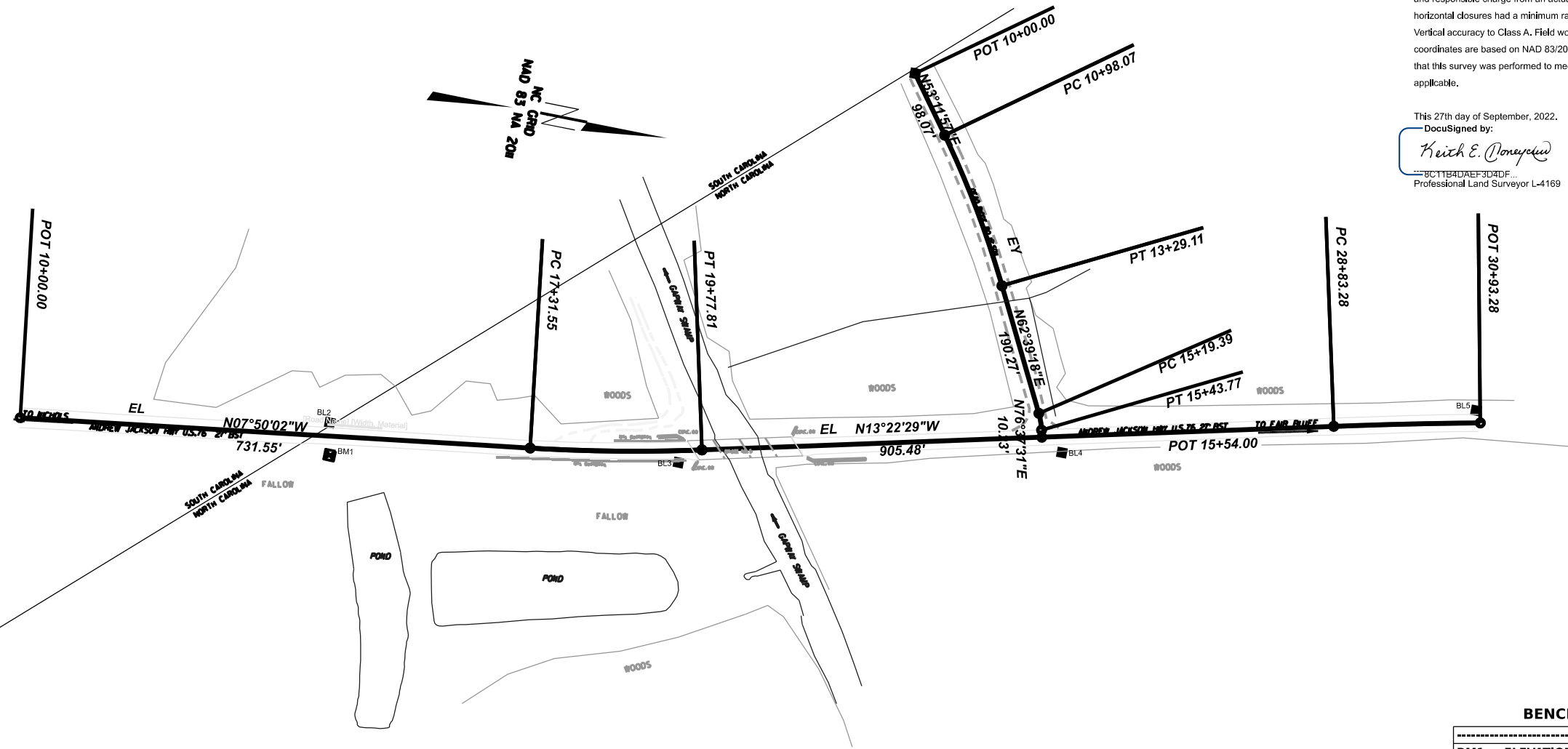
 10/14/2022
 DOCUMENT NOT CONSIDERED FINAL UNLESS ALL SIGNATURES ARE COMPLETED
 2018 STANDARD SPECIFICATIONS



BASELINE

| BL | BR-0073 | BL | NORTHING | EASTING | ELEVATION |
|-----|---------|------|------------|-------------|-----------|
| BL1 | BR-0073 | BL-1 | 190172.223 | 1987583.044 | 70.170 |
| BL2 | BR-0073 | BL-2 | 190771.948 | 1987500.024 | 65.852 |
| BL3 | BR-0073 | BL-3 | 191272.904 | 1987458.676 | 68.233 |
| BL4 | BR-0073 | BL-4 | 191808.800 | 1987337.757 | 65.610 |
| BL5 | BR-0073 | BL-5 | 192378.805 | 1987163.113 | 65.678 |

BENCHMARK

| | |
|--|---------------------------------|
| BM1 | ELEVATION = 67.870 |
| N | 190780.709 E 1987545.718 |
| RR SPIKE IN BASE OF 20\" GUM TREE | |

| EXISTING ALIGNMENT NAME: EL | NORTHING | EASTING | BEARING | DIST | DELTA | D | L | T | R |
|-----------------------------|------------|-------------|--------------|---------|------------------|------------|---------|---------|----------|
| POINT | 190335.687 | 1987579.534 | | | | | | | |
| START | | | N07°50'02\"W | 731.546 | | | | | |
| LINE | | | | | | | | | |
| PC | 191060.406 | 1987479.823 | | | | | | | |
| CURVE | | | | | 05°32'27\" Left | 02°15'00\" | 246.260 | 123.226 | 2546.479 |
| PT | 191302.366 | 1987434.523 | | | | | | | |
| LINE | | | N13°22'29\"W | 905.475 | | | | | |
| PC | 192183.283 | 1987225.070 | | | | | | | |
| CURVE | | | | | 01°34'30\" Right | 00°45'00\" | 210.000 | 105.007 | 7639.437 |

| EXISTING ALIGNMENT NAME: EY | NORTHING | EASTING | BEARING | DIST | DELTA | D | L | T | R |
|-----------------------------|------------|-------------|--------------|---------|------------------|------------|---------|---------|----------|
| POINT | 191496.734 | 1986845.998 | | | | | | | |
| START | | | N53°11'57\"E | 98.065 | | | | | |
| LINE | | | | | | | | | |
| PC | 191555.479 | 1986924.521 | | | | | | | |
| CURVE | | | | | 09°27'21\" Right | 04°05'33\" | 231.047 | 115.786 | 1400.000 |
| PT | 191678.025 | 1987120.082 | | | | | | | |
| LINE | | | N62°39'18\"E | 190.273 | | | | | |
| PC | 191765.427 | 1987289.093 | | | | | | | |
| CURVE | | | | | 13°58'13\" Right | 57°17'45\" | 24.383 | 12.252 | 100.000 |
| PT | 191773.889 | 1987311.896 | | | | | | | |
| LINE | | | N76°37'31\"E | 10.229 | | | | | |
| END | 191776.255 | 1987321.848 | | | | | | | |

TIP PROJECT: BR-0073
 County: Columbus

PREPARED FOR

 LOCATION AND SURVEYS UNIT
 PREPARED BY
 DIVISION 6
 LOCATION & SURVEYS
 4834 US HWY 301 S.
 HOPE MILLS, NC 28348

PROPOSED ALIGNMENT CONTROL SHEET

I, Keith E. Honeycutt, PLS, certify that the data compiled came from available surveys/mapping performed by others and provided to me by NCDOT and do not certify to the accuracy or quality of the individual data sources.

This 27th day of September, 2022.

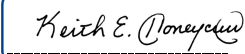
DocuSigned by:

 8C11B4DAEF3D4DF...
 Professional Land Surveyor L-4169

| | | | | | | | | | | |
|--------------------------|------------|-------------|-------------|---------|----------------|-----------|---------|---------|----------|--|
| PROPOSED ALIGNMENT NAME: | | | | | | | | | | |
| L | | | | | | | | | | |
| POINT | NORTHING | EASTING | BEARING | DIST | DELTA | D | L | T | R | |
| START | 190547.104 | 1987550.446 | | | | | | | | |
| LINE | | | N07°50'02"W | 286.298 | | | | | | |
| SC | 190897.584 | 1987502.110 | | | | | | | | |
| CURVE | | | | | 04°57'30" Left | 00°51'46" | 574.628 | 287.493 | 6640.000 | |
| ST | 191527.917 | 1987380.894 | | | | | | | | |
| LINE | | | N13°22'29"W | 673.636 | | | | | | |
| END | 192183.283 | 1987225.070 | | | | | | | | |

| | | | | | | | | | | |
|--------------------------|------------|-------------|-------------|--------|-----------------|------------|---------|--------|----------|--|
| PROPOSED ALIGNMENT NAME: | | | | | | | | | | |
| DR1 | | | | | | | | | | |
| POINT | NORTHING | EASTING | BEARING | DIST | DELTA | D | L | T | R | |
| START | 191051.948 | 1987478.216 | | | | | | | | |
| LINE | | | S80°31'54"W | 20.169 | | | | | | |
| PC | 191048.630 | 1987458.321 | | | | | | | | |
| CURVE | | | | | 89°48'11" Right | 229°10'59" | 39.184 | 24.914 | 25.000 | |
| PRC | 191069.092 | 1987429.564 | | | | | | | | |
| CURVE | | | | | 08°58'32" Left | 04°35'01" | 195.818 | 98.110 | 1250.000 | |

BR-0073
 R/W RW02D-1
 NORTH CAROLINA
 DEPARTMENT
 OF TRANSPORTATION



PROFESSIONAL LAND
 SURVEYOR

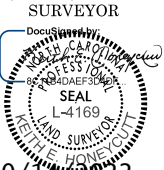

10/14/2022

DOCUMENT NOT CONSIDERED
 FINAL UNLESS ALL SIGNATURES
 ARE COMPLETED

2018 STANDARD
 SPECIFICATIONS

TIP PROJECT: BR-0073
 County: Columbus

PREPARED FOR



LOCATION AND
 SURVEYS UNIT

PREPARED BY

DIVISION 6
 LOCATION & SURVEYS
 4834 US HWY 301 S.
 HOPE MILLS, NC 28348

RIGHT OF WAY CONTROL SHEET

I, Keith E. Honeycutt, certify that the right of way and permanent easement monumentation for this project shown herein was completed under my direct and responsible charge from an actual survey made under my supervision; that all horizontal closures had a minimum ratio of precision of 1:10,000 (Class A). Field work was performed in July 2022, and all coordinates are based on NAD83/2011; That this survey was performed to meet the requirements of 21NCAC 56.1600 as applicable.

This 27th day of September, 2022.

Keith E. Honeycutt
 Professional Land Surveyor L-4169

| STATION | OFFSET | NORTH | EAST |
|----------|--------|------------|-------------|
| 12+40.00 | 30.00 | 190788.953 | 1987547.454 |
| 12+86.30 | -30.00 | 190826.641 | 1987481.703 |
| 13+53.80 | -29.89 | 190893.360 | 1987472.524 |
| 13+53.80 | 54.00 | 190905.219 | 1987555.567 |
| 14+50.00 | 67.00 | 191003.148 | 1987554.007 |
| 14+87.00 | -40.00 | 191022.805 | 1987442.485 |
| 14+87.00 | -27.88 | 191024.758 | 1987454.445 |
| 15+35.09 | -39.12 | 191070.099 | 1987435.478 |
| 17+09.00 | 72.00 | 191261.683 | 1987513.159 |
| 17+32.61 | -51.50 | 191260.690 | 1987387.418 |
| 17+62.00 | -60.00 | 191287.548 | 1987373.271 |
| 18+12.00 | 65.00 | 191362.195 | 1987485.317 |
| 19+28.43 | -60.00 | 191448.640 | 1987337.954 |
| 19+28.43 | 74.00 | 191478.978 | 1987468.475 |
| 19+95.93 | -60.00 | 191514.038 | 1987322.521 |
| 19+95.93 | 70.00 | 191544.114 | 1987448.995 |
| 22+16.00 | -60.00 | 191728.144 | 1987271.614 |
| 22+16.00 | -30.00 | 191735.084 | 1987300.800 |
| 22+47.00 | 55.00 | 191784.905 | 1987376.324 |
| 23+10.00 | 44.00 | 191843.652 | 1987351.049 |
| 23+10.00 | 30.00 | 191840.413 | 1987337.429 |

BR-0073
 R/W RW03E-1
 NORTH CAROLINA
 DEPARTMENT
 OF TRANSPORTATION

PROFESSIONAL LAND SURVEYOR
 KEITH E. HONEYCUTT
 L-4169
 10/14/2022

DOCUMENT NOT CONSIDERED
 FINAL UNLESS ALL SIGNATURES
 ARE COMPLETED

2018 STANDARD
 SPECIFICATIONS

TIP PROJECT: BR-0073
 County: Columbus

PREPARED FOR

LOCATION AND SURVEYS UNIT

PREPARED BY

DIVISION 6
 LOCATION & SURVEYS
 4834 US HWY 301 S.
 HOPE MILLS, NC 28348

I, Keith E. Honeycutt, certify that the right of way and permanent easement monumentation for this project shown herein was completed under my direct and responsible charge from an actual survey made under my supervision; that all horizontal closures had a minimum ratio of precision of 1:10,000 (Class A). Field work was performed in July to 2022, and all coordinates are based on NAD83/2011; That this survey was performed to meet the requirements of 21NCAC 56.1600 as applicable.

This Survey of September, 2022.
Keith E. Honeycutt
Professional Land Surveyor L-4169

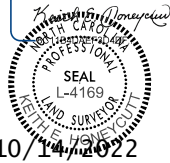
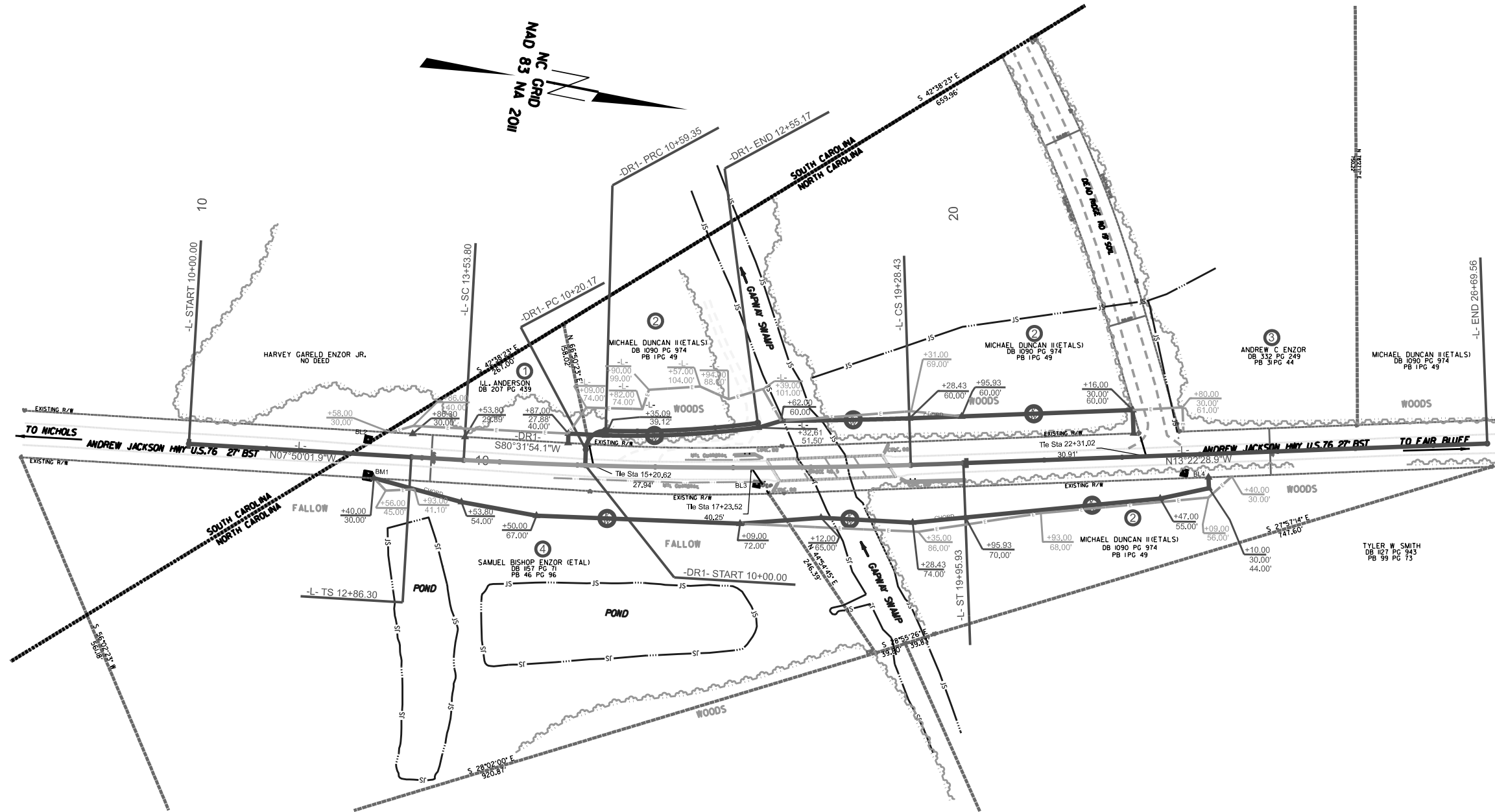

TIP PROJECT: BR-0073
County: Columbus

