

09/08/09

PROJECT: BR-0073

See Sheet 1A For Index of Sheets

STATE OF NORTH CAROLINA DIVISION OF HIGHWAYS

STATE	STATE PROJECT REFERENCE NO.	SHEET NO.	TOTAL SHEETS
N.C.	BR-0073	1	5

SURVEY CONTROL, EXISTING CENTERLINES, RIGHT OF WAY, EASEMENTS, AND PROPERTY TIES

COLUMBUS COUNTY

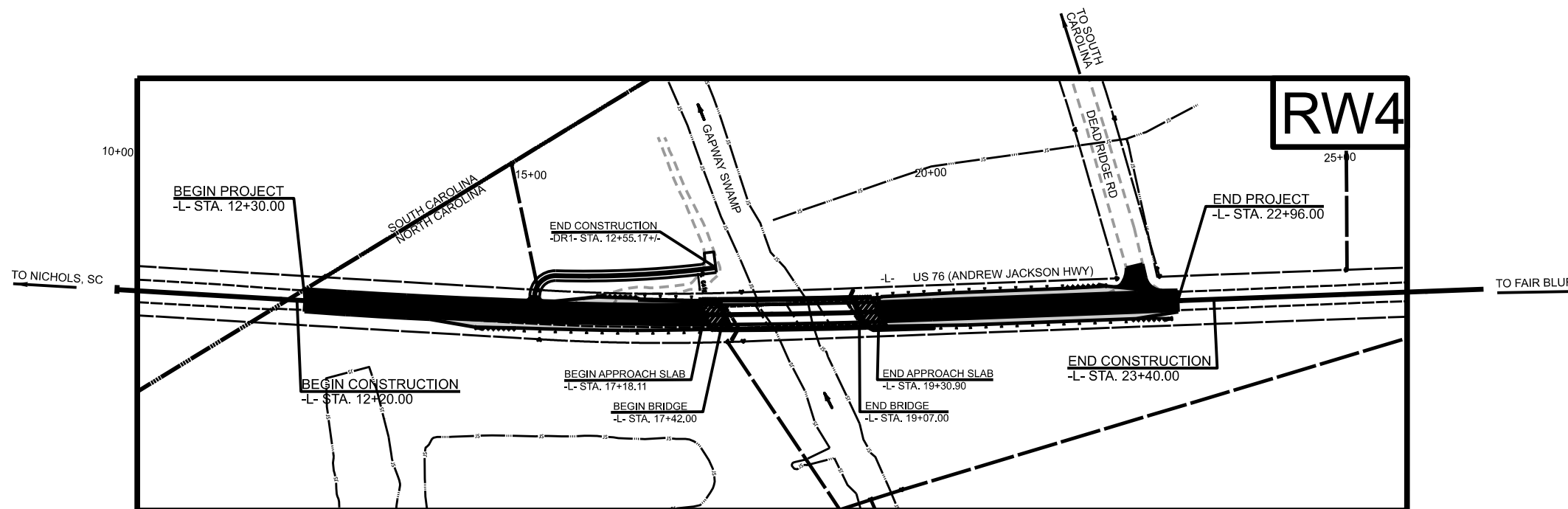
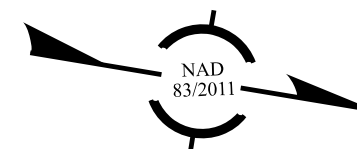
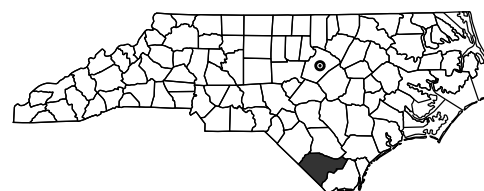
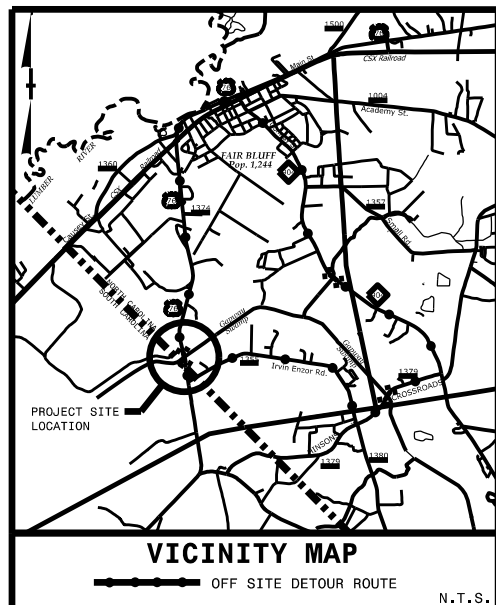

DOCUMENT NOT CONSIDERED FINAL
UNLESS ALL SIGNATURES COMPLETED

GRAPHIC SCALES



DATUM DESCRIPTION

THE LOCALIZED COORDINATE SYSTEM DEVELOPED FOR THIS PROJECT IS BASED ON THE STATE PLANE COORDINATES ESTABLISHED BY NCDOT FOR MONUMENT "BR0073-P7" WITH NAD 83(2011) STATE PLANE GRID COORDINATES OF
 NORTHING: 190062.907(ft) EASTING: 1987616.9722(ft)
 ELEVATION: 70.17(ft)
 THE AVERAGE COMBINED GRID FACTOR USED ON THIS PROJECT (GROUND TO GRID) IS: 1.00001851634
 ALL LINEAR DIMENSIONS ARE LOCALIZED HORIZONTAL DISTANCES
 VERTICAL DATUM USED IS NAVD 88

Prepared in the Office of:

DIVISION 6
 LOCATION & SURVEYS
 4834 US US HWY 301S
 HOPE MILLS, NC 28348

2018 STANDARD SPECIFICATIONS

RIGHT OF WAY DATE:
 01/21/2022

LETTING DATE:
 01/17/2023

PROFESSIONAL LAND SURVEYOR



DocuSigned by:

Keith E. Honeycutt 10/14/2022

09/08/09 DATE:

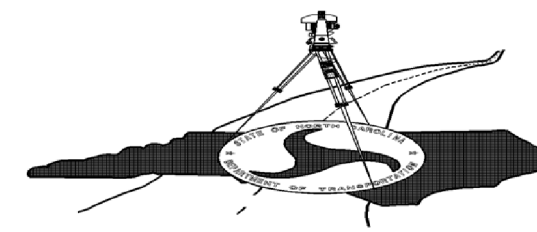

SECONDARY SURVEY CONTROL SHEET

W/EXISTING CENTERLINE ALIGNMENTS PRIOR TO CONSTRUCTION

I, Keith E. Honeycutt, PLS, certify that the Project Control was [performed] under my supervision from an actual GPS survey made under my supervision and the following information was used to perform the survey:

Class of survey: AA
 Type of GPS field procedure: [RTN]
 Dates of survey: March 2020
 Datum/Epoch: NAD83/2011
 Published/Fixed-control use: [N/A]
 Localized around: BR0073-P7
 Northing: 190062.9074
 Easting: 1987616.9722
 Combined grid factor: 1.00001851634
 Geoid model: 12BNC
 Units: US : SURVEY FEET

I also certify that the Baseline Control for this project was completed under my direct and responsible charge from an actual survey made under my supervision; that all horizontal closures had a minimum ratio of precision of 1:20,000 (Class AA) and Vertical accuracy to Class A. Field work was performed in March 2020, and all coordinates are based on NAD 83/2011 and all elevations are based on NAVD 88; that this survey was performed to meet the requirements of 21NCAC 56.1600 as applicable.

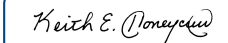
This 27th day of September, 2022.
 DocuSigned by:

 8C11B4DAEF3D4DF...
 Professional Land Surveyor L-4169

BR-0073

R/W RW02G-1

NORTH CAROLINA
DEPARTMENT
OF TRANSPORTATION



PROFESSIONAL LAND SURVEYOR



10/14/2022

DOCUMENT NOT CONSIDERED FINAL UNLESS ALL SIGNATURES ARE COMPLETED

2018 STANDARD SPECIFICATIONS

TIP PROJECT: BR-0073
 County: Columbus

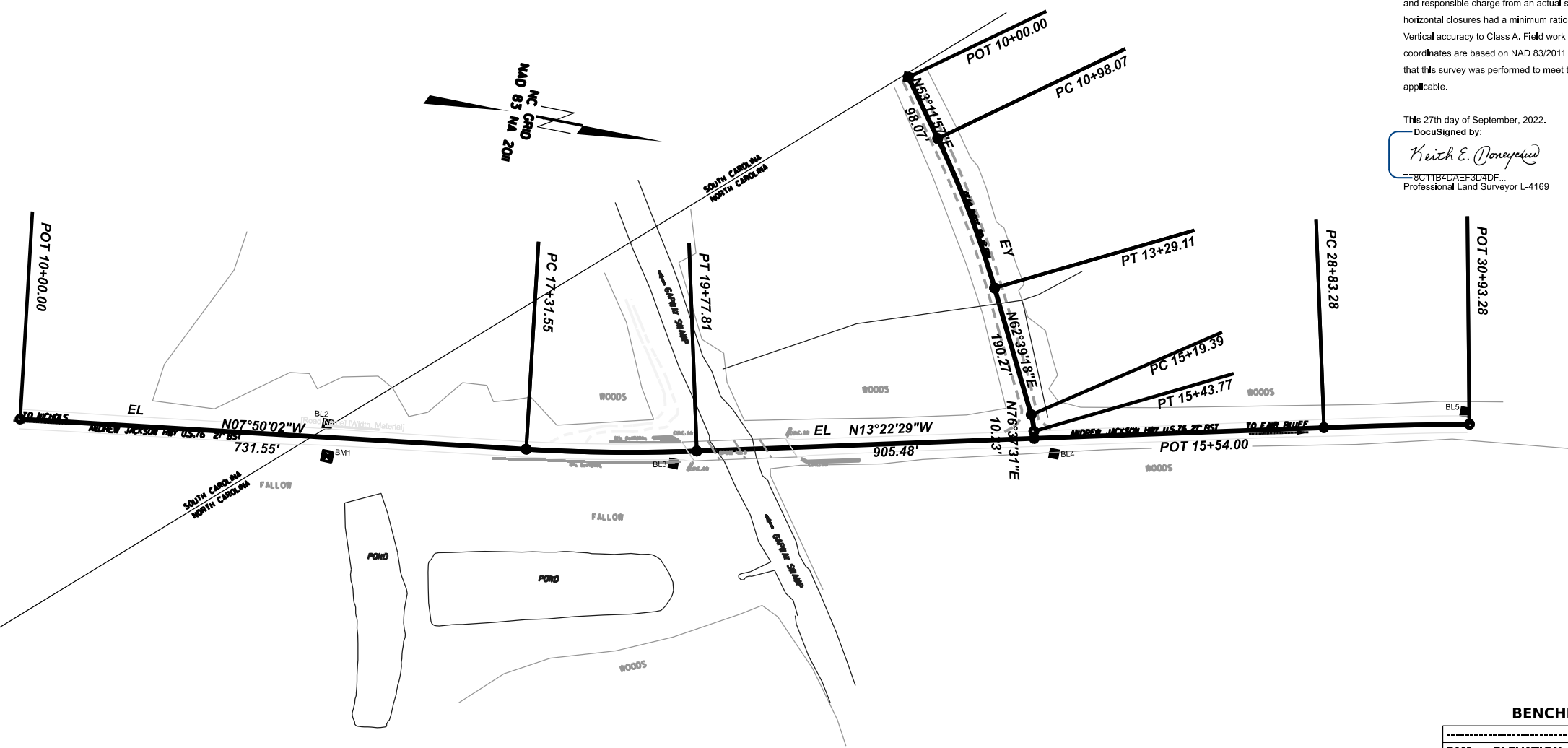

BASELINE

BL	BR-0073	BL	NORTHING	EASTING	ELEVATION
BL1	BR-0073	BL-1	190172.223	1987583.044	70.170
BL2	BR-0073	BL-2	190771.948	1987500.024	65.852
BL3	BR-0073	BL-3	191272.904	1987458.676	68.233
BL4	BR-0073	BL-4	191808.800	1987337.757	65.610
BL5	BR-0073	BL-5	192378.805	1987163.113	65.678

BENCHMARK

BM1	ELEVATION = 67.870
N	190780.709 E 1987545.718
RR SPIKE IN BASE OF 20\" GUM TREE	

EXISTING ALIGNMENT NAME: EL	NORTHING	EASTING	BEARING	DIST	DELTA	D	L	T	R
POINT	190335.687	1987579.534							
START			N07°50'02\"W	731.546					
LINE									
PC	191060.406	1987479.823							
CURVE					05°32'27\" Left	02°15'00\"	246.260	123.226	2546.479
PT	191302.366	1987434.523							
LINE			N13°22'29\"W	905.475					
PC	192183.283	1987225.070							
CURVE					01°34'30\" Right	00°45'00\"	210.000	105.007	7639.437

EXISTING ALIGNMENT NAME: EY	NORTHING	EASTING	BEARING	DIST	DELTA	D	L	T	R
POINT	191496.734	1986845.998							
START			N53°11'57\"E	98.065					
LINE									
PC	191555.479	1986924.521							
CURVE					09°27'21\" Right	04°05'33\"	231.047	115.786	1400.000
PT	191678.025	1987120.082							
LINE			N62°39'18\"E	190.273					
PC	191765.427	1987289.093							
CURVE					13°58'13\" Right	57°17'45\"	24.383	12.252	100.000
PT	191773.889	1987311.896							
LINE			N76°37'31\"E	10.229					
END	191776.255	1987321.848							

PREPARED FOR



LOCATION AND SURVEYS UNIT

PREPARED BY

DIVISION 6
 LOCATION & SURVEYS
 4834 US HWY 301 S.
 HOPE MILLS, NC 28348

PROPOSED ALIGNMENT CONTROL SHEET

I, Keith E. Honeycutt, PLS, certify that the data compiled came from available surveys/mapping performed by others and provided to me by NCDOT and do not certify to the accuracy or quality of the individual data sources.

This 27th day of September, 2022.

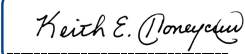
DocuSigned by:

 8C11B4DAEF3D4DF...
 Professional Land Surveyor L-4169

PROPOSED ALIGNMENT NAME:									
L									
POINT	NORTHING	EASTING	BEARING	DIST	DELTA	D	L	T	R
START	190547.104	1987550.446							
LINE			N07°50'02"W	286.298					
SC	190897.584	1987502.110							
CURVE					04°57'30" Left	00°51'46"	574.628	287.493	6640.000
ST	191527.917	1987380.894							
LINE			N13°22'29"W	673.636					
END	192183.283	1987225.070							

PROPOSED ALIGNMENT NAME:									
DR1									
POINT	NORTHING	EASTING	BEARING	DIST	DELTA	D	L	T	R
START	191051.948	1987478.216							
LINE			S80°31'54"W	20.169					
PC	191048.630	1987458.321							
CURVE					89°48'11" Right	229°10'59"	39.184	24.914	25.000
PRC	191069.092	1987429.564							
CURVE					08°58'32" Left	04°35'01"	195.818	98.110	1250.000

BR-0073
 R/W RW02D-1
 NORTH CAROLINA
 DEPARTMENT
 OF TRANSPORTATION



PROFESSIONAL LAND
 SURVEYOR

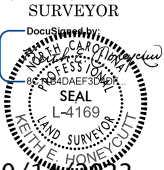

10/14/2022

DOCUMENT NOT CONSIDERED
 FINAL UNLESS ALL SIGNATURES
 ARE COMPLETED

2018 STANDARD
 SPECIFICATIONS

TIP PROJECT: BR-0073
 County: Columbus

PREPARED FOR

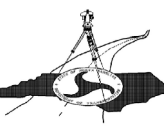

LOCATION AND
 SURVEYS UNIT

PREPARED BY

DIVISION 6
 LOCATION & SURVEYS
 4834 US HWY 301 S.
 HOPE MILLS, NC 28348

RIGHT OF WAY CONTROL SHEET

I, Keith E. Honeycutt, certify that the right of way and permanent easement monumentation for this project shown herein was completed under my direct and responsible charge from an actual survey made under my supervision; that all horizontal closures had a minimum ratio of precision of 1:10,000 (Class A). Field work was performed in July 2022, and all coordinates are based on NAD83/2011; That this survey was performed to meet the requirements of 21NCAC 56.1600 as applicable.

This 27th day of September, 2022.

Keith E. Honeycutt
 Professional Land Surveyor L-4169

STATION	OFFSET	NORTH	EAST
12+40.00	30.00	190788.953	1987547.454
12+86.30	-30.00	190826.641	1987481.703
13+53.80	-29.89	190893.360	1987472.524
13+53.80	54.00	190905.219	1987555.567
14+50.00	67.00	191003.148	1987554.007
14+87.00	-40.00	191022.805	1987442.485
14+87.00	-27.88	191024.758	1987454.445
15+35.09	-39.12	191070.099	1987435.478
17+09.00	72.00	191261.683	1987513.159
17+32.61	-51.50	191260.690	1987387.418
17+62.00	-60.00	191287.548	1987373.271
18+12.00	65.00	191362.195	1987485.317
19+28.43	-60.00	191448.640	1987337.954
19+28.43	74.00	191478.978	1987468.475
19+95.93	-60.00	191514.038	1987322.521
19+95.93	70.00	191544.114	1987448.995
22+16.00	-60.00	191728.144	1987271.614
22+16.00	-30.00	191735.084	1987300.800
22+47.00	55.00	191784.905	1987376.324
23+10.00	44.00	191843.652	1987351.049
23+10.00	30.00	191840.413	1987337.429

BR-0073
 R/W RW03E-1
 NORTH CAROLINA
 DEPARTMENT
 OF TRANSPORTATION



PROFESSIONAL LAND SURVEYOR
 KEITH E. HONEYCUTT
 SEAL
 L-4169
 10/14/2022

DOCUMENT NOT CONSIDERED
 FINAL UNLESS ALL SIGNATURES
 ARE COMPLETED

2018 STANDARD
 SPECIFICATIONS

TIP PROJECT: BR-0073
 County: Columbus

PREPARED FOR

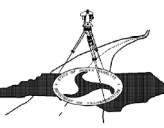

LOCATION AND SURVEYS UNIT

PREPARED BY

DIVISION 6
 LOCATION & SURVEYS
 4834 US HWY 301 S.
 HOPE MILLS, NC 28348

I, Keith E. Honeycutt, certify that the right of way and permanent easement monumentation for this project shown herein was completed under my direct and responsible charge from an actual survey made under my supervision; that all horizontal closures had a minimum ratio of precision of 1:10,000 (Class A). Field work was performed in July to 2022, and all coordinates are based on NAD83/2011; That this survey was performed to meet the requirements of 21NCAC 56.1600 as applicable.

This Survey of September, 2022.
Keith E. Honeycutt
Professional Land Surveyor L-4169

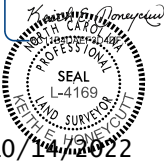
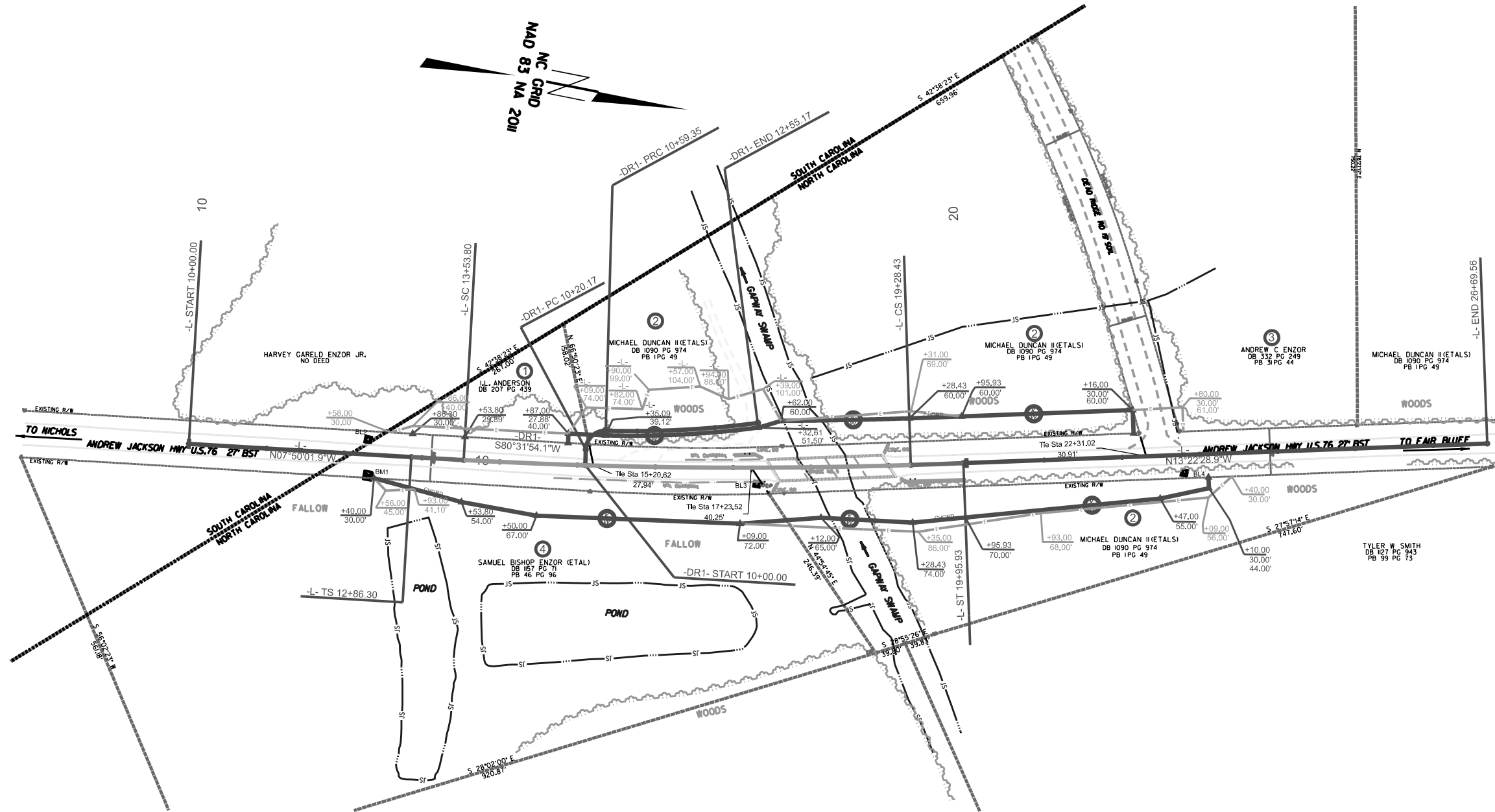

TIP PROJECT: BR-0073
County: Columbus

