

### UTILITIES BY OTHERS

NOTE:  
ALL UTILITY WORK SHOWN ON THIS SHEET WILL BE DONE BY OTHERS. NO PAYMENT WILL BE MADE TO THE CONTRACTOR FOR UTILITY WORK SHOWN ON THIS SHEET.

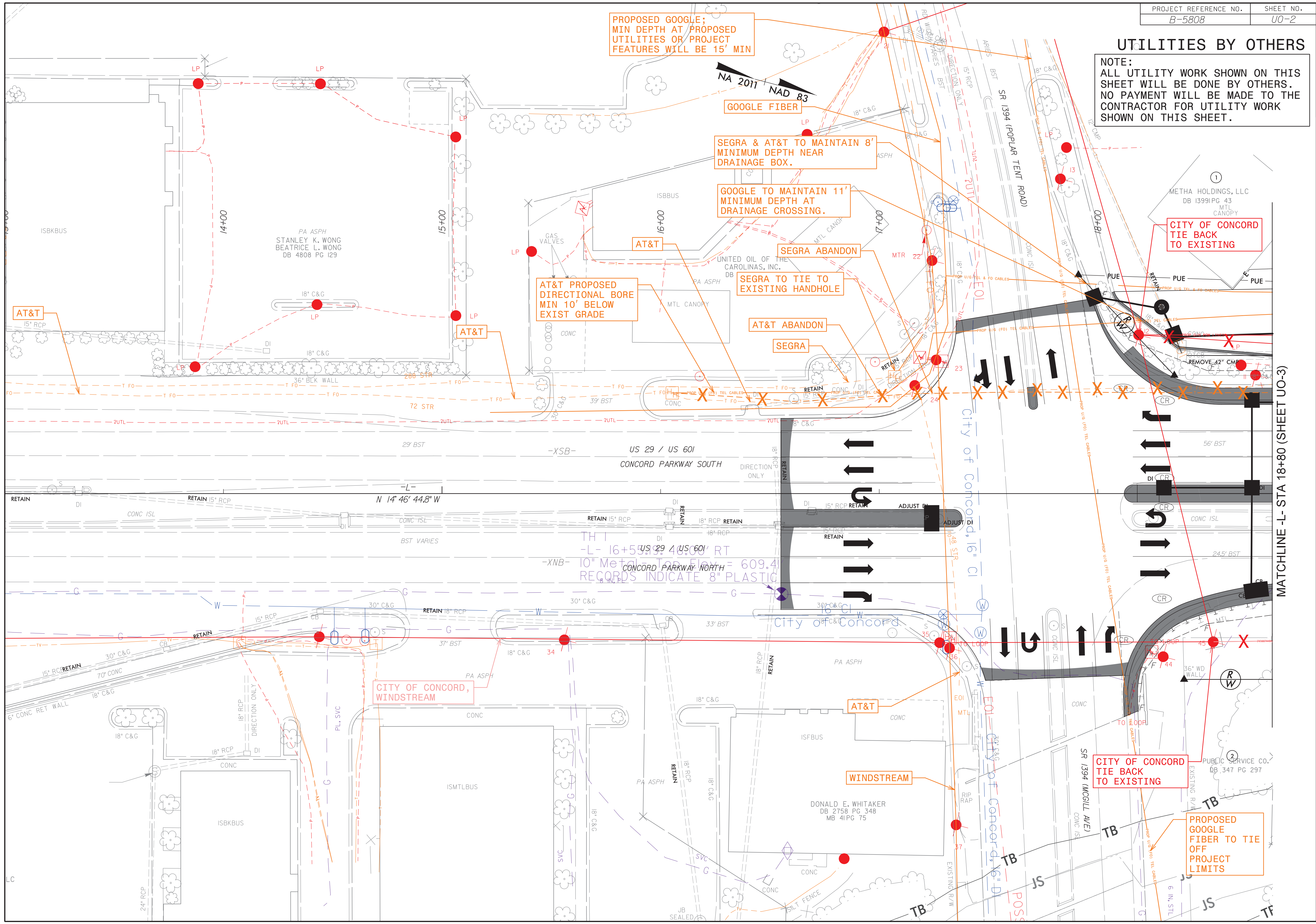

PROPOSED GOOGLE;  
MIN DEPTH AT PROPOSED  
UTILITIES OR PROJECT  
FEATURES WILL BE 15' MIN

GOOGLE FIBER

SEGRA & AT&T TO MAINTAIN 8'  
MINIMUM DEPTH NEAR  
DRAINAGE BOX.

GOOGLE TO MAINTAIN 11'  
MINIMUM DEPTH AT  
DRAINAGE CROSSING.

AT&T PROPOSED  
DIRECTIONAL BORE  
MIN 10' BELOW  
EXIST GRADE

SEGRA TO TIE TO  
EXISTING HANDHOLE

AT&T ABANDON  
SEGRA

CITY OF CONCORD  
TIE BACK  
TO EXISTING

CITY OF CONCORD,  
WINDSTREAM

WINDSTREAM

CITY OF CONCORD  
TIE BACK  
TO EXISTING

PROPOSED  
GOOGLE  
FIBER TO TIE  
OFF  
PROJECT  
LIMITS

MATCHLINE -L- STA 18+80 (SHEET U0-3)