

5/28/99

SCALE: 1" = 20' HORIZONTAL
1" = 4' VERTICAL

- NOTES:
1. LOCATION AND DEPTHS OF EXISTING UTILITIES ARE APPROXIMATE. CONTRACTOR TO FIELD VERIFY LOCATIONS AND DEPTHS PRIOR TO FORCE MAIN & WATER LINE CONSTRUCTION.
 2. EXPOSE EXISTING 48" SANITARY GRAVITY SEWER, INSTALL 84" DIAMETER 12-GAUGE LINER PLATE TUNNEL AROUND EXISTING SEWER. BOLT LINER PLATE TUNNEL TO EXISTING TUNNEL AT INTERFACE.

EXISTING 48" GRAVITY SEWER -EX SSA-WSACC

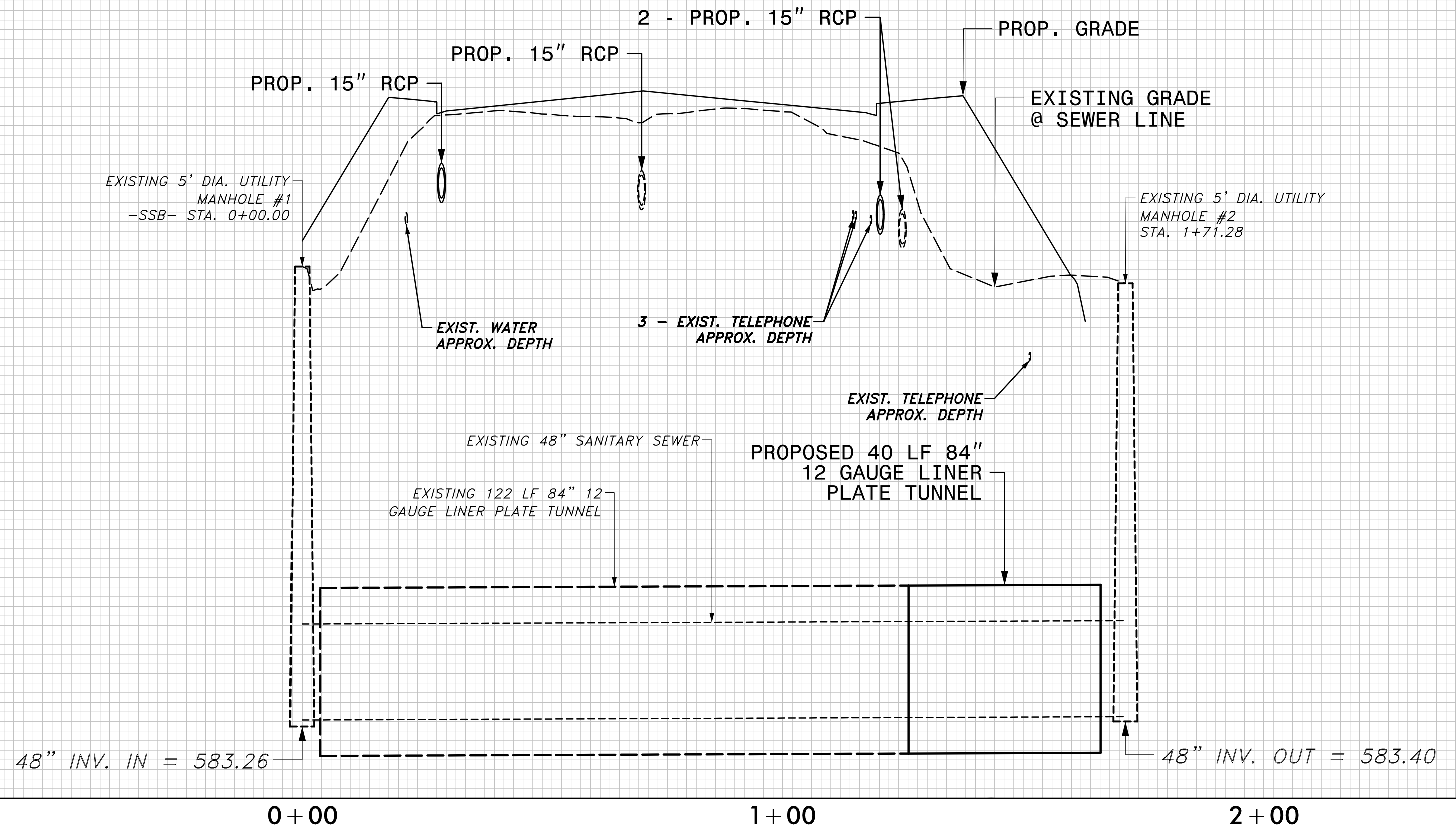

SEE SHEET UC-5 FOR -EX SSA- PLAN

PROJECT REFERENCE NO.	SHEET NO.
B-5808	UC-7
DESIGNED BY: NKA	
DRAWN BY: NKA	
CHECKED BY: ASV	
APPROVED BY:	
REVISED:	
NORTH CAROLINA DEPARTMENT OF TRANSPORTATION	
UTILITIES ENGINEERING SEC. PHONE: (919) 707-6690 FAX: (919) 250-4151	
UTILITY CONSTRUCTION PLANS ONLY	

UTILITY CONSTRUCTION

DOCUMENT NOT CONSIDERED FINAL UNLESS ALL SIGNATURES COMPLETED

STV 100 Years STV Engineers, Inc. 900 West Trade St., Suite 715 Charlotte, NC 28202 NC License Number F-0991

F:\Utilities\Engineering\UC\Proj\Sheet\B-5808B_ut_pf1_UC07_psh.dgn 1/1/2023 2:43pm

PROP. 10" GRAVITY SEWER -SSB-CITY OF CONCORD

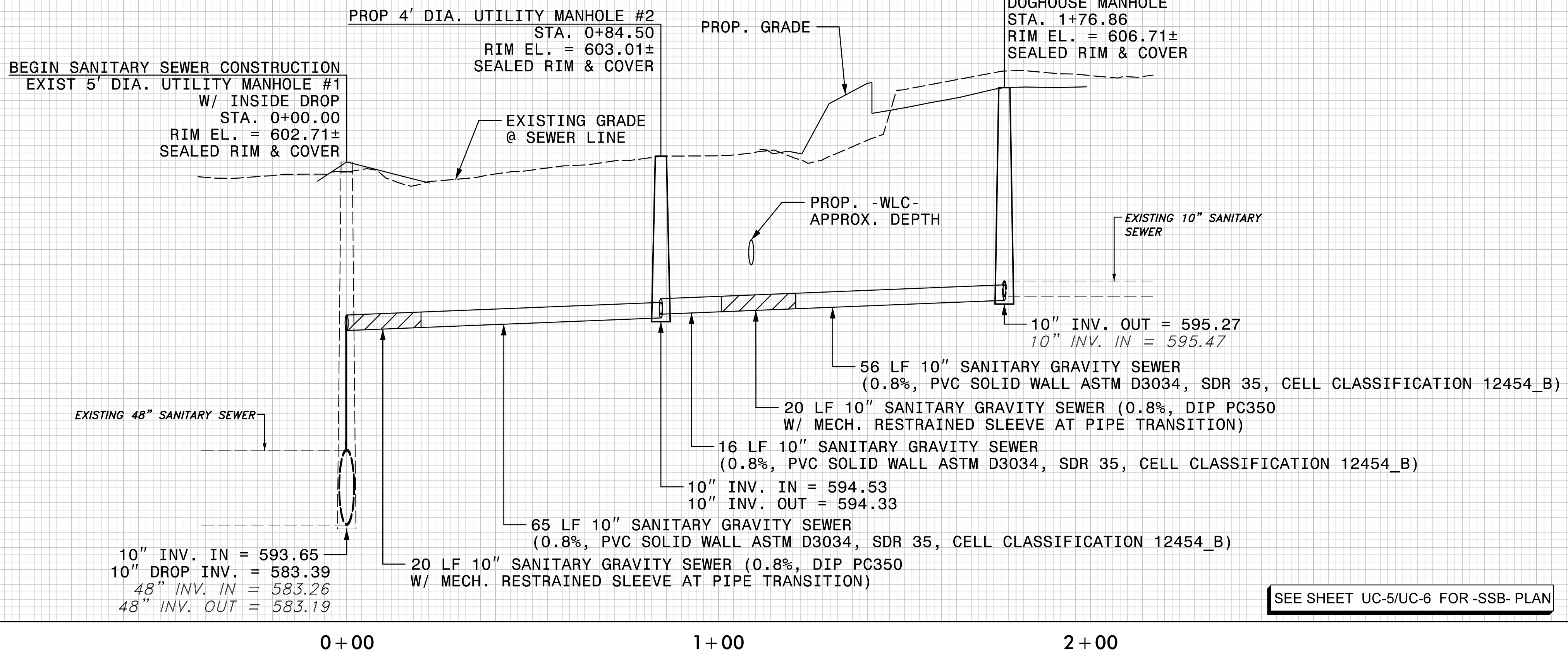

SEE SHEET UC-5/UC-6 FOR -SSB- PLAN

616
612
608
604
600
596
592
588
584
580

610
606
602
598
594
590
586
582
578
574

600
596
592
588
584
580

610
606
602
598
594
590
586
582
578
574