

09/08/99

TIP PROJECT: B5808

STATE OF NORTH CAROLINA
DIVISION OF HIGHWAYS

SURVEY CONTROL, EXISTING CENTERLINES,
RIGHT OF WAY, EASEMENTS AND PROPERTY TIES

CABBARUS COUNTY

STATE	STATE PROJECT REFERENCE NO.	SHEET NO.	TOTAL SHEETS
N.C.	B5808	RW01	4

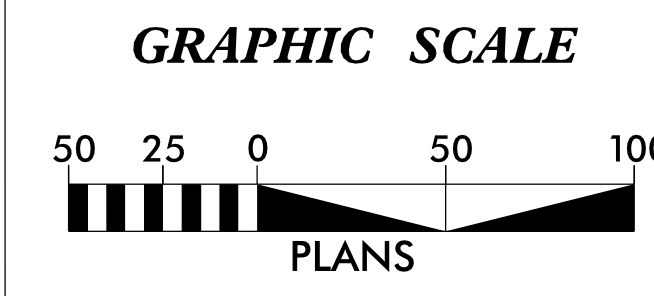
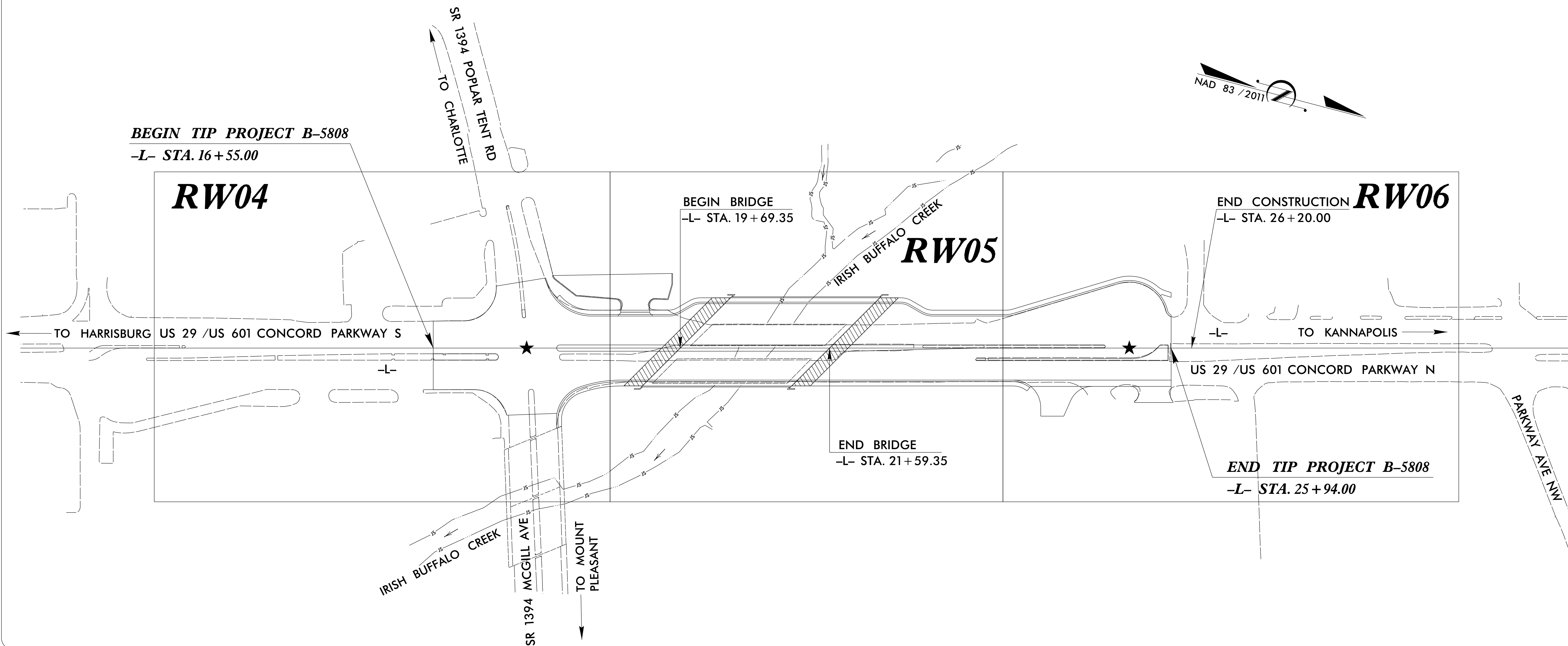

DATUM DESCRIPTION

THE LOCALIZED COORDINATE SYSTEM DEVELOPED FOR THIS PROJECT IS BASED ON THE STATE PLANE COORDINATES ESTABLISHED BY NCDOT FOR MONUMENT "P5" WITH NAD 83/NA 2011 STATE PLANE GRID COORDINATES OF NORTHING: 609,444.661(ft) EASTING: 1,518,826.846(ft) ELEVATION: 607.022(ft) THE AVERAGE COMBINED GRID FACTOR USED ON THIS PROJECT (GROUND TO GRID) IS: 0.99985434 THE N.C. LAMBERT GRID BEARING AND LOCALIZED HORIZONTAL GROUND DISTANCE FROM "P5" TO -L- STATION 16+55 IS N 82-52'57.4" E 590.17(ft) ALL LINEAR DIMENSIONS ARE LOCALIZED HORIZONTAL DISTANCES VERTICAL DATUM USED IS NAVD 88

Prepared in the Office of:

GEL SOLUTIONS

2018 STANDARD SPECIFICATIONS

RIGHT OF WAY DATE:
07/13/2021

LETTING DATE:
05/17/2022

PROFESSIONAL LAND SURVEYOR

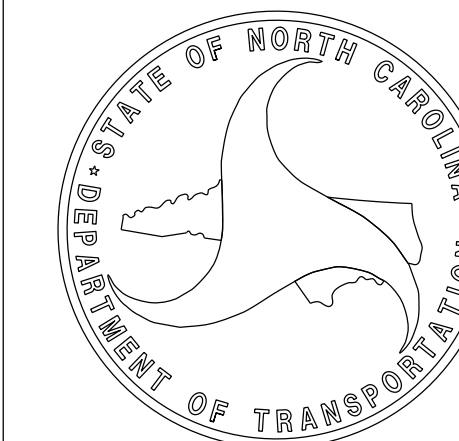
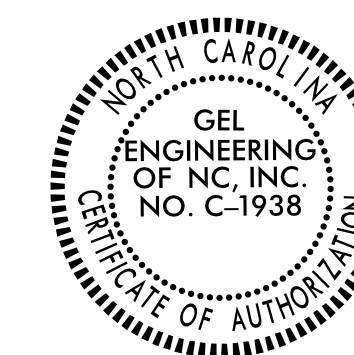

SIGNATURE:

Date:

16-SEP-2021 14:37
C:\B5808\B5808_IS-RW01.dgn
Andy Smith AT ANDY SMITH-GEG