

8/17/19

STAGED CONSTRUCTION DETAIL FOR -XSB- AND -XNB-

STV 100 Years
 STV Engineers, Inc.
 300 West Trade St., Suite 715
 Charlotte, NC 28202
 NC License Number F-0991

| | |
|--|--------------------------|
| PROJECT REFERENCE NO. B-5808 | SHEET NO. 2B-3 |
| RW SHEET NO. | HYDRAULICS ENGINEER |
| ROADWAY DESIGN ENGINEER | |
| | |

DOCUMENT NOT CONSIDERED FINAL UNLESS ALL SIGNATURES COMPLETED

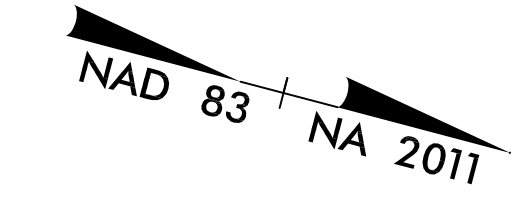

-XSB-
 PI Sta 24+81.19
 $\Delta = 11' 13" 17.2" (LT)$
 $D = 8' 11" 06.4"$
 $L = 137.10'$
 $T = 68.77'$
 $R = 700.00'$
 $SE = NC$
 $RO = N/A$

-XNB-
 PI Sta 24+37.43
 $\Delta = 14' 21" 41.4" (LT)$
 $D = 9' 32" 57.5"$
 $L = 150.39'$
 $T = 75.59'$
 $R = 600.00'$
 $SE = NC$
 $RO = N/A$

MATCHLINE -XSB- STA 24+00 (SEE SHEET 2B-2)

MATCHLINE -XNB- STA 24+00 (SEE SHEET 2B-2)

END CONSTRUCTION
 -XSB- STA. 25+49.52 =
 -L- STA. 25+44.91, 17.50' LT

END CONSTRUCTION
 -XNB- PC STA. 25+12.23 =
 -L- STA. 25+06.04, 29.50' RT

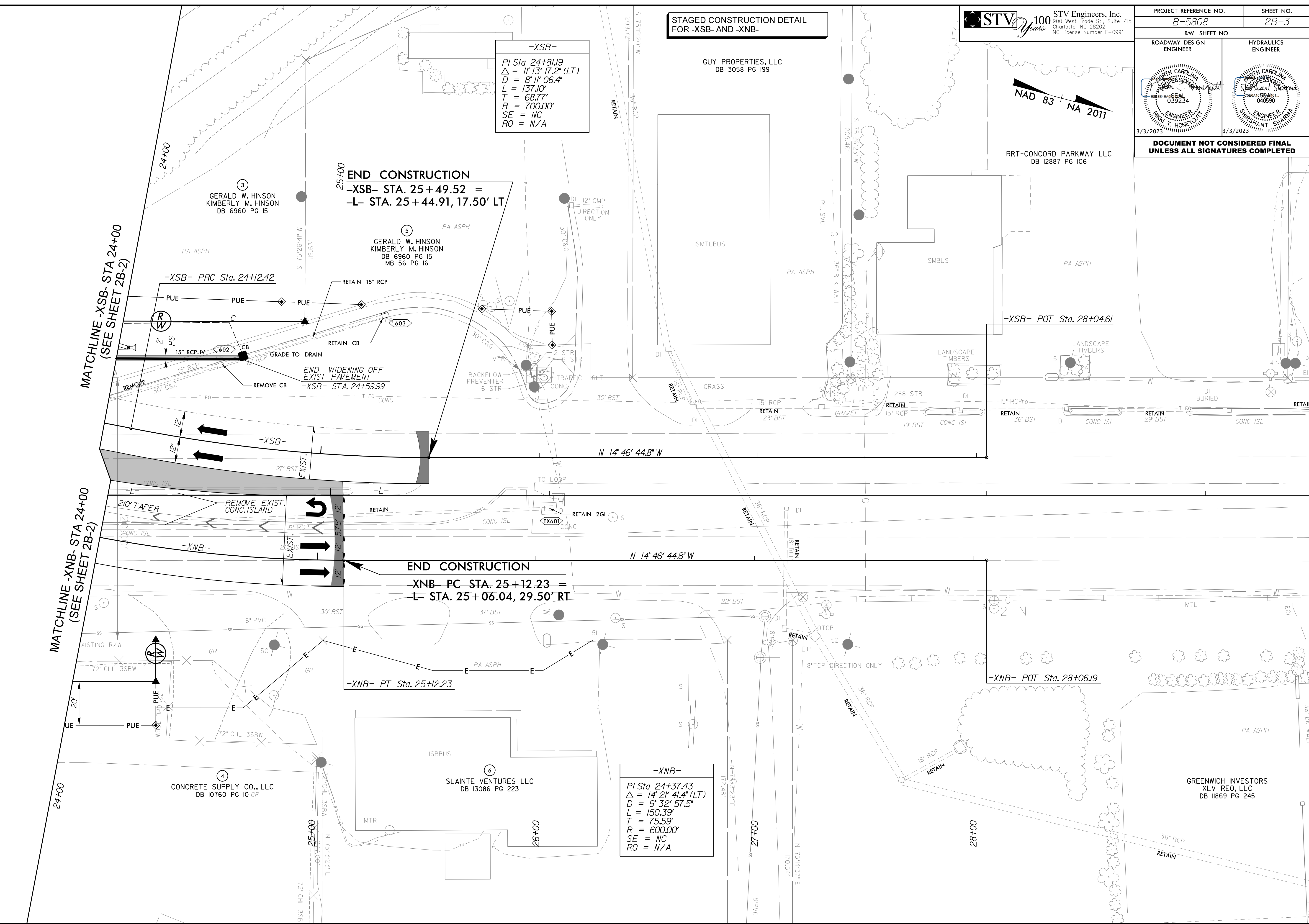

3/3/2023
 C:\projects\sh02B-3.dgn
 model.dwg

GREENWICH INVESTORS
 XLV. REQ, LLC
 DB 11869 PG 245