



STATE OF NORTH CAROLINA  
DEPARTMENT OF TRANSPORTATION

ROY COOPER  
GOVERNOR

J. ERIC BOYETTE  
SECRETARY

April 13, 2023

**Addendum No. 2**

RE: Contract # C204793

WBS # 67041.3.1, 67043.3.1

STATE FUNDED

**Rockingham County (BR-0041, BR-0043)**

BRIDGE 78001 OVER US-29 ON SR-2817 AND BRIDGE 780151 OVER US-29 ON US-158.

**April 18, 2023 Letting**

To Whom It May Concern:

Reference is made to the proposal and plans furnished to you on this project.

The following revisions have been made to the Structures Plans.

Sheet No.	Revision
S-04	Bill of Material updated to reflect quantity changes below.

Please void the above listed Sheet in your Plans and staple the revised Sheet thereto.

The following revisions have been made to the proposal.

Page No.	Revision
Proposal Cover	Note added that reads "Includes Addendum No. 1 Dated 04-13-2023".

Please void the above listed existing Page in your proposal and staple the revised Page thereto.

On the item sheets the following pay item revisions have been made:

*Mailing Address:*  
NC DEPARTMENT OF TRANSPORTATION  
CONTRACT STANDARDS AND DEVELOPMENT  
1591 MAIL SERVICE CENTER  
RALEIGH, NC 27699-1591

*Telephone:* (919) 707-6900  
*Fax:* (919) 250-4127  
*Customer Service:* 1-877-368-4968

*Location:*  
1020 BIRCH RIDGE DR.  
RALEIGH, NC 27610

*Website:* [www.ncdot.gov](http://www.ncdot.gov)

<u>Item</u>	<u>Description</u>	<u>Old Quantity</u>	<u>New Quantity</u>
0235-8105540000-E 411	3'-6" DIA DRILLED PIERS IN SOIL	22 LF	220 LF
0237-8105640000-E 411	3'-6" DIA DRILLED PIERS NOT IN SOIL	220 LF	22 LF

The Contractor's bid must include these pay item revisions.

The electronic bidding file has been updated to reflect these revisions. Please download the Addendum File and follow the instructions for applying the addendum. Bid Express will not accept your bid unless the addendum has been applied.

The contract will be prepared accordingly.

Sincerely,

DocuSigned by:  
  
F81B6038A47A442...

Ronald E. Davenport, Jr., PE  
State Contract Officer

RED/cms  
Attachments

cc: Mr. Boyd Tharrington, PE  
Mr. Wright R. Archer, III, PE  
Mr. Ken Kennedy, PE  
Mr. Mike Gwyn  
Project File (2)

Mr. Forrest Dungan, PE  
Ms. Jaci Kincaid  
Mr. Jon Weathersbee, PE

STATE OF NORTH CAROLINA  
DEPARTMENT OF TRANSPORTATION  
RALEIGH, N.C.

PROPOSAL

**INCLUDES ADDENDUM No. 2 DATED 04-13-2023**

DATE AND TIME OF BID OPENING: **Apr 18, 2023 AT 02:00 PM**

CONTRACT ID C204793  
WBS 67041.3.1, 67043.3.1

FEDERAL-AID NO. STATE FUNDED  
COUNTY ROCKINGHAM  
T.I.P NO. BR-0041, BR-0043  
MILES 0.887  
ROUTE NO.  
LOCATION BRIDGE 78001 OVER US-29 ON SR-2817 AND BRIDGE 780151 OVER US-29  
ON US-158.

TYPE OF WORK GRADING, DRAINAGE, PAVING, SIGNAL, AND STRUCTURE.

**NOTICE:**

ALL BIDDERS SHALL COMPLY WITH ALL APPLICABLE LAWS REGULATING THE PRACTICE OF GENERAL CONTRACTING AS CONTAINED IN CHAPTER 87 OF THE GENERAL STATUTES OF NORTH CAROLINA WHICH REQUIRES THE BIDDER TO BE LICENSED BY THE N.C. LICENSING BOARD FOR CONTRACTORS WHEN BIDDING ON ANY NON-FEDERAL AID PROJECT WHERE THE BID IS \$30,000 OR MORE, EXCEPT FOR CERTAIN SPECIALTY WORK AS DETERMINED BY THE LICENSING BOARD. BIDDERS SHALL ALSO COMPLY WITH ALL OTHER APPLICABLE LAWS REGULATING THE PRACTICES OF ELECTRICAL, PLUMBING, HEATING AND AIR CONDITIONING AND REFRIGERATION CONTRACTING AS CONTAINED IN CHAPTER 87 OF THE GENERAL STATUTES OF NORTH CAROLINA. NOTWITHSTANDING THESE LIMITATIONS ON BIDDING, THE BIDDER WHO IS AWARDED ANY FEDERAL - AID FUNDED PROJECT SHALL COMPLY WITH CHAPTER 87 OF THE GENERAL STATUTES OF NORTH CAROLINA FOR LICENSING REQUIREMENTS WITHIN 60 CALENDAR DAYS OF BID OPENING.

**BIDS WILL BE RECEIVED AS SHOWN BELOW:**

**THIS IS A ROADWAY & STRUCTURE PROPOSAL**

**5% BID BOND OR BID DEPOSIT REQUIRED**

---

County: ROCKINGHAM

Line #	Item Number	Sec #	Description	Quantity	Unit Cost	Amount
<b>ROADWAY ITEMS</b>						
0001	0000100000-N	800	MOBILIZATION	Lump Sum	L.S.	
0002	0000400000-N	801	CONSTRUCTION SURVEYING	Lump Sum	L.S.	
0003	0029000000-N	SP	TYPE III REINFORCED APPROACH FILL, STATION ***** (25+80.88 -L-)	Lump Sum	L.S.	
0004	0029000000-N	SP	TYPE III REINFORCED APPROACH FILL, STATION ***** (34+73.00 -L-)	Lump Sum	L.S.	
0005	0043000000-N	226	GRADING	Lump Sum	L.S.	
0006	0050000000-E	226	SUPPLEMENTARY CLEARING & GRUBBING	2 ACR		
0007	0057000000-E	226	UNDERCUT EXCAVATION	1,140 CY		
0008	0134000000-E	240	DRAINAGE DITCH EXCAVATION	130 CY		
0009	0195000000-E	265	SELECT GRANULAR MATERIAL	540 CY		
0010	0196000000-E	270	GEOTEXTILE FOR SOIL STABILIZATION	7,650 SY		
0011	0199000000-E	SP	TEMPORARY SHORING	10,916 SF		
0012	0318000000-E	300	FOUNDATION CONDITIONING MATERIAL, MINOR STRUCTURES	591 TON		
0013	0320000000-E	300	FOUNDATION CONDITIONING GEOTEXTILE	3,355 SY		
0014	0448200000-E	310	15" RC PIPE CULVERTS, CLASS IV	2,444 LF		
0015	0448300000-E	310	18" RC PIPE CULVERTS, CLASS IV	1,260 LF		
0016	0448400000-E	310	24" RC PIPE CULVERTS, CLASS IV	264 LF		
0017	0582000000-E	310	15" CS PIPE CULVERTS, 0.064" THICK	224 LF		

County: ROCKINGHAM

Line #	Item Number	Sec #	Description	Quantity	Unit Cost	Amount
0018	0594000000-E	310	24" CS PIPE CULVERTS, 0.064" THICK	64 LF		
0019	0636000000-E	310	*** CS PIPE ELBOWS, ***** THICK (15", 0.064")	8 EA		
0020	0636000000-E	310	*** CS PIPE ELBOWS, ***** THICK (24", 0.064")	2 EA		
0021	0973100000-E	330	*** WELDED STEEL PIPE, ***** THICK, GRADE B IN SOIL (18", 0.500")	66 LF		
0022	0973100000-E	330	*** WELDED STEEL PIPE, ***** THICK, GRADE B IN SOIL (24", 0.500")	68 LF		
0023	0973300000-E	330	*** WELDED STEEL PIPE, ***** THICK, GRADE B NOT IN SOIL (18", 0.500")	66 LF		
0024	0973300000-E	330	*** WELDED STEEL PIPE, ***** THICK, GRADE B NOT IN SOIL (24", 0.500")	68 LF		
0025	0995000000-E	340	PIPE REMOVAL	812 LF		
0026	1099500000-E	505	SHALLOW UNDERCUT	1,930 CY		
0027	1099700000-E	505	CLASS IV SUBGRADE STABILIZATION	4,090 TON		
0028	1121000000-E	520	AGGREGATE BASE COURSE	2,627 TON		
0029	1220000000-E	545	INCIDENTAL STONE BASE	1,000 TON		
0030	1275000000-E	600	PRIME COAT	1,594 GAL		
0031	1297000000-E	607	MILLING ASPHALT PAVEMENT, ***** DEPTH (1-1/2")	17,220 SY		
0032	1297000000-E	607	MILLING ASPHALT PAVEMENT, ***** DEPTH (3/4")	6,540 SY		
0033	1330000000-E	607	INCIDENTAL MILLING	2,280 SY		

County: ROCKINGHAM

Line #	Item Number	Sec #	Description	Quantity	Unit Cost	Amount
0034	1491000000-E	610	ASPHALT CONC BASE COURSE, TYPE B25.0C	13,130 TON		
0035	1503000000-E	610	ASPHALT CONC INTERMEDIATE COURSE, TYPE I19.0C	11,270 TON		
0036	1519000000-E	610	ASPHALT CONC SURFACE COURSE, TYPE S9.5B	4,580 TON		
0037	1523000000-E	610	ASPHALT CONC SURFACE COURSE, TYPE S9.5C	6,540 TON		
0038	1575000000-E	620	ASPHALT BINDER FOR PLANT MIX	1,820 TON		
0039	1577000000-E	620	POLYMER MODIFIED ASPHALT BINDER FOR PLANT MIX	20 TON		
0040	1662000000-E	650	OPEN-GRADED ASPHALT FRICTION COURSE, TYPE FC-1 MODIFIED	340 TON		
0041	1693000000-E	654	ASPHALT PLANT MIX, PAVEMENT REPAIR	960 TON		
0042	1840000000-E	665	MILLED RUMBLE STRIPS (ASPHALT CONCRETE)	10,000 LF		
0043	2022000000-E	815	SUBDRAIN EXCAVATION	90 CY		
0044	2026000000-E	815	GEOTEXTILE FOR SUBSURFACE DRAINS	400 SY		
0045	2036000000-E	815	SUBDRAIN COARSE AGGREGATE	68 CY		
0046	2044000000-E	815	6" PERFORATED SUBDRAIN PIPE	400 LF		
0047	2070000000-N	815	SUBDRAIN PIPE OUTLET	2 EA		
0048	2077000000-E	815	6" OUTLET PIPE	12 LF		
0049	2209000000-E	838	ENDWALLS	1.4 CY		
0050	2253000000-E	840	PIPE COLLARS	0.446 CY		

County: ROCKINGHAM

Line #	Item Number	Sec #	Description	Quantity	Unit Cost	Amount
0051	2275000000-E	SP	FLOWABLE FILL	47 CY		
0052	2286000000-N	840	MASONRY DRAINAGE STRUCTURES	53 EA		
0053	2308000000-E	840	MASONRY DRAINAGE STRUCTURES	12.8 LF		
0054	2364000000-N	840	FRAME WITH TWO GRATES, STD 840.16	9 EA		
0055	2364200000-N	840	FRAME WITH TWO GRATES, STD 840.20	11 EA		
0056	2365000000-N	840	FRAME WITH TWO GRATES, STD 840.22	11 EA		
0057	2367000000-N	840	FRAME WITH TWO GRATES, STD 840.29	1 EA		
0058	2374000000-N	840	FRAME WITH GRATE & HOOD, STD 840.03, TYPE ** (F)	10 EA		
0059	2374000000-N	840	FRAME WITH GRATE & HOOD, STD 840.03, TYPE ** (G)	11 EA		
0060	2396000000-N	840	FRAME WITH COVER, STD 840.54	7 EA		
0061	2451000000-N	852	CONCRETE TRANSITIONAL SECTION FOR DROP INLET	9 EA		
0062	2549000000-E	846	2'-6" CONCRETE CURB & GUTTER	2,980 LF		
0063	2556000000-E	846	SHOULDER BERM GUTTER	350 LF		
0064	2612000000-E	848	6" CONCRETE DRIVEWAY	40 SY		
0065	2619000000-E	850	4" CONCRETE PAVED DITCH	310 SY		
0066	2655000000-E	852	5" MONOLITHIC CONCRETE ISLANDS (KEYED IN)	1,970 SY		
0067	2724000000-E	857	PRECAST REINFORCED CONCRETE BARRIER, SINGLE FACED	1,250 LF		

County: ROCKINGHAM

Line #	Item Number	Sec #	Description	Quantity	Unit Cost	Amount
0068	2815000000-N	858	ADJUSTMENT OF DROP INLETS	2 EA		
0069	2905000000-N	859	CONVERT EXISTING DROP INLET TO JUNCTION BOX	3 EA		
0070	3001000000-N	SP	IMPACT ATTENUATOR UNITS, TYPE TL-3	4 EA		
0071	3030000000-E	862	STEEL BEAM GUARDRAIL	1,237.5 LF		
0072	3150000000-N	862	ADDITIONAL GUARDRAIL POSTS	10 EA		
0073	3210000000-N	862	GUARDRAIL END UNITS, TYPE CAT-1	5 EA		
0074	3215000000-N	SP	GUARDRAIL ANCHOR UNITS, TYPE III	4 EA		
0075	3287000000-N	SP	GUARDRAIL END UNITS, TYPE TL-3	9 EA		
0076	3317000000-N	SP	GUARDRAIL ANCHOR UNITS, TYPE B-77	16 EA		
0077	3360000000-E	863	REMOVE EXISTING GUARDRAIL	3,640 LF		
0078	3365000000-E	863	REMOVE EXISTING GUIDERAIL	1,923 LF		
0079	3380000000-E	862	TEMPORARY STEEL BEAM GUARDRAIL	150 LF		
0080	3387000000-N	SP	TEMPORARY GUARDRAIL ANCHOR UNITS, TYPE ***** (TYPE III)	1 EA		
0081	3389150000-N	SP	TEMPORARY GUARDRAIL END UNITS, TYPE ***** (TL-2)	1 EA		
0082	3389200000-E	865	CABLE GUIDERAIL	1,732 LF		
0083	3389500000-N	865	ADDITIONAL GUIDERAIL POSTS	10 EA		
0084	3389600000-N	865	CABLE GUIDERAIL ANCHOR UNITS	12 EA		



County: ROCKINGHAM

Line #	Item Number	Sec #	Description	Quantity	Unit Cost	Amount
0085	3628000000-E	876	RIP RAP, CLASS I	43 TON		
0086	3649000000-E	876	RIP RAP, CLASS B	185 TON		
0087	3656000000-E	876	GEOTEXTILE FOR DRAINAGE	2,119 SY		
0088	4025000000-E	901	CONTRACTOR FURNISHED, TYPE *** SIGN (D)	180 SF		
0089	4025000000-E	901	CONTRACTOR FURNISHED, TYPE *** SIGN (E)	434 SF		
0090	4025000000-E	901	CONTRACTOR FURNISHED, TYPE *** SIGN (F)	271 SF		
0091	4072000000-E	903	SUPPORTS, 3-LB STEEL U-CHANNEL	1,961 LF		
0092	4096000000-N	904	SIGN ERECTION, TYPE D	12 EA		
0093	4102000000-N	904	SIGN ERECTION, TYPE E	74 EA		
0094	4108000000-N	904	SIGN ERECTION, TYPE F	14 EA		
0095	4116100000-N	904	SIGN ERECTION, RELOCATE TYPE **** (GROUND MOUNTED) TYPE E GROUND MOUNTED	1 EA		
0096	4155000000-N	907	DISPOSAL OF SIGN SYSTEM, U- CHANNEL	84 EA		
0097	4400000000-E	1110	WORK ZONE SIGNS (STATIONARY)	1,736 SF		
0098	4405000000-E	1110	WORK ZONE SIGNS (PORTABLE)	736 SF		
0099	4410000000-E	1110	WORK ZONE SIGNS (BARRICADE MOUNTED)	144 SF		
0100	4415000000-N	1115	FLASHING ARROW BOARD	6 EA		

County: ROCKINGHAM

Line #	Item Number	Sec #	Description	Quantity	Unit Cost	Amount
0101	4420000000-N	1120	PORTABLE CHANGEABLE MESSAGE SIGN	10 EA		
0102	4423000000-N	SP	WORK ZONE DIGITAL SPEED LIMIT SIGNS	12 EA		
0103	4430000000-N	1130	DRUMS	365 EA		
0104	4434000000-N	SP	SEQUENTIAL FLASHING WARNING LIGHTS	29 EA		
0105	4435000000-N	1135	CONES	50 EA		
0106	4445000000-E	1145	BARRICADES (TYPE III)	288 LF		
0107	4455000000-N	1150	FLAGGER	82 DAY		
0108	4465000000-N	1160	TEMPORARY CRASH CUSHIONS	20 EA		
0109	4470000000-N	1160	REMOVE & RESET TEMPORARY CRASH CUSHION	20 EA		
0110	4480000000-N	1165	TMA	4 EA		
0111	4485000000-E	1170	PORTABLE CONCRETE BARRIER	9,440 LF		
0112	4490000000-E	1170	PORTABLE CONCRETE BARRIER (ANCHORED)	2,600 LF		
0113	4500000000-E	1170	REMOVE AND RESET PORTABLE CONCRETE BARRIER	2,600 LF		
0114	4505000000-E	1170	REMOVE & RESET PORTABLE CONCRETE BARRIER (ANCHORED)	7,270 LF		
0115	4516000000-N	1180	SKINNY DRUM	75 EA		
0116	4650000000-N	1251	TEMPORARY RAISED PAVEMENT MARKERS	639 EA		
0117	4709000000-E	1205	THERMOPLASTIC PAVEMENT MARKING LINES (24", 90 MILS)	450 LF		

County: ROCKINGHAM

Line #	Item Number	Sec #	Description	Quantity	Unit Cost	Amount
0118	4720000000-E	1205	THERMOPLASTIC PAVEMENT MARKING CHARACTER (90 MILS)	12 EA		
0119	4725000000-E	1205	THERMOPLASTIC PAVEMENT MARKING SYMBOL (90 MILS)	98 EA		
0120	4810000000-E	1205	PAINT PAVEMENT MARKING LINES (4")	39,443 LF		
0121	4815000000-E	1205	PAINT PAVEMENT MARKING LINES (6")	78,723 LF		
0122	4820000000-E	1205	PAINT PAVEMENT MARKING LINES (8")	548 LF		
0123	4825000000-E	1205	PAINT PAVEMENT MARKING LINES (12")	834 LF		
0124	4835000000-E	1205	PAINT PAVEMENT MARKING LINES (24")	690 LF		
0125	4840000000-N	1205	PAINT PAVEMENT MARKING CHARACTER	32 EA		
0126	4845000000-N	1205	PAINT PAVEMENT MARKING SYMBOL	218 EA		
0127	4847096000-E	SP	POLYUREA PAVEMENT MARKING LINES, ***, ** MILS (STANDARD GLASS BEADS) (12", 20 MILS)	1,085 LF		
0128	4847096000-E	SP	POLYUREA PAVEMENT MARKING LINES, ***, ** MILS (STANDARD GLASS BEADS) (4", 20 MILS)	22,783 LF		
0129	4847096000-E	SP	POLYUREA PAVEMENT MARKING LINES, ***, ** MILS (STANDARD GLASS BEADS) (6", 20 MILS)	19,608 LF		
0130	4847096000-E	SP	POLYUREA PAVEMENT MARKING LINES, ***, ** MILS (STANDARD GLASS BEADS) (8", 20 MILS)	784 LF		
0131	4850000000-E	1205	REMOVAL OF PAVEMENT MARKING LINES (4")	18,580 LF		
0132	4890000000-E	SP	GENERIC PAVEMENT MARKING ITEM PAINT PAVEMENT MARKING LINES, 12" BLACK	111,466 LF		

County: ROCKINGHAM

Line #	Item Number	Sec #	Description	Quantity	Unit Cost	Amount
0133	4890000000-E	SP	GENERIC PAVEMENT MARKING ITEM POLYUREA PAVEMENT MARKING LINES, 12" BLACK	111,466 LF		
0134	4900000000-N	1251	PERMANENT RAISED PAVEMENT MARKERS	30 EA		
0135	4905100000-N	SP	NON-CAST IRON SNOWPLOWABLE PAVEMENT MARKER	362 EA		
0136	5155000000-E	1409	ELECTRICAL DUCT, TYPE BD, SIZE ***** (2" )	900 LF		
0137	5165000000-E	1410	** #10 W/G FEEDER CIRCUIT (2)	575 LF		
0138	5240000000-N	1411	ELECTRICAL JUNCTION BOXES ***** (IG18)	6 EA		
0139	5255000000-N	1413	PORTABLE LIGHTING	Lump Sum	L.S.	
0140	5326200000-E	1510	12" WATER LINE	2,905 LF		
0141	5329000000-E	1510	DUCTILE IRON WATER PIPE FITTINGS	6,490 LB		
0142	5540000000-E	1515	6" VALVE	2 EA		
0143	5558000000-E	1515	12" VALVE	2 EA		
0144	5572200000-E	1515	12" TAPPING SLEEVE & VALVE	3 EA		
0145	5589200000-E	1515	2" AIR RELEASE VALVE	4 EA		
0146	5648000000-N	1515	RELOCATE WATER METER	4 EA		
0147	5649000000-N	1515	RECONNECT WATER METER	1 EA		
0148	5672000000-N	1515	RELOCATE FIRE HYDRANT	2 EA		
0149	5673000000-E	1515	FIRE HYDRANT LEG	24 LF		

County: ROCKINGHAM

Line #	Item Number	Sec #	Description	Quantity	Unit Cost	Amount
0150	5679000000-E	1515	12" LINE STOP	2 EA		
0151	5686500000-E	1515	WATER SERVICE LINE	250 LF		
0152	5804000000-E	1530	ABANDON 12" UTILITY PIPE	2,675 LF		
0153	5836000000-E	1540	24" ENCASEMENT PIPE	370 LF		
0154	5872500000-E	1550	BORE AND JACK OF *** (24")	370 LF		
0155	6000000000-E	1605	TEMPORARY SILT FENCE	8,300 LF		
0156	6006000000-E	1610	STONE FOR EROSION CONTROL, CLASS A	1,190 TON		
0157	6009000000-E	1610	STONE FOR EROSION CONTROL, CLASS B	1,320 TON		
0158	6012000000-E	1610	SEDIMENT CONTROL STONE	1,375 TON		
0159	6015000000-E	1615	TEMPORARY MULCHING	24.5 ACR		
0160	6018000000-E	1620	SEED FOR TEMPORARY SEEDING	1,400 LB		
0161	6021000000-E	1620	FERTILIZER FOR TEMPORARY SEEDING	8 TON		
0162	6024000000-E	1622	TEMPORARY SLOPE DRAINS	400 LF		
0163	6029000000-E	SP	SAFETY FENCE	720 LF		
0164	6030000000-E	1630	SILT EXCAVATION	4,370 CY		
0165	6036000000-E	1631	MATTING FOR EROSION CONTROL	48,800 SY		
0166	6037000000-E	SP	COIR FIBER MAT	35 SY		

County: ROCKINGHAM

Line #	Item Number	Sec #	Description	Quantity	Unit Cost	Amount
0167	6042000000-E	1632	1/4" HARDWARE CLOTH	2,300 LF		
0168	6071010000-E	SP	WATTLE	2,150 LF		
0169	6071020000-E	SP	POLYACRYLAMIDE (PAM)	1,225 LB		
0170	6071030000-E	1640	COIR FIBER BAFFLE	550 LF		
0171	6071050000-E	SP	*** SKIMMER (1-1/2")	3 EA		
0172	6084000000-E	1660	SEEDING & MULCHING	24 ACR		
0173	6087000000-E	1660	MOWING	15 ACR		
0174	6090000000-E	1661	SEED FOR REPAIR SEEDING	300 LB		
0175	6093000000-E	1661	FERTILIZER FOR REPAIR SEEDING	0.5 TON		
0176	6096000000-E	1662	SEED FOR SUPPLEMENTAL SEEDING	525 LB		
0177	6108000000-E	1665	FERTILIZER TOPDRESSING	15.5 TON		
0178	6114500000-N	1667	SPECIALIZED HAND MOWING	45 MHR		
0179	6114800000-N	SP	MANUAL LITTER REMOVAL	7 MHR		
0180	6114900000-E	SP	LITTER DISPOSAL	1 TON		
0181	6117000000-N	SP	RESPONSE FOR EROSION CONTROL	150 EA		
0182	6117500000-N	SP	CONCRETE WASHOUT STRUCTURE	12 EA		
0183	6132000000-N	SP	GENERIC EROSION CONTROL ITEM FABRIC INSERT INLET PROTECTION DEVICE	30 EA		

County: ROCKINGHAM

Line #	Item Number	Sec #	Description	Quantity	Unit Cost	Amount
0184	6132000000-N	SP	GENERIC EROSION CONTROL ITEM FABRIC INSERT INLET PROTECTION DEVICE CLEANOUT	86 EA		
0185	7060000000-E	1705	SIGNAL CABLE	7,975 LF		
0186	7120000000-E	1705	VEHICLE SIGNAL HEAD (12", 3 SECTION)	48 EA		
0187	7132000000-E	1705	VEHICLE SIGNAL HEAD (12", 4 SECTION)	9 EA		
0188	7144000000-E	1705	VEHICLE SIGNAL HEAD (12", 5 SECTION)	3 EA		
0189	7180000000-N	1706	BACKPLATE	11 EA		
0190	7252000000-E	1710	MESSENGER CABLE (1/4")	960 LF		
0191	7264000000-E	1710	MESSENGER CABLE (3/8")	2,975 LF		
0192	7279000000-E	1715	TRACER WIRE	680 LF		
0193	7300000000-E	1715	UNPAVED TRENCHING (***** (1, 2")	2,225 LF		
0194	7300000000-E	1715	UNPAVED TRENCHING (***** (2, 2")	595 LF		
0195	7300000000-E	1715	UNPAVED TRENCHING (***** (3, 2")	75 LF		
0196	7301000000-E	1715	DIRECTIONAL DRILL (***** (2, 2")	210 LF		
0197	7312000000-N	1716	JUNCTION BOX (***** (SPECIAL OVERSIZED, 36" X 24" X 24")	1 EA		
0198	7324000000-N	1716	JUNCTION BOX (STANDARD SIZE)	30 EA		
0199	7348000000-N	1716	JUNCTION BOX (OVER-SIZED, HEAVY DUTY)	5 EA		
0200	7360000000-N	1720	WOOD POLE	8 EA		

County: ROCKINGHAM

Line #	Item Number	Sec #	Description	Quantity	Unit Cost	Amount
0201	7372000000-N	1721	GUY ASSEMBLY	16 EA		
0202	7408000000-E	1722	1" RISER WITH WEATHERHEAD	3 EA		
0203	7420000000-E	1722	2" RISER WITH WEATHERHEAD	9 EA		
0204	7432000000-E	1722	2" RISER WITH HEAT SHRINK TUBING	1 EA		
0205	7444000000-E	1725	INDUCTIVE LOOP SAWCUT	2,450 LF		
0206	7456000000-E	1726	LEAD-IN CABLE (***** (14-2)	8,975 LF		
0207	7481000000-N	SP	SITE SURVEY	12 EA		
0208	7481240000-N	SP	CAMERA WITHOUT INTERNAL LOOP EMULATOR PROCESSING UNIT	19 EA		
0209	7481260000-N	SP	EXTERNAL LOOP EMULATOR PROCESSING UNIT	5 EA		
0210	7516000000-E	1730	COMMUNICATIONS CABLE (** FIBER) (24)	2,500 LF		
0211	7528000000-E	1730	DROP CABLE	820 LF		
0212	7540000000-N	1731	SPLICE ENCLOSURE	4 EA		
0213	7552000000-N	1731	INTERCONNECT CENTER	4 EA		
0214	7575160000-E	1734	REMOVE EXISTING COMMUNICATIONS CABLE	1,650 LF		
0215	7576000000-N	SP	METAL STRAIN SIGNAL POLE	16 EA		
0216	7613000000-N	SP	SOIL TEST	16 EA		
0217	7614100000-E	SP	DRILLED PIER FOUNDATION	104 CY		



County: ROCKINGHAM

Line #	Item Number	Sec #	Description	Quantity	Unit Cost	Amount
0218	7636000000-N	1745	SIGN FOR SIGNALS	17 EA		
0219	7684000000-N	1750	SIGNAL CABINET FOUNDATION	4 EA		
0220	7696000000-N	1751	CONTROLLERS WITH CABINET (*****) (2070LX, BASE MOUNTED)	4 EA		
0221	7744000000-N	1751	DETECTOR CARD (TYPE 170)	24 EA		
0222	7901000000-N	1753	CABINET BASE EXTENDER	4 EA		
0223	7980000000-N	SP	GENERIC SIGNAL ITEM 2070LX CONTROLLER	1 EA		
0224	7980000000-N	SP	GENERIC SIGNAL ITEM ETHERNET EDGE SWITCH	4 EA		
0225	7980000000-N	SP	GENERIC SIGNAL ITEM MICROWAVE VEHICLE DETECTOR- SINGLE ZONE	3 EA		
<b>WALL ITEMS</b>						
0226	8801000000-E	SP	MSE RETAINING WALL NO **** (1)	3,790 SF		
0227	8801000000-E	SP	MSE RETAINING WALL NO **** (2)	3,370 SF		
0228	8801000000-E	SP	MSE RETAINING WALL NO **** (W1)	3,677 SF		
0229	8801000000-E	SP	MSE RETAINING WALL NO **** (W2)	3,491 SF		
<b>STRUCTURE ITEMS</b>						
0230	8035000000-N	402	REMOVAL OF EXISTING STRUCTURE AT STATION ***** (25+80.88 -L-)	Lump Sum	L.S.	
0231	8035000000-N	402	REMOVAL OF EXISTING STRUCTURE AT STATION ***** (34+73.00-L-)	Lump Sum	L.S.	

County: ROCKINGHAM

Line #	Item Number	Sec #	Description	Quantity	Unit Cost	Amount
0232	8065000000-N	SP	ASBESTOS ASSESSMENT	Lump Sum	L.S.	
0233	8096000000-E	450	PILE EXCAVATION IN SOIL	30 LF		
0234	8097000000-E	450	PILE EXCAVATION NOT IN SOIL	14 LF		
0235	8105540000-E	411	3'-6" DIA DRILLED PIERS IN SOIL	220 LF		
0236	8105560000-E	411	4'-0" DIA DRILLED PIERS IN SOIL	72.3 LF		
0237	8105640000-E	411	3'-6" DIA DRILLED PIERS NOT IN SOIL	22 LF		
0238	8105660000-E	411	4'-0" DIA DRILLED PIERS NOT IN SOIL	104.1 LF		
0239	8112730000-N	450	PDA TESTING	3 EA		
0240	8113000000-N	411	SID INSPECTIONS	1 EA		
0241	8114000000-N	411	SPT TESTING	1 EA		
0242	8115000000-N	411	CSL TESTING	7 EA		
0243	8121000000-N	412	UNCLASSIFIED STRUCTURE EXCAVATION AT STATION ***** (34+73.00-L-)	Lump Sum	L.S.	
0244	8147000000-E	420	REINFORCED CONCRETE DECK SLAB	28,863 SF		
0245	8161000000-E	420	GROOVING BRIDGE FLOORS	31,849 SF		
0246	8182000000-E	420	CLASS A CONCRETE (BRIDGE)	549.8 CY		
0247	8210000000-N	422	BRIDGE APPROACH SLABS, STATION ***** (25+80.88 -L-)	Lump Sum	L.S.	
0248	8210000000-N	422	BRIDGE APPROACH SLABS, STATION ***** (34+73.00-L-)	Lump Sum	L.S.	

County: ROCKINGHAM

Line #	Item Number	Sec #	Description	Quantity	Unit Cost	Amount
0249	8217000000-E	425	REINFORCING STEEL (BRIDGE)	97,370 LB		
0250	8238000000-E	425	SPIRAL COLUMN REINFORCING STEEL (BRIDGE)	14,699 LB		
0251	8265000000-E	430	54" PRESTRESSED CONCRETE GIRDERS	3,050.81 LF		
0252	8328200000-E	450	PILE DRIVING EQUIPMENT SETUP FOR *** STEEL PILES (HP 12 X 53)	56 EA		
0253	8364000000-E	450	HP 12 X 53 STEEL PILES	2,730 LF		
0254	8482000000-E	460	THREE BAR METAL RAIL	337.39 LF		
0255	8503000000-E	460	CONCRETE BARRIER RAIL	370.5 LF		
0256	8531000000-E	462	4" SLOPE PROTECTION	128.1 SY		
0257	8657000000-N	430	ELASTOMERIC BEARINGS	Lump Sum	L.S.	
0258	8692000000-N	SP	FOAM JOINT SEALS	Lump Sum	L.S.	
0259	8860000000-N	SP	GENERIC STRUCTURE ITEM STRIP SEAL EXPANSION JOINTS	Lump Sum	L.S.	
0260	8897000000-N	SP	GENERIC STRUCTURE ITEM CAP END AESTHETIC	2 EA		

0930/Apr13/Q888406.646/D1261141134000/E260

Total Amount Of Bid For Entire Project :

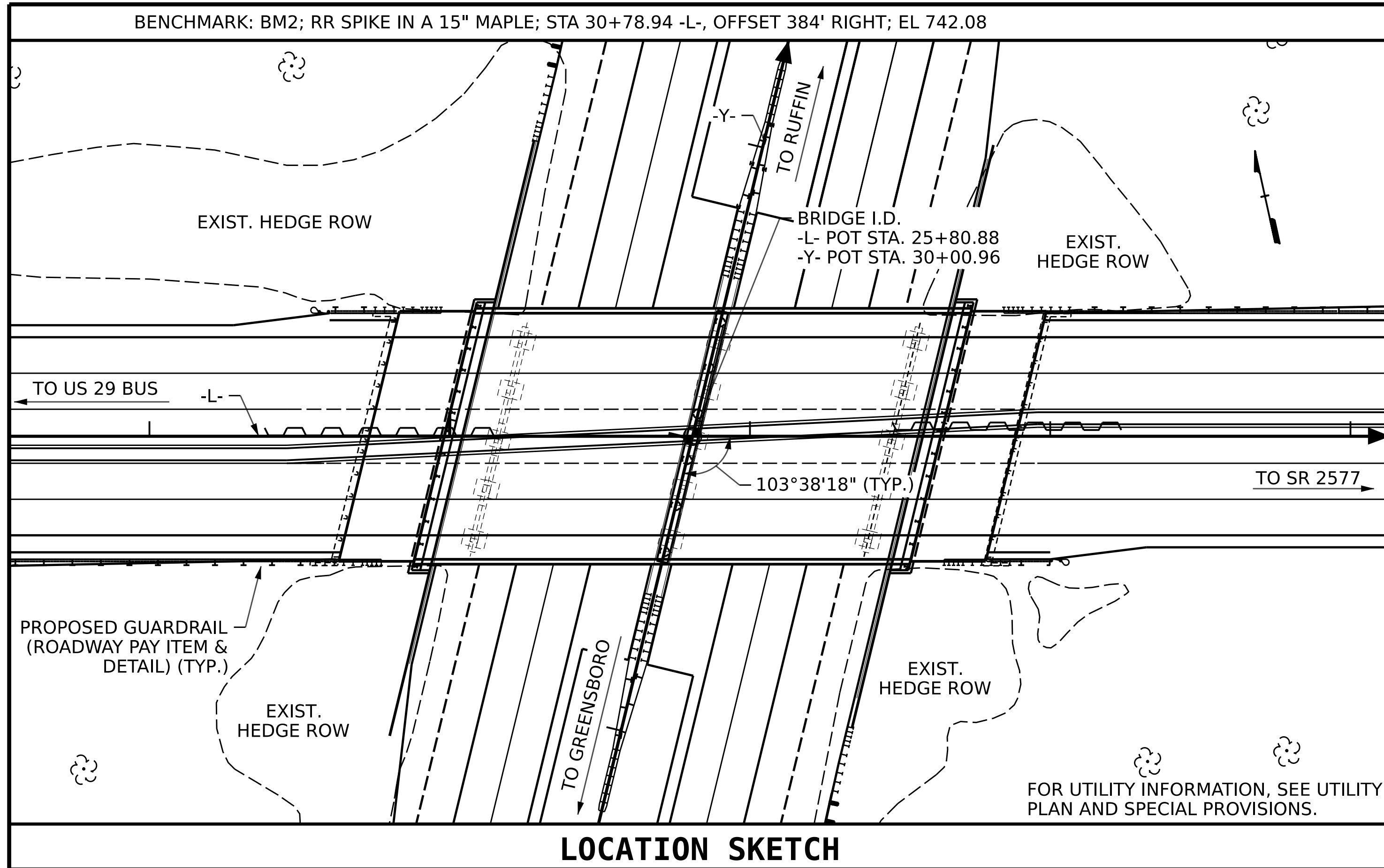

**GENERAL NOTES:**

- ASSUMED LIVE LOAD = HL-93 OR ALTERNATE LOADING.
- THIS BRIDGE HAS BEEN DESIGNED IN ACCORDANCE WITH THE AASHTO LRFD BRIDGE DESIGN SPECIFICATIONS.
- THIS BRIDGE IS LOCATED IN SEISMIC ZONE 1.
- FOR OTHER DESIGN DATA AND GENERAL NOTES, SEE SHEET SN.
- FOR FALSEWORK AND FORMWORK, SEE SPECIAL PROVISIONS.
- FOR SUBMITTAL OF WORKING DRAWINGS, SEE SPECIAL PROVISIONS.
- FOR CRANE SAFETY, SEE SPECIAL PROVISIONS.
- FOR GROUT FOR STRUCTURES, SEE SPECIAL PROVISIONS.
- REMOVABLE FORMS MAY BE USED IN LIEU OF METAL STAY-IN-PLACE FORMS IN ACCORDANCE WITH ARTICLE 420-3 OF THE STANDARD SPECIFICATIONS.
- NEEDLE BEAMS WILL NOT BE ALLOWED UNLESS OTHERWISE CALLED FOR ON THE PLANS OR APPROVED BY THE ENGINEER.
- TEMPORARY SHORING WILL BE REQUIRED IN THE AREAS INDICATED IN THE PLAN VIEW.
- FOR LIMITS OF TEMPORARY SHORING FOR MAINTENANCE OF TRAFFIC, SEE TRAFFIC CONTROL PLANS. FOR PAY ITEM FOR TEMPORARY SHORING FOR MAINTENANCE OF TRAFFIC, SEE ROADWAY PLANS.
- FOR ASBESTOS ASSESSMENT FOR BRIDGE DEMOLITION ACTIVITIES, SEE SPECIAL PROVISIONS.
- FOR EROSION CONTROL MEASURES, SEE EROSION CONTROL PLANS.
- FOR MSE WALLS, SEE GEOTECHNICAL SPECIAL PROVISIONS.
- THE ELEVATIONS AND CLEARANCES SHOWN ON THE PLANS AT THE POINTS OF MINIMUM VERTICAL CLEARANCE ARE FROM THE BEST INFORMATION AVAILABLE. PRIOR TO BEGINNING BRIDGE CONSTRUCTION, VERIFY THE ELEVATIONS ON THE EXISTING PAVEMENT AND CHECK THE CLEARANCE. REPORT ANY VARIATIONS TO THE ENGINEER. ANY PLAN REVISIONS NECESSARY TO ACHIEVE THE REQUIRED MINIMUM VERTICAL CLEARANCE WILL BE PROVIDED BY THE DEPARTMENT.

FOR MAINTENANCE AND PROTECTION OF TRAFFIC BENEATH PROPOSED STRUCTURE, SEE SPECIAL PROVISIONS.

INASMUCH AS THE PAINT SYSTEM ON THE EXISTING STRUCTURAL STEEL CONTAINS LEAD FOR THE EXISTING STRUCTURE, THE CONTRACTOR'S ATTENTION IS DIRECTED TO ARTICLE 107-1 OF THE STANDARD SPECIFICATIONS. ANY COSTS RESULTING FROM COMPLIANCE WITH APPLICABLE STATE OR FEDERAL REGULATIONS PERTAINING TO HANDLING OF MATERIALS CONTAINING LEAD BASED PAINT SHALL BE INCLUDED IN THE BID PRICE FOR "REMOVAL OF EXISTING STRUCTURE AT STATION 25+80.88 -L-".

THE CLASS AA CONCRETE IN THE BRIDGE DECK SHALL CONTAIN FLY ASH OR GROUND GRANULATED BLAST FURNACE SLAG AT THE SUBSTITUTION RATE SPECIFIED IN ARTICLE 1024-1 AND IN ACCORDANCE WITH ARTICLES 1024-5 AND 1024-6 OF THE STANDARD SPECIFICATIONS. NO PAYMENT WILL BE MADE FOR THIS SUBSTITUTION AS IT IS CONSIDERED INCIDENTAL TO THE COST OF THE REINFORCED CONCRETE DECK SLAB.

AFTER SERVING AS A TEMPORARY STRUCTURE, THE EXISTING DUAL STRUCTURES CONSISTING OF A 4 SPAN (43.625' - 64.25' - 64.25' - 40.125') CONCRETE DECK ON ROLLED STEEL W-SHAPE GIRDERS, WITH 76.0 FT CLEAR ROADWAY WIDTH, SUPPORTED BY PILE BENT CONCRETE END BENTS AND CONCRETE POST AND BEAM BENTS ON ISOLATED SPREAD FOOTINGS, AND LOCATED AT THE PROPOSED STRUCTURE SHALL BE REMOVED. THE EXISTING BRIDGE IS PRESENTLY NOT POSTED FOR LOAD LIMIT. SHOULD THE STRUCTURAL INTEGRITY OF THE BRIDGES DETERIORATE DURING CONSTRUCTION OF THE PROPOSED BRIDGE, A LOAD LIMIT MAY BE POSTED AND MAY BE REDUCED AS FOUND NECESSARY DURING THE LIFE OF THE PROJECT.

THE SUBSTRUCTURE OF THE EXISTING BRIDGE INDICATED ON THE PLANS IS FROM THE BEST INFORMATION AVAILABLE. THIS INFORMATION IS SHOWN FOR THE CONVENIENCE OF THE CONTRACTOR. THE CONTRACTOR SHALL HAVE NO CLAIM WHATSOEVER AGAINST THE DEPARTMENT OF TRANSPORTATION FOR ANY DELAYS OR ADDITIONAL COST INCURRED BASED ON DIFFERENCES BETWEEN THE EXISTING BRIDGE SUBSTRUCTURE SHOWN ON THE PLANS AND THE ACTUAL CONDITIONS AT THE PROJECT SITE.

THE LOCATION OF THE CONSTRUCTION JOINT IN THE DRILLED PIERS IS BASED ON AN APPROXIMATE GROUND LINE ELEVATION. IF THE CONSTRUCTION JOINT IS ABOVE THE ACTUAL GROUND ELEVATION, THE CONTRACTOR SHALL PLACE THE CONSTRUCTION JOINT 1 FT. BELOW THE GROUND LINE.

**LOCATION SKETCH**

**TOTAL BILL OF MATERIAL**

	REMOVAL OF EXISTING STRUCTURE AT STA. 25+80.88 -L-	ASEBESTOS ASSESSMENT	3'-6" Ø DRILLED PIERS IN SOIL	3'-6" Ø DRILLED PIERS NOT IN SOIL	PDA TESTING	SID INSPECTIONS	SPT TESTING	CSL TESTING	REINFORCED CONCRETE DECK SLAB	GROOVING BRIDGE FLOORS	CLASS A CONCRETE	BRIDGE APPROACH SLABS
	LUMP SUM	LUMP SUM	LIN. FT.	LIN. FT.	EACH	EACH	EACH	EACH	SQ. FT.	SQ. FT.	CU. YDS.	LUMP SUM
SUPERSTRUCTURE									14,089	16,926		
END BENT 1											76.2	
BENT 1			220.0	22.0							94.9	
END BENT 2											77.1	
TOTAL	LUMP SUM	LUMP SUM	220.0	22.0	2	1	1	1	14,089	16,926	248.2	LUMP SUM

**TOTAL BILL OF MATERIAL**

	REINFORCING STEEL	SPIRAL COLUMN REINFORCING STEEL	54" PRESTRESSED CONCRETE GIRDER	PILE DRIVING EQUIPMENT SETUP FOR HP 12X53 STEEL PILES	HP 12X53 STEEL PILES	CONCRETE BARRIER RAIL	4" SLOPE PROTECTION	ELASTOMERIC BEARINGS	STRIP SEAL EXPANSION JOINTS
	LBS.	LBS.	NO. LIN. FT.	EACH	NO. LIN. FT.	LIN. FT.	SQ. YDS.	LUMP SUM	LUMP SUM
SUPERSTRUCTURE			18 1476.00			370.5			
END BENT 1	10,385			13	13 645		26.9		
BENT 1	22,919	7,302							
END BENT 2	10,638			13	13 655		26.9		
TOTAL	43,942	7,302	18 1476.00	26	26 1,300	370.5	53.8	LUMP SUM	LUMP SUM

PROJECT NO. BR-0043  
ROCKINGHAM COUNTY  
 STATION: POT 25+80.88 -L-  
 SHEET 4 OF 4

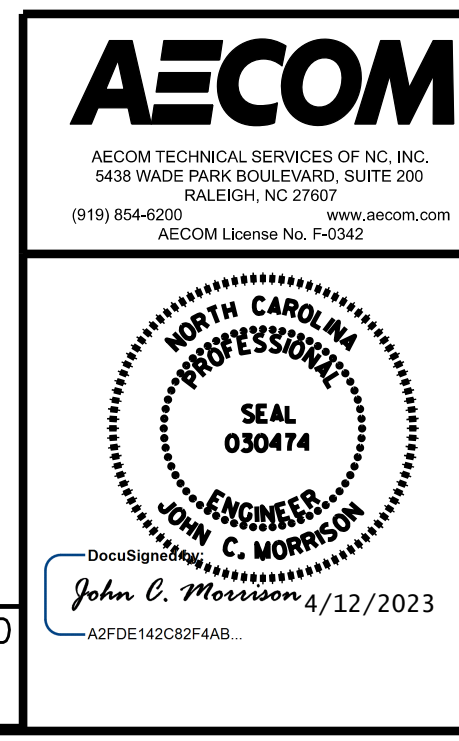

STATE OF NORTH CAROLINA  
 DEPARTMENT OF TRANSPORTATION  
 RALEIGH

**GENERAL DRAWING**

FOR BRIDGE ON US 158 /  
 NC 14 OVER US 29 BETWEEN  
 US 29 BUS & SR 2577

REVISIONS						SHEET NO.
NO.	BY:	DATE:	NO.	BY:	DATE:	TOTAL SHEETS
1			3			45
2			4			

DRAWN BY : A.R. VAN VUREN DATE : 12/2022  
 CHECKED BY : J.C. MORRISON DATE : 12/2022  
 DESIGN ENGINEER OF RECORD: J.C. MORRISON DATE : 12/2022

DOCUMENT NOT CONSIDERED  
 FINAL UNLESS ALL  
 SIGNATURES COMPLETED