

PROJECT REFERENCE NO.	SHEET NO.
R-5751	RW02C-7
Location and Surveys	

SURVEY CONTROL SHEET

W/ EXISTING CENTERLINE ALIGNMENTS PRIOR TO CONSTRUCTION

MATCHLINE SHEET RW02C-6

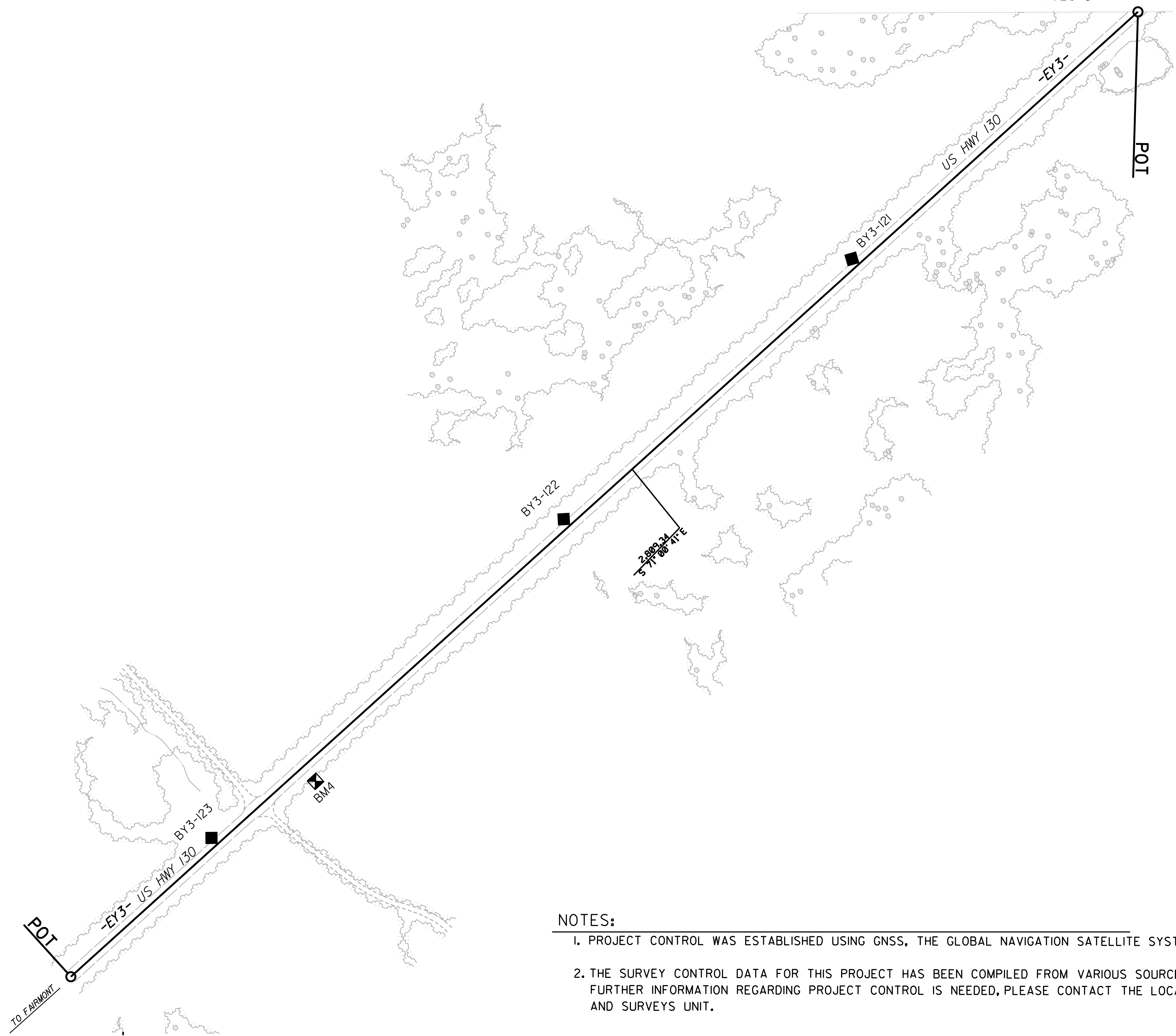
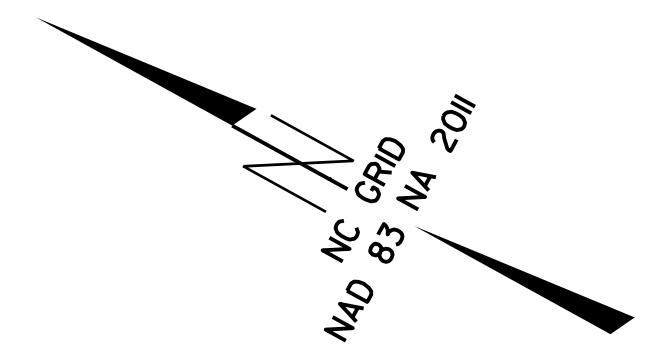

NOTES:

1. PROJECT CONTROL WAS ESTABLISHED USING GNSS, THE GLOBAL NAVIGATION SATELLITE SYSTEM.
2. THE SURVEY CONTROL DATA FOR THIS PROJECT HAS BEEN COMPILED FROM VARIOUS SOURCES. IF FURTHER INFORMATION REGARDING PROJECT CONTROL IS NEEDED, PLEASE CONTACT THE LOCATION AND SURVEYS UNIT.

REVISIONS

6/2/09

30 AUG 2018 16:31 \\f:\proj\SEPI\1R-5751 Revised Control Sheets 8.30.18\final revised files\R5751 revised control sheets 180830\RE5751.rw02c-7_180830.dgn