

RANDOLPH COUNTY
RESURFACING MAP

040397
 04-JAN-2023 15:27
 f:\gis\mxd\2023\2023_Submittal\Randolph_2023_February\2023_Maps_Typ_2.dgn
 20230118 10:00 AM
 20230118 10:00 AM

Map 1

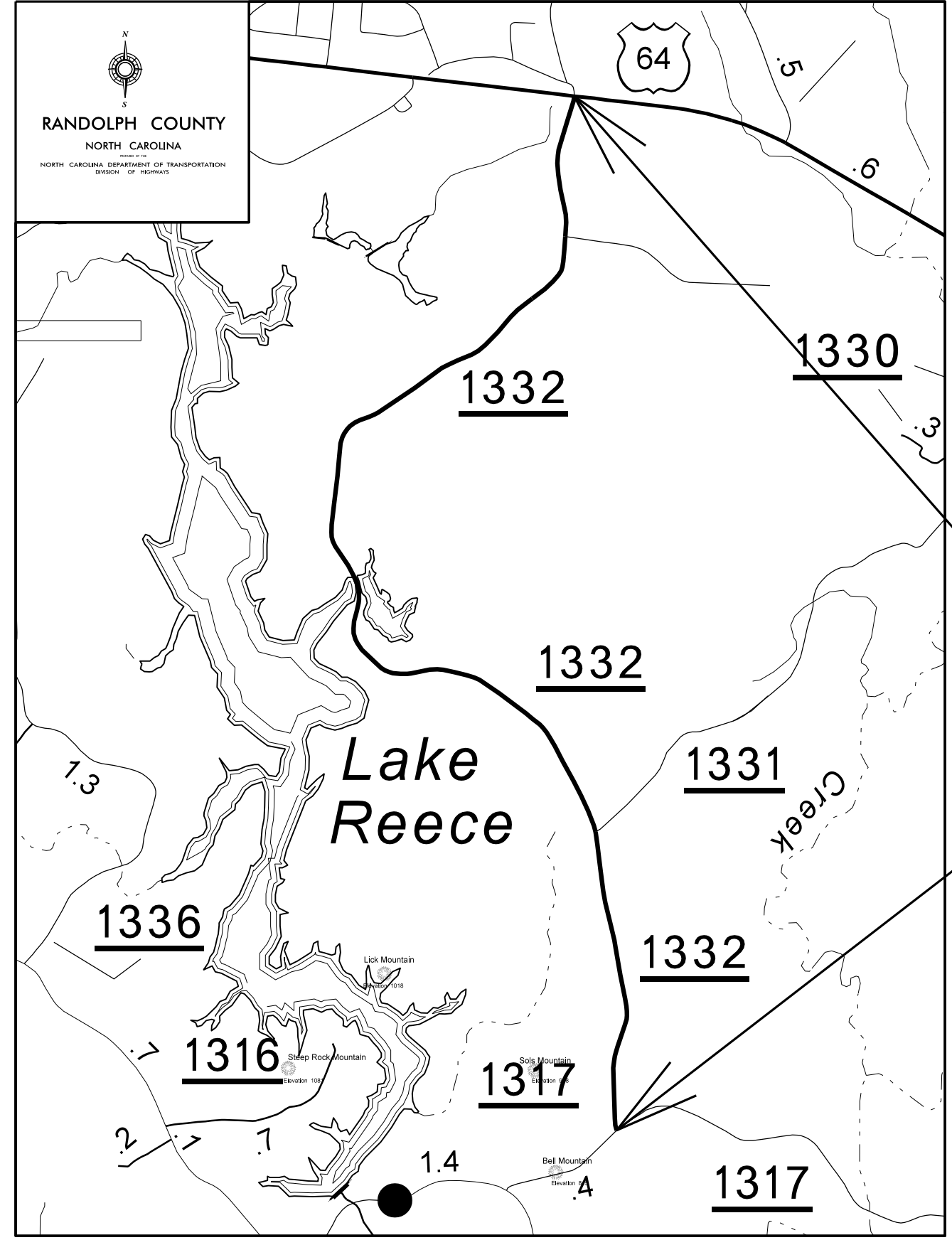

1

Map 2 and 3

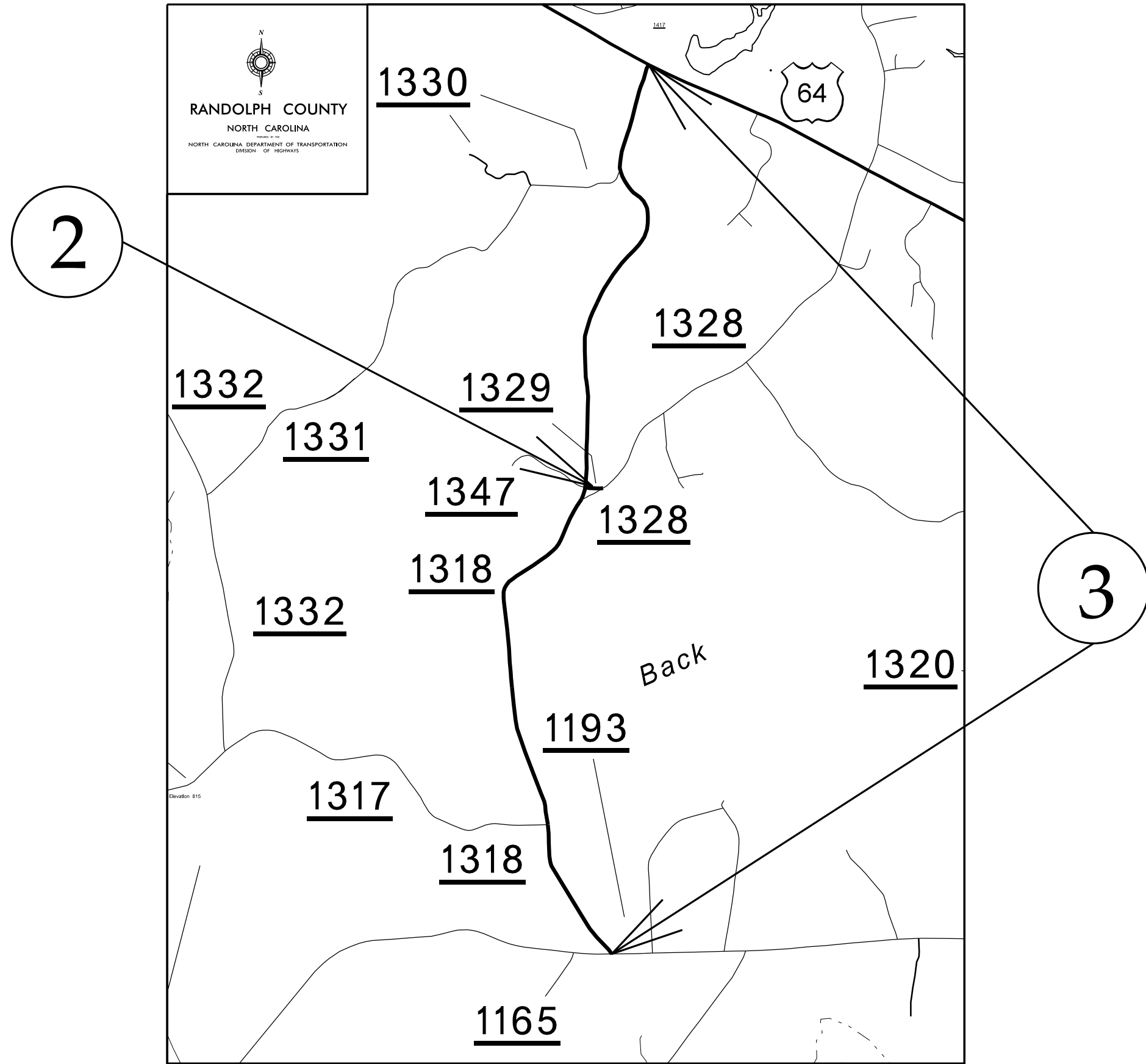

Maps 4 and 7

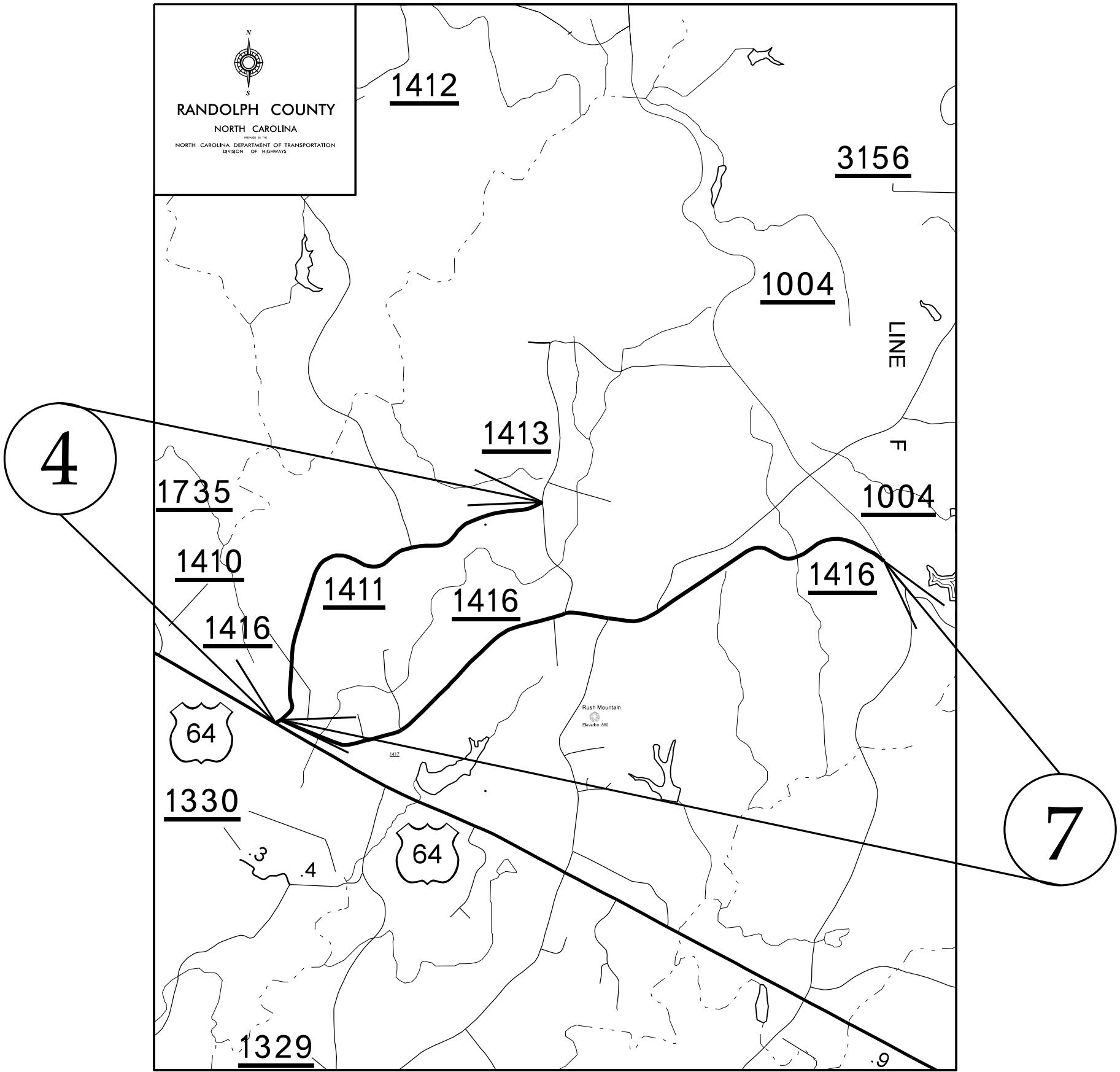

Maps 5 and 6

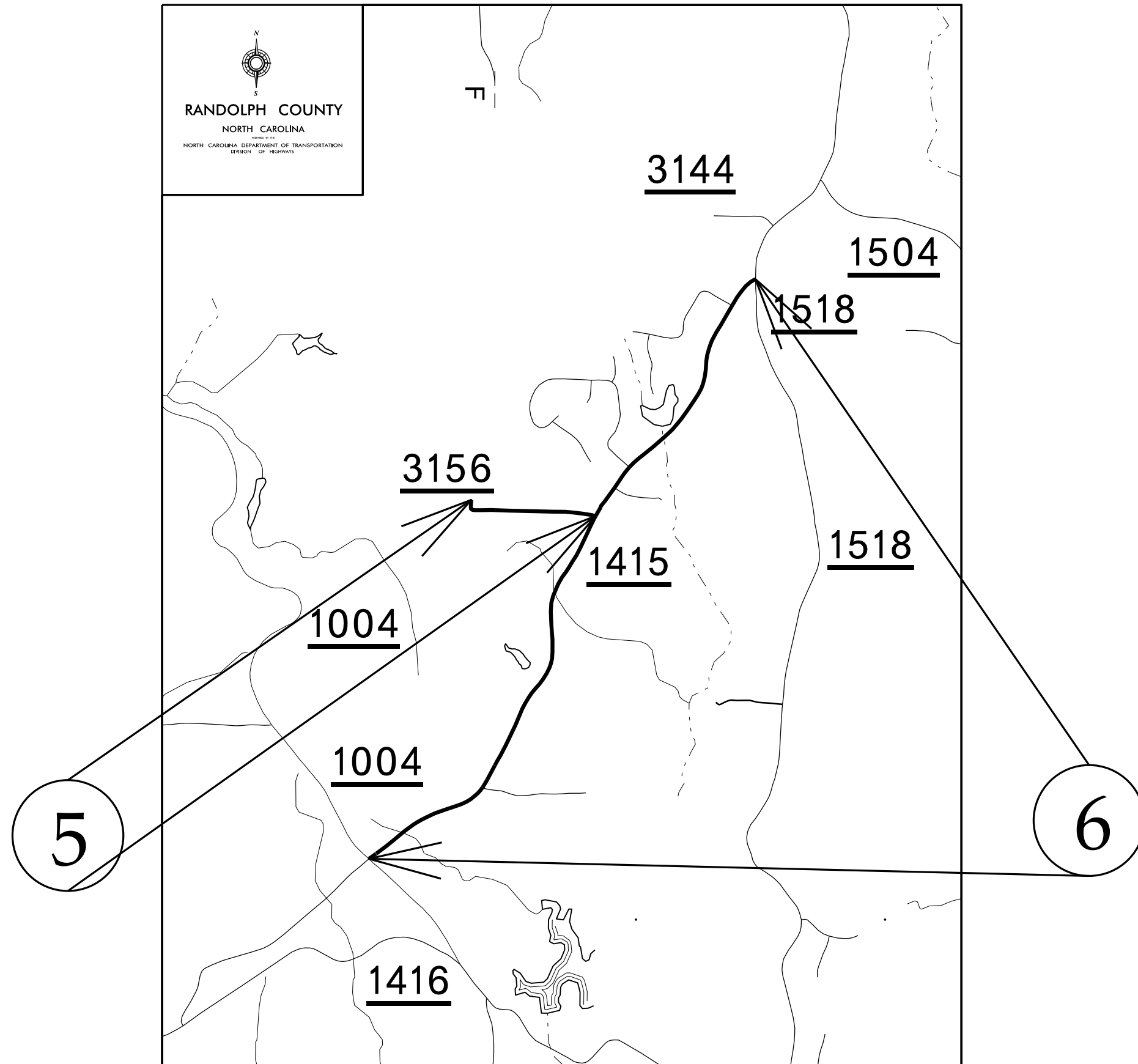

Map 8

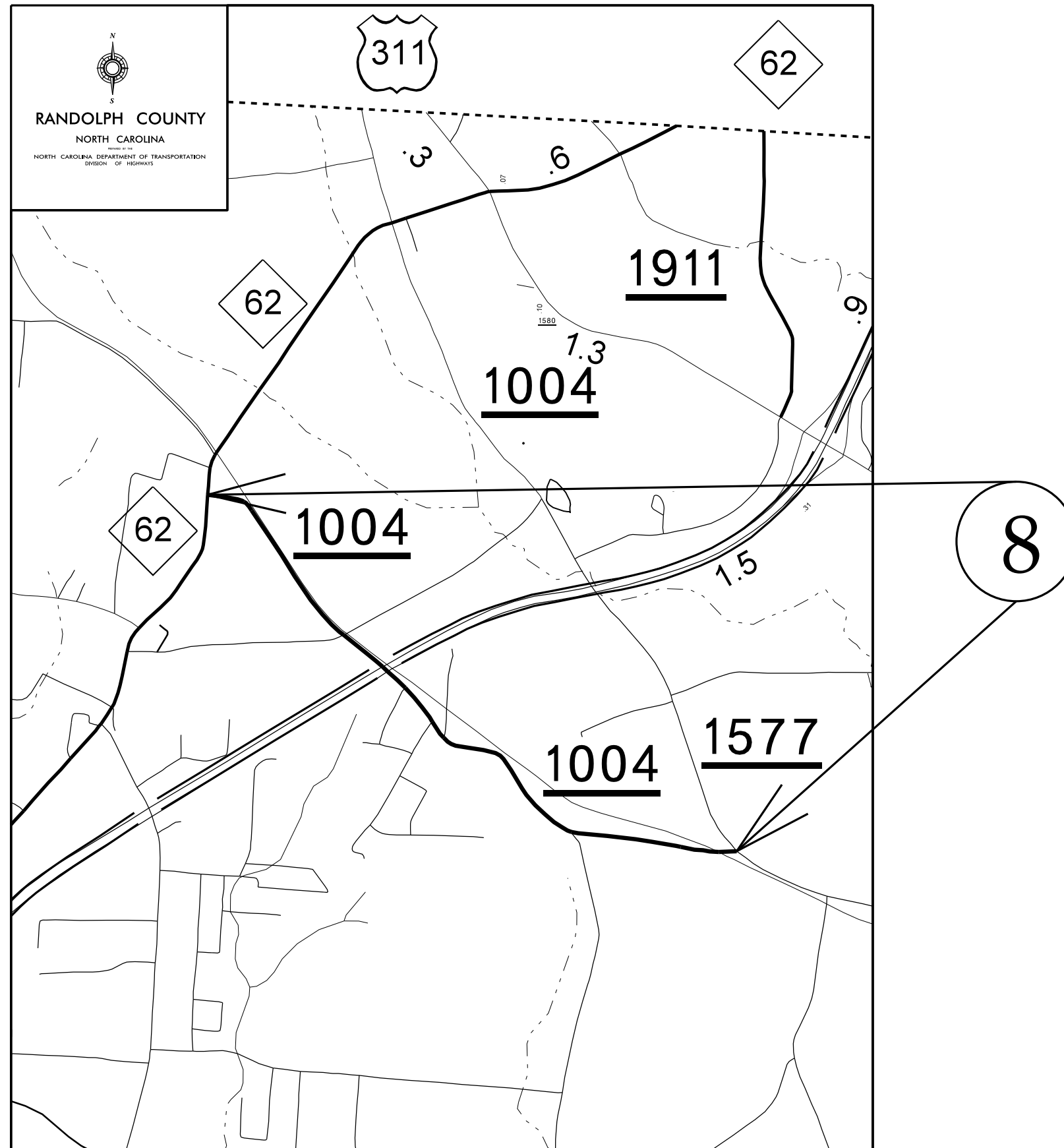

Maps 9 and 10

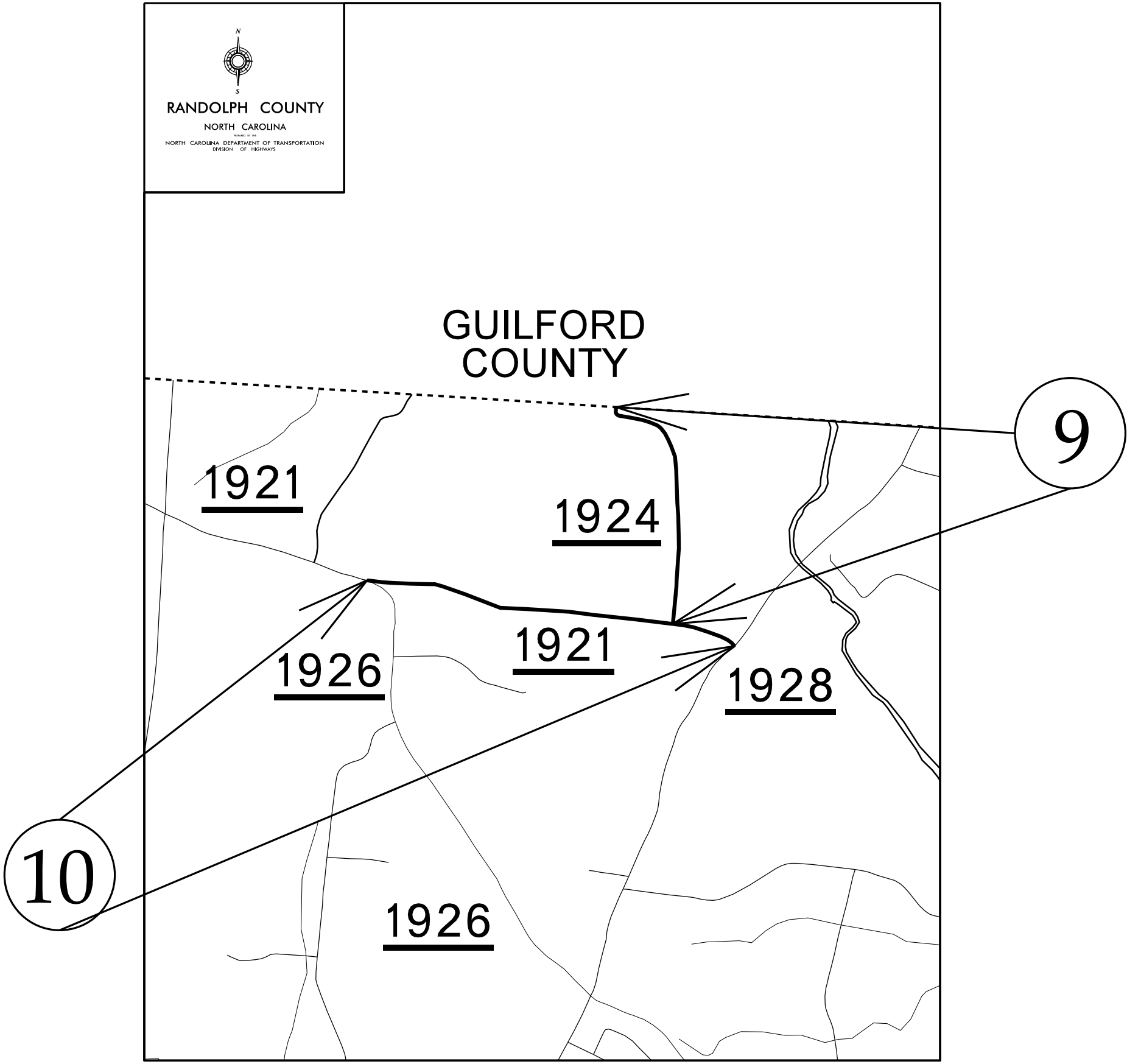

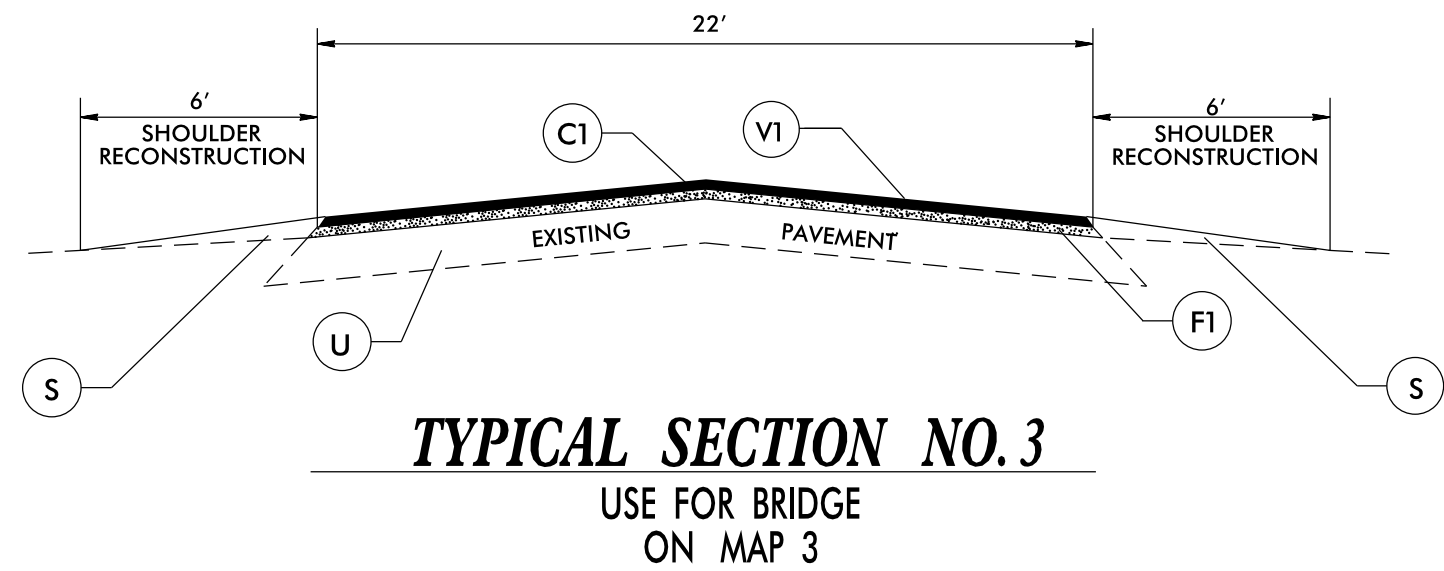
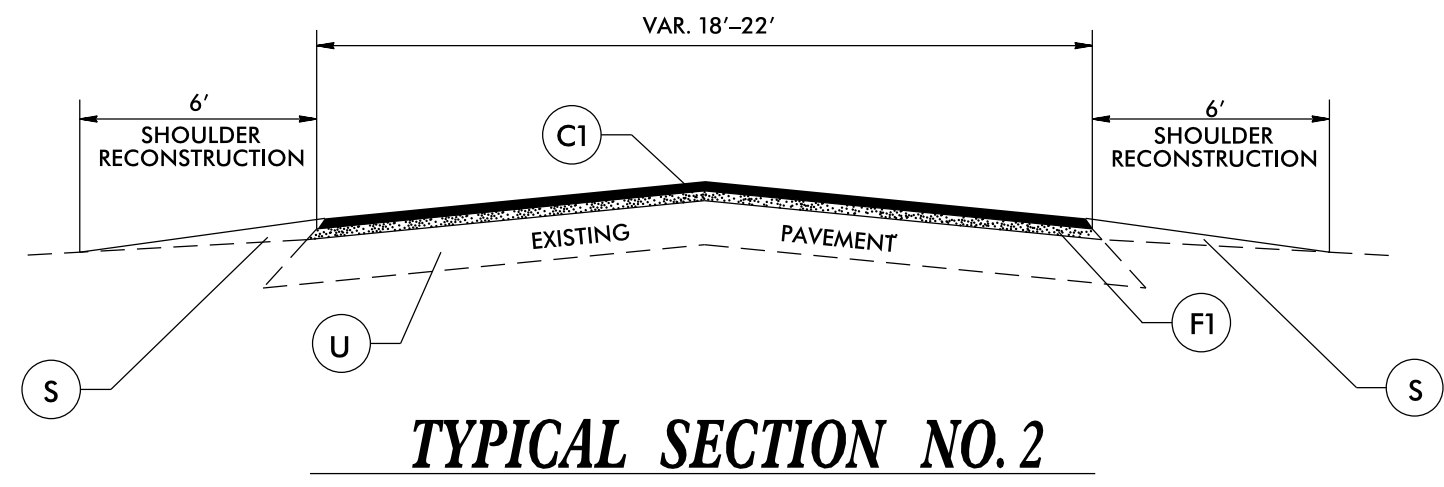
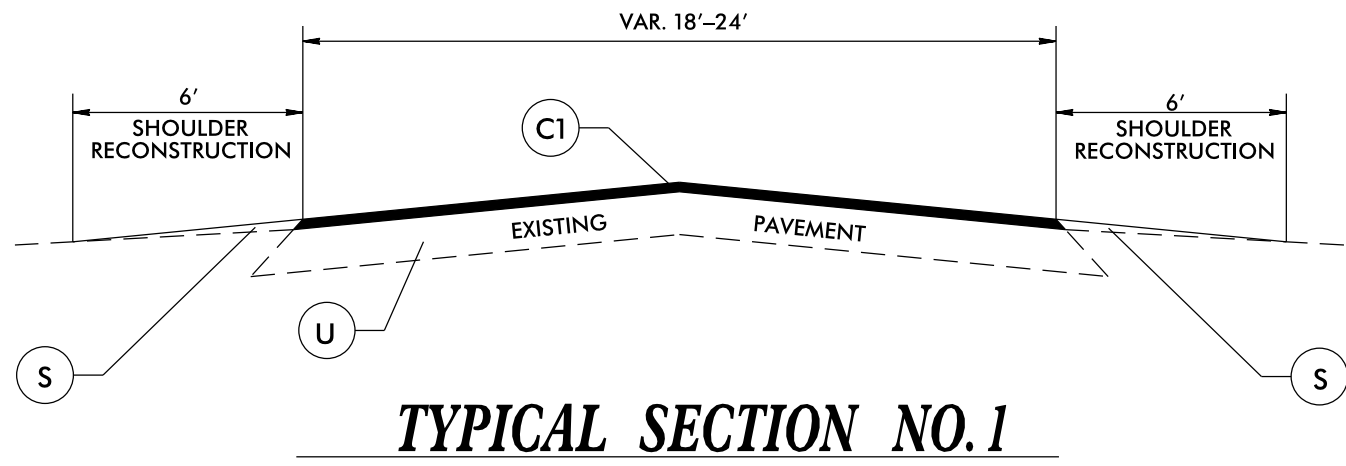

PAVEMENT SCHEDULE	
C1	PROP. APPROX. 1.5" ASPHALT CONCRETE SURFACE COURSE, TYPE S9.5B, AT AN AVERAGE RATE OF 165 LBS. PER SQ. YD.
F1	PROPOSED ASPHALT SURFACE TREATMENT, MAT COAT WITH #67 STONE
S	AGGREGATE SHOULDER BORROW
U	EXISTING PAVEMENT.
V1	MILLING 1.5" IN DEPTH

03-JAN-2023 15:57
 f:\eng\ag\110010101\2023\Submittal\Randolph_February2023_Maps_Typ_2.dgn
 sheet: 8 of 10

BRIDGE DETAILS

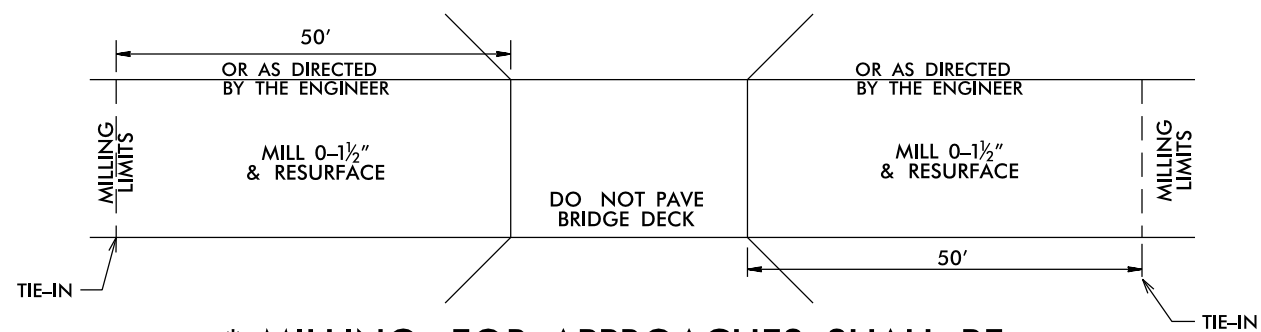

* MILLING FOR APPROACHES SHALL BE PAID FOR UNDER INCIDENTAL MILLING

**BRIDGE DRAWING FOR
MAP #8 SR 1004 TRINITY RD BRIDGE #81**

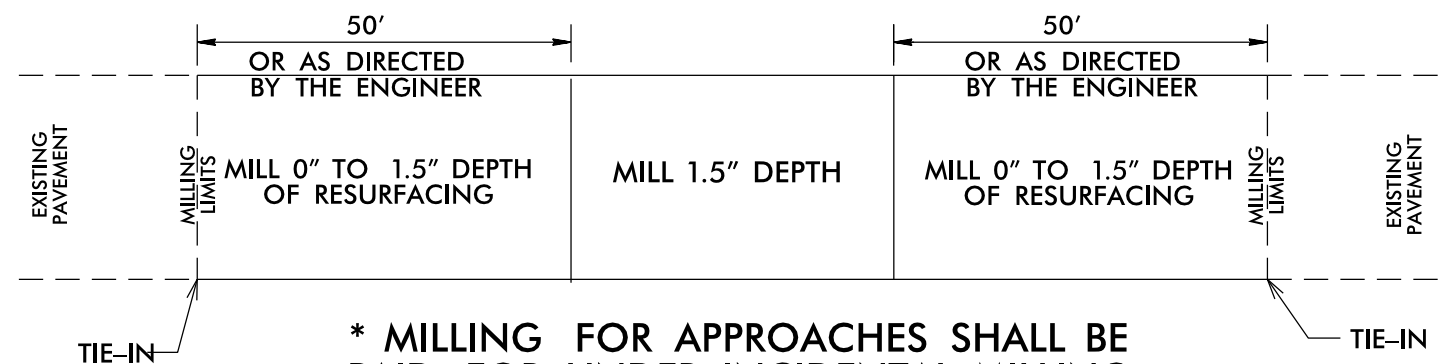

* MILLING FOR APPROACHES SHALL BE PAID FOR UNDER INCIDENTAL MILLING

**BRIDGE DRAWING FOR
MAP #3 SR 1318 MOORE RD BRIDGE #36**

PAVEMENT TIE-IN DETAIL

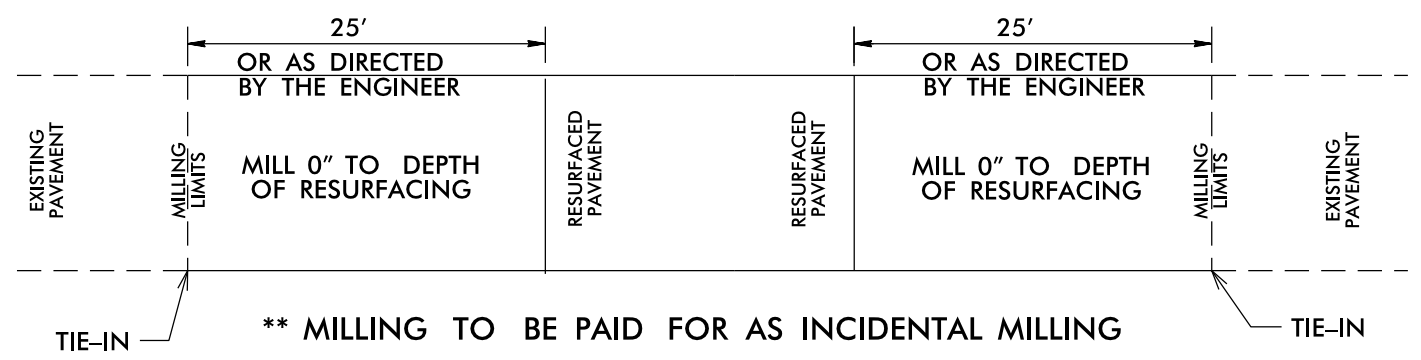

DETAILS OF PATCHING EXISTING PAVEMENT PRIOR TO RESURFACING

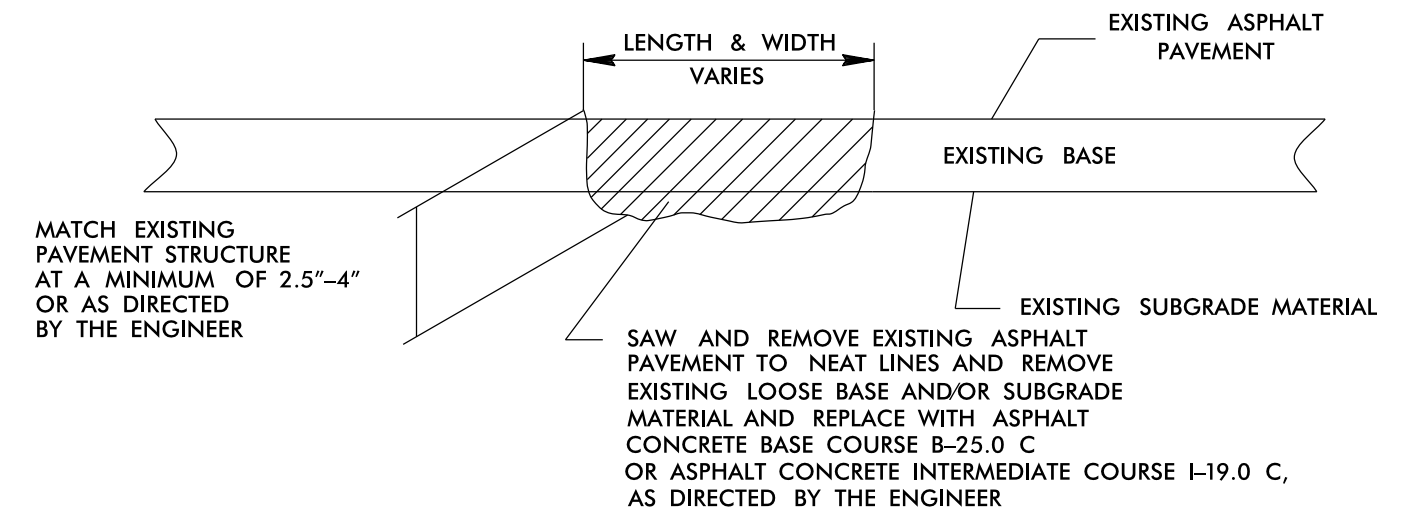

PROJECT NOTES

- ONE COAT OF PAINT MARKINGS TO BE APPLIED ON ALL MAPS. PERMANENT MARKINGS TO BE HANDLED ON A LATER PROJECT.
- PAINT AND LINE REMOVAL ON MAP 8 ARE FOR BRIDGE DECK.

NOTES:

- 1) DETAIL DOES NOT APPLY TO OGAFB AND ULTRA-THIN BONDED WEARING COURSE.
- 2) BACKFILL SHOULDER WITH APPROVED MATERIAL.
- 3) THE SHOULDER WEDGE DEVICE MAY BE DISENGAGED AT PAVED DRIVEWAYS, SIDE STREETS, HIGH SHOULDERS, AND OTHER LOCATIONS NOT FEASIBLE TO CONSTRUCT AS APPROVED BY THE ENGINEER.

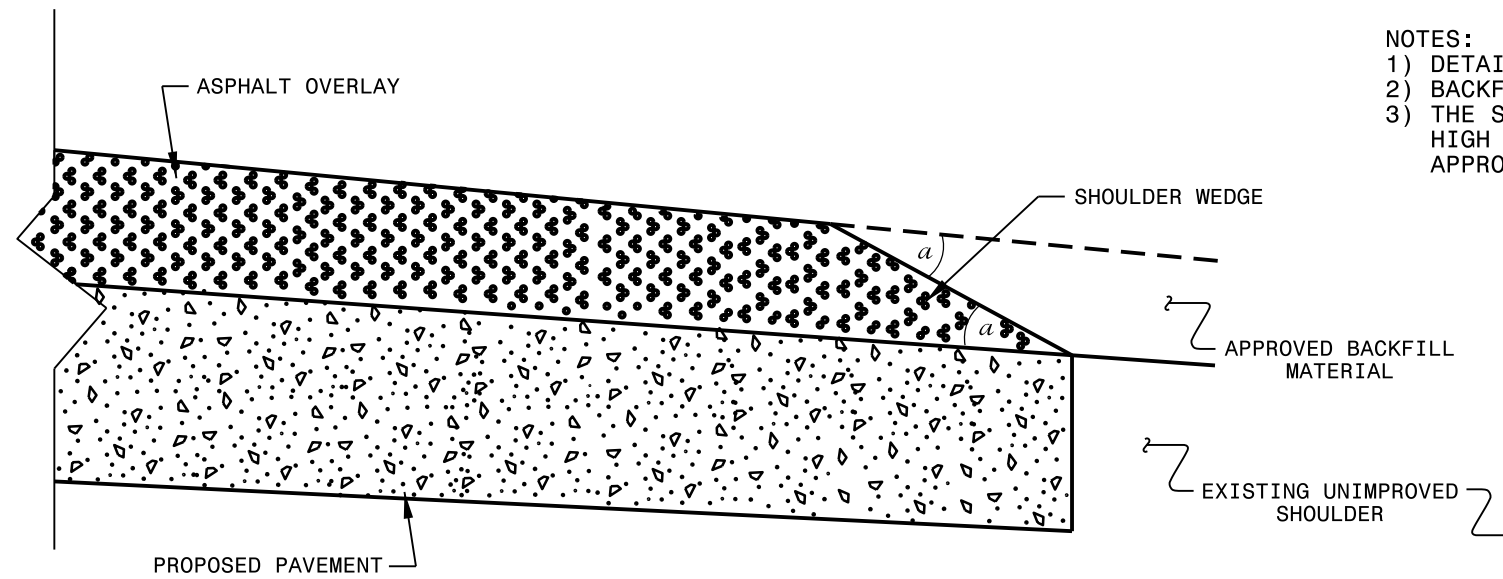

SHOULDER WEDGE DETAIL

(Resurfacing Projects w/ Widening or with Existing Paved Shoulder having no dropoffs)

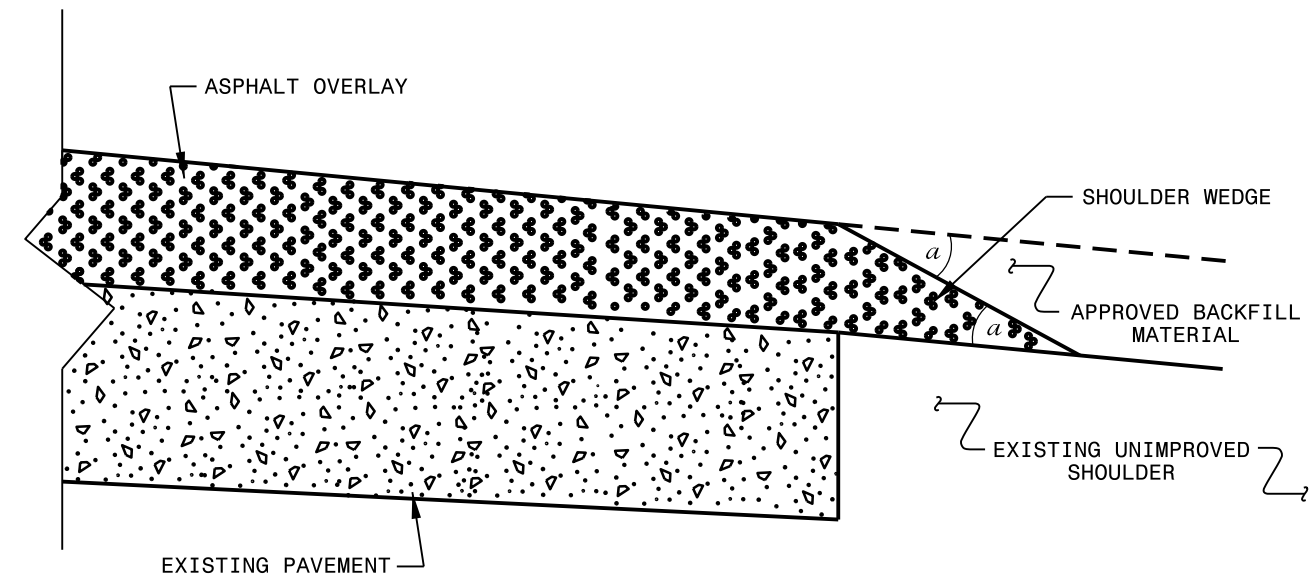

SHOULDER WEDGE DETAIL

(Resurfacing Projects w/ NO Widening)

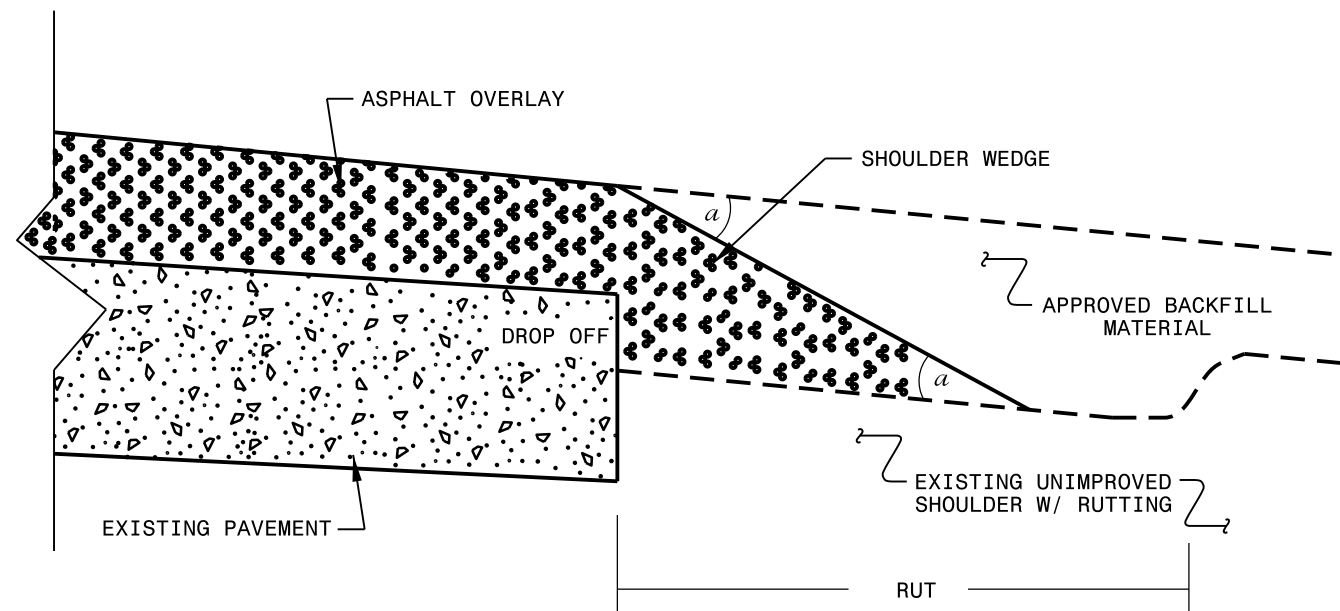

SHOULDER WEDGE DETAIL

(Resurfacing Adjacent to Rutted Shoulder)

- SHOULDER WEDGE ANGLE = 30°

CONTRACT STANDARDS AND DEVELOPMENT UNIT		
Office 919-707-6950 FAX 919-250-4119		
SHOULDER WEDGE DETAILS		
ORIGINAL BY: T.SPELL	DATE: 7-19-11	
MODIFIED BY:	DATE: 2/2/16	
CHECKED BY:	DATE:	
FILE SPEC.: szusr/details/stand/shoulderwedgedetail.dgn		

PROJECT NO.	SHEET NO.	TOTAL NO.
2023CPT.08.17.20761	12	

SUMMARY OF QUANTITIES

PROJECT NO	COUNTY	MAP NO	ROUTE	DESCRIPTION	TYP NO	LANE S	LANE TYPE	FINAL SURFACE TESTING REQUIRED	WARM MIX ASPHALT REQUIRED	LENGT H	WIDT H	1245000000-E	1260000000-E	1297000000-E	1330000000-E	1519000000-E	1575000000-E	1704000000-E	1775000000-E	1838000000-E	1838500000-N	2143000000-E	
												SHOULDER RECONSTRUCTION	AGGREGATE SHOULDER BORROW	1.5" MILLING	INCIDENTAL MILLING	SURFACE COURSE, \$9.5B	ASPHALT BINDER FOR PLANT MIX	PATCHING EXISTING PAVEMENT	ASPHALT SURFACE TREATMENT, MATCOAT, #67 STONE	EMULSION FOR ASPHALT SURFACE TREATMENT	VACUUM TRUCK	BLOTTING SAND	
											MI	FT	SMI	TON	SY	SY	TONS	TONS	TONS	SY	GAL	WK	TON
2023CPT.08.17.20761	Randolph	1	SR 1332 GARREN TOWN RD.	(FROM: US HWY 64 W. TO: SR1317 GOLDEN MEADOW RD.)	2	2	2WU	NO	NO	4.29	22	8.58	1,201.00		520	5,105	352	200	60,906.00	24,362	3.00	2	
TOTAL FOR MAP NO. 1											4.29		8.58	1,201.00		520	5,105	352	200	60,906.00	24,362	3.00	2
2023CPT.08.17.20761	Randolph	2	SR 1329 JACKSON RD.	(FROM: SR1328 SAWYERSVILLE RD. TO: SR 1318 MOORE RD.)	2	2	2WU	NO	NO	0.07	18	0.14	20.00			61	6	15	739.00	296	0.10	2	
TOTAL FOR MAP NO. 2											0.07		0.14	20.00			61	6	15	739.00	296	0.10	2
2023CPT.08.17.20761	Randolph	3	SR 1318 MOORE RD.	(FROM: SR 1193 OLD NC-49 TO: US-HWY 64)	2,3	2	2WU	NO	NO	3.74	22	7.48	1,051.00	325	245	4,381	297	75	53,100.00	21,240	2.60	2	
TOTAL FOR MAP NO. 3											3.74		7.48	1,051.00	325	245	4,381	297	75	53,100.00	21,240	2.60	2
2023CPT.08.17.20761	Randolph	4	SR 1411 JARVIS MILLER RD.	(FROM: US-64 W TO: SR 1413 MOUNTAIN VIEW CHURCH RD.)	1	2	2WU	NO	NO	1.95	20	4.29	603.00		520	2,364	161	60					
TOTAL FOR MAP NO. 4											1.95		4.29	603.00		520	2,364	161	60				
2023CPT.08.17.20761	Randolph	5	SR 3156 RACE TRACK RD.	(FROM: SR 1415 OLD COUNTY FARM RD. TO: END OF MAINTENANCE)	1	2	2WU	NO	NO	0.51	18	1.02	143.00		260	529	38	50					
TOTAL FOR MAP NO. 5											0.51		1.02	143.00		260	529	38	50				
2023CPT.08.17.20761	Randolph	6	SR 1415 OLD COUNTY FARM RD.	(FROM: SR 1004 CARAWAY MOUNTAIN RD. TO: SR 1518 LAKE LUCAS RD.)	1	2	2WU	NO	NO	3.79	24	7.58	1,065.00		2,340	4,843	344	400					
TOTAL FOR MAP NO. 6											3.79		7.58	1,065.00		2,340	4,843	344	400				
2023CPT.08.17.20761	Randolph	7	SR 1416 OLD LEXINGTON RD.	(FROM: SR 1004 CARAWAY MOUNTAIN RD. TO: SR 1411 JARVIS MILLER RD.)	1	2	2WU	NO	NO	3.26	20	6.46	907.00		1,170	3,620	247	100					
TOTAL FOR MAP NO. 7											3.26		6.46	907.00		1,170	3,620	247	100				
2023CPT.08.17.20761	Randolph	8	SR 1004 TRINITY RD.	(FROM: NC-62 TO: SR 1577 ARCHDALE RD.)	2	2	2WU	NO	NO	2.03	22	4.06	570.00		1,430	2,706	184	50	30,133.00	12,053	1.50	2	
TOTAL FOR MAP NO. 8											2.03		4.06	570.00		1,430	2,706	184	50	30,133.00	12,053	1.50	2
2023CPT.08.17.20761	Randolph	9	SR 1924 TOM BALL RD.	(FROM: GUILFORD COUNTY LINE TO: SR 1921 COLTRANE MILL RD.)	1	2	2WU	NO	NO	0.81	20	1.62	227.00		260	902	63	50					
TOTAL FOR MAP NO. 9											0.81		1.62	227.00		260	902	63	50				
2023CPT.08.17.20761	Randolph	10	SR 1921 COLTRANE MILL RD.	(FROM:SR 1926 HARLOW RD. TO: SR 1928 COLTRANE MILL RD.)	1	2	2WU	NO	NO	1.19	20	2.20	309.00		520	1,252	86	40					
TOTAL FOR MAP NO. 10											1.19		2.20	309.00		520	1,252	86	40				
TOTAL FOR PROJ NO. 2023CPT.08.17.20761											21.64		43.43	6,096.00	325	7,265	25,763	1,778	1,040	144,878.00	57,951	7.20	8
GRAND TOTAL											21.64		43.43	6,096.00	325	7,265	25,763	1,778	1,040	144,878.00	57,951	7.20	8

PROJECT NO.	SHEET NO.	TOTAL NO.
2023CPT.08.17.20761	13	

THERMOPLASTIC AND PAINT QUANTITIES

PROJECT NO	COUNTY	MAP NO	ROUTE	DESCRIPTION	TYP NO	LANE S	LANE TYPE	LENGTH	WIDTH	4413000000-E	4457000000-N	4810000000-E		4830000000-E	4835000000-E	4840000000-N	4845000000-N	4850000000-E	
								MI	FT	WORK ZONE ADVANCE/GENERAL WARNING SIGNING	TEMPORARY TRAFFIC CONTROL	4" WHITE PAINT	4" YELLOW PAINT	16" WHITE PAINT	24" WHITE PAINT	PAINT MSG RXR	PAINT LT ARROW	4" LINE REMOVAL	
									SF	LS	LF	LF	LF	LF	EA	EA	LF		
2023CPT.08.17.20761	Randolph	1	SR 1332 GARREN TOWN RD.	(FROM: US HWY 64 W. TO: SR1317 GOLDEN MEADOW RD.)	2	2	2WU	4.29	22	481			45,302	45,302					
TOTAL FOR MAP NO. 1									4.29		481		45,302	45,302					
2023CPT.08.17.20761	Randolph	2	SR 1329 JACKSON RD.	(FROM: SR1328 SAWYERSVILLE RD. TO: SR 1318 MOORE RD.)	2	2	2WU	0.07	18	79			740	740					
TOTAL FOR MAP NO. 2									0.07		79		740	740					
2023CPT.08.17.20761	Randolph	3	SR 1318 MOORE RD.	(FROM: SR 1193 OLD NC-49 TO: US-HWY 64)	2,3	2	2WU	3.74	22	419			39,496	39,496					
TOTAL FOR MAP NO. 3									3.74		419		39,496	39,496					
2023CPT.08.17.20761	Randolph	4	SR 1411 JARVIS MILLER RD.	(FROM: US-64 W TO: SR 1413 MOUNTAIN VIEW CHURCH RD.)	1	2	2WU	1.95	20	219			22,652	22,652					
TOTAL FOR MAP NO. 4									1.95		219		22,652	22,652					
2023CPT.08.17.20761	Randolph	5	SR 3156 RACE TRACK RD.	(FROM: SR 1415 OLD COUNTY FARM RD. TO: END OF MAINTENANCE)	1	2	2WU	0.51	18	58			5,386	5,386					
TOTAL FOR MAP NO. 5									0.51		58		5,386	5,386					
2023CPT.08.17.20761	Randolph	6	SR 1415 OLD COUNTY FARM RD.	(FROM: SR 1004 CARAWAY MOUNTAIN RD. TO: SR 1518 LAKE LUCAS RD.)	1	2	2WU	3.79	24	425			40,022	40,022					
TOTAL FOR MAP NO. 6									3.79		425		40,022	40,022					
2023CPT.08.17.20761	Randolph	7	SR 1416 OLD LEXINGTON RD.	(FROM: SR 1004 CARAWAY MOUNTAIN RD. TO: SR 1411 JARVIS MILLER RD.)	1	2	2WU	3.26	20	366			34,108	34,108	20				
TOTAL FOR MAP NO. 7									3.26		366		34,108	34,108	20				
2023CPT.08.17.20761	Randolph	8	SR 1004 TRINITY RD.	(FROM: NC-62 TO: SR 1577 ARCHDALE RD.)	2	2	2WU	2.03	22	228			23,171	23,171	200	225	4	4	1,328
TOTAL FOR MAP NO. 8									2.03		228		23,171	23,171	200	225	4	4	1,328
2023CPT.08.17.20761	Randolph	9	SR 1924 TOM BALL RD.	(FROM: GUILFORD COUNTY LINE TO: SR 1921 COLTRANE MILL RD.)	1	2	2WU	0.81	20	91			8,552	8,552					
TOTAL FOR MAP NO. 9									0.81		91		8,552	8,552					
2023CPT.08.17.20761	Randolph	10	SR 1921 COLTRANE MILL RD.	(FROM: SR 1926 HARLOW RD. TO: SR 1928 COLTRANE MILL RD.)	1	2	2WU	1.19	20	134			11,616	11,616					
TOTAL FOR MAP NO. 10									1.19		134		11,616	11,616					
TOTAL FOR PROJ NO. 2023CPT.08.17.20761									21.64		2,500	*	231,045	231,045	200	245	4	4	1,328
												462,090							
GRAND TOTAL									21.64		2,500	1	231,045	231,045	200	245	4	4	1,328
												462,090							

SIGNING FOR RESURFACING PROJECTS

LEGEND
 ┆ STATIONARY SIGN
 ← DIRECTION OF TRAFFIC FLOW

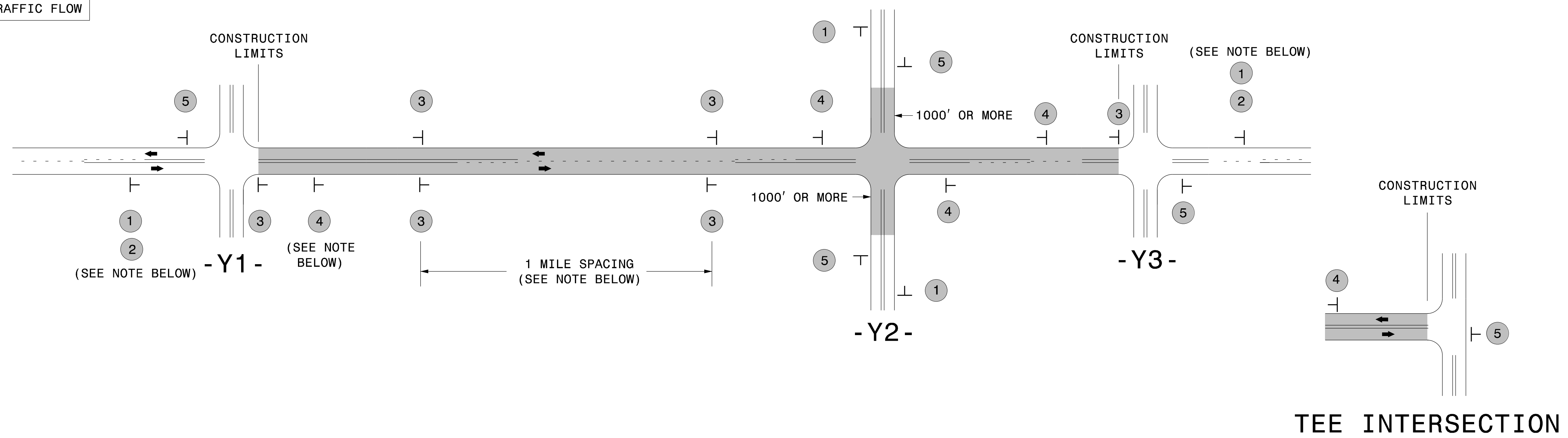

MAINLINE (-L-) SIGNING

-Y- LINE SIGNING

SIGNING NOTES AND PLACEMENT PER DIRECTION	1		PLACE 1000' PRIOR TO BEGINNING OF CONSTRUCTION LIMITS. ONLY USED ON -Y- LINES IF RESURFACING LIMITS EXTEND 1000' ALONG -Y- LINE.	<p>NO REQUIRED STATIONARY SIGNING FOR THE FOLLOWING -Y- LINE CONDITIONS:</p> <ol style="list-style-type: none"> LESS THAN 1000' OF RESURFACING ALONG -Y- LINE SUBDIVISION ROADS DEAD END ROADS <p>WHEN PAVING/CONSTRUCTION ACTIVITIES PROCEED ACROSS AN UNSIGNED -Y- LINE, PORTABLE ADVANCE WARNING SIGNS SHALL BE USED ALONG THE -Y- LINE AS SHOWN BELOW. REMOVE UPON COMPLETION OF WORK.</p> <div style="display: flex; justify-content: space-around;"> <div style="text-align: center;"> W20-1 48" X 48" PLACED 500' IN ADVANCE OF FLAGGER. </div> <div style="text-align: center;"> W20-7 A 48" X 48" PLACED 250' IN ADVANCE OF FLAGGER. </div> </div>
	2		#2 SIGN ONLY USED WHEN CONSTRUCTION LIMITS ARE 2 OR MORE MILES IN LENGTH. ROUND UP TO NEXT WHOLE NUMBER. (NO FRACTIONAL OR DECIMAL NUMBERS)	
	3		- PLACE INITIALLY AT THE CONSTRUCTION LIMITS AND SPACE 1 MILE APART THEREAFTER. - AT TEE INTERSECTIONS INSTALL INITIALLY 1/2 MILE FROM INTERSECTION AND SPACE 1 MILE APART THEREAFTER.	
	4		- THESE ARE FOR -Y- LINES THAT ARE "THROUGH" ROADWAYS. - DEAD END AND SUBDIVISION ROADS ARE NOT "THROUGH" ROADWAYS. - INSTALL 500' +/- FROM EACH -Y- LINE APPROACH AS SHOWN ABOVE. - FOR MULTIPLE -Y- LINES THAT ARE SEPARATED BY 0.25 MILES OR LESS, TREAT AS A SINGLE UNIT AND INSTALL WITHIN 500' OF EACH APPROACH. - A MAXIMUM OF 2 SIGN SETS PER MILE. DO NOT INSTALL WHEN -Y- LINES ARE WITHIN 0.5 MILES FROM "END ROAD WORK" SIGN. - FOR TEE INTERSECTIONS, INSTALL WITHIN 500' +/- OF THE INTERSECTION ALONG -L- LINE.	
	5		PLACE 500' FOLLOWING THE END OF CONSTRUCTION LIMITS OR AS SHOWN WHEN WORK ENDS AT A 3-WAY TEE INTERSECTION.	

THE ABOVE SIGNS ARE ALL THAT ARE REQUIRED FOR A CONTRACTOR TO BEGIN A RESURFACING CONTRACT. ANY ADDITIONAL SIGNS REQUESTED BY NCDOT DIVISIONS SHALL BE INSTALLED WITHIN 7 BUSINESS DAYS OF THE START OF CONTRACT WORK.

MAPS LESS THAN 2 MILES

FOR RESURFACING MAPS WITH CONSTRUCTION LIMITS LESS THAN 2 MILES IN LENGTH, NO STATIONARY SIGNS ARE REQUIRED. USE PORTABLE "ROAD UNDER CONSTRUCTION" OR "ROAD WORK AHEAD" SIGNS IN LIEU OF STATIONARY ADVANCE WARNINGS SIGNS.

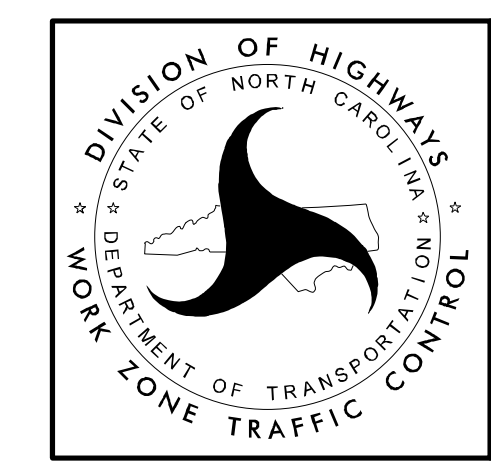

ADVANCE WARNING SIGNS FOR RURAL AND SUBURBAN 2-LANE ROADWAY RESURFACING