

5/14/99

$PI\ Sta\ 165+43.38$ $\Delta = 20^{\circ} 53' 20.9" (LT)$ $D = 1^{\circ} 00' 18.7"$ $L = 2,078.13'$ $T = 1,050.73'$ $R = 5,700.00'$ $SE = EXIST.$	$PI\ Sta\ 178+57.82$ $\Delta = 5^{\circ} 26' 33.8" (LT)$ $D = 1^{\circ} 06' 06.6"$ $L = 493.97'$ $T = 247.17'$ $R = 5,200.00'$ $SE = EXIST.$	$PI\ Sta\ 188+90.22$ $\Delta = 15^{\circ} 21' 43.2" (LT)$ $D = 0^{\circ} 59' 01.0"$ $L = 1,561.78'$ $T = 785.60'$ $R = 5,825.00'$ $SE = EXIST.$	$PI\ Sta\ 12+52.21$ $\Delta = 11^{\circ} 14' 58.8" (LT)$ $D = 4^{\circ} 38' 44.6"$ $L = 242.15'$ $T = 121.47'$ $R = 1,233.30'$ $SE = EXIST.$	$PI\ Sta\ 11+95.99$ $\Delta = 12^{\circ} 58' 52.7" (RT)$ $D = 1^{\circ} 52' 53.9"$ $L = 689.90'$ $T = 346.43'$ $R = 3,045.00'$ $SE = EXIST.$
---	--	---	--	--

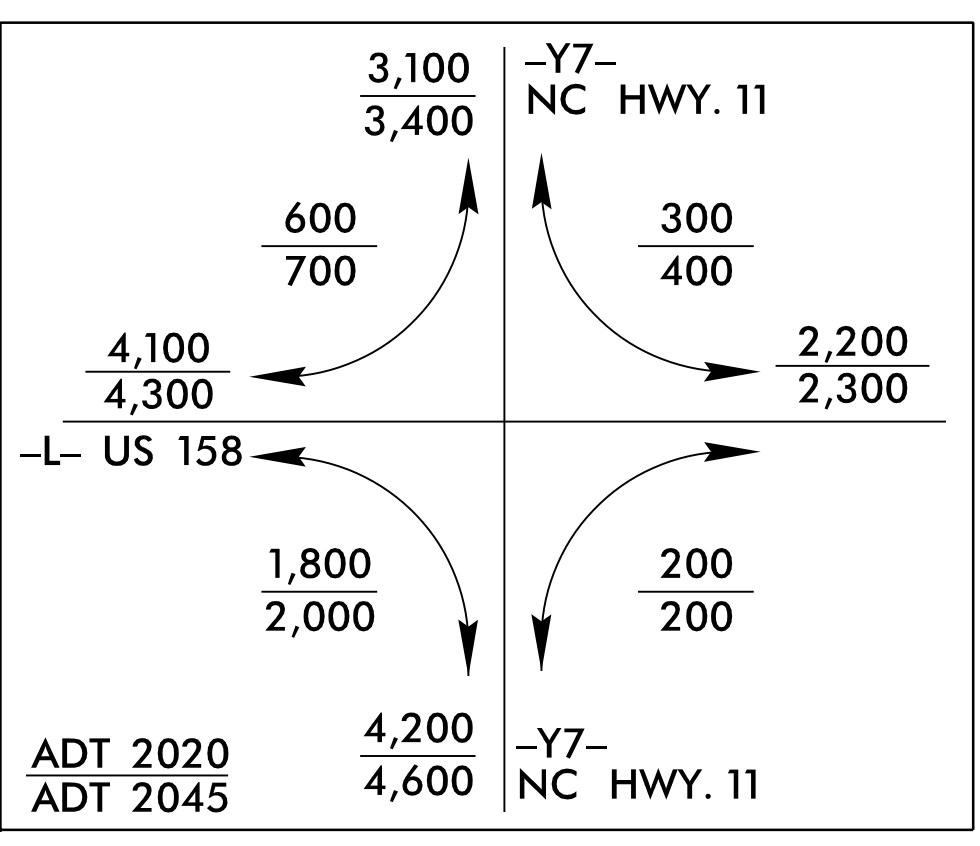

PROJECT REFERENCE NO. W-5701B	SHEET NO. 9
ROADWAY DESIGN ENGINEER	HYDRAULICS ENGINEER
DOCUMENT NOT CONSIDERED FINAL UNLESS ALL SIGNATURES COMPLETED	

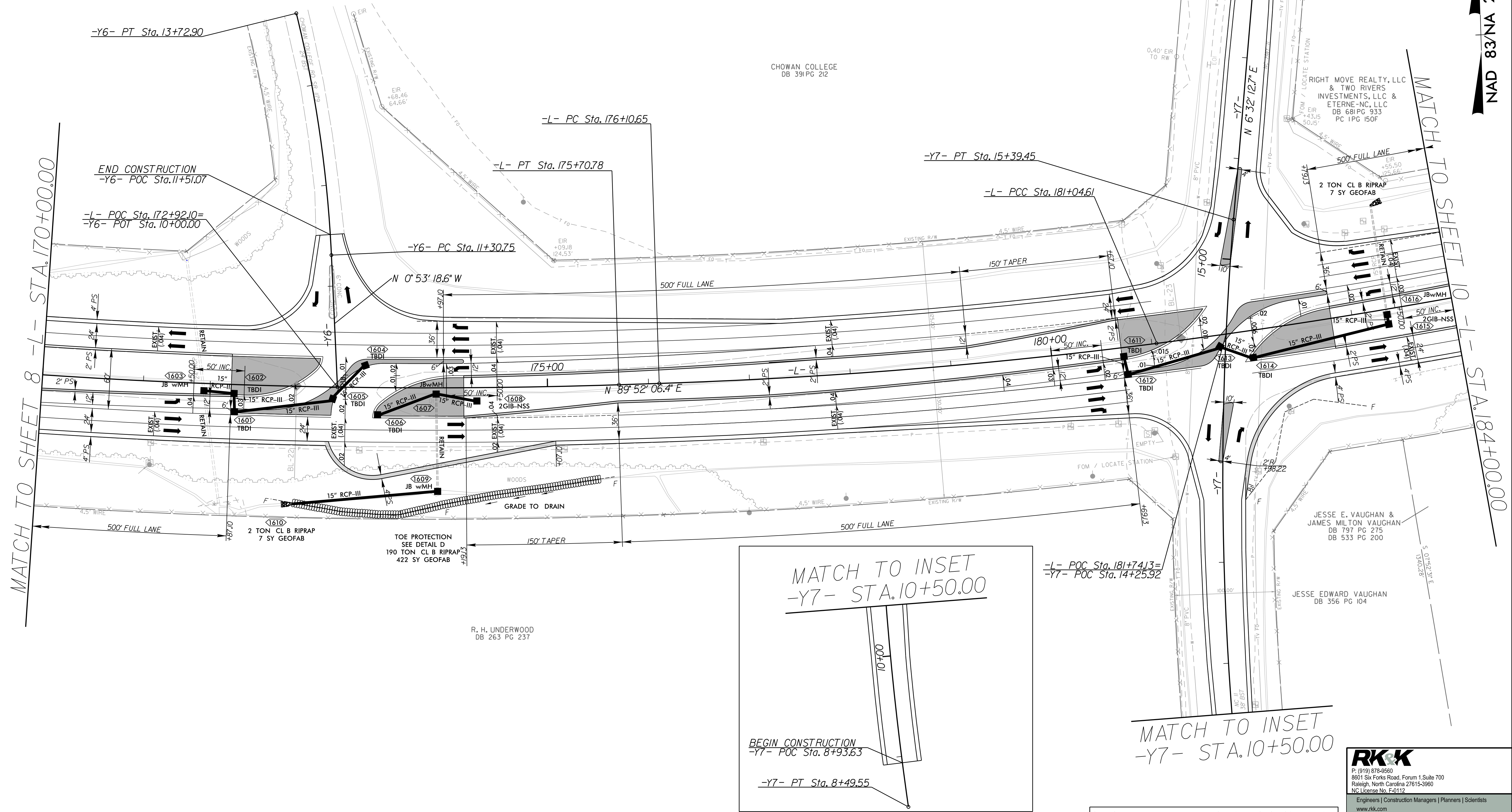

R:\Road\2013\05\W5701B_Rdy_esh_09.dgn

NAD 83/NA 2011

RK&K
 P: (919) 878-0560
 8601 Six Forks Road, Forum 1, Suite 700
 Raleigh, North Carolina 27615-3960
 NC License No. F-0112
 Engineers | Construction Managers | Planners | Scientists
 www.rkk.com
 Responsive People | Creative Solutions

SEE SHEET 2B-3 & 2B-4 FOR INTERSECTION DETAIL