

09/06/99

TIP PROJECT: B-5989

STATE	STATE PROJECT REFERENCE NO.	SHEET NO.	TOTAL SHEETS
N.C.	47845.1.1	RW01	06

STATE OF NORTH CAROLINA
 DIVISION OF HIGHWAYS
 SURVEY CONTROL, EXISTING CENTERLINES,
 RIGHT OF WAY, EASEMENTS AND PROPERTY TIES
MADISON COUNTY

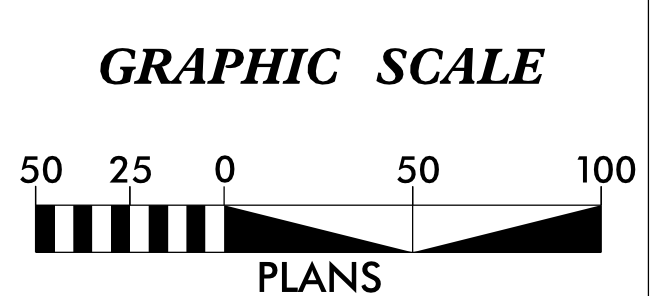
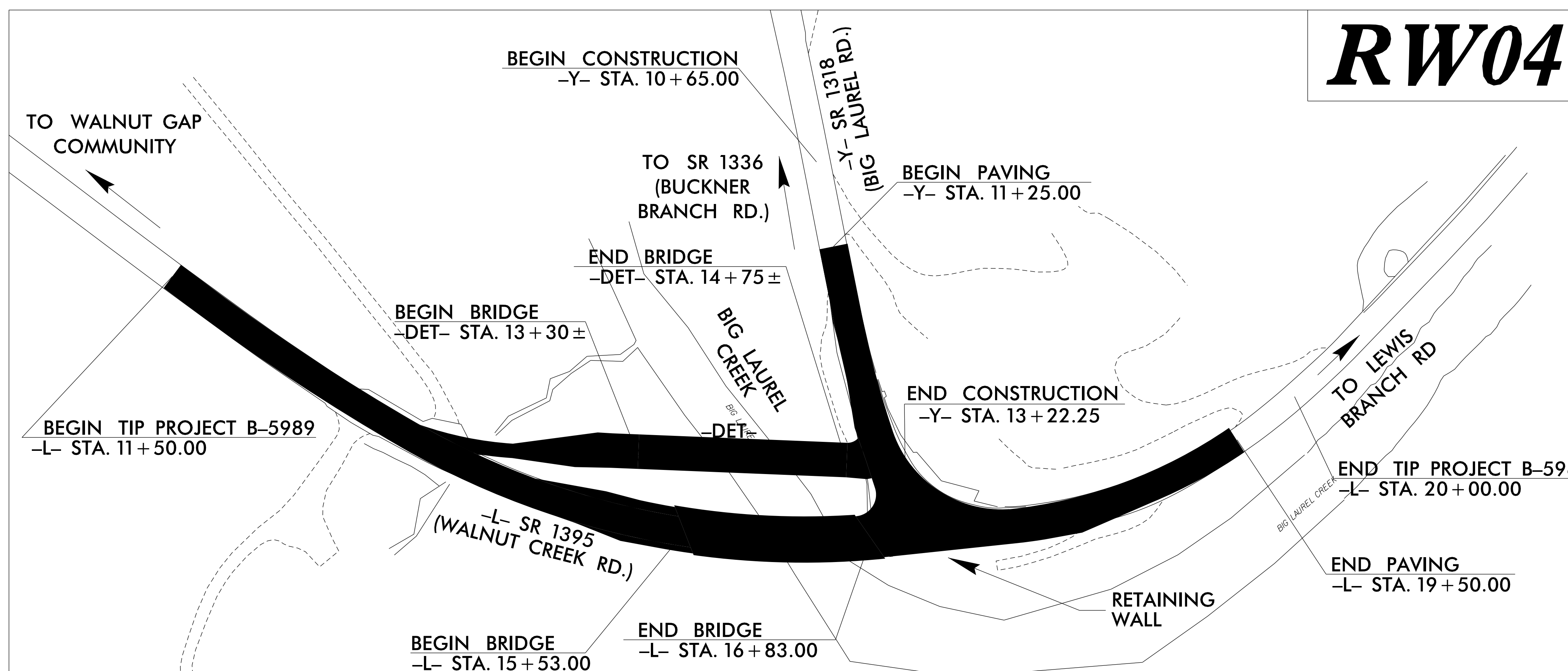
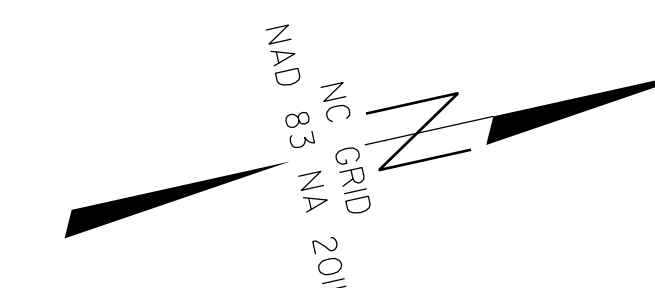

DATUM DESCRIPTION

THE LOCALIZED COORDINATE SYSTEM DEVELOPED FOR THIS PROJECT IS BASED ON THE STATE PLANE COORDINATES ESTABLISHED BY NCDOT FOR MONUMENT "B5989-1" WITH NAD 83/NA 2011 STATE PLANE GRID COORDINATES OF NORTHING: 806,257.8790(ft) EASTING: 919,837.3190(ft) ELEVATION: 2,048.22(ft)
 THE AVERAGE COMBINED GRID FACTOR USED ON THIS PROJECT (GROUND TO GRID) IS: 0.99984541
 THE N.C. LAMBERT GRID BEARING AND LOCALIZED HORIZONTAL GROUND DISTANCE FROM "B5989-1" TO -L- STATION 11+50.00 IS S 32-34'49.2" W X 561.19(ft)
 ALL LINEAR DIMENSIONS ARE LOCALIZED HORIZONTAL DISTANCES
 VERTICAL DATUM USED IS NAVD 88

Prepared in the Office of:

V&M
Vaughn & Melton
 1318-F Patton Avenue
 Asheville, NC 28806
 Firm License # F-1088

2018 STANDARD SPECIFICATIONS

RIGHT OF WAY DATE:
 MARCH 20, 2020

LETTING DATE:
 JANUARY 18, 2022

PROFESSIONAL LAND SURVEYOR

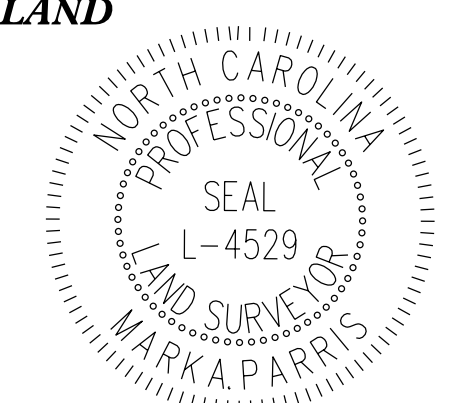

DocuSigned by:
 F1570C8B5C7248A...
 SIGNATURE:

3/14/2022
 Date:

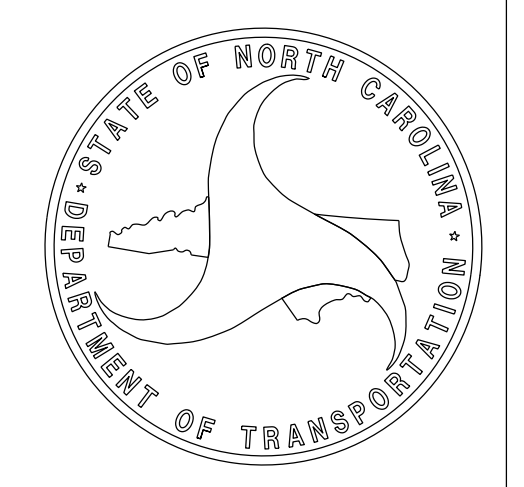

\$\$\$\$\$ SYSTEM \$\$\$\$\$\$
 \$\$\$ DDN \$\$\$
 \$\$\$ USERNAME \$\$\$