

5/28/19

PROJECT REFERENCE NO. B-5989	SHEET NO. 6
ROADWAY DESIGN ENGINEER 10/31/2019 SEAL 014571 JAMES A. SPEER	HYDRAULICS ENGINEER 10/31/2019 SEAL 053755 PATRICK M. HARTNETT
DOCUMENT NOT CONSIDERED FINAL UNLESS ALL SIGNATURES COMPLETED	
Prepared in the Office of: SUMMIT	NC FIRM LICENSE No. P-0339 220 Executive Five Ct. Hillsborough, NC 27278 (919) 732-3883 (919) 732-6676 (FAX)

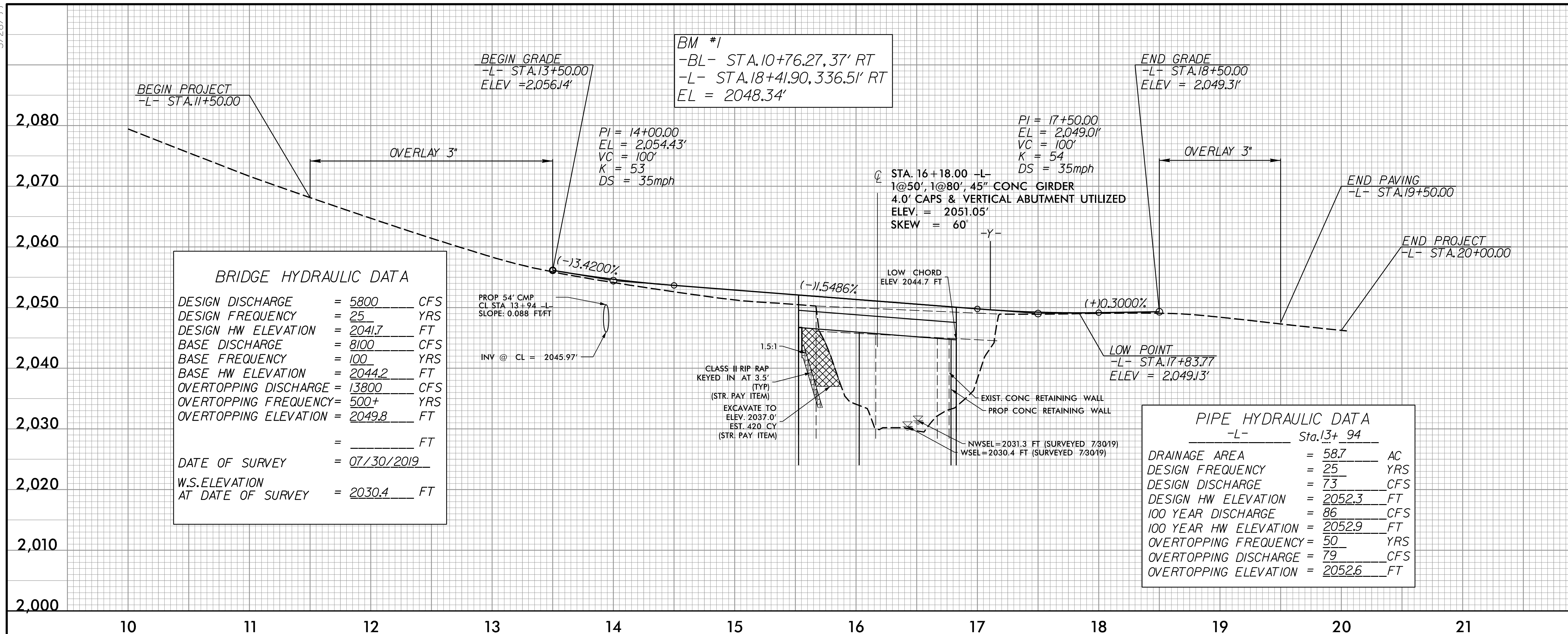

BRIDGE HYDRAULIC DATA

DESIGN DISCHARGE	= 5800	CFS
DESIGN FREQUENCY	= 25	YRS
DESIGN HW ELEVATION	= 2041.7	FT
BASE DISCHARGE	= 8100	CFS
BASE FREQUENCY	= 100	YRS
BASE HW ELEVATION	= 2044.2	FT
OVERTOPPING DISCHARGE	= 13800	CFS
OVERTOPPING FREQUENCY	= 500+	YRS
OVERTOPPING ELEVATION	= 2049.8	FT
	=	FT
DATE OF SURVEY	= 07/30/2019	
W.S. ELEVATION AT DATE OF SURVEY	= 2030.4	FT

PIPE HYDRAULIC DATA
-L- Sta. 13+ 94

DRAINAGE AREA	= 58.7	AC
DESIGN FREQUENCY	= 25	YRS
DESIGN DISCHARGE	= 73	CFS
DESIGN HW ELEVATION	= 2052.3	FT
100 YEAR DISCHARGE	= 86	CFS
100 YEAR HW ELEVATION	= 2052.9	FT
OVERTOPPING FREQUENCY	= 50	YRS
OVERTOPPING DISCHARGE	= 79	CFS
OVERTOPPING ELEVATION	= 2052.6	FT

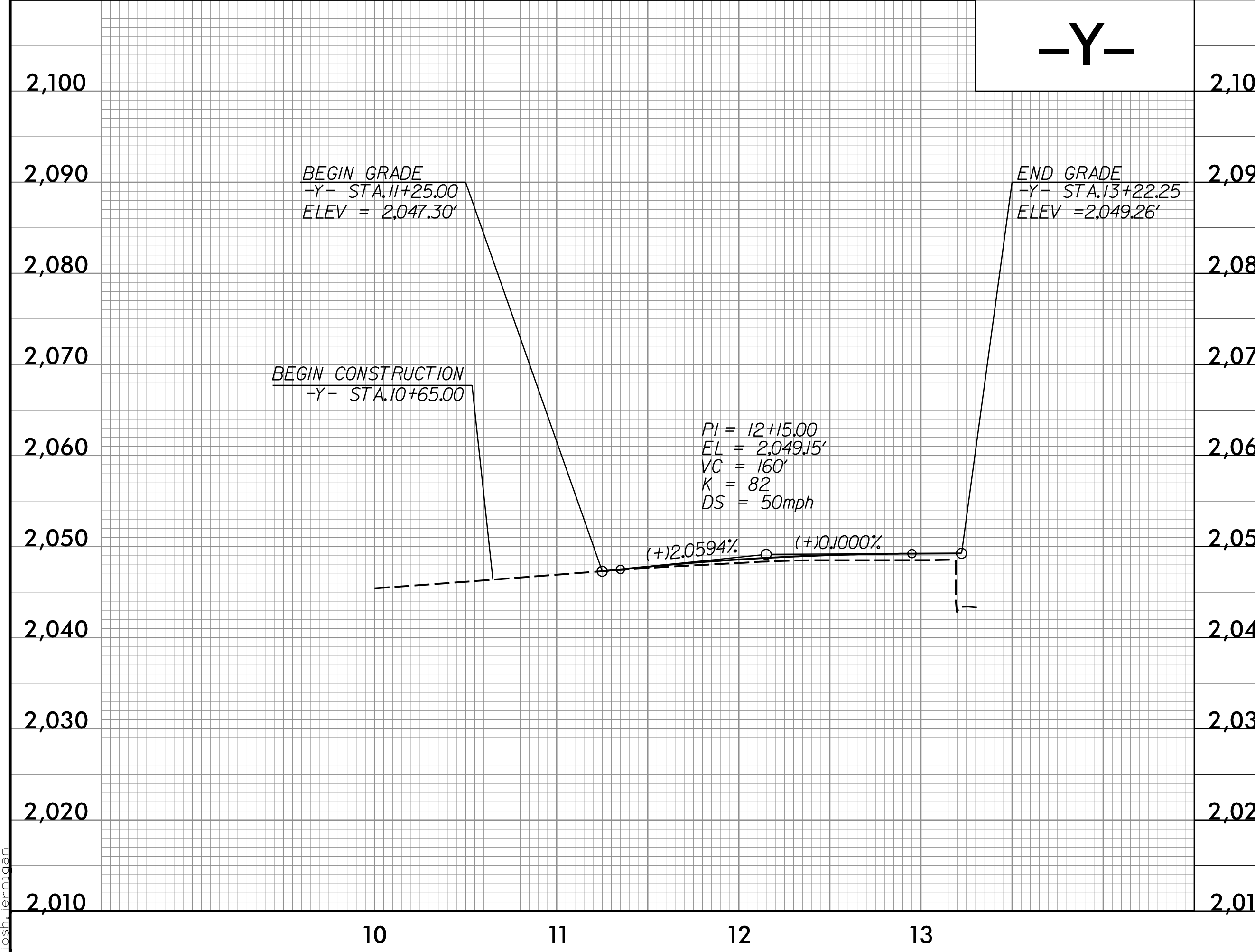

PIPE HYDRAULIC DATA
-DET- Sta. 12+ 23

DRAINAGE AREA	= 58.7	AC
DESIGN FREQUENCY	= 10	YRS
DESIGN DISCHARGE	= 63	CFS
DESIGN HW ELEVATION	= 2051.9	FT
100 YEAR DISCHARGE	= 86	CFS
100 YEAR HW ELEVATION	= 2052.9	FT
OVERTOPPING FREQUENCY	= 50	YRS
OVERTOPPING DISCHARGE	= 79	CFS
OVERTOPPING ELEVATION	= 2052.6	FT

BRIDGE HYDRAULIC DATA

DESIGN DISCHARGE	= 4400	CFS
DESIGN FREQUENCY	= 10	YRS
DESIGN HW ELEVATION	= 2039.8	FT
BASE DISCHARGE	= N/A	CFS
BASE FREQUENCY	= N/A	YRS
BASE HW ELEVATION	= N/A	FT
OVERTOPPING DISCHARGE	= N/A	CFS
OVERTOPPING FREQUENCY	= N/A	YRS
OVERTOPPING ELEVATION	= N/A	FT
	= N/A	FT
DATE OF SURVEY	= 07/30/2019	
W.S. ELEVATION AT DATE OF SURVEY	= 2030.4	FT

3/10/2022 09:36
B-5989-1802-10-11-16.dgn
Josh Brumback