

NOTES:

1. TRAFFIC CONTROL DEVICES SHALL BE INSTALLED PER ENGINEER'S INSTRUCTIONS.
2. USE THIS DRAWING IN CONJUNCTION WITH TMP-56.

4/21/2022
 I5915B_TC_TMP_US_64_SB_OUTSIDE_LANE_CLOSURE_DETAILS (4 OF 4).dgn
 User: jdebone

APPROVED: *Jacob Duke*
DocuSigned by: Jacob Duke 295303034E94D9

DATE: 4/26/2022

SEAL

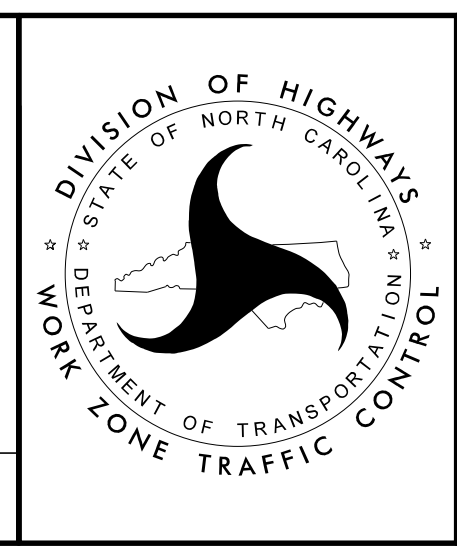

**US 64 SB OUTSIDE
 LANE CLOSURE
 DETAILS (4 OF 4)**

**DOCUMENT NOT CONSIDERED FINAL
 UNLESS ALL SIGNATURES COMPLETED**

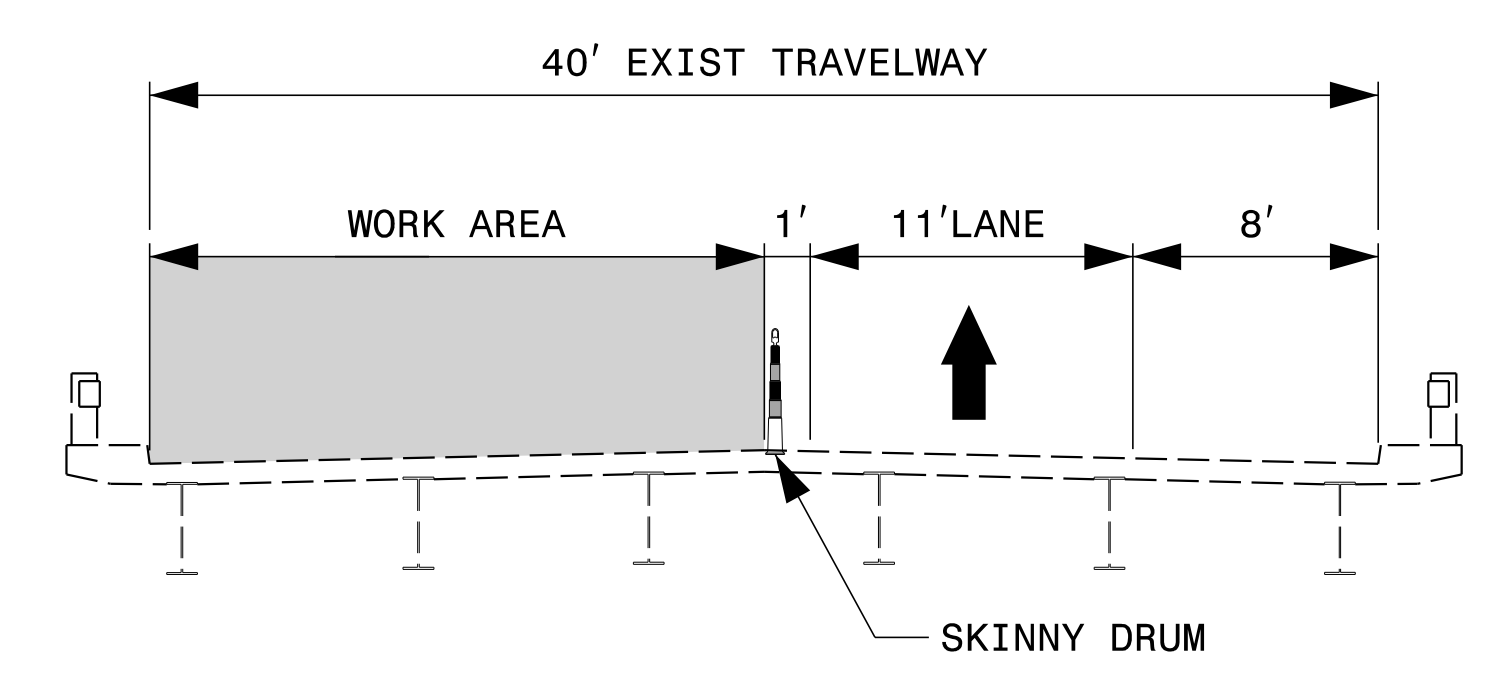
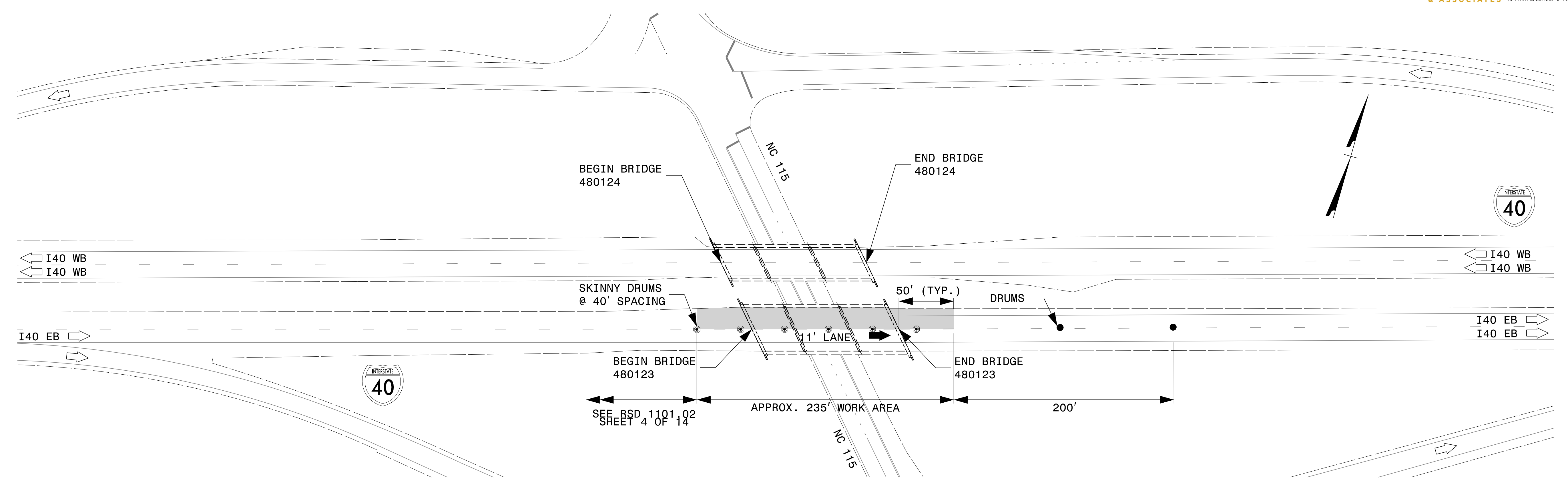

NOTES:

1. USE THIS DRAWING IN CONJUNCTION WITH RSD 1101.02 SHEET 4 OF 14.
2. USE SKINNY DRUMS THROUGH WORK AREA.
3. SEE SHEET TMP-1D FOR "ROAD NARROWS" SIGN PLACEMENT.

APPROVED: *Jacob Duke*
DocuSigned by: Jacob Duke 2953030304E9409

DATE: 4/26/2022

SEAL

**DOCUMENT NOT CONSIDERED FINAL
 UNLESS ALL SIGNATURES COMPLETED**

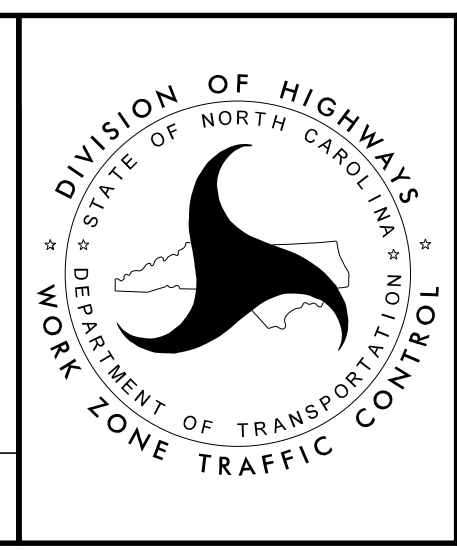

**I40 EB STRUCTURE
 480123 INSIDE LANE
 CLOSURE DETAILS**

4/21/2022
 I5915B_TC_TMP_I40_EB_STRUCTURE_123_INSIDE_LANE_CLOSURE_DETAILS.dgn
 User: jdebone

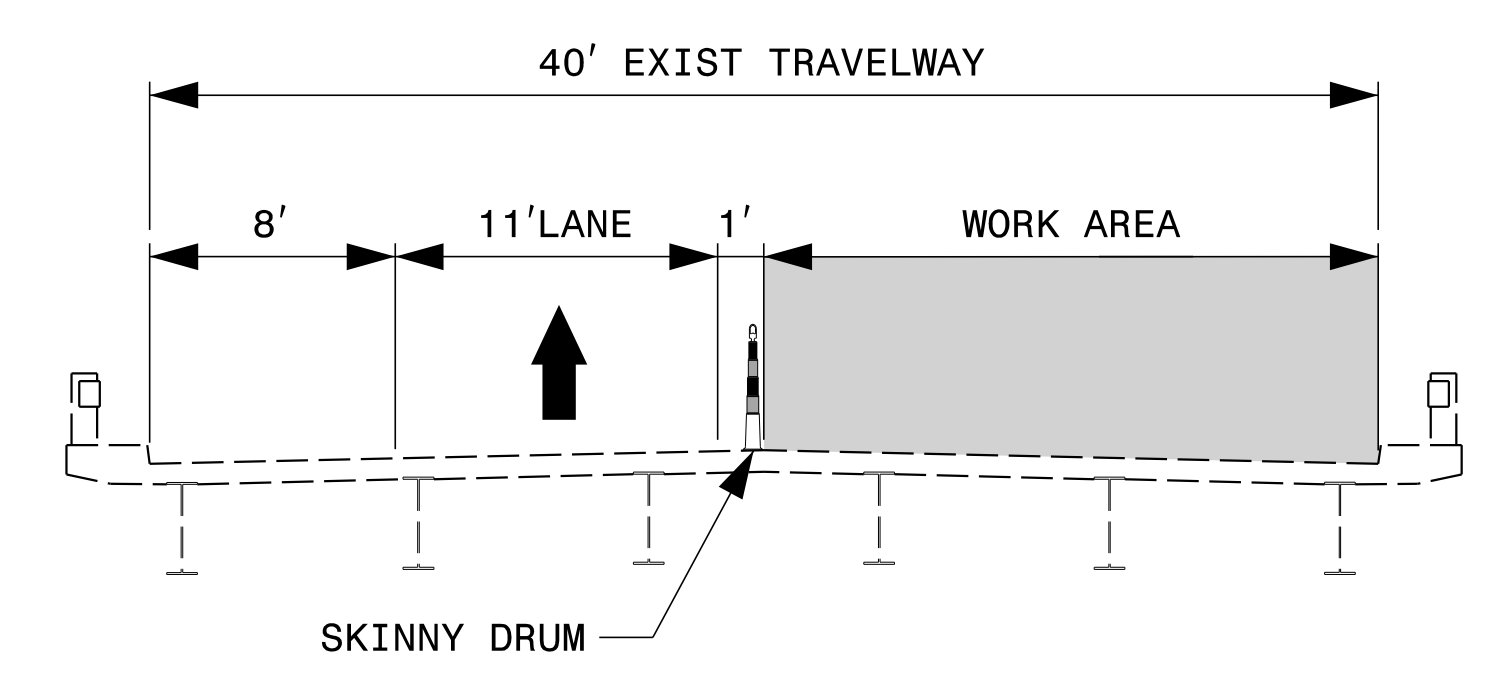
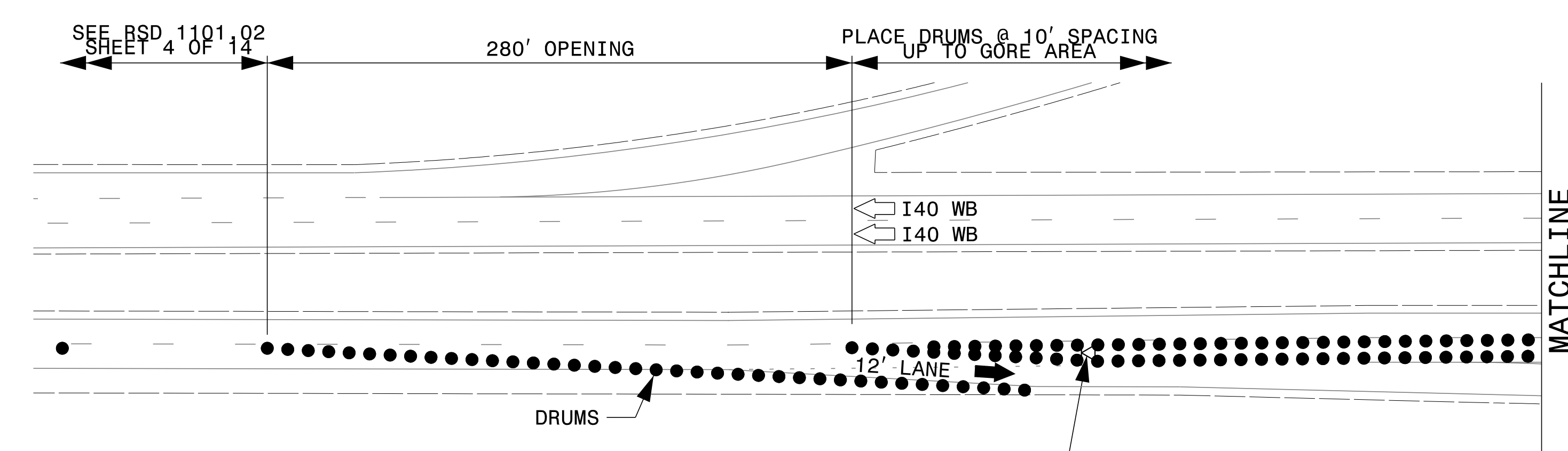
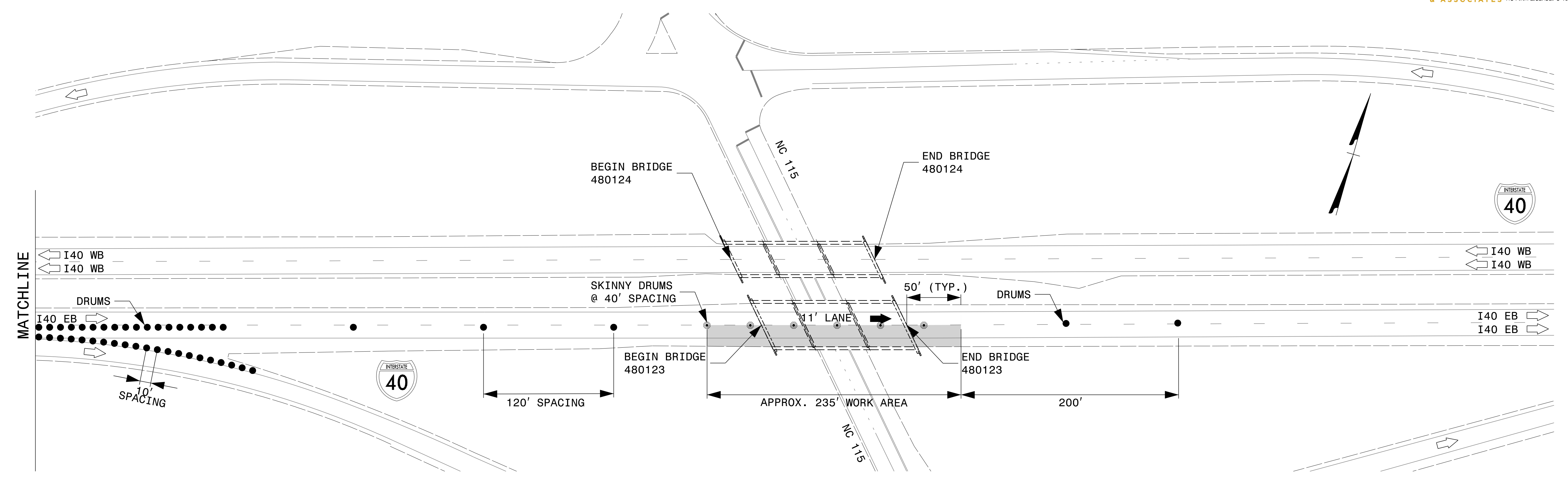

- NOTES:**
1. USE THIS DRAWING IN CONJUNCTION WITH RSD 1101.02 SHEET 4 OF 14.
 2. USE SKINNY DRUMS THROUGH WORK AREA.
 3. SEE SHEET TMP-1D FOR "ROAD NARROWS" SIGN PLACEMENT.

APPROVED: *Jacob Duke*
 DATE: 4/26/2022

SEAL

PROFESSIONAL SEAL
 043777
 ENGINEER
 JACOB H. DUKE

**DOCUMENT NOT CONSIDERED FINAL
 UNLESS ALL SIGNATURES COMPLETED**

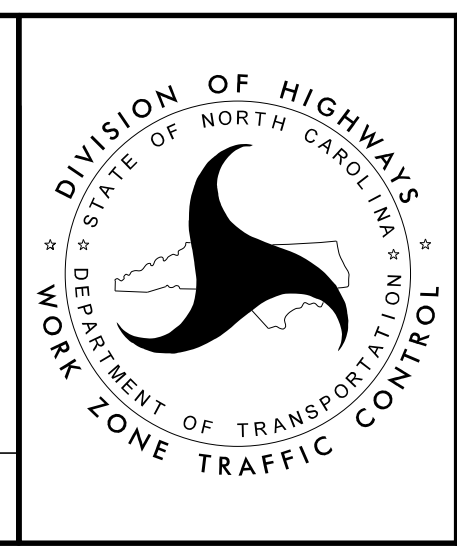

**I40 EB STRUCTURE
 480123 OUTSIDE LANE
 CLOSURE DETAILS**

4/21/2022 15915B_TC_TMP_I40_EB_STRUCTURE_123_OUTSIDE_LANE_CLOSURE_DETAILS.dgn User: jdebone

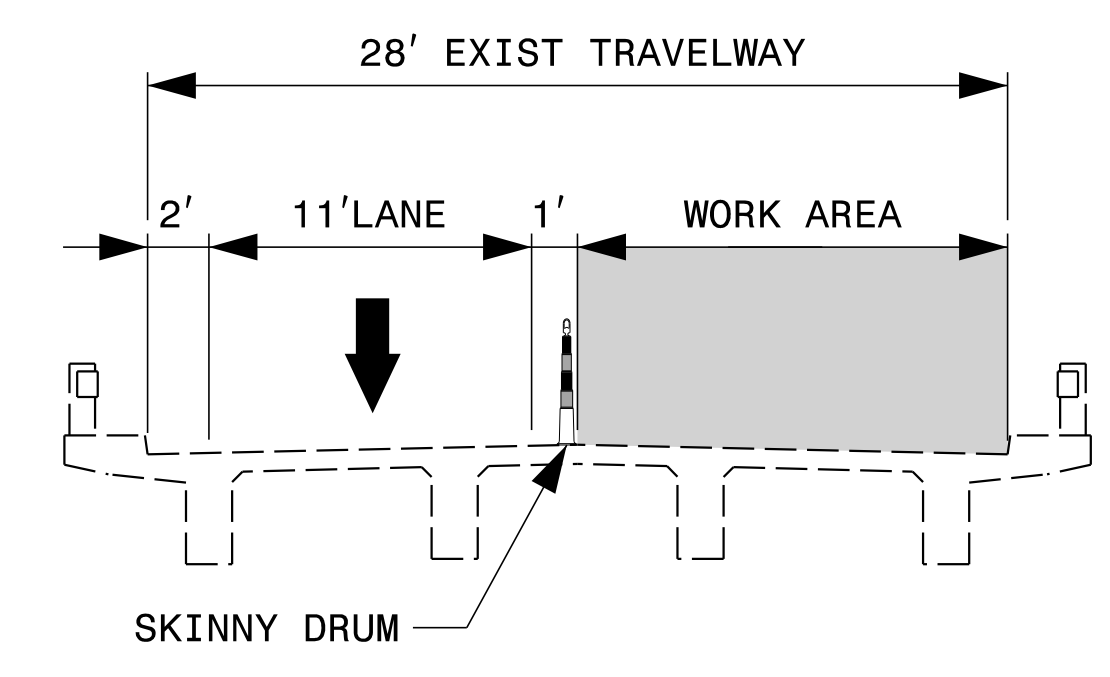
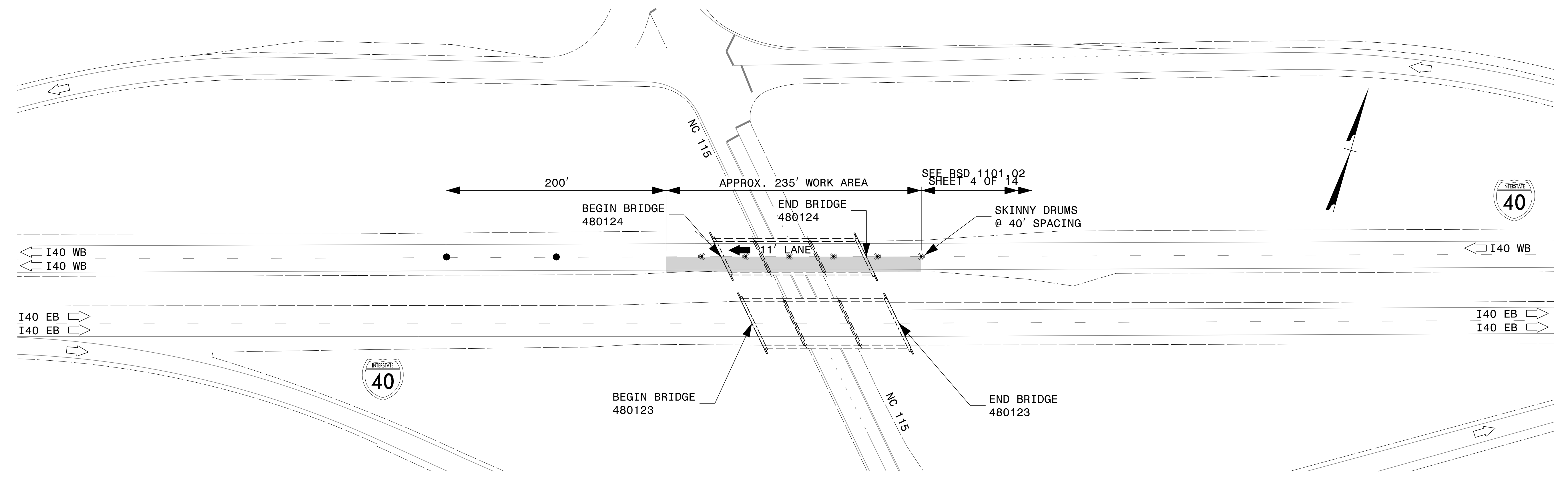

- NOTES:**
1. USE THIS DRAWING IN CONJUNCTION WITH RSD 1101.02 SHEET 4 OF 14.
 2. USE SKINNY DRUMS THROUGH WORK AREA.
 3. SEE SHEET TMP-1D FOR "ROAD NARROWS" SIGN PLACEMENT.

4/21/2022
 I5915B.TC.TMP_I40_WB_STRUCTURE_I24_INSIDE_LANE_CLOSURE_DETAILS.dgn
 User: jdebone

APPROVED: *Jacob Duke*
DocuSigned by: Jacob Duke 2953903094E9409

DATE: 4/26/2022

SEAL

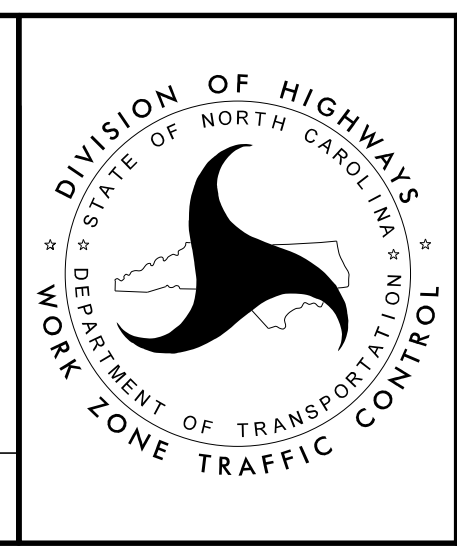

**I40 WB STRUCTURE
 480124 INSIDE LANE
 CLOSURE DETAILS**

**DOCUMENT NOT CONSIDERED FINAL
 UNLESS ALL SIGNATURES COMPLETED**

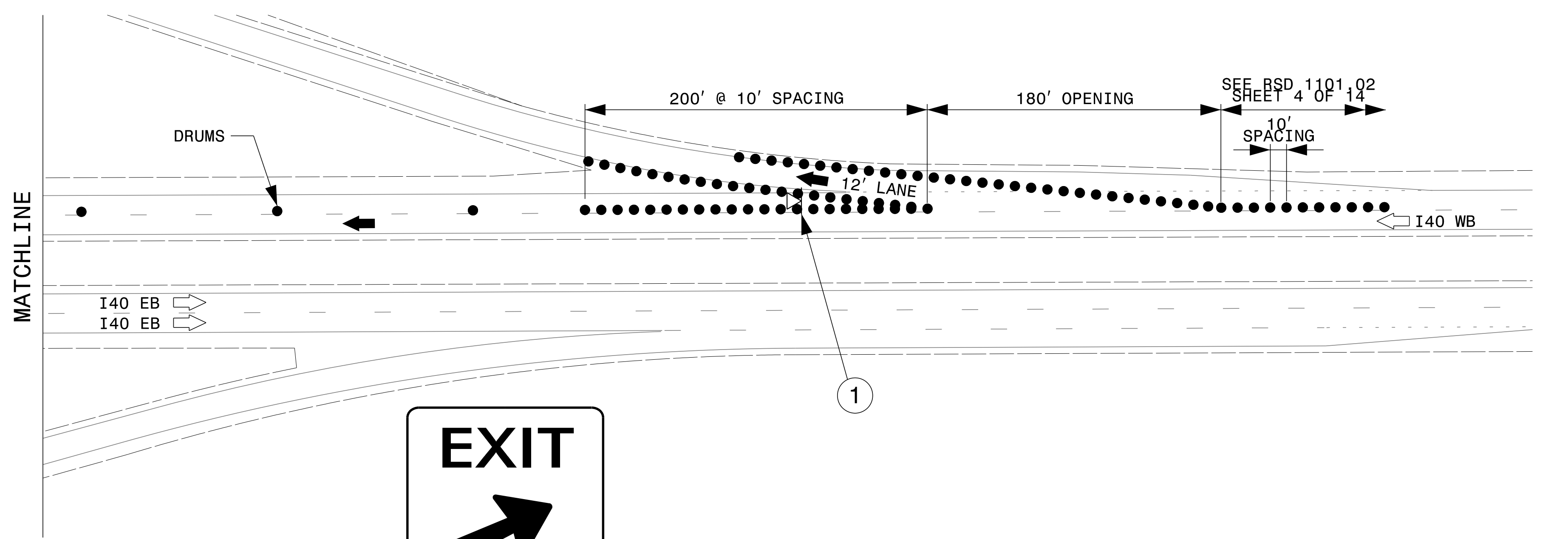
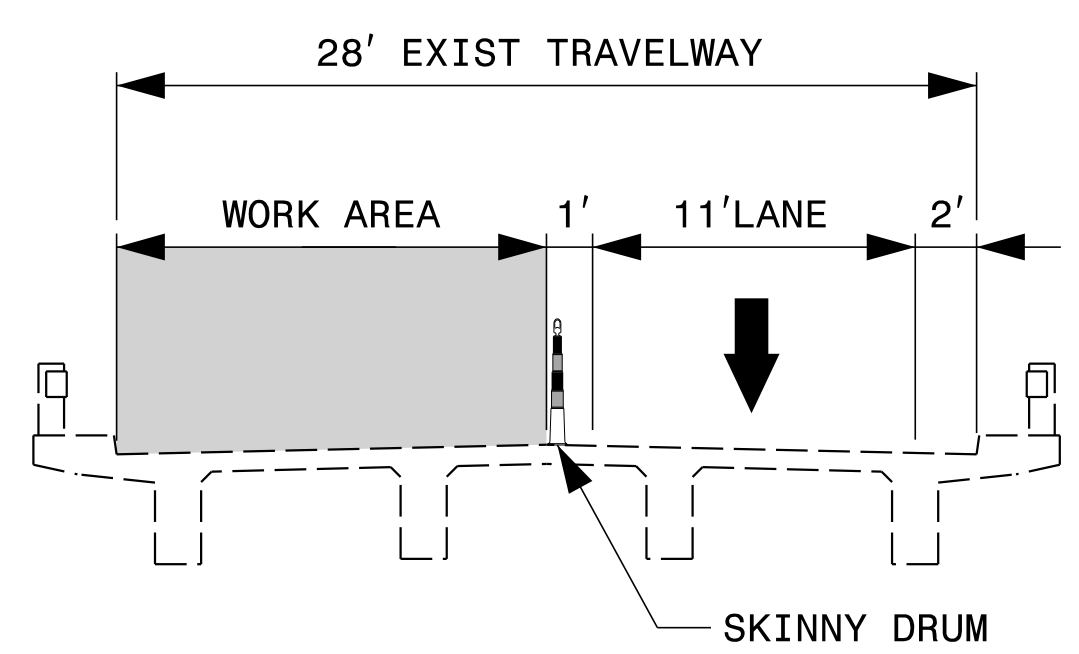
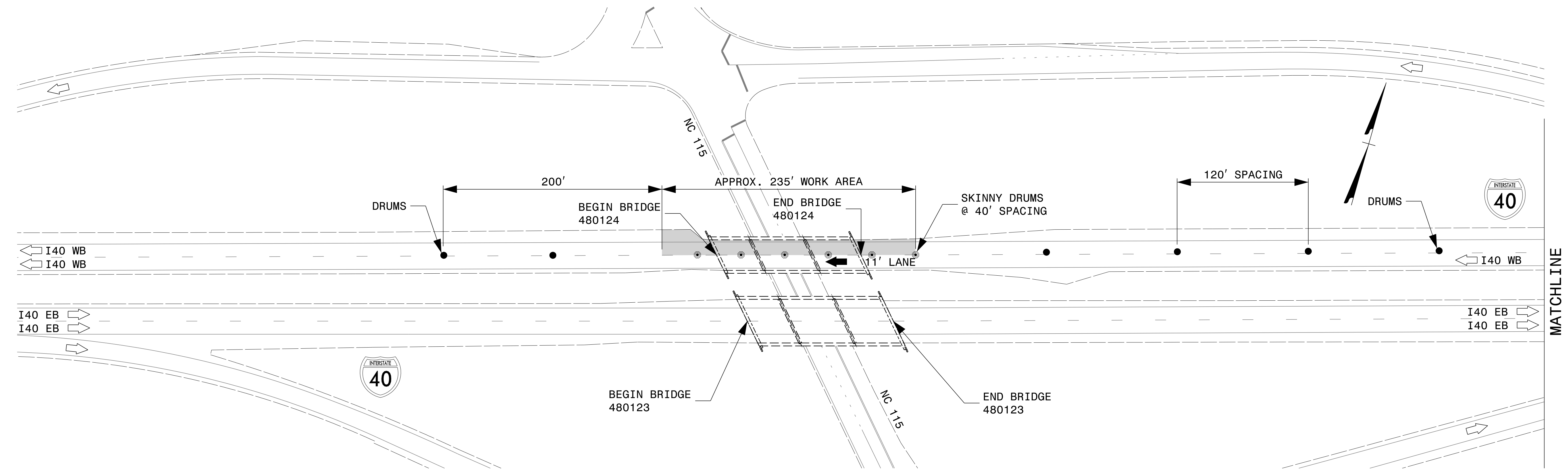

- NOTES:**
1. USE THIS DRAWING IN CONJUNCTION WITH RSD 1101.02 SHEET 4 OF 14.
 2. USE SKINNY DRUMS THROUGH WORK AREA.
 3. SEE SHEET TMP-1D FOR "ROAD NARROWS" SIGN PLACEMENT.

APPROVED: *Jacob Duke*
 DATE: 4/26/2022

SEAL

DocuSigned by:
 Jacob Duke
 2953030304E409

PROFESSIONAL SEAL
 043777
 ENGINEER
 JACOB H. DUKE

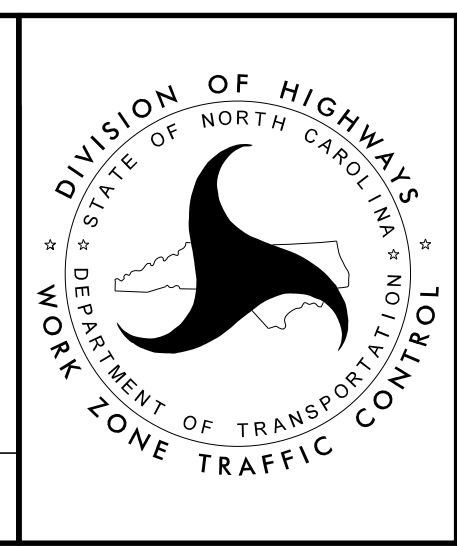

I40 WB STRUCTURE
 480124 OUTSIDE LANE
 CLOSURE DETAILS

4/21/2022 15:51:55 TC: TMP_I40 WB STRUCTURE I24 OUTSIDE LANE CLOSURE DETAILS.dgn User: jdebone

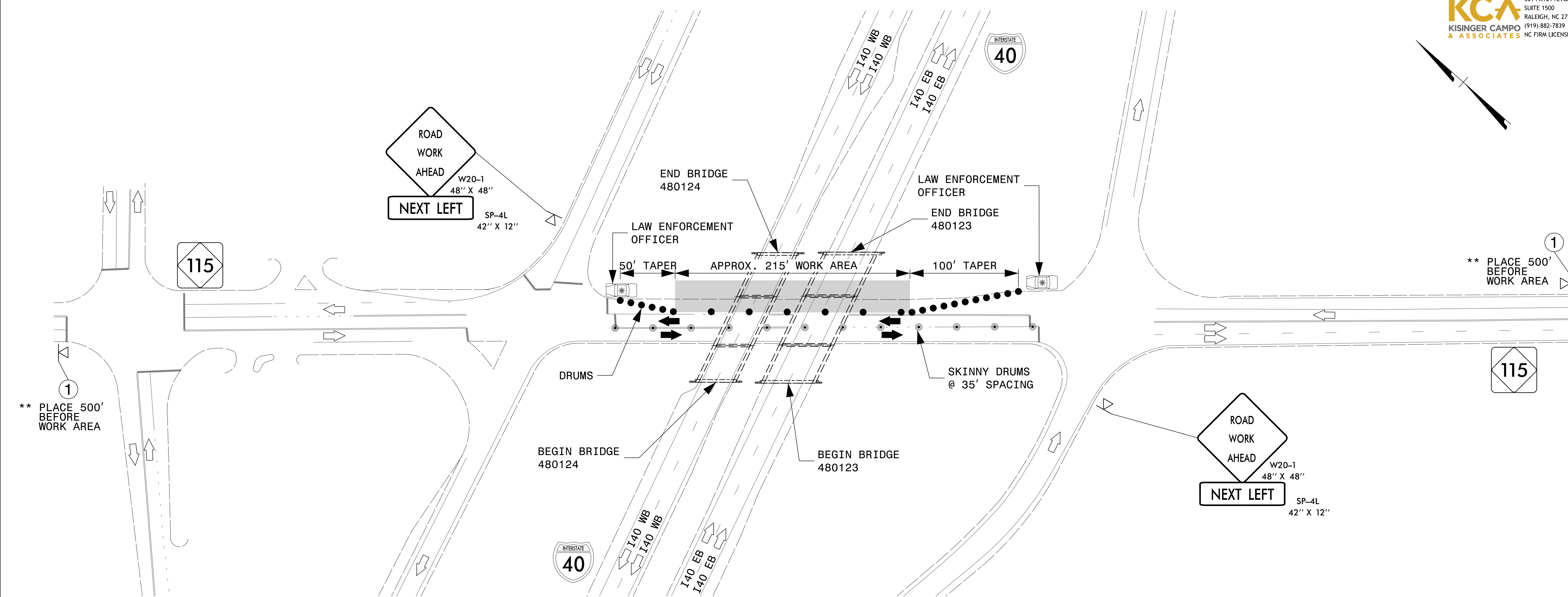

** PLACE 500' BEFORE WORK AREA

** PLACE 500' BEFORE WORK AREA

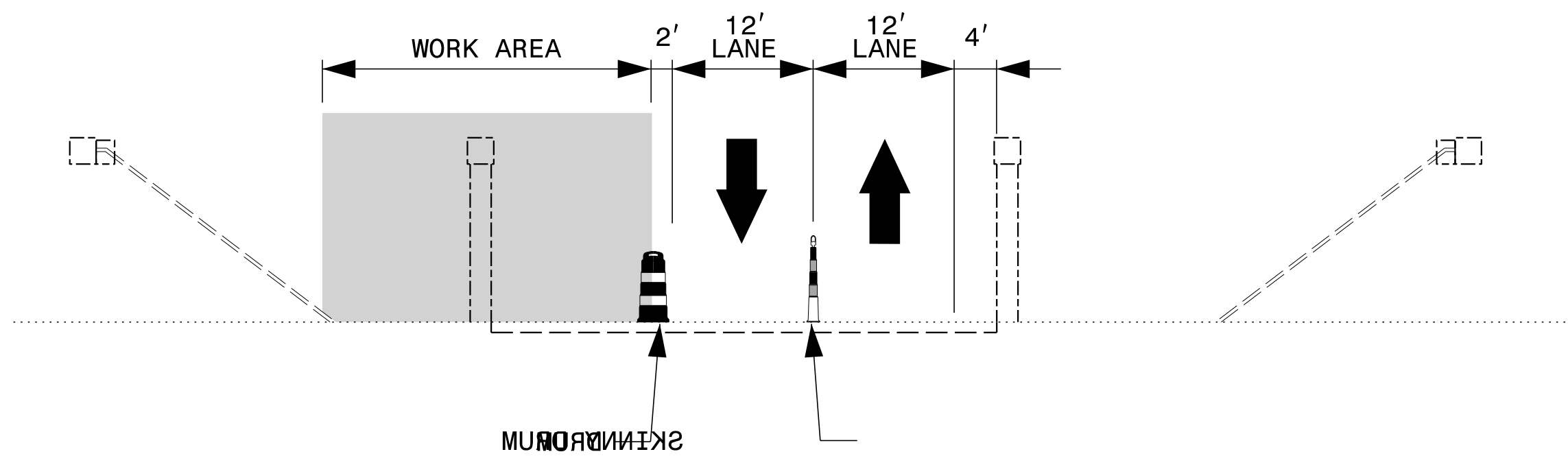

NOTES:

1. TRAFFIC CONTROL DEVICES SHALL BE INSTALLED PER ENGINEER'S INSTRUCTIONS.
2. USE SKINNY DRUMS TO DIVIDE TRAFFIC.

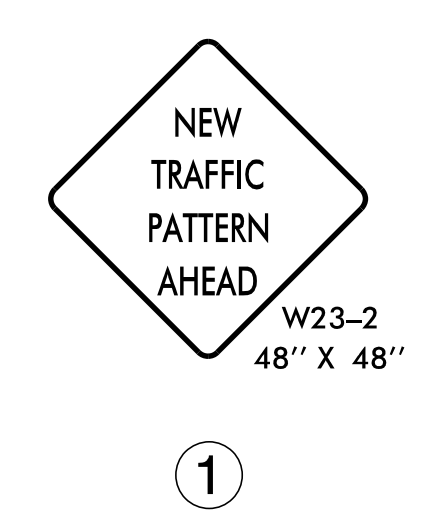

4/21/2022
15915B_TC_TMP_NC_115_NB_OUTSIDE_LANE_CLOSURE_DETAILS.dgn
User: jdebone

APPROVED: *Jacob Duke*
DATE: 4/26/2022

SEAL

PROFESSIONAL ENGINEER
JACOB H. DUKE
043777

DOCUMENT NOT CONSIDERED FINAL
UNLESS ALL SIGNATURES COMPLETED

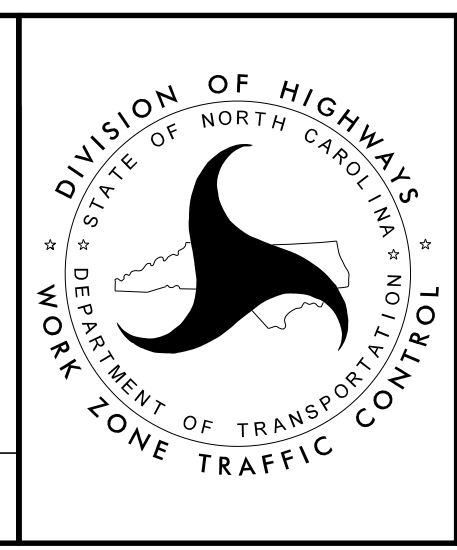

NC 115 NB OUTSIDE
LANE CLOSURE DETAILS

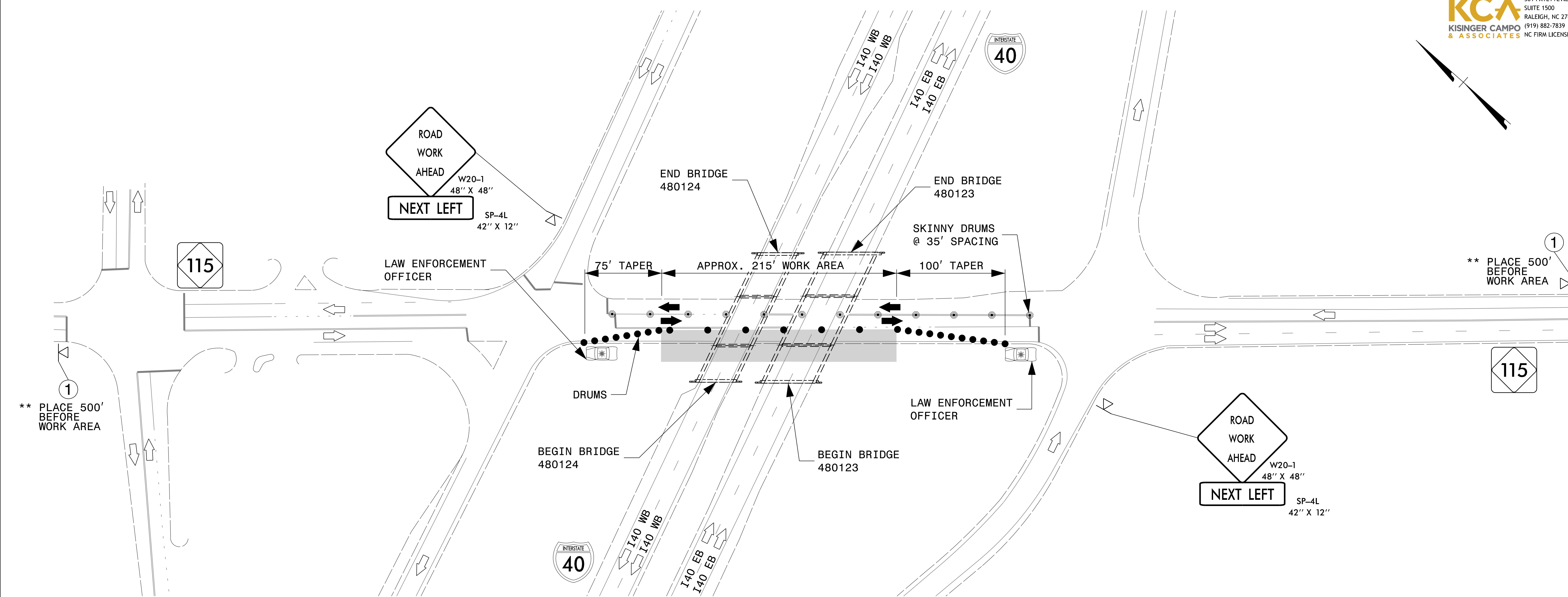

** PLACE 500' BEFORE WORK AREA

** PLACE 500' BEFORE WORK AREA

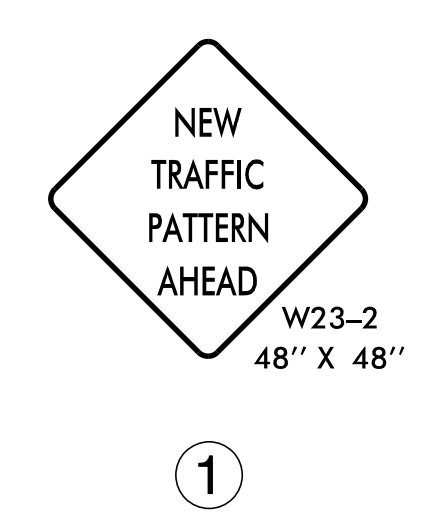
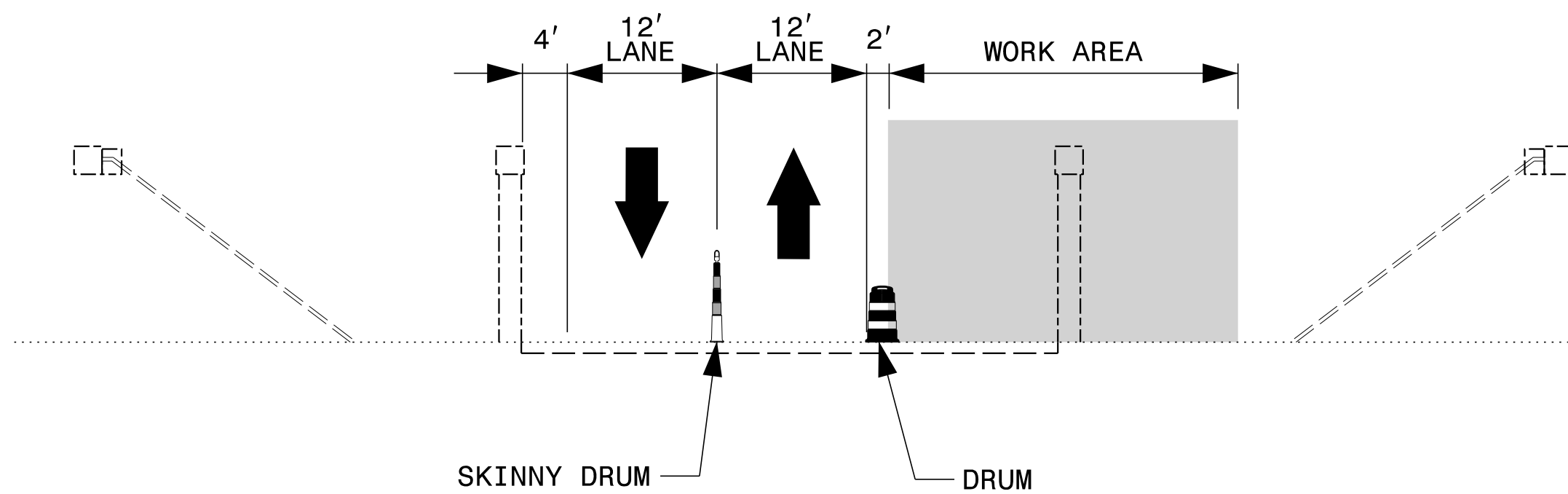

- NOTES:**
1. TRAFFIC CONTROL DEVICES SHALL BE INSTALLED PER ENGINEER'S INSTRUCTIONS.
 2. USE SKINNY DRUMS TO DIVIDE TRAFFIC.

APPROVED: *Jacob Duke*
 DATE: 4/26/2022

SEAL

PROFESSIONAL ENGINEER
 JACOB H. DUKE
 043777

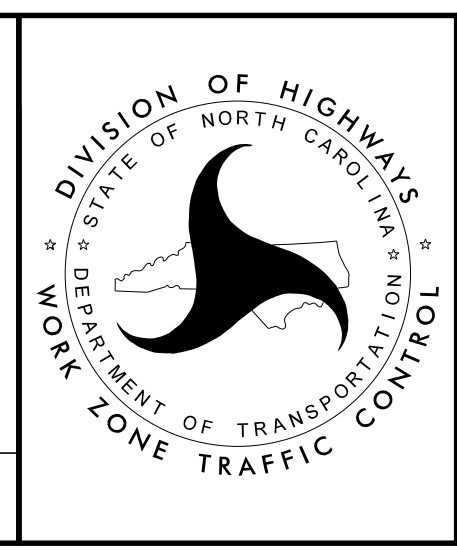

NC 115 SB OUTSIDE
 LANE CLOSURE DETAILS

4/21/2022
 I5915B_TC_TMP_NC_I15_SB_OUTSIDE_LANE_CLOSURE_DETAILS.dgn
 User: jdebone