

SEE RSD 1101.02
SHEET 4 OF 14

MATCHLINE SHEET (2 OF 2)

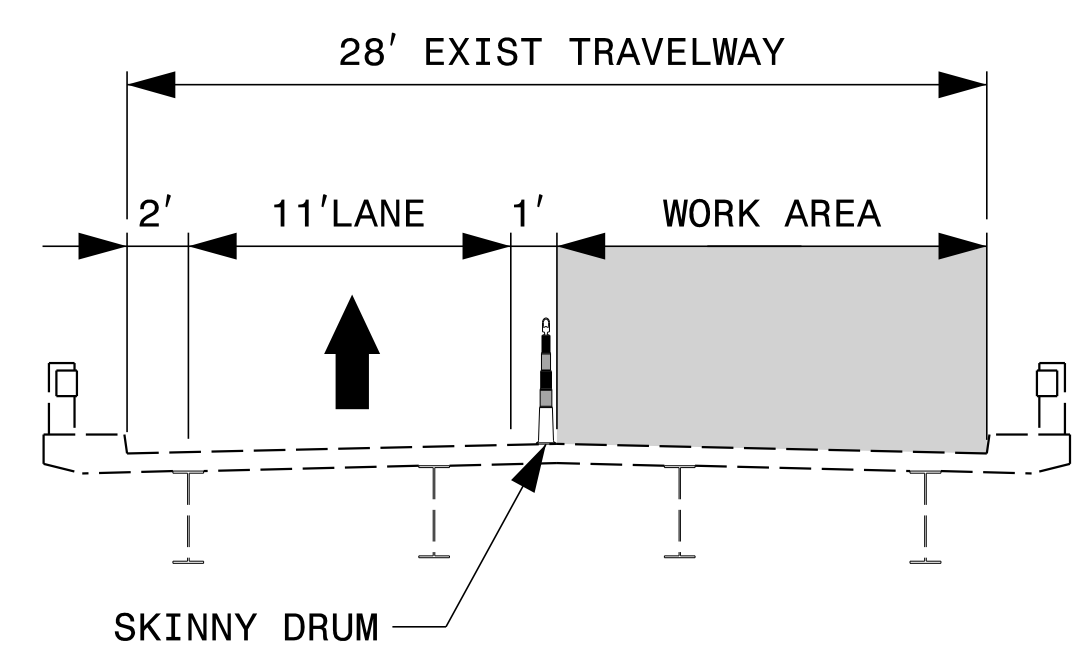

NOTES:

1. USE THIS DRAWING IN CONJUNCTION WITH RSD 1101.02 SHEET 4 OF 14 AND TMP-24.
2. USE SKINNY DRUMS THROUGH WORK AREA.
3. SEE SHEET TMP-1D FOR "ROAD NARROWS" SIGN PLACEMENT.

APPROVED: *Jacob Duke*
 DATE: 4/26/2022

SEAL

**DOCUMENT NOT CONSIDERED FINAL
UNLESS ALL SIGNATURES COMPLETED**

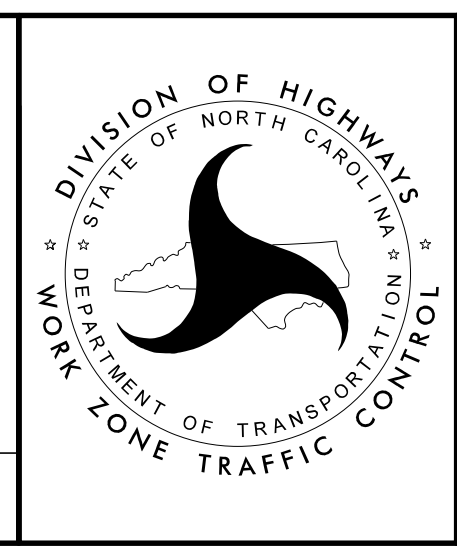

**I40 EB STRUCTURES
 480051 AND 480065
 OUTSIDE LANE
 CLOSURE DETAILS
 (1 OF 2)**

4/21/2022 15:51:55 TC: TMP_I40_EB_STRUCTURES_051AND_065_OUTSIDE_LANE_CLOSURE_DETAILS (1 OF 2).dgn User: jdebone