

1

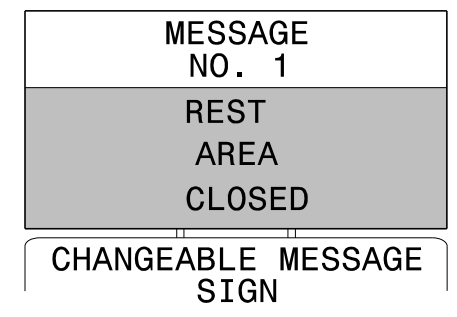

2

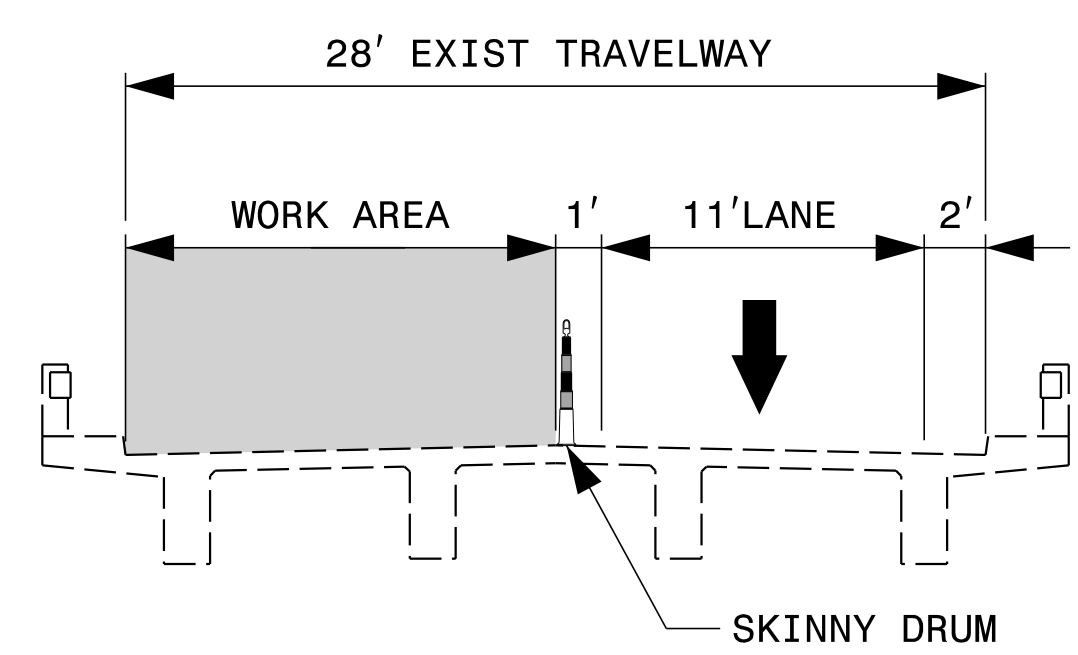

NOTES:

1. USE THIS DRAWING IN CONJUNCTION WITH RSD 1101.02 SHEET 4 OF 14.
2. USE SKINNY DRUMS THROUGH WORK AREA.
3. SEE SHEET TMP-1D FOR "ROAD NARROWS" SIGN PLACEMENT.

APPROVED: *Jacob Duke*
DATE: 4/26/2022

SEAL

**DOCUMENT NOT CONSIDERED FINAL
UNLESS ALL SIGNATURES COMPLETED**

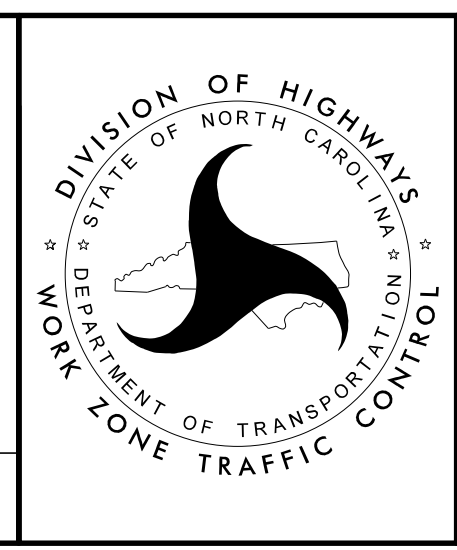

**I40 WB STRUCTURE 170178
OUTSIDE LANE
CLOSURE DETAILS**

4/21/2022 15:51:58 TC: TMP_I40 WB STRUCTURE 178 OUTSIDE LANE CLOSURE DETAILS.dgn User: jdebone