

SUPERSTRUCTURE REINFORCING STEEL LENGTHS ARE BASED ON THE FOLLOWING MINIMUM SPLICE LENGTHS

BAR SIZE	SUPERSTRUCTURE EXCEPT APPROACH SLABS, PARAPETS, AND BARRIER RAILS		APPROACH SLABS		PARAPETS AND BARRIER RAILS
	EPOXY COATED	UNCOATED	EPOXY COATED	UNCOATED	
#4	1'-11"	1'-7"	1'-11"	1'-7"	2'-6"
#5	2'-5"	2'-0"	2'-5"	2'-0"	3'-1"
#6	2'-10"	2'-5"	3'-7"	2'-5"	3'-8"
#7	4'-2"	2'-9"			
#8	4'-9"	3'-2"			

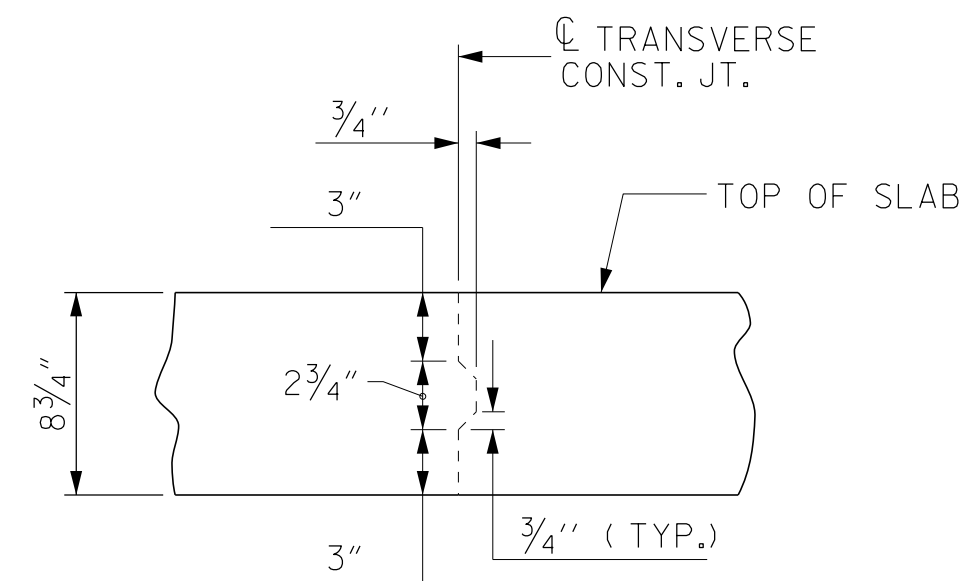

TRANSVERSE CONSTRUCTION JOINT DETAIL

NOTE: REINFORCING STEEL IN SLAB NOT SHOWN. LONGITUDINAL REINFORCING STEEL SHALL BE CONTINUOUS THRU JOINT.

BILL OF MATERIAL

BAR NO.	SIZE	TYPE	LENGTH	WEIGHT	BAR NO.	SIZE	TYPE	LENGTH	WEIGHT	BAR NO.	SIZE	TYPE	LENGTH	WEIGHT			
* A1	485	#5	STR	38'-11"	19,686	* A133	2	#5	STR	8'-2"	17	A226	2	#5	STR	14'-9"	31
A2	485	#5	STR	38'-11"	19,686	* A134	2	#5	STR	7'-3"	15	A227	2	#5	STR	13'-9"	29
* A101	2	#5	STR	38'-2"	80	* A135	2	#5	STR	6'-3"	13	A228	2	#5	STR	12'-10"	27
* A102	2	#5	STR	37'-3"	78	* A136	2	#5	STR	5'-4"	11	A229	2	#5	STR	11'-11"	25
* A103	2	#5	STR	36'-4"	76	* A137	2	#5	STR	4'-5"	9	A230	2	#5	STR	11'-0"	23
* A104	2	#5	STR	35'-4"	74	* A138	2	#5	STR	3'-6"	7	A231	2	#5	STR	10'-0"	21
* A105	2	#5	STR	34'-5"	72	* A139	2	#5	STR	2'-6"	5	A232	2	#5	STR	9'-1"	19
* A106	2	#5	STR	33'-6"	70	* A140	2	#5	STR	1'-7"	3	A233	2	#5	STR	8'-2"	17
* A107	2	#5	STR	32'-7"	68	* A141	4	#5	STR	1'-6"	6	A234	2	#5	STR	7'-3"	15
* A108	2	#5	STR	31'-7"	66	A201	2	#5	STR	38'-2"	80	A235	2	#5	STR	6'-3"	13
* A109	2	#5	STR	30'-8"	64	A202	2	#5	STR	37'-3"	78	A236	2	#5	STR	5'-4"	11
* A110	2	#5	STR	29'-8"	62	A203	2	#5	STR	36'-4"	76	A237	2	#5	STR	4'-5"	9
* A111	2	#5	STR	28'-10"	60	A204	2	#5	STR	35'-4"	74	A238	2	#5	STR	3'-6"	7
* A112	2	#5	STR	27'-10"	58	A205	2	#5	STR	34'-5"	72	A239	2	#5	STR	2'-6"	5
* A113	2	#5	STR	26'-11"	56	A206	2	#5	STR	33'-6"	70	A240	2	#5	STR	1'-7"	3
* A114	2	#5	STR	26'-0"	54	A207	2	#5	STR	32'-7"	68	A241	4	#5	STR	1'-6"	6
* A115	2	#5	STR	25'-1"	52	A208	2	#5	STR	31'-7"	66						
* A116	2	#5	STR	24'-1"	50	A209	2	#5	STR	30'-8"	64	* B1	54	#4	STR	26'-11"	971
* A117	2	#5	STR	23'-2"	48	A210	2	#5	STR	29'-8"	62	* B2	54	#5	STR	35'-6"	1,999
* A118	2	#5	STR	22'-3"	46	A211	2	#5	STR	28'-10"	60	* B3	52	#5	STR	39'-3"	2,129
* A119	2	#5	STR	21'-4"	45	A212	2	#5	STR	27'-10"	58	* B4	54	#4	STR	21'-11"	791
* A120	2	#5	STR	20'-4"	42	A213	2	#5	STR	26'-11"	56	* B5	54	#5	STR	37'-0"	2,084
* A121	2	#5	STR	19'-5"	41	A214	2	#5	STR	26'-0"	54	* B6	52	#5	STR	40'-9"	2,210
* A122	2	#5	STR	18'-6"	39	A215	2	#5	STR	25'-1"	52	* B7	54	#4	STR	30'-6"	1,100
* A123	2	#5	STR	17'-7"	37	A216	2	#5	STR	24'-1"	50	B8	180	#5	STR	58'-8"	11,014
* A124	2	#5	STR	16'-7"	35	A217	2	#5	STR	23'-2"	48	B9	31	#5	STR	49'-0"	1,584
* A125	2	#5	STR	15'-8"	33	A218	2	#5	STR	22'-3"	46	B10	31	#5	STR	51'-0"	1,649
* A126	2	#5	STR	14'-9"	31	A219	2	#5	STR	21'-4"	45						
* A127	2	#5	STR	13'-9"	29	A220	2	#5	STR	20'-4"	42	* G1	2	#5	STR	44'-11"	94
* A128	2	#5	STR	12'-10"	27	A221	2	#5	STR	19'-5"	41						
* A129	2	#5	STR	11'-11"	25	A222	2	#5	STR	18'-6"	39	* K1	8	#8	1	12'-5"	265
* A130	2	#5	STR	11'-0"	23	A223	2	#5	STR	17'-7"	37	* K2	8	#8	2	19'-1"	408
* A131	2	#5	STR	10'-0"	21	A224	2	#5	STR	16'-7"	35	* K3	18	#6	STR	7'-0"	189
* A132	2	#5	STR	9'-1"	19	A225	2	#5	STR	15'-8"	33						

BAR TYPES

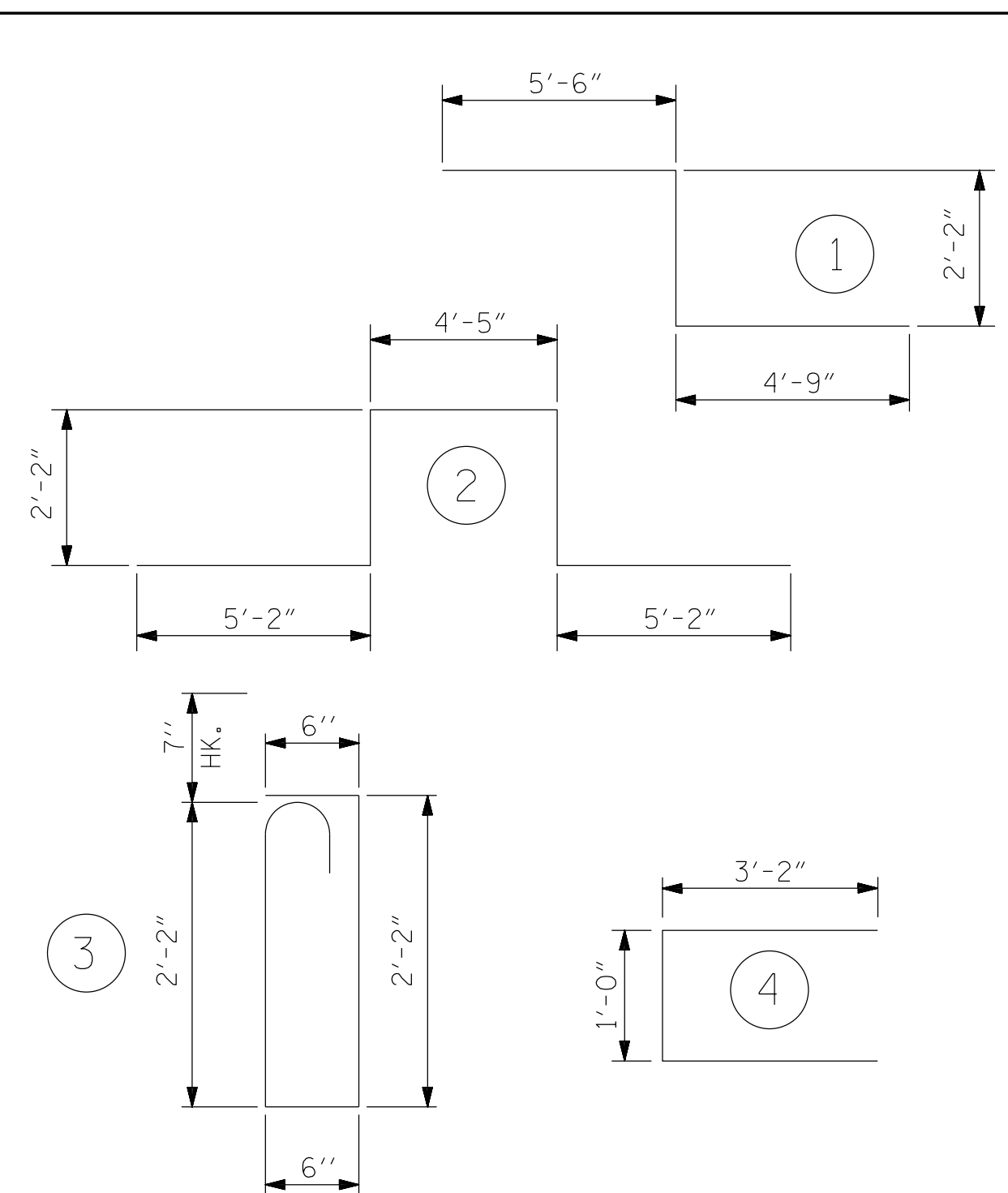

ALL BAR DIMENSIONS ARE OUT TO OUT

SUPERSTRUCTURE BILL OF MATERIAL

	CLASS AA CONCRETE	REINFORCING STEEL	* EPOXY COATED REINFORCING STEEL
	(CU. YDS.)	(LBS.)	(LBS.)
POUR 1	313.3		
POUR 2	47.7		
TOTALS**	361.0	35,600	34,058

**QUANTITIES FOR BARRIER RAIL ARE NOT INCLUDED

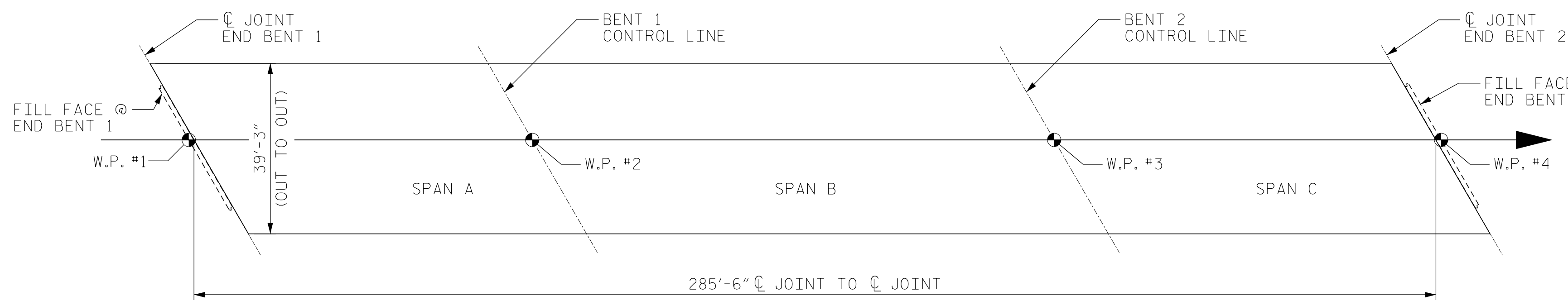

LAYOUT FOR COMPUTING AREA REINFORCED CONCRETE DECK SLAB (SQ. FT. = 11,199)

GROOVING BRIDGE FLOORS		
APPROACH SLABS	1,612	SQ.FT.
BRIDGE DECK	9,390	SQ.FT.
TOTAL	11,002	SQ.FT.

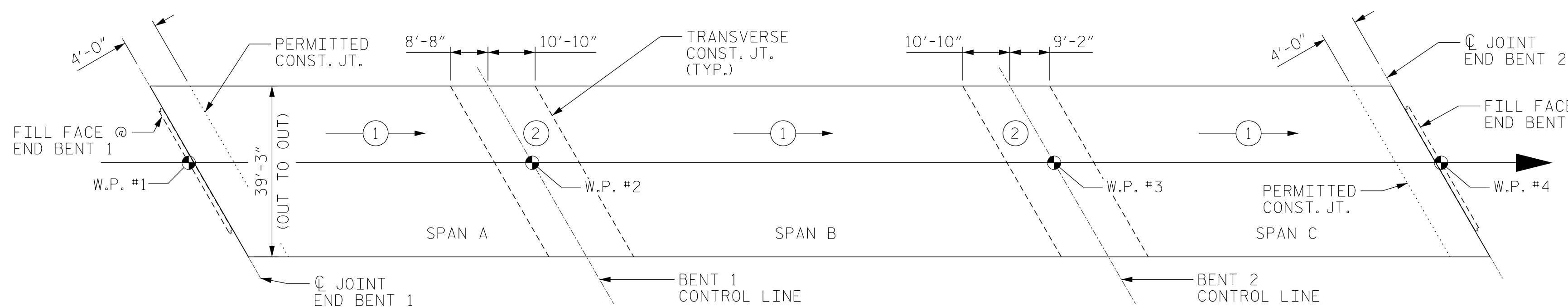

POURING SEQUENCE

PROJECT NO. BR-0070
CASWELL COUNTY
STATION: 30+57.00 -L-

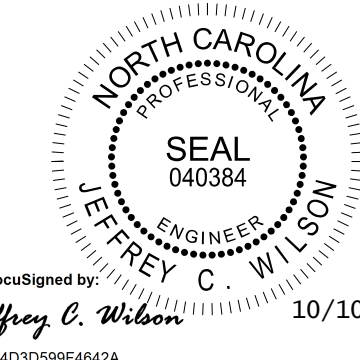

DOCUMENT NOT CONSIDERED FINAL UNLESS ALL SIGNATURES COMPLETED

STEWART
Firm License No. C-1051
223 S West St,
Suite 1100
Raleigh, NC 27603
T 919.380.8750
www.stewartinc.com

REVISIONS						SHEET NO.
NO.	BY:	DATE:	NO.	BY:	DATE:	S-26
1			3			TOTAL SHEETS
2			4			39

BR-0070
10/10/2022
BR-0070-SMU-BMI-160061.dgn
USER: jwilson

DRAWN BY: J. WILSON DATE: 10/22
CHECKED BY: D. RUGGLES DATE: 10/22
DESIGN ENGINEER OF RECORD: J. WILSON DATE: 10/22