

8/17/99

-L-

PI Sta 17+02.78	PI Sta 24+22.25
$\Delta = 4' 18" 09.6" (RT)$	$\Delta = 4' 18" 09.6" (LT)$
$D = 0' 42" 39.1"$	$D = 0' 30" 58.2"$
$L = 605.27'$	$L = 833.56'$
$T = 302.78'$	$T = 416.98'$
$R = 8,060.00'$	$R = 11,100.00'$
$S_e = RC$	$S_e = NC$
Runoff = 54'	

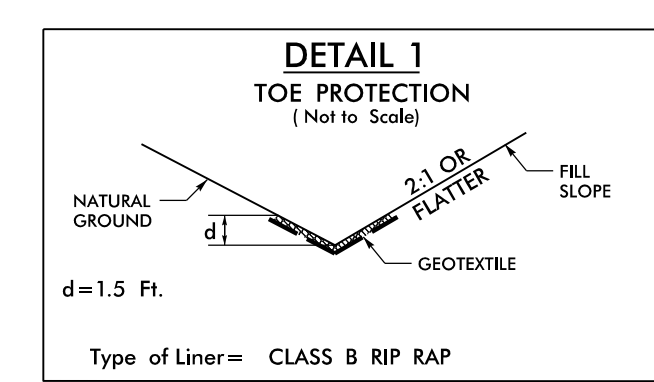

Type of Liner = CLASS B RIP RAP
 FROM STA. 15+19 TO STA. 16+63 -L- LT
 FROM STA. 21+00 TO STA. 21+21 -L- RT

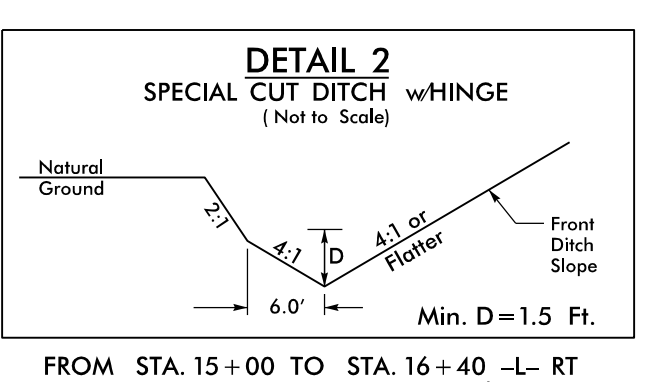

FROM STA. 15+00 TO STA. 16+40 -L- RT

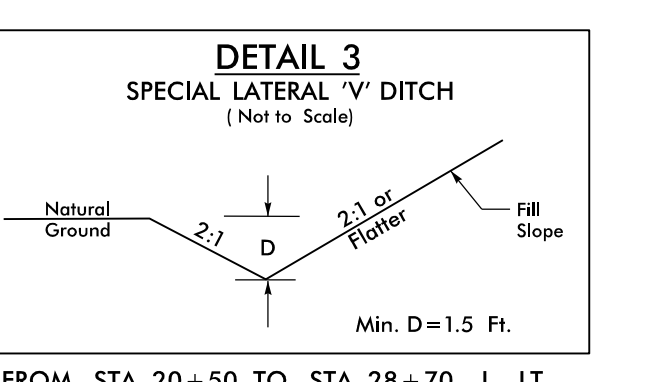

FROM STA. 20+50 TO STA. 28+70 -L- LT
 FROM STA. 22+50 TO STA. 22+86 -L- RT

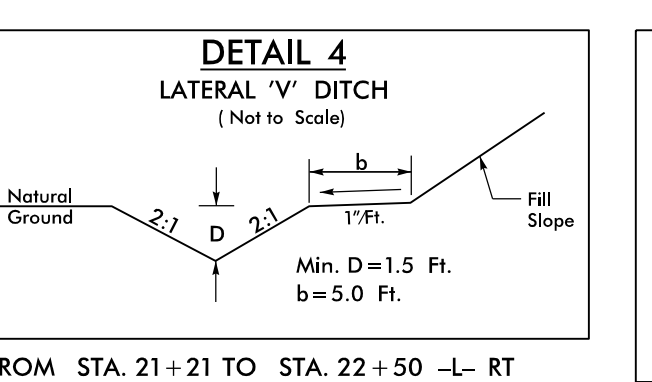

FROM STA. 21+21 TO STA. 22+50 -L- RT

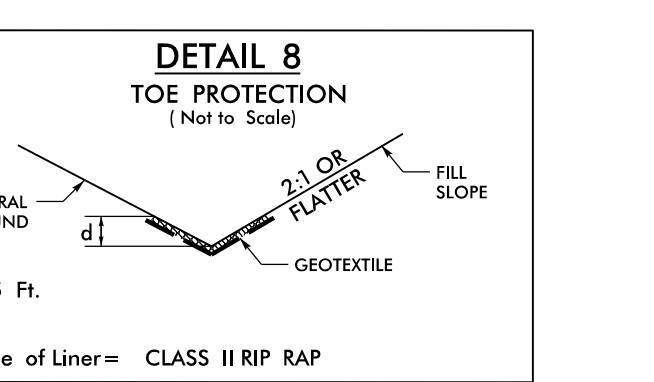

Type of Liner = CLASS II RIP RAP
 FROM STA. 12+85 TO STA. 13+43 -L- LT
 FROM STA. 12+96 TO STA. 13+09 -L- RT
 FROM STA. 13+18 TO STA. 14+50 -L- RT

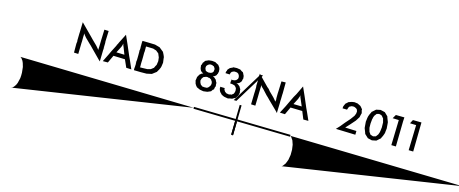

PROJECT REFERENCE NO. BR-0070	SHEET NO. 4
ROADWAY DESIGN ENGINEER 10/20/2022	HYDRAULICS ENGINEER 10/26/2022
Professional Engineer Seal MICHAEL S. BURNS, JR. SEAL 045230 NORTH CAROLINA PROFESSIONAL ENGINEERS BOARD	Professional Engineer Seal Reid B. Robb SEAL 043870 NORTH CAROLINA PROFESSIONAL ENGINEERS BOARD
Michael S. Burns, Jr. 223 S. West St. Raleigh, NC 27601 www.stewartinc.com	Reid B. Robb 223 S. West St. Raleigh, NC 27601 www.vhb.com
STEWART	VHB Engineering NC, P.C. (C-3705) 940 Main Campus Drive, Suite 500 Raleigh, NC 27606
DOCUMENT NOT CONSIDERED FINAL UNLESS ALL SIGNATURES COMPLETED	

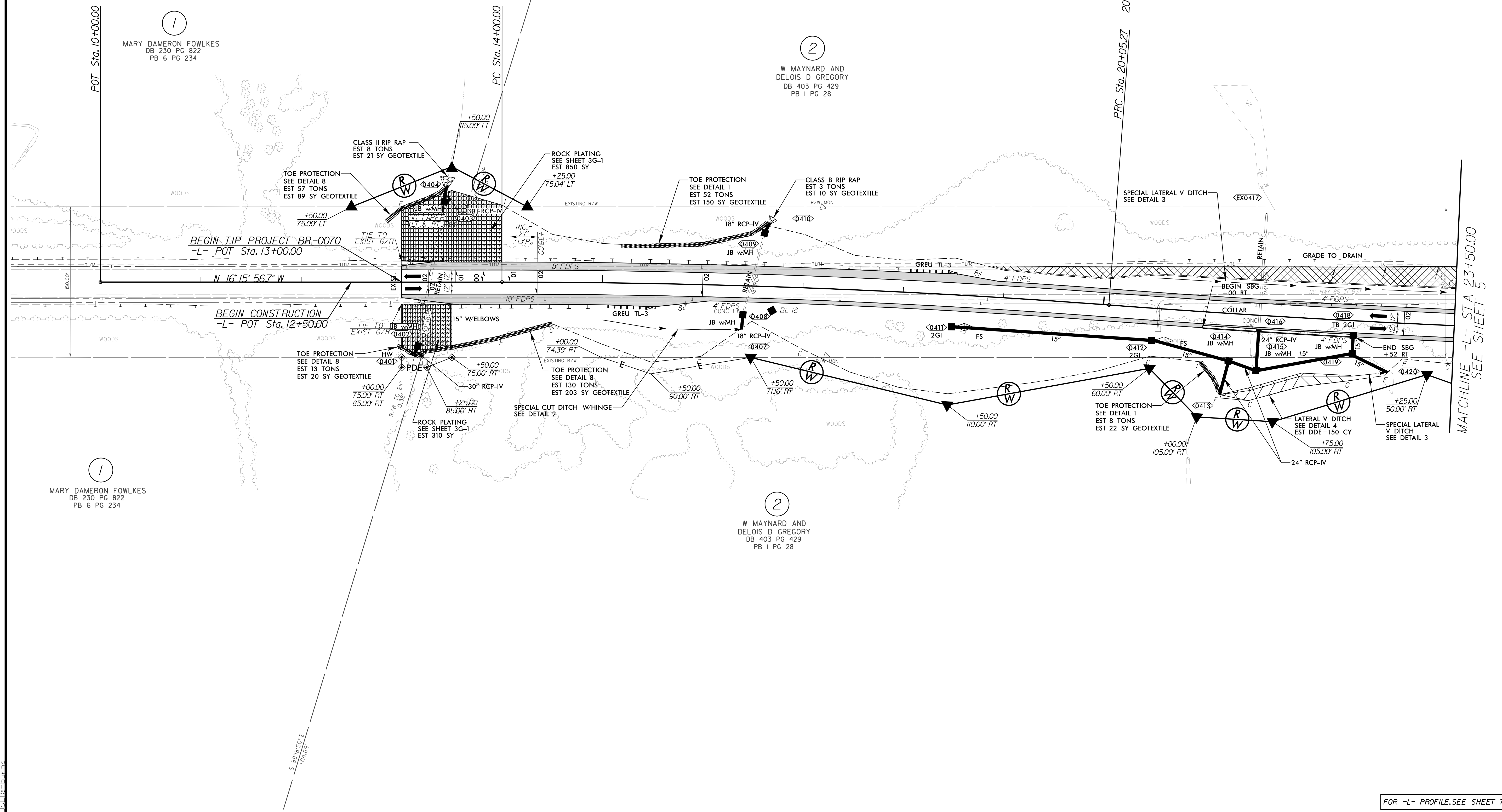

9/18/2022 BR0070_Rdy_psh_04.dgn

FOR -L- PROFILE, SEE SHEET 7