

**This electronic collection of documents is provided
for the convenience of the user
and is Not a Certified Document –**

**The documents contained herein were originally issued
and sealed by the individuals whose names and license
numbers appear on each page, on the dates appearing
with their signature on that page.**

**This file or an individual page
shall not be considered a certified document.**

REFERENCE: B-5644

PROJECT: 45599

STATE OF NORTH CAROLINA
DEPARTMENT OF TRANSPORTATION
DIVISION OF HIGHWAYS
GEOTECHNICAL ENGINEERING UNIT

STATE	STATE PROJECT REFERENCE NO.	SHEET NO.	TOTAL SHEETS
N.C.	B-5644	1	6

CONTENTS

SHEET NO.	DESCRIPTION
1	TITLE SHEET
2	LEGEND (SOIL & ROCK)
3	SITE PLAN
4	PROFILE
5	BORE LOGS
6	SITE PHOTOGRAPHS

STRUCTURE
SUBSURFACE INVESTIGATION

COUNTY PENDER
PROJECT DESCRIPTION REPLACE BRIDGE NO. 700015
ON NC 11 OVER CROOKED RUN AT
STATION 15+55 -L-

CAUTION NOTICE

THE SUBSURFACE INFORMATION AND THE SUBSURFACE INVESTIGATION ON WHICH IT IS BASED WERE MADE FOR THE PURPOSE OF STUDY, PLANNING AND DESIGN, AND NOT FOR CONSTRUCTION OR PAY PURPOSES. THE VARIOUS FIELD BORING LOGS, ROCK CORES AND SOIL TEST DATA AVAILABLE MAY BE REVIEWED OR INSPECTED IN RALEIGH BY CONTACTING THE N. C. DEPARTMENT OF TRANSPORTATION, GEOTECHNICAL ENGINEERING UNIT AT 1919 707-6850. THE SUBSURFACE PLANS AND REPORTS, FIELD BORING LOGS, ROCK CORES AND SOIL TEST DATA ARE NOT PART OF THE CONTRACT.

GENERAL SOIL AND ROCK STRATA DESCRIPTIONS AND INDICATED BOUNDARIES ARE BASED ON A GEOTECHNICAL INTERPRETATION OF ALL AVAILABLE SUBSURFACE DATA AND MAY NOT NECESSARILY REFLECT THE ACTUAL SUBSURFACE CONDITIONS BETWEEN BORINGS OR BETWEEN SAMPLED STRATA WITHIN THE BOREHOLE. THE LABORATORY SAMPLE DATA AND THE IN SITU (IN-PLACE) TEST DATA CAN BE RELIED ON ONLY TO THE DEGREE OF RELIABILITY INHERENT IN THE STANDARD TEST METHOD. THE OBSERVED WATER LEVELS OR SOIL MOISTURE CONDITIONS INDICATED IN THE SUBSURFACE INVESTIGATIONS ARE AS RECORDED AT THE TIME OF THE INVESTIGATION. THESE WATER LEVELS OR SOIL MOISTURE CONDITIONS MAY VARY CONSIDERABLY WITH TIME ACCORDING TO CLIMATIC CONDITIONS INCLUDING TEMPERATURES, PRECIPITATION AND WIND, AS WELL AS OTHER NON-CLIMATIC FACTORS.

THE BIDDER OR CONTRACTOR IS CAUTIONED THAT DETAILS SHOWN ON THE SUBSURFACE PLANS ARE PRELIMINARY ONLY AND IN MANY CASES THE FINAL DESIGN DETAILS ARE DIFFERENT. FOR BIDDING AND CONSTRUCTION PURPOSES, REFER TO THE CONSTRUCTION PLANS AND DOCUMENTS FOR FINAL DESIGN INFORMATION ON THIS PROJECT. THE DEPARTMENT DOES NOT WARRANT OR GUARANTEE THE SUFFICIENCY OR ACCURACY OF THE INVESTIGATION MADE, NOR THE INTERPRETATIONS MADE, OR OPINION OF THE DEPARTMENT AS TO THE TYPE OF MATERIALS AND CONDITIONS TO BE ENCOUNTERED. THE BIDDER OR CONTRACTOR IS CAUTIONED TO MAKE SUCH INDEPENDENT SUBSURFACE INVESTIGATIONS AS HE DEEMS NECESSARY TO SATISFY HIMSELF AS TO CONDITIONS TO BE ENCOUNTERED ON THE PROJECT. THE CONTRACTOR SHALL HAVE NO CLAIM FOR ADDITIONAL COMPENSATION OR FOR AN EXTENSION OF TIME FOR ANY REASON RESULTING FROM THE ACTUAL CONDITIONS ENCOUNTERED AT THE SITE DIFFERING FROM THOSE INDICATED IN THE SUBSURFACE INFORMATION.

- NOTES:
1. THE INFORMATION CONTAINED HEREIN IS NOT IMPLIED OR GUARANTEED BY THE N. C. DEPARTMENT OF TRANSPORTATION AS ACCURATE NOR IS IT CONSIDERED PART OF THE PLANS, SPECIFICATIONS OR CONTRACT FOR THE PROJECT.
 2. BY HAVING REQUESTED THIS INFORMATION, THE CONTRACTOR SPECIFICALLY WAIVES ANY CLAIMS FOR INCREASED COMPENSATION OR EXTENSION OF TIME BASED ON DIFFERENCES BETWEEN THE CONDITIONS INDICATED HEREIN AND THE ACTUAL CONDITIONS AT THE PROJECT SITE.

PERSONNEL

RUSSEK, S. C.

STUDNICKY, R. T.

MOODY, J. R.

INVESTIGATED BY RUSSEK, S. C.

DRAWN BY FIELDS, W. D.

CHECKED BY RIGGS, Jr., A. F.

SUBMITTED BY ALEXANDER, M. J.

DATE AUGUST 2019

Prepared in the Office of:

Terracon

Consulting Engineers and Scientists

2401 BRENTWOOD ROAD, SUITE 107
RALPHIGH, NORTH CAROLINA 27604
NC REGISTERED ENGINEERING FIRM: F-0869
NC REGISTERED GEOLOGIC FIRM: C-367



DocuSigned by:

Matthew J. Alexander 8/22/2019

AC113DDE6101413

SIGNATURE DATE

DOCUMENT NOT CONSIDERED FINAL
UNLESS ALL SIGNATURES COMPLETED

**NORTH CAROLINA DEPARTMENT OF TRANSPORTATION
DIVISION OF HIGHWAYS
GEOTECHNICAL ENGINEERING UNIT**

SUBSURFACE INVESTIGATION

SOIL AND ROCK LEGEND, TERMS, SYMBOLS, AND ABBREVIATIONS

SOIL DESCRIPTION										GRADATION										ROCK DESCRIPTION										TERMS AND DEFINITIONS																																																																																									
<p>SOIL IS CONSIDERED UNCONSOLIDATED, SEMI-CONSOLIDATED, OR WEATHERED EARTH MATERIALS THAT CAN BE PENETRATED WITH A CONTINUOUS FLIGHT POWER AUGER AND YIELD LESS THAN 100 BLOWS PER FOOT ACCORDING TO THE STANDARD PENETRATION TEST (AASHTO T 206, ASTM D1586). SOIL CLASSIFICATION IS BASED ON THE AASHTO SYSTEM. BASIC DESCRIPTIONS GENERALLY INCLUDE THE FOLLOWING: CONSISTENCY, COLOR, TEXTURE, MOISTURE, AASHTO CLASSIFICATION, AND OTHER PERTINENT FACTORS SUCH AS MINERALOGICAL COMPOSITION, ANGULARITY, STRUCTURE, PLASTICITY, ETC. FOR EXAMPLE, <i>VERY STIFF, GRAY, SILTY CLAY, MOIST WITH INTERBEDDED FINE SAND LAYERS, HIGHLY PLASTIC, A-7-6</i></p>										<p>WELL GRADED - INDICATES A GOOD REPRESENTATION OF PARTICLE SIZES FROM FINE TO COARSE. UNIFORMLY GRADED - INDICATES THAT SOIL PARTICLES ARE ALL APPROXIMATELY THE SAME SIZE. GAP-GRADED - INDICATES A MIXTURE OF UNIFORM PARTICLE SIZES OF TWO OR MORE SIZES.</p> <p style="text-align: center;">ANGULARITY OF GRAINS</p> <p>THE ANGULARITY OR ROUNDNESS OF SOIL GRAINS IS DESIGNATED BY THE TERMS: ANGULAR, SUBANGULAR, SUBROUNDED, OR ROUNDED.</p>										<p>HARD ROCK IS NON-COASTAL PLAIN MATERIAL THAT WOULD YIELD SPT REFUSAL IF TESTED, AN INFERRED ROCK LINE INDICATES THE LEVEL AT WHICH NON-COASTAL PLAIN MATERIAL WOULD YIELD SPT REFUSAL. SPT REFUSAL IS PENETRATION BY A SPLIT SPOON SAMPLER EQUAL TO OR LESS THAN 0.1 FOOT PER 60 BLOWS IN NON-COASTAL PLAIN MATERIAL. THE TRANSITION BETWEEN SOIL AND ROCK IS OFTEN REPRESENTED BY A ZONE OF WEATHERED ROCK. ROCK MATERIALS ARE TYPICALLY DIVIDED AS FOLLOWS:</p> <p>WEATHERED ROCK (WR) - NON-COASTAL PLAIN MATERIAL THAT WOULD YIELD SPT N VALUES > 100 BLOWS PER FOOT IF TESTED.</p> <p>CRYSTALLINE ROCK (CR) - FINE TO COARSE GRAIN IGNEOUS AND METAMORPHIC ROCK THAT WOULD YIELD SPT REFUSAL IF TESTED. ROCK TYPE INCLUDES GRANITE, GNEISS, GABBRO, SCHIST, ETC.</p> <p>NON-CRYSTALLINE ROCK (NCR) - FINE TO COARSE GRAIN METAMORPHIC AND NON-COASTAL PLAIN SEDIMENTARY ROCK THAT WOULD YIELD SPT REFUSAL IF TESTED. ROCK TYPE INCLUDES PHYLLITE, SLATE, SANDSTONE, ETC.</p> <p>COASTAL PLAIN SEDIMENTARY ROCK (CP) - COASTAL PLAIN SEDIMENTS CEMENTED INTO ROCK, BUT MAY NOT YIELD SPT REFUSAL. ROCK TYPE INCLUDES LIMESTONE, SANDSTONE, CEMENTED SHELL BEDS, ETC.</p>										<p>ALLUVIUM (ALLUV.) - SOILS THAT HAVE BEEN TRANSPORTED BY WATER. AQUIFER - A WATER BEARING FORMATION OR STRATA. ARENACEOUS - APPLIED TO ROCKS THAT HAVE BEEN DERIVED FROM SAND OR THAT CONTAIN SAND. ARGILLACEOUS - APPLIED TO ALL ROCKS OR SUBSTANCES COMPOSED OF CLAY MINERALS, OR HAVING A NOTABLE PROPORTION OF CLAY IN THEIR COMPOSITION, SUCH AS SHALE, SLATE, ETC. ARTESIAN - GROUND WATER THAT IS UNDER SUFFICIENT PRESSURE TO RISE ABOVE THE LEVEL AT WHICH IT IS ENCOUNTERED, BUT WHICH DOES NOT NECESSARILY RISE TO OR ABOVE THE GROUND SURFACE. CALCAREOUS (CALC.) - SOILS THAT CONTAIN APPRECIABLE AMOUNTS OF CALCIUM CARBONATE. COLLUVIUM - ROCK FRAGMENTS MIXED WITH SOIL DEPOSITED BY GRAVITY ON SLOPE OR AT BOTTOM OF SLOPE. CORE RECOVERY (REC.) - TOTAL LENGTH OF ALL MATERIAL RECOVERED IN THE CORE BARREL DIVIDED BY TOTAL LENGTH OF CORE RUN AND EXPRESSED AS A PERCENTAGE. DIKE - A TABULAR BODY OF IGNEOUS ROCK THAT CUTS ACROSS THE STRUCTURE OF ADJACENT ROCKS OR CUTS MASSIVE ROCK. DIP - THE ANGLE AT WHICH A STRATUM OR ANY PLANAR FEATURE IS INCLINED FROM THE HORIZONTAL. DIP DIRECTION (DIP AZIMUTH) - THE DIRECTION OR BEARING OF THE HORIZONTAL TRACE OF THE LINE OF DIP, MEASURED CLOCKWISE FROM NORTH. FAULT - A FRACTURE OR FRACTURE ZONE ALONG WHICH THERE HAS BEEN DISPLACEMENT OF THE SIDES RELATIVE TO ONE ANOTHER PARALLEL TO THE FRACTURE. FISSILE - A PROPERTY OF SPLITTING ALONG CLOSELY SPACED PARALLEL PLANES. FLOAT - ROCK FRAGMENTS ON SURFACE NEAR THEIR ORIGINAL POSITION AND DISLOGGED FROM PARENT MATERIAL. FLOOD PLAIN (FP) - LAND BORDERING A STREAM, BUILT OF SEDIMENTS DEPOSITED BY THE STREAM. FORMATION (FM) - A MAPPABLE GEOLOGIC UNIT THAT CAN BE RECOGNIZED AND TRACED IN THE FIELD. JOINT - FRACTURE IN ROCK ALONG WHICH NO APPRECIABLE MOVEMENT HAS OCCURRED. LEDGE - A SHELF-LIKE RIDGE OR PROJECTION OF ROCK WHOSE THICKNESS IS SMALL COMPARED TO ITS LATERAL EXTENT. LENS - A BODY OF SOIL OR ROCK THAT THINS OUT IN ONE OR MORE DIRECTIONS. MOTTLED (MOT.) - IRREGULARLY MARKED WITH SPOTS OF DIFFERENT COLORS. MOTTLING IN SOILS USUALLY INDICATES POOR AERATION AND LACK OF GOOD DRAINAGE. PERCHED WATER - WATER MAINTAINED ABOVE THE NORMAL GROUND WATER LEVEL BY THE PRESENCE OF AN INTERVENING IMPERVIOUS STRATUM. RESIDUAL (RES.) SOIL - SOIL FORMED IN PLACE BY THE WEATHERING OF ROCK. ROCK QUALITY DESIGNATION (RQD) - A MEASURE OF ROCK QUALITY DESCRIBED BY TOTAL LENGTH OF ROCK SEGMENTS EQUAL TO OR GREATER THAN 4 INCHES DIVIDED BY THE TOTAL LENGTH OF CORE RUN AND EXPRESSED AS A PERCENTAGE. SAPROLITE (SAP.) - RESIDUAL SOIL THAT RETAINS THE RELIC STRUCTURE OR FABRIC OF THE PARENT ROCK. SILL - AN INTRUSIVE BODY OF IGNEOUS ROCK OF APPROXIMATELY UNIFORM THICKNESS AND RELATIVELY THIN COMPARED WITH ITS LATERAL EXTENT, THAT HAS BEEN EMPLACED PARALLEL TO THE BEDDING OR SCHISTOSITY OF THE INTRUDED ROCKS. SLICKENSIDE - POLISHED AND STRIATED SURFACE THAT RESULTS FROM FRICTION ALONG A FAULT OR SLIP PLANE. STANDARD PENETRATION TEST (PENETRATION RESISTANCE) (SPT) - NUMBER OF BLOWS (N OR BPF) OF A 140 LB. HAMMER FALLING 30 INCHES REQUIRED TO PRODUCE A PENETRATION OF 1 FOOT INTO SOIL WITH A 2 INCH OUTSIDE DIAMETER SPLIT SPOON SAMPLER. SPT REFUSAL IS PENETRATION EQUAL TO OR LESS THAN 0.1 FOOT PER 60 BLOWS. STRATA CORE RECOVERY (SREC.) - TOTAL LENGTH OF STRATA MATERIAL RECOVERED DIVIDED BY TOTAL LENGTH OF STRATUM AND EXPRESSED AS A PERCENTAGE. STRATA ROCK QUALITY DESIGNATION (SROD) - A MEASURE OF ROCK QUALITY DESCRIBED BY TOTAL LENGTH OF ROCK SEGMENTS WITHIN A STRATUM EQUAL TO OR GREATER THAN 4 INCHES DIVIDED BY THE TOTAL LENGTH OF STRATA AND EXPRESSED AS A PERCENTAGE. TOPSOIL (TS) - SURFACE SOILS USUALLY CONTAINING ORGANIC MATTER.</p>																																																																																									
SOIL LEGEND AND AASHTO CLASSIFICATION										MINERALOGICAL COMPOSITION										WEATHERING										RECOMMENDATION SYMBOLS																																																																																									
<table border="1" style="width: 100%; border-collapse: collapse;"> <thead> <tr> <th>GENERAL CLASS.</th> <th colspan="5">GRANULAR MATERIALS (≤ 35% PASSING #200)</th> <th colspan="5">SILT-CLAY MATERIALS (> 35% PASSING #200)</th> <th colspan="5">ORGANIC MATERIALS</th> </tr> <tr> <th>GROUP CLASS.</th> <th>A-1</th> <th>A-3</th> <th>A-2</th> <th>A-4</th> <th>A-5</th> <th>A-6</th> <th>A-7</th> <th>A-1, A-2</th> <th>A-3</th> <th>A-4, A-5</th> <th>A-6, A-7</th> <th></th> <th></th> <th></th> <th></th> </tr> <tr> <th>SYMBOL</th> <td colspan="5">[Pattern]</td> <td colspan="5">[Pattern]</td> <td colspan="5">[Pattern]</td> </tr> </thead> </table>										GENERAL CLASS.	GRANULAR MATERIALS (≤ 35% PASSING #200)					SILT-CLAY MATERIALS (> 35% PASSING #200)					ORGANIC MATERIALS					GROUP CLASS.	A-1	A-3	A-2	A-4	A-5	A-6	A-7	A-1, A-2	A-3	A-4, A-5	A-6, A-7					SYMBOL	[Pattern]					[Pattern]					[Pattern]					<p style="text-align: center;">MINERALOGICAL COMPOSITION</p> <p>MINERAL NAMES SUCH AS QUARTZ, FELDSPAR, MICA, TALC, KAOLIN, ETC. ARE USED IN DESCRIPTIONS WHEN THEY ARE CONSIDERED OF SIGNIFICANCE.</p> <p style="text-align: center;">COMPRESSIBILITY</p> <p>SLIGHTLY COMPRESSIBLE LL < 31 MODERATELY COMPRESSIBLE LL = 31 - 50 HIGHLY COMPRESSIBLE LL > 50</p> <p style="text-align: center;">PERCENTAGE OF MATERIAL</p> <table border="1" style="width: 100%; border-collapse: collapse;"> <thead> <tr> <th></th> <th>GRANULAR SOILS</th> <th>SILT - CLAY SOILS</th> <th>OTHER MATERIAL</th> </tr> </thead> <tbody> <tr> <td>TRACE OF ORGANIC MATTER</td> <td>2 - 3%</td> <td>3 - 5%</td> <td>TRACE 1 - 10%</td> </tr> <tr> <td>LITTLE ORGANIC MATTER</td> <td>3 - 5%</td> <td>5 - 12%</td> <td>LITTLE 10 - 20%</td> </tr> <tr> <td>MODERATELY ORGANIC</td> <td>5 - 10%</td> <td>12 - 20%</td> <td>SOME 20 - 35%</td> </tr> <tr> <td>HIGHLY ORGANIC</td> <td>> 10%</td> <td>> 20%</td> <td>HIGHLY 35% AND ABOVE</td> </tr> </tbody> </table>											GRANULAR SOILS	SILT - CLAY SOILS	OTHER MATERIAL	TRACE OF ORGANIC MATTER	2 - 3%	3 - 5%	TRACE 1 - 10%	LITTLE ORGANIC MATTER	3 - 5%	5 - 12%	LITTLE 10 - 20%	MODERATELY ORGANIC	5 - 10%	12 - 20%	SOME 20 - 35%	HIGHLY ORGANIC	> 10%	> 20%	HIGHLY 35% AND ABOVE	<p style="text-align: center;">GROUND WATER</p> <p>▽ WATER LEVEL IN BORE HOLE IMMEDIATELY AFTER DRILLING ▼ STATIC WATER LEVEL AFTER 24 HOURS ▽PW PERCHED WATER, SATURATED ZONE, OR WATER BEARING STRATA SPRING OR SEEP</p> <p style="text-align: center;">WEATHERING</p> <p>FRESH ROCK FRESH, CRYSTALS BRIGHT, FEW JOINTS MAY SHOW SLIGHT STAINING. ROCK RINGS UNDER HAMMER IF CRYSTALLINE. VERY SLIGHT (V SLI) ROCK GENERALLY FRESH, JOINTS STAINED, SOME JOINTS MAY SHOW THIN CLAY COATINGS IF OPEN, CRYSTALS ON A BROKEN SPECIMEN FACE SHINE BRIGHTLY. ROCK RINGS UNDER HAMMER BLOWS IF OF A CRYSTALLINE NATURE. SLIGHT (SLI) ROCK GENERALLY FRESH, JOINTS STAINED AND DISCOLORATION EXTENDS INTO ROCK UP TO 1 INCH. OPEN JOINTS MAY CONTAIN CLAY. IN GRANITOID ROCKS SOME OCCASIONAL FELDSPAR CRYSTALS ARE DULL AND DISCOLORED. CRYSTALLINE ROCKS RING UNDER HAMMER BLOWS. MODERATE (MOD) SIGNIFICANT PORTIONS OF ROCK SHOW DISCOLORATION AND WEATHERING EFFECTS. IN GRANITOID ROCKS, MOST FELDSPARS ARE DULL AND DISCOLORED, SOME SHOW CLAY. ROCK HAS DULL SOUND UNDER HAMMER BLOWS AND SHOWS SIGNIFICANT LOSS OF STRENGTH AS COMPARED WITH FRESH ROCK. MODERATELY SEVERE (MOD. SEV.) ALL ROCK EXCEPT QUARTZ DISCOLORED OR STAINED. IN GRANITOID ROCKS, ALL FELDSPARS DULL AND DISCOLORED AND A MAJORITY SHOW KAOLINIZATION. ROCK SHOWS SEVERE LOSS OF STRENGTH AND CAN BE EXCAVATED WITH A GEOLOGIST'S PICK. ROCK GIVES "CLUNK" SOUND WHEN STRUCK. <i>IF TESTED, WOULD YIELD SPT REFUSAL</i> SEVERE (SEV.) ALL ROCK EXCEPT QUARTZ DISCOLORED OR STAINED. ROCK FABRIC CLEAR AND EVIDENT BUT REDUCED IN STRENGTH TO STRONG SOIL. IN GRANITOID ROCKS ALL FELDSPARS ARE KAOLINIZED TO SOME EXTENT. SOME FRAGMENTS OF STRONG ROCK USUALLY REMAIN. <i>IF TESTED, WOULD YIELD SPT N VALUES > 100 BPF</i> VERY SEVERE (V SEV.) ALL ROCK EXCEPT QUARTZ DISCOLORED OR STAINED. ROCK FABRIC ELEMENTS ARE DISCERNIBLE BUT MASS IS EFFECTIVELY REDUCED TO SOIL STATUS, WITH ONLY FRAGMENTS OF STRONG ROCK REMAINING. SAPROLITE IS AN EXAMPLE OF ROCK WEATHERED TO A DEGREE THAT ONLY MINOR VESTIGES OF ORIGINAL ROCK FABRIC REMAIN. <i>IF TESTED, WOULD YIELD SPT N VALUES < 100 BPF</i> COMPLETE ROCK REDUCED TO SOIL. ROCK FABRIC NOT DISCERNIBLE, OR DISCERNIBLE ONLY IN SMALL AND SCATTERED CONCENTRATIONS. QUARTZ MAY BE PRESENT AS DIKES OR STRINGERS. SAPROLITE IS ALSO AN EXAMPLE.</p>										<p style="text-align: center;">CONSISTENCY OR DENSENESS</p> <table border="1" style="width: 100%; border-collapse: collapse;"> <thead> <tr> <th>PRIMARY SOIL TYPE</th> <th>COMPACTNESS OR CONSISTENCY</th> <th>RANGE OF STANDARD PENETRATION RESISTANCE (N-VALUE)</th> <th>RANGE OF UNCONFINED COMPRESSIVE STRENGTH (TONS/FT²)</th> </tr> </thead> <tbody> <tr> <td>GENERALLY GRANULAR MATERIAL (NON-COHESSIVE)</td> <td>VERY LOOSE LOOSE MEDIUM DENSE DENSE VERY DENSE</td> <td>< 4 4 TO 10 10 TO 30 30 TO 50 > 50</td> <td>N/A</td> </tr> <tr> <td>GENERALLY SILT-CLAY MATERIAL (COHESIVE)</td> <td>VERY SOFT SOFT MEDIUM STIFF STIFF VERY STIFF HARD</td> <td>< 2 2 TO 4 4 TO 8 8 TO 15 15 TO 30 > 30</td> <td>< 0.25 0.25 TO 0.5 0.5 TO 1.0 1 TO 2 2 TO 4 > 4</td> </tr> </tbody> </table>										PRIMARY SOIL TYPE	COMPACTNESS OR CONSISTENCY	RANGE OF STANDARD PENETRATION RESISTANCE (N-VALUE)	RANGE OF UNCONFINED COMPRESSIVE STRENGTH (TONS/FT ²)	GENERALLY GRANULAR MATERIAL (NON-COHESSIVE)	VERY LOOSE LOOSE MEDIUM DENSE DENSE VERY DENSE	< 4 4 TO 10 10 TO 30 30 TO 50 > 50	N/A	GENERALLY SILT-CLAY MATERIAL (COHESIVE)	VERY SOFT SOFT MEDIUM STIFF STIFF VERY STIFF HARD	< 2 2 TO 4 4 TO 8 8 TO 15 15 TO 30 > 30	< 0.25 0.25 TO 0.5 0.5 TO 1.0 1 TO 2 2 TO 4 > 4
GENERAL CLASS.	GRANULAR MATERIALS (≤ 35% PASSING #200)					SILT-CLAY MATERIALS (> 35% PASSING #200)					ORGANIC MATERIALS																																																																																																												
GROUP CLASS.	A-1	A-3	A-2	A-4	A-5	A-6	A-7	A-1, A-2	A-3	A-4, A-5	A-6, A-7																																																																																																												
SYMBOL	[Pattern]					[Pattern]					[Pattern]																																																																																																												
	GRANULAR SOILS	SILT - CLAY SOILS	OTHER MATERIAL																																																																																																																				
TRACE OF ORGANIC MATTER	2 - 3%	3 - 5%	TRACE 1 - 10%																																																																																																																				
LITTLE ORGANIC MATTER	3 - 5%	5 - 12%	LITTLE 10 - 20%																																																																																																																				
MODERATELY ORGANIC	5 - 10%	12 - 20%	SOME 20 - 35%																																																																																																																				
HIGHLY ORGANIC	> 10%	> 20%	HIGHLY 35% AND ABOVE																																																																																																																				
PRIMARY SOIL TYPE	COMPACTNESS OR CONSISTENCY	RANGE OF STANDARD PENETRATION RESISTANCE (N-VALUE)	RANGE OF UNCONFINED COMPRESSIVE STRENGTH (TONS/FT ²)																																																																																																																				
GENERALLY GRANULAR MATERIAL (NON-COHESSIVE)	VERY LOOSE LOOSE MEDIUM DENSE DENSE VERY DENSE	< 4 4 TO 10 10 TO 30 30 TO 50 > 50	N/A																																																																																																																				
GENERALLY SILT-CLAY MATERIAL (COHESIVE)	VERY SOFT SOFT MEDIUM STIFF STIFF VERY STIFF HARD	< 2 2 TO 4 4 TO 8 8 TO 15 15 TO 30 > 30	< 0.25 0.25 TO 0.5 0.5 TO 1.0 1 TO 2 2 TO 4 > 4																																																																																																																				
<p style="text-align: center;">TEXTURE OR GRAIN SIZE</p> <table border="1" style="width: 100%; border-collapse: collapse;"> <thead> <tr> <th>U.S. STD. SIEVE SIZE OPENING (MM)</th> <th>4</th> <th>10</th> <th>40</th> <th>60</th> <th>200</th> <th>270</th> </tr> </thead> <tbody> <tr> <td></td> <td>4.76</td> <td>2.00</td> <td>0.42</td> <td>0.25</td> <td>0.075</td> <td>0.053</td> </tr> </tbody> </table> <table border="1" style="width: 100%; border-collapse: collapse;"> <thead> <tr> <th>BOULDER (BLDR.)</th> <th>COBBLE (COB.)</th> <th>GRAVEL (GR.)</th> <th>COARSE SAND (CSE. SD.)</th> <th>FINE SAND (F SD.)</th> <th>SILT (SL.)</th> <th>CLAY (CL.)</th> </tr> </thead> <tbody> <tr> <td>GRAIN SIZE</td> <td>MM 305</td> <td>75</td> <td>2.0</td> <td>0.25</td> <td>0.05</td> <td>0.005</td> </tr> <tr> <td></td> <td>IN. 12</td> <td>3</td> <td></td> <td></td> <td></td> <td></td> </tr> </tbody> </table>										U.S. STD. SIEVE SIZE OPENING (MM)	4	10	40	60	200	270		4.76	2.00	0.42	0.25	0.075	0.053	BOULDER (BLDR.)	COBBLE (COB.)	GRAVEL (GR.)	COARSE SAND (CSE. SD.)	FINE SAND (F SD.)	SILT (SL.)	CLAY (CL.)	GRAIN SIZE	MM 305	75	2.0	0.25	0.05	0.005		IN. 12	3					<p style="text-align: center;">ABBREVIATIONS</p> <table border="1" style="width: 100%; border-collapse: collapse;"> <thead> <tr> <th>AR - AUGER REFUSAL</th> <th>BT - BORING TERMINATED</th> <th>CL - CLAY</th> <th>CPT - CONE PENETRATION TEST</th> <th>CSE - COARSE</th> <th>DMT - DILATOMETER TEST</th> <th>DPT - DYNAMIC PENETRATION TEST</th> <th>e - VOID RATIO</th> <th>F - FINE</th> <th>FOSS. - FOSSILIFEROUS</th> <th>FRAC. - FRACTURED, FRACTURES</th> <th>FRAGS. - FRAGMENTS</th> <th>HI. - HIGHLY</th> <th>MED. - MEDIUM</th> <th>MICA. - MICACEOUS</th> <th>MOD. - MODERATELY</th> <th>NP - NON PLASTIC</th> <th>ORG. - ORGANIC</th> <th>PMT - PRESSUREMETER TEST</th> <th>SAP. - SAPROLITIC</th> <th>SD. - SAND, SANDY</th> <th>SL. - SILT, SILTY</th> <th>SLI. - SLIGHTLY</th> <th>TCR - TRICONE REFUSAL</th> <th>w - MOISTURE CONTENT</th> <th>V - VERY</th> <th>VST - VANE SHEAR TEST</th> <th>WEA. - WEATHERED</th> <th>UW - UNIT WEIGHT</th> <th>UW - DRY UNIT WEIGHT</th> </tr> </thead> <tbody> <tr> <td></td> <td></td> <td></td> <td></td> <td></td> <td></td> <td></td> <td></td> <td></td> <td></td> <td></td> <td></td> <td></td> <td></td> <td></td> <td></td> <td></td> <td></td> <td></td> <td></td> <td></td> <td></td> <td></td> <td></td> <td></td> <td></td> <td></td> <td></td> <td></td> <td></td> <td></td> </tr> </tbody> </table>										AR - AUGER REFUSAL	BT - BORING TERMINATED	CL - CLAY	CPT - CONE PENETRATION TEST	CSE - COARSE	DMT - DILATOMETER TEST	DPT - DYNAMIC PENETRATION TEST	e - VOID RATIO	F - FINE	FOSS. - FOSSILIFEROUS	FRAC. - FRACTURED, FRACTURES	FRAGS. - FRAGMENTS	HI. - HIGHLY	MED. - MEDIUM	MICA. - MICACEOUS	MOD. - MODERATELY	NP - NON PLASTIC	ORG. - ORGANIC	PMT - PRESSUREMETER TEST	SAP. - SAPROLITIC	SD. - SAND, SANDY	SL. - SILT, SILTY	SLI. - SLIGHTLY	TCR - TRICONE REFUSAL	w - MOISTURE CONTENT	V - VERY	VST - VANE SHEAR TEST	WEA. - WEATHERED	UW - UNIT WEIGHT	UW - DRY UNIT WEIGHT																																			
U.S. STD. SIEVE SIZE OPENING (MM)	4	10	40	60	200	270																																																																																																																	
	4.76	2.00	0.42	0.25	0.075	0.053																																																																																																																	
BOULDER (BLDR.)	COBBLE (COB.)	GRAVEL (GR.)	COARSE SAND (CSE. SD.)	FINE SAND (F SD.)	SILT (SL.)	CLAY (CL.)																																																																																																																	
GRAIN SIZE	MM 305	75	2.0	0.25	0.05	0.005																																																																																																																	
	IN. 12	3																																																																																																																					
AR - AUGER REFUSAL	BT - BORING TERMINATED	CL - CLAY	CPT - CONE PENETRATION TEST	CSE - COARSE	DMT - DILATOMETER TEST	DPT - DYNAMIC PENETRATION TEST	e - VOID RATIO	F - FINE	FOSS. - FOSSILIFEROUS	FRAC. - FRACTURED, FRACTURES	FRAGS. - FRAGMENTS	HI. - HIGHLY	MED. - MEDIUM	MICA. - MICACEOUS	MOD. - MODERATELY	NP - NON PLASTIC	ORG. - ORGANIC	PMT - PRESSUREMETER TEST	SAP. - SAPROLITIC	SD. - SAND, SANDY	SL. - SILT, SILTY	SLI. - SLIGHTLY	TCR - TRICONE REFUSAL	w - MOISTURE CONTENT	V - VERY	VST - VANE SHEAR TEST	WEA. - WEATHERED	UW - UNIT WEIGHT	UW - DRY UNIT WEIGHT																																																																																										
<p style="text-align: center;">SOIL MOISTURE - CORRELATION OF TERMS</p> <table border="1" style="width: 100%; border-collapse: collapse;"> <thead> <tr> <th>SOIL MOISTURE SCALE (ATTERBERG LIMITS)</th> <th>FIELD MOISTURE DESCRIPTION</th> <th>GUIDE FOR FIELD MOISTURE DESCRIPTION</th> </tr> </thead> <tbody> <tr> <td>LL - LIQUID LIMIT</td> <td>- SATURATED - (SAT.)</td> <td>USUALLY LIQUID; VERY WET, USUALLY FROM BELOW THE GROUND WATER TABLE</td> </tr> <tr> <td>PLASTIC RANGE (PI)</td> <td>- WET - (W)</td> <td>SEMISOLID; REQUIRES DRYING TO ATTAIN OPTIMUM MOISTURE</td> </tr> <tr> <td>OM - OPTIMUM MOISTURE</td> <td>- MOIST - (M)</td> <td>SOLID; AT OR NEAR OPTIMUM MOISTURE</td> </tr> <tr> <td>SL - SHRINKAGE LIMIT</td> <td>- DRY - (D)</td> <td>REQUIRES ADDITIONAL WATER TO ATTAIN OPTIMUM MOISTURE</td> </tr> </tbody> </table>										SOIL MOISTURE SCALE (ATTERBERG LIMITS)	FIELD MOISTURE DESCRIPTION	GUIDE FOR FIELD MOISTURE DESCRIPTION	LL - LIQUID LIMIT	- SATURATED - (SAT.)	USUALLY LIQUID; VERY WET, USUALLY FROM BELOW THE GROUND WATER TABLE	PLASTIC RANGE (PI)	- WET - (W)	SEMISOLID; REQUIRES DRYING TO ATTAIN OPTIMUM MOISTURE	OM - OPTIMUM MOISTURE	- MOIST - (M)	SOLID; AT OR NEAR OPTIMUM MOISTURE	SL - SHRINKAGE LIMIT	- DRY - (D)	REQUIRES ADDITIONAL WATER TO ATTAIN OPTIMUM MOISTURE	<p style="text-align: center;">EQUIPMENT USED ON SUBJECT PROJECT</p> <table border="1" style="width: 100%; border-collapse: collapse;"> <thead> <tr> <th>DRILL UNITS:</th> <th>ADVANCING TOOLS:</th> <th>HAMMER TYPE:</th> </tr> </thead> <tbody> <tr> <td><input type="checkbox"/> CME-45C</td> <td><input type="checkbox"/> CLAY BITS</td> <td><input checked="" type="checkbox"/> AUTOMATIC <input type="checkbox"/> MANUAL</td> </tr> <tr> <td><input type="checkbox"/> CME-55</td> <td><input type="checkbox"/> 6" CONTINUOUS FLIGHT AUGER</td> <td></td> </tr> <tr> <td><input type="checkbox"/> CME-55B</td> <td><input type="checkbox"/> 8" HOLLOW AUGERS</td> <td></td> </tr> <tr> <td><input type="checkbox"/> VANE SHEAR TEST</td> <td><input type="checkbox"/> HARD FACED FINGER BITS</td> <td></td> </tr> <tr> <td><input type="checkbox"/> PORTABLE HOIST</td> <td><input type="checkbox"/> TUNG-CARBIDE INSERTS</td> <td></td> </tr> <tr> <td><input checked="" type="checkbox"/> CME-45B (TER1974)</td> <td><input checked="" type="checkbox"/> CASING <input type="checkbox"/> W/ ADVANCER</td> <td></td> </tr> <tr> <td></td> <td><input checked="" type="checkbox"/> TRICONE <input type="checkbox"/> 3/8" * STEEL TEETH</td> <td></td> </tr> <tr> <td></td> <td><input type="checkbox"/> TRICONE <input type="checkbox"/> * TUNG-CARB.</td> <td></td> </tr> <tr> <td></td> <td><input type="checkbox"/> CORE BIT</td> <td></td> </tr> <tr> <td></td> <td></td> <td></td> </tr> </tbody> </table>										DRILL UNITS:	ADVANCING TOOLS:	HAMMER TYPE:	<input type="checkbox"/> CME-45C	<input type="checkbox"/> CLAY BITS	<input checked="" type="checkbox"/> AUTOMATIC <input type="checkbox"/> MANUAL	<input type="checkbox"/> CME-55	<input type="checkbox"/> 6" CONTINUOUS FLIGHT AUGER		<input type="checkbox"/> CME-55B	<input type="checkbox"/> 8" HOLLOW AUGERS		<input type="checkbox"/> VANE SHEAR TEST	<input type="checkbox"/> HARD FACED FINGER BITS		<input type="checkbox"/> PORTABLE HOIST	<input type="checkbox"/> TUNG-CARBIDE INSERTS		<input checked="" type="checkbox"/> CME-45B (TER1974)	<input checked="" type="checkbox"/> CASING <input type="checkbox"/> W/ ADVANCER			<input checked="" type="checkbox"/> TRICONE <input type="checkbox"/> 3/8" * STEEL TEETH			<input type="checkbox"/> TRICONE <input type="checkbox"/> * TUNG-CARB.			<input type="checkbox"/> CORE BIT																																																								
SOIL MOISTURE SCALE (ATTERBERG LIMITS)	FIELD MOISTURE DESCRIPTION	GUIDE FOR FIELD MOISTURE DESCRIPTION																																																																																																																					
LL - LIQUID LIMIT	- SATURATED - (SAT.)	USUALLY LIQUID; VERY WET, USUALLY FROM BELOW THE GROUND WATER TABLE																																																																																																																					
PLASTIC RANGE (PI)	- WET - (W)	SEMISOLID; REQUIRES DRYING TO ATTAIN OPTIMUM MOISTURE																																																																																																																					
OM - OPTIMUM MOISTURE	- MOIST - (M)	SOLID; AT OR NEAR OPTIMUM MOISTURE																																																																																																																					
SL - SHRINKAGE LIMIT	- DRY - (D)	REQUIRES ADDITIONAL WATER TO ATTAIN OPTIMUM MOISTURE																																																																																																																					
DRILL UNITS:	ADVANCING TOOLS:	HAMMER TYPE:																																																																																																																					
<input type="checkbox"/> CME-45C	<input type="checkbox"/> CLAY BITS	<input checked="" type="checkbox"/> AUTOMATIC <input type="checkbox"/> MANUAL																																																																																																																					
<input type="checkbox"/> CME-55	<input type="checkbox"/> 6" CONTINUOUS FLIGHT AUGER																																																																																																																						
<input type="checkbox"/> CME-55B	<input type="checkbox"/> 8" HOLLOW AUGERS																																																																																																																						
<input type="checkbox"/> VANE SHEAR TEST	<input type="checkbox"/> HARD FACED FINGER BITS																																																																																																																						
<input type="checkbox"/> PORTABLE HOIST	<input type="checkbox"/> TUNG-CARBIDE INSERTS																																																																																																																						
<input checked="" type="checkbox"/> CME-45B (TER1974)	<input checked="" type="checkbox"/> CASING <input type="checkbox"/> W/ ADVANCER																																																																																																																						
	<input checked="" type="checkbox"/> TRICONE <input type="checkbox"/> 3/8" * STEEL TEETH																																																																																																																						
	<input type="checkbox"/> TRICONE <input type="checkbox"/> * TUNG-CARB.																																																																																																																						
	<input type="checkbox"/> CORE BIT																																																																																																																						
<p style="text-align: center;">PLASTICITY</p> <table border="1" style="width: 100%; border-collapse: collapse;"> <thead> <tr> <th>NON PLASTIC</th> <th colspan="2">PLASTICITY INDEX (PI)</th> <th>DRY STRENGTH</th> </tr> </thead> <tbody> <tr> <td>SLIGHTLY PLASTIC</td> <td>0-5</td> <td></td> <td>VERY LOW</td> </tr> <tr> <td>MODERATELY PLASTIC</td> <td>6-15</td> <td></td> <td>SLIGHT</td> </tr> <tr> <td>HIGHLY PLASTIC</td> <td>16-25</td> <td></td> <td>MEDIUM</td> </tr> <tr> <td></td> <td>26 OR MORE</td> <td></td> <td>HIGH</td> </tr> </tbody> </table>										NON PLASTIC	PLASTICITY INDEX (PI)		DRY STRENGTH	SLIGHTLY PLASTIC	0-5		VERY LOW	MODERATELY PLASTIC	6-15		SLIGHT	HIGHLY PLASTIC	16-25		MEDIUM		26 OR MORE		HIGH	<p style="text-align: center;">RECOMMENDATION SYMBOLS</p> <table border="1" style="width: 100%; border-collapse: collapse;"> <tbody> <tr> <td></td> <td>UNDERCUT</td> <td></td> <td>UNCLASSIFIED EXCAVATION - UNSUITABLE WASTE</td> <td></td> <td>UNCLASSIFIED EXCAVATION - ACCEPTABLE ROCK</td> </tr> <tr> <td></td> <td>SHALLOW UNDERCUT</td> <td></td> <td>UNCLASSIFIED EXCAVATION - ACCEPTABLE ROCK</td> <td></td> <td>UNCLASSIFIED EXCAVATION - ACCEPTABLE ROCK</td> </tr> </tbody> </table>											UNDERCUT		UNCLASSIFIED EXCAVATION - UNSUITABLE WASTE		UNCLASSIFIED EXCAVATION - ACCEPTABLE ROCK		SHALLOW UNDERCUT		UNCLASSIFIED EXCAVATION - ACCEPTABLE ROCK		UNCLASSIFIED EXCAVATION - ACCEPTABLE ROCK																																																																				
NON PLASTIC	PLASTICITY INDEX (PI)		DRY STRENGTH																																																																																																																				
SLIGHTLY PLASTIC	0-5		VERY LOW																																																																																																																				
MODERATELY PLASTIC	6-15		SLIGHT																																																																																																																				
HIGHLY PLASTIC	16-25		MEDIUM																																																																																																																				
	26 OR MORE		HIGH																																																																																																																				
	UNDERCUT		UNCLASSIFIED EXCAVATION - UNSUITABLE WASTE		UNCLASSIFIED EXCAVATION - ACCEPTABLE ROCK																																																																																																																		
	SHALLOW UNDERCUT		UNCLASSIFIED EXCAVATION - ACCEPTABLE ROCK		UNCLASSIFIED EXCAVATION - ACCEPTABLE ROCK																																																																																																																		
<p style="text-align: center;">COLOR</p> <p>DESCRIPTIONS MAY INCLUDE COLOR OR COLOR COMBINATIONS (TAN, RED, YELLOW-BROWN, BLUE-GRAY). MODIFIERS SUCH AS LIGHT, DARK, STREAKED, ETC. ARE USED TO DESCRIBE APPEARANCE.</p>										<p style="text-align: center;">ROCK HARDNESS</p> <table border="1" style="width: 100%; border-collapse: collapse;"> <thead> <tr> <th>VERY HARD</th> <th>HARD</th> <th>MODERATELY HARD</th> <th>MEDIUM HARD</th> <th>SOFT</th> <th>VERY SOFT</th> <th>COMPLETE</th> </tr> </thead> <tbody> <tr> <td>CANNOT BE SCRATCHED BY KNIFE OR SHARP PICK. BREAKING OF HAND SPECIMENS REQUIRES SEVERAL HARD BLOWS OF THE GEOLOGIST'S PICK.</td> <td>CAN BE SCRATCHED BY KNIFE OR PICK ONLY WITH DIFFICULTY. HARD HAMMER BLOWS REQUIRED TO DETACH HAND SPECIMEN.</td> <td>CAN BE SCRATCHED BY KNIFE OR PICK. GOUGES OR GROOVES TO 0.25 INCHES DEEP CAN BE EXCAVATED BY HARD BLOW OF A GEOLOGIST'S PICK. HAND SPECIMENS CAN BE DETACHED BY MODERATE BLOWS.</td> <td>CAN BE GROOVED OR GOUGED 0.05 INCHES DEEP BY FIRM PRESSURE OF KNIFE OR PICK POINT. CAN BE EXCAVATED IN SMALL CHIPS TO PIECES 1 INCH MAXIMUM SIZE BY HARD BLOWS OF THE POINT OF A GEOLOGIST'S PICK.</td> <td>CAN BE GROOVED OR GOUGED READILY BY KNIFE OR PICK. CAN BE EXCAVATED IN FRAGMENTS FROM CHIPS TO SEVERAL INCHES IN SIZE BY MODERATE BLOWS OF A PICK POINT. SMALL, THIN PIECES CAN BE BROKEN BY FINGER PRESSURE.</td> <td>CAN BE CARVED WITH KNIFE. CAN BE EXCAVATED READILY WITH POINT OF PICK. PIECES 1 INCH OR MORE IN THICKNESS CAN BE BROKEN BY FINGER PRESSURE. CAN BE SCRATCHED READILY BY FINGER NAIL.</td> <td>ROCK REDUCED TO SOIL. ROCK FABRIC NOT DISCERNIBLE, OR DISCERNIBLE ONLY IN SMALL AND SCATTERED CONCENTRATIONS. QUARTZ MAY BE PRESENT AS DIKES OR STRINGERS. SAPROLITE IS ALSO AN EXAMPLE.</td> </tr> </tbody> </table>										VERY HARD	HARD	MODERATELY HARD	MEDIUM HARD	SOFT	VERY SOFT	COMPLETE	CANNOT BE SCRATCHED BY KNIFE OR SHARP PICK. BREAKING OF HAND SPECIMENS REQUIRES SEVERAL HARD BLOWS OF THE GEOLOGIST'S PICK.	CAN BE SCRATCHED BY KNIFE OR PICK ONLY WITH DIFFICULTY. HARD HAMMER BLOWS REQUIRED TO DETACH HAND SPECIMEN.	CAN BE SCRATCHED BY KNIFE OR PICK. GOUGES OR GROOVES TO 0.25 INCHES DEEP CAN BE EXCAVATED BY HARD BLOW OF A GEOLOGIST'S PICK. HAND SPECIMENS CAN BE DETACHED BY MODERATE BLOWS.	CAN BE GROOVED OR GOUGED 0.05 INCHES DEEP BY FIRM PRESSURE OF KNIFE OR PICK POINT. CAN BE EXCAVATED IN SMALL CHIPS TO PIECES 1 INCH MAXIMUM SIZE BY HARD BLOWS OF THE POINT OF A GEOLOGIST'S PICK.	CAN BE GROOVED OR GOUGED READILY BY KNIFE OR PICK. CAN BE EXCAVATED IN FRAGMENTS FROM CHIPS TO SEVERAL INCHES IN SIZE BY MODERATE BLOWS OF A PICK POINT. SMALL, THIN PIECES CAN BE BROKEN BY FINGER PRESSURE.	CAN BE CARVED WITH KNIFE. CAN BE EXCAVATED READILY WITH POINT OF PICK. PIECES 1 INCH OR MORE IN THICKNESS CAN BE BROKEN BY FINGER PRESSURE. CAN BE SCRATCHED READILY BY FINGER NAIL.	ROCK REDUCED TO SOIL. ROCK FABRIC NOT DISCERNIBLE, OR DISCERNIBLE ONLY IN SMALL AND SCATTERED CONCENTRATIONS. QUARTZ MAY BE PRESENT AS DIKES OR STRINGERS. SAPROLITE IS ALSO AN EXAMPLE.																																																																																						
VERY HARD	HARD	MODERATELY HARD	MEDIUM HARD	SOFT	VERY SOFT	COMPLETE																																																																																																																	
CANNOT BE SCRATCHED BY KNIFE OR SHARP PICK. BREAKING OF HAND SPECIMENS REQUIRES SEVERAL HARD BLOWS OF THE GEOLOGIST'S PICK.	CAN BE SCRATCHED BY KNIFE OR PICK ONLY WITH DIFFICULTY. HARD HAMMER BLOWS REQUIRED TO DETACH HAND SPECIMEN.	CAN BE SCRATCHED BY KNIFE OR PICK. GOUGES OR GROOVES TO 0.25 INCHES DEEP CAN BE EXCAVATED BY HARD BLOW OF A GEOLOGIST'S PICK. HAND SPECIMENS CAN BE DETACHED BY MODERATE BLOWS.	CAN BE GROOVED OR GOUGED 0.05 INCHES DEEP BY FIRM PRESSURE OF KNIFE OR PICK POINT. CAN BE EXCAVATED IN SMALL CHIPS TO PIECES 1 INCH MAXIMUM SIZE BY HARD BLOWS OF THE POINT OF A GEOLOGIST'S PICK.	CAN BE GROOVED OR GOUGED READILY BY KNIFE OR PICK. CAN BE EXCAVATED IN FRAGMENTS FROM CHIPS TO SEVERAL INCHES IN SIZE BY MODERATE BLOWS OF A PICK POINT. SMALL, THIN PIECES CAN BE BROKEN BY FINGER PRESSURE.	CAN BE CARVED WITH KNIFE. CAN BE EXCAVATED READILY WITH POINT OF PICK. PIECES 1 INCH OR MORE IN THICKNESS CAN BE BROKEN BY FINGER PRESSURE. CAN BE SCRATCHED READILY BY FINGER NAIL.	ROCK REDUCED TO SOIL. ROCK FABRIC NOT DISCERNIBLE, OR DISCERNIBLE ONLY IN SMALL AND SCATTERED CONCENTRATIONS. QUARTZ MAY BE PRESENT AS DIKES OR STRINGERS. SAPROLITE IS ALSO AN EXAMPLE.																																																																																																																	
<p style="text-align: center;">FRACTURE SPACING</p> <table border="1" style="width: 100%; border-collapse: collapse;"> <thead> <tr> <th>TERM</th> <th>SPACING</th> </tr> </thead> <tbody> <tr> <td>VERY WIDE</td> <td>MORE THAN 10 FEET</td> </tr> <tr> <td>WIDE</td> <td>3 TO 10 FEET</td> </tr> <tr> <td>MODERATELY CLOSE</td> <td>1 TO 3 FEET</td> </tr> <tr> <td>CLOSE</td> <td>0.16 TO 1 FOOT</td> </tr> <tr> <td>VERY CLOSE</td> <td>LESS THAN 0.16 FEET</td> </tr> </tbody> </table>										TERM	SPACING	VERY WIDE	MORE THAN 10 FEET	WIDE	3 TO 10 FEET	MODERATELY CLOSE	1 TO 3 FEET	CLOSE	0.16 TO 1 FOOT	VERY CLOSE	LESS THAN 0.16 FEET	<p style="text-align: center;">BEDDING</p> <table border="1" style="width: 100%; border-collapse: collapse;"> <thead> <tr> <th>TERM</th> <th>THICKNESS</th> </tr> </thead> <tbody> <tr> <td>VERY THICKLY BEDDED</td> <td>4 FEET</td> </tr> <tr> <td>THICKLY BEDDED</td> <td>1.5 - 4 FEET</td> </tr> <tr> <td>THINLY BEDDED</td> <td>0.16 - 1.5 FEET</td> </tr> <tr> <td>VERY THINLY BEDDED</td> <td>0.03 - 0.16 FEET</td> </tr> <tr> <td>THICKLY LAMINATED</td> <td>0.008 - 0.03 FEET</td> </tr> <tr> <td>THINLY LAMINATED</td> <td>< 0.008 FEET</td> </tr> </tbody> </table>										TERM	THICKNESS	VERY THICKLY BEDDED	4 FEET	THICKLY BEDDED	1.5 - 4 FEET	THINLY BEDDED	0.16 - 1.5 FEET	VERY THINLY BEDDED	0.03 - 0.16 FEET	THICKLY LAMINATED	0.008 - 0.03 FEET	THINLY LAMINATED	< 0.008 FEET																																																																										
TERM	SPACING																																																																																																																						
VERY WIDE	MORE THAN 10 FEET																																																																																																																						
WIDE	3 TO 10 FEET																																																																																																																						
MODERATELY CLOSE	1 TO 3 FEET																																																																																																																						
CLOSE	0.16 TO 1 FOOT																																																																																																																						
VERY CLOSE	LESS THAN 0.16 FEET																																																																																																																						
TERM	THICKNESS																																																																																																																						
VERY THICKLY BEDDED	4 FEET																																																																																																																						
THICKLY BEDDED	1.5 - 4 FEET																																																																																																																						
THINLY BEDDED	0.16 - 1.5 FEET																																																																																																																						
VERY THINLY BEDDED	0.03 - 0.16 FEET																																																																																																																						
THICKLY LAMINATED	0.008 - 0.03 FEET																																																																																																																						
THINLY LAMINATED	< 0.008 FEET																																																																																																																						
<p style="text-align: center;">INDURATION</p> <p>FOR SEDIMENTARY ROCKS, INDURATION IS THE HARDENING OF MATERIAL BY CEMENTING, HEAT, PRESSURE, ETC.</p> <table border="1" style="width: 100%; border-collapse: collapse;"> <tbody> <tr> <td>FRIABLE</td> <td>RUBBING WITH FINGER FREES NUMEROUS GRAINS; GENTLE BLOW BY HAMMER DISINTEGRATES SAMPLE.</td> </tr> <tr> <td>MODERATELY INDURATED</td> <td>GRAINS CAN BE SEPARATED FROM SAMPLE WITH STEEL PROBE; BREAKS EASILY WHEN HIT WITH HAMMER.</td> </tr> <tr> <td>INDURATED</td> <td>GRAINS ARE DIFFICULT TO SEPARATE WITH STEEL PROBE; DIFFICULT TO BREAK WITH HAMMER.</td> </tr> <tr> <td>EXTREMELY INDURATED</td> <td>SHARP HAMMER BLOWS REQUIRED TO BREAK SAMPLE; SAMPLE BREAKS ACROSS GRAINS.</td> </tr> </tbody> </table>										FRIABLE	RUBBING WITH FINGER FREES NUMEROUS GRAINS; GENTLE BLOW BY HAMMER DISINTEGRATES SAMPLE.	MODERATELY INDURATED	GRAINS CAN BE SEPARATED FROM SAMPLE WITH STEEL PROBE; BREAKS EASILY WHEN HIT WITH HAMMER.	INDURATED	GRAINS ARE DIFFICULT TO SEPARATE WITH STEEL PROBE; DIFFICULT TO BREAK WITH HAMMER.	EXTREMELY INDURATED	SHARP HAMMER BLOWS REQUIRED TO BREAK SAMPLE; SAMPLE BREAKS ACROSS GRAINS.	<p style="text-align: center;">NOTES:</p> <p>FIAD - FILLED IMMEDIATELY AFTER DRILLING</p>																																																																																																					
FRIABLE	RUBBING WITH FINGER FREES NUMEROUS GRAINS; GENTLE BLOW BY HAMMER DISINTEGRATES SAMPLE.																																																																																																																						
MODERATELY INDURATED	GRAINS CAN BE SEPARATED FROM SAMPLE WITH STEEL PROBE; BREAKS EASILY WHEN HIT WITH HAMMER.																																																																																																																						
INDURATED	GRAINS ARE DIFFICULT TO SEPARATE WITH STEEL PROBE; DIFFICULT TO BREAK WITH HAMMER.																																																																																																																						
EXTREMELY INDURATED	SHARP HAMMER BLOWS REQUIRED TO BREAK SAMPLE; SAMPLE BREAKS ACROSS GRAINS.																																																																																																																						
<p style="text-align: center;">BENCH MARK: BM1: -L-STA. 18+40.09, 33.82' RT, RR SPIKE IN POWER POLE N-333,598; E-2,287,727</p> <p style="text-align: right;">ELEVATION: 55.09 FEET</p>										<p style="text-align: right;">DATE: 8-15-14</p>																																																																																																													

SKEW = 120°

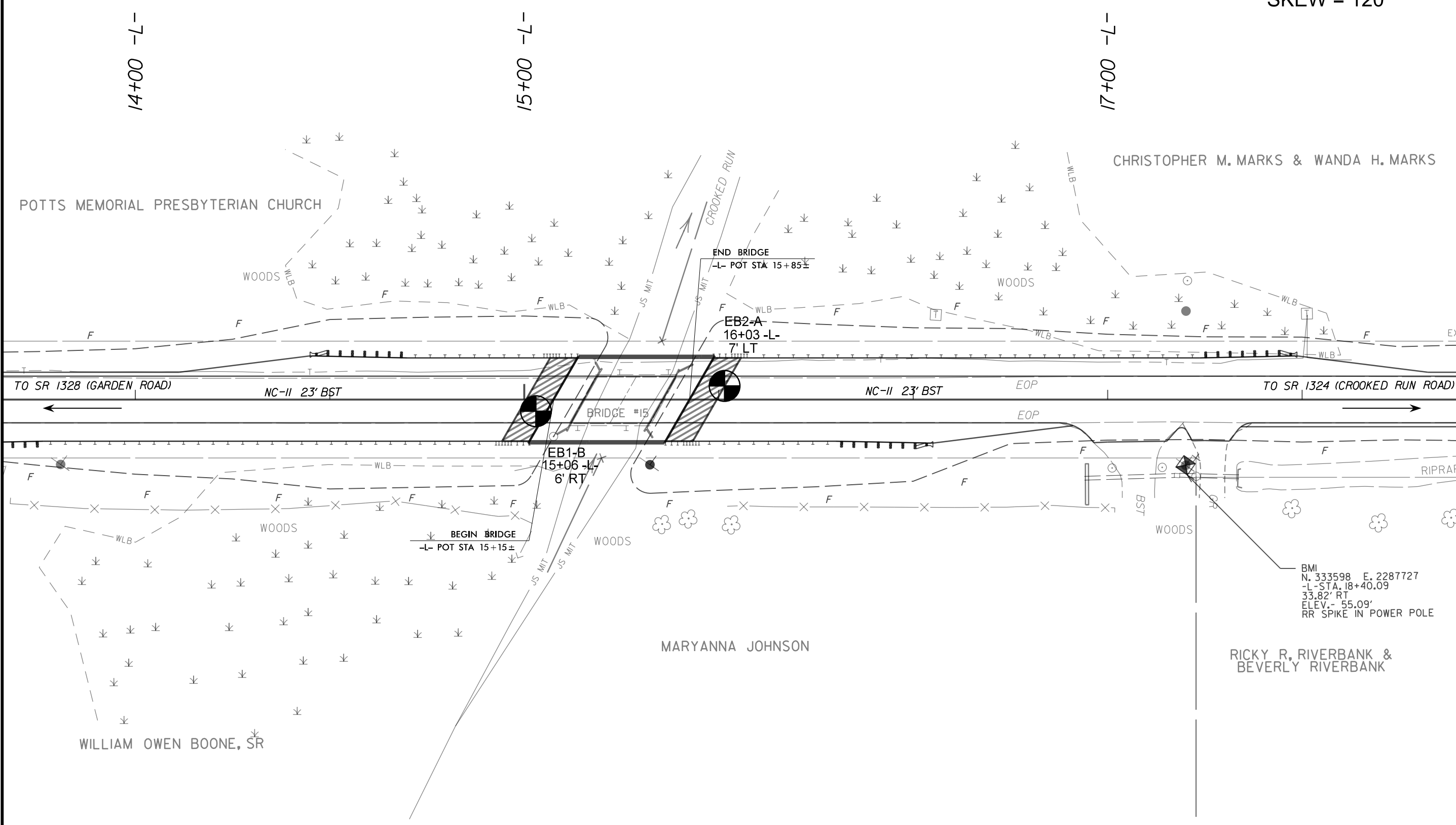

NOTE: INFERRED STRATIGRAPHY IS DRAWN THROUGH THE BORINGS WITH BOTH PROJECTED ON TO THE EXISTING GROUND PROFILE ALONG THE CENTERLINE OF -L- TAKEN FROM THE PROVIDED PROJECT TIN FILE (b5644_ls_tin_170510.tin) DATED 03/07/2019.

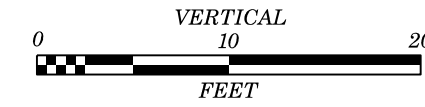

VE = 2

PROJECT REFERENCE NO. SHEET NO.

B-5644 4

CENTERLINE PROFILE ALONG
-L- AT BRIDGE NO. 700015

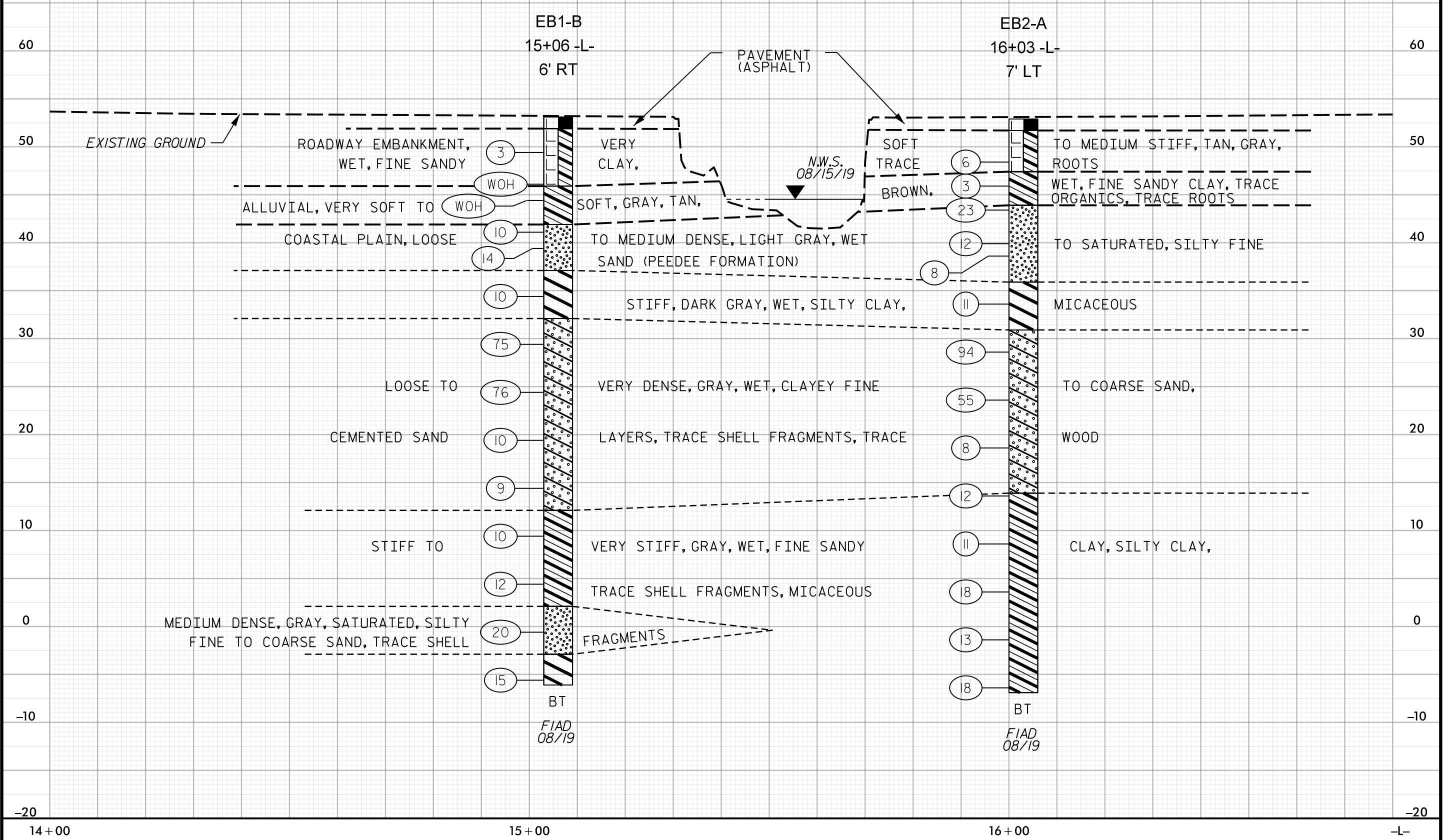

SITE PHOTOGRAPHS

REPLACE BRIDGE NO. 700015
ON NC 11 OVER CROOKED RUN

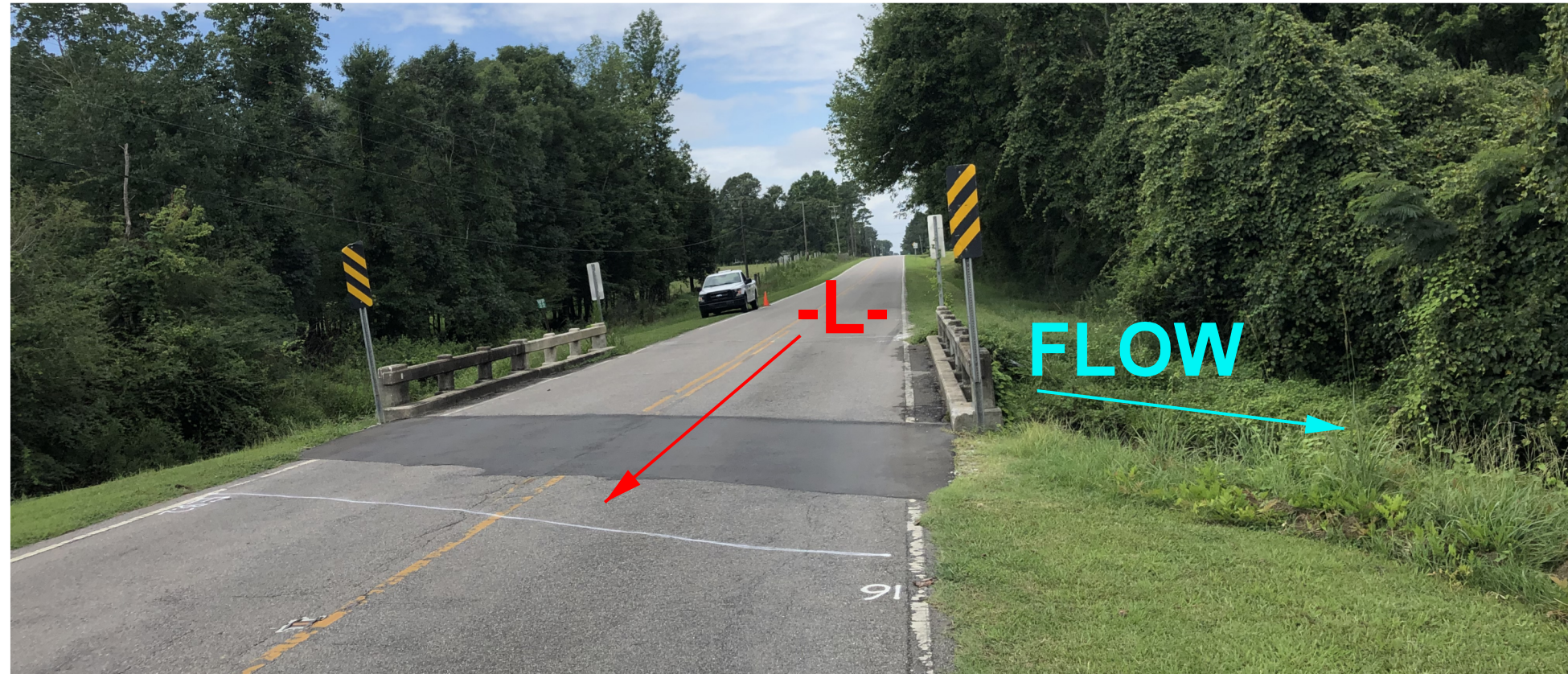

LOOKING FROM END BENT 2, WEST TOWARD END BENT 1

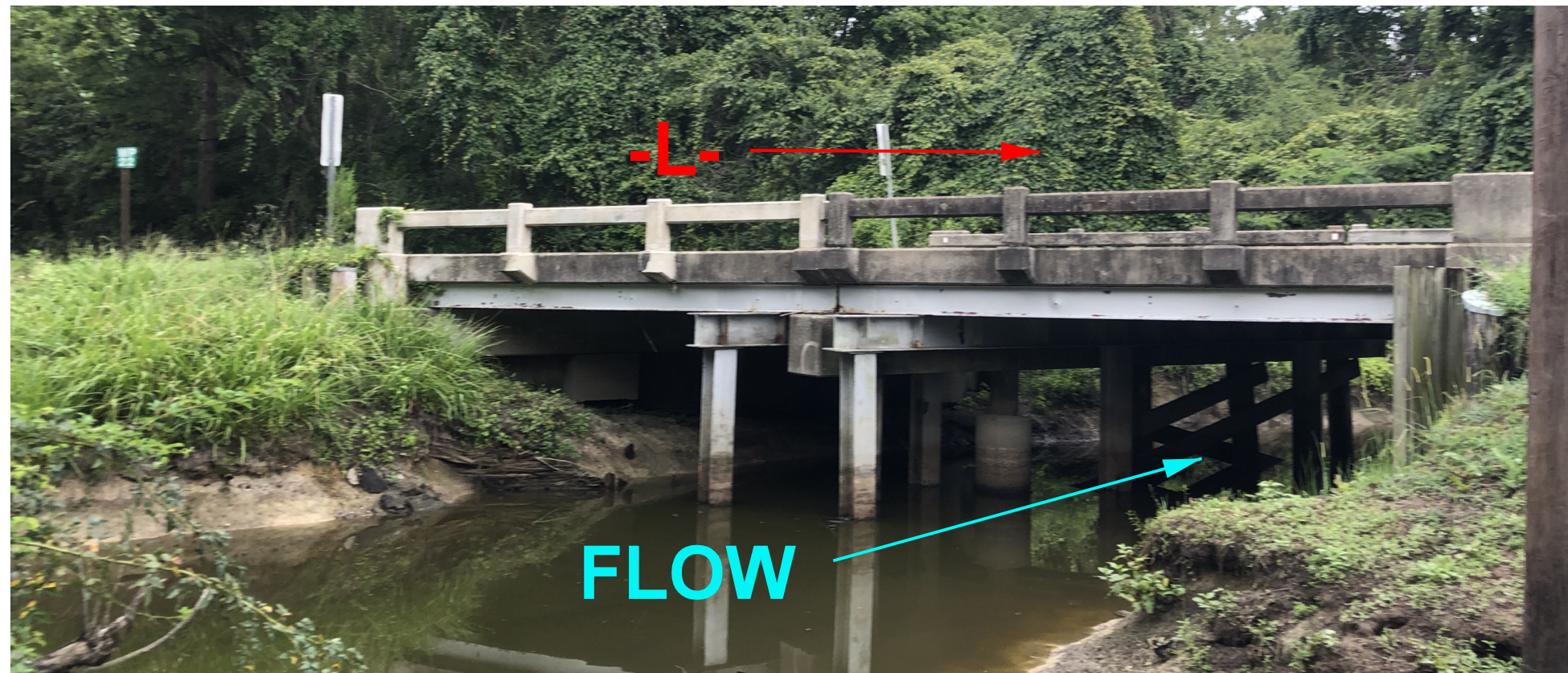

SOUTH OF BRIDGE, LOOKING DOWNSTREAM