

#1	-L_RT-	STA. 25+69.25, 40.20'	LT
#2	-L_RT-	STA. 25+71.53, 13.79'	LT
#3	-L_RT-	STA. 26+15.73, 21.16'	LT

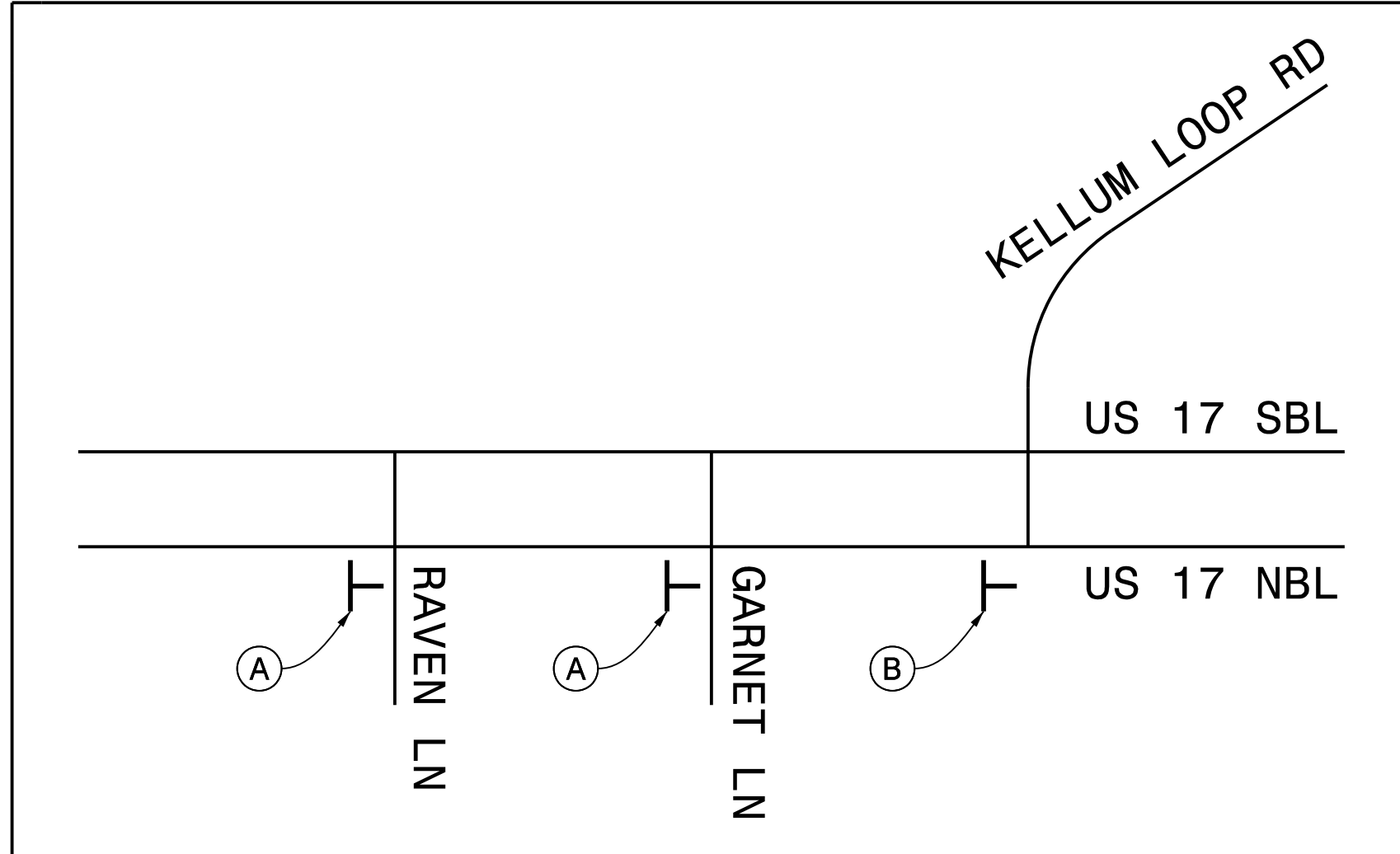

APPROVED: *Michael T. Rzepka*  
 DATE: 9/14/2022  
 SEAL  
 NORTH CAROLINA PROFESSIONAL ENGINEER  
 SEAL 15876  
 MICHAEL T. RZEPKA

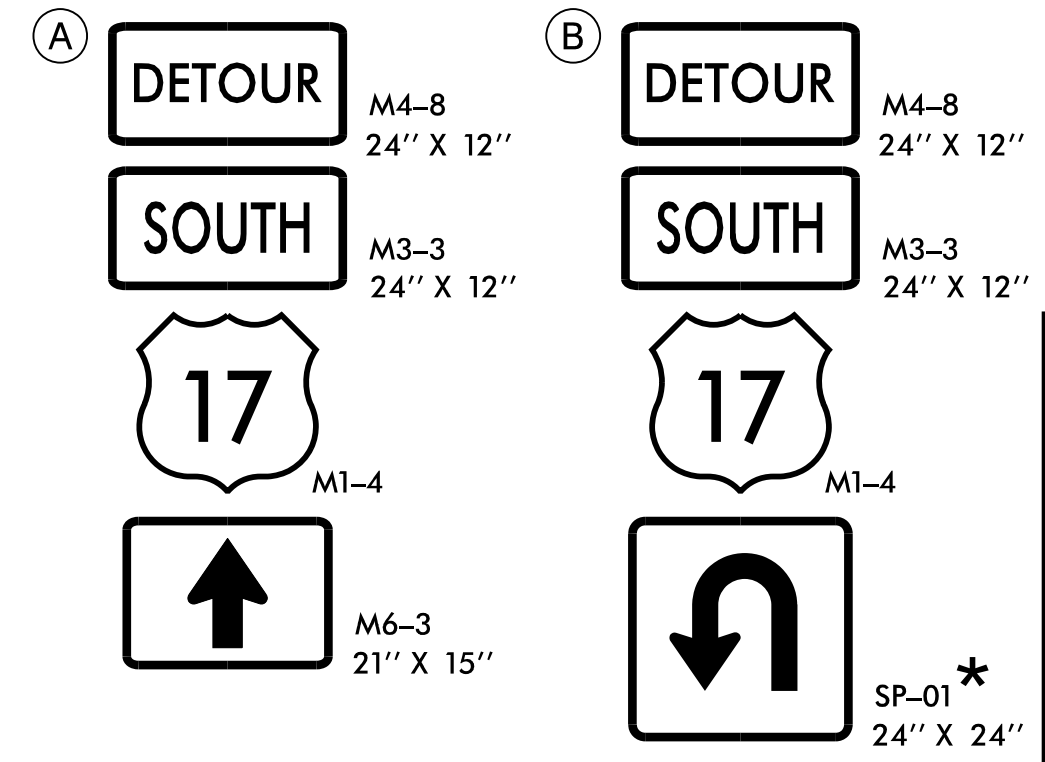

PHASE 2  
 DETAIL

\*SEE TMP-2A FOR SPECIAL SIGN DESIGN

PLOT DRIVER: NCDOT\_color\_eng\_50.plt  
 USER: CHARNDEN  
 DATE: 9/14/2022  
 TIME: 10:38:04 AM  
 FILE: p:\p\h\p\users\01\h\p\US\_East\_01\Documents\5705\1012\505\6.0\_CAD\_BIM\6.2\_WIP\Division\_03\B-5652\_TrafficControl\TCP\B5652.tmp\_07.d\02.dgn

REVISIONS