

09/08/99

14-OCT-2022 07:33 C:\UJO_FILES\2020\UCTG-14 A-0009C (TGS)\Section C UB0s\Utilities\Engineering\UB0\Proj\A-0009CC_ut_tsh_U001.psh.dgn

TIP PROJECT: A-0009CC

STATE OF NORTH CAROLINA
DIVISION OF HIGHWAYS

T.I.P. NO.	SHEET NO.
A-0009CC	UO-1

NOTE:
ALL UTILITY WORK SHOWN ON THIS SHEET WILL BE DONE BY OTHERS. NO PAYMENT WILL BE MADE TO THE CONTRACTOR FOR UTILITY WORK SHOWN ON THIS SHEET.

**UTILITIES BY OTHERS PLANS
GRAHAM COUNTY**

**LOCATION: UPGRADE NC 143 FROM 0.5 MILES NORTH OF APPALACHIAN TRAIL TO NC 28
UPGRADE NC 28 FROM 0.2 MILES WEST OF NC 143 TO SR 1228 (STECOAH RD)**
TYPE OF WORK: DISTRIBUTION POWER, COMMUNICATIONS, CATV

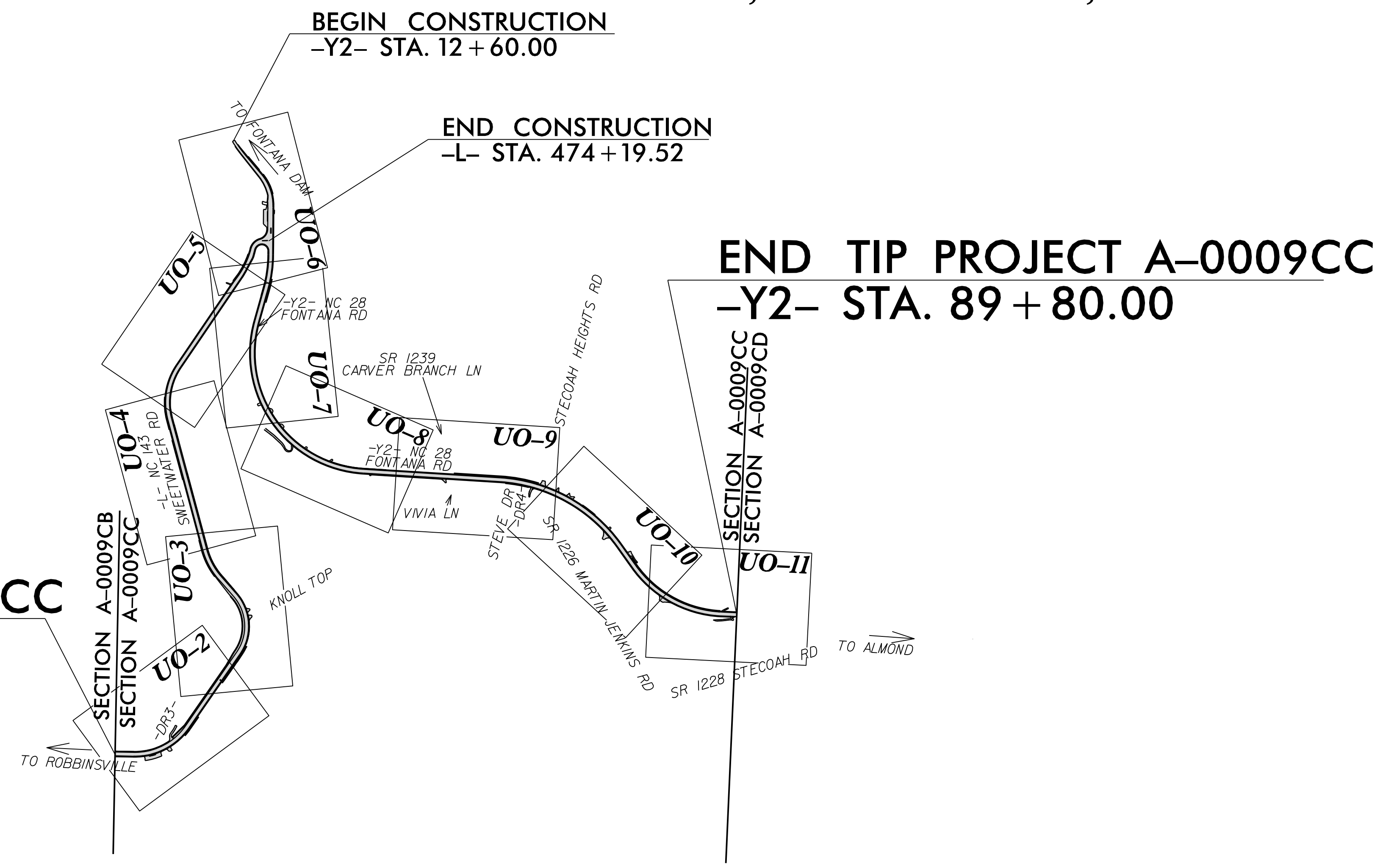
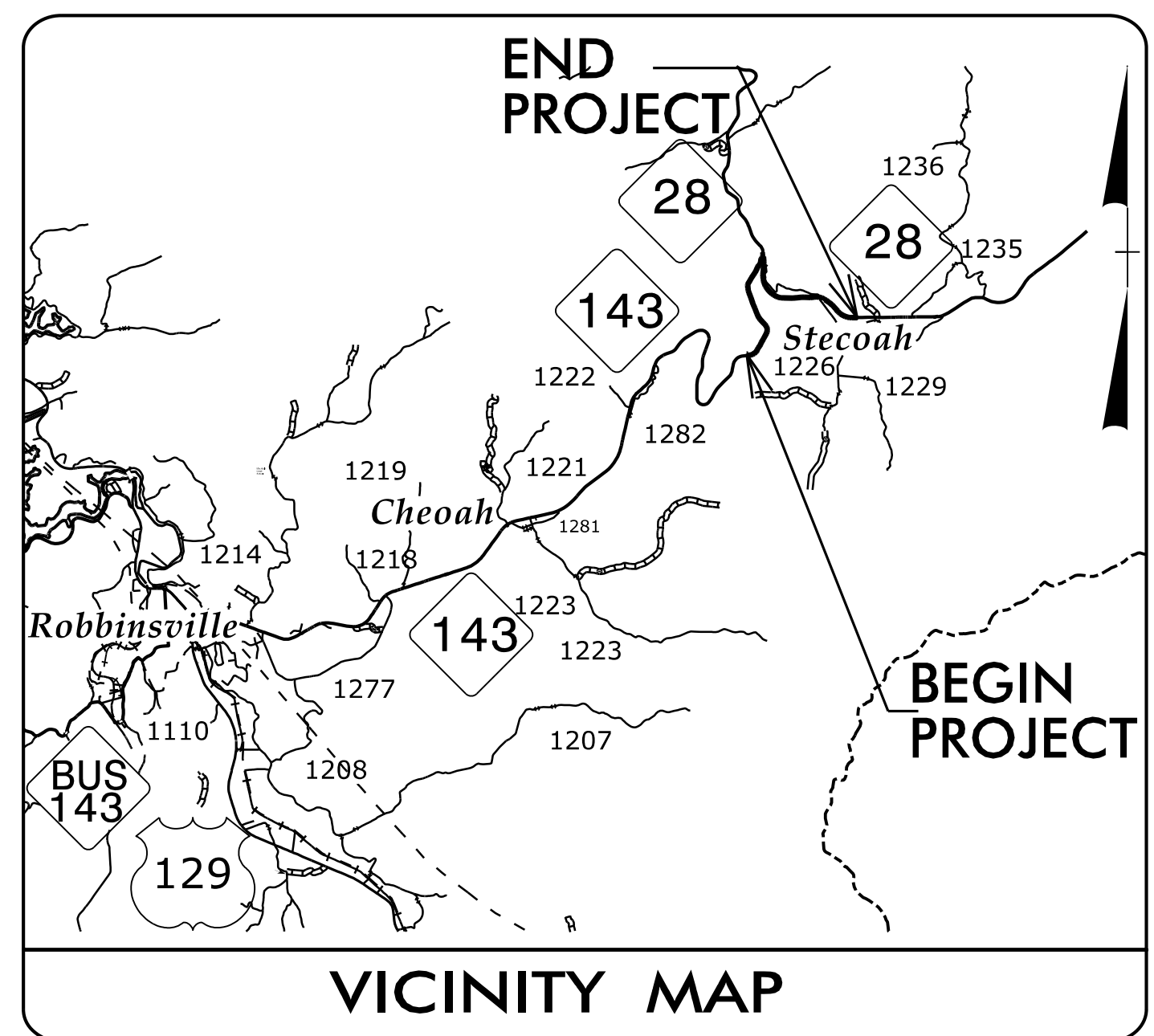

BEGIN TIP PROJECT A-0009CC
-L- STA. 414 + 50.00

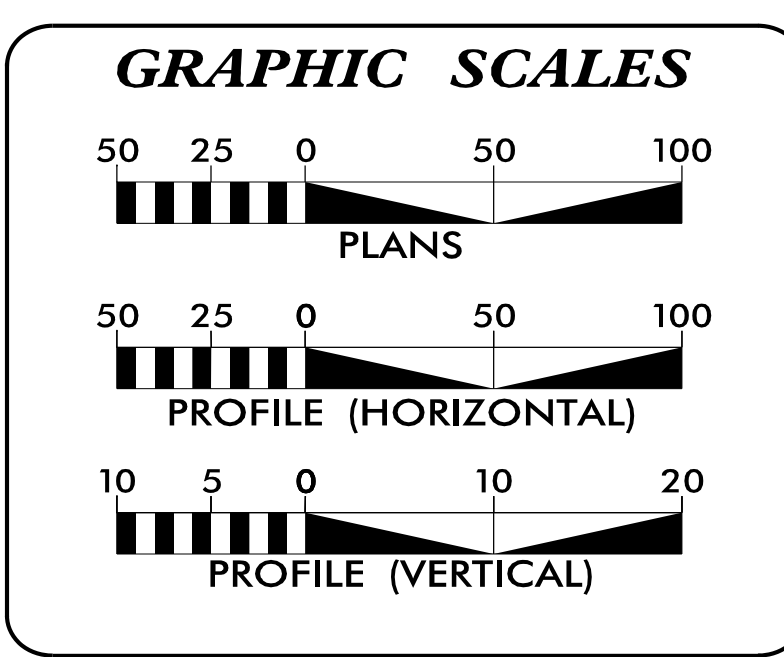
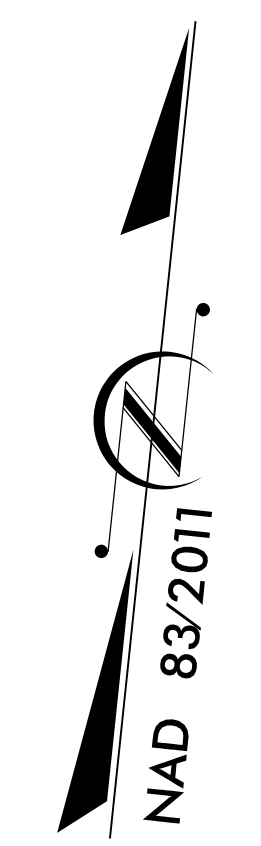

INDEX OF SHEETS

SHEET NO.:	DESCRIPTION:
UO-1	TITLE SHEET
UO-2 THRU UO-11	UBO PLAN SHEETS

UTILITY OWNERS WITH CONFLICTS

- (A) POWER DISTRIBUTION - DUKE ENERGY
- (B) COMMUNICATIONS - FRONTIER
- (C) COMMUNICATIONS/CATV - ZITO MEDIA

PREPARED IN THE OFFICE OF:

TELICS
1598 WESTBROOK PLAZA DR.
SUITE 202
WINSTON-SALEM, NC 27103
(336) 803-6038

<u>JIM BROOKS</u>	UTILITY PROJECT MANAGER
<u>CHRIS KENNEDY</u>	PROJECT UTILITY COORDINATOR

**DIVISION OF HIGHWAYS
DIVISION 14**
253 WEBSTER RD
SYLVIA, NC 28779

<u>WANDA AUSTIN, PE</u>	DIVISION ENGINEER
<u>BOB GOLDING</u>	DIVISION UTILITY ENGINEER

UTILITIES BY OTHERS

ALL PROPOSED UTILITY WORK SHOWN ON THIS SHEET WILL BE DONE BY OTHERS. NO PAYMENT WILL BE MADE TO THE CONTRACTOR FOR PROPOSED UTILITY WORK SHOWN ON THIS SHEET.

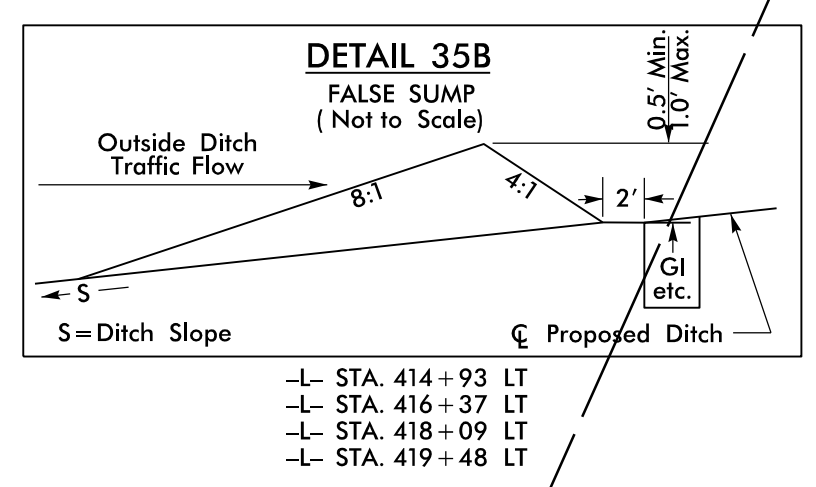
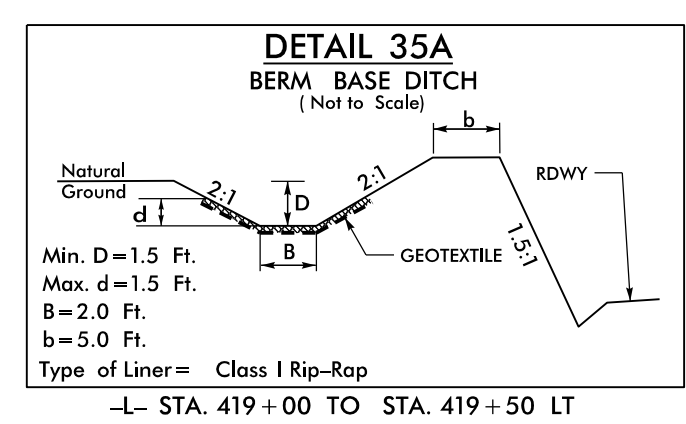
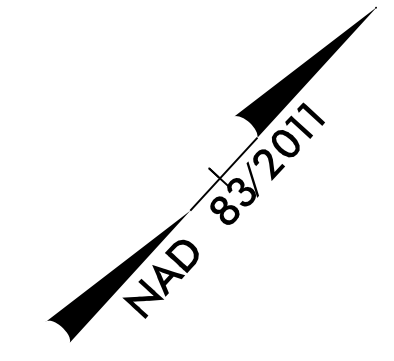

END SECTION A-0009CB
BEGIN SECTION A-0009CC

BEGIN TIP PROJECT A-0009CC
 -L- STA. 414 + 50.00

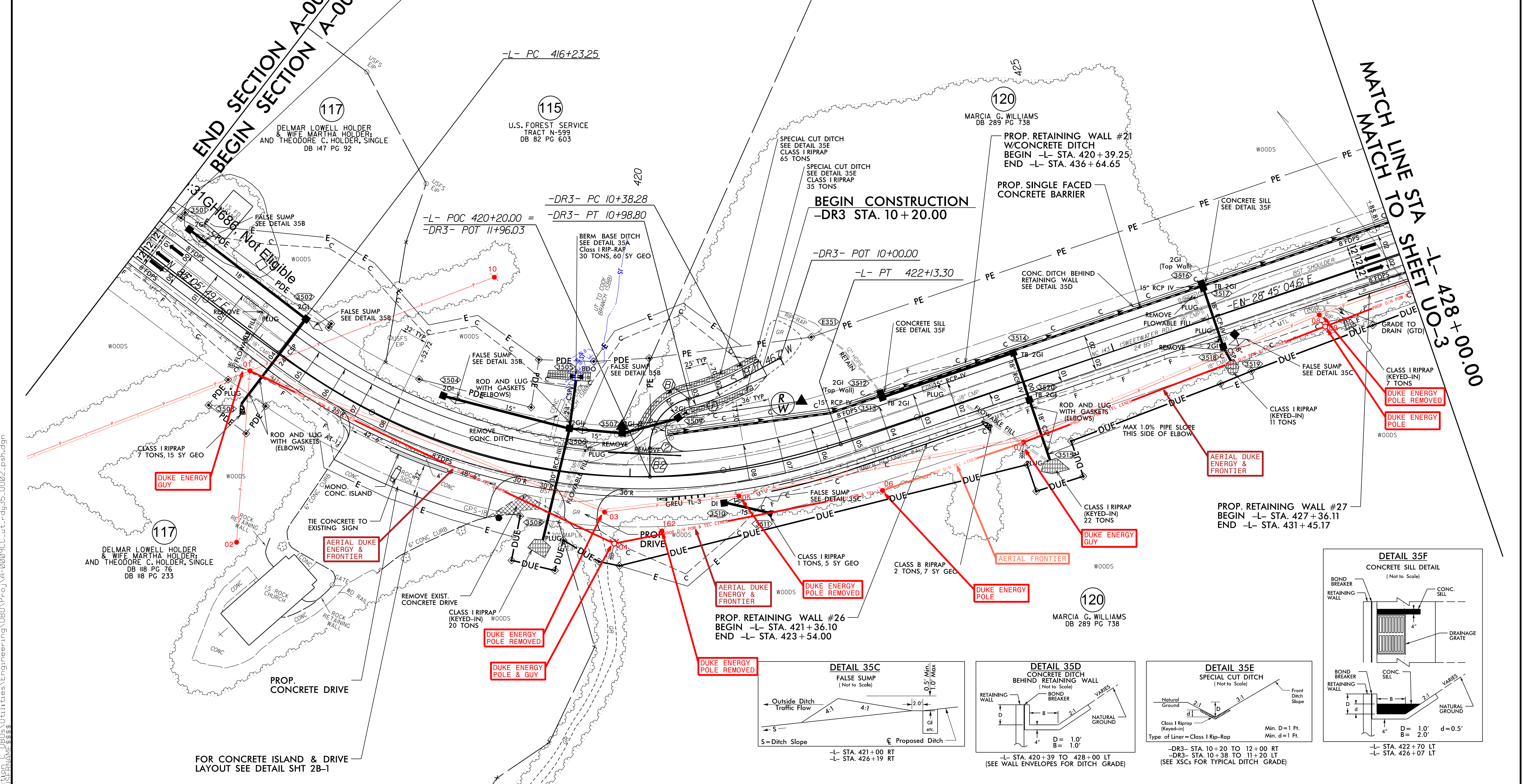

MATCH LINE TO SHEET U0-3
 -L- STA. 428 + 00.00

DUKE ENERGY GUY

AERIAL DUKE ENERGY & FRONTIER

DUKE ENERGY POLE REMOVED

DUKE ENERGY POLE REMOVED

DUKE ENERGY POLE REMOVED

DUKE ENERGY POLE

DUKE ENERGY GUY

AERIAL DUKE ENERGY & FRONTIER

DUKE ENERGY POLE REMOVED

DUKE ENERGY POLE

14-OCT-2022 07:50 C:\Users\jgibson\Documents\Projects\A-0009CC\ut.rdj\35_U002_psh.dgn
 9c (TGS)\Utilities\Engineer\mg\UBOV\Proj\A-0009CC\ut.rdj\35_U002_psh.dgn

FOR CONCRETE ISLAND & DRIVE LAYOUT SEE DETAIL SHT 2B-1

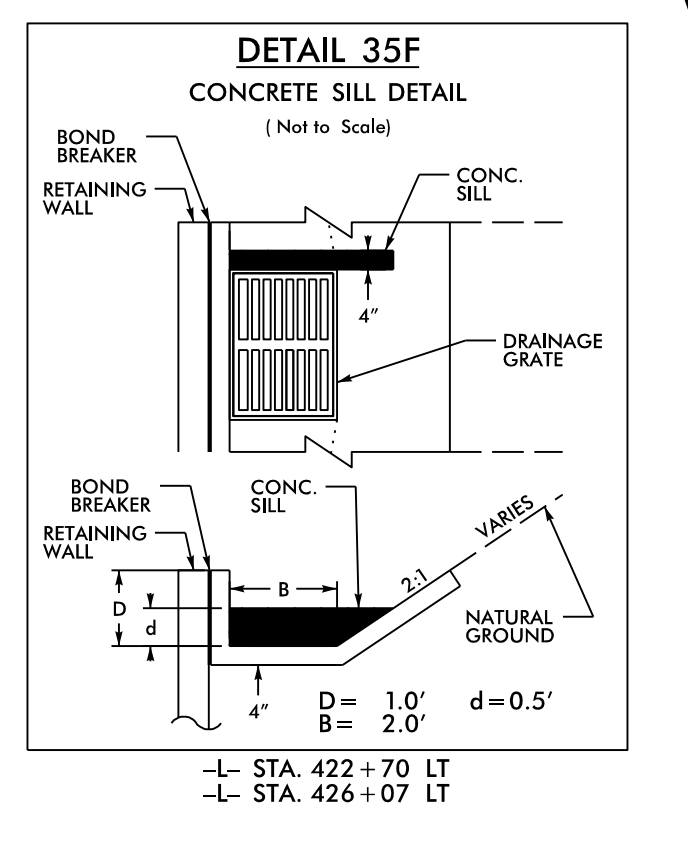
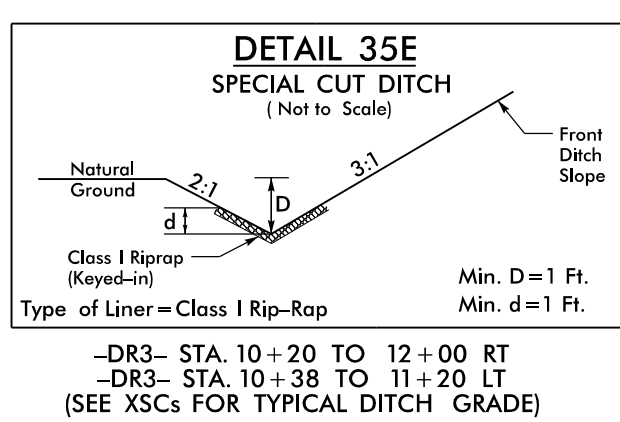
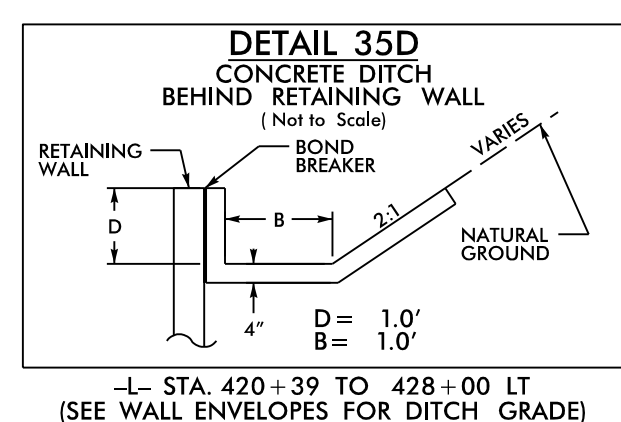
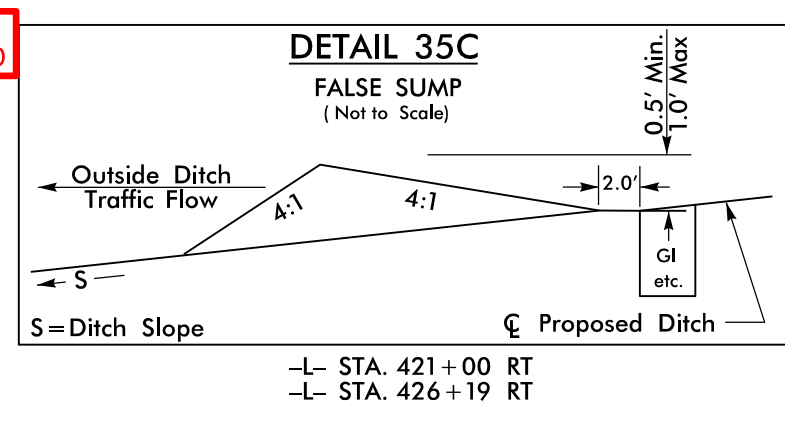

5/14/2022 09:07 (TGS) \\ut-lit-tues\Engineering\LIB0\Pro\A-A-0009CC-ut-rdy\37_UD04_psh.dgn

PROJECT REFERENCE NO.	SHEET NO.
A-0009CC	UO-4
THIS SHEET CORRESPONDS TO RDY-37	

-L- CURVE DATA
 PI Sta 456+91.51
 $\Delta = 49^{\circ}15'00.2" (RT)$
 $D = 9^{\circ}32'57.5"$
 $L = 515.75'$
 $R = 275.02'$
 $SE = 0.08$
 $DS = 45 MPH$

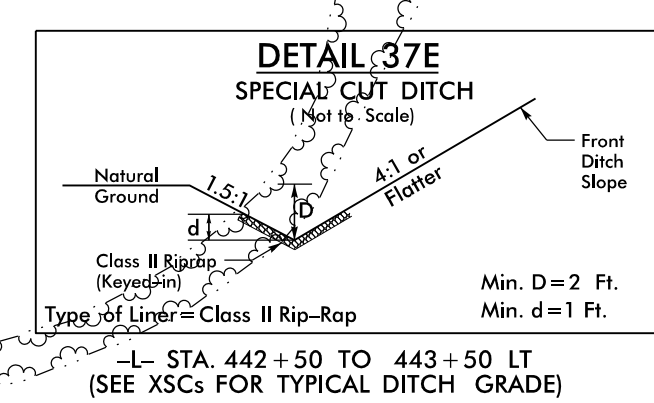
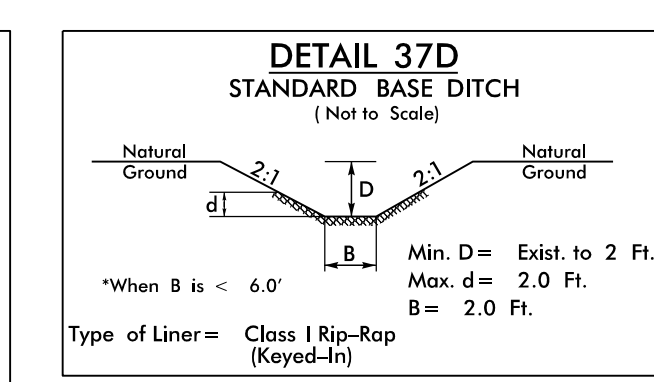
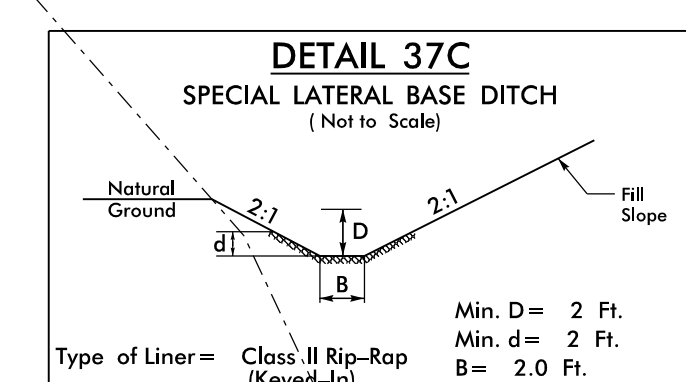
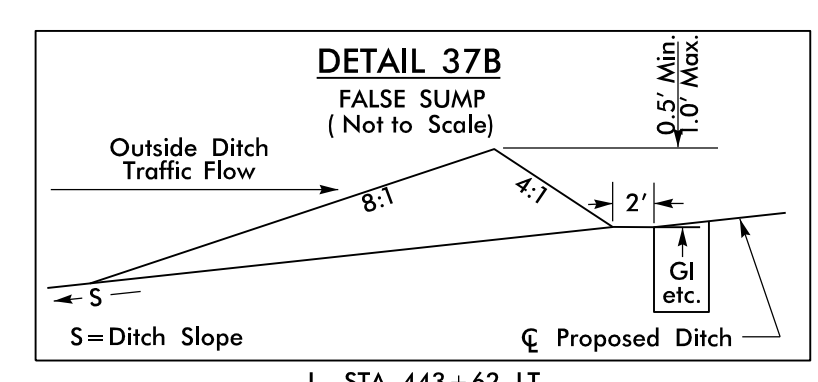
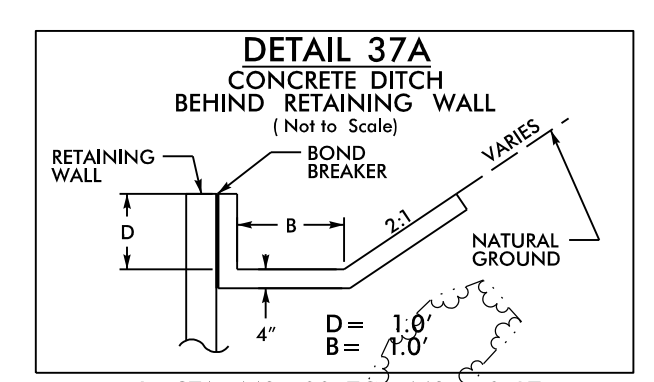

UTILITIES BY OTHERS
 ALL PROPOSED UTILITY WORK SHOWN ON THIS SHEET WILL BE DONE BY OTHERS. NO PAYMENT WILL BE MADE TO THE CONTRACTOR FOR PROPOSED UTILITY WORK SHOWN ON THIS SHEET.

MATCH LINE STA -L- 442+00.00
MATCH TO SHEET UO-3

MATCH LINE STA -L- 456+00.00
MATCH TO SHEET UO-5

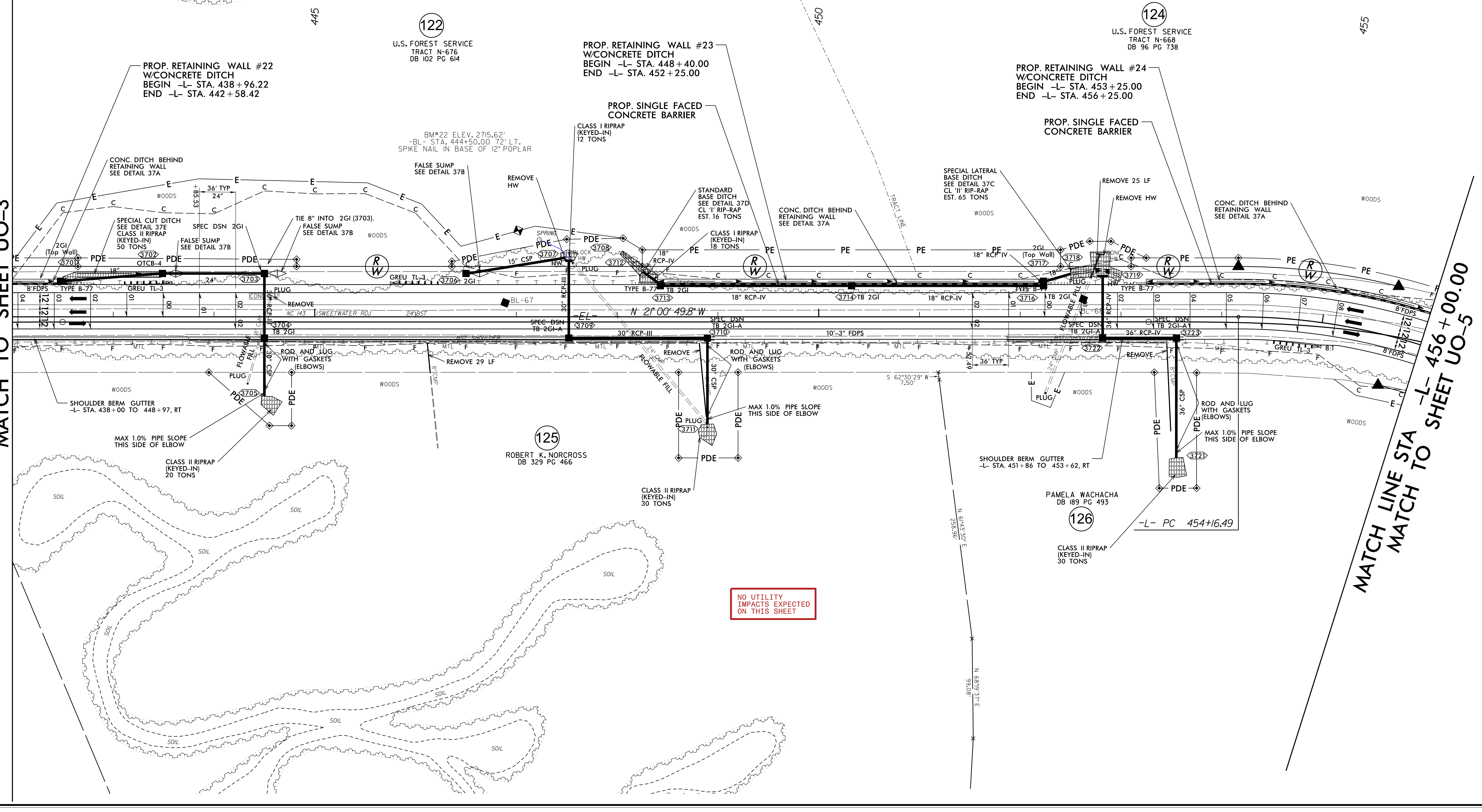

NO UTILITY IMPACTS EXPECTED ON THIS SHEET

5/14/2011

-L- CURVE DATA

PI Sta 456+91.51	PI Sta 470+84.26
$\Delta = 49^\circ 15' 00.2''$ (RT)	$\Delta = 21^\circ 31' 55.6''$ (LT)
$D = 9^\circ 32' 57.5''$	$D = 7^\circ 32' 20.1''$
$L = 515.75'$	$L = 285.61'$
$T = 275.02'$	$T = 144.51'$
$R = 600.00'$	$R = 760.00'$
$SE = 0.08$	$SE = 0.04$
$DS = 45$ MPH	$DS = 45$ MPH

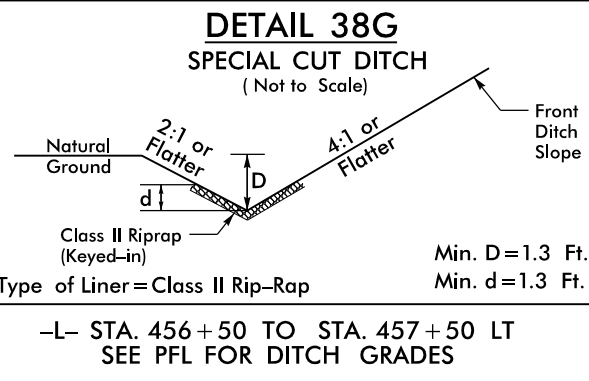
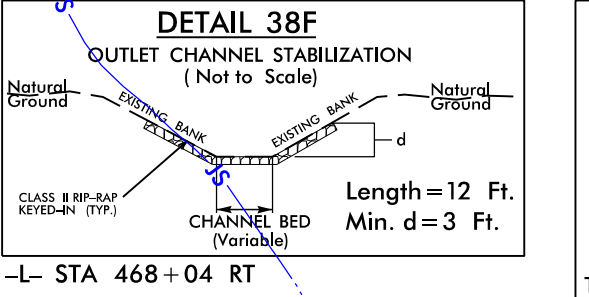
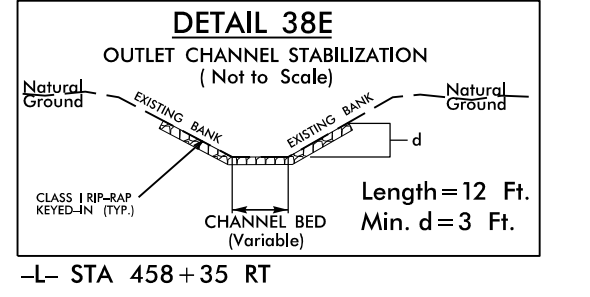
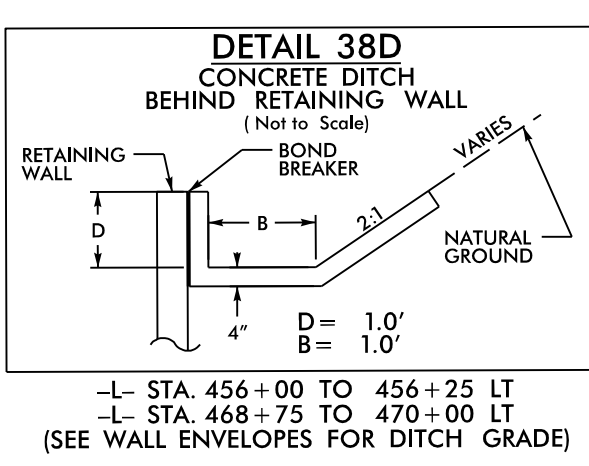
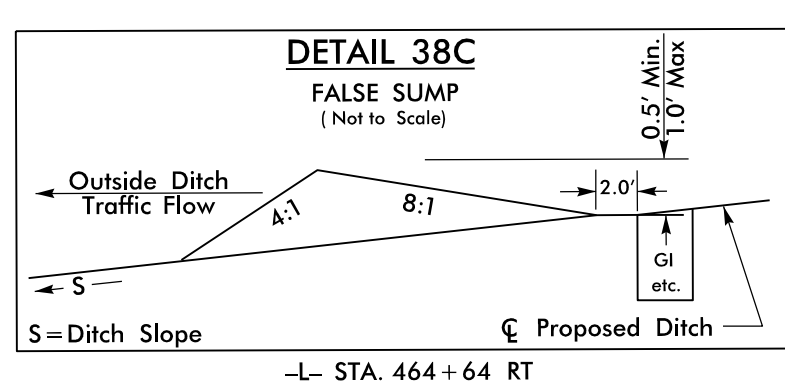
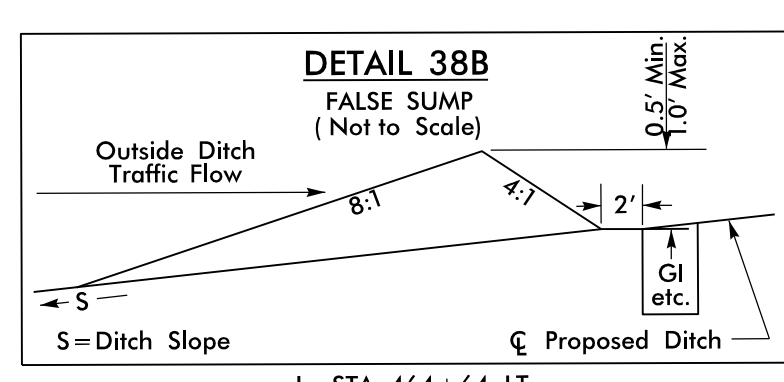
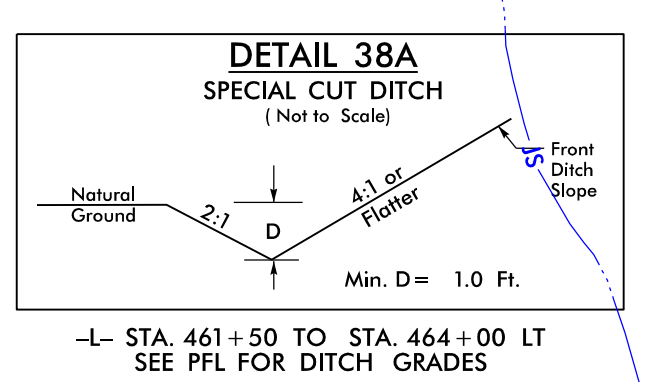

UTILITIES BY OTHERS

ALL PROPOSED UTILITY WORK SHOWN ON THIS SHEET WILL BE DONE BY OTHERS. NO PAYMENT WILL BE MADE TO THE CONTRACTOR FOR PROPOSED UTILITY WORK SHOWN ON THIS SHEET.

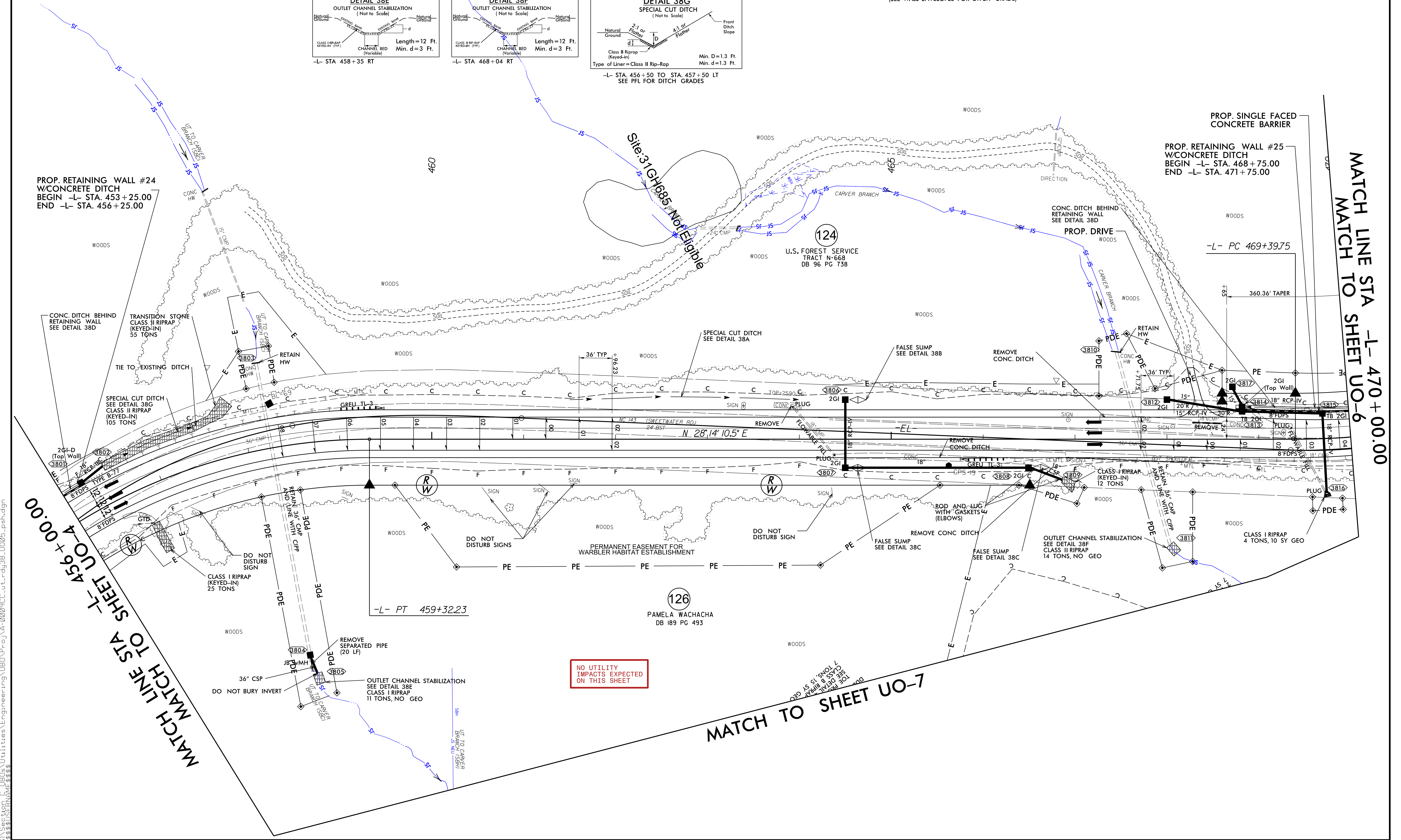

MATCH LINE TO SHEET UO-4
-L- STA 456+00.00

MATCH LINE TO SHEET UO-6
-L- STA 470+00.00

NO UTILITY IMPACTS EXPECTED ON THIS SHEET

14-OCT-2022 08:10
C:\Users\jfrank\Documents\Projects\A-0009CC-ut-rd\38_U005_psh.dgn

UTILITIES BY OTHERS

ALL PROPOSED UTILITY WORK SHOWN ON THIS SHEET WILL BE DONE BY OTHERS. NO PAYMENT WILL BE MADE TO THE CONTRACTOR FOR PROPOSED UTILITY WORK SHOWN ON THIS SHEET.

-Y2- CURVE DATA			-L- CURVE DATA		
PI Sta 11+99.45	PI Sta 18+27.84	PI Sta 25+91.41	PI Sta 470+84.26	PI Sta 473+03.33	
$\Delta = 19^{\circ} 44' 48.4" (LT)$	$\Delta = 38^{\circ} 45' 19.5" (RT)$	$\Delta = 15^{\circ} 17' 06.5" (RT)$	$\Delta = 2^{\circ} 31' 55.6" (LT)$	$\Delta = 75^{\circ} 53' 24.9" (RT)$	
D = 5' 00" 00.0"	D = 12' 52" 31.6"	D = 4' 46" 28.7"	D = 7' 32" 20.1"	D = 57' 17" 44.8"	
L = 394.94'	L = 301.00'	L = 320.13'	L = 285.61'	L = 132.45'	
T = 199.45'	T = 156.51'	T = 161.02'	T = 144.51'	T = 77.97'	
R = 1,145.92'	R = 445.00'	R = 1,200.00'	R = 760.00'	R = 100.00'	
SE = 0.08	SE = 0.08	SE = 0.08	SE = 0.04	SE = 0.03	
DS = 55 MPH	DS = 40 MPH	DS = 60 MPH	DS = 45 MPH	DS = 20 MPH	

① -Y2- PC 24+30.38

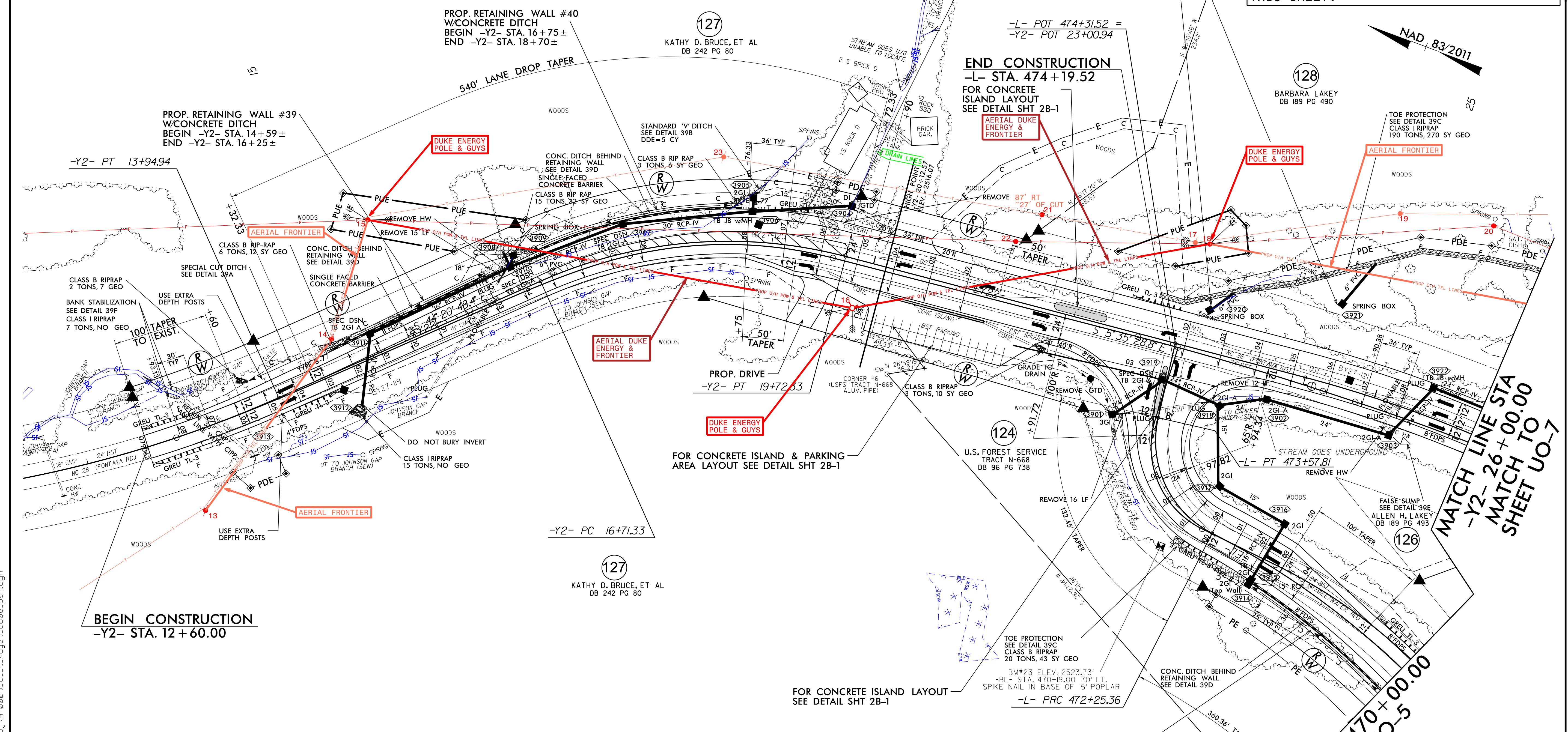

BEGIN CONSTRUCTION
-Y2- STA. 12+60.00

END CONSTRUCTION
-L- STA. 474+19.52
FOR CONCRETE ISLAND LAYOUT
SEE DETAIL SHT 2B-1

FOR CONCRETE ISLAND & PARKING AREA LAYOUT
SEE DETAIL SHT 2B-1

FOR CONCRETE ISLAND LAYOUT
SEE DETAIL SHT 2B-1

PROP. RETAINING WALL #25
W/CONCRETE DITCH
BEGIN -L- STA. 468+75.00
END -L- STA. 471+75.00

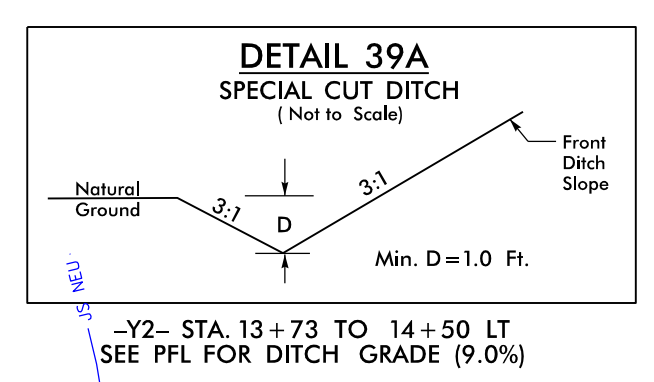

-Y2- STA. 13+73 TO 14+50 LT
SEE PFL FOR DITCH GRADE (9.0%)

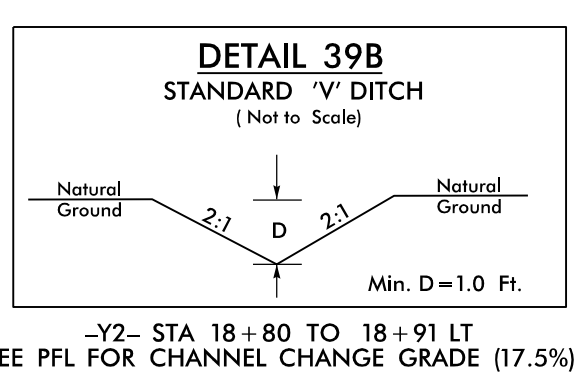

-Y2- STA. 18+80 TO 18+91 LT
SEE PFL FOR CHANNEL CHANGE GRADE (17.5%)

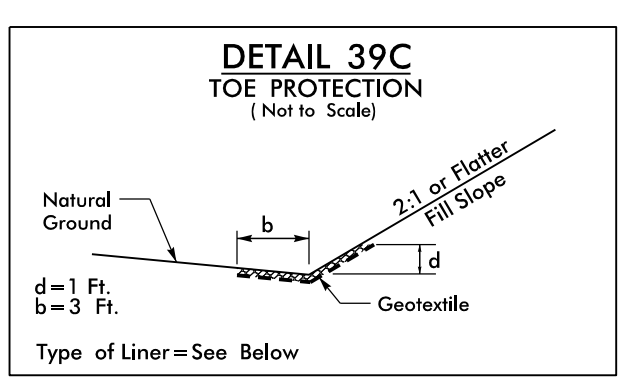

-L- STA. 471+75 TO 472+50 LT (Class B Rip-Rap)
-Y2- STA. 22+75 TO 26+45 LT (Class I Rip-Rap)

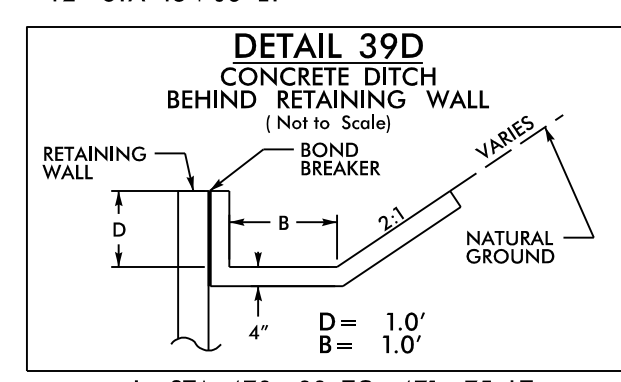

-L- STA. 470+00 TO 471+75 LT
-Y2- STA. 14+75 TO 16+25 LT
-Y2- STA. 16+75 TO 18+60 LT
(SEE WALL ENVELOPES FOR DITCH GRADE)

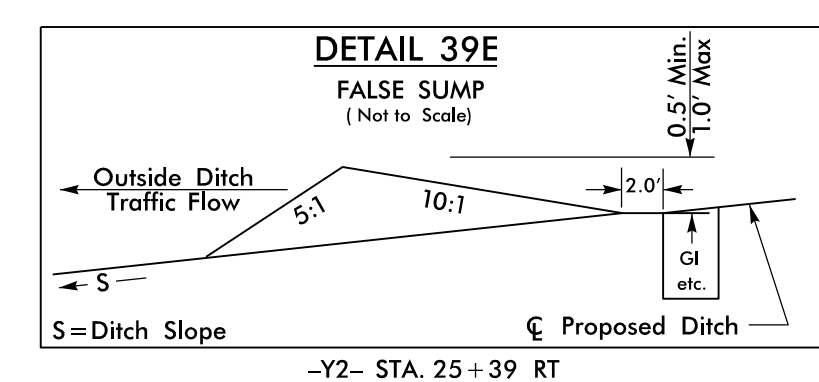

-Y2- STA. 25+39 RT

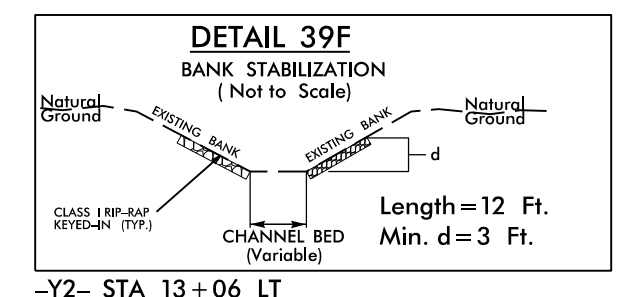

-Y2- STA. 13+06 LT

MATCH LINE STA
-Y2- 26+00.00
MATCH TO
SHEET UO-7

MATCH LINE STA
-L- 470+00.00
MATCH TO
SHEET UO-5

5/14/09
14-OCT-2022 08:16
C:\Users\jacob\OneDrive\Engineering\UBO\Proj\A-0009CC-ut.-rdy39_u006_psh.dgn

14-OCT-2022 08:21 (TGS) \Sect\Utilities\Engineering\UBD\Proj\A-0009CC.ctb.rdy40_U007_psh.dgn
5/14/2022 10:10 AM

PROJECT REFERENCE NO.	SHEET NO.
A-0009CC	U0-7
THIS SHEET CORRESPONDS TO RDY-40	

UTILITIES BY OTHERS

ALL PROPOSED UTILITY WORK SHOWN ON THIS SHEET WILL BE DONE BY OTHERS. NO PAYMENT WILL BE MADE TO THE CONTRACTOR FOR PROPOSED UTILITY WORK SHOWN ON THIS SHEET.

-Y2- CURVE DATA

PI Sta 25+91.41	PI Sta 44+39.36
$\Delta = 15^{\circ}17'06.5''$ (RT)	$\Delta = 102^{\circ}05'50.9''$ (LT)
$D = 4^{\circ}46'28.7''$	$D = 5^{\circ}09'42.4''$
$L = 320.13'$	$L = 1,977.95'$
$T = 161.02'$	$T = 1,373.12'$
$R = 1,200.00'$	$R = 1,110.00'$
$SE = 0.08$	$SE = 0.08$
$DS = 60$ MPH	$DS = 55$ MPH

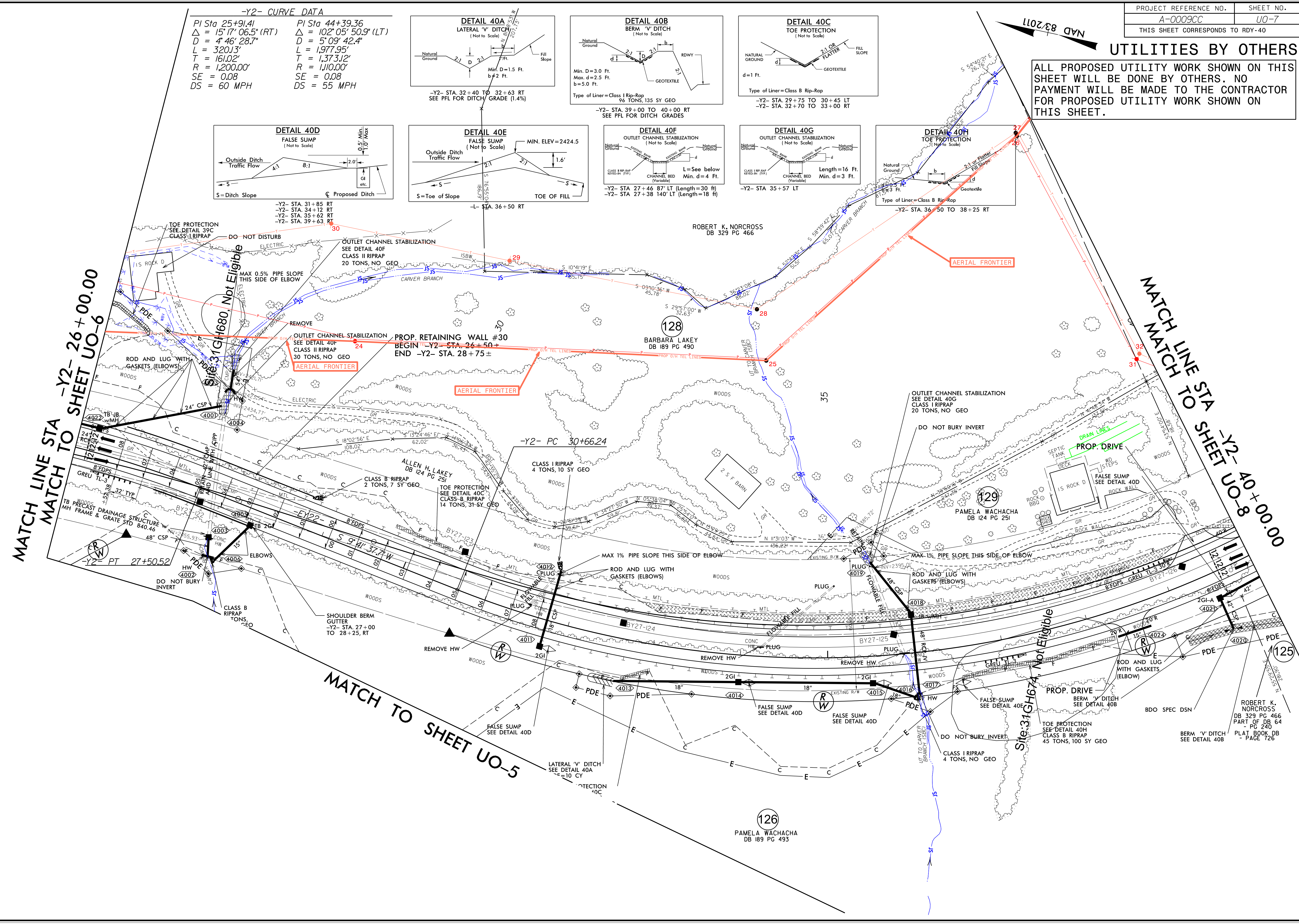
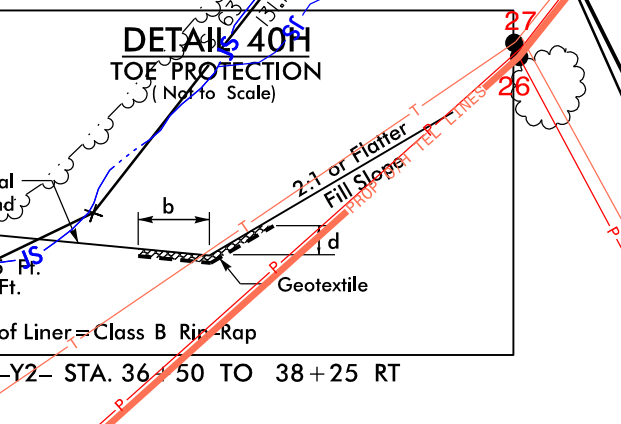
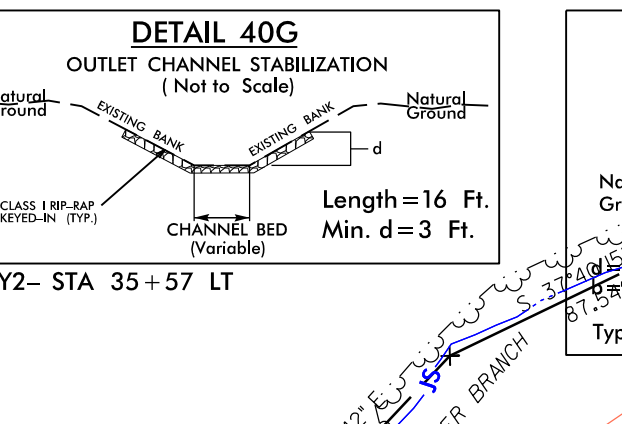
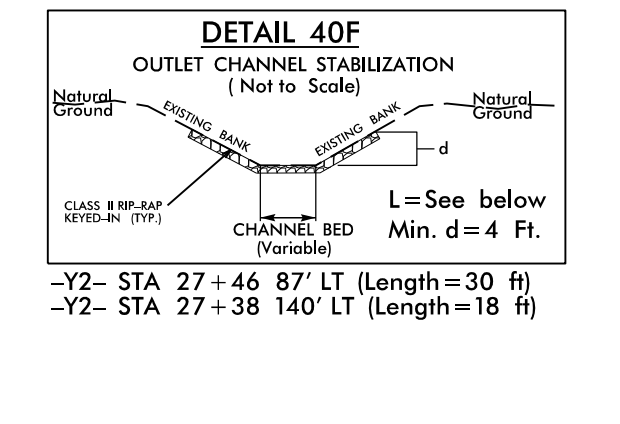
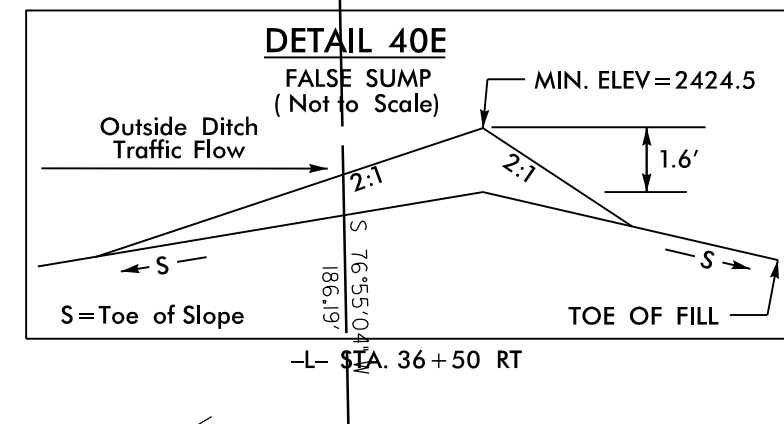
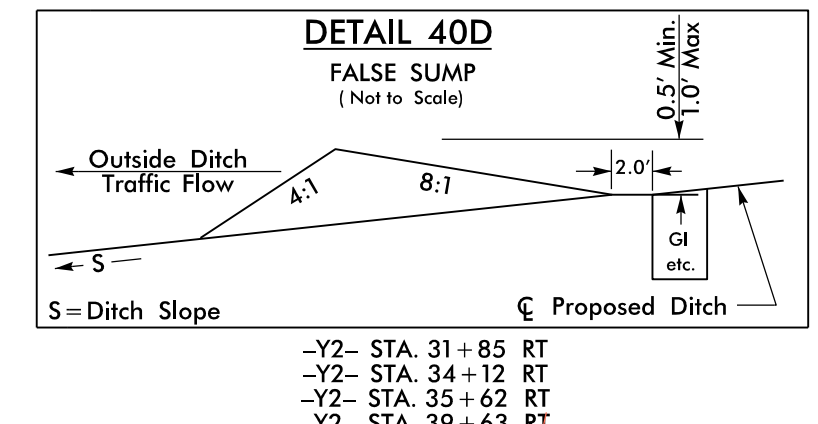
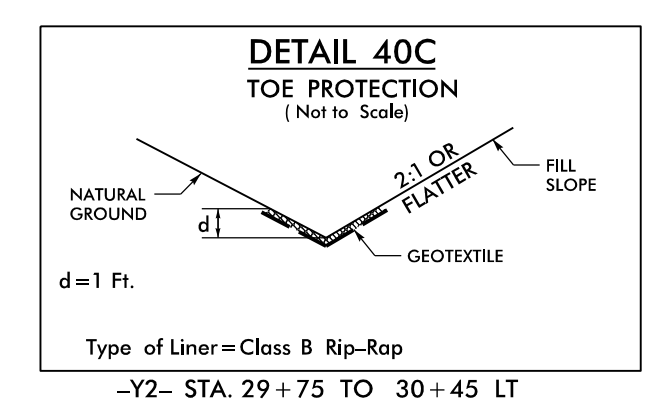
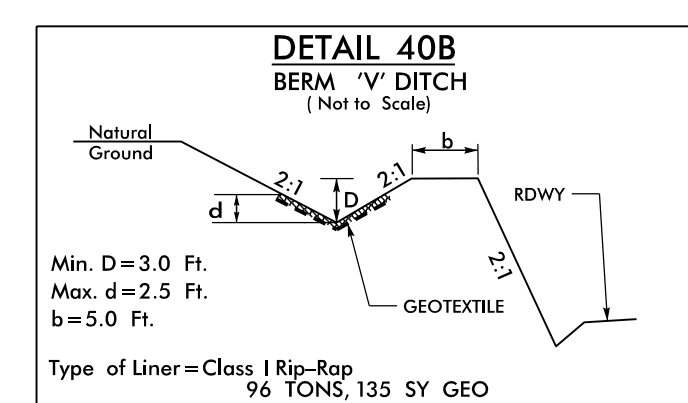
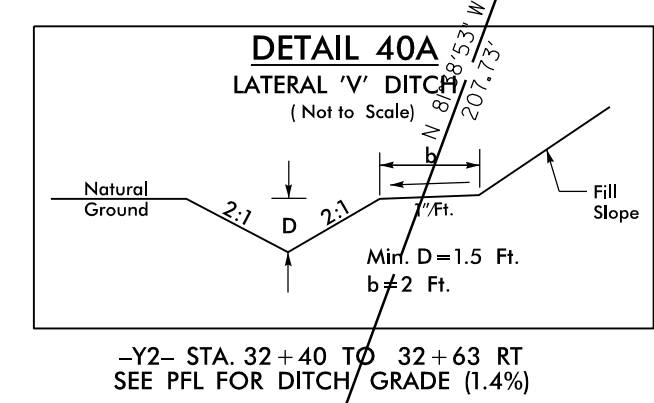

MATCH LINE STA -Y2- 26+00.00
MATCH TO SHEET UO-6

MATCH LINE STA -Y2- 40+00.00
MATCH TO SHEET UO-8

MATCH TO SHEET UO-5

Site 31GH674 Not Eligible

AERIAL FRONTIER

AERIAL FRONTIER

AERIAL FRONTIER

AERIAL FRONTIER

AERIAL FRONTIER

AERIAL FRONTIER

AERIAL FRONTIER

AERIAL FRONTIER

AERIAL FRONTIER

AERIAL FRONTIER

AERIAL FRONTIER

AERIAL FRONTIER

AERIAL FRONTIER

AERIAL FRONTIER

AERIAL FRONTIER

AERIAL FRONTIER

AERIAL FRONTIER

AERIAL FRONTIER

AERIAL FRONTIER

AERIAL FRONTIER

AERIAL FRONTIER

AERIAL FRONTIER

AERIAL FRONTIER

AERIAL FRONTIER

AERIAL FRONTIER

AERIAL FRONTIER

AERIAL FRONTIER

AERIAL FRONTIER

AERIAL FRONTIER

AERIAL FRONTIER

AERIAL FRONTIER

AERIAL FRONTIER

AERIAL FRONTIER

AERIAL FRONTIER

AERIAL FRONTIER

AERIAL FRONTIER

AERIAL FRONTIER

AERIAL FRONTIER

AERIAL FRONTIER

AERIAL FRONTIER

AERIAL FRONTIER

AERIAL FRONTIER

AERIAL FRONTIER

AERIAL FRONTIER

AERIAL FRONTIER

AERIAL FRONTIER

AERIAL FRONTIER

AERIAL FRONTIER

AERIAL FRONTIER

AERIAL FRONTIER

AERIAL FRONTIER

AERIAL FRONTIER

AERIAL FRONTIER

AERIAL FRONTIER

AERIAL FRONTIER

AERIAL FRONTIER

AERIAL FRONTIER

AERIAL FRONTIER

AERIAL FRONTIER

UTILITIES BY OTHERS

ALL PROPOSED UTILITY WORK SHOWN ON THIS SHEET WILL BE DONE BY OTHERS. NO PAYMENT WILL BE MADE TO THE CONTRACTOR FOR PROPOSED UTILITY WORK SHOWN ON THIS SHEET.

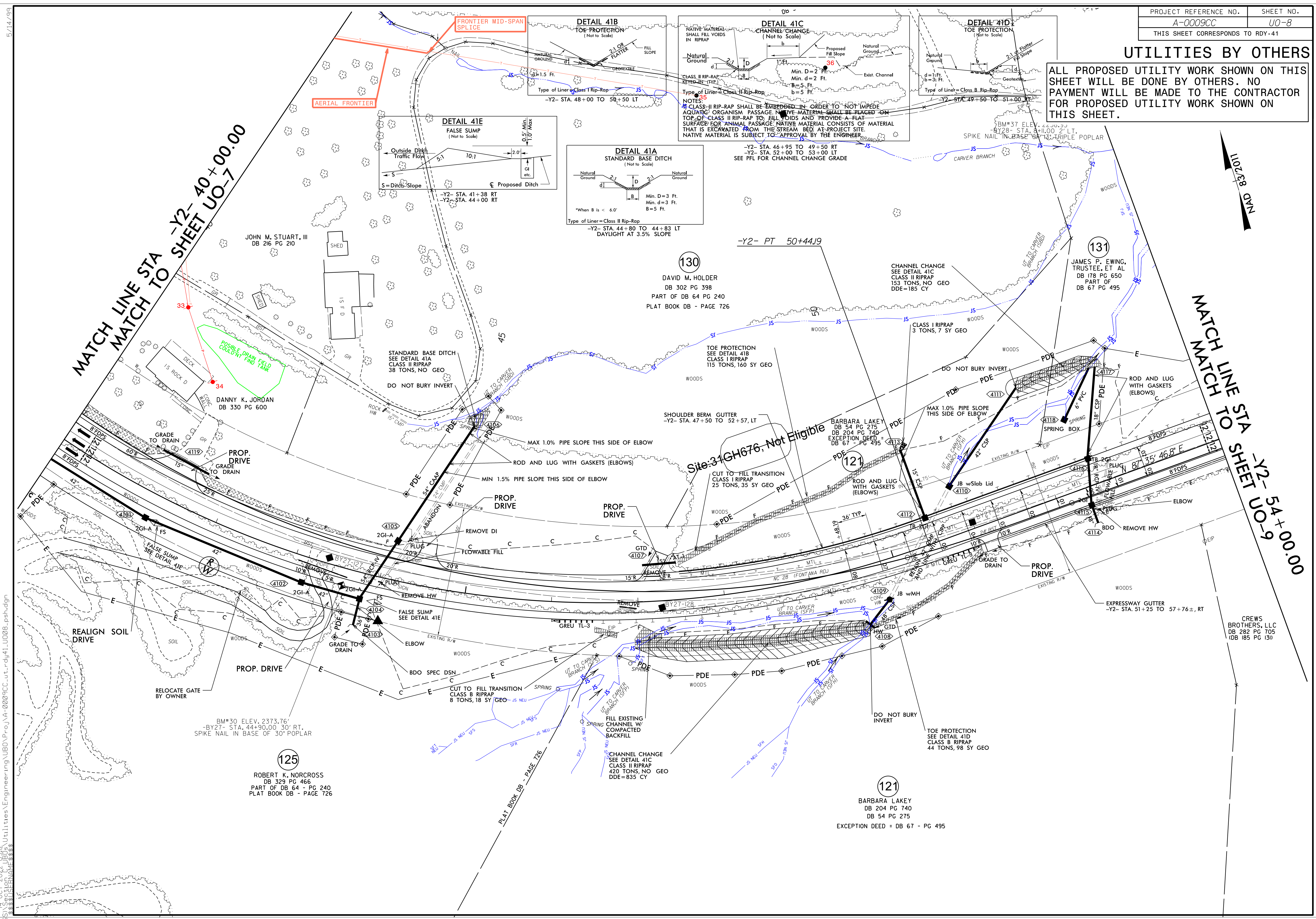

MATCH LINE STA -Y2- 40+00.00
MATCH TO SHEET UO-7

MATCH LINE STA -Y2- 54+00.00
MATCH TO SHEET UO-9

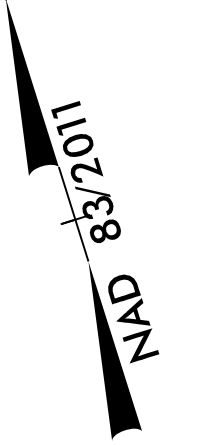

5/14/1999
15-OCT-2022 09:12 Utilities\Engineering\UBO\Proj\A-0009CC-ut-rdy41-UO08.psh.dgn
C:\Users\jchen\OneDrive\Documents\A-0009CC-ut-rdy41-UO08.psh.dgn

UTILITIES BY OTHERS

ALL PROPOSED UTILITY WORK SHOWN ON THIS SHEET WILL BE DONE BY OTHERS. NO PAYMENT WILL BE MADE TO THE CONTRACTOR FOR PROPOSED UTILITY WORK SHOWN ON THIS SHEET.

MATCH LINE STA -Y2- 54+00.00
MATCH TO SHEET UO-8

MATCH LINE STA -Y2- 68+00.00
MATCH TO SHEET UO-10

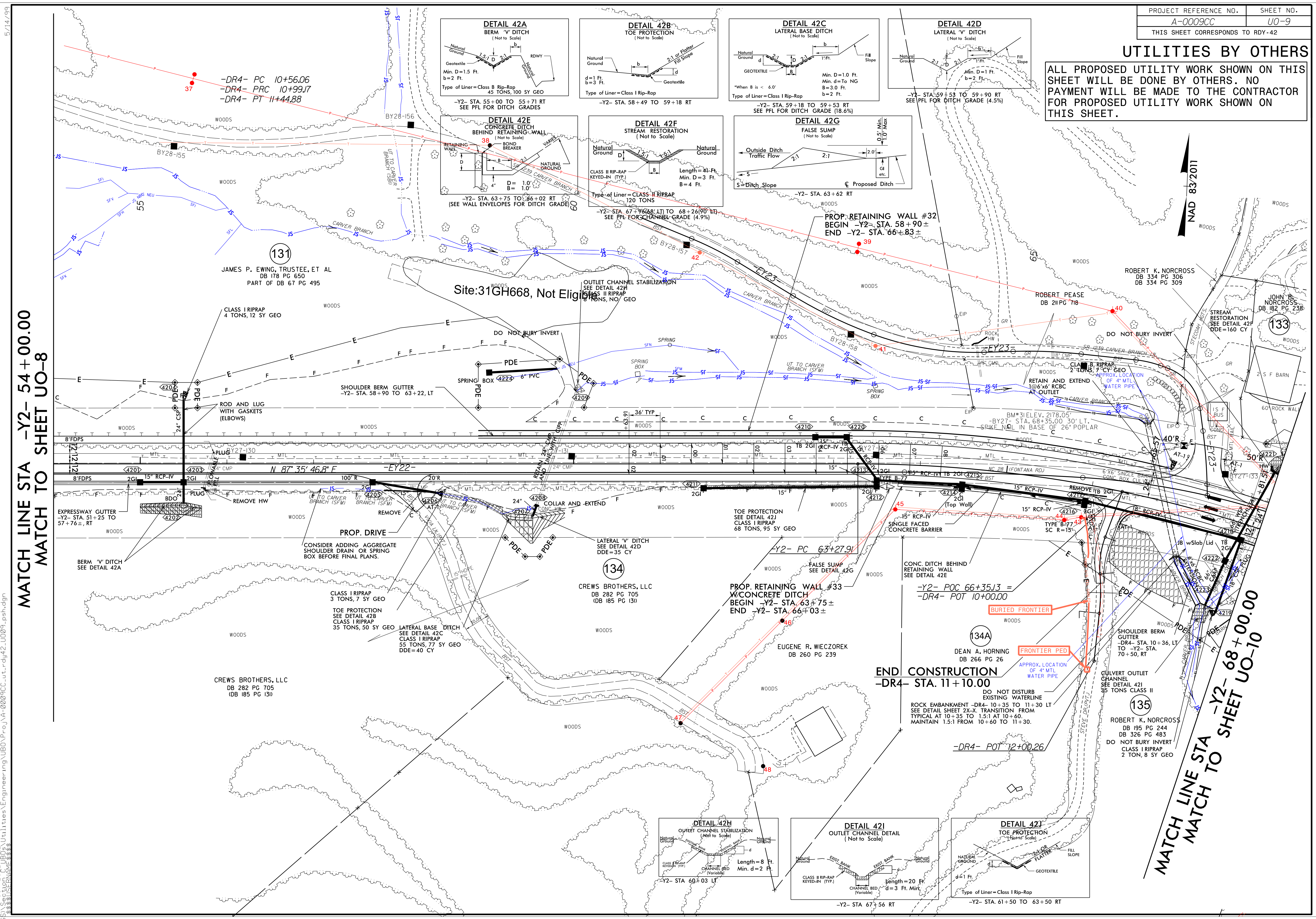

5/14/2022 09:21
I:\GIS\Projects\Utilities\Engineering\UBO\ProJ\A-0009CC\ut_rdy42_UO09_psb.dgn
14 OCT 2022 09:21
I:\GIS\Projects\Utilities\Engineering\UBO\ProJ\A-0009CC\ut_rdy42_UO09_psb.dgn

UTILITIES BY OTHERS

ALL PROPOSED UTILITY WORK SHOWN ON THIS SHEET WILL BE DONE BY OTHERS. NO PAYMENT WILL BE MADE TO THE CONTRACTOR FOR PROPOSED UTILITY WORK SHOWN ON THIS SHEET.

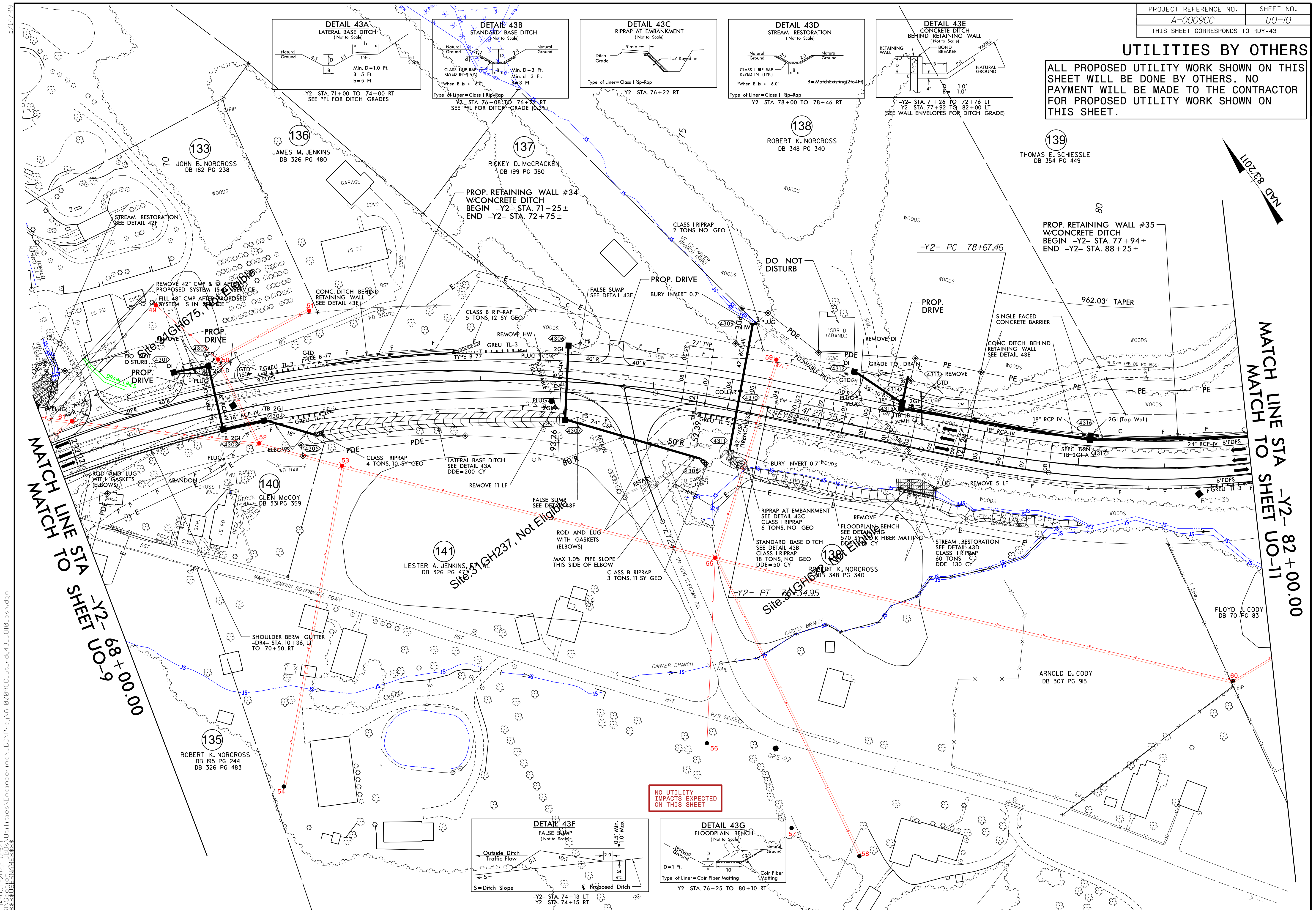

5/14/99
14-OCT-2022 09:27 Utilities\Engineering\UBO\Proj\A-0009CC-ut_rdy43-U010_psh.dgn
10/25/2022 10:53 AM
10/25/2022 10:53 AM

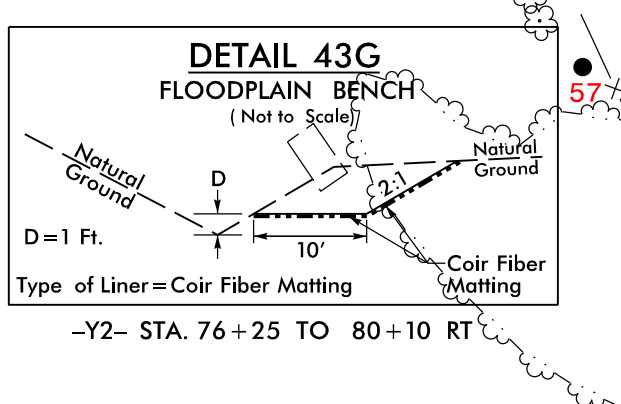
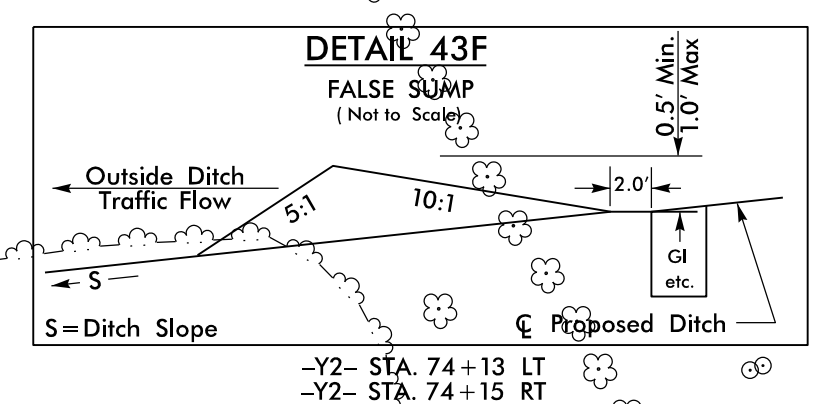
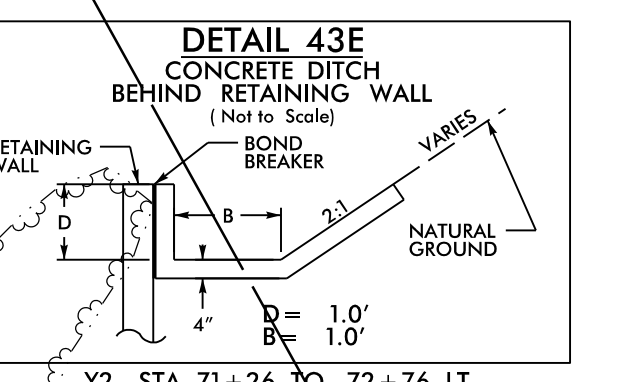
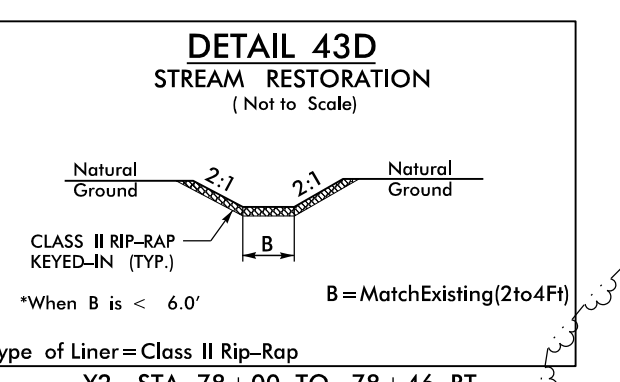
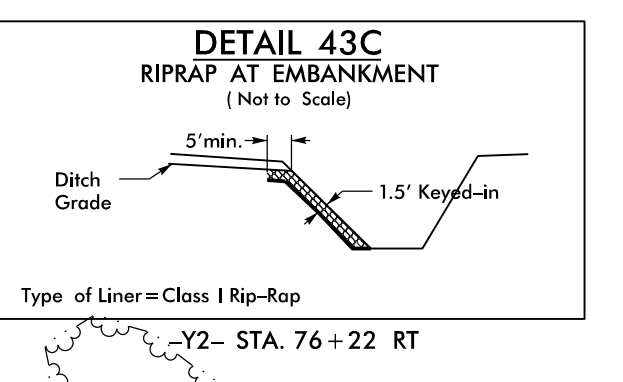
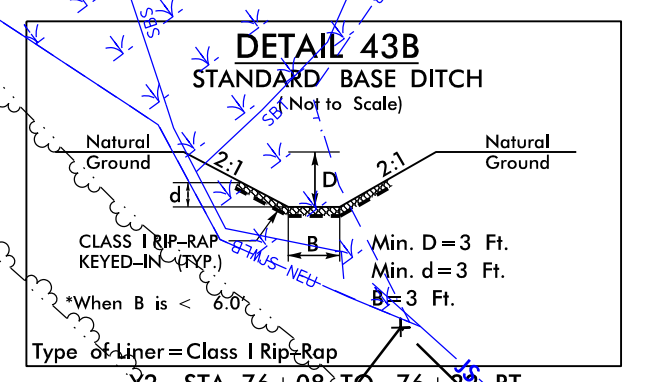
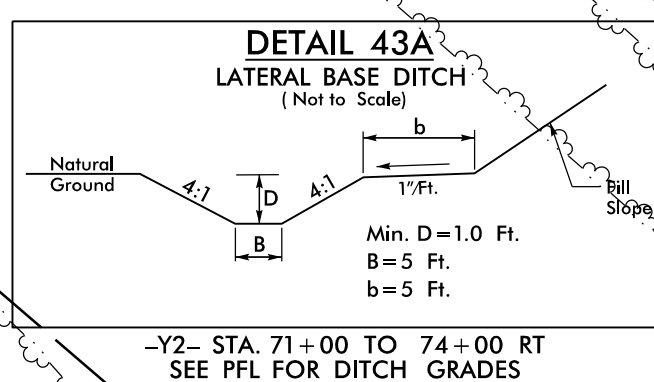

NO UTILITY IMPACTS EXPECTED ON THIS SHEET

MATCH LINE TO SHEET UO-9
MATCH LINE TO SHEET UO-11

MATCH LINE TO SHEET UO-11
MATCH LINE TO SHEET UO-11

