

# RETAINING WALL #26:

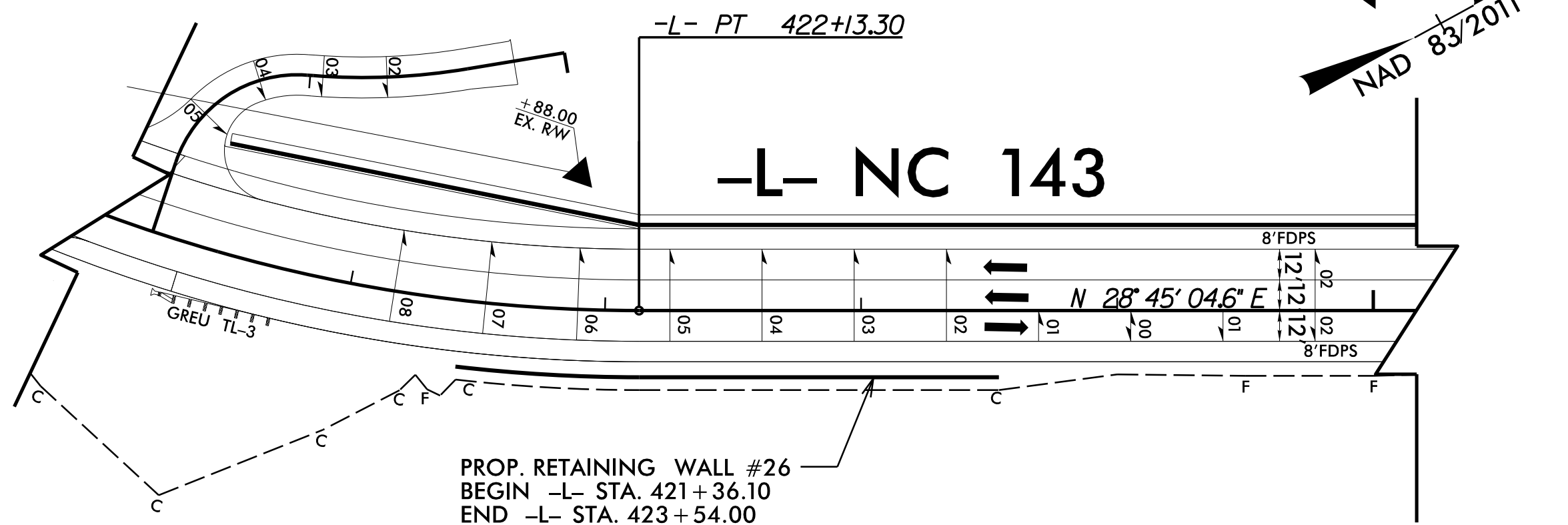

PROP. RETAINING WALL #26  
 BEGIN -L- STA. 421+36.10  
 END -L- STA. 423+54.00

## RETAINING WALL #26:

NOT TO SCALE

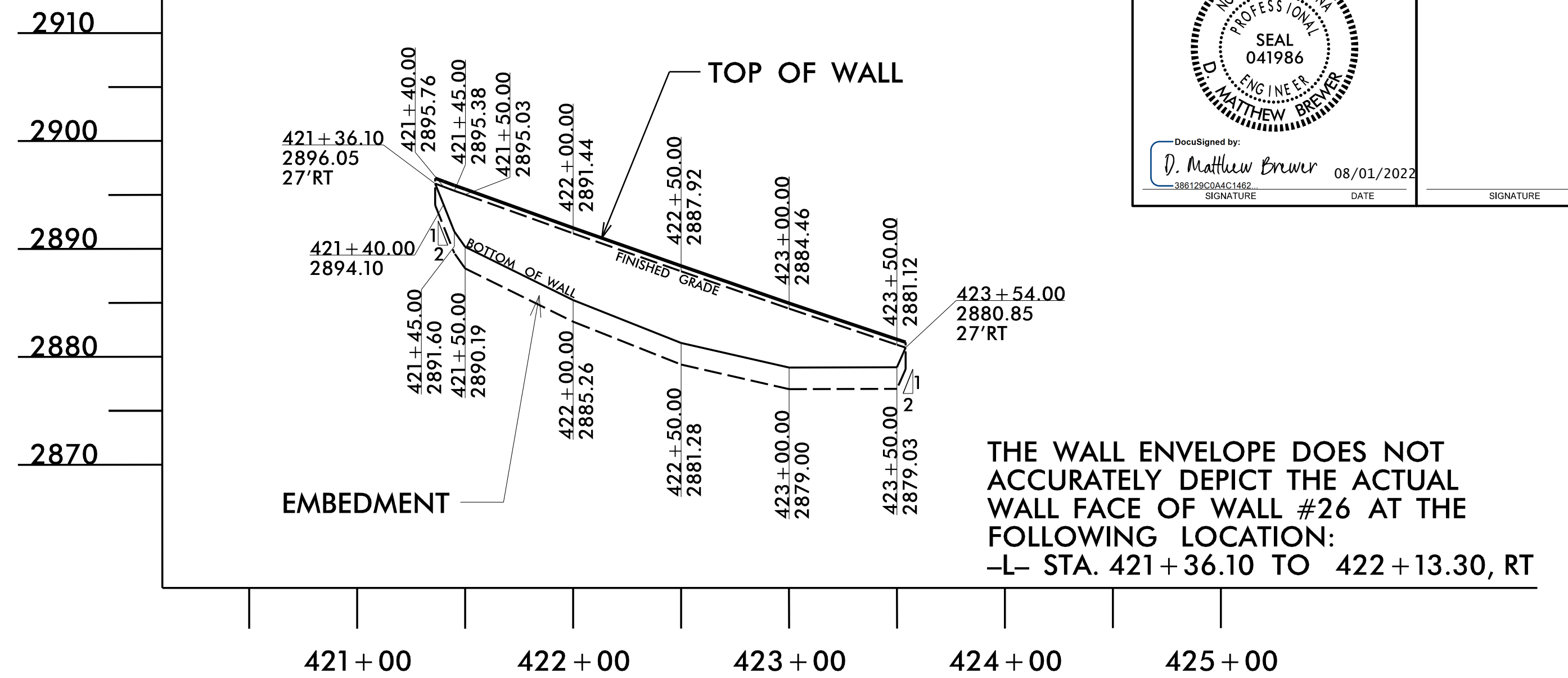

THE WALL ENVELOPE DOES NOT ACCURATELY DEPICT THE ACTUAL WALL FACE OF WALL #26 AT THE FOLLOWING LOCATION:  
 -L- STA. 421+36.10 TO 422+13.30, RT

## RETAINING WALL #26:

NOT TO SCALE  
 (LOOKING AT FACE OF WALL)

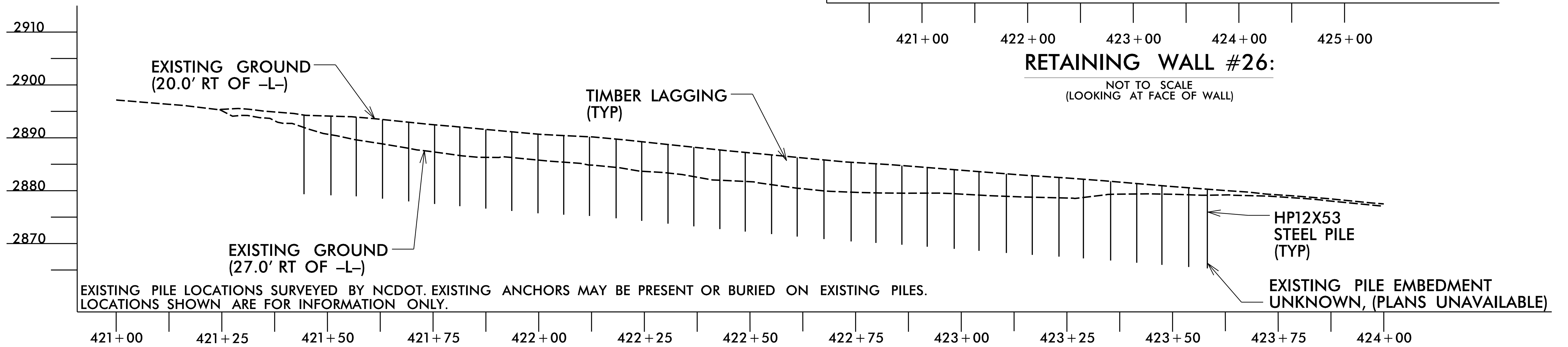

EXISTING PILE LOCATIONS SURVEYED BY NCDOT. EXISTING ANCHORS MAY BE PRESENT OR BURIED ON EXISTING PILES. LOCATIONS SHOWN ARE FOR INFORMATION ONLY.

## EXISTING WALL PROFILE - #26

NOT TO SCALE  
 (LOOKING AT FACE OF WALL)

MSE RETAINING WALL #26						
STA. -L-	OFFSET FROM -L- (FT)	FINISHED GRADE* (FT)	BOTTOM OF WALL (FT)	TOP OF LEVELING PAD (FT)	ESTIMATED MSE WALL EMBEDMENT (FT)	DESIGN MSE WALL HEIGHT "H" (FT)
421+36.10	27.00 RT	2896.05	2896.05	2894.05	2.00	2.00
421+40.00	27.00 RT	2895.76	2894.10	2892.10	2.00	3.66
421+45.00	27.00 RT	2895.38	2891.60	2889.60	2.00	5.78
421+50.00	27.00 RT	2895.03	2890.19	2888.19	2.00	6.84
422+00.00	27.00 RT	2891.44	2885.26	2883.26	2.00	8.18
422+50.00	27.00 RT	2887.92	2881.28	2879.28	2.00	8.64
423+00.00	27.00 RT	2884.46	2879.00	2877.00	2.00	7.46
423+50.00	27.00 RT	2881.12	2879.03	2877.03	2.00	4.09
423+54.00	27.00 RT	2880.85	2880.85	2878.85	2.00	2.00

\*FINISHED GRADE ELEVATION ADJACENT TO COPING EXTENSION, SEE TYPICAL DETAIL

## ESTIMATED RETAINING WALL QUANTITY

(SQUARE FEET)

MECHANICALLY STABILIZED EARTH (MSE) RETAINING WALL #26 1,680 SF\*

\*INCLUDES WALL EMBEDMENT

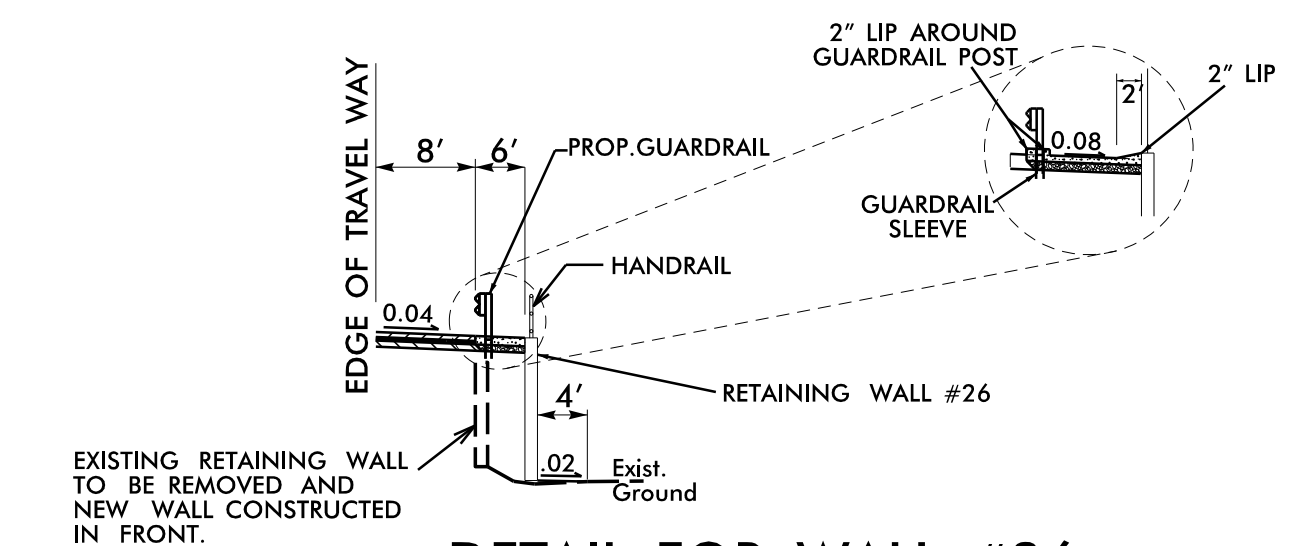

## DETAIL FOR WALL #26

NOT TO SCALE

-L- STA. 421+36.10 TO -L- STA. 423+54.00, RT

PROJECT NO.: A-0009CC

GRAHAM COUNTY

RETAINING WALL #26 STATION: -L- 421+36, 27' RT TO 423+54, 27' RT

SHEET 1 OF 3

Prepared in the Office of:

**CAROLINAS GEOTECHNICAL GROUP**  
 2400 CROWNPPOINT EXECUTIVE DRIVE  
 SUITE 800  
 CHARLOTTE, NC 28227  
 (980) 339-8684

## RETAINING WALL #26 MECHANICALLY STABILIZED EARTH (MSE) WALL

### REVISIONS

NO.	BY	DATE	NO.	BY	DATE
1			3		
2			4		

SHEET NO. W26-1

PREPARED BY: DMB DATE: 7/10/2022  
 REVIEWED BY: REK DATE: 7/10/2022

RETAINING WALL #26 ENVELOPE AND WALL LAYOUT PROVIDED BY TGS ENGINEERS, INC.