

# RETAINING WALL #22:

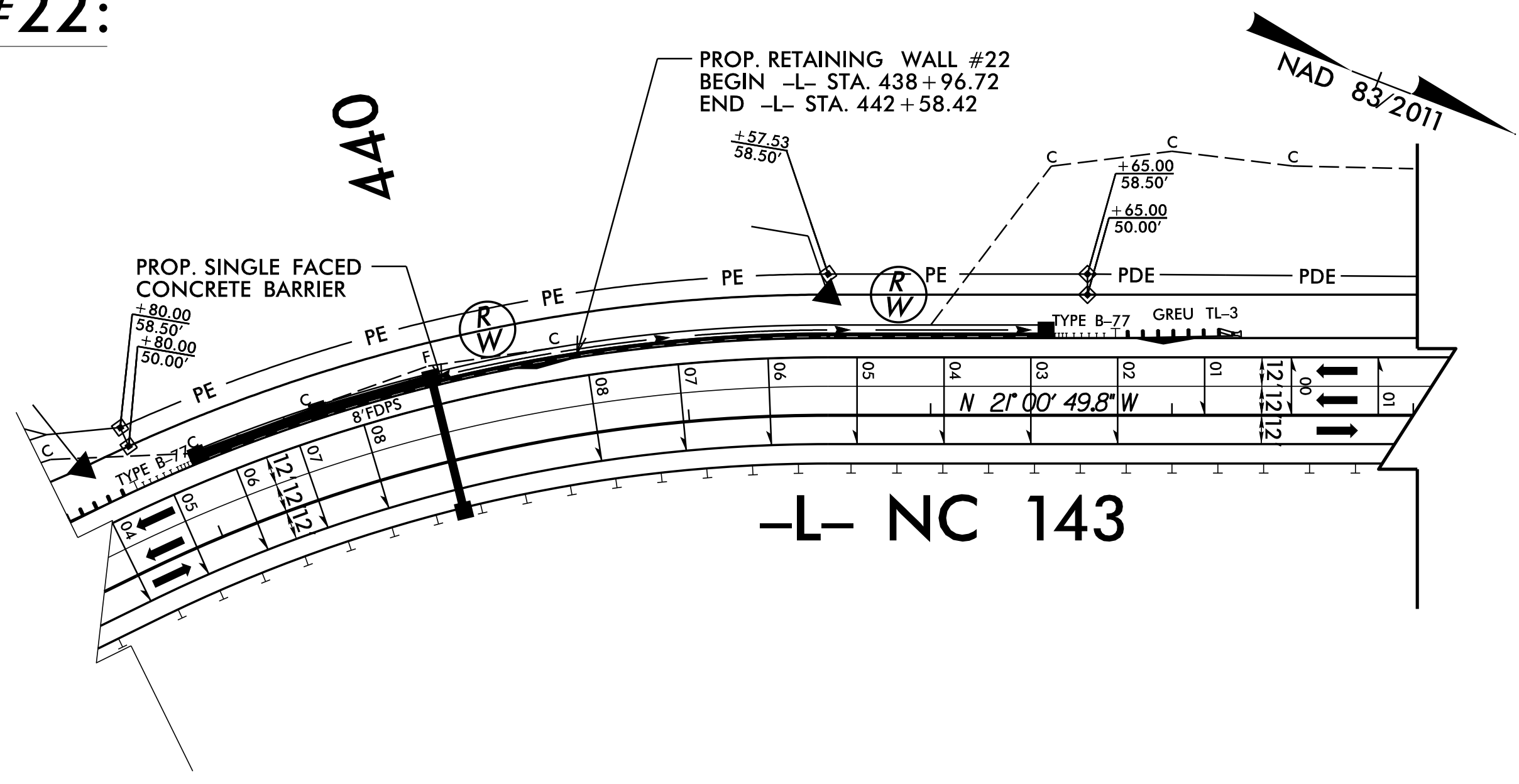

## RETAINING WALL #22 - PLAN

NOT TO SCALE

THE WALL ENVELOPE DOES NOT ACCURATELY DEPICT THE ACTUAL WALL FACE OF WALL #22 AT THE FOLLOWING LOCATION:  
 -L- STA. 438+96.72 TO 441+57.53, LT

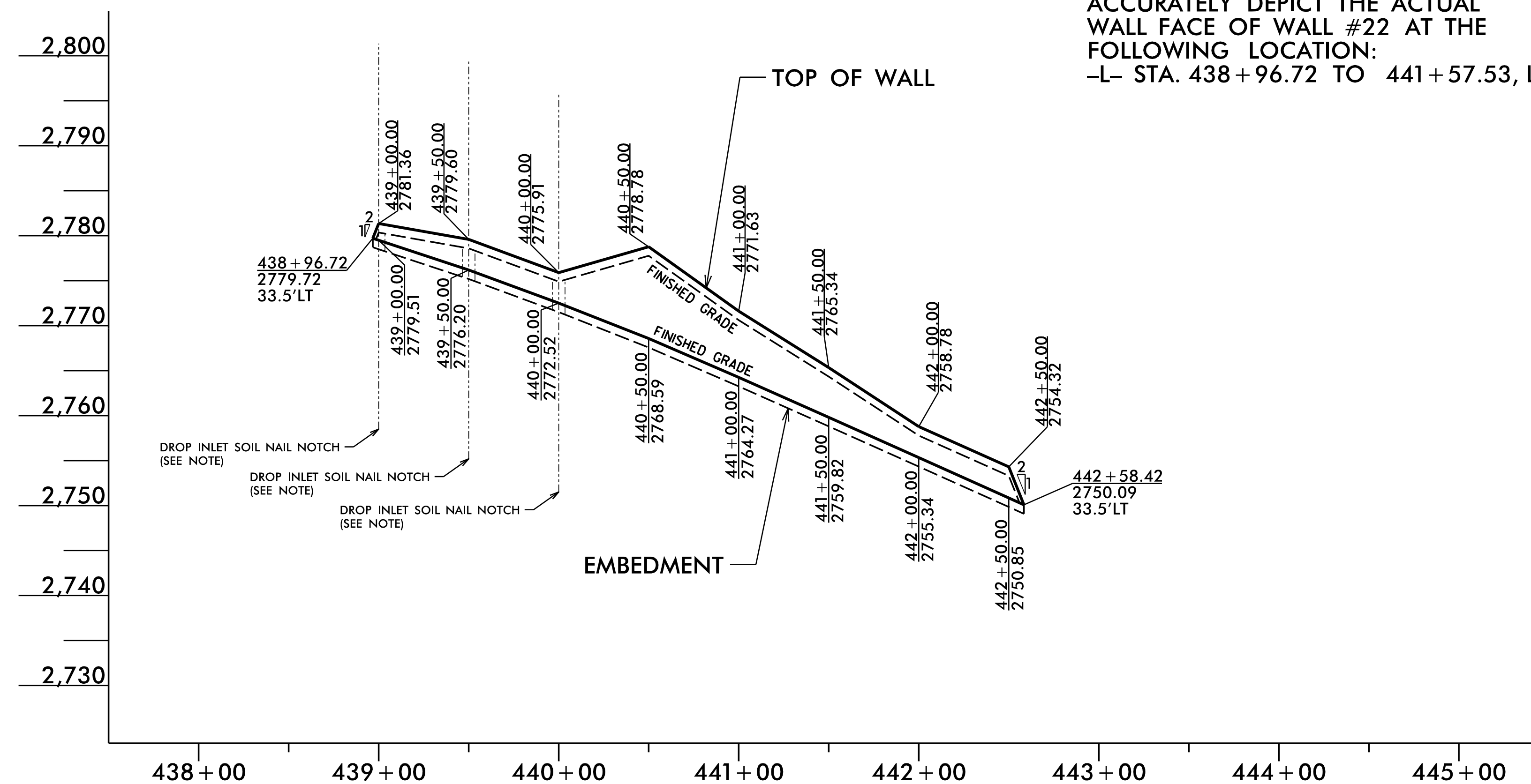

## RETAINING WALL #22 - ENVELOPE

NOT TO SCALE  
 (LOOKING AT FACE OF WALL)

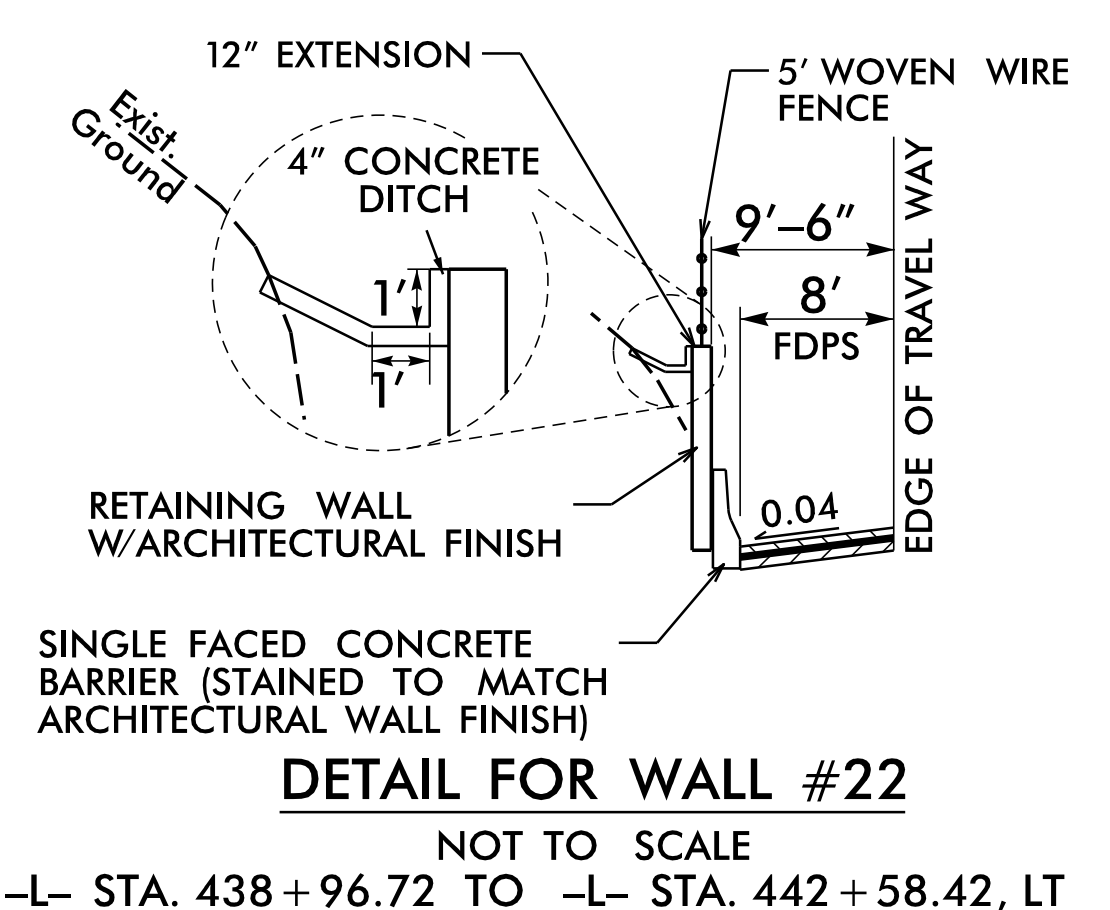

### DETAIL FOR WALL #22

NOT TO SCALE

-L- STA. 438+96.72 TO -L- STA. 442+58.42, LT

### ESTIMATED SOIL NAIL WALL QUANTITIES

RETAINING WALL NO.	SOIL NAIL RETAINING WALLS (SQUARE FEET)	SOIL NAIL VERIFICATION TESTS	SOIL NAIL PROOF TESTS
22	2,180 *	2	10
FORM LINER ARCHITECTURAL FINISH			2,180 * SF
HORIZONTAL DRAINS (CONTINGENCY)			185 LF

\* INCLUDES RETAINING WALL EMBEDMENT

### SOIL NAIL RETAINING WALL #22

STA. -L-	OFFSET FROM -L- (LT) FT.	ELEV. @ TOP OF WALL	BOW FINISHED GRADE	TOP OF LEVELING PAD	ESTIMATED WALL EMBEDMENT FT.	WALL DESIGN HEIGHT "H"
438+96.72	33.50	2779.72	2779.72	2778.72	1.00	1.00
439+00.00	33.50	2781.36	2779.51	2778.51	1.00	1.85
439+50.00	33.50	2779.60	2776.20	2775.20	1.00	3.40
440+00.00	33.50	2775.91	2772.52	2771.52	1.00	3.39
440+50.00	33.50	2778.78	2768.59	2767.59	1.00	10.19
441+00.00	33.50	2771.63	2764.27	2763.27	1.00	7.36
441+50.00	33.50	2765.34	2759.82	2758.82	1.00	5.52
442+00.00	33.50	2758.78	2755.34	2754.34	1.00	3.44
442+50.00	33.50	2754.32	2750.85	2749.85	1.00	3.47
442+58.42	33.50	2750.09	2750.09	2749.09	1.00	1.00

BOW = BOTTOM OF WALL  
 ALL MEASUREMENTS ARE IN FEET

PROJECT NO.: A-0009CC

GRAHAM COUNTY

RETAINING WALL #22: -L- 438+96, 34' LT TO 442+58, 34' LT

SHEET 1 OF 3

PREPARED BY: R. KRAL  
 REVIEWED BY: M. BREWER

DATE: 7/9/2022  
 DATE: 7/9/2022

RETAINING WALL #22 ENVELOPE AND WALL LAYOUT PROVIDED BY TGS ENGINEERS, INC.

Prepared in the Office of:

**CAROLINAS GEOTECHNICAL GROUP**  
 2400 CROWPOINT EXECUTIVE DRIVE  
 SUITE 800  
 CHARLOTTE, NC 28227  
 (980) 339-8684

**NORTH CAROLINA DEPARTMENT OF TRANSPORTATION DIVISION OF HIGHWAYS**

**GEOTECHNICAL ENGINEERING UNIT**

REVISIONS						SHEET NO.
NO.	BY	DATE	NO.	BY	DATE	
1			3			W22-1
2			4			