



# RETAINING WALL #21:

GEOTECHNICAL ENGINEER  SEAL 042642 ROBERT E. KRAL	ENGINEER
DocuSigned by:  SIGNATURE	08/01/2022 DATE
<b>DOCUMENT NOT CONSIDERED FINAL UNLESS ALL SIGNATURES COMPLETED</b>	

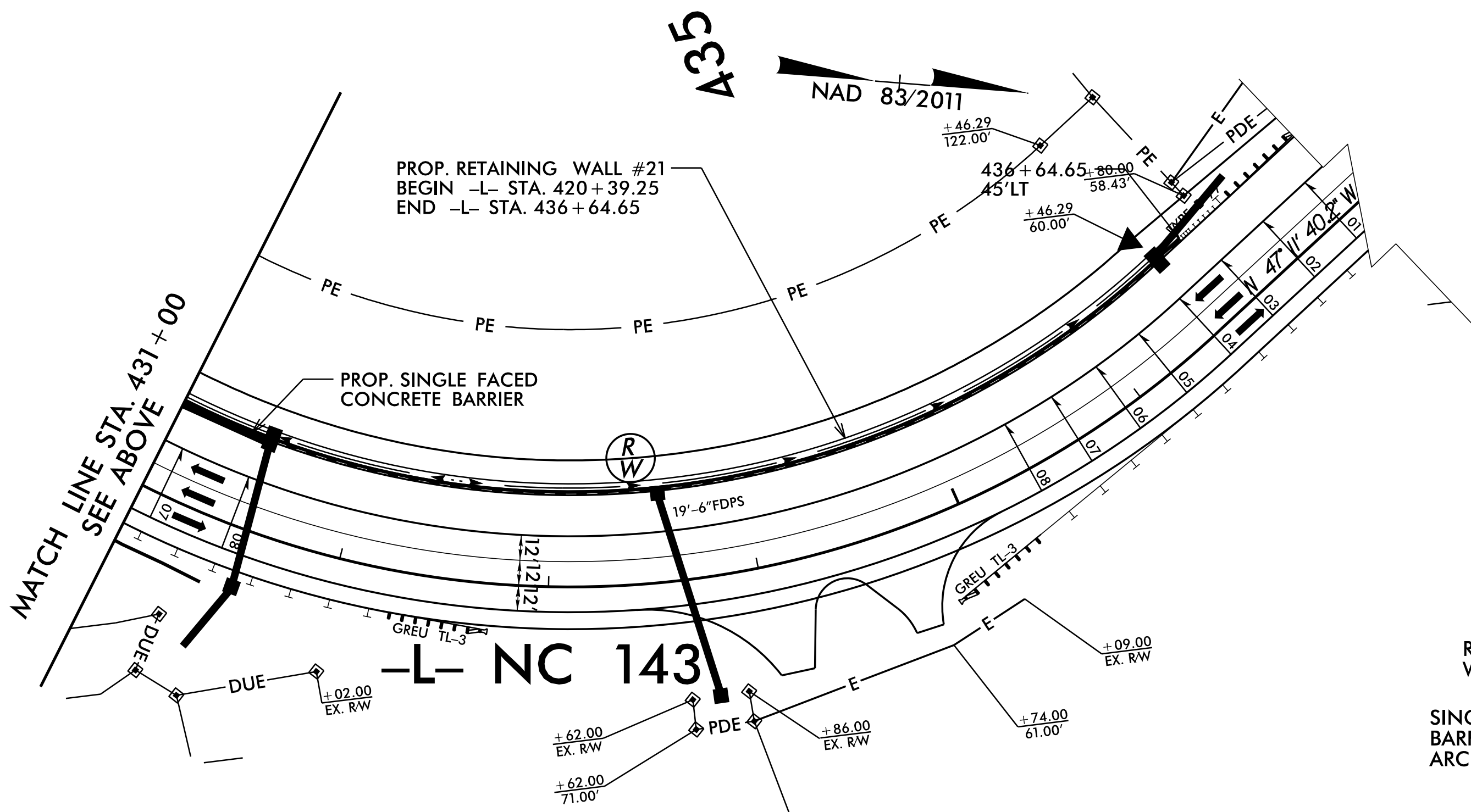
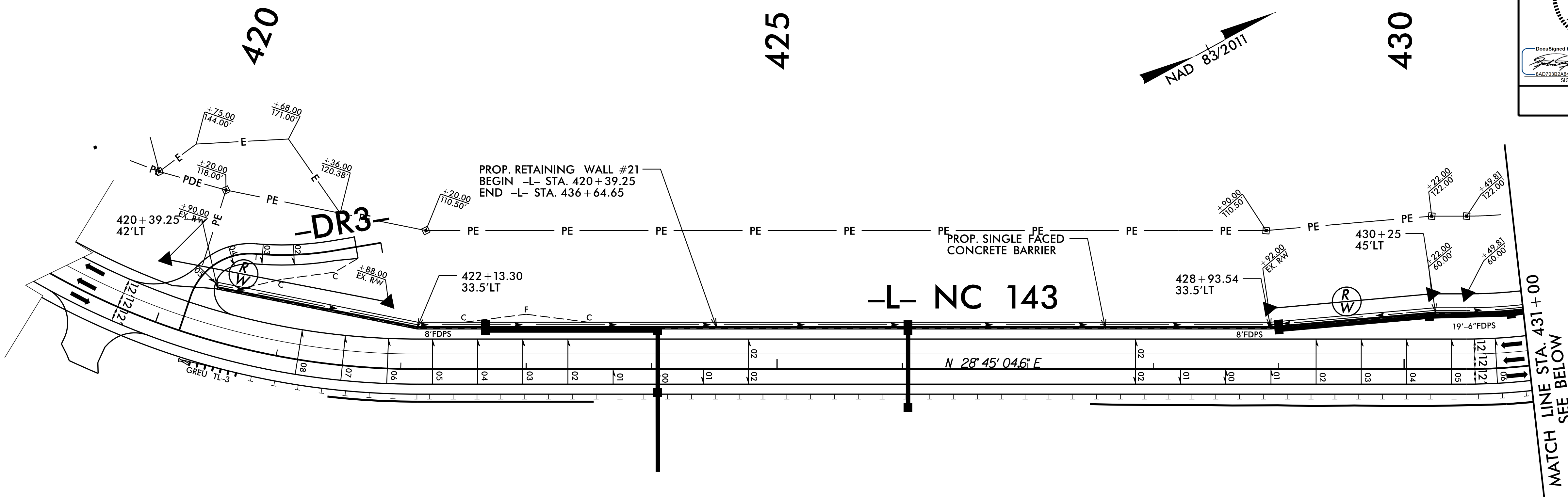

### ESTIMATED SOIL NAIL WALL QUANTITIES

RETAINING WALL NO.	SOIL NAIL RETAINING WALLS (SQ. FEET)	SOIL NAIL VERIFICATION TESTS	SOIL NAIL PROOF TESTS
21	26,290*	5	55
FORM LINER ARCHITECTURAL FINISH			26,290* SF
HORIZONTAL DRAINS (CONTINGENCY)			815 LF

\*INCLUDES RETAINING WALL EMBEDMENT

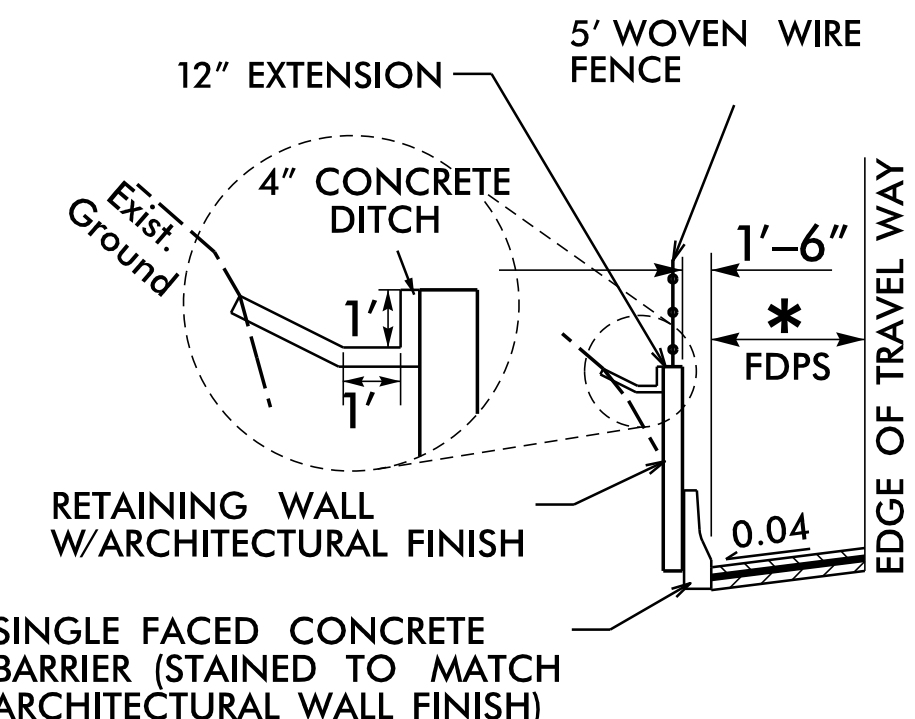

### DETAIL FOR WALL #21

NOT TO SCALE  
-L- STA. 420+39.25 TO -L- STA. 436+64.65, LT

PROJECT NO.: A-0009CC  
GRAHAM COUNTY  
RETAINING WALL #21: -L- 420+39, 42' LT TO 436+65, 45' LT  
SHEET 1 OF 5

## RETAINING WALL #21 - PLAN

NOT TO SCALE

PREPARED BY: R. KRAL  
REVIEWED BY: M. BREWER

DATE: 8/1/2022  
DATE: 8/1/2022

RETAINING WALL #21 ENVELOPE AND WALL LAYOUT PROVIDED BY  
TGS ENGINEERS, INC.

Prepared in the Office of:



**CAROLINAS  
GEOTECHNICAL  
GROUP**  
2400 CROWNPOINT EXECUTIVE DRIVE  
SUITE 800  
CHARLOTTE, NC 28227  
(980) 339-8684

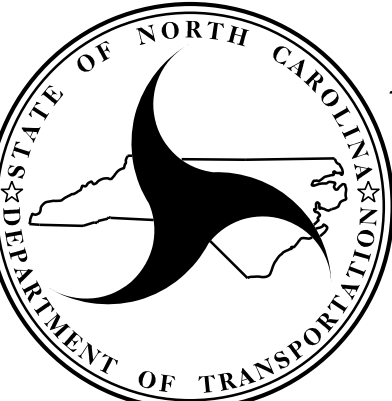

**NORTH CAROLINA  
DEPARTMENT OF TRANSPORTATION  
DIVISION OF HIGHWAYS**

**GEOTECHNICAL  
ENGINEERING UNIT**

REVISIONS						SHEET NO.
NO.	BY	DATE	NO.	BY	DATE	
1			3			W21-1
2			4			