

PROJECT REFERENCE NO. A-0009CC	SHEET NO. 39
ROADWAY DESIGN ENGINEER JIMMY L. TERRY 35018 10/18/2022	HYDRAULICS ENGINEER DAVID B. PETTIT 038697 10/18/2022

**DOCUMENT NOT CONSIDERED FINAL
UNLESS ALL SIGNATURES COMPLETED**

TGS ENGINEERS
201 W. MARION ST
SHELBY, NC 28150
PH: (704) 476-0003
CORP. LICENSE NO.: C-0275

-Y2- CURVE DATA		-L- CURVE DATA	
PI Sta 11+99.45	PI Sta 18+27.84	PI Sta 25+91.41	PI Sta 470+84.26
$\Delta = 19^\circ 44' 48.4" (LT)$	$\Delta = 38^\circ 45' 19.5" (RT)$	$\Delta = 15^\circ 17' 06.5" (RT)$	$\Delta = 2^\circ 31' 55.6" (LT)$
$D = 5' 00' 00.0"$	$D = 12' 52' 31.6"$	$D = 4' 46' 28.7"$	$D = 7' 32' 20.1"$
$L = 394.94'$	$L = 301.00'$	$L = 320.13'$	$L = 285.61'$
$T = 199.45'$	$T = 156.51'$	$T = 161.02'$	$T = 144.51'$
$R = 1145.92'$	$R = 445.00'$	$R = 1200.00'$	$R = 760.00'$
$SE = 0.08$	$SE = 0.08$	$SE = 0.08$	$SE = 0.04$
$DS = 55 \text{ MPH}$	$DS = 40 \text{ MPH}$	$DS = 60 \text{ MPH}$	$DS = 45 \text{ MPH}$

NOTE:
ALL DRIVEWAYS ARE TO BE ASPHALT UNLESS OTHERWISE NOTED.
END LOCATION OF DRIVEWAY SHOWN ON PLANS REPRESENTS TIE-IN
PER CROSS-SECTIONS, THE CONTRACTOR SHALL EXTEND THE DRIVES AND
PAVE UP TO THE RIGHT OF WAY LINE FROM ROW POINT ON MATCH
DRIVEWAY IN KIND, UNLESS OTHERWISE NOTED.

CONTRACTOR TO LOCATE AS DIRECTED BY ENGINEER.

CONTRACTOR TO LOCATE AS DIRECTED BY ENGINEER.

CONTRACTOR TO FIELD VERIFY UNDERGROUND STREAM
ELEVATION & DIMENSIONS & COORDINATE WITH
ENGINEER PRIOR TO ORDERING STRUCTURE #3904.

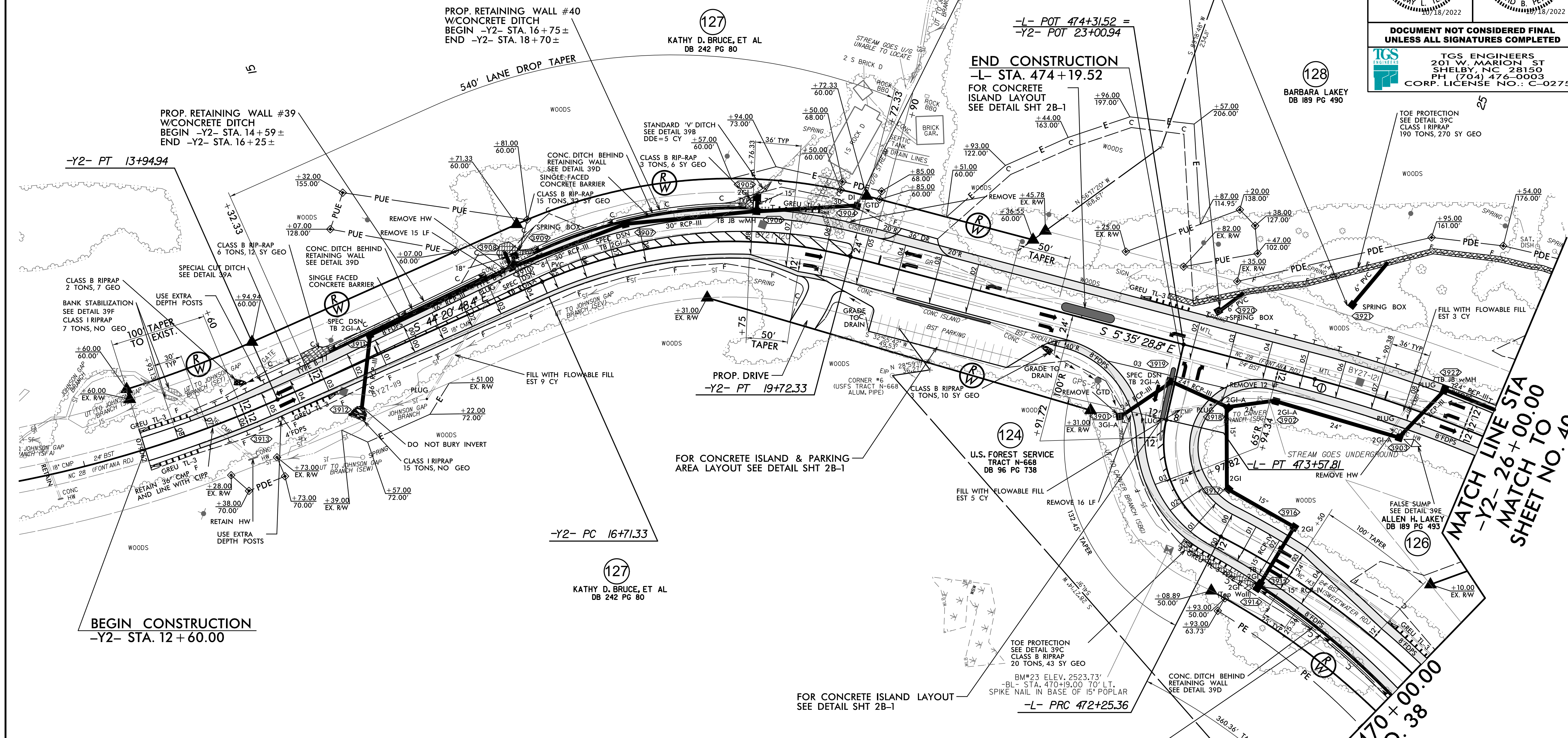

PROP. RETAINING WALL #39
W/CONCRETE DITCH
BEGIN -Y2- STA. 14+59 ±
END -Y2- STA. 16+25 ±

PROP. RETAINING WALL #40
W/CONCRETE DITCH
BEGIN -Y2- STA. 16+75 ±
END -Y2- STA. 18+70 ±

END CONSTRUCTION
-L- STA. 474+19.52
FOR CONCRETE ISLAND LAYOUT
SEE DETAIL SHT 2B-1

KATHY D. BRUCE, ET AL
DB 242 PG 80

BARBARA LAKEY
DB 189 PG 490

-Y2- PT 13+94.94

-Y2- PC 16+71.33

U.S. FOREST SERVICE
TRACT N-668
DB 96 PG 738

PROP. DRIVE
-Y2- PT 19+72.33

FOR CONCRETE ISLAND & PARKING
AREA LAYOUT SEE DETAIL SHT 2B-1

FOR CONCRETE ISLAND LAYOUT
SEE DETAIL SHT 2B-1

BEGIN CONSTRUCTION
-Y2- STA. 12+60.00

MATCH LINE STA
-Y2- 26+00.00
MATCH TO
SHEET NO. 40

-L- 470+00.00
MATCH TO SHEET NO. 38

THE CONTRACTOR SHOULD BE ADVISED THAT ANY CLEARING WITHIN THE
PERMANENT EASEMENT (PE) ALONG USFS PROPERTY SHALL ADHERE TO THE
AGREEMENT BETWEEN NCDOT AND THE USFS. THE CONTRACTOR IS TO
COORDINATE WITH THE RESIDENT ENGINEER AND DIVISION ENVIRONMENTAL
OFFICER PRIOR TO STARTING CLEARING OPERATIONS TO ENSURE COMPLIANCE.

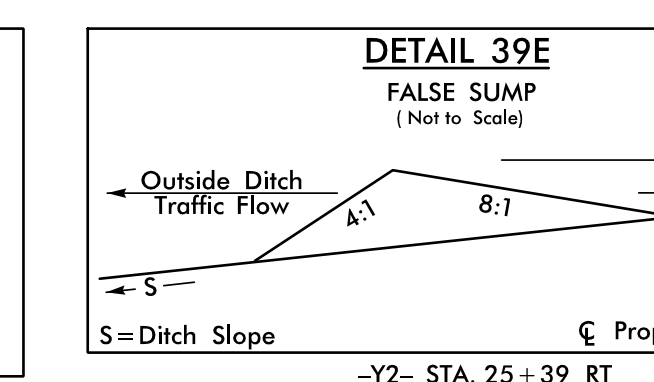
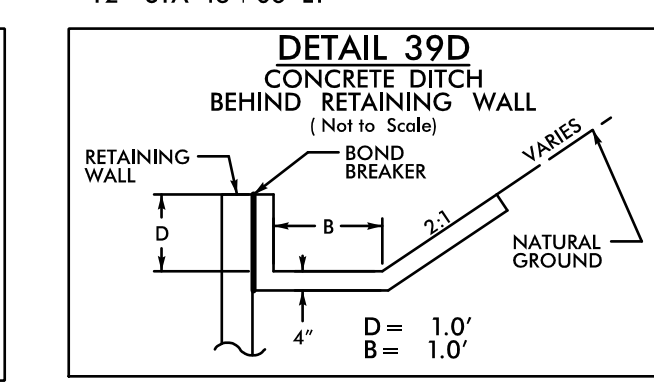
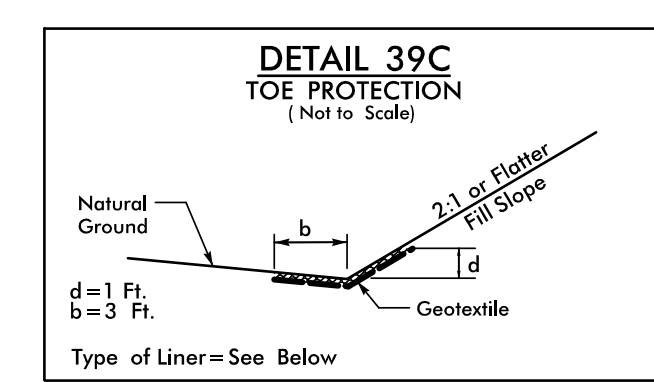
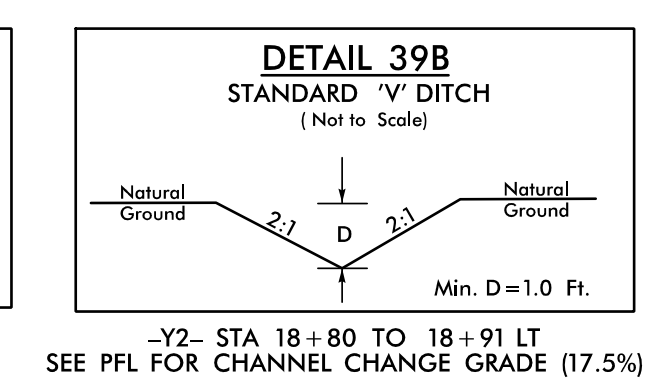
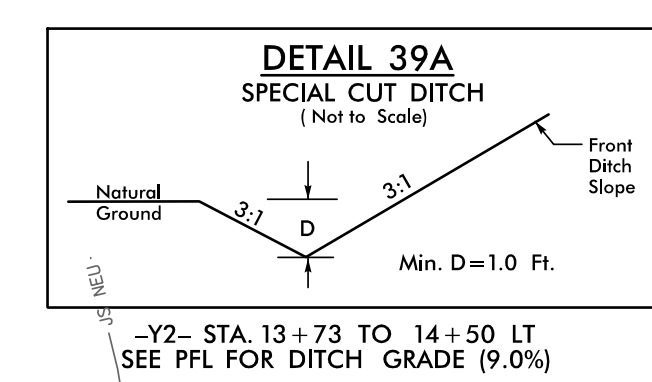
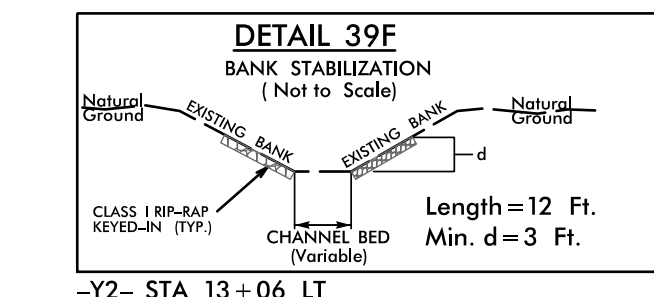

PROP. RETAINING WALL #25
W/CONCRETE DITCH
BEGIN -L- STA. 468+75.00
END -L- STA. 471+75.00

AVERAGE DAILY TRAFFIC	
-Y2- NC 28	3,790
-L- NC 28	5,200
1,930	2,600
2,900	3,300
740	1,000
2,600	3,300
1,000	4,300
2022 ADT	3,330
2045 ADT	4,300

FOR -L- PROFILE, SEE SHEET NO. 71
FOR -Y2- PROFILE, SEE SHEET NO. 71

REVISIONS

10/17/2022 A:\Roadway\Proj\A-0009CC_Plan
 Sheets\A-0009CC_Rdy_psh_39.dgn
 8.17.19.99