

8/17/2022

-L- CURVE DATA

PI Sta 456+91.51	PI Sta 470+84.26
$\Delta = 49^{\circ}15'00.2''$ (RT)	$\Delta = 21^{\circ}31'55.6''$ (LT)
D = 9' 32" 57.5"	D = 7' 32" 20.1"
L = 515.75'	L = 285.61'
T = 275.02'	T = 144.51'
R = 600.00'	R = 760.00'
SE = 0.08	SE = 0.04
DS = 45 MPH	DS = 45 MPH

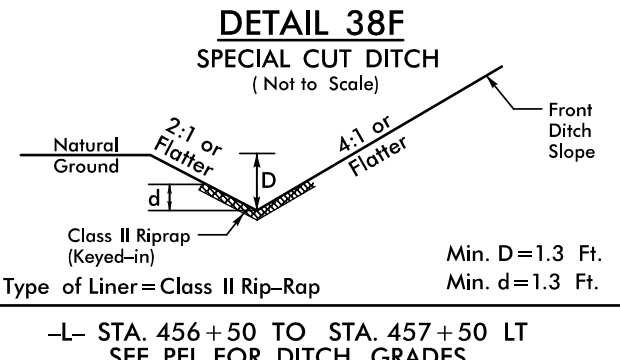
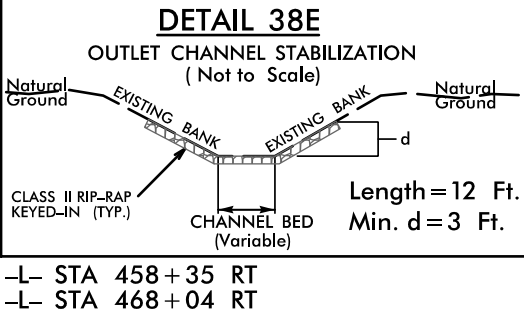
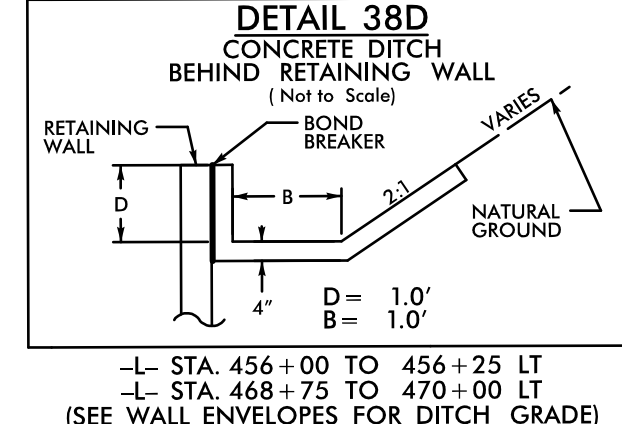
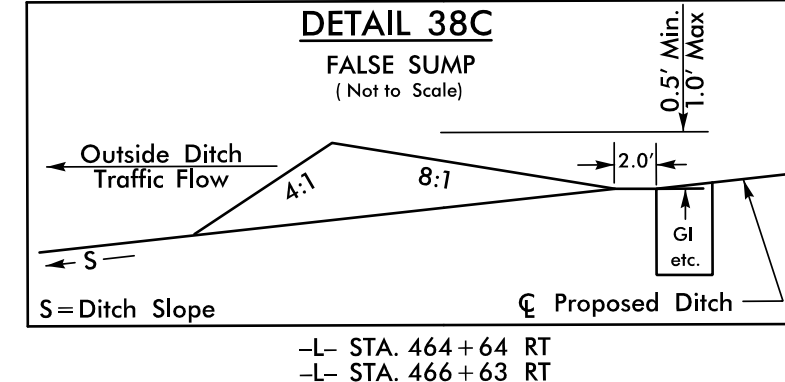
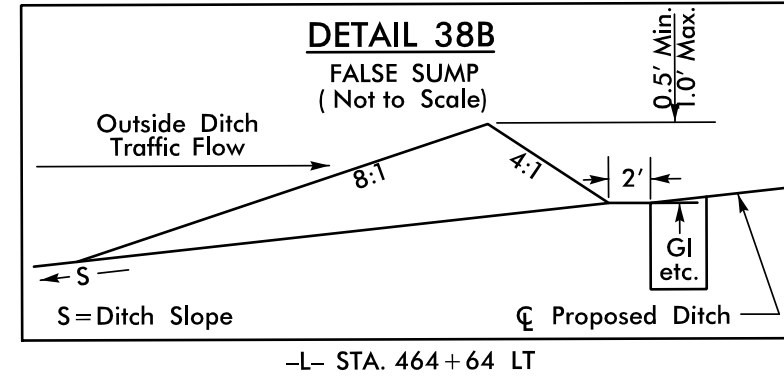
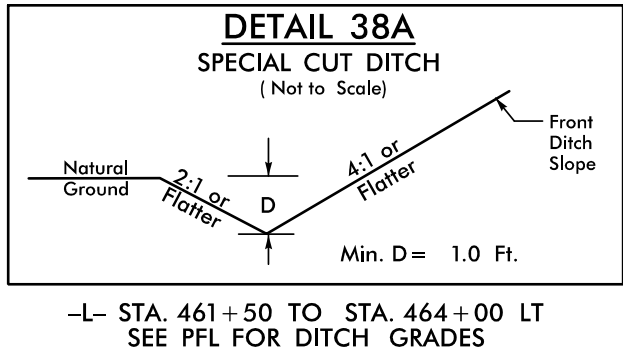

NOTE:
ALL DRIVEWAYS ARE TO BE ASPHALT UNLESS OTHERWISE NOTED.
END LOCATION OF DRIVEWAY SHOWN ON PLANS REPRESENTS TIE-IN PER CROSS-SECTIONS, THE CONTRACTOR SHALL EXTEND THE DRIVES AND PAVE UP TO THE RIGHT OF WAY LINE FROM ROW POINT ON MATCH DRIVEWAY IN KIND, UNLESS OTHERWISE NOTED.

THE CONTRACTOR SHOULD BE ADVISED THAT ANY CLEARING WITHIN THE PERMANENT EASEMENT (PE) ALONG USFS PROPERTY SHALL ADHERE TO THE AGREEMENT BETWEEN NCDOT AND THE USFS. THE CONTRACTOR IS TO COORDINATE WITH THE RESIDENT ENGINEER AND DIVISION ENVIRONMENTAL OFFICER PRIOR TO STARTING CLEARING OPERATIONS TO ENSURE COMPLIANCE.

PROJECT REFERENCE NO. A-0009CC	SHEET NO. 38
ROADWAY DESIGN	HYDRAULICS ENGINEER
11/8/2022	11/8/2022
DOCUMENT NOT CONSIDERED FINAL UNLESS ALL SIGNATURES COMPLETED	
TGS ENGINEERS 201 W. MARION ST SHELBY, NC 28150 PH (704) 476-0003 CORP. LICENSE NO.: C-0275	

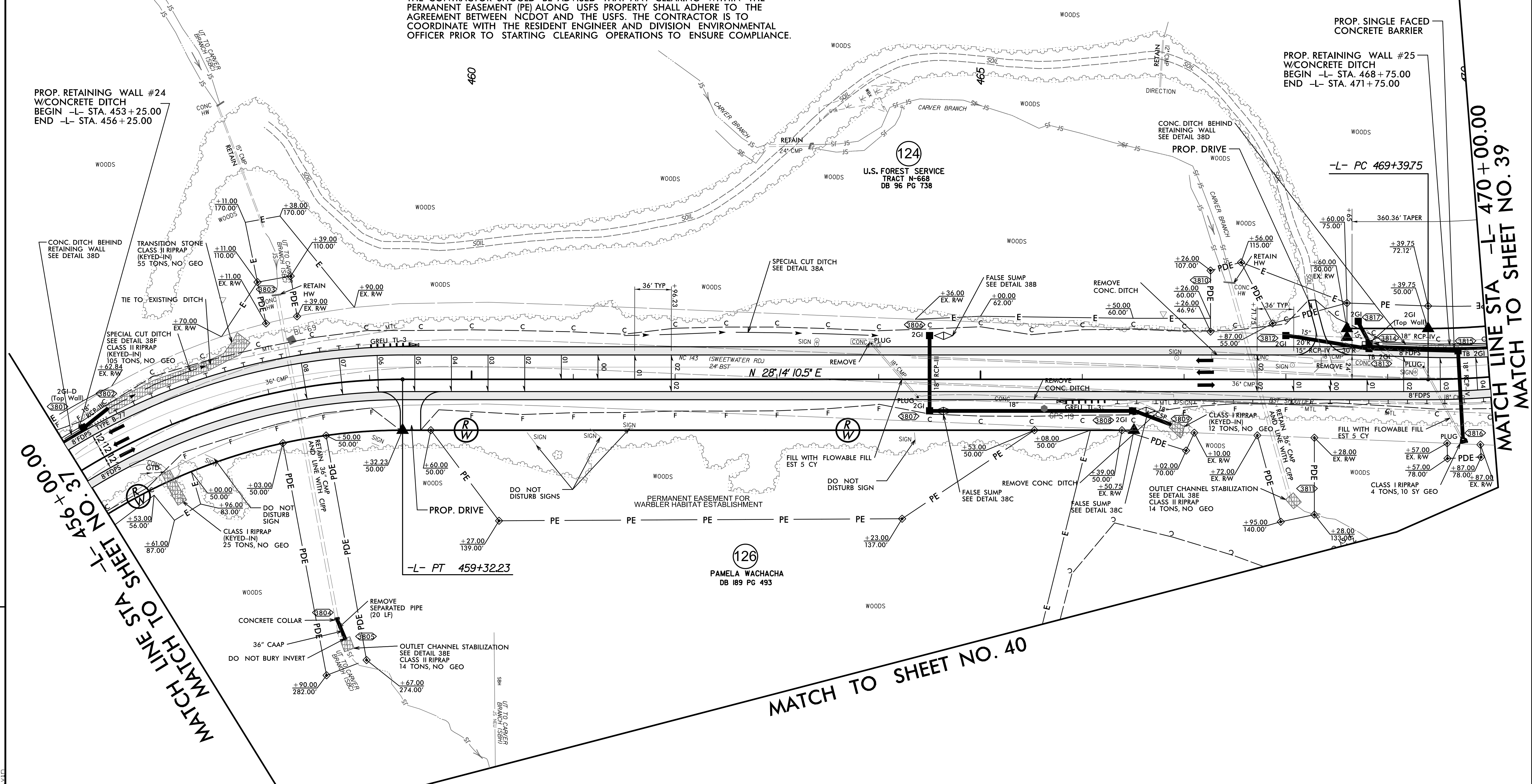

MATCH LINE STA -L- 456+00.00
MATCH TO SHEET NO. 37

MATCH TO SHEET NO. 40

MATCH LINE STA -L- 470+00.00
MATCH TO SHEET NO. 39

FOR -L- PROFILE, SEE SHEET NO. 70

X:\2022\A-0009\Roadway\Proj\A-0009CC_Plan_Sheets\A-0009CC_Rdy_psh_38.dgn
11/8/2022 11:51:52 AM